



US00D626386S

(12) **United States Design Patent**
Cohen

(10) **Patent No.:** **US D626,386 S**
(45) **Date of Patent:** **** Nov. 2, 2010**

(54) **COOKIE/ICE CREAM SCOOP**

(76) **Inventor:** **Betsy Cohen**, 45 Dunbar Rd., Palm Beach Gardens, FL (US) 33418

(**) **Term:** **14 Years**

(21) **Appl. No.:** **29/335,075**

(22) **Filed:** **Apr. 8, 2009**

(51) **LOC (9) Cl.** **07-99**

(52) **U.S. Cl.** **D7/681**

(58) **Field of Classification Search** D7/681,
D7/692; 294/1.1, 55; 425/187, 276-286;
73/426; 30/128, 130, 324

See application file for complete search history.

(56) **References Cited**

U.S. PATENT DOCUMENTS

2,439,125	A *	4/1948	Bolinger	425/280
D312,193	S *	11/1990	Cooper	D7/681
D361,480	S *	8/1995	Cooper	D7/681
D371,283	S *	7/1996	Cooper	D7/681
D487,381	S *	3/2004	Bates et al.	D7/681
D488,680	S *	4/2004	Kwok	D7/681
D532,262	S *	11/2006	Schuler	D7/681
7,270,530	B2 *	9/2007	Schulling	425/187
D575,999	S *	9/2008	Funka, Jr.	D7/681
D582,222	S *	12/2008	Lolsberg	D7/681

* cited by examiner

Primary Examiner—Charles A Rademaker

Assistant Examiner—Carissa C Fitts

(74) *Attorney, Agent, or Firm*—McHale & Slavin, P.A.

(57) **CLAIM**

The ornamental design for a cookie/ice cream scoop, as shown and described.

DESCRIPTION

FIG. 1 is a plane view of a cookie/ice cream scoop, showing my new design;

FIG. 2 is a left side view thereof;

FIG. 3 is a plane back view thereof;

FIG. 4 is a right side view thereof;

FIG. 5 is a corner perspective view thereof;

FIG. 6 is a bottom view thereof;

FIG. 7 is a top view thereof;

FIG. 8 is a cross sectional view of FIG. 4, taken along lines 8—8;

FIG. 9 is a cross sectional view of FIG. 1, taken along lines 9—9;

FIG. 10 is a front and side perspective view of the cookie/ice cream scoop shown in FIG. 1;

FIG. 11 is a front and side perspective view thereof with the scoop detached from the hand actuator;

FIG. 12 is a front and side perspective view of a modified embodiment of the cookie/ice cream scoop;

FIG. 13 is a front and side perspective view thereof with the scoop detached from the hand actuator;

FIG. 14 is a front and side perspective view of a second embodiment of the cookie/ice cream scoop; and,

FIG. 15 is a front and side perspective view thereof with the scoop detached from the hand actuator.

1 Claim, 5 Drawing Sheets

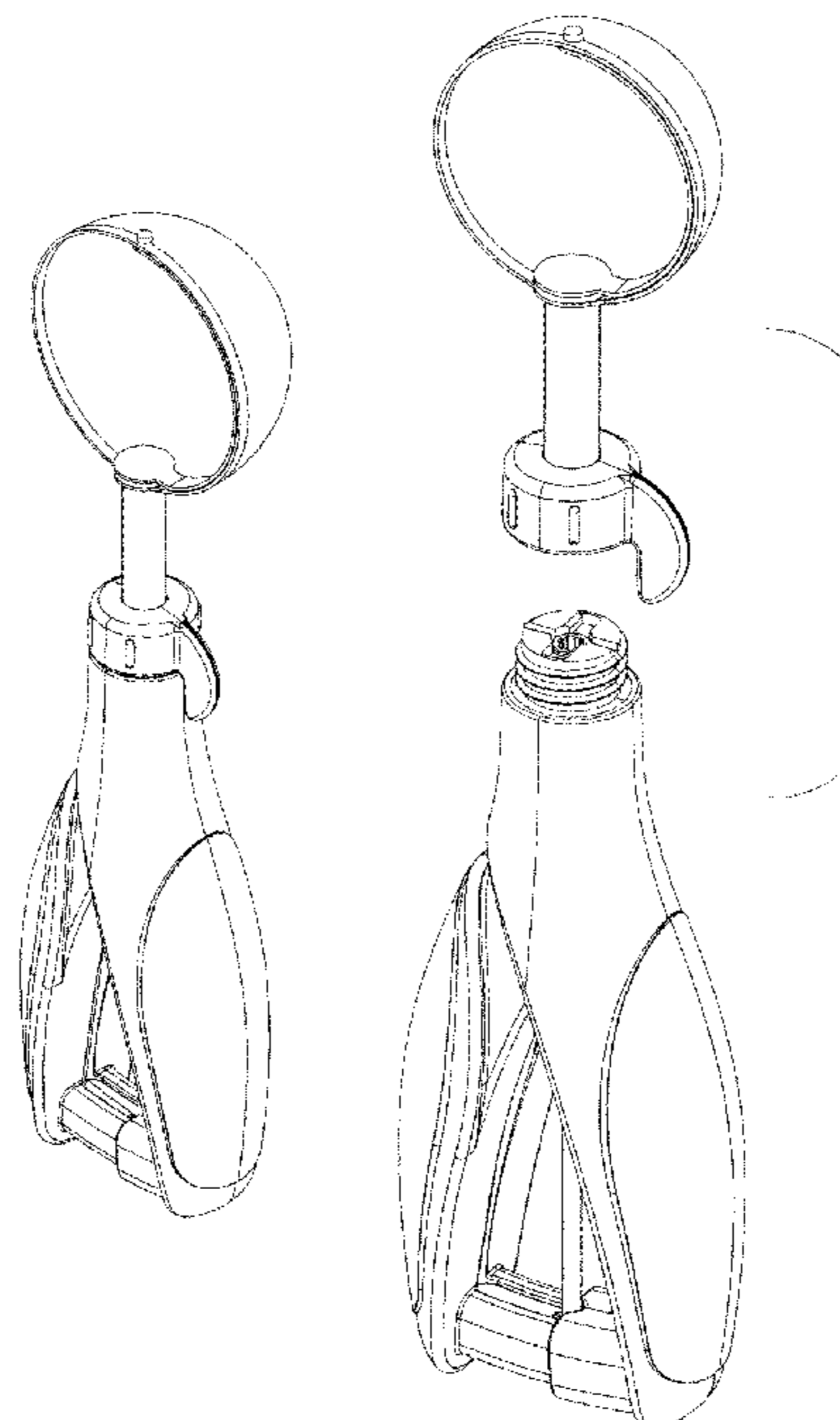

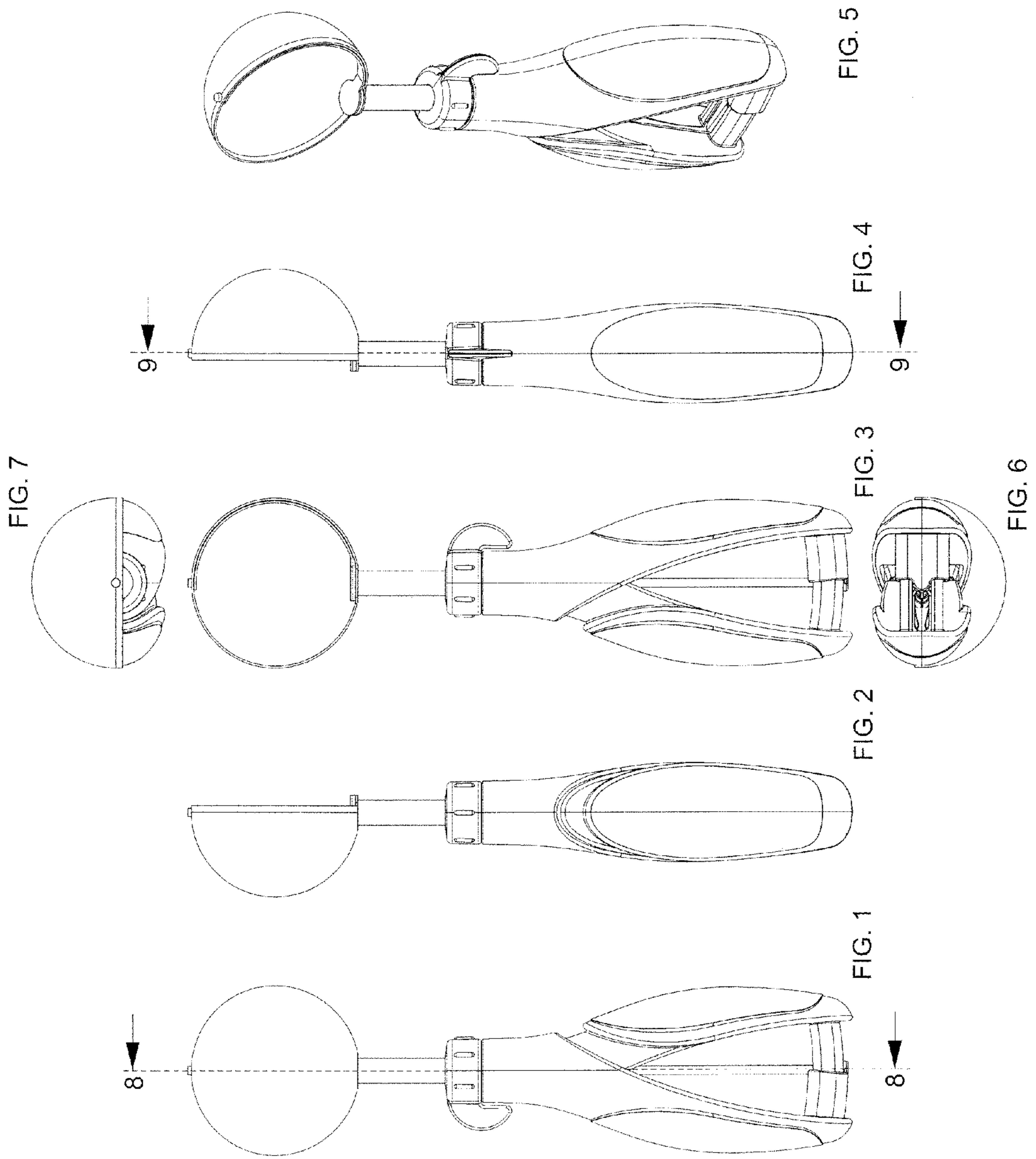

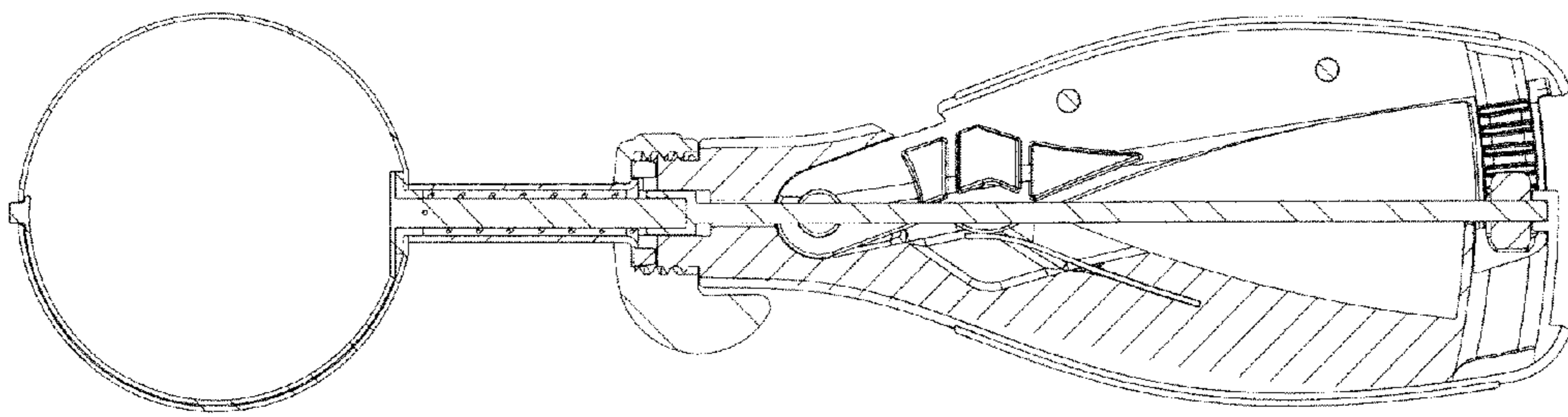

FIG. 9

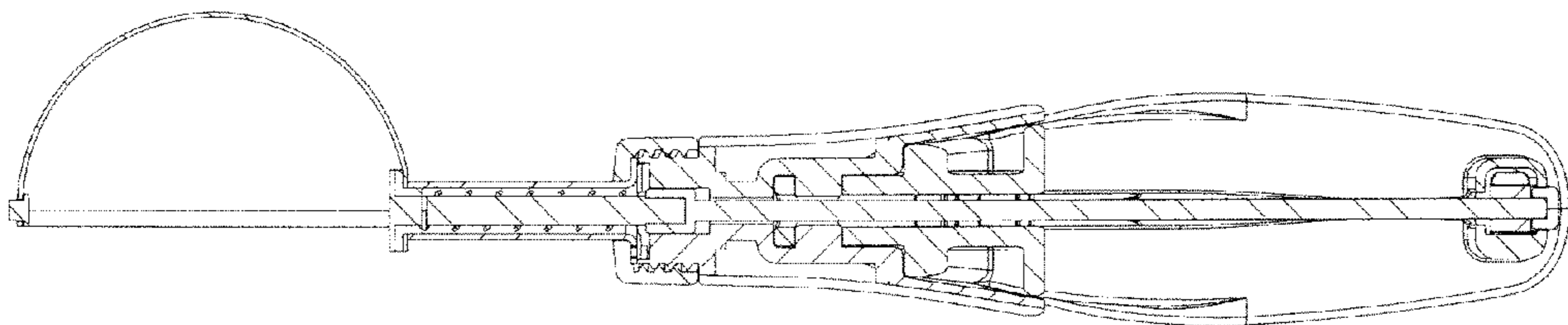

FIG. 8

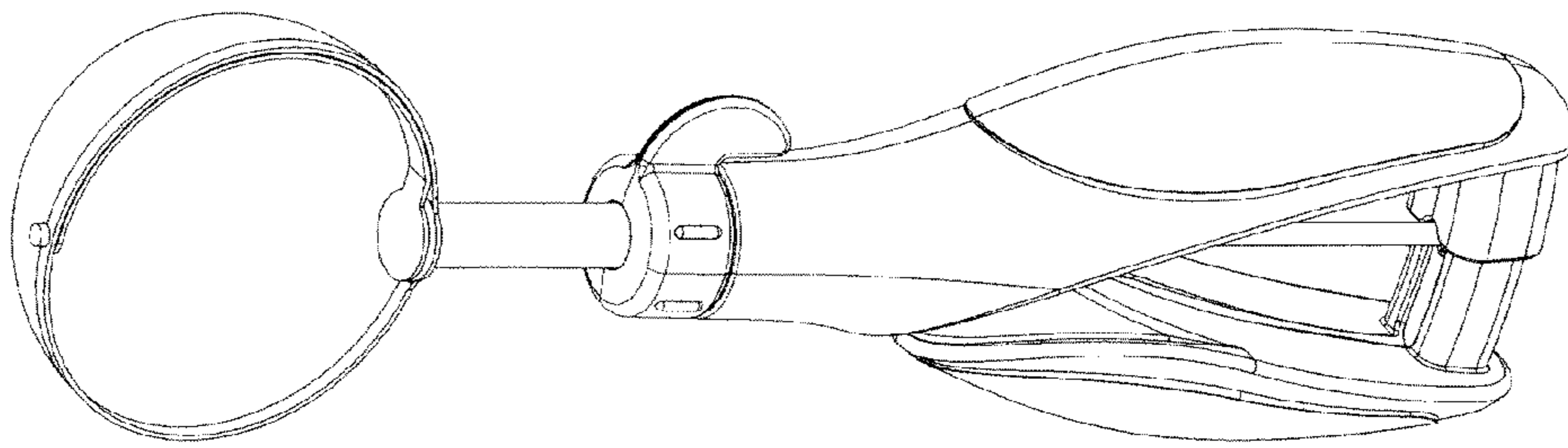

FIG. 10

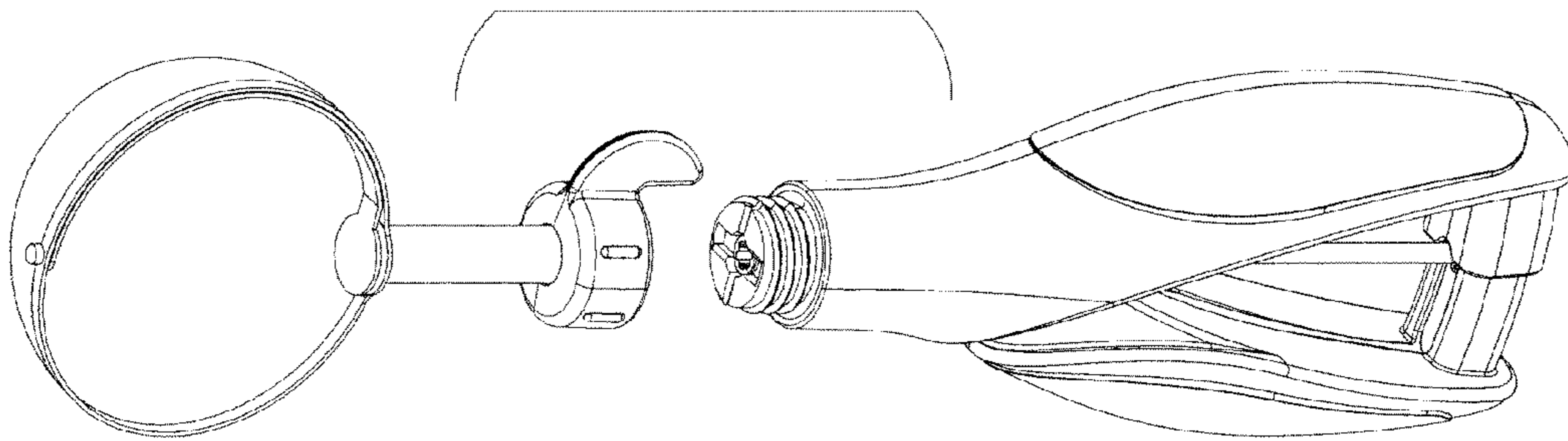

FIG. 11

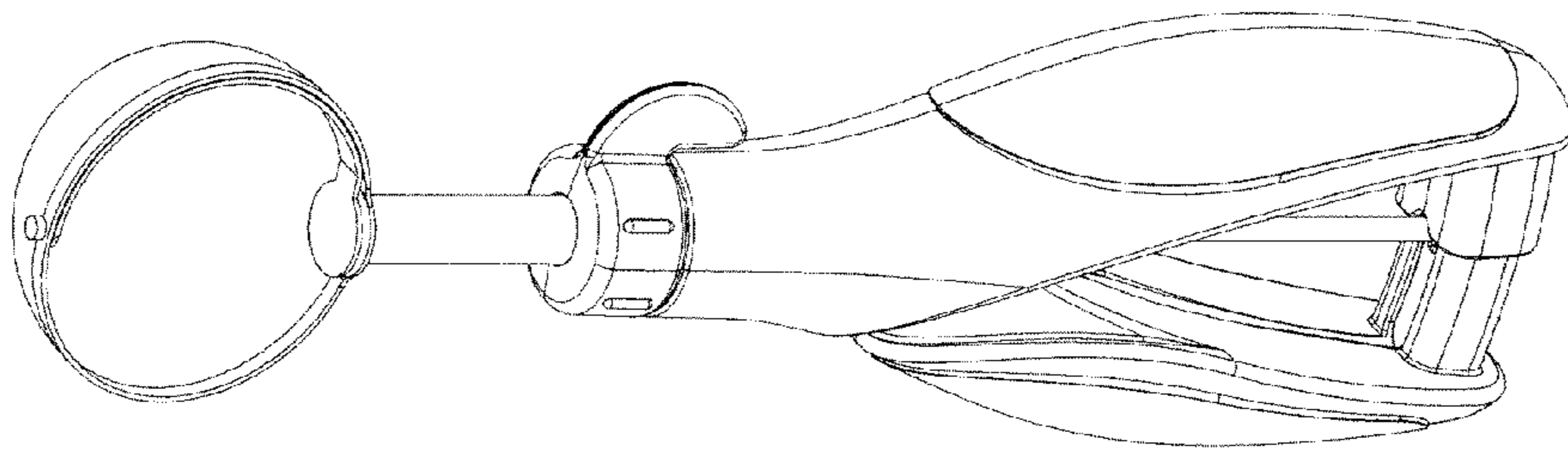

FIG. 12

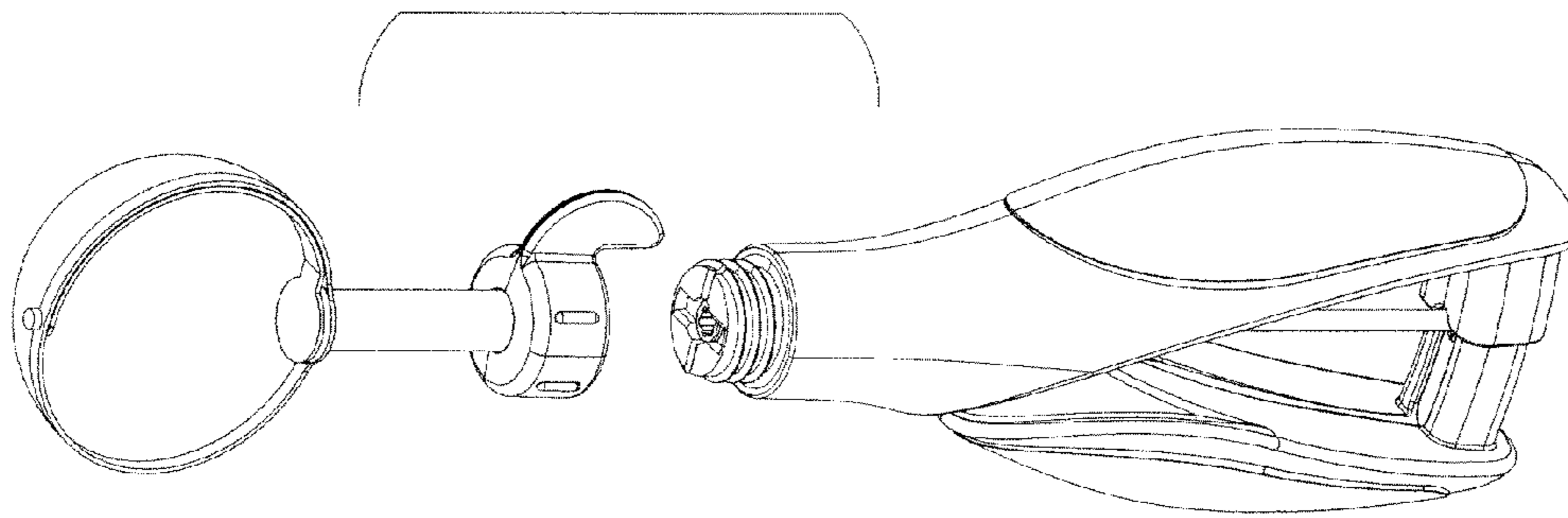

FIG. 13

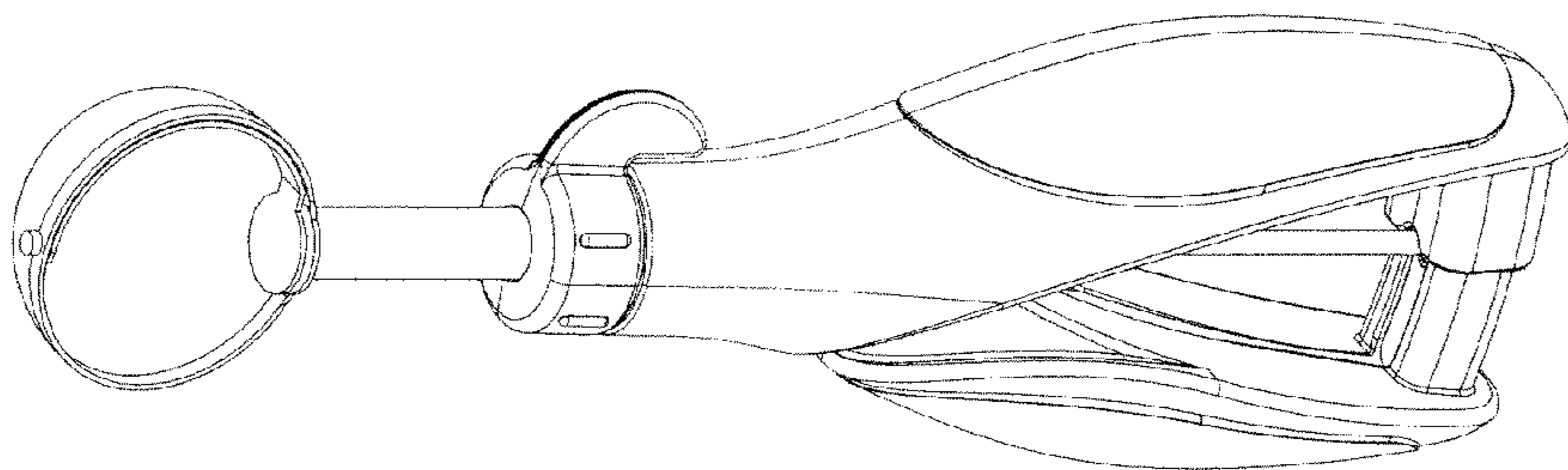

FIG. 14

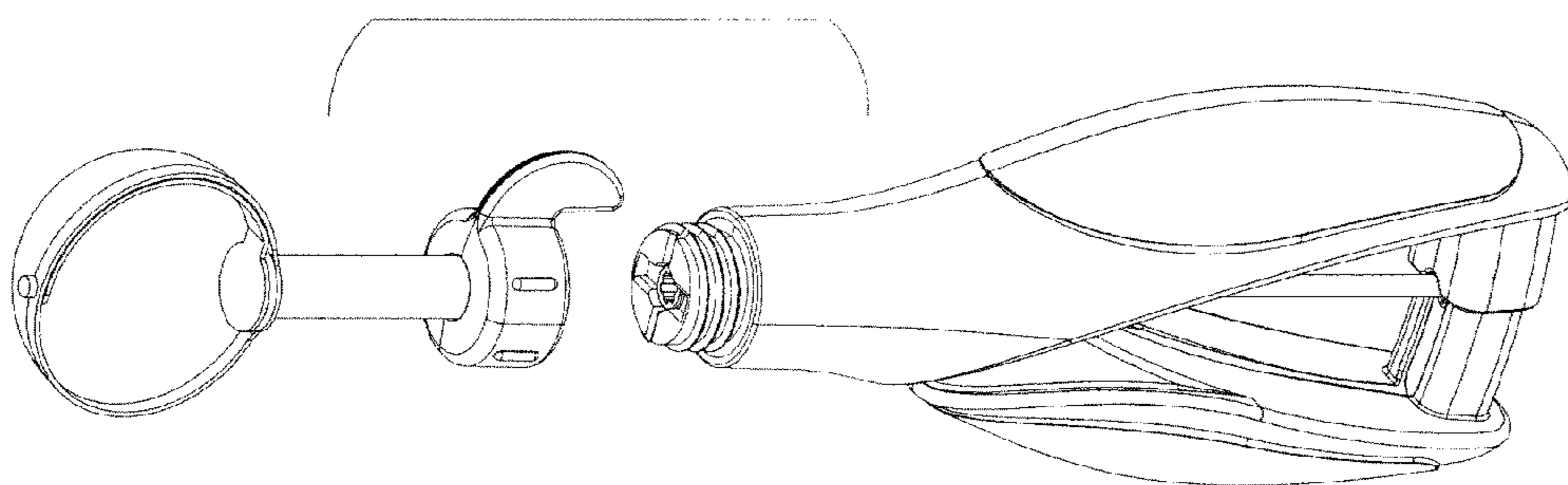

FIG. 15