



US00D626204S

(12) **United States Design Patent**
Morgan

(10) **Patent No.:** **US D626,204 S**

(45) **Date of Patent:** **** Oct. 26, 2010**

(54) **CANISTER FILTER**

(75) Inventor: **Lee Pendleton Morgan**, Jonesboro, AR (US)

(73) Assignee: **Camfil Farr, Inc.**, Jonesbro, AR (US)

(**) Term: **14 Years**

(21) Appl. No.: **29/334,721**

(22) Filed: **Mar. 31, 2009**

(51) **LOC (9) Cl.** **23-04**

(52) **U.S. Cl.** **D23/365**

(58) **Field of Classification Search** D23/365,
D23/209, 363, 358, 386, 354, 341, 364; 55/302,
55/385.3, 502, 497, 506, 505, 521, 495, 422,
55/493, DIG. 30; 210/497.01, 497.1, 167.12;
D32/31

See application file for complete search history.

(56) **References Cited**

U.S. PATENT DOCUMENTS

4,395,269	A	7/1983	Schuler	
4,491,460	A *	1/1985	Tokar	55/495
D349,567	S *	8/1994	Miller et al.	D23/365
D393,705	S *	4/1998	Dure	D23/365
5,803,939	A *	9/1998	Huning	55/502
D404,797	S *	1/1999	Jameson et al.	D23/209
6,056,796	A *	5/2000	Chiang et al.	55/302
D440,294	S *	4/2001	Bilek	D23/365
6,364,921	B1	4/2002	Raether et al.	
D458,670	S *	6/2002	Bosyi et al.	D23/365
6,488,746	B1	12/2002	Kosmider et al.	
D471,623	S *	3/2003	Gieseke et al.	D23/365

D475,129	S *	5/2003	Ward et al.	D23/365
D499,177	S *	11/2004	Kosmider et al.	D23/365
D521,137	S *	5/2006	Khalil	D23/365
7,524,349	B2 *	4/2009	Schrage et al.	55/502
2004/0261376	A1	12/2004	Morgan et al.	

* cited by examiner

Primary Examiner—David G Muller

(74) *Attorney, Agent, or Firm*—Patterson & Sheridan, LLP; Keith P. Taboada

(57) **CLAIM**

The ornamental design for a canister filter, as shown and described.

DESCRIPTION

This application is related to U.S. patent application Ser. No. 12/410,436, filed Mar. 24, 2008, entitled “Canister Filter and Method of Fabricating the Same” by Lee Pendleton Morgan, which is herein incorporated by reference in its entirety.

FIG. 1 presents an isometric view of a canister filter of the present invention;

FIG. 2 is a front elevation view of the canister filter of FIG. 1;

FIG. 3 is a back elevation view of the canister filter of FIG. 1;

FIG. 4 is side elevation view of the canister filter of FIG. 1, the opposite side being a mirror image thereof;

FIG. 5 is a top plan view of the canister filter of FIG. 1; and,

FIG. 6 is a bottom plan view of the canister filter of FIG. 1.

The broken lines depict portions of the filter cartridge that form no part of the claimed design.

1 Claim, 5 Drawing Sheets

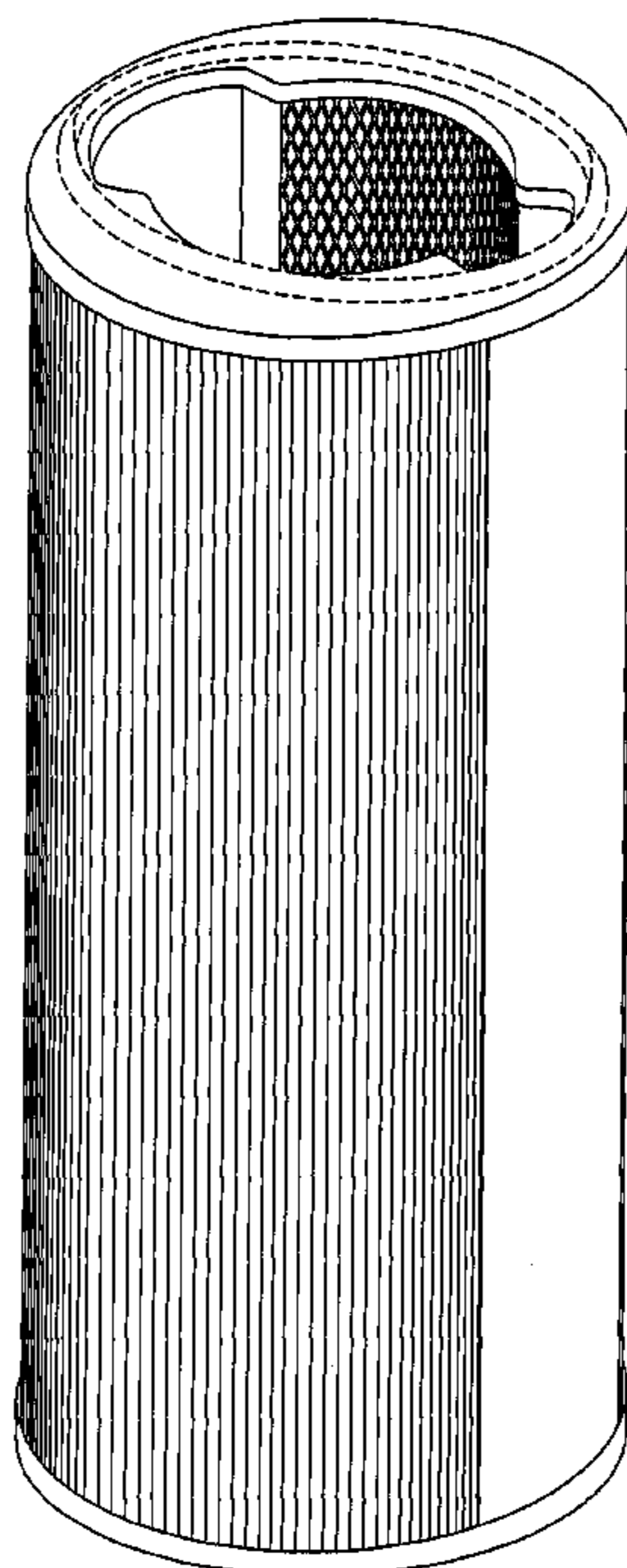

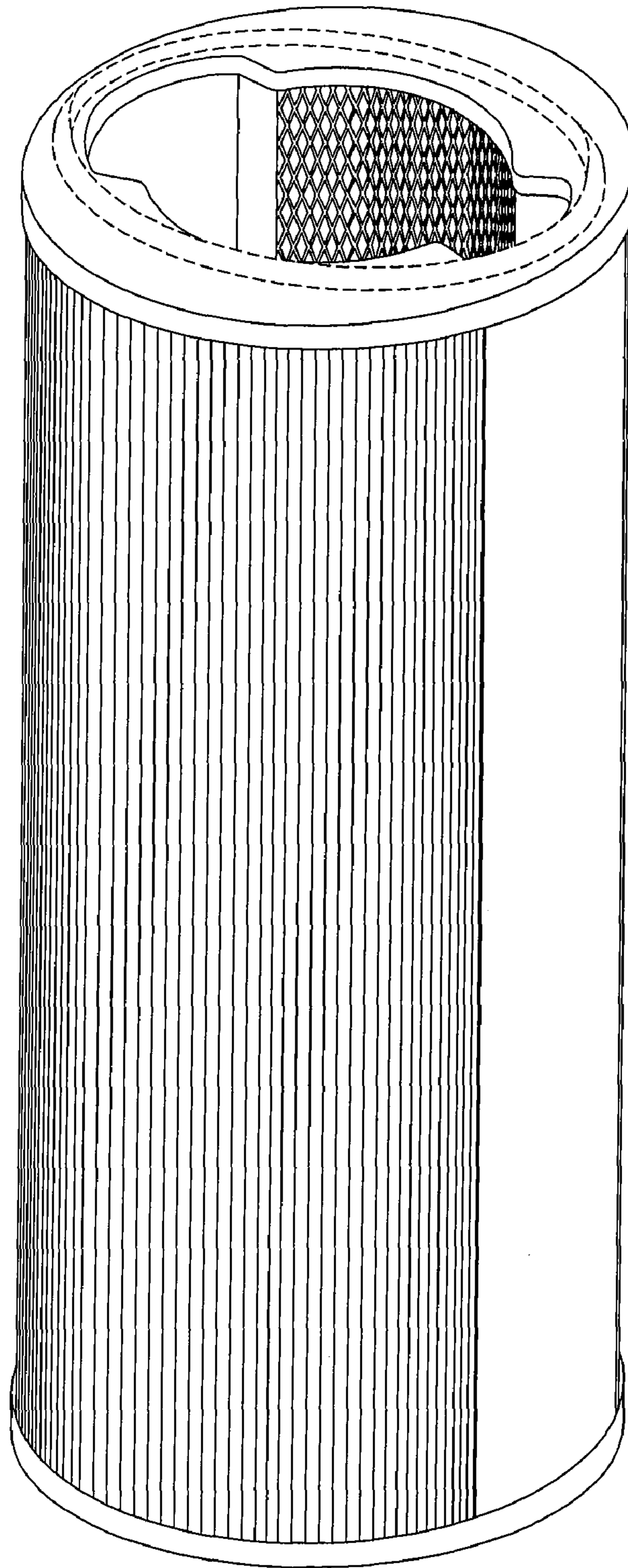

FIG .1

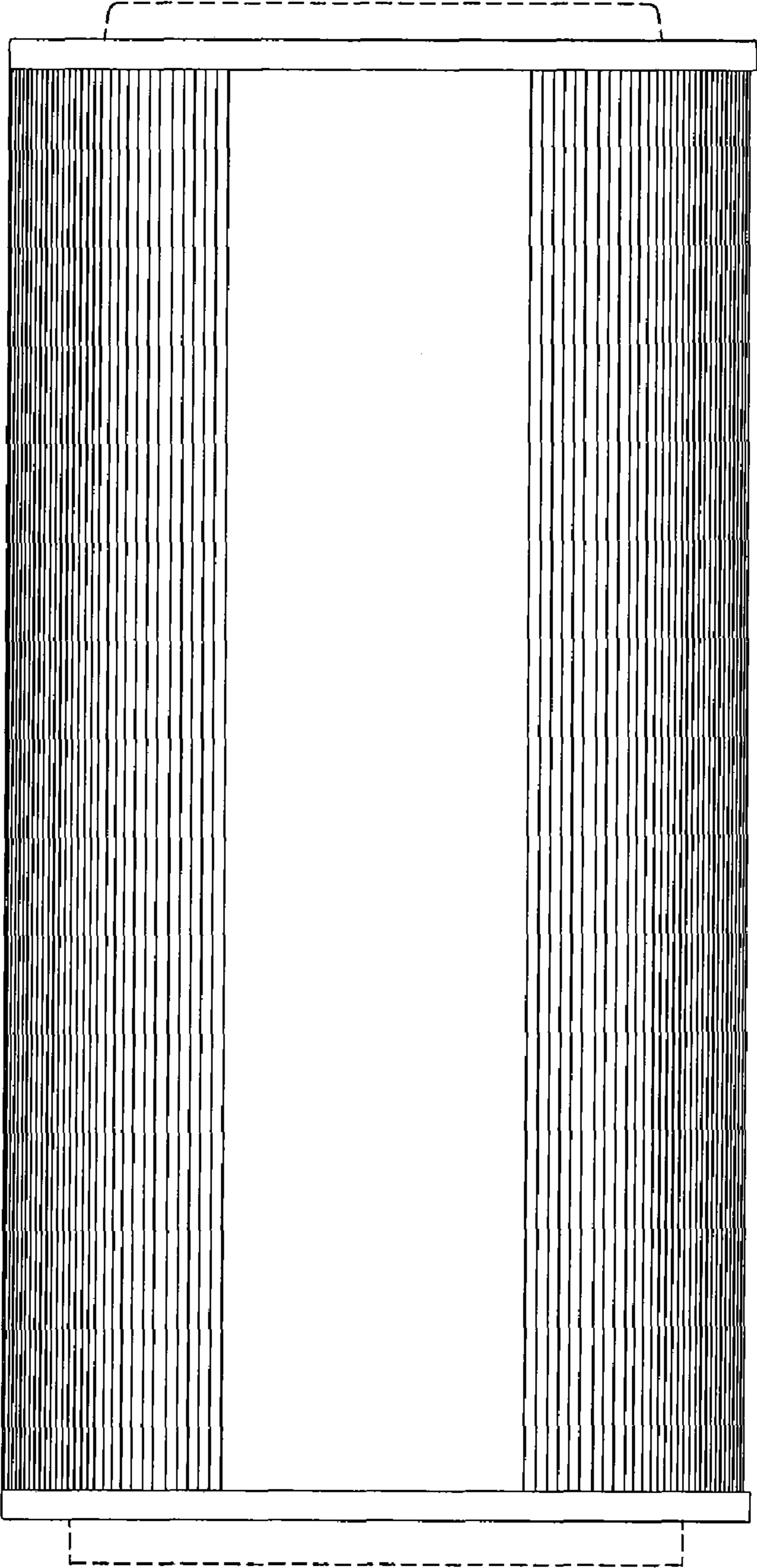

FIG. 2

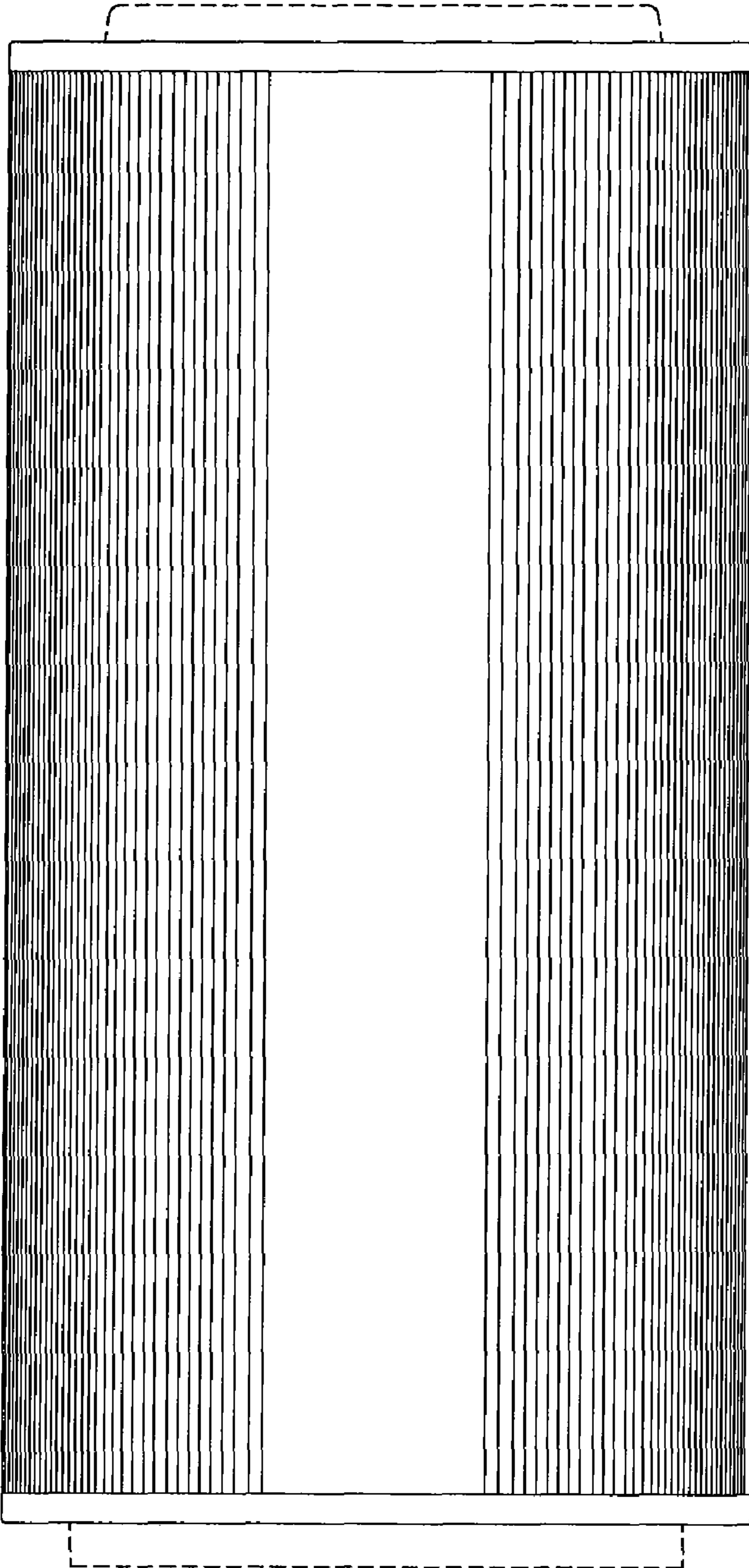

FIG. 3

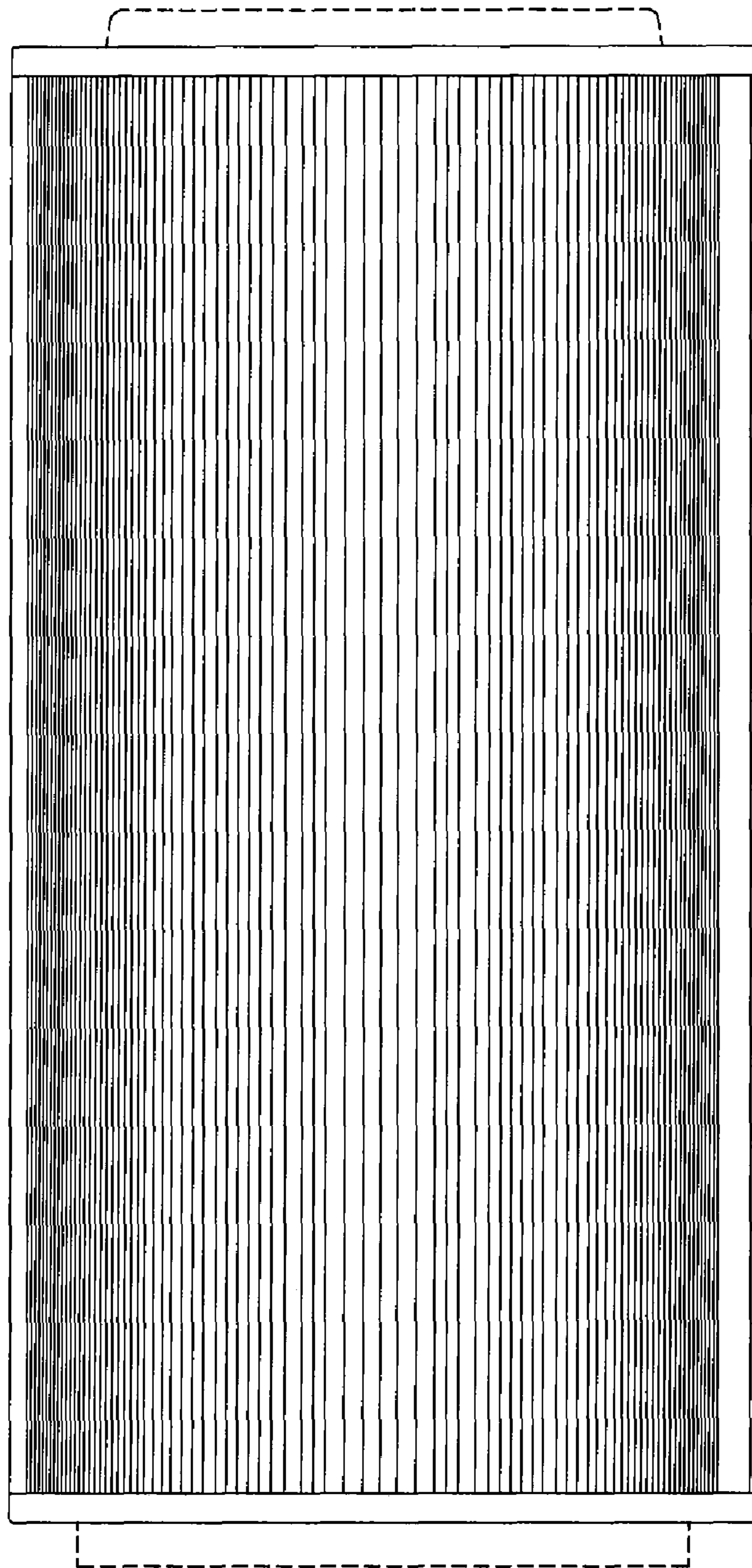

FIG. 4

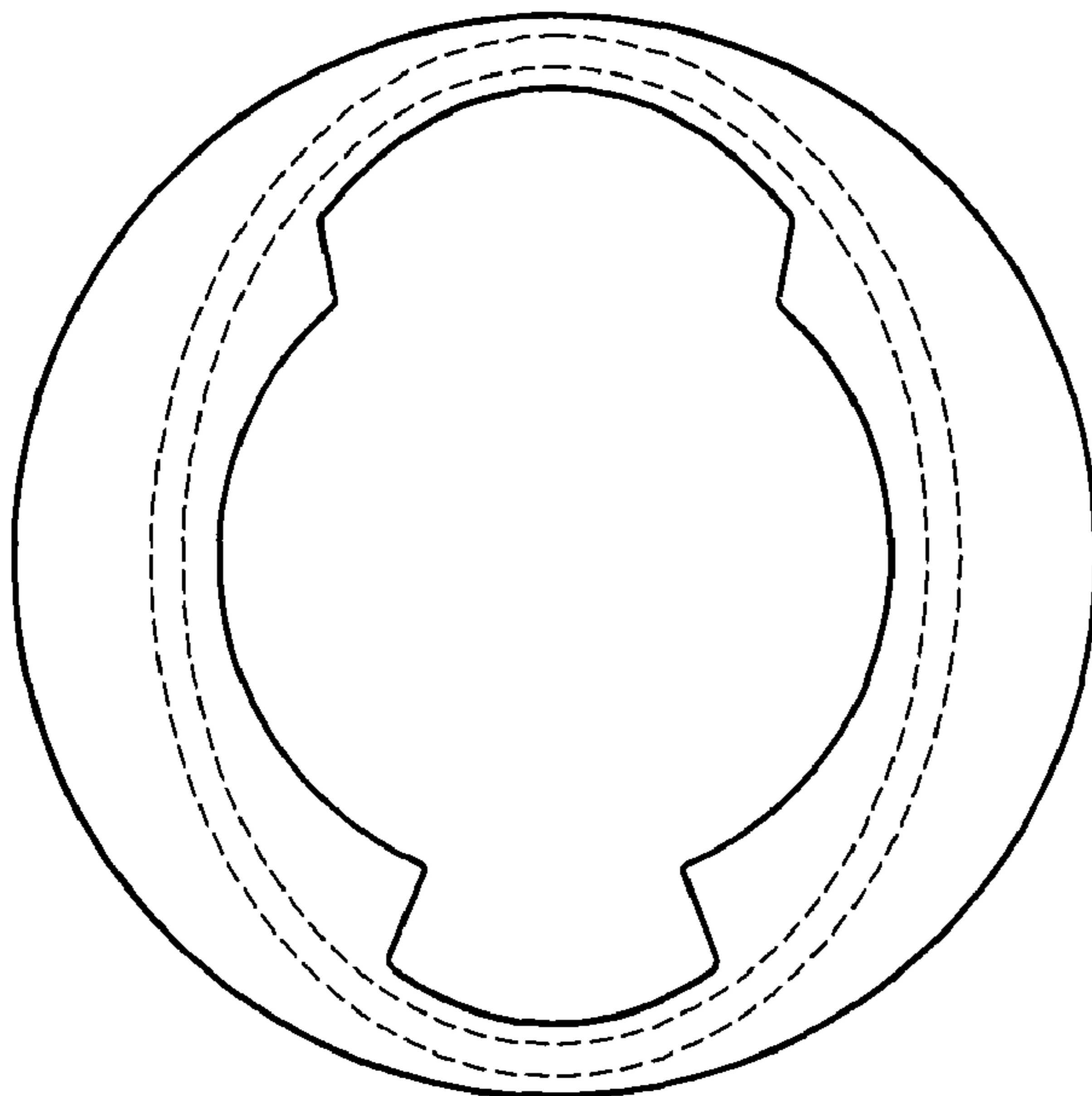

FIG. 5

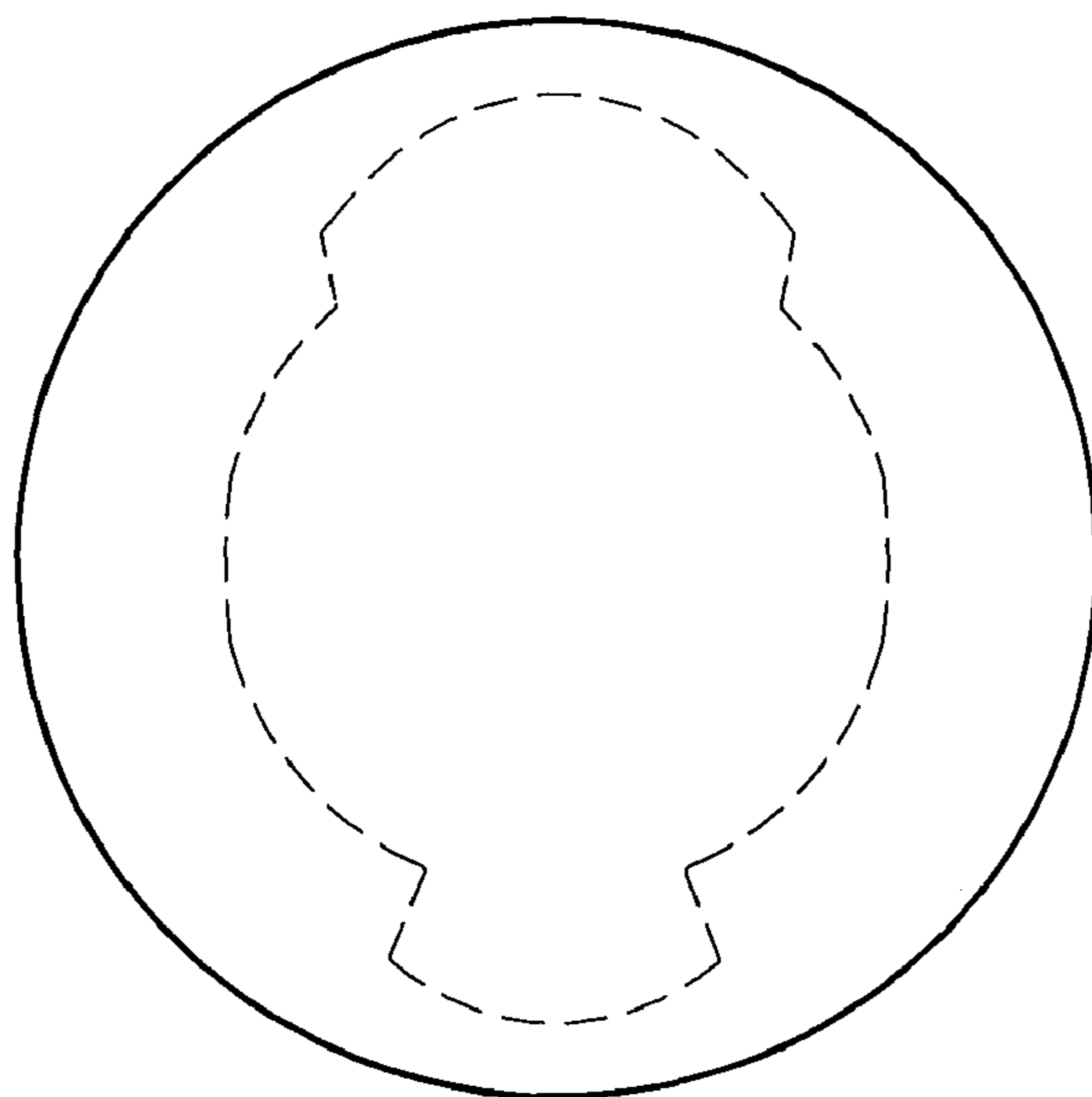

FIG. 6