



US00D625846S

(12) **United States Design Patent**
Scott

(10) **Patent No.:** **US D625,846 S**
(45) **Date of Patent:** **** Oct. 19, 2010**

(54) **LAYOUT FORM FOR EMBEDDING OBJECTS
IN A SETTABLE MATERIAL**

6,186,469 B1 2/2001 Scott

* cited by examiner

(75) Inventor: **Samuel C. Scott**, Denver, CO (US)

Primary Examiner—Doris Clark

(73) Assignee: **Scott System, Inc.**, Denver, CO (US)

(74) *Attorney, Agent, or Firm*—Dorr, Carson & Birney, P.C.

(**) Term: **14 Years**

(57) **CLAIM**

(21) Appl. No.: **29/322,329**

The ornamental design for a layout form for embedding objects in a settable material, as shown and described.

(22) Filed: **Aug. 1, 2008**

DESCRIPTION

(51) **LOC (9) Cl.** **25-01**

FIG. 1 is a perspective view of a layout form for embedding objects in a settable material showing my new design.

(52) **U.S. Cl.** **D25/199**

FIG. 2 is a top plan view thereof.

(58) **Field of Classification Search** 249/13,
249/16, 61; 52/749.11, 384; D25/199

FIG. 3 is a bottom plan view thereof.

See application file for complete search history.

FIG. 4 is a front elevational view thereof.

(56) **References Cited**

U.S. PATENT DOCUMENTS

FIG. 5 is a detail front elevational view of a portion of the layout form for embedding objects in a settable material in FIG. 4.

1,147,704	A *	7/1915	Bruckner	249/15
3,594,968	A	7/1971	Johnson		
3,602,476	A	8/1971	Iragorri		
3,701,228	A	10/1972	Taylor		
3,868,801	A	3/1975	Weiner		
3,908,326	A	9/1975	Francis		
4,076,875	A	2/1978	Van Gaase		
4,131,406	A *	12/1978	Fresquez	425/385
4,644,719	A	2/1987	Salazar		
4,916,875	A	4/1990	Kashiwagi		
5,009,387	A	4/1991	Scott et al.		
5,014,488	A	5/1991	Evangelos et al.		
D354,576	S *	1/1995	Weinig	D25/199
5,667,190	A	9/1997	Scott et al.		
5,900,180	A	5/1999	Scott et al.		
5,922,235	A	7/1999	Scott et al.		
6,138,423	A	10/2000	Poutanen et al.		
6,164,037	A	12/2000	Passeno		

FIG. 6 is a rear elevational view thereof.

FIG. 7 is a detail rear elevational view of a portion of the layout form for embedding objects in a settable material in FIG. 6.

FIG. 8 is a left side elevational view thereof.

FIG. 9 is a detail left side elevational view of a portion of the layout form for embedding objects in a settable material in FIG. 8.

FIG. 10 is a right side elevational view thereof; and,

FIG. 11 is a detail right side elevational view of a portion of the layout form for embedding objects in a settable material in FIG. 10.

1 Claim, 5 Drawing Sheets

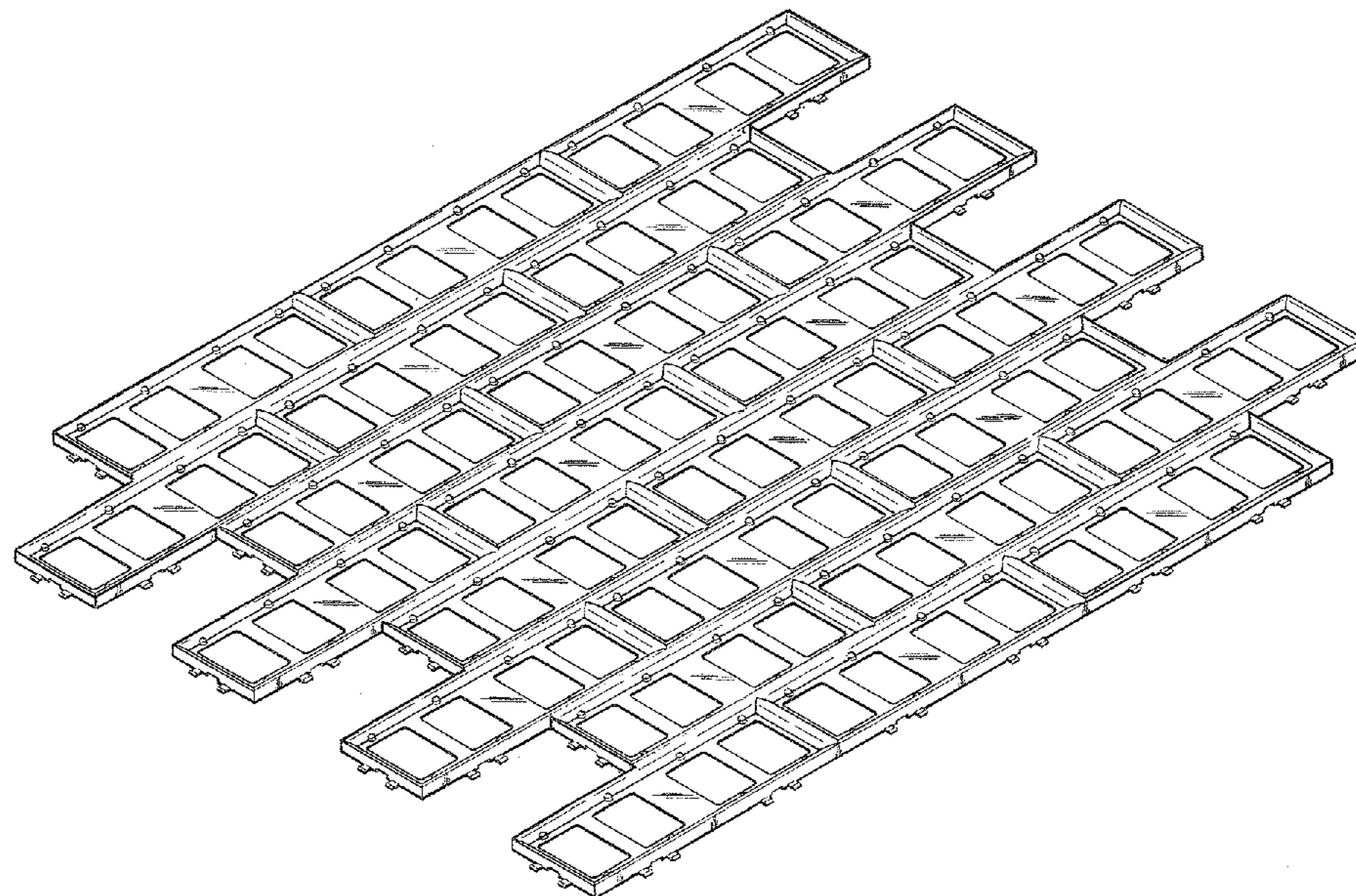

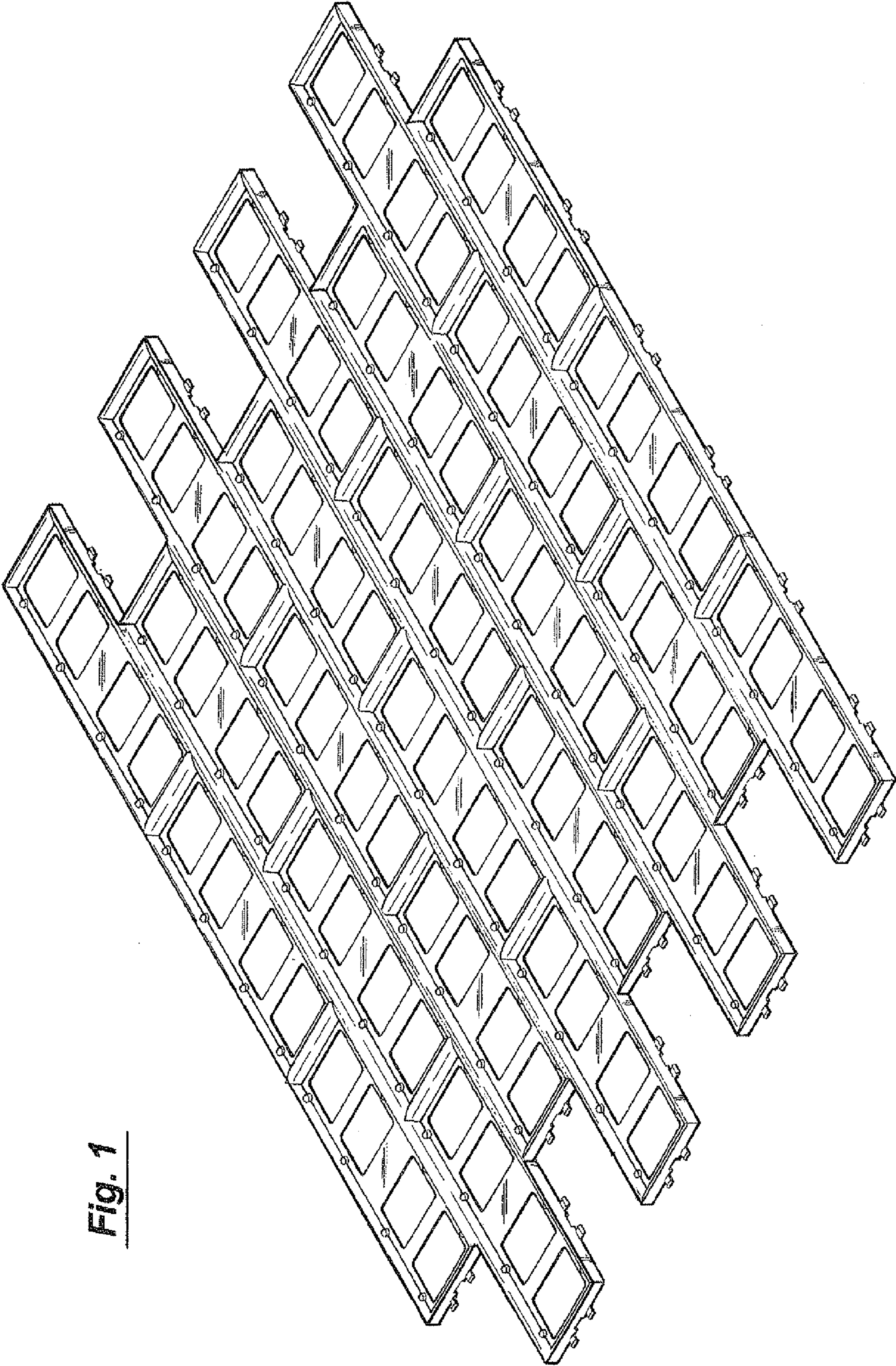

Fig. 1

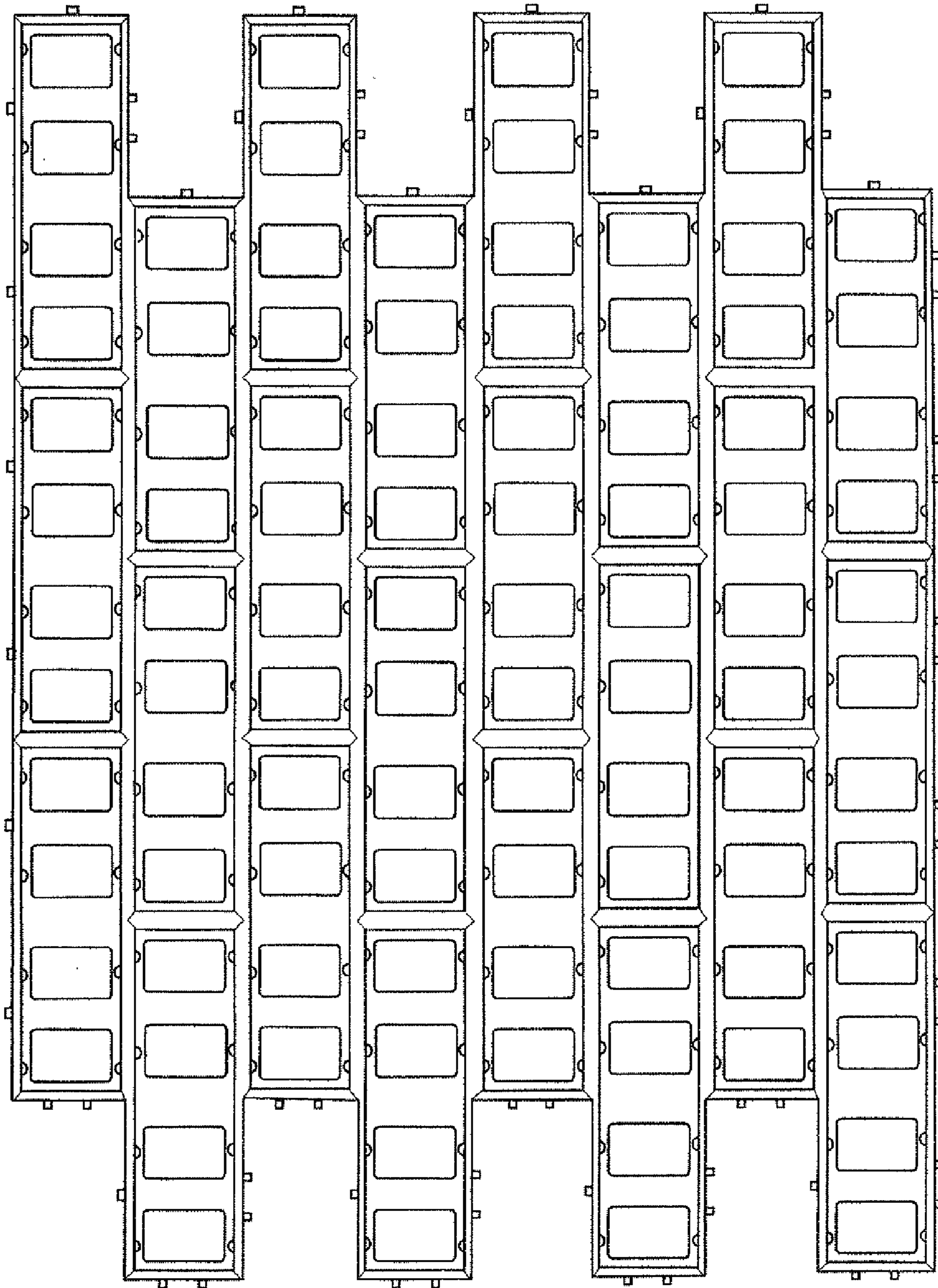

Fig. 2

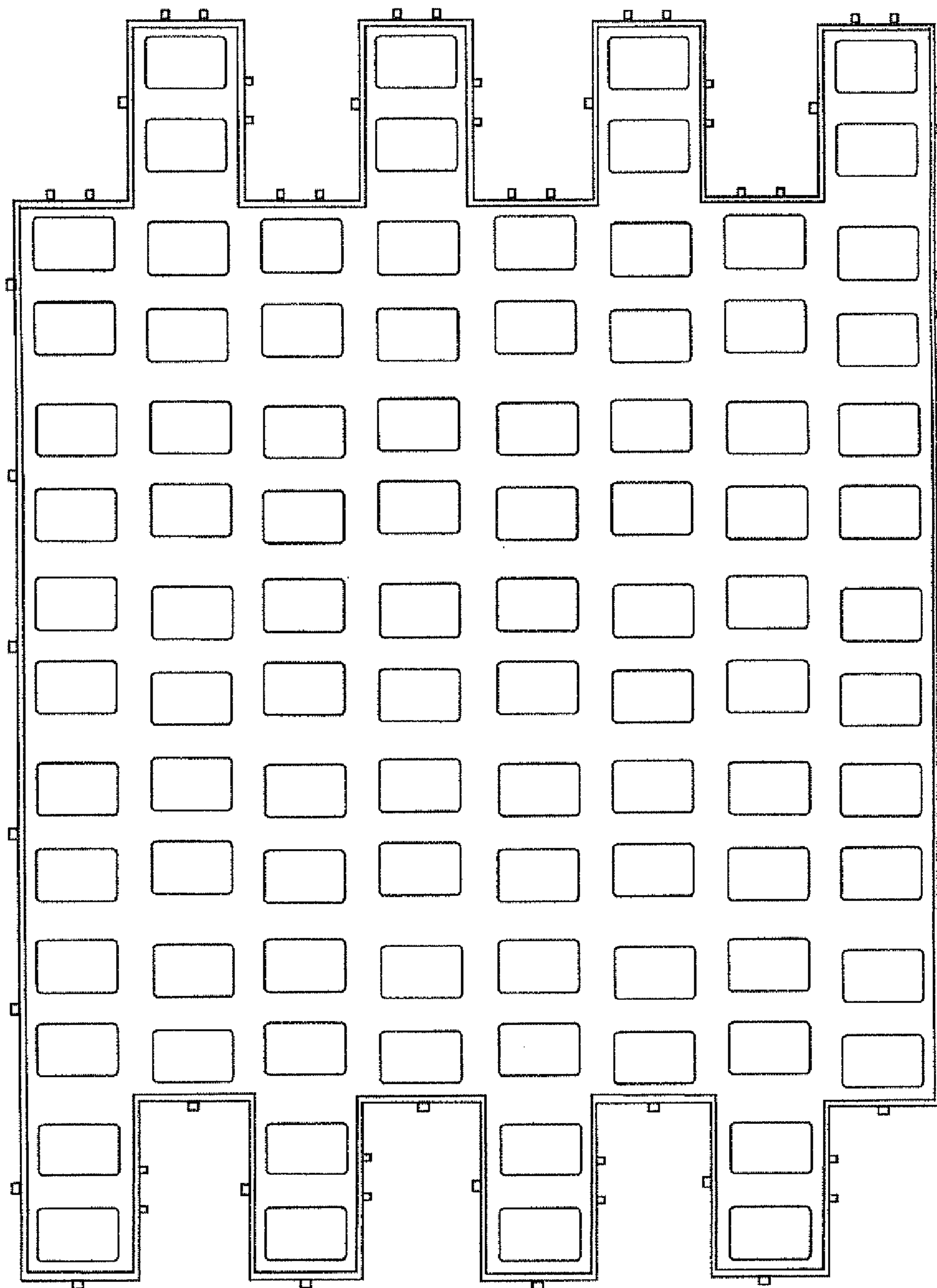

Fig. 3

