



US00D625805S

(12) **United States Design Patent**  
**Hereford**

(10) **Patent No.:** **US D625,805 S**

(45) **Date of Patent:** **\*\* Oct. 19, 2010**

(54) **NEEDLE GUIDE**

(76) **Inventor:** **Robert Hereford**, 218 A E Eau Gallie Blvd #21, Indian Harbour Beach, FL (US) 32937

(\*\*) **Term:** **14 Years**

(21) **Appl. No.:** **29/346,132**

(22) **Filed:** **Oct. 27, 2009**

(51) **LOC (9) Cl.** ..... **24-02**

(52) **U.S. Cl.** ..... **D24/140; D24/108; D24/129; D24/130; D24/133**

(58) **Field of Classification Search** ..... D24/140, D24/114, 127-128, 130, 133, 108, 129; 604/210, 604/232, 263, 403, 407, 411, 414-415, 198; 141/330, 370, 375

See application file for complete search history.

(56) **References Cited**

**U.S. PATENT DOCUMENTS**

3,610,241	A *	10/1971	LeMarie	604/407
3,853,158	A *	12/1974	Whitty	141/330
D248,314	S *	6/1978	Romero et al.	D24/130
D280,018	S *	8/1985	Scott	D24/130
4,636,201	A *	1/1987	Ambrose et al.	604/263
5,167,640	A *	12/1992	Balding	604/263
D397,217	S *	8/1998	Brookfield	D24/130
5,894,870	A *	4/1999	Maxwell	604/411
D447,229	S *	8/2001	Falk	D24/108
D454,194	S *	3/2002	Bar-Or	D24/108
6,497,697	B1 *	12/2002	Cohn	604/414
6,581,648	B1 *	6/2003	Zolentroff et al.	604/414
6,941,983	B2 *	9/2005	Garukyan	141/366
7,041,086	B2 *	5/2006	Yang	604/198
7,201,736	B2 *	4/2007	Hauri	604/263

\* cited by examiner

*Primary Examiner*—Ian Simmons

*Assistant Examiner*—Wan Laymon

(74) *Attorney, Agent, or Firm*—Mark R. Malek, Esq.; Zies Widerman & Malek, P.L.

(57) **CLAIM**

The ornamental design for a needle guide, as shown and described.

**DESCRIPTION**

FIG. 1 is a rear and left side perspective view of a needle guide according to the present invention.

FIG. 2 is a left side elevation view of a needle guide according to the present invention.

FIG. 3 is a rear elevation view of a needle guide according to the present invention.

FIG. 4 is a bottom plan view of a needle guide according to the present invention.

FIG. 5 is a top plan view of a needle guide according to the present invention.

FIG. 6 is a front elevation view of a needle guide according to the present invention.

FIG. 7 is a right side elevation view of a needle guide according to the present invention.

FIG. 8 is another perspective view of a needled guide according to the present invention; and,

FIG. 9 is another perspective view of a needled guide according to the present invention.

The broken lines showing the vial and a syringe of the needle guide in FIGS. 8 and 9 are included for the purpose of illustrating environmental structure and form no part of the claimed design.

**1 Claim, 4 Drawing Sheets**

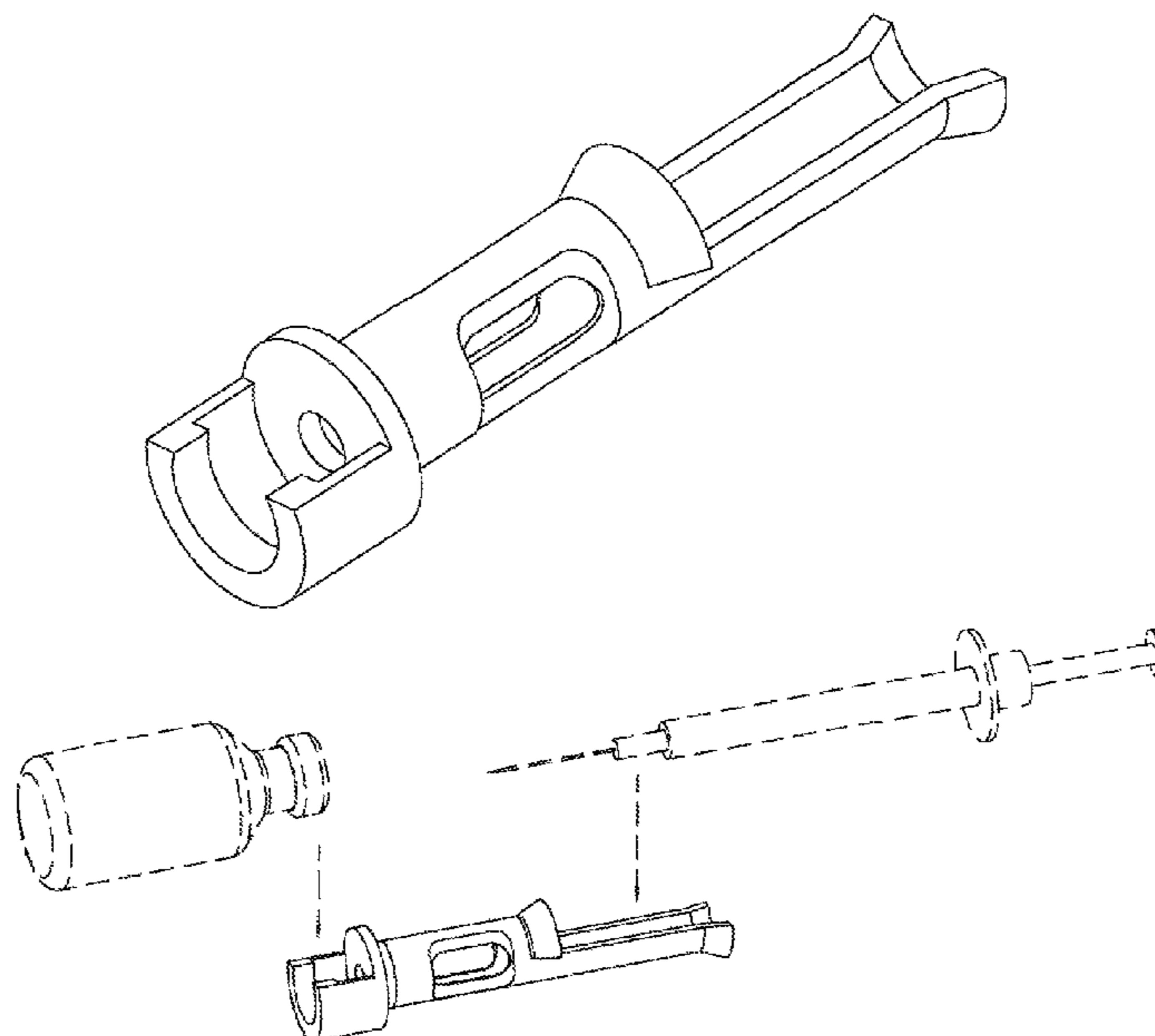

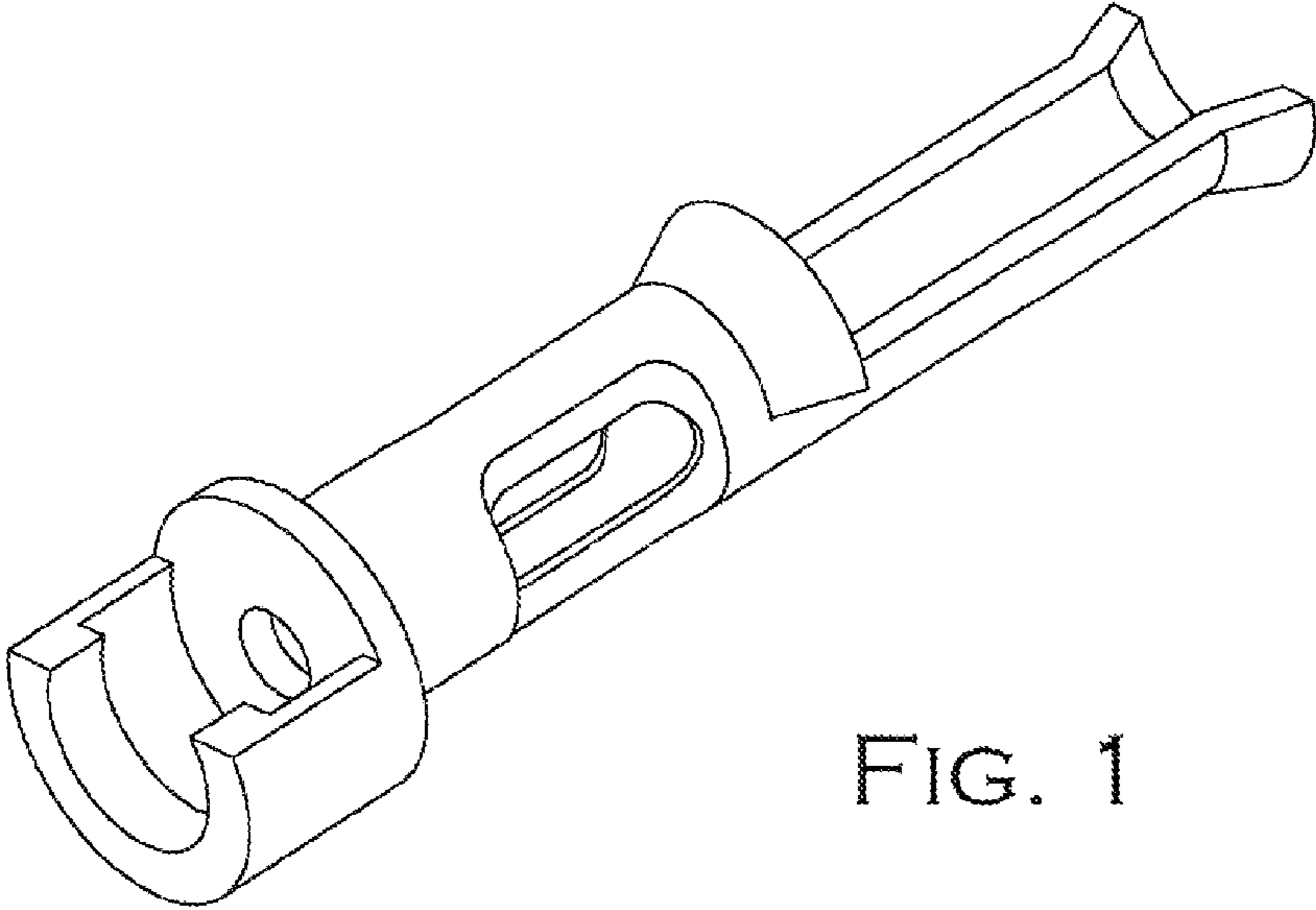

FIG. 1

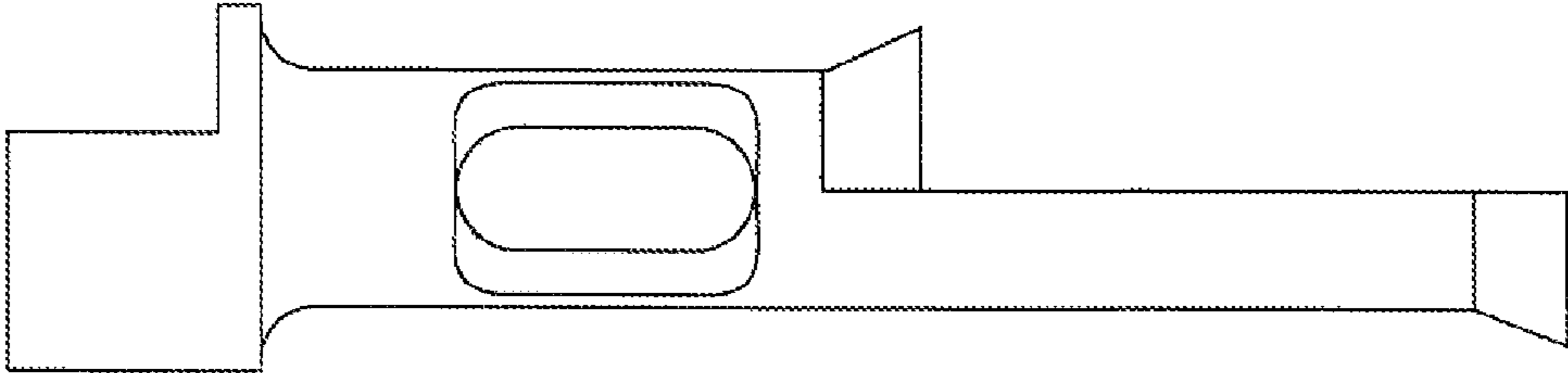

FIG. 2

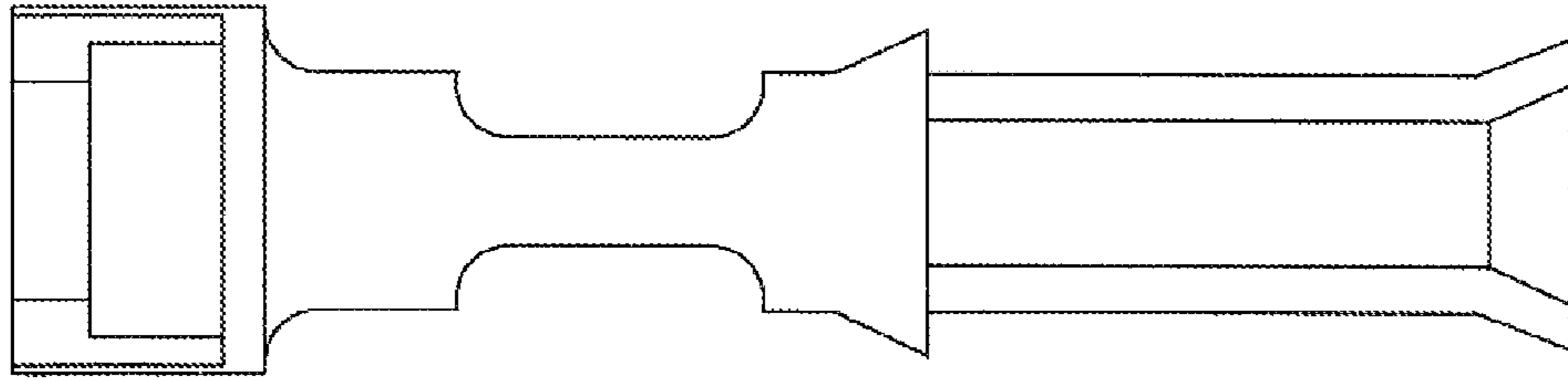

FIG. 3

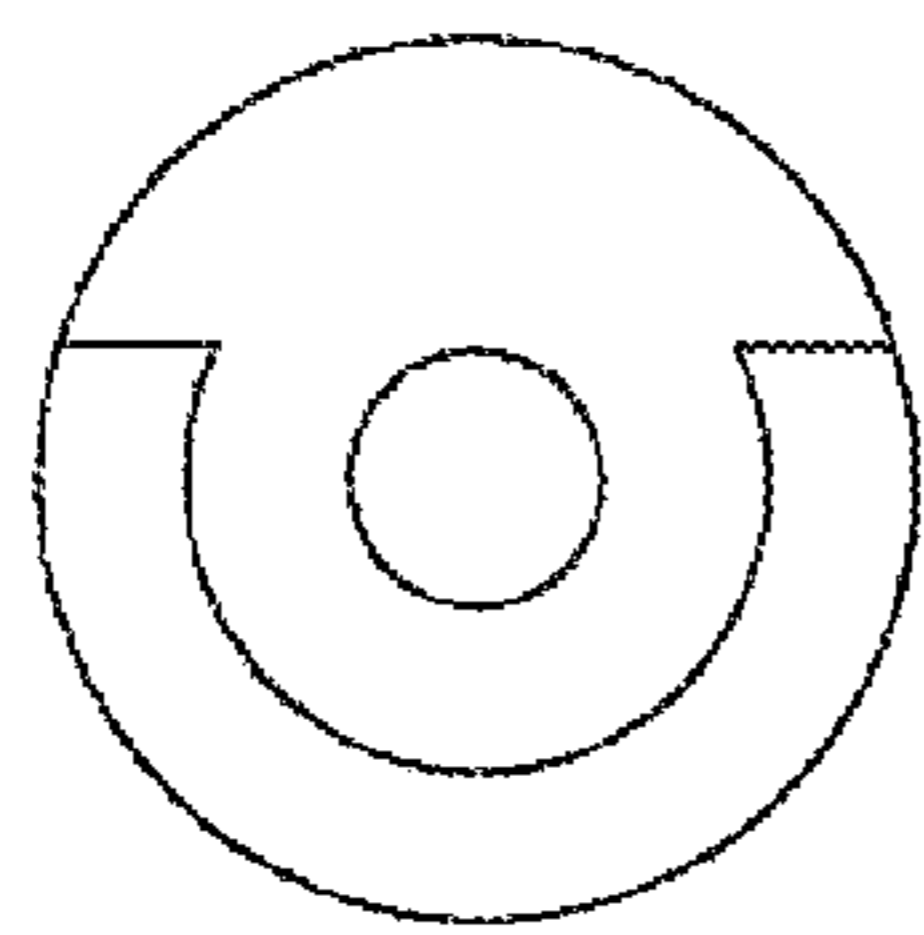

FIG. 4

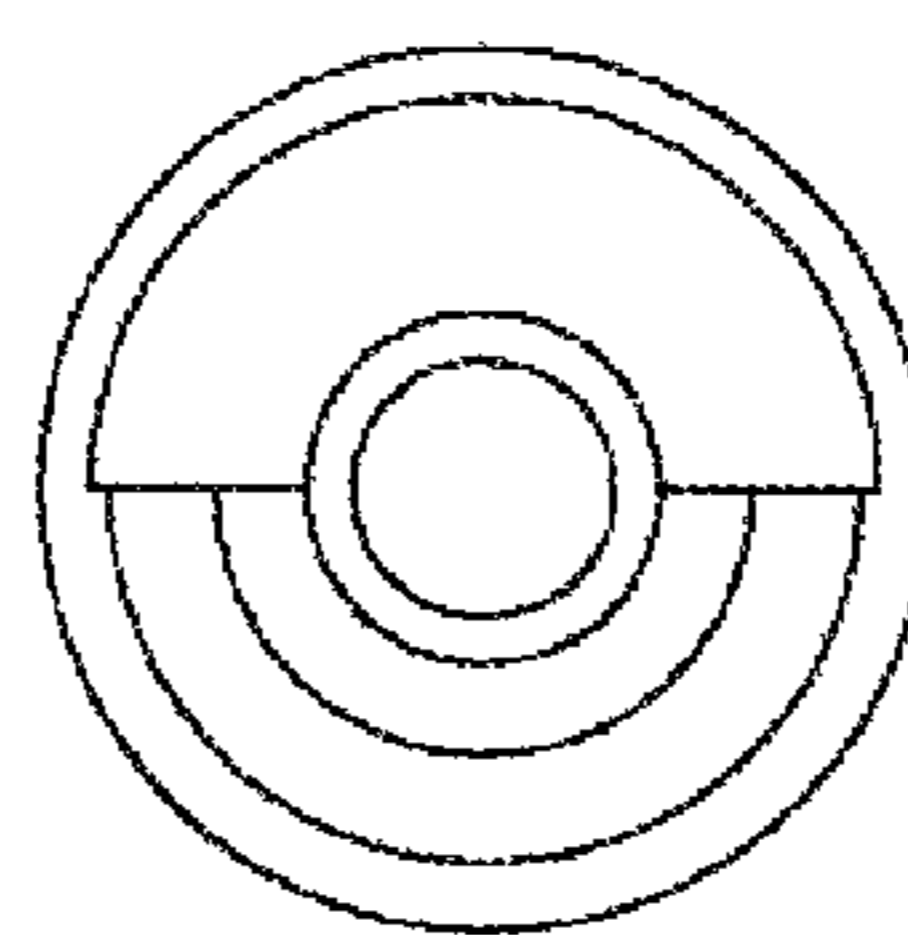

FIG. 5

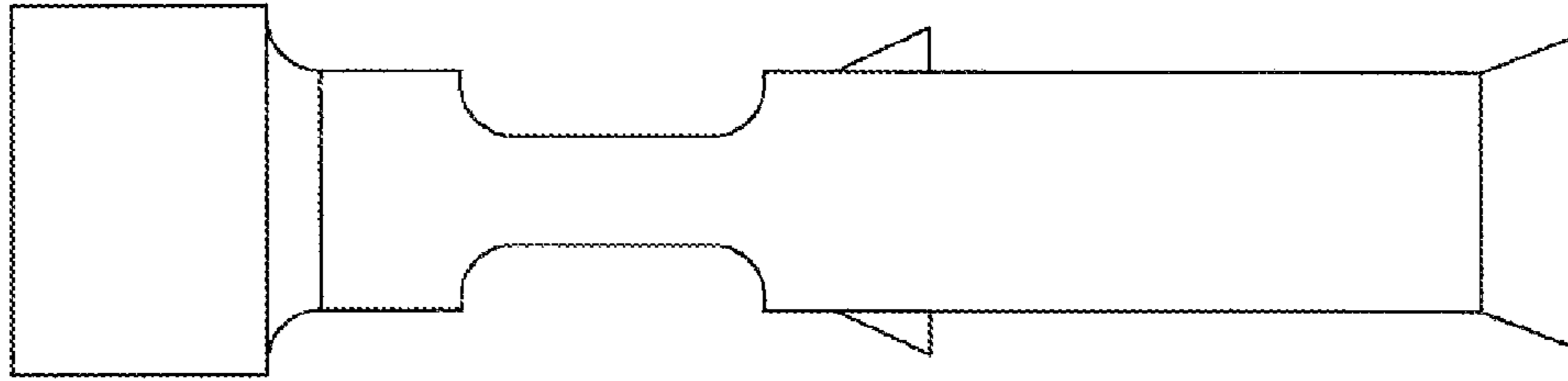

FIG. 6

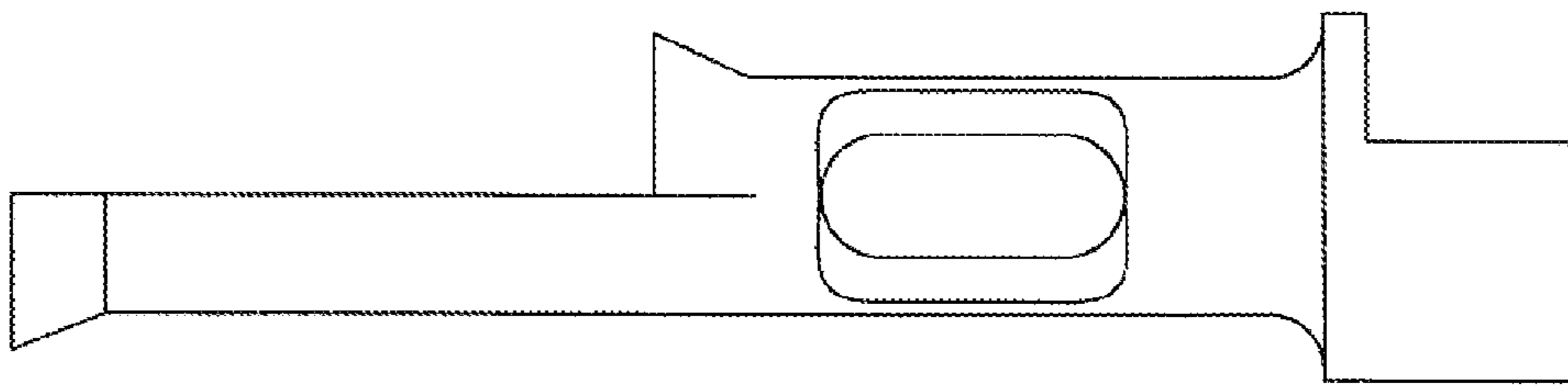

FIG. 7

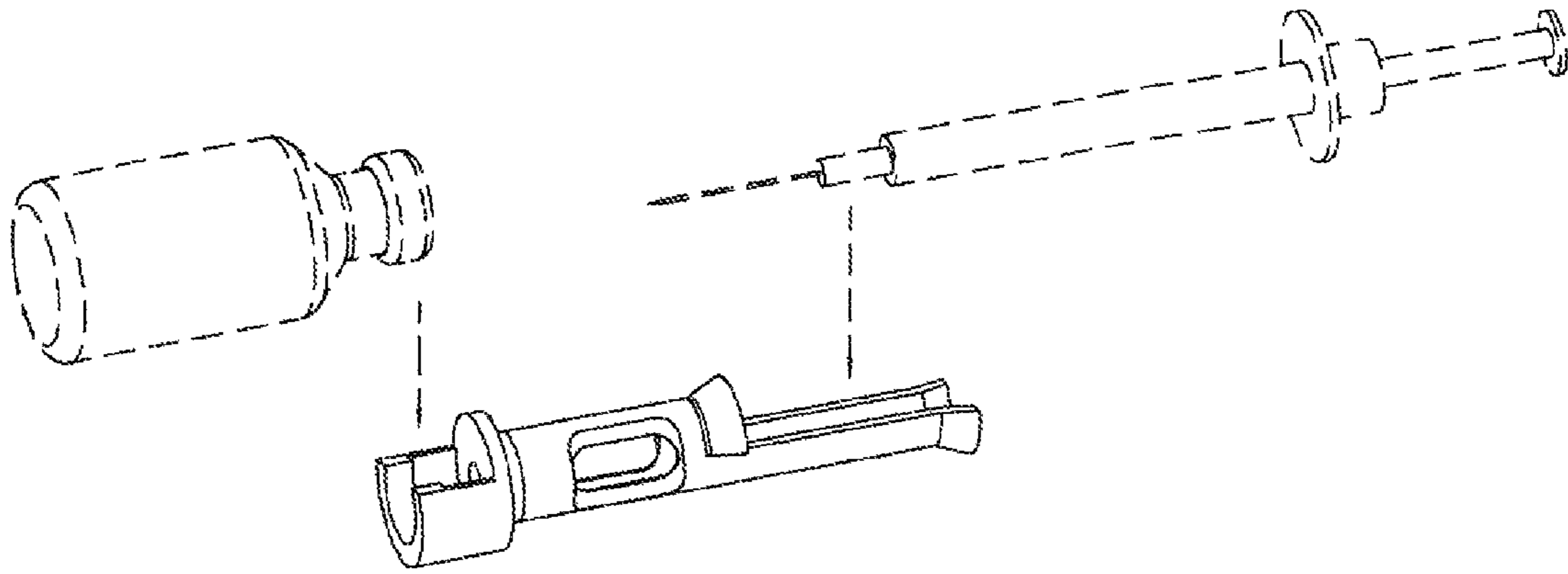

FIG. 8

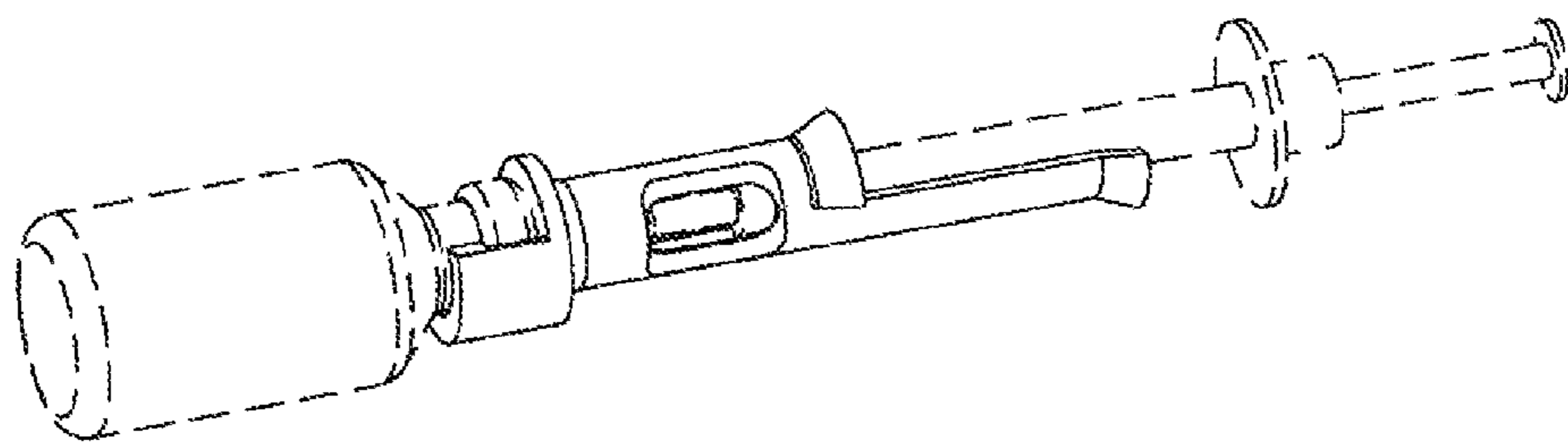

FIG. 9