



US00D625789S

(12) **United States Design Patent**
Malek et al.

(10) **Patent No.:** **US D625,789 S**
(45) **Date of Patent:** **** Oct. 19, 2010**

(54) **SHOWER ENCLOSURE**

(75) Inventors: **Bruce Malek**, Sainte-Anne-de-Bellevue (CA); **Tommy Harbour**, Montreal (CA)

(73) Assignee: **Bombardier Inc.**, Quebec (CA)

(**) Term: **14 Years**

(21) Appl. No.: **29/361,307**

(22) Filed: **May 10, 2010**

Related U.S. Application Data

(62) Division of application No. 29/334,873, filed on Apr. 3, 2009, now Pat. No. Des. 618,317.

(30) **Foreign Application Priority Data**

Oct. 3, 2008 (EM) 001014088

(51) **LOC (9) Cl.** **23-02**

(52) **U.S. Cl.** **D23/283**

(58) **Field of Classification Search** D23/275-277, D23/280.1-280.2, 283, 304-306; 4/548, 4/552, 555, 576.1, 577.1, 578.1, 596, 614, 4/663, 538; D3/273, 303; D24/202-203
See application file for complete search history.

(56) **References Cited**

U.S. PATENT DOCUMENTS

D122,018 S * 8/1940 Greth D23/275

D255,598 S * 6/1980 Chapman D23/275
D352,548 S * 11/1994 Pinsky et al. D23/283
D427,294 S * 6/2000 Haug et al. D23/304
6,681,417 B2 * 1/2004 Brunelle et al. 4/614
D528,641 S * 9/2006 DeBoer et al. D23/283
D534,278 S * 12/2006 Lu D24/202
D567,956 S * 4/2008 Gay D24/202

* cited by examiner

Primary Examiner—Robert A Delehanty

(74) *Attorney, Agent, or Firm*—Thomas, Karceski, Raring & Teague, PC

(57) **CLAIM**

The ornamental design for a shower enclosure, as shown and described.

DESCRIPTION

FIG. 1 is a perspective view of a shower enclosure of our design;

FIG. 2 is a right side view of the shower enclosure of FIG. 1; and,

FIG. 3 is a front view of the shower enclosure of FIG. 1.

The broken lines showing structural supports and peripheral components in FIGS. 1-3 are for illustrative purposes only and form no part of the claimed design. For the embodiment, the left side view, the rear view, the top view, and the bottom view are plain and unornamented and for no part of the claimed design.

1 Claim, 3 Drawing Sheets

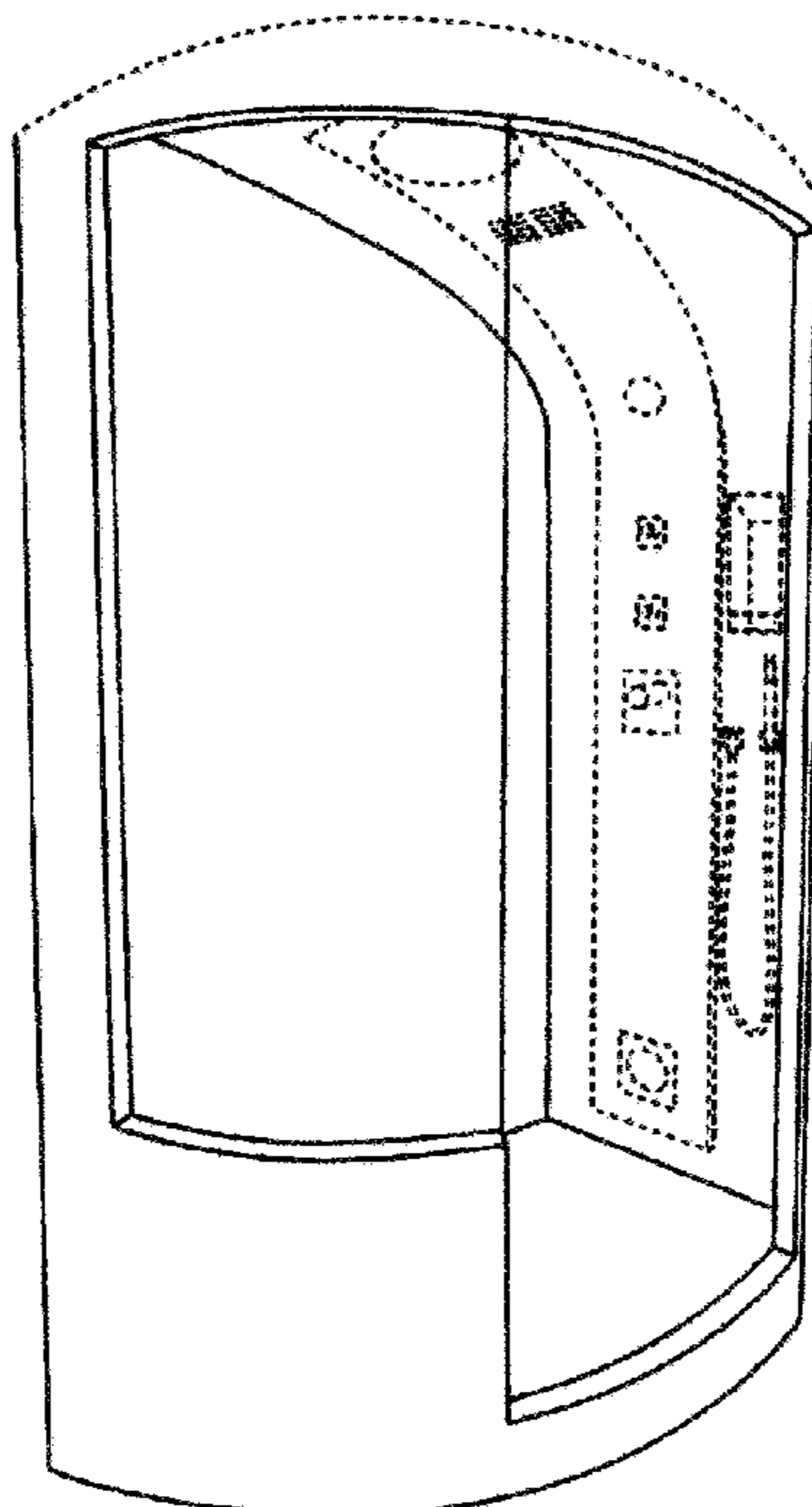

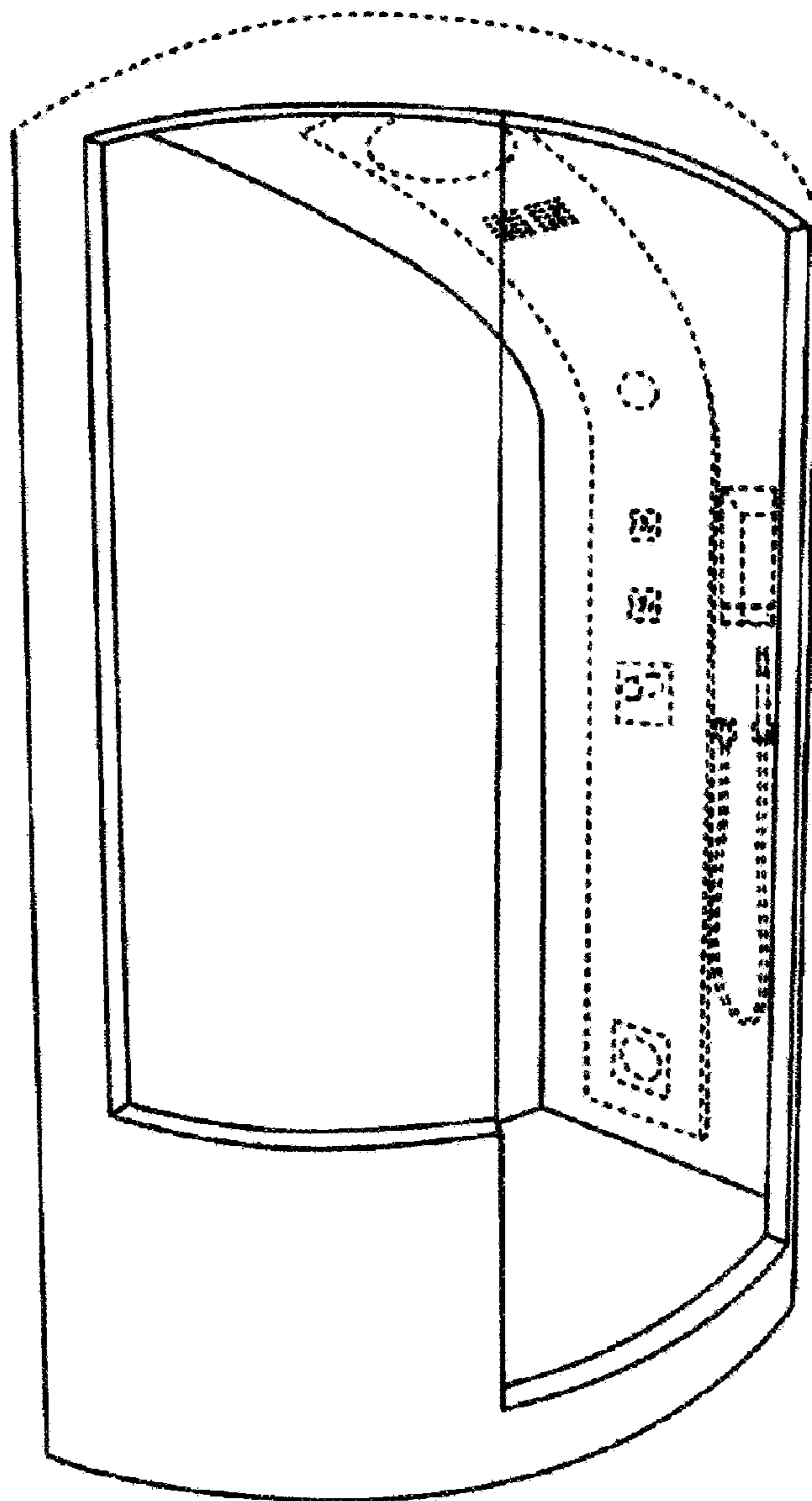

Fig. 1

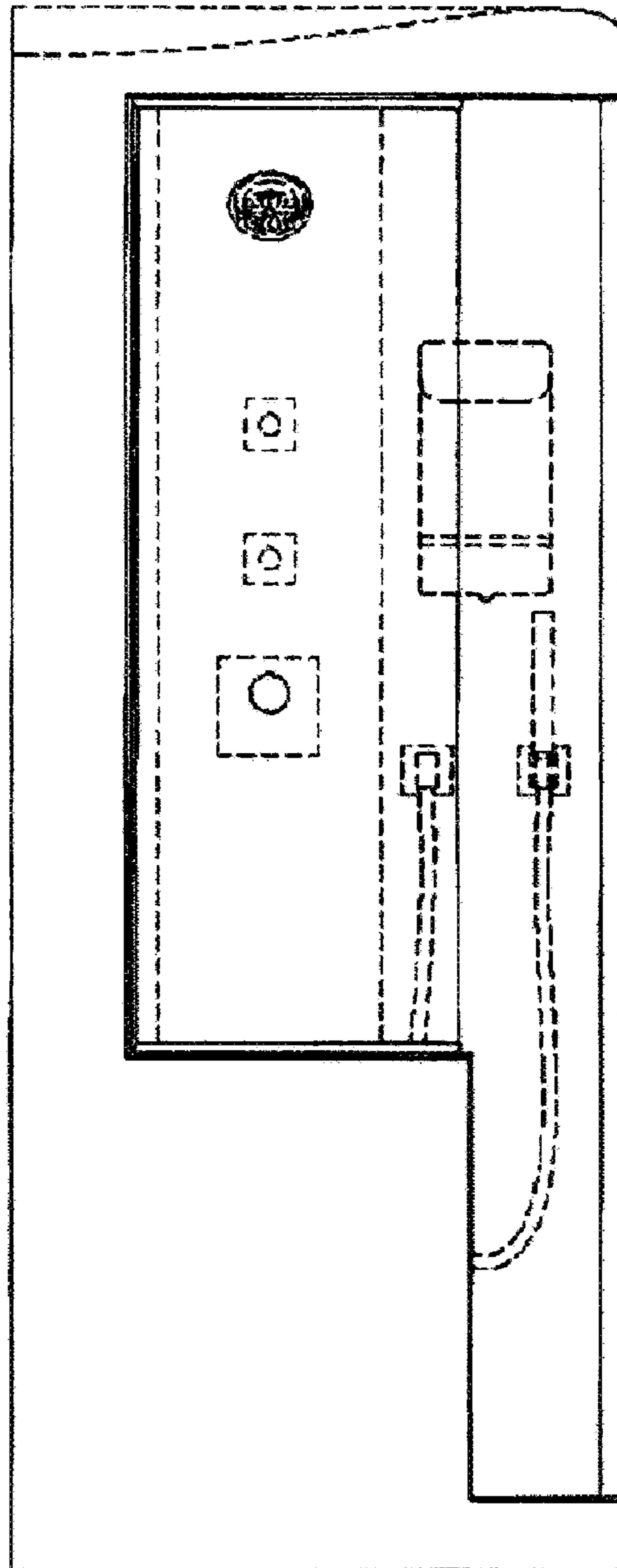

Fig. 2

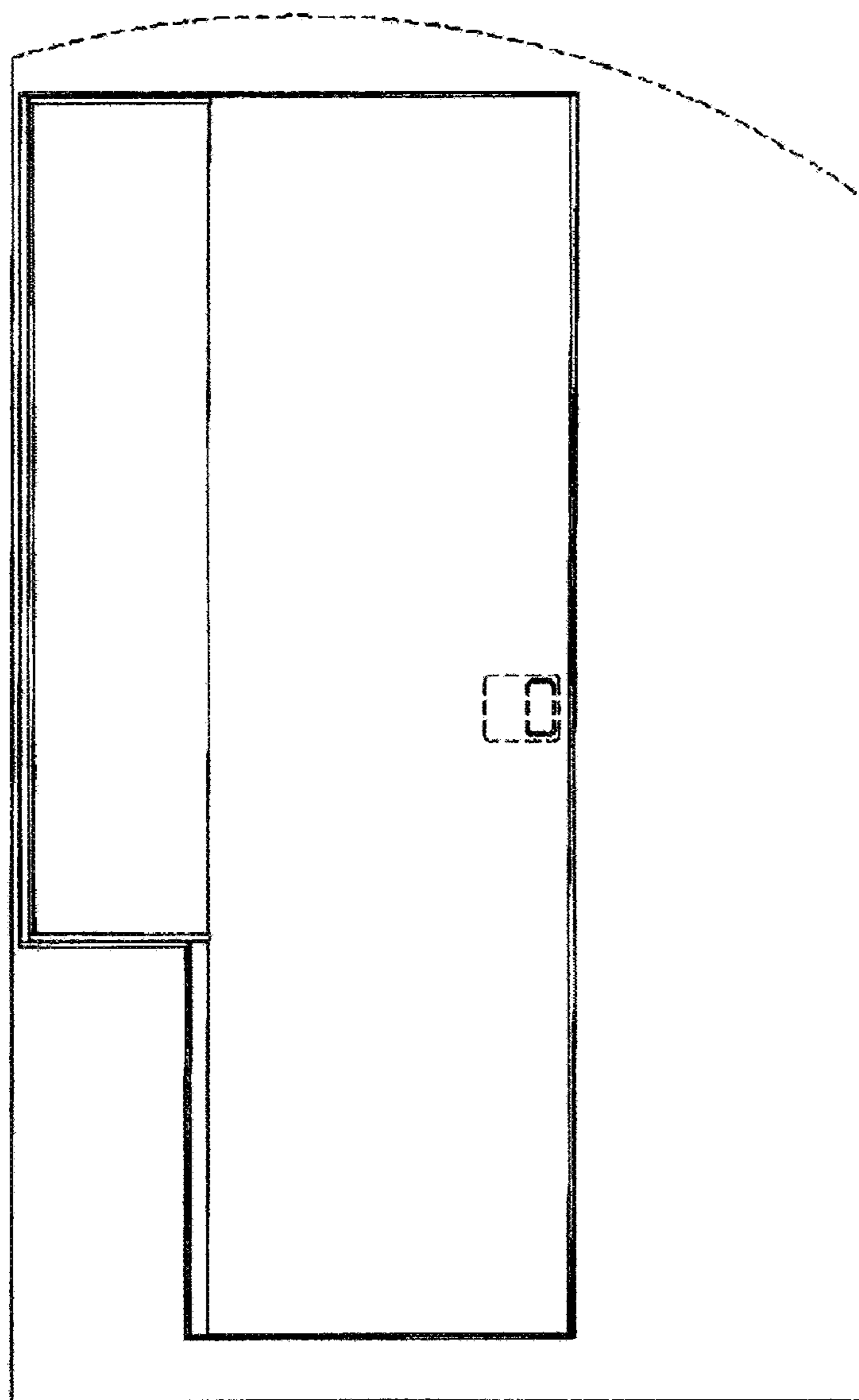

Fig. 3