



US00D625175S

(12) **United States Design Patent**  
**Balcell Comas**

(10) **Patent No.:** **US D625,175 S**

(45) **Date of Patent:** **\*\* Oct. 12, 2010**

(54) **CLAMP**

(75) Inventor: **Eduardo Balcell Comas**, Sabadell (ES)

(73) Assignee: **Mikalor, S.A.**, Sabadell, Barcelona (ES)

(\*\*) Term: **14 Years**

(21) Appl. No.: **29/302,818**

(22) Filed: **Jan. 25, 2008**

(30) **Foreign Application Priority Data**

Jul. 31, 2007 (EM) ..... 000766530

(51) **LOC (9) Cl.** ..... **08-08**

(52) **U.S. Cl.** ..... **D8/396**

(58) **Field of Classification Search** ..... D8/396;

D23/265; 24/274 R, 279; 285/252, 253

See application file for complete search history.

(56) **References Cited**

**U.S. PATENT DOCUMENTS**

3,006,663 A \* 10/1961 Bowne ..... 285/233

4,365,393 A \* 12/1982 Hauffe et al. .... 24/279

5,010,626 A \* 4/1991 Dominguez ..... 24/279

5,137,305 A \* 8/1992 Straub ..... 285/112

6,490,765 B2 \* 12/2002 Anthes et al. .... 24/279

D546,666 S \* 7/2007 Mohlin et al. .... D8/396

7,441,311 B2 \* 10/2008 Lovgren et al. .... 24/279

2008/0184536 A1 \* 8/2008 Rigollet et al. .... 24/279

\* cited by examiner

*Primary Examiner*—Cathron C Brooks

*Assistant Examiner*—John Windmuller

(74) *Attorney, Agent, or Firm*—Shoemaker and Mattare

(57) **CLAIM**

The ornamental design for a clamp, as shown and described.

**DESCRIPTION**

FIG. 1 is a front elevational view of a clamp, showing my new design;

FIG. 2 is a right side elevational view thereof;

FIG. 3 is a left side elevational view thereof;

FIG. 4 is a top plan view thereof; and,

FIG. 5 is a perspective view thereof, showing the clamp from the top and front.

**1 Claim, 5 Drawing Sheets**

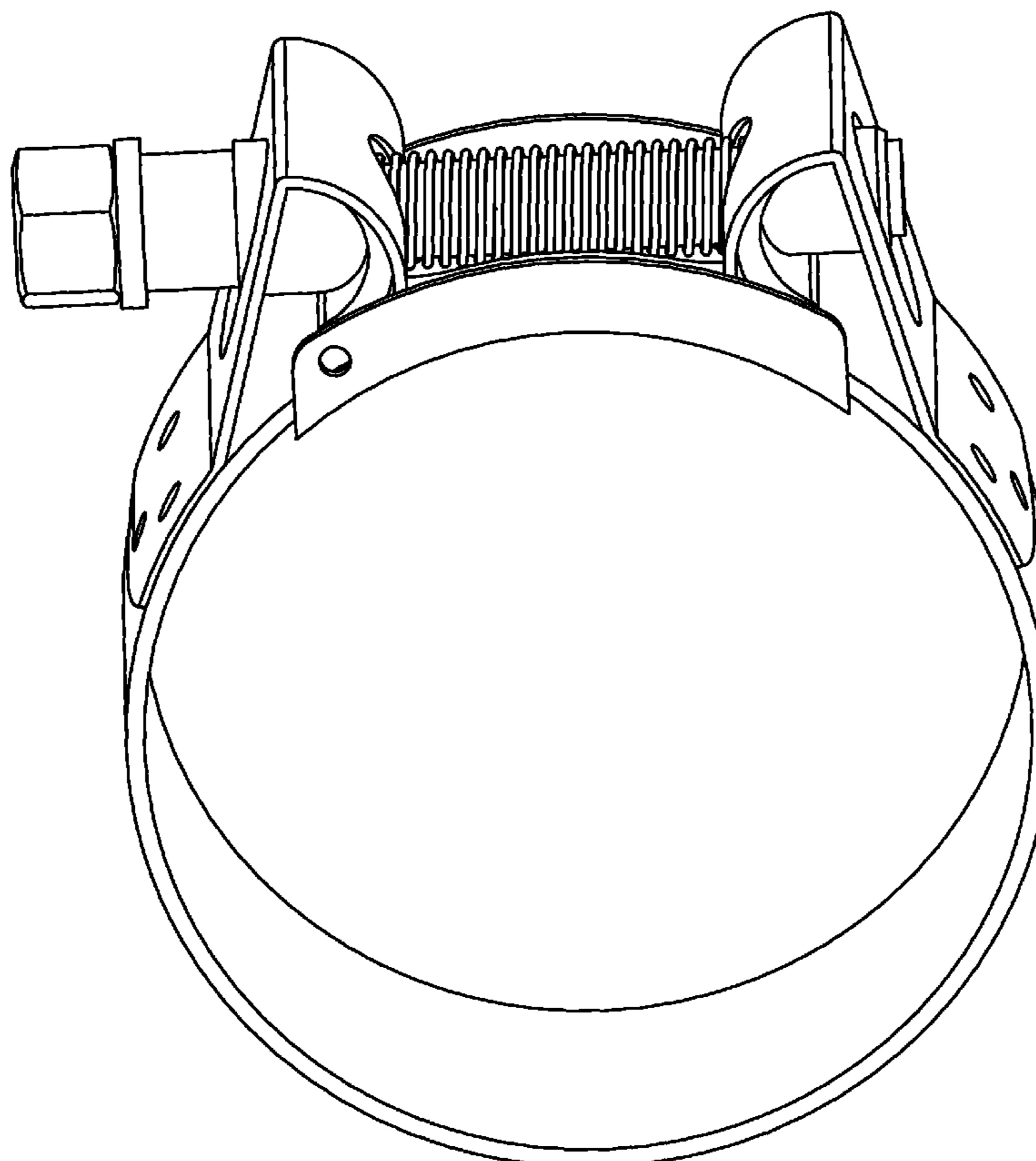

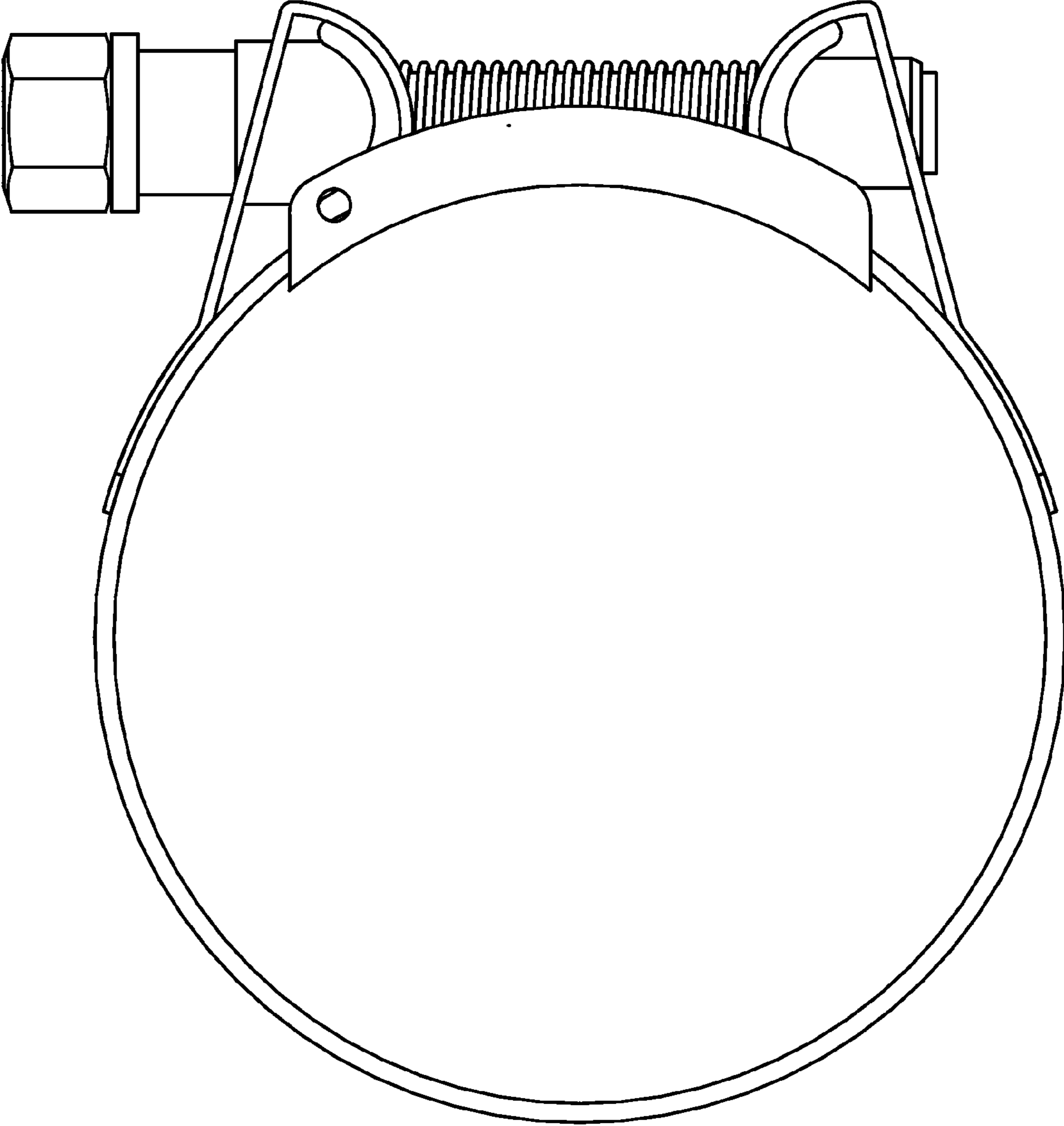

Fig. 1

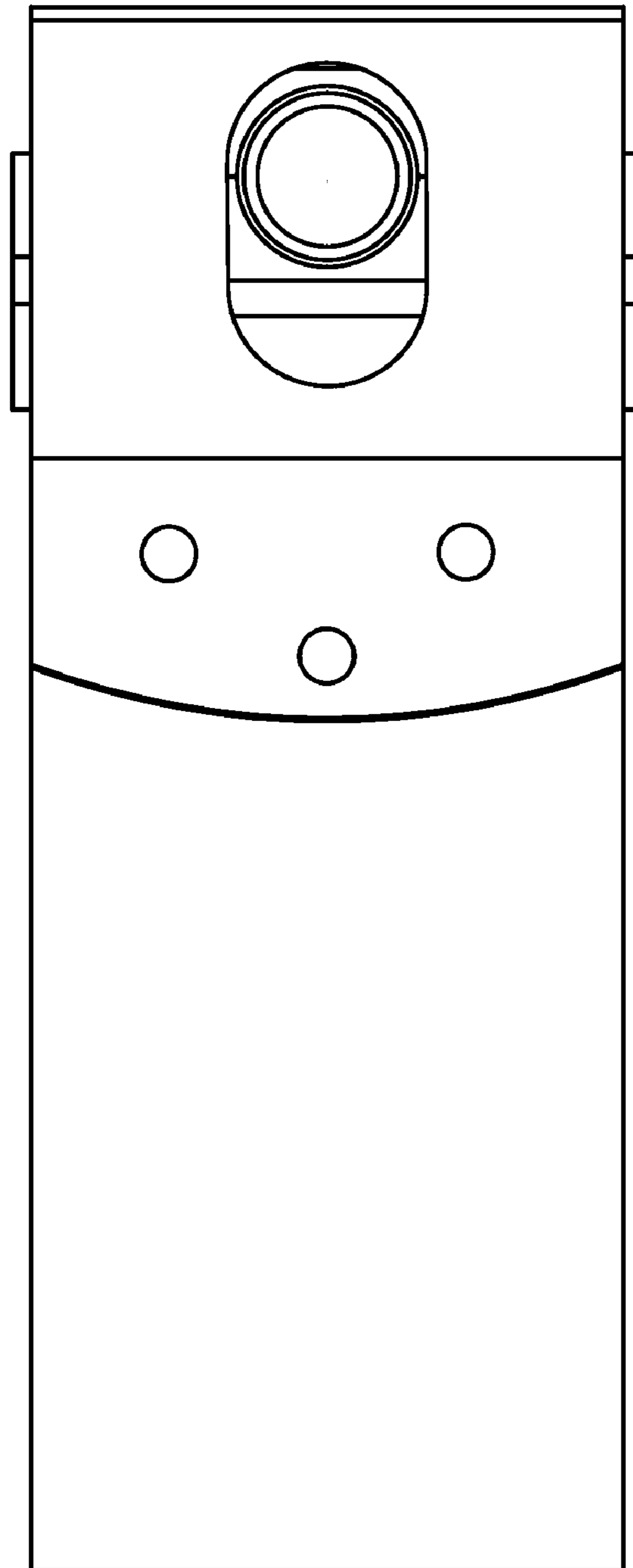

Fig. 2

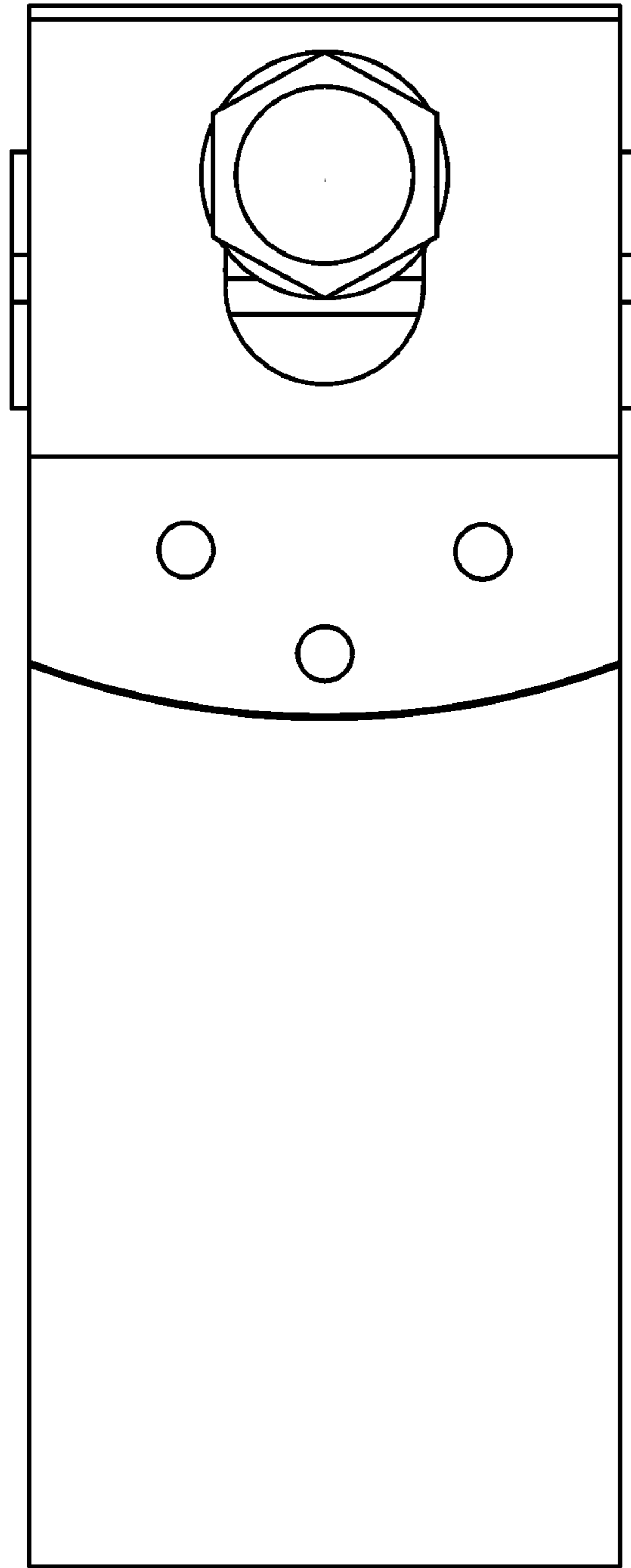

Fig. 3

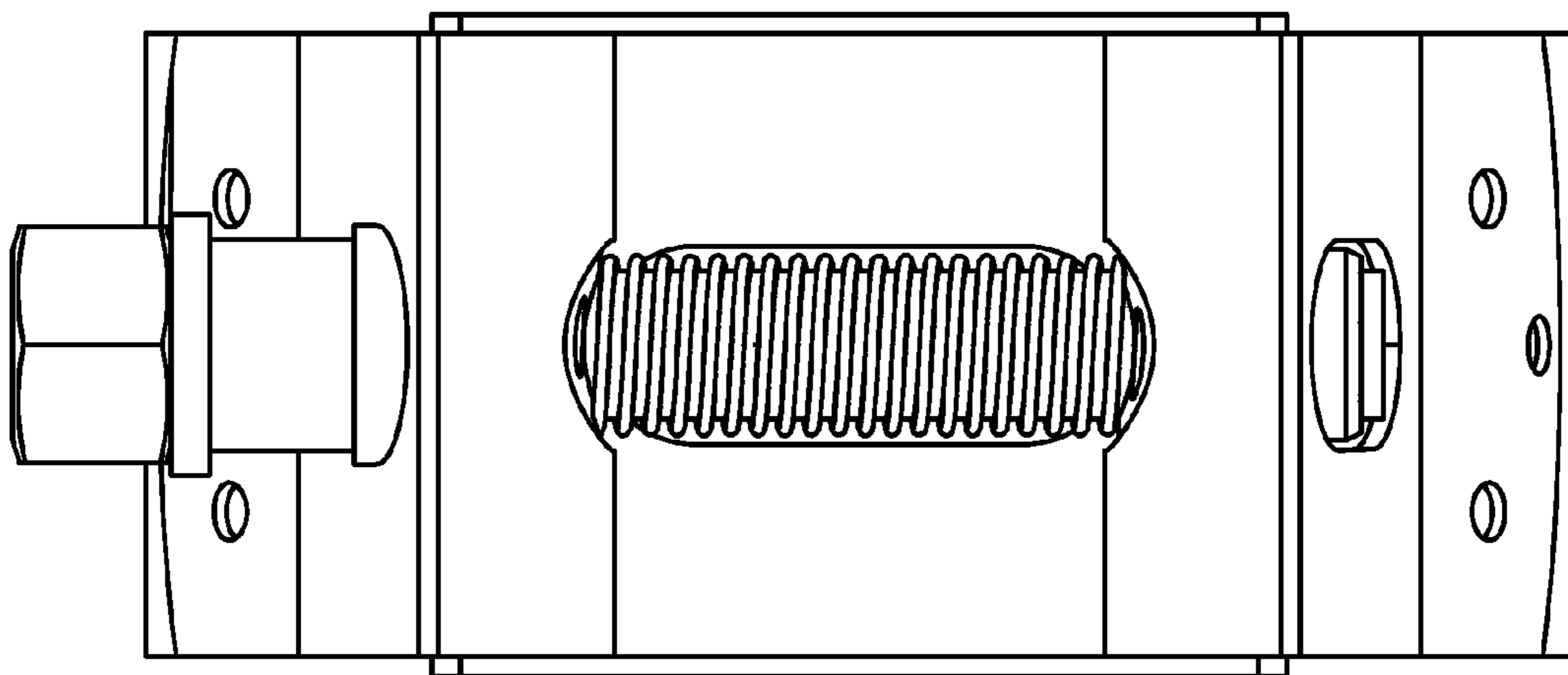

Fig. 4

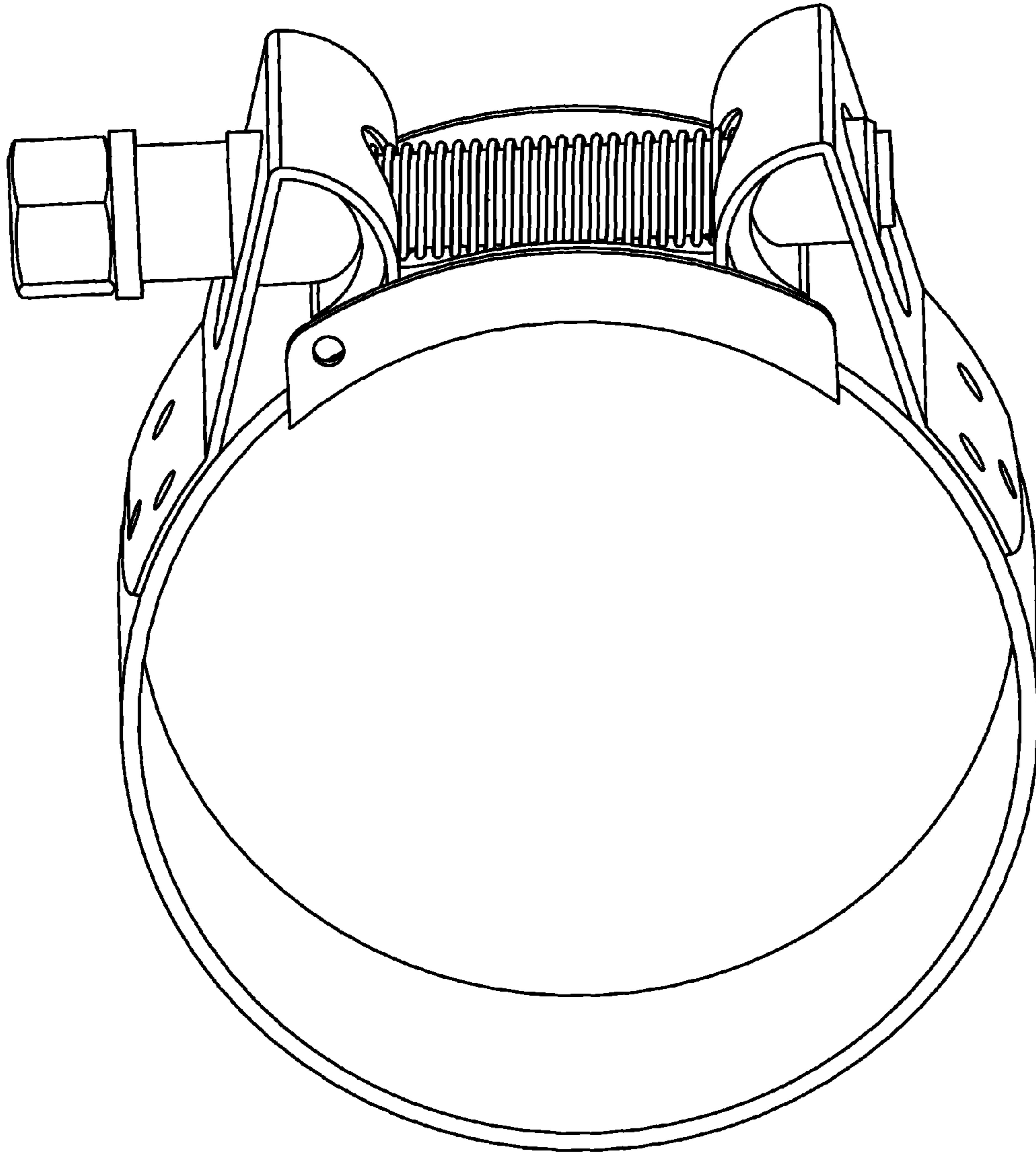

Fig. 5