



US00D624502S

(12) **United States Design Patent**
Ayers et al.

(10) **Patent No.:** **US D624,502 S**

(45) **Date of Patent:** **** Sep. 28, 2010**

(54) **CONNECTOR FOR USE WITH VEHICLE
FUNCTIONALITY TESTING DEVICE**

(75) Inventors: **Brian Ayers**, Marysville, OH (US); **John
Cheek**, Mechanicsburg, OH (US)

(73) Assignee: **Honda Motor Co., Ltd.**, Tokyo (JP)

(**) Term: **14 Years**

(21) Appl. No.: **29/326,674**

(22) Filed: **Oct. 22, 2008**

(51) **LOC (9) Cl.** **13-03**

(52) **U.S. Cl.** **D13/147**

(58) **Field of Classification Search** D13/147,
D13/154, 184; 439/34–36, 135, 278, 476.1,
439/483, 833, 607–610, 892, 894, 948
See application file for complete search history.

(56) **References Cited**

U.S. PATENT DOCUMENTS

D356,543 S *	3/1995	Hoffman	D13/133
5,442,170 A	8/1995	Kreft et al.		
D402,628 S *	12/1998	Canuto et al.	D13/133
D472,877 S *	4/2003	Jaag	D13/133
D500,291 S *	12/2004	Byrne	D13/147
7,225,065 B1	5/2007	Hunt et al.		
D549,173 S *	8/2007	Muller et al.	D13/133
D609,190 S *	2/2010	Liu	D13/154

FOREIGN PATENT DOCUMENTS

WO 98/16840 A1 4/1998

OTHER PUBLICATIONS

Jackmark Engineering Ltd., photograph of Connector Series 5, Oct. 22, 2008, 1 page, <http://www.jackmark.com/images/html/prod15.html>.

Photographs of existing connector, May 7, 2008, 2 pages.

* cited by examiner

Primary Examiner—Daniel D Bui

(74) *Attorney, Agent, or Firm*—Standley Law Group LLP

(57) **CLAIM**

The ornamental design for a connector for use with vehicle functionality testing device, as shown and described.

DESCRIPTION

FIG. 1 is a right side perspective view of a connector for use with vehicle functionality testing device showing our new design;

FIG. 2 is a top plan view thereof;

FIG. 3 is a front elevation view thereof;

FIG. 4 is a right side elevation view thereof;

FIG. 5 is a back elevation view thereof;

FIG. 6 is a left side elevation view thereof;

FIG. 7 is a bottom plan view thereof;

FIG. 8 is a right side perspective view thereof, wherein a removable cover is installed on the connector; and,

FIG. 9 is a back elevation view thereof, wherein a removable cover is installed on the connector.

The broken line portion of the figure drawings is included to show unclaimed subject matter only and forms no part of the claimed design.

1 Claim, 4 Drawing Sheets

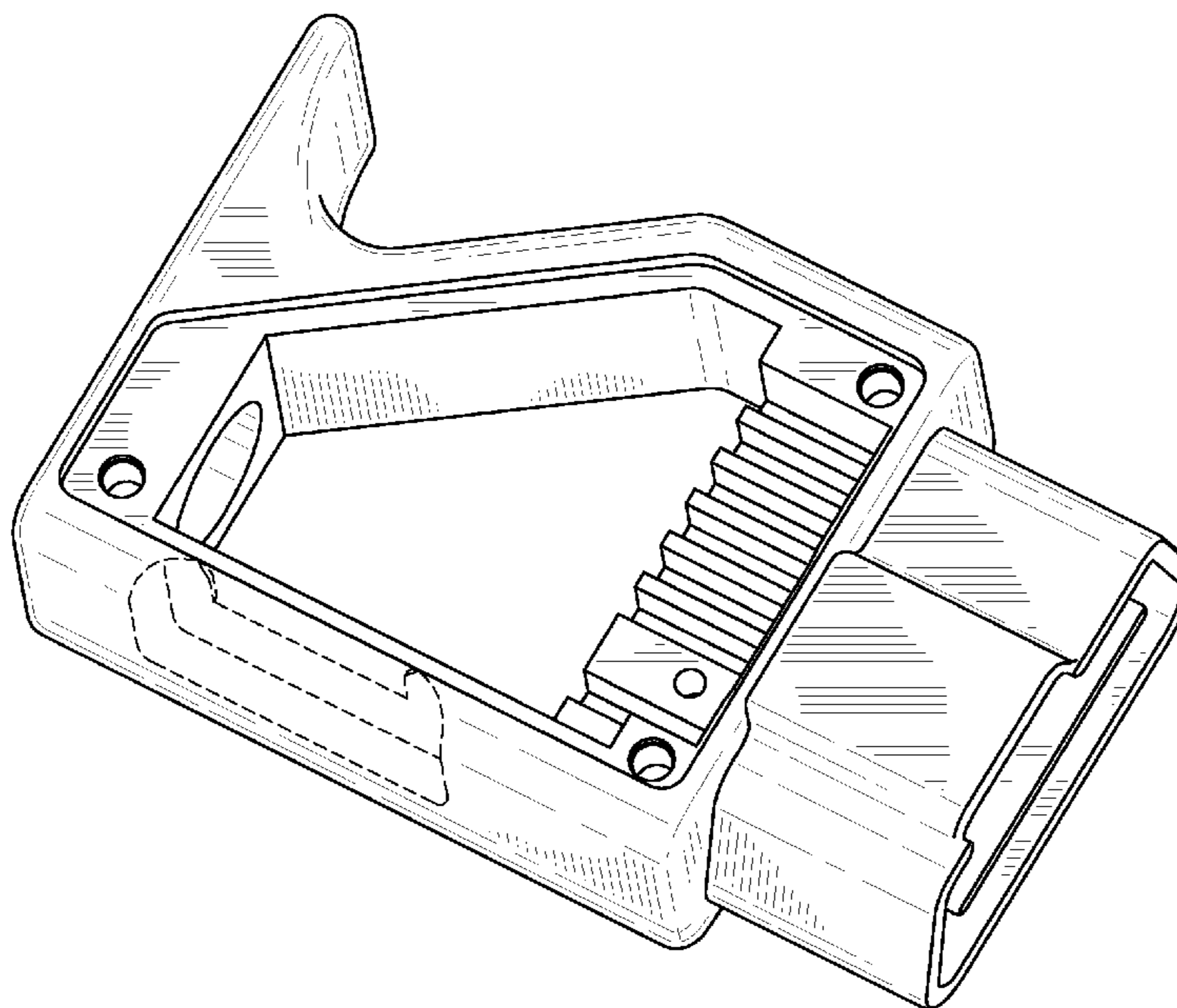

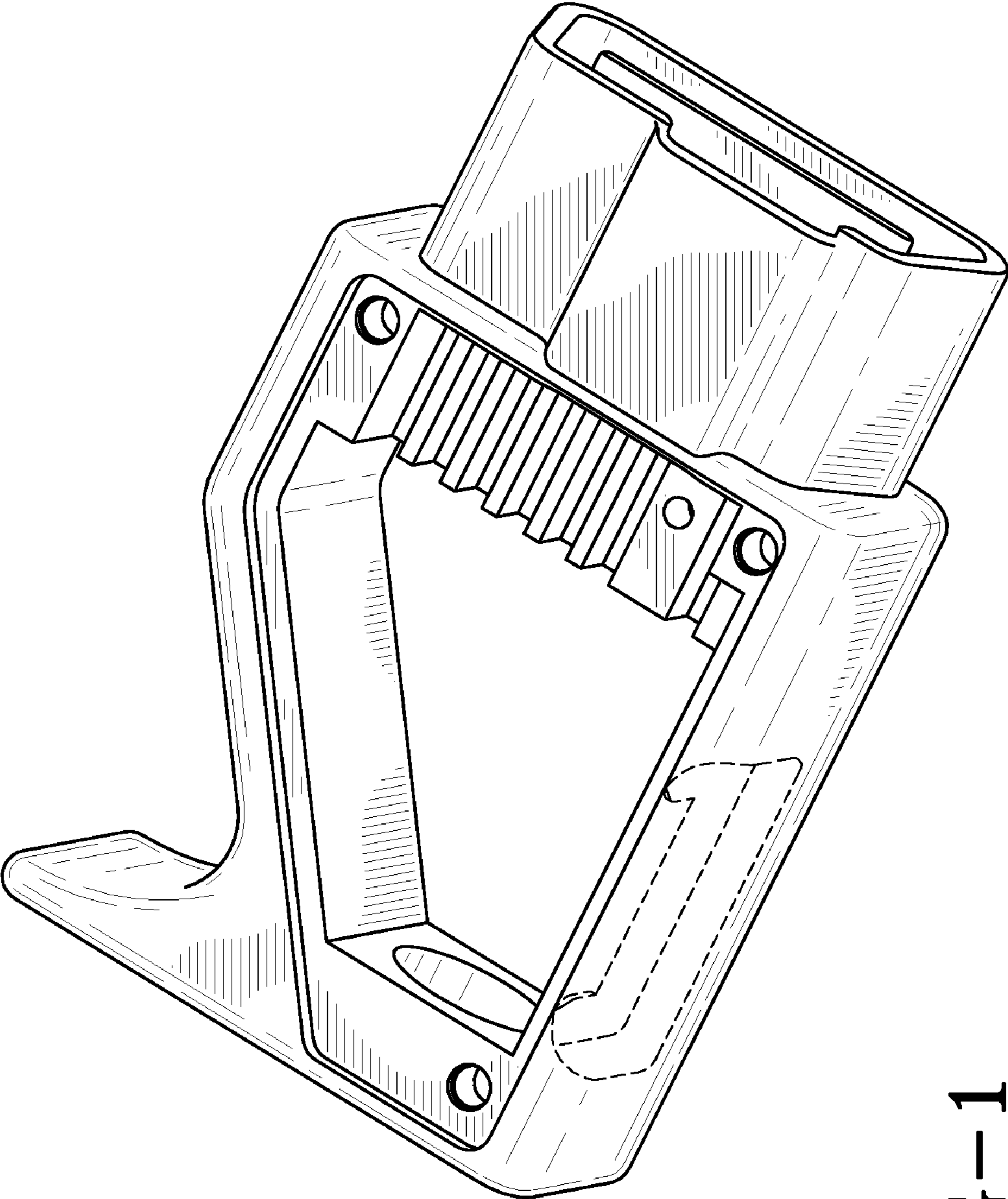

FIG--1

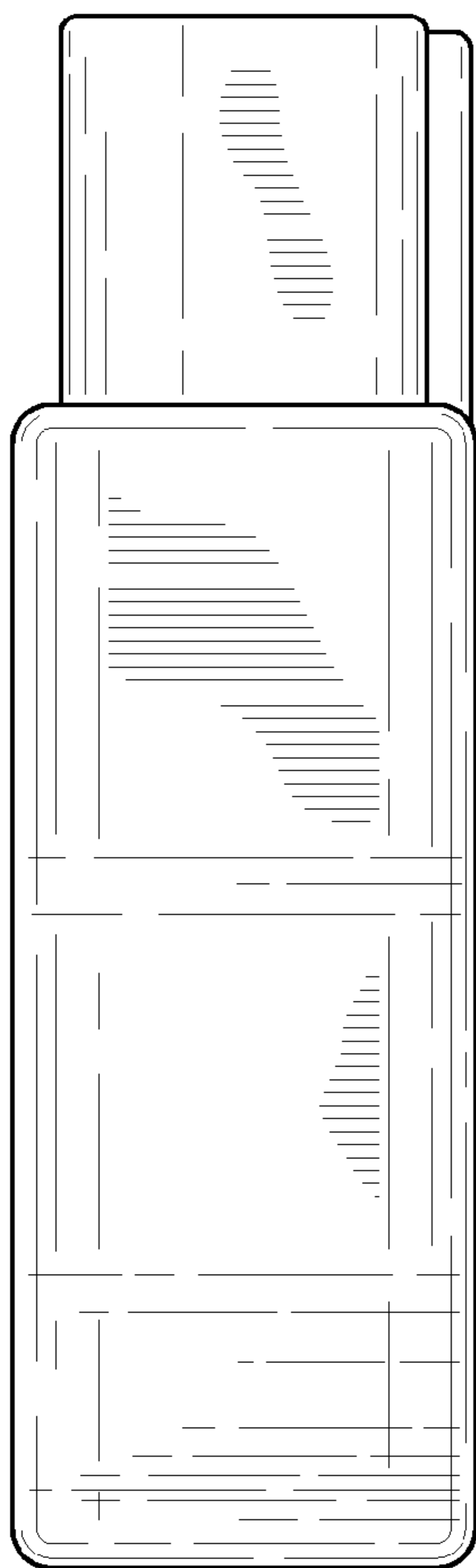

FIG-2

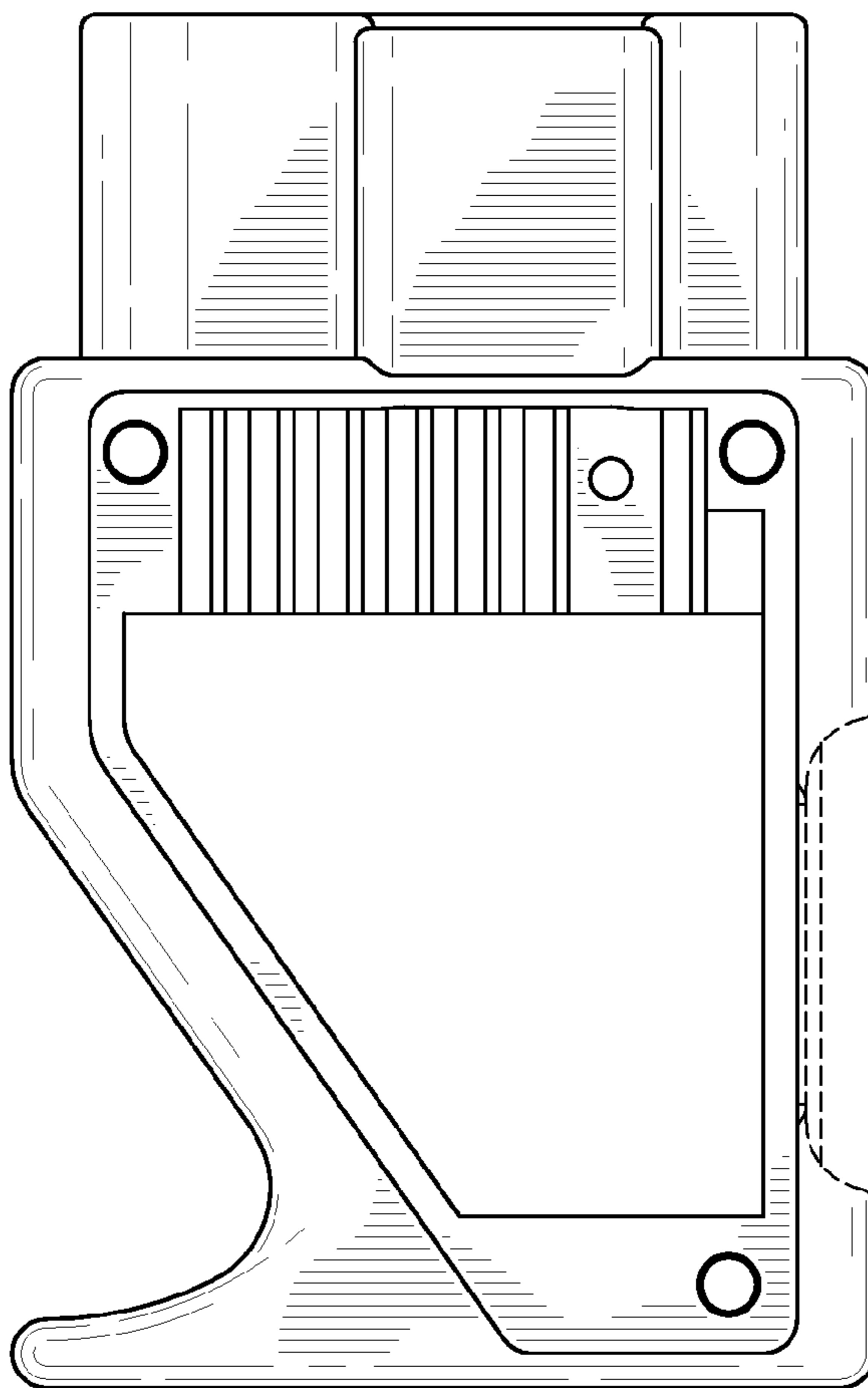

FIG-3

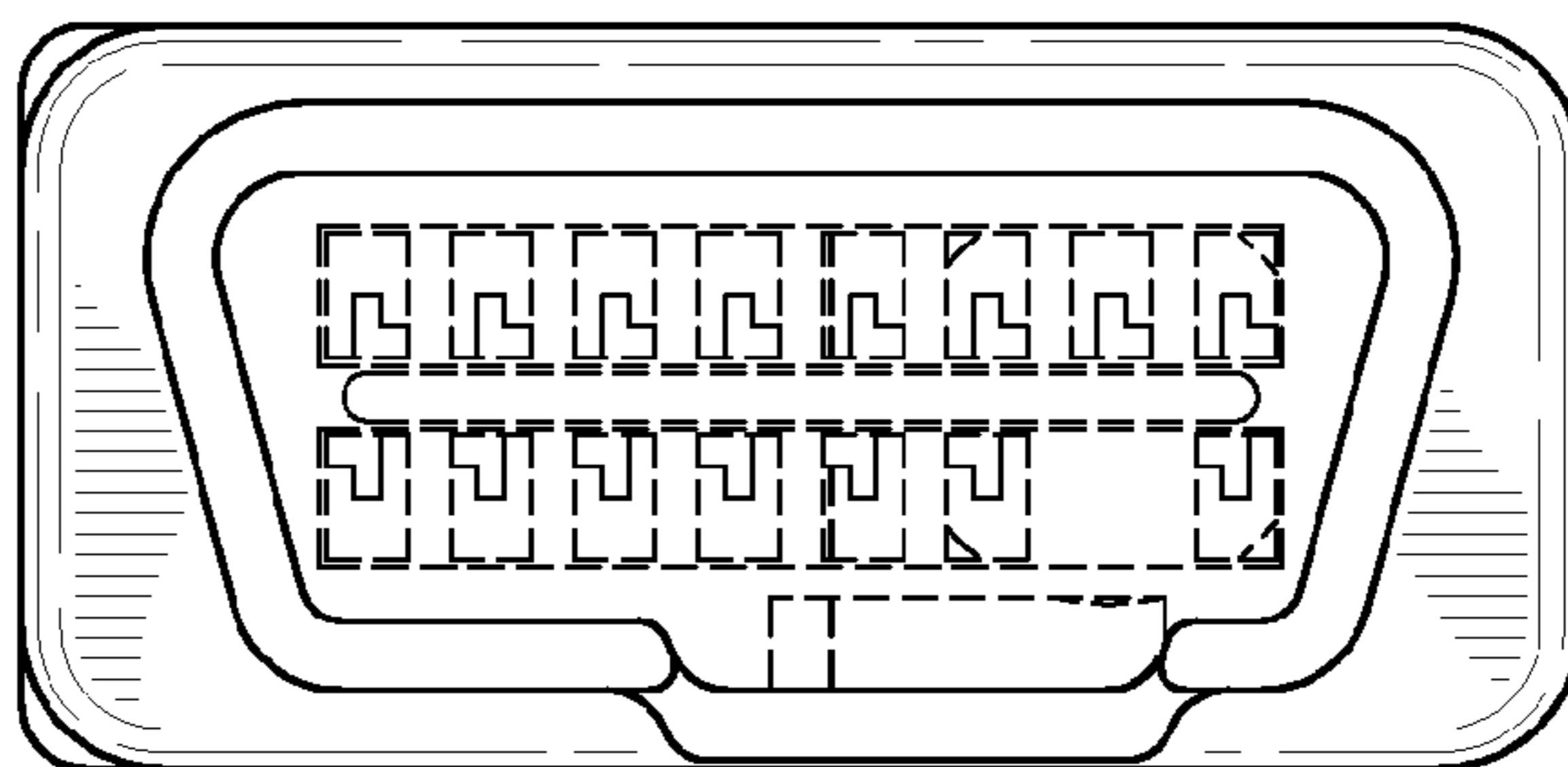

FIG-4

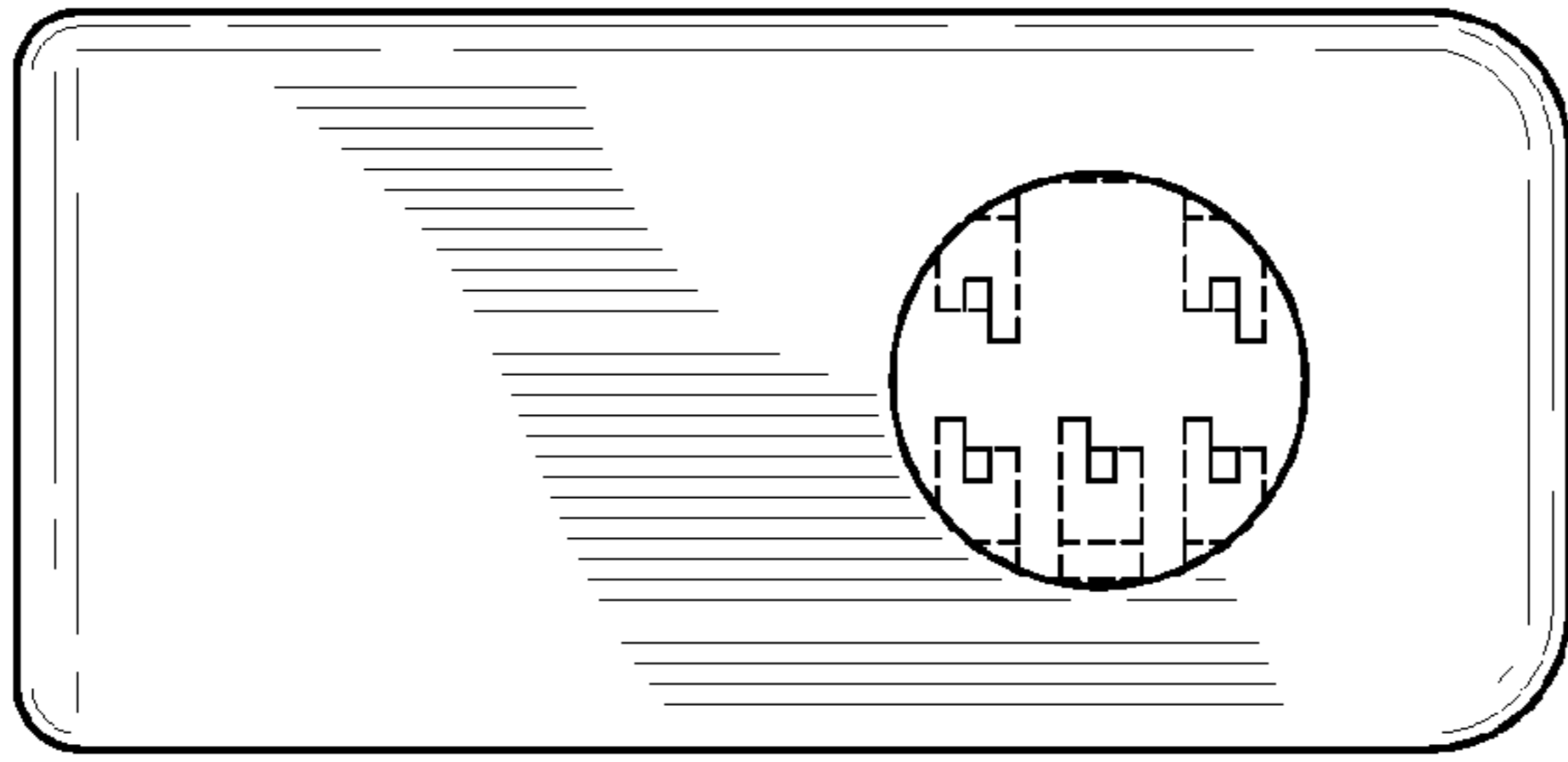

FIG-6

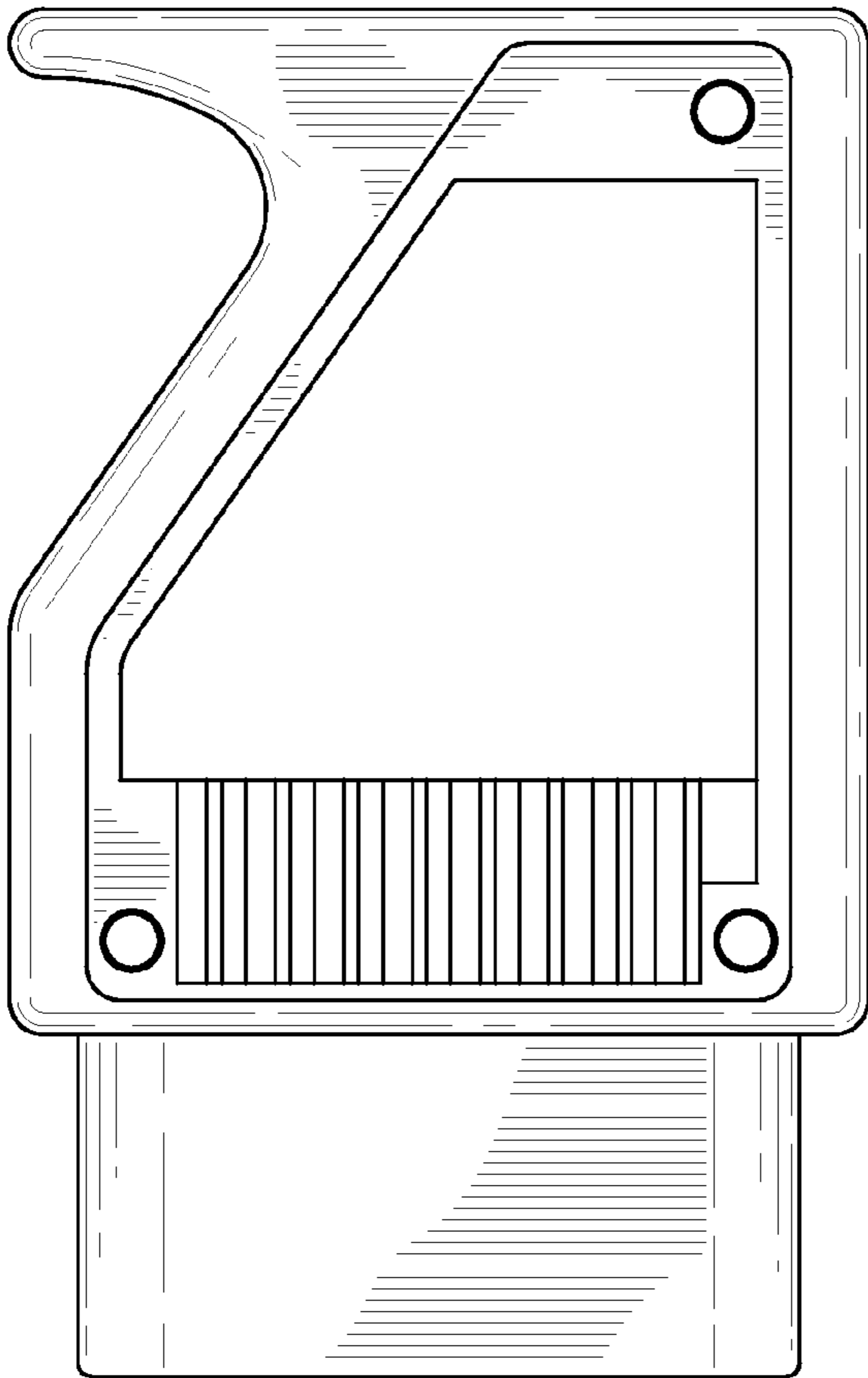

FIG-5

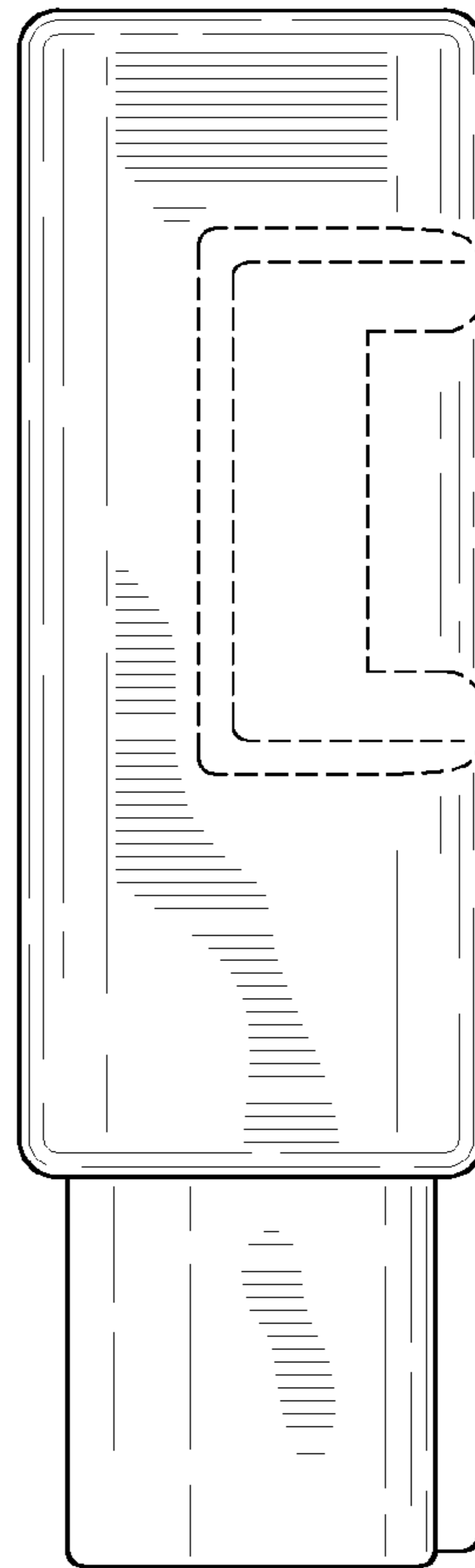

FIG-7

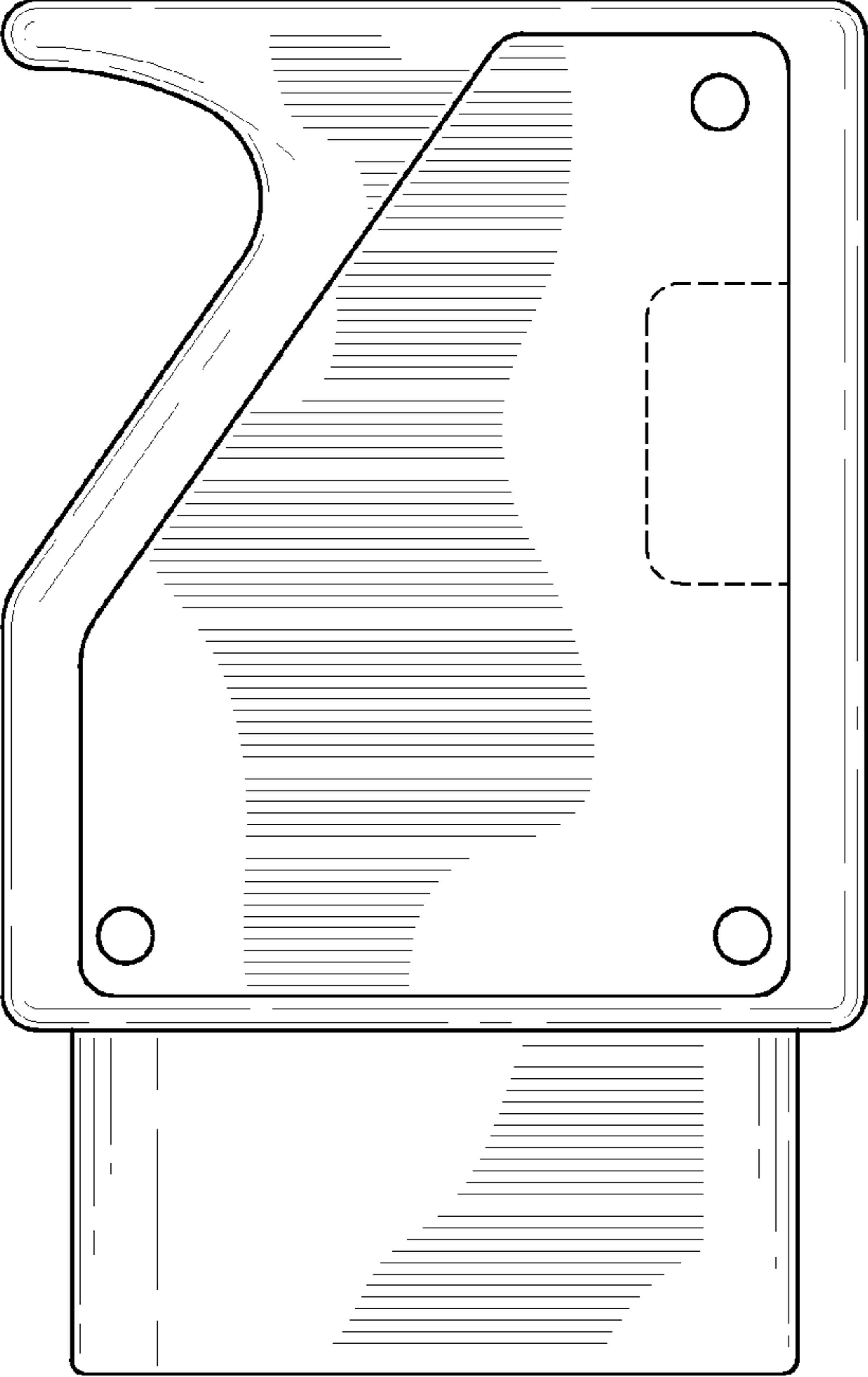

FIG-9

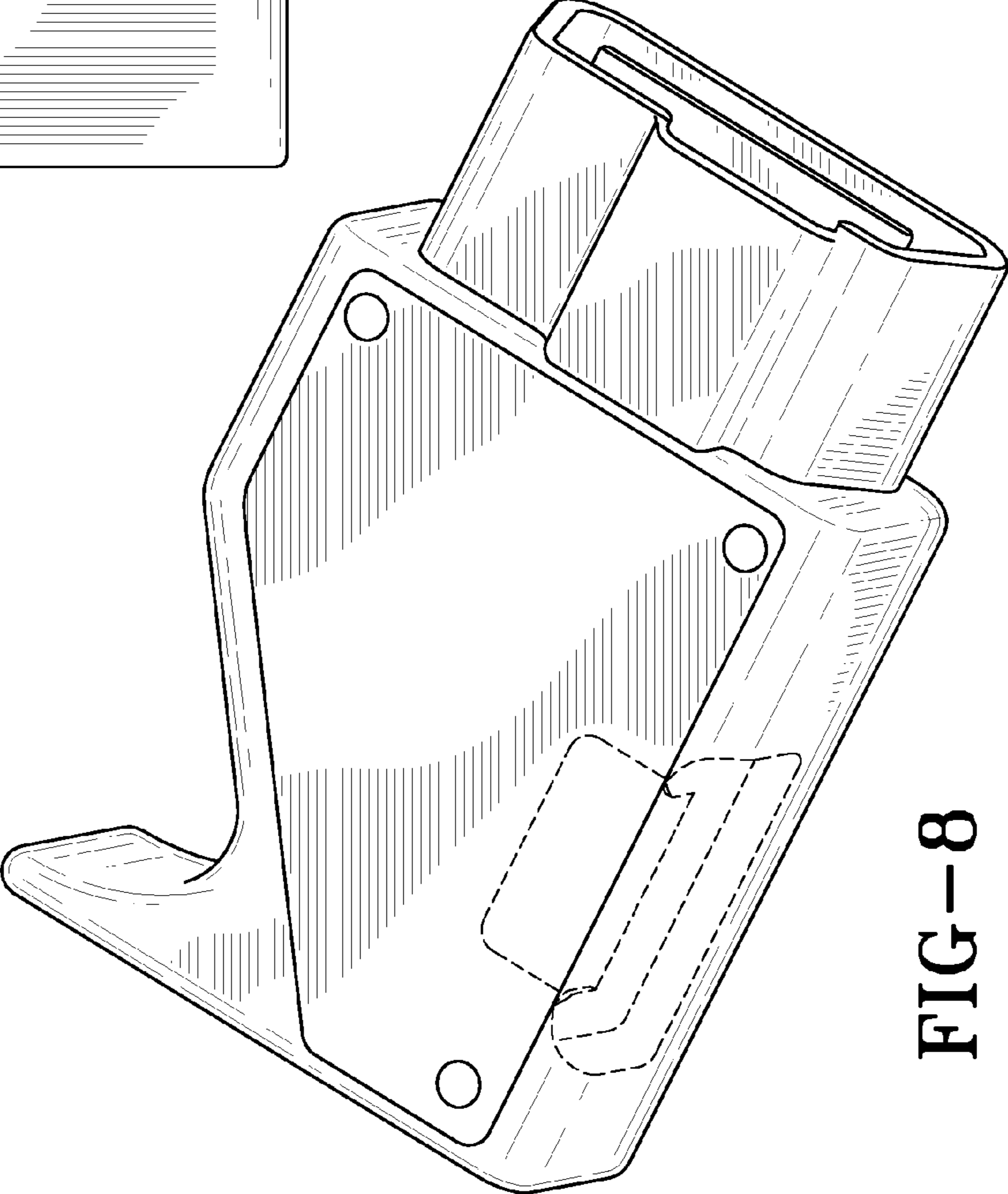

FIG-8