

US00D624140S

(12) **United States Design Patent**
Hicks

(10) **Patent No.:** **US D624,140 S**

(45) **Date of Patent:** **** Sep. 21, 2010**

(54) **GOLF PUTTER ACCESSORY**

(75) Inventor: **David Raymond Hicks**, Hampshire
(GB)

(73) Assignee: **Dave Hicks Golf Ltd.** (GB)

(**) Term: **14 Years**

(21) Appl. No.: **29/336,703**

(22) Filed: **May 7, 2009**

(51) **LOC (9) Cl.** **21-02**

(52) **U.S. Cl.** **D21/789**

(58) **Field of Classification Search** D21/789,
D21/753, 759; 473/219, 220, 221, 223, 226,
473/257; 250/221; D26/37; 362/259
See application file for complete search history.

(56) **References Cited**

U.S. PATENT DOCUMENTS

| | | | | | |
|-----------|------|---------|-----------------|-------|---------|
| 5,465,972 | A * | 11/1995 | Cornett | | 473/220 |
| 5,733,202 | A * | 3/1998 | Vargo | | 473/220 |
| D448,059 | S * | 9/2001 | Battaglia | | D21/791 |
| 6,450,893 | B1 * | 9/2002 | Primiano et al. | | 473/220 |
| 6,605,005 | B1 * | 8/2003 | Lin | | 473/220 |
| 6,690,003 | B2 * | 2/2004 | Zak | | 250/221 |

| | | | | | |
|-----------|------|--------|----------------|-------|---------|
| 6,746,336 | B1 * | 6/2004 | Brant et al. | | 473/44 |
| 6,796,910 | B1 * | 9/2004 | Foster | | 473/220 |
| 6,875,122 | B2 * | 4/2005 | Collins et al. | | 473/220 |
| 6,905,419 | B1 * | 6/2005 | Yeh | | 473/220 |
| D599,427 | S * | 9/2009 | O'Keefe | | D21/791 |

* cited by examiner

Primary Examiner—Mitchell I Siegel

(74) *Attorney, Agent, or Firm*—Renner, Otto, Boisselle & Sklar, LLP

(57) **CLAIM**

The ornamental design for a golf putter accessory, as shown and described.

DESCRIPTION

FIG. 1 is a perspective view from one end of a golf putter accessory showing my new design.

FIG. 2 is a perspective view from other end of the golf putter accessory, opposite that of FIG. 1.

FIG. 3 is a side view of the golf putter accessory.

FIG. 4 is a one end view of the golf putter accessory; and,

FIG. 5 is an end view of the golf putter accessory, opposite that of FIG. 4.

1 Claim, 2 Drawing Sheets

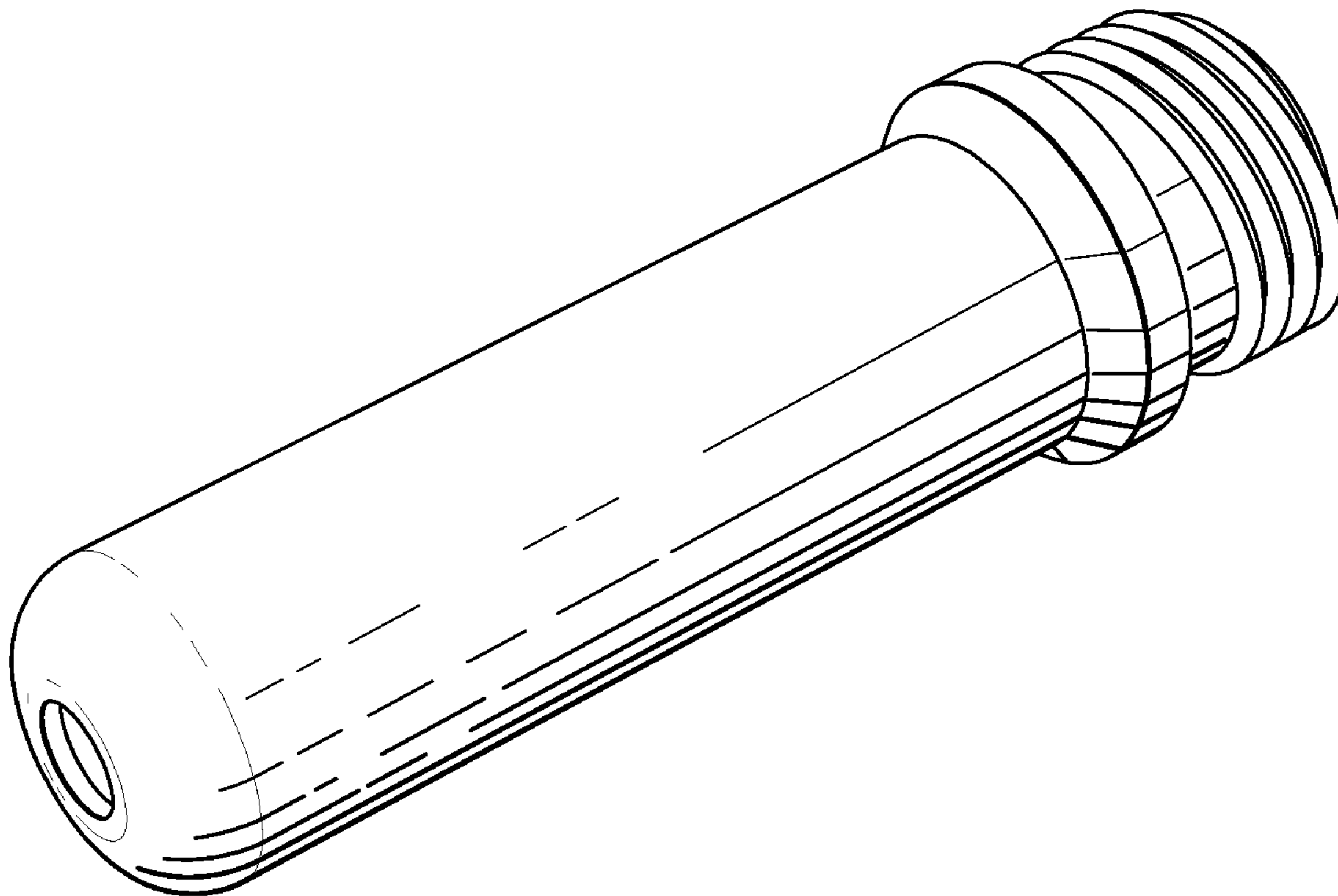

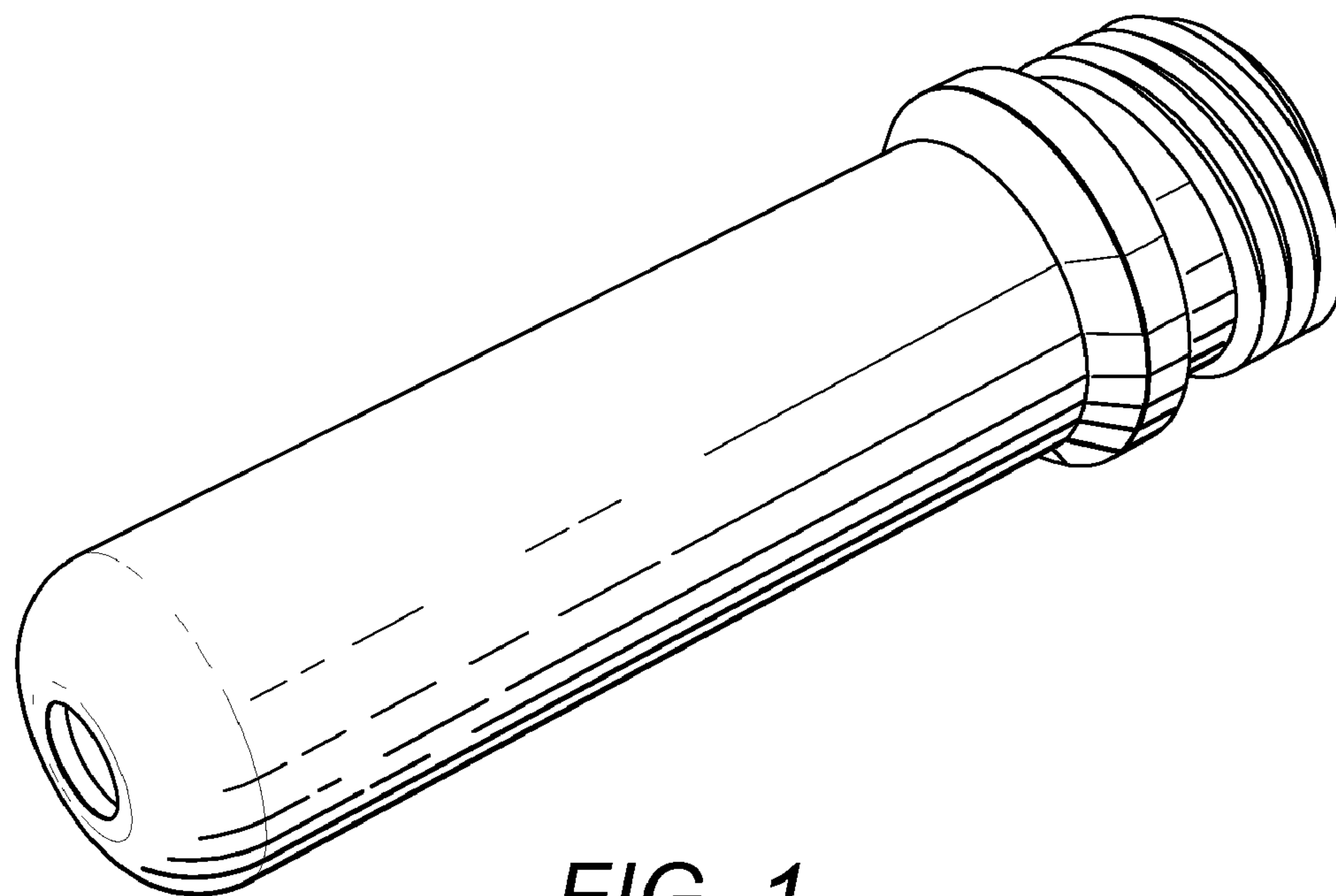

FIG. 1

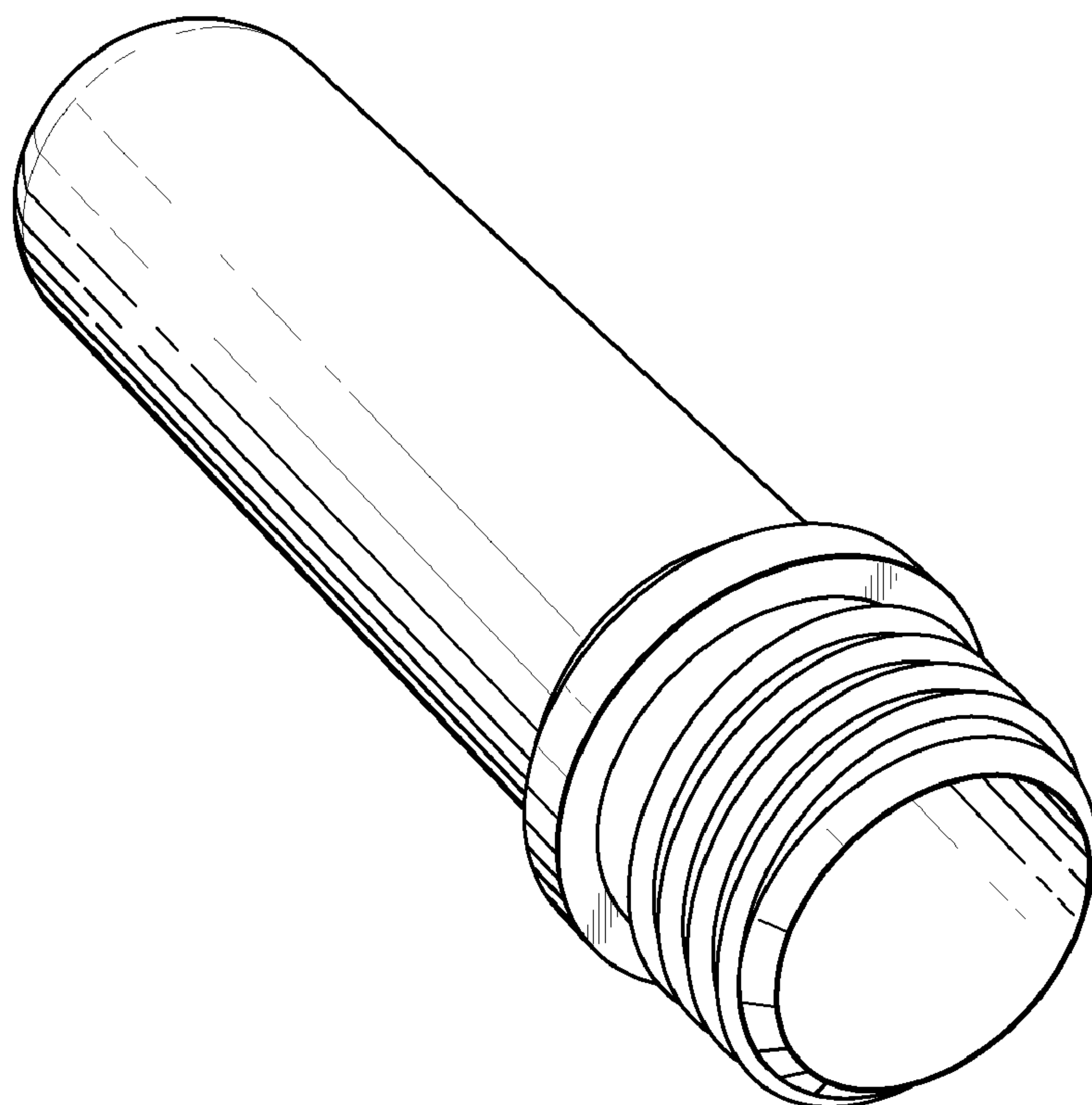

FIG. 2

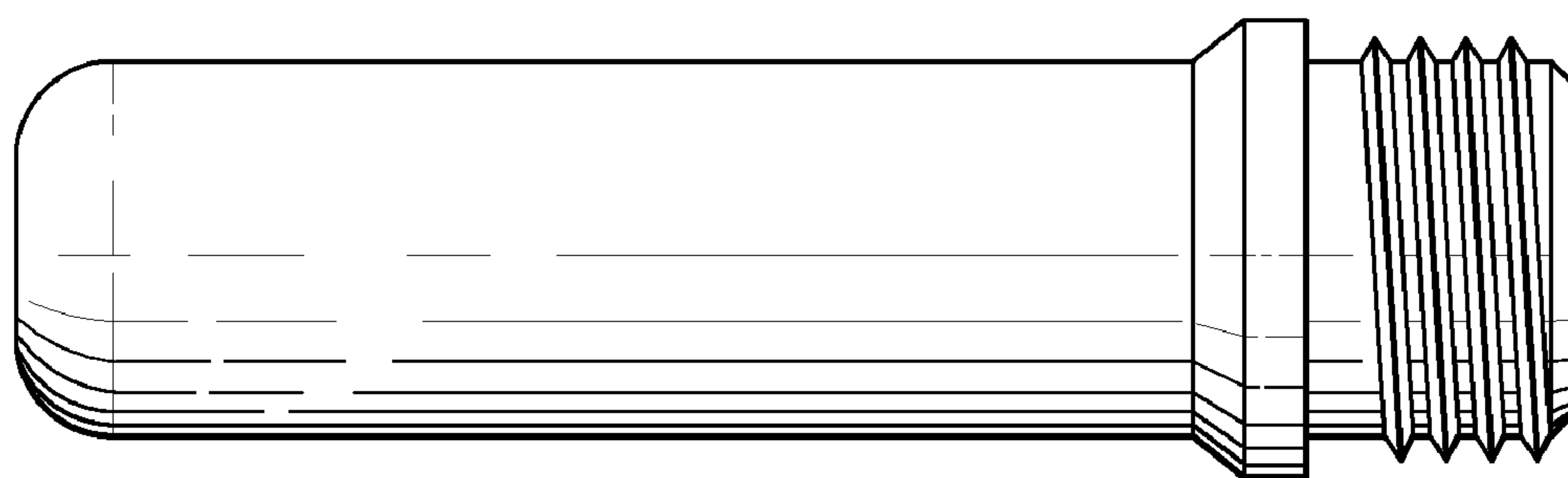

FIG. 3

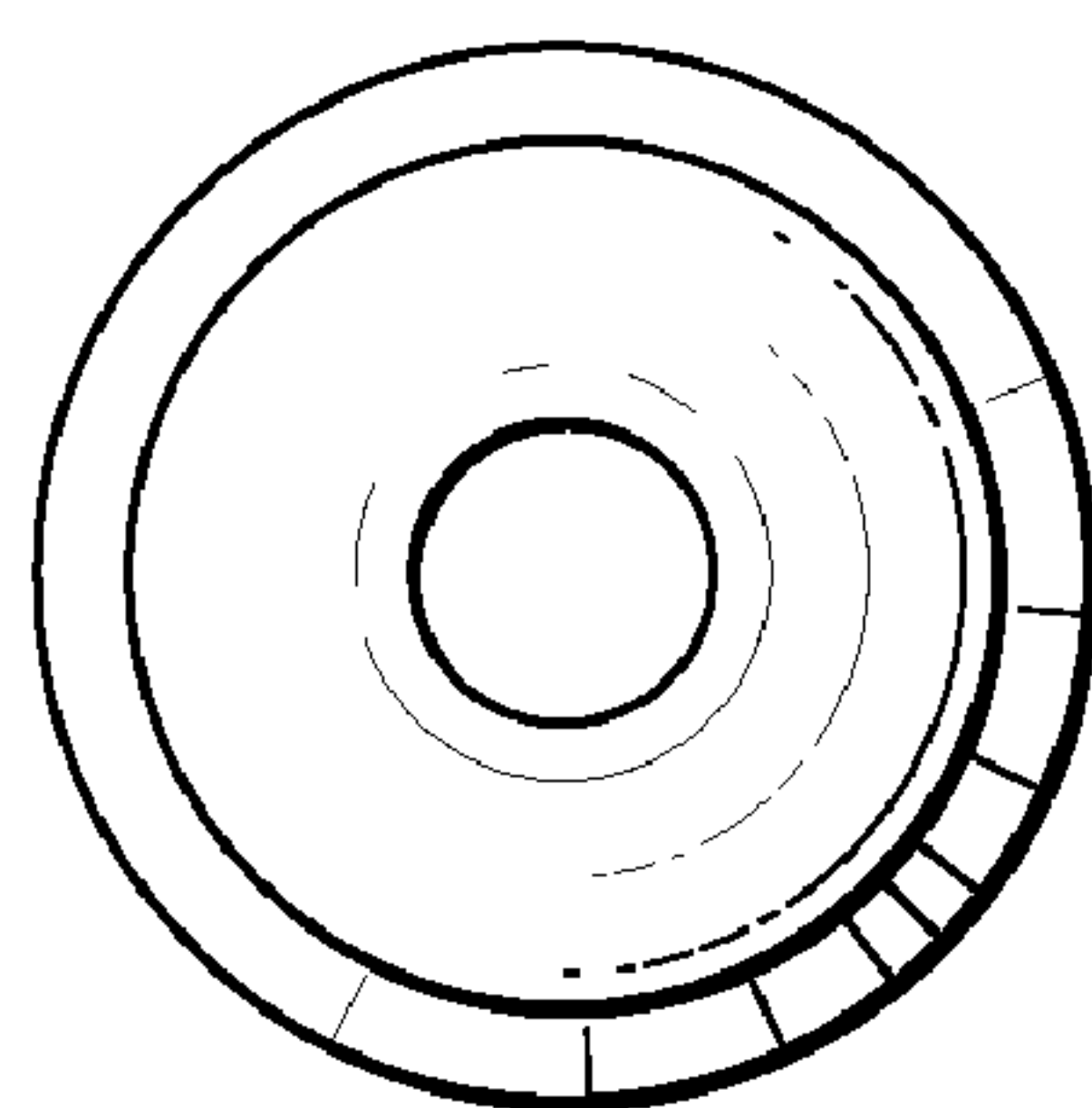

FIG. 4

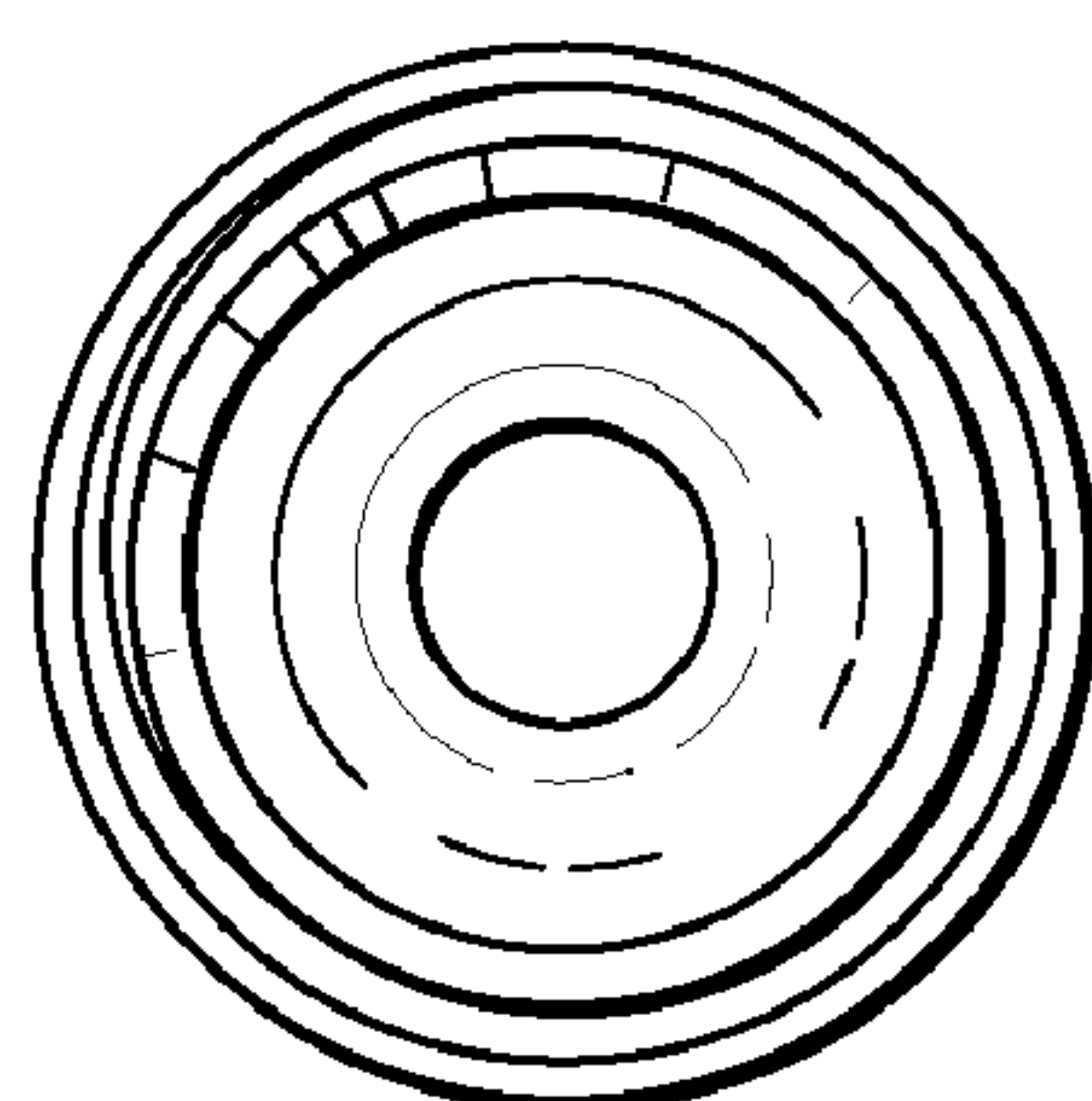

FIG. 5