



US00D622770S

(12) **United States Design Patent**  
**Shi**

(10) **Patent No.:** **US D622,770 S**

(45) **Date of Patent:** **\*\* Aug. 31, 2010**

(54) **PEN**  
(75) Inventor: **Yuemin Shi**, Ningbo (CN)  
(73) Assignee: **Beifa Group Co., Ltd.**, Ningbo (CN)  
(\*\*) Term: **14 Years**  
(21) Appl. No.: **29/338,976**  
(22) Filed: **Jun. 22, 2009**

(30) **Foreign Application Priority Data**  
Dec. 22, 2008 (CN) ..... 2008 3 0348832  
(51) **LOC (9) Cl.** ..... **19-06**  
(52) **U.S. Cl.** ..... **D19/51**  
(58) **Field of Classification Search** ..... D19/35,  
D19/36, 41-45, 53-57; 24/11 R, 11 F, 11 P;  
401/52, 99, 100, 104-109, 192, 195, 196  
See application file for complete search history.

(56) **References Cited**  
U.S. PATENT DOCUMENTS  
D117,265 S \* 10/1939 Gerhart ..... D9/453  
2,453,201 A \* 11/1948 Cushman ..... 401/207  
D259,792 S 7/1981 Itoh  
D261,010 S 9/1981 Itoh  
D266,769 S 11/1982 Camps  
D280,420 S \* 9/1985 Verhaegue ..... D19/48  
D284,872 S \* 7/1986 Booker ..... D19/48  
D294,600 S 3/1988 Funahashi  
D354,985 S \* 1/1995 Hong ..... D19/50  
D366,901 S 2/1996 Takahashi  
D366,902 S 2/1996 Takahashi  
D376,817 S \* 12/1996 Boix Gacia ..... D19/51  
D398,641 S 9/1998 Hollington

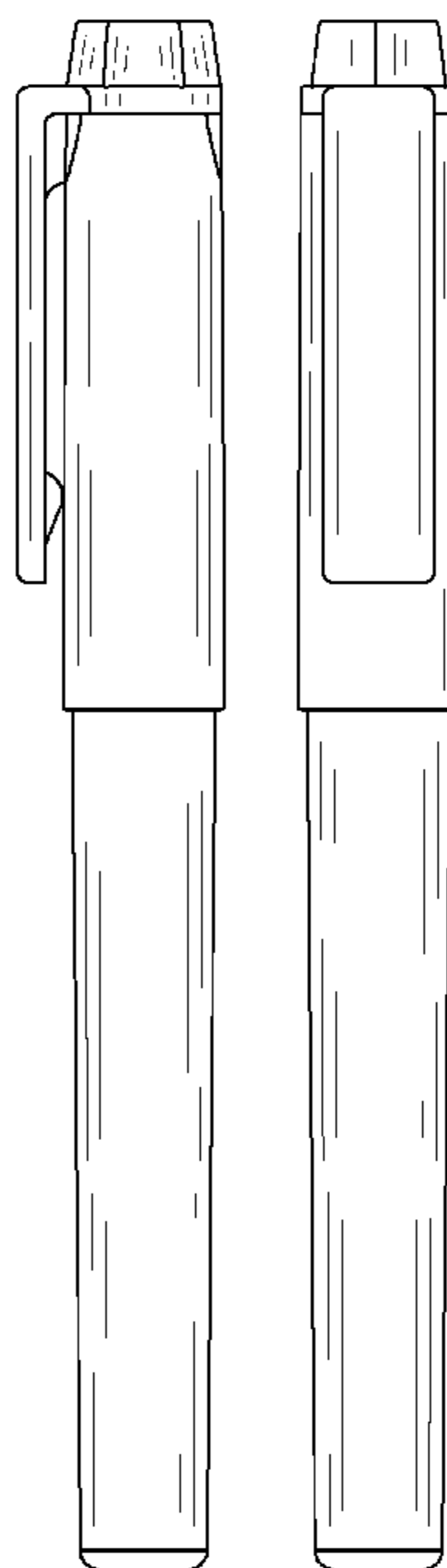
D405,826 S \* 2/1999 Worther ..... D19/49  
D409,241 S 5/1999 Melnick  
D409,656 S 5/1999 Melnick  
D410,029 S 5/1999 Melnick  
D411,237 S 6/1999 Izushima  
D437,888 S \* 2/2001 Briggl et al. .... D19/51  
D547,375 S \* 7/2007 Gerules ..... D19/51  
D566,175 S \* 4/2008 Qiu et al. .... D19/44  
D587,754 S \* 3/2009 Cetera ..... D19/57  
D587,755 S \* 3/2009 Cetera ..... D19/57  
D601,195 S 9/2009 Wang

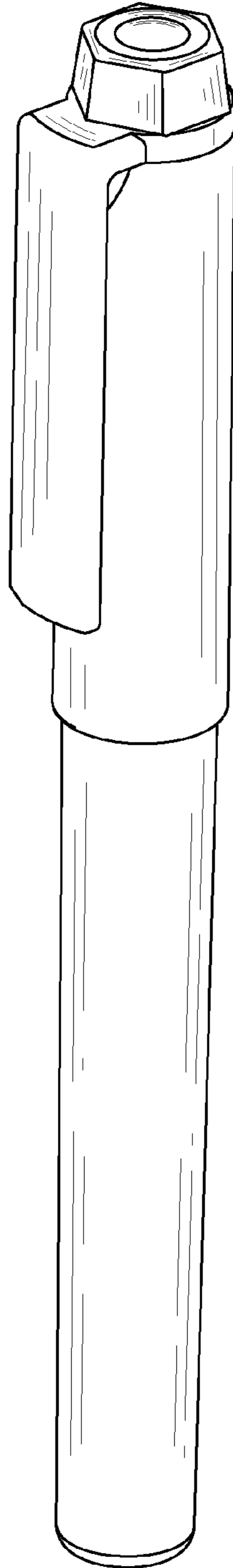
\* cited by examiner  
*Primary Examiner*—Elizabeth A Albert  
(74) *Attorney, Agent, or Firm*—Christensen O'Connor  
Johnson Kindness PLLC

(57) **CLAIM**  
The ornamental design for a pen, as shown and described.

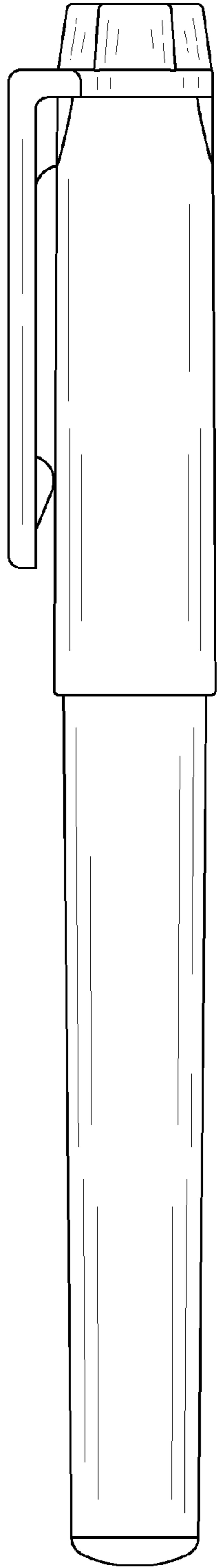
**DESCRIPTION**  
FIG. 1 is an upper front right perspective view of a pen showing my new design;  
FIG. 2 is a right side elevation view thereof;  
FIG. 3 is an enlarged top plan view thereof;  
FIG. 4 is a front elevation view thereof;  
FIG. 5 is a left side elevation view thereof;  
FIG. 6 is a bottom plan view thereof; and,  
FIG. 7 is a rear elevation view thereof.  
The broken lines showing portions of the top are included for the purpose of illustrating environment and form no part of the claimed design.

**1 Claim, 3 Drawing Sheets**

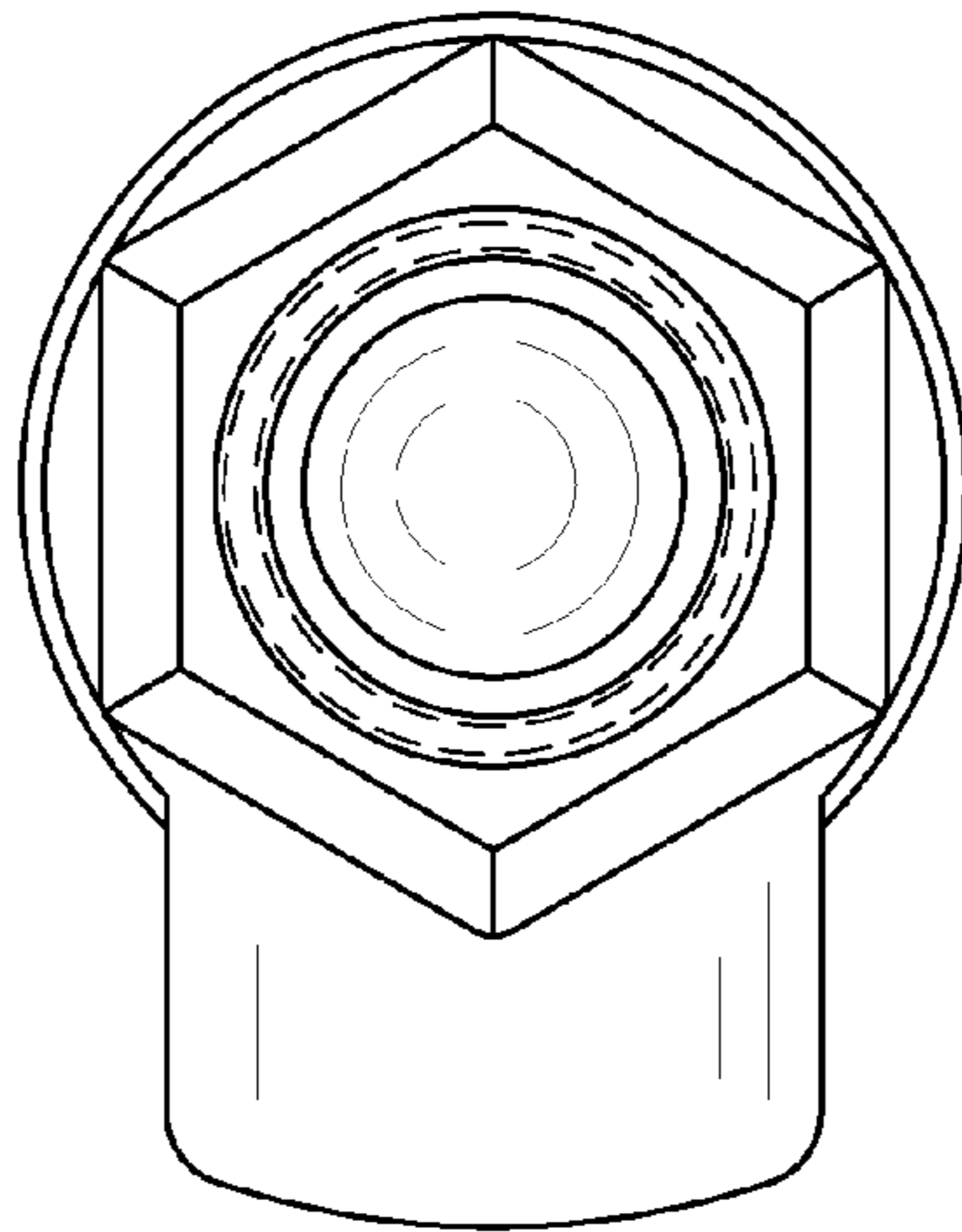




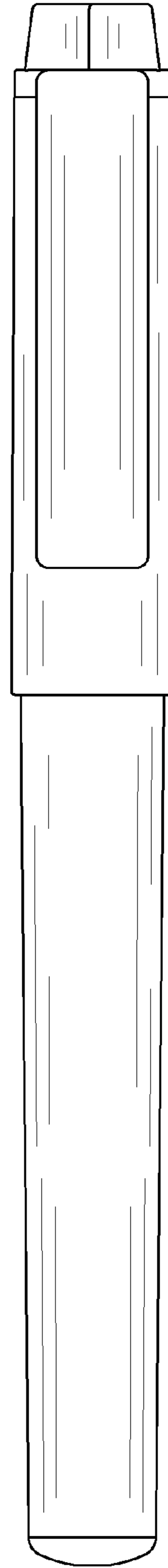
*Fig. 1.*



*Fig. 2.*

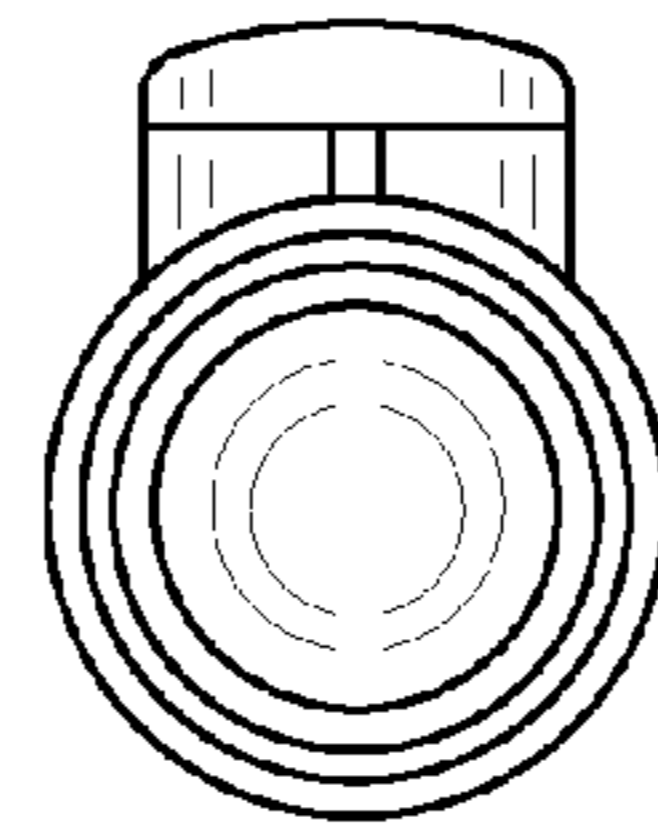
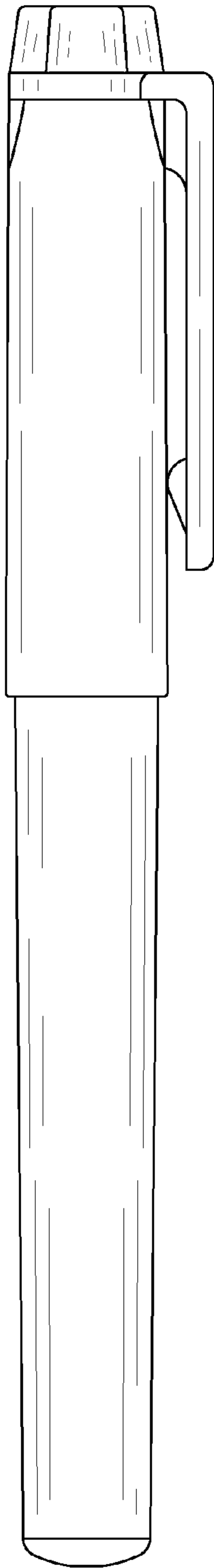


*Fig. 3.*



*Fig. 4.*

*Fig. 5.*



*Fig. 6.*

*Fig. 7.*

