



US00D622744S

(12) **United States Design Patent**
Inagawa

(10) **Patent No.:** **US D622,744 S**

(45) **Date of Patent:** **** Aug. 31, 2010**

(54) **LOAD LOCK ROLLER BALL SUPPORT**

(75) Inventor: **Makoto Inagawa**, Palo Alto, CA (US)

(73) Assignee: **Applied Materials, Inc.**, Santa Clara, CA (US)

(**) Term: **14 Years**

(21) Appl. No.: **29/327,945**

(22) Filed: **Nov. 14, 2008**

(51) **LOC (9) Cl.** **15-09**

(52) **U.S. Cl.** **D15/138**

(58) **Field of Classification Search** D8/402;
D13/182; D15/138, 139, 140, 143; 134/110;
204/224 M, 279; 361/234; 396/611; 414/331.15,
414/411, 416.03; 451/526; 601/72, 80, 102,
601/110; 700/213

See application file for complete search history.

(56) **References Cited**

U.S. PATENT DOCUMENTS

2,797,685	A *	7/1957	Packwood	601/131
D378,539	S *	3/1997	Scott	D24/211
5,672,254	A *	9/1997	Mauz	204/279
6,200,052	B1 *	3/2001	Pitaniello	401/131
D502,264	S *	2/2005	Timmer	D24/211
7,066,800	B2	6/2006	Chen et al.		
7,125,477	B2	10/2006	Butterfield et al.		
7,303,662	B2	12/2007	Mavliev et al.		
7,549,656	B2 *	6/2009	Bier	280/93.511
2003/0025671	A1 *	2/2003	Cheng	345/163

2003/0150079	A1 *	8/2003	Takai et al.	16/26
2004/0120620	A1 *	6/2004	Landrive	384/448
2005/0187498	A1 *	8/2005	Miller	601/72
2007/0162133	A1 *	7/2007	Doubler et al.	623/17.11
2007/0196160	A1 *	8/2007	Nakatani	401/215
2009/0079164	A1 *	3/2009	Columbia	280/511

* cited by examiner

Primary Examiner—Sandra Snapp

Assistant Examiner—Patricia Palasik

(74) *Attorney, Agent, or Firm*—Patterson & Sheridan, LLP

(57) **CLAIM**

The ornamental design for a load lock roller ball support, as shown and described.

DESCRIPTION

FIG. 1 is an isometric view of a load lock roller ball support.

FIG. 2 is a side view of the load lock roller ball support.

FIG. 3 is a side view of the load lock roller ball support.

FIG. 4 is a side view of the load lock roller ball support.

FIG. 5 is a side view of the load lock roller ball support.

FIG. 6 is a top view of the load lock roller ball support; and,

FIG. 7 is a bottom view of the load lock roller ball support.

The present invention generally includes a load lock roller ball support. The load lock roller ball support includes a vespel ball held in a stainless steel body. The ball is maintained in the body by a stainless steel cap that is coupled to the stainless steel body.

1 Claim, 3 Drawing Sheets

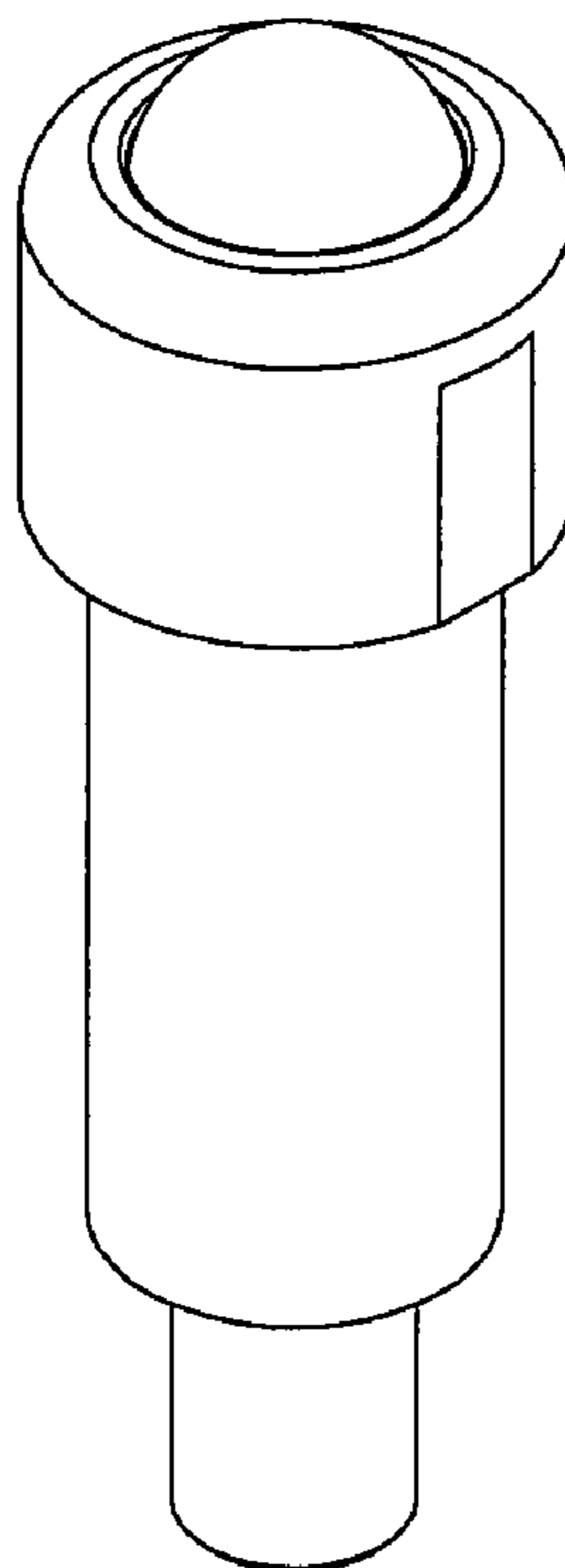

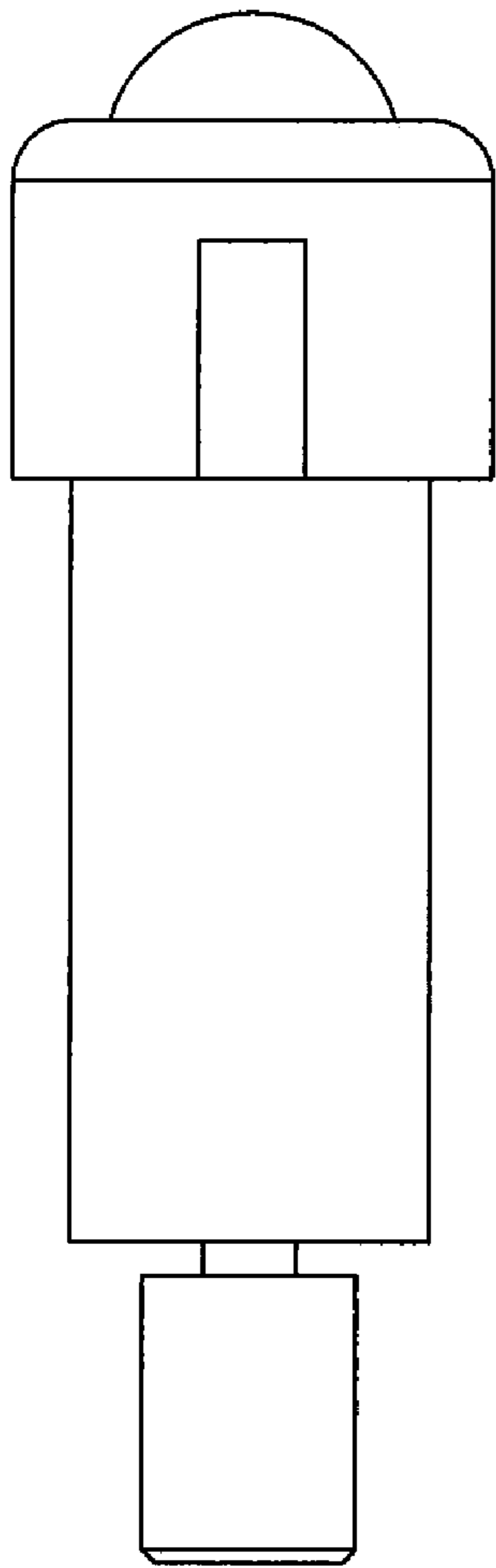

FIG. 2

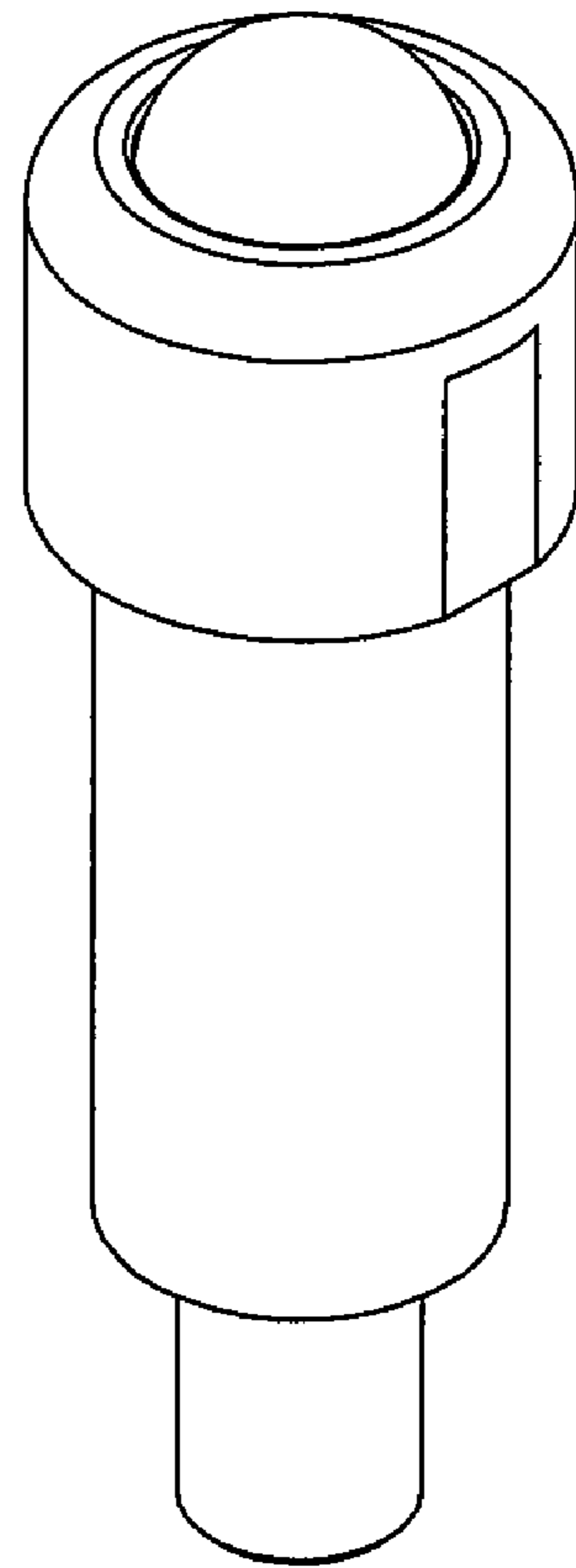

FIG. 1

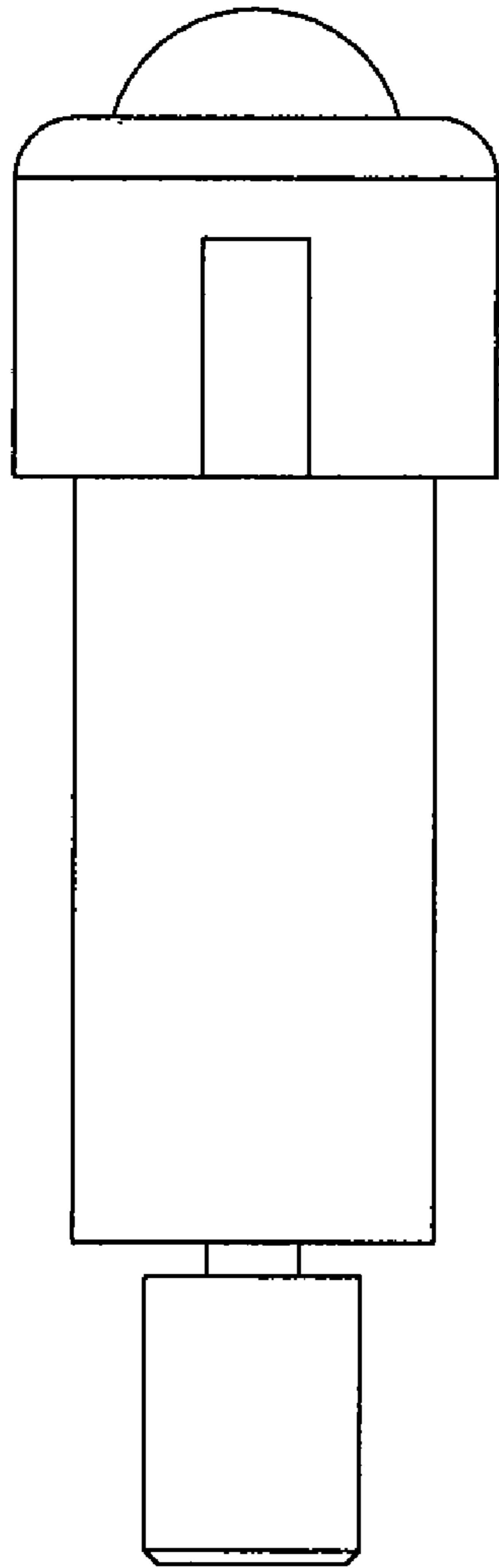

FIG. 4

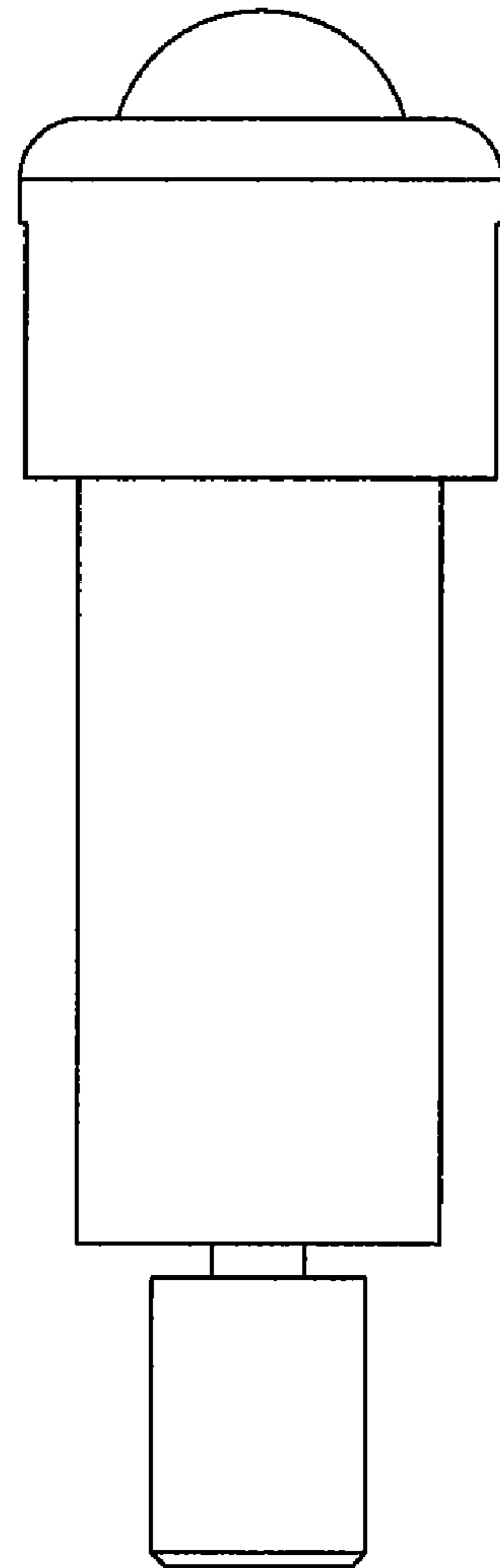

FIG. 3

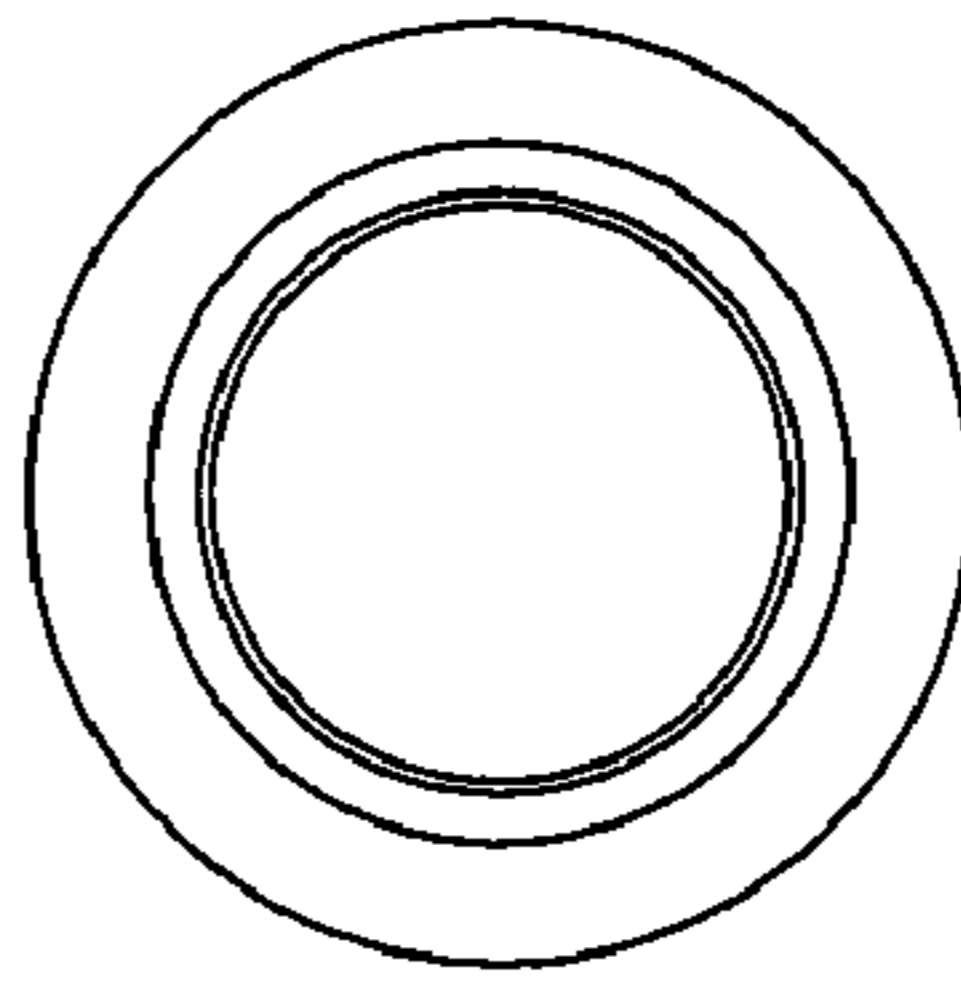

FIG. 6

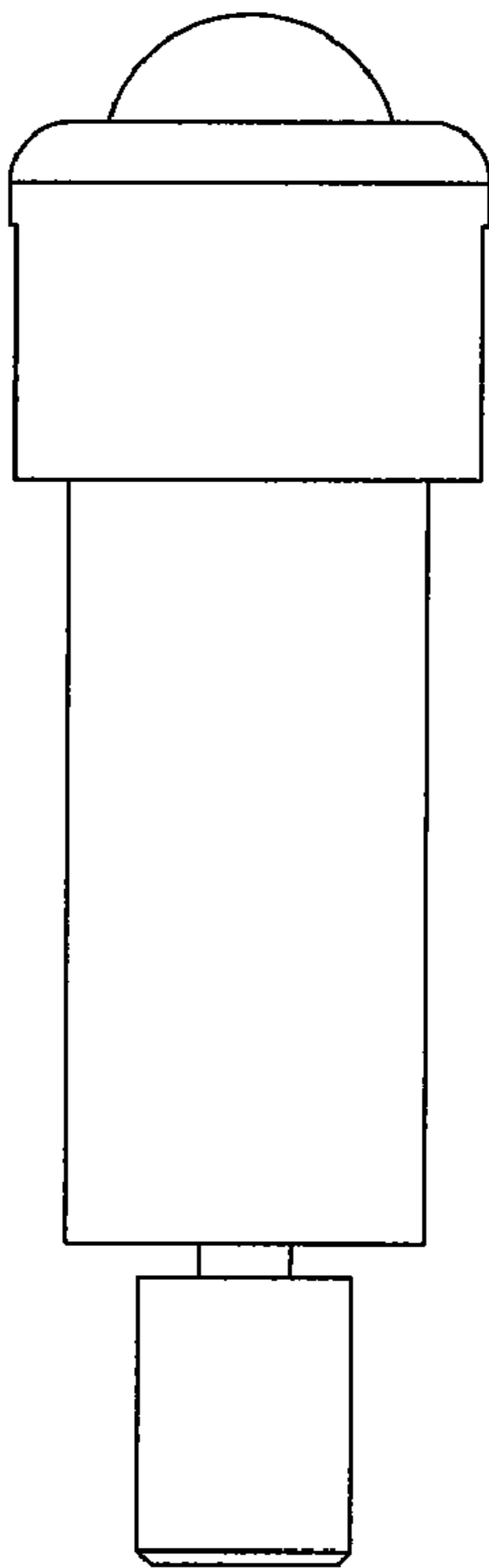

FIG. 5

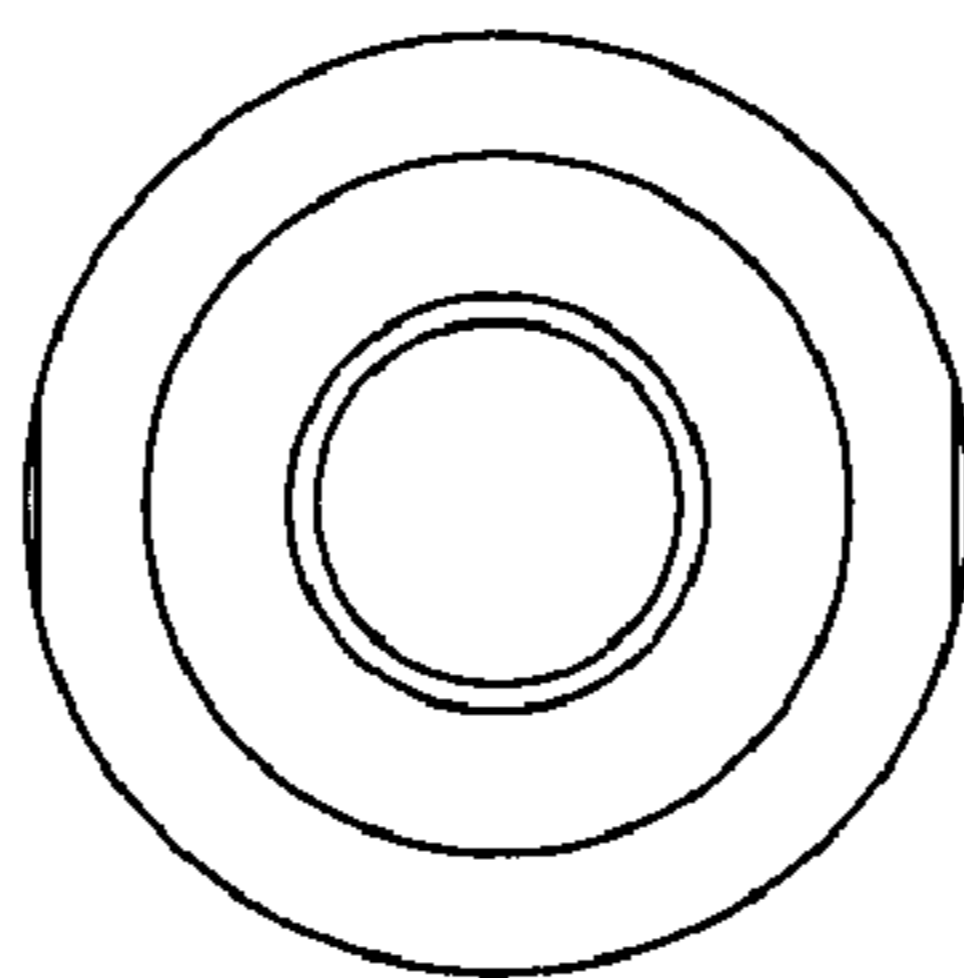

FIG. 7