



US00D621976S

(12) **United States Design Patent**
Langley

(10) **Patent No.:** **US D621,976 S**

(45) **Date of Patent:** **** Aug. 17, 2010**

(54) **RACE CAR MEMORABILIA OUTDOOR TORCH**

(76) Inventor: **James A. Langley**, 6260 Nature Dr.,
Montgomery, AL (US) 36117

(**) Term: **14 Years**

(21) Appl. No.: **29/315,135**

(22) Filed: **May 29, 2009**

(51) **LOC (9) Cl.** **26-02**

(52) **U.S. Cl.** **D26/8**

(58) **Field of Classification Search** D26/6-23;
D9/635, 435, 541, 447, 454; D7/472, 575,
D7/536, 584; D11/160, 96; 431/288-297,
431/125, 126, 343, 320, 350; 362/806-810,
362/161-163

See application file for complete search history.

(56) **References Cited**

U.S. PATENT DOCUMENTS

D456,917 S	5/2002	Kumar	
D464,447 S	10/2002	Yeh	
D487,522 S *	3/2004	Lu	D26/8
D487,808 S *	3/2004	Lu	D26/8
D548,371 S	8/2007	Kleist et al.	
D589,177 S	3/2009	Langley	

* cited by examiner

Primary Examiner—T. Chase Nelson
Assistant Examiner—Ania K Dworzecka
(74) *Attorney, Agent, or Firm*—Gable Gotwals

(57) **CLAIM**

The ornamental design for a race car memorabilia outdoor torch, as shown and described.

DESCRIPTION

FIG. 1 is a front elevational view of the race car memorabilia outdoor torch showing my new design.

FIG. 2 is a right side elevational view of my design.

FIG. 3 is a left side elevational view of my design.

FIG. 4 is a rear side elevational view of my design.

FIG. 5 is a top plan view of my design; and,

FIG. 6 is a front elevational view of my design with the cap removed and the torch lighted.

The race car memorabilia torch is shown broken away to indicate that a particular height forms no part of the claimed design.

In the drawings, the broken lines showing the flame in FIG. 6 depict environmental subject matter only and form no part of the claimed design.

In the drawings, the broken lines depict unclaimed subject matter only and form no part of the claimed design.

1 Claim, 3 Drawing Sheets

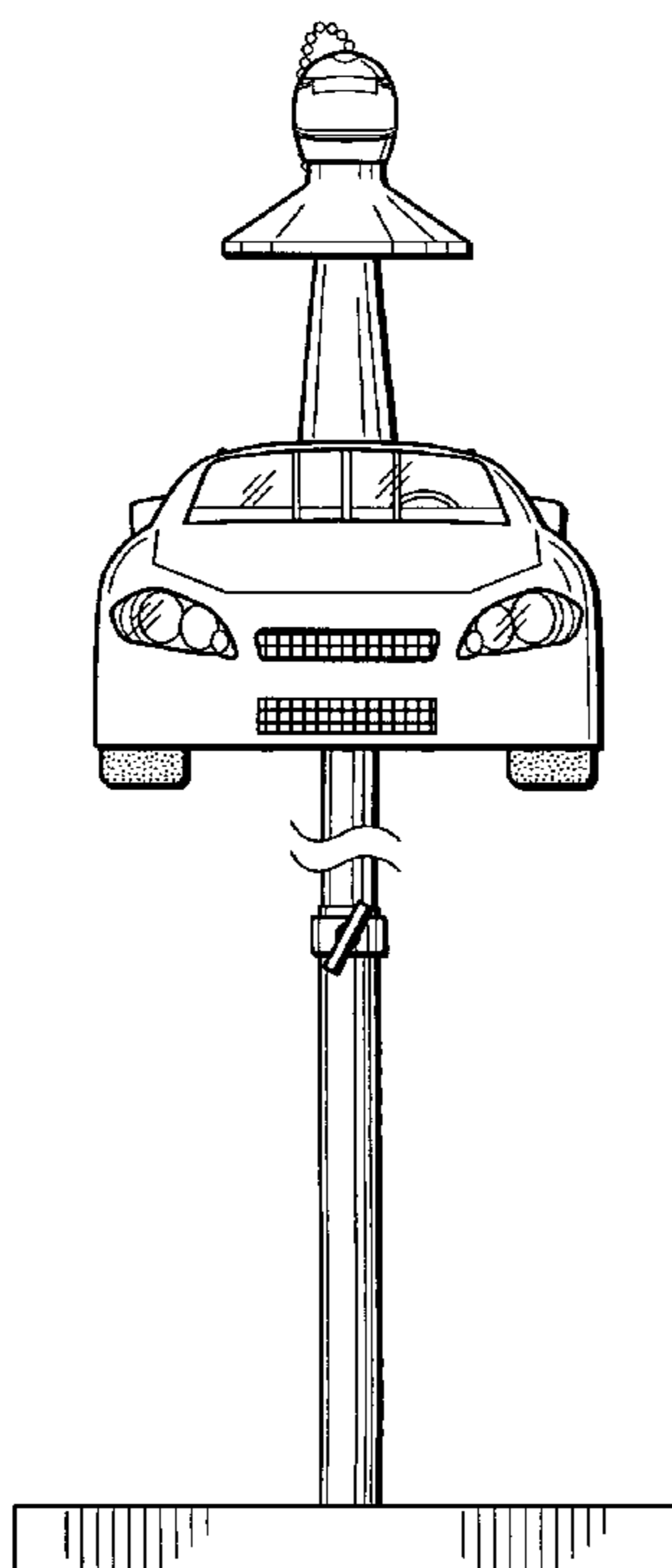

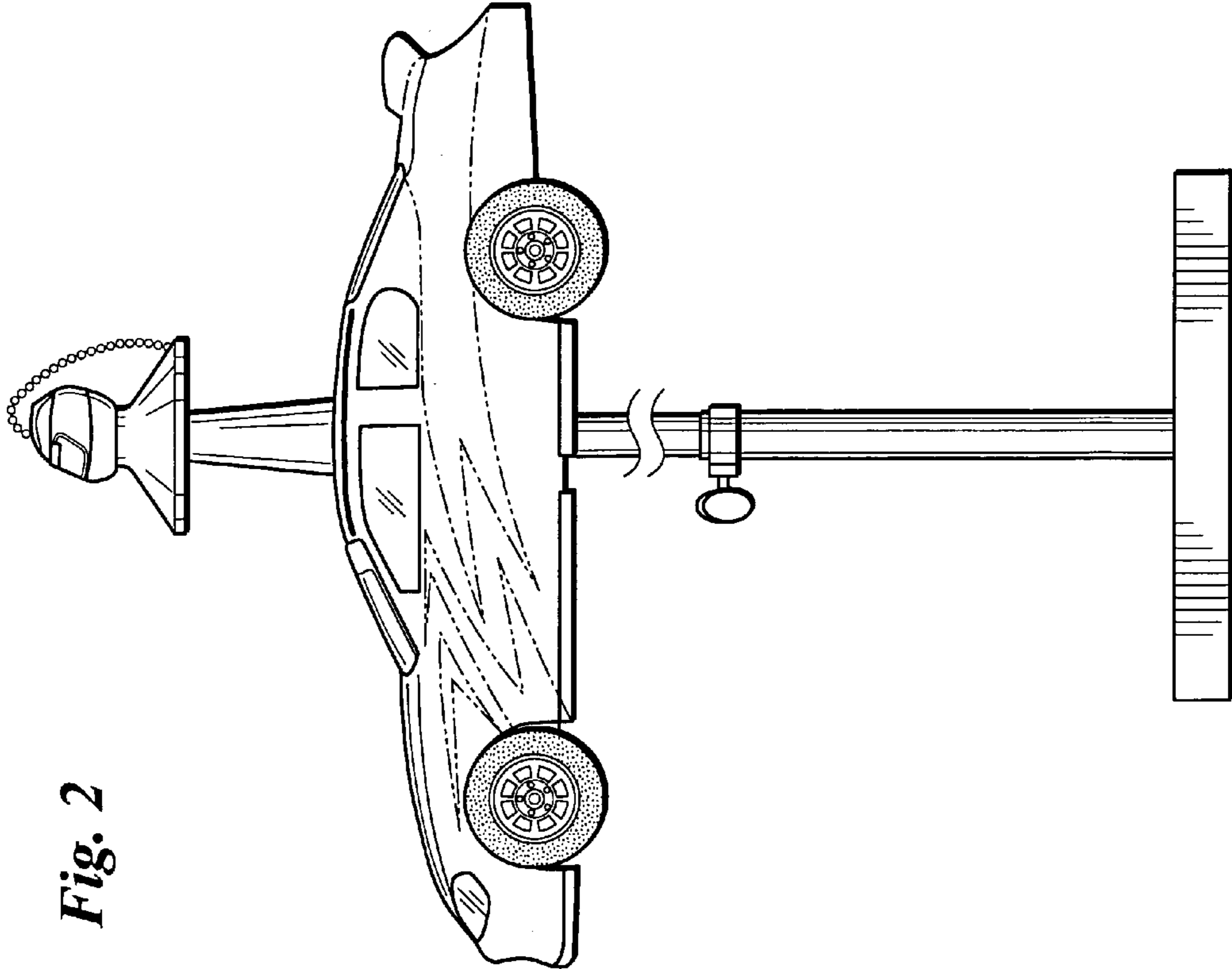

Fig. 1

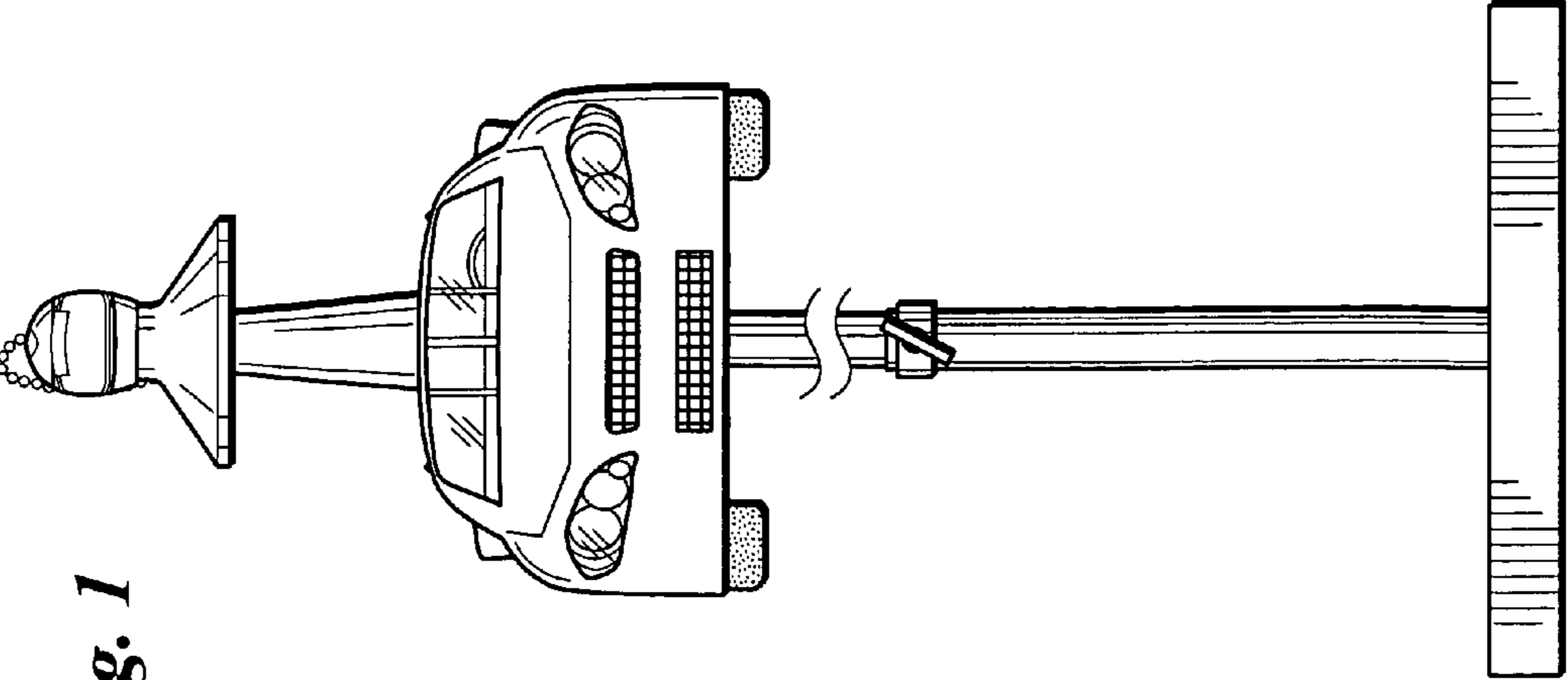

Fig. 2

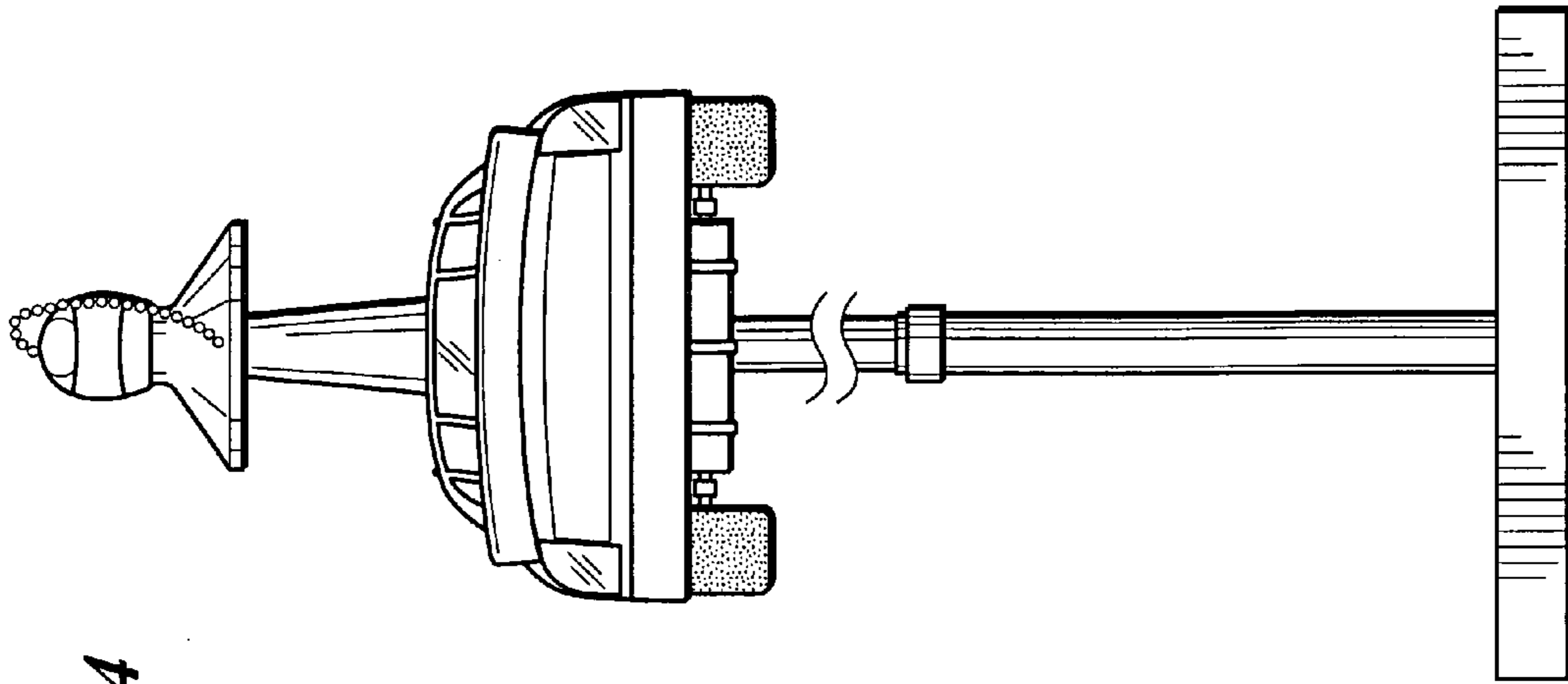

Fig. 4

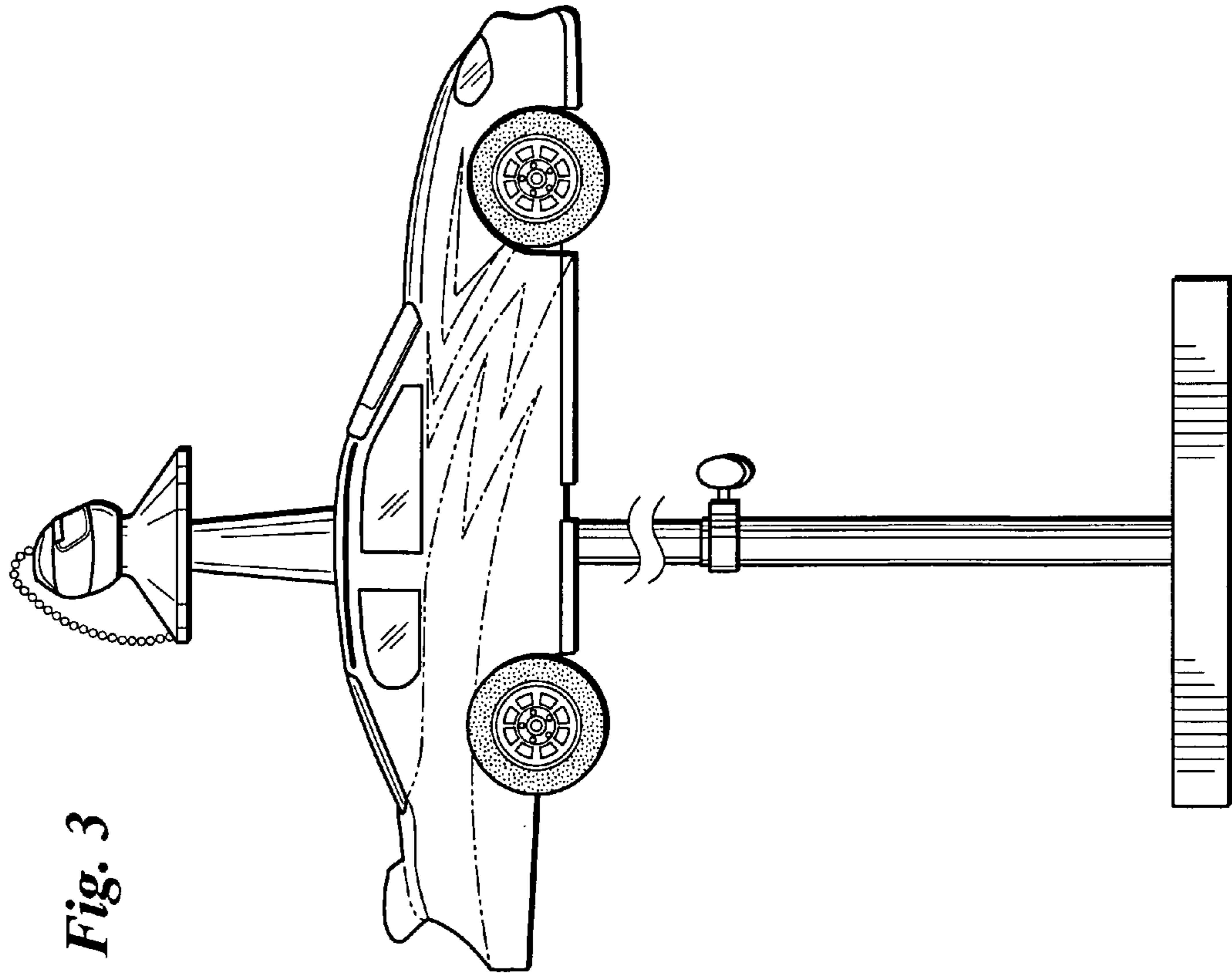

Fig. 3

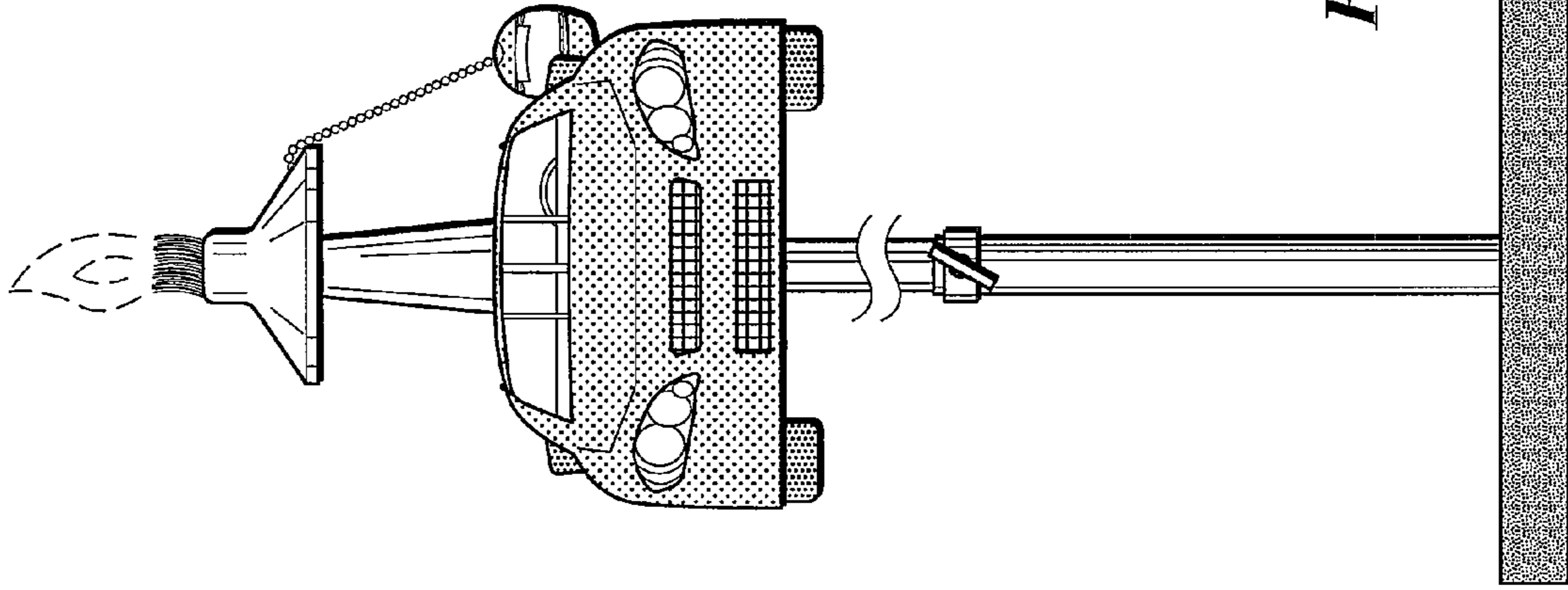

Fig. 6

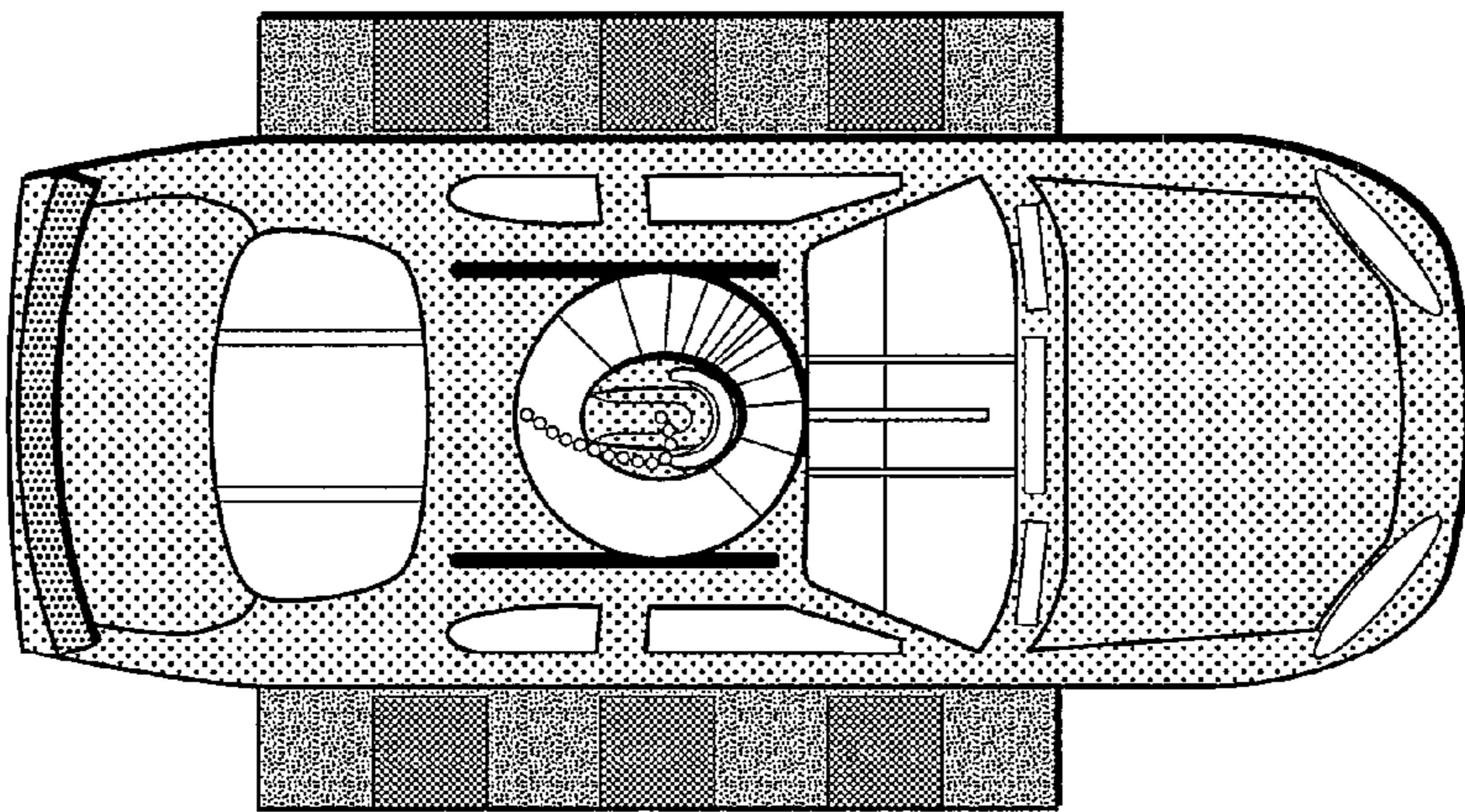

Fig. 5