



US00D621420S

(12) **United States Design Patent**
Jiang

(10) **Patent No.:** **US D621,420 S**

(45) **Date of Patent:** **** Aug. 10, 2010**

(54) **COMPRESSOR CASE ASSEMBLY**

D574,856 S * 8/2008 Chu D15/9
D574,857 S * 8/2008 Chu D15/9

(75) Inventor: **Junfeng Jiang**, Wuxi (CN)

* cited by examiner

(73) Assignee: **Michael B. Sunday**, Fort Worth, TX
(US)

Primary Examiner—Ralf Seifert

(74) *Attorney, Agent, or Firm*—Eric Karich

(**) Term: **14 Years**

(57) **CLAIM**

(21) Appl. No.: **29/342,008**

The ornamental design for a “compressor case assembly,” as shown and described.

(22) Filed: **Aug. 17, 2009**

(51) **LOC (9) Cl.** **15-02**

(52) **U.S. Cl.** **D15/9**

(58) **Field of Classification Search** D15/7-9;
D23/231, 232, 225; 417/410.1, 359, 415-416,
417/234, 321, 265, 405

See application file for complete search history.

DESCRIPTION

FIG. 1 is a perspective view of a compressor case assembly, showing my new design;

FIG. 2 is a front elevational view thereof;

FIG. 3 is a rear elevational view thereof;

FIG. 4 is a left side elevational view thereof

FIG. 5 is a right side elevational view thereof;

FIG. 6 is a top plan view thereof; and,

FIG. 7 is a bottom plan view thereof.

The broken lines are included for the purpose of illustrating portions of the compressor case assembly that forms no part of the claimed design.

(56) **References Cited**

U.S. PATENT DOCUMENTS

D381,993 S *	8/1997	Takenaka et al.	D15/9
D429,738 S *	8/2000	Kayukawa et al.	D15/9
D505,961 S *	6/2005	Chu	D15/9
D506,763 S *	6/2005	Chu	D15/9
D540,351 S *	4/2007	Chu	D15/9
D549,737 S *	8/2007	Chu	D15/9

1 Claim, 7 Drawing Sheets

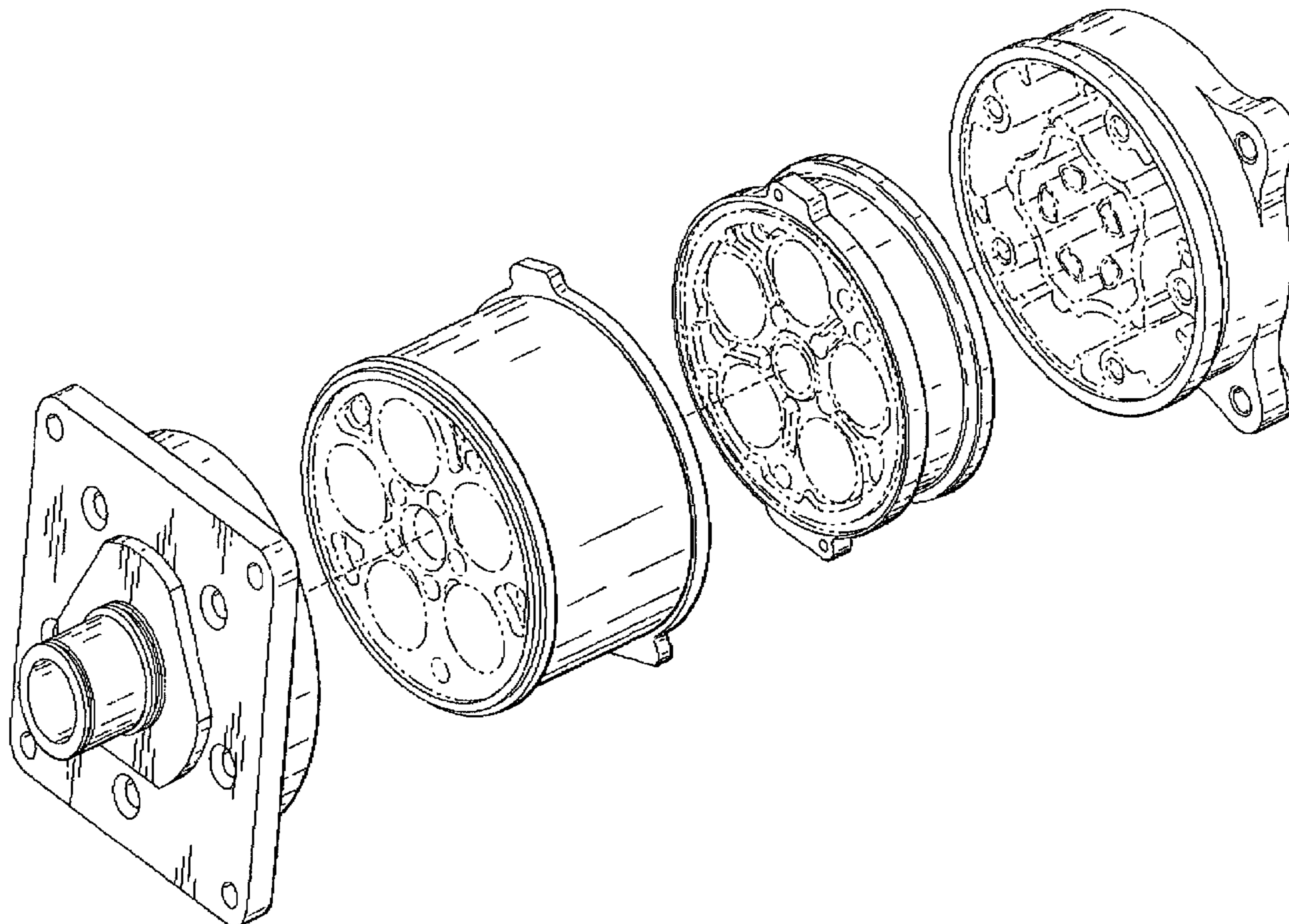

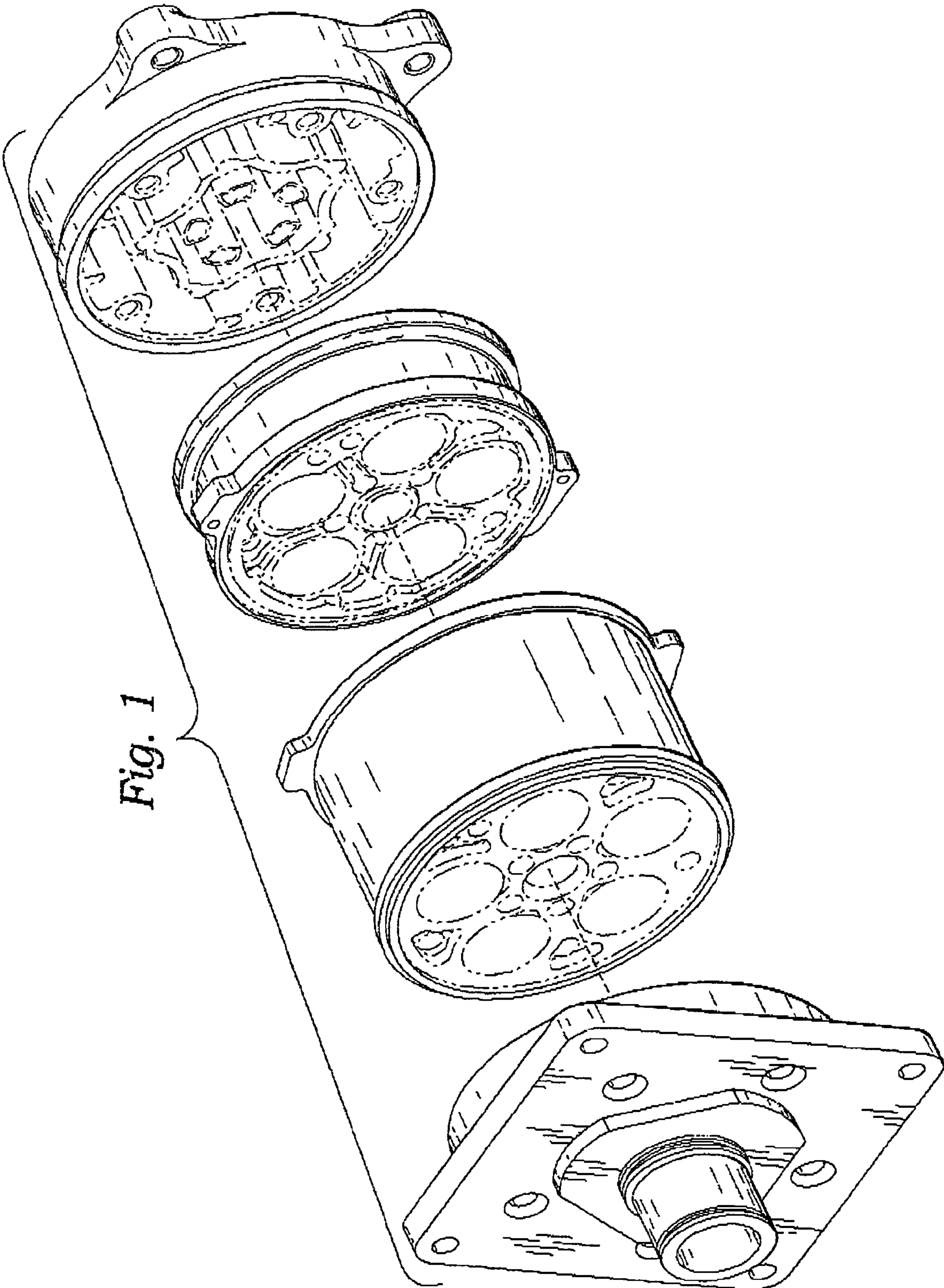

Fig. 1

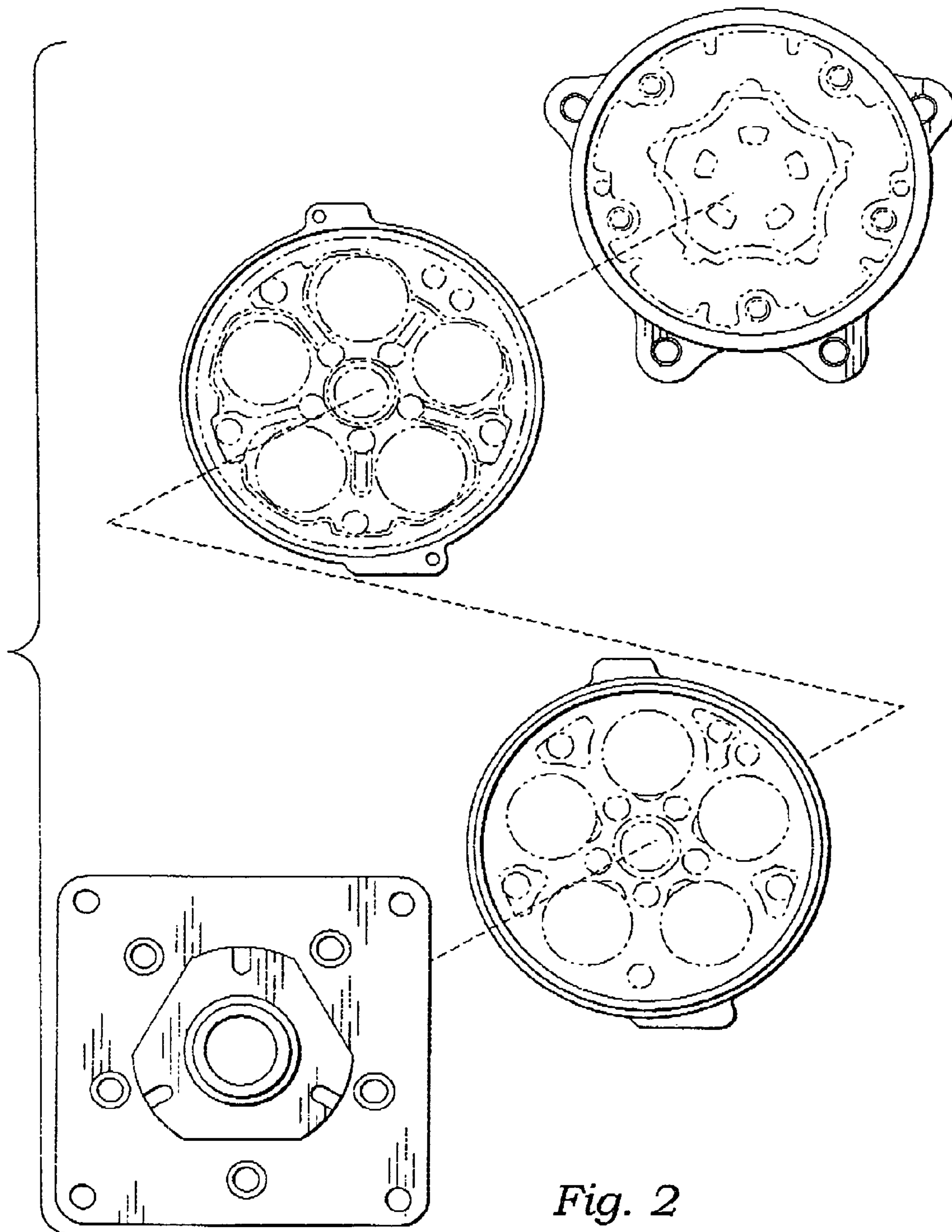

Fig. 2

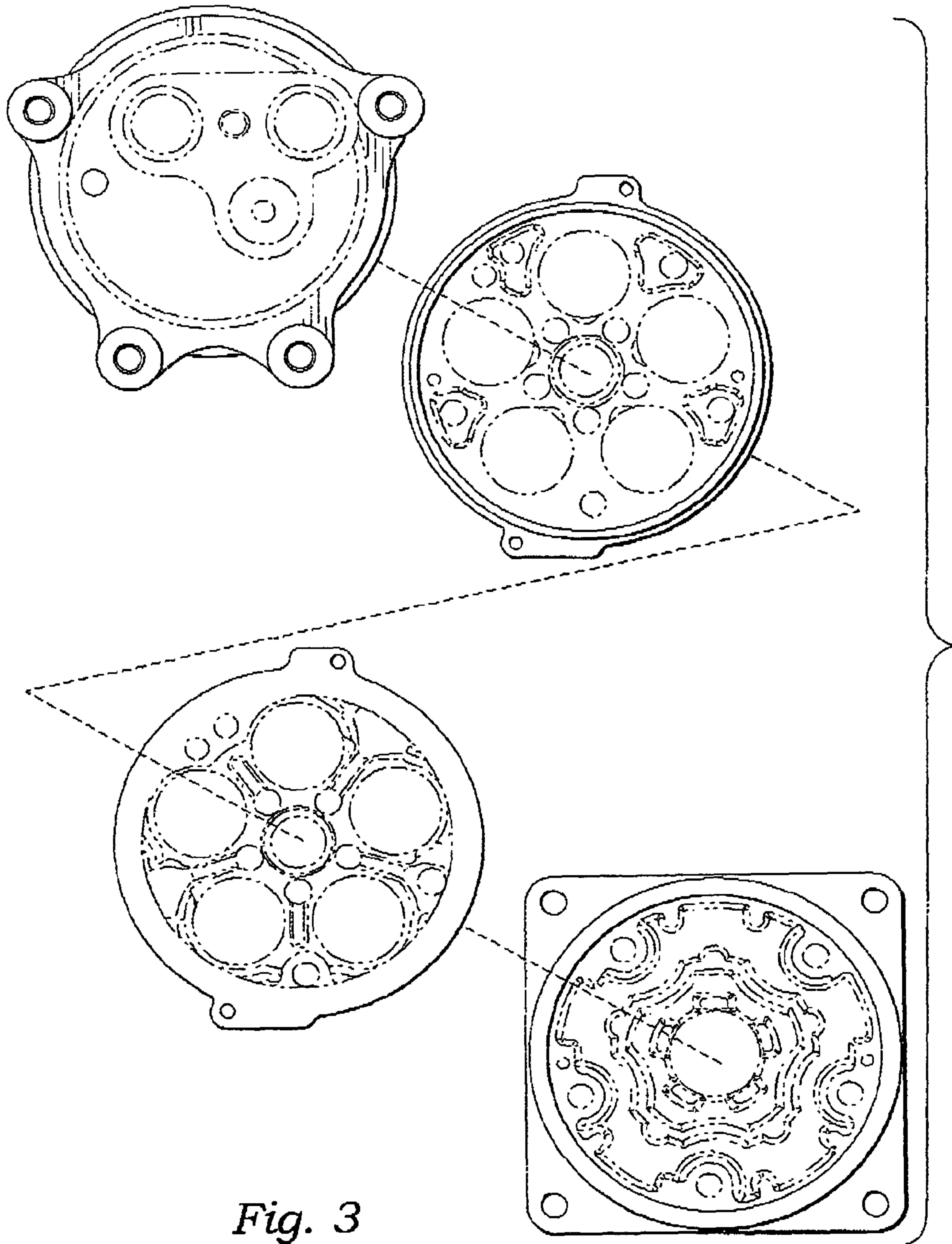

Fig. 3

