

US00D621178S

(12) **United States Design Patent**
Palmby

(10) **Patent No.:** **US D621,178 S**

(45) **Date of Patent:** **** Aug. 10, 2010**

(54) **COMBINATION CUP AND REMOTE CONTROL HOLDER**

(76) **Inventor:** **Chris Palmby**, 1107 Carolina St., Bellingham, WA (US) 98229

(**) **Term:** **14 Years**

(21) **Appl. No.:** **29/354,179**

(22) **Filed:** **Jan. 20, 2010**

(51) **LOC (9) Cl.** **06-04**

(52) **U.S. Cl.** **D6/449**

(58) **Field of Classification Search** D6/449,
D6/478, 396, 421, 335, 480, 509, 362, 406.1,
D6/406.3, 406.6, 408, 418, 429, 430, 437,
D6/451, 454, 467, 473, 477, 479, 484; D20/10,
D20/43; D16/225; 211/13.1, 42, 43, 49.1,
211/59.3, 70.1, 134, 135; 108/59, 65, 115,
108/186, 190

See application file for complete search history.

(56) **References Cited**

U.S. PATENT DOCUMENTS

D143,599 S *	1/1946	Karf	D6/478
D220,997 S *	6/1971	Svezia	D6/335
D248,437 S *	7/1978	Robinson	D6/421
D385,306 S *	10/1997	Collins	D20/10
D423,825 S *	5/2000	Alcala et al.	D6/478
D488,005 S *	4/2004	Feng	D6/480

D529,311 S *	10/2006	Waldron	D6/449
D552,879 S *	10/2007	Phan	D6/449
D581,701 S *	12/2008	Grubb	D6/449
D617,361 S *	6/2010	Simonsen et al.	D16/225

FOREIGN PATENT DOCUMENTS

DE	10204216 A1 *	8/2003
GB	2397515 A *	7/2004

* cited by examiner

Primary Examiner—Susan M Lee

Assistant Examiner—Sydney R Buffalow

(74) *Attorney, Agent, or Firm*—Dwayne E. Rogge; Hughes Law Firm, PLLC

(57) **CLAIM**

The ornamental design for a combination cup and remote control holder, as shown.

DESCRIPTION

FIG. 1 is an isometric, perspective view thereof,

FIG. 2 is a top view thereof,

FIG. 3 is a left side view thereof,

FIG. 4 is a right side view thereof,

FIG. 5 is a rear view thereof,

FIG. 6 is a front view thereof; and,

FIG. 7 is a bottom view thereof.

1 Claim, 7 Drawing Sheets

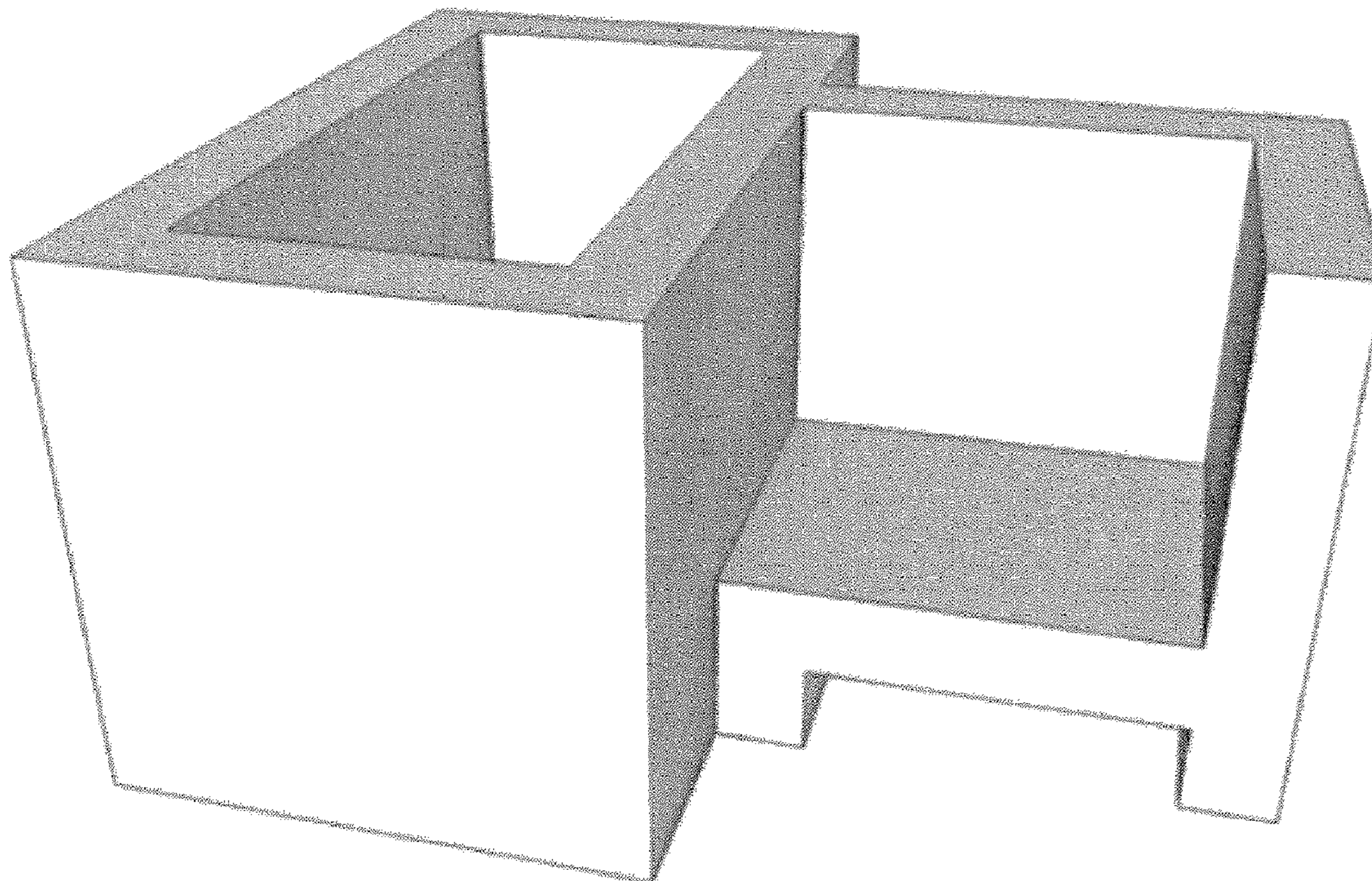

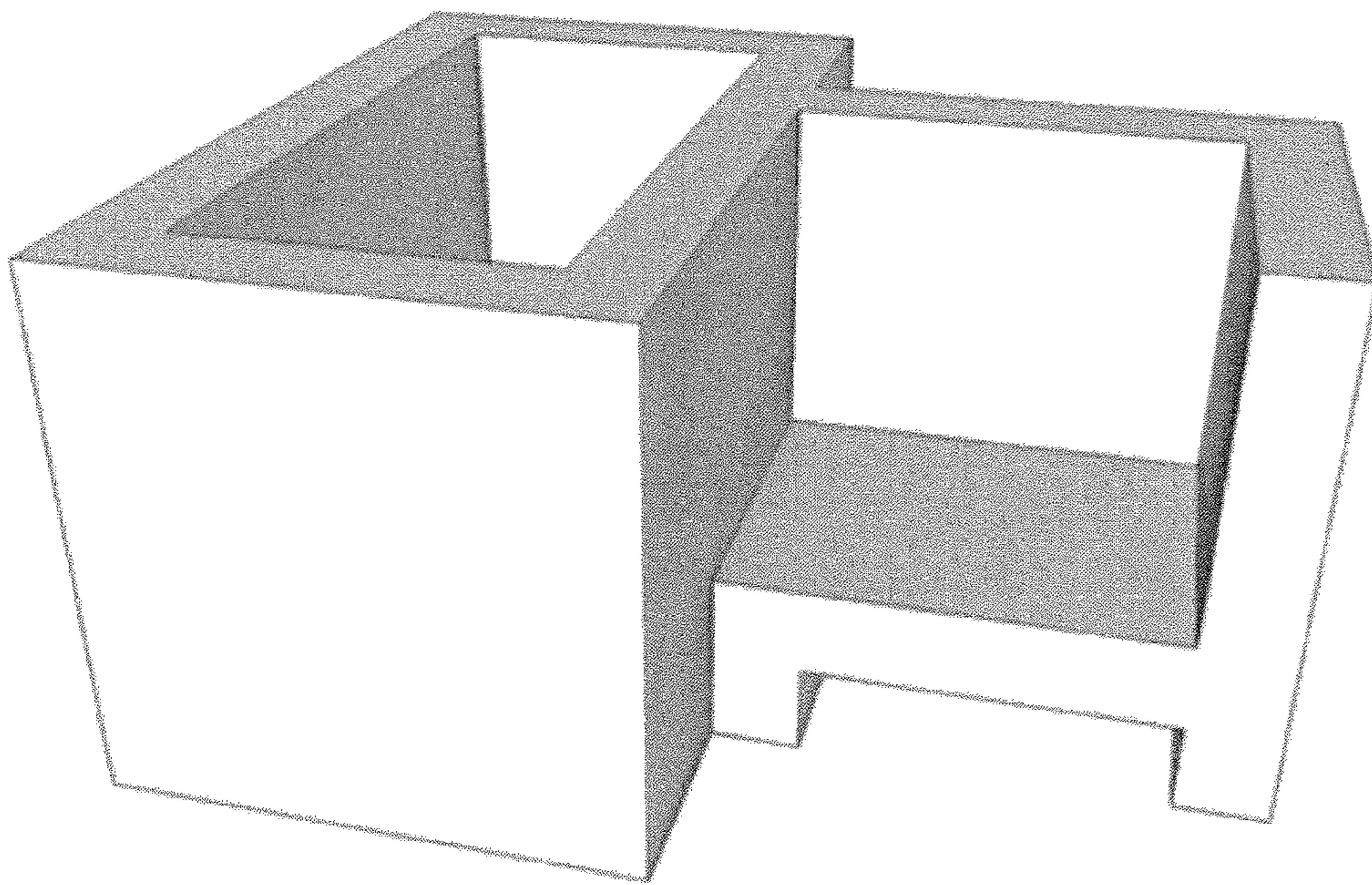

Fig. 1

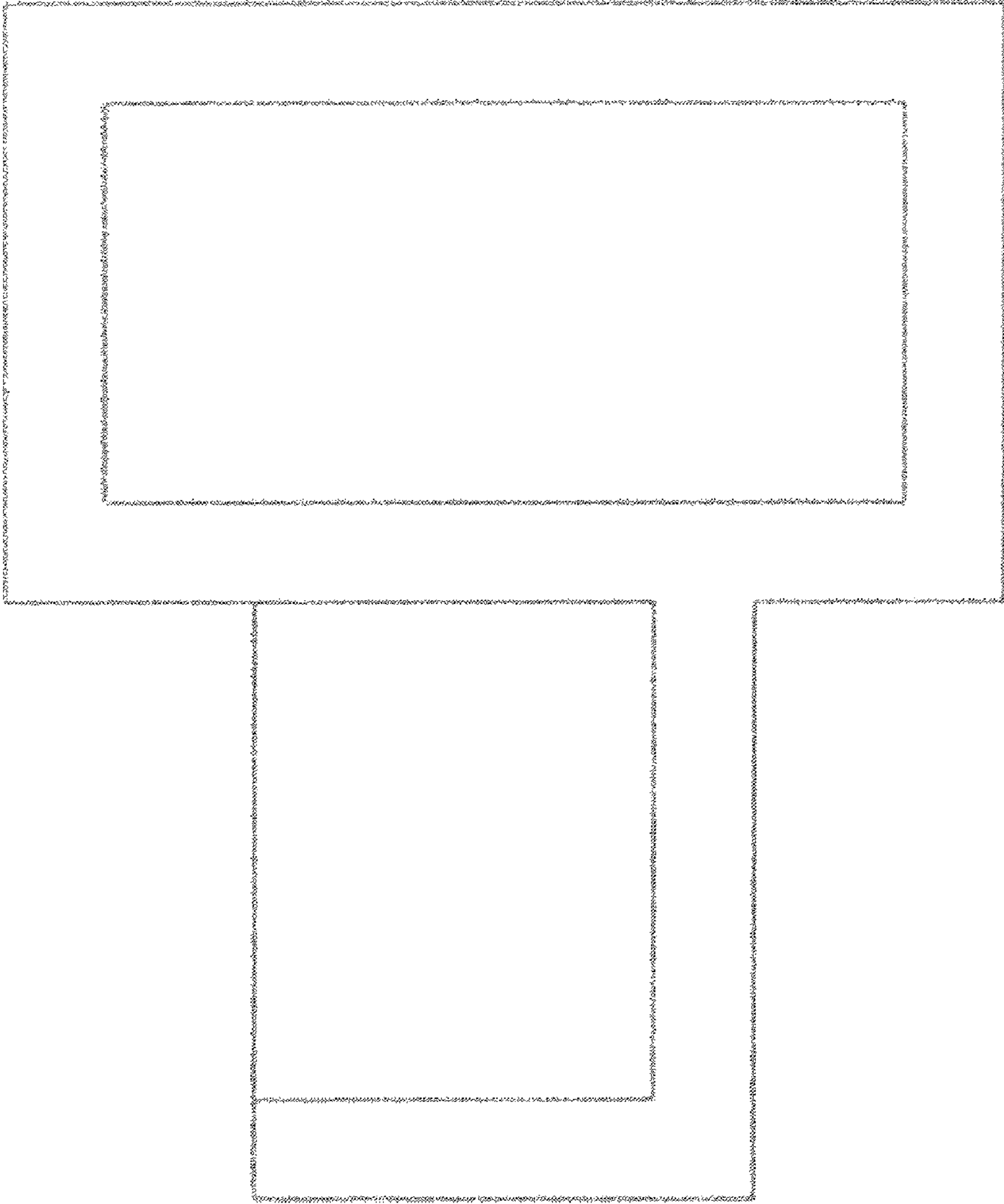

Fig. 2

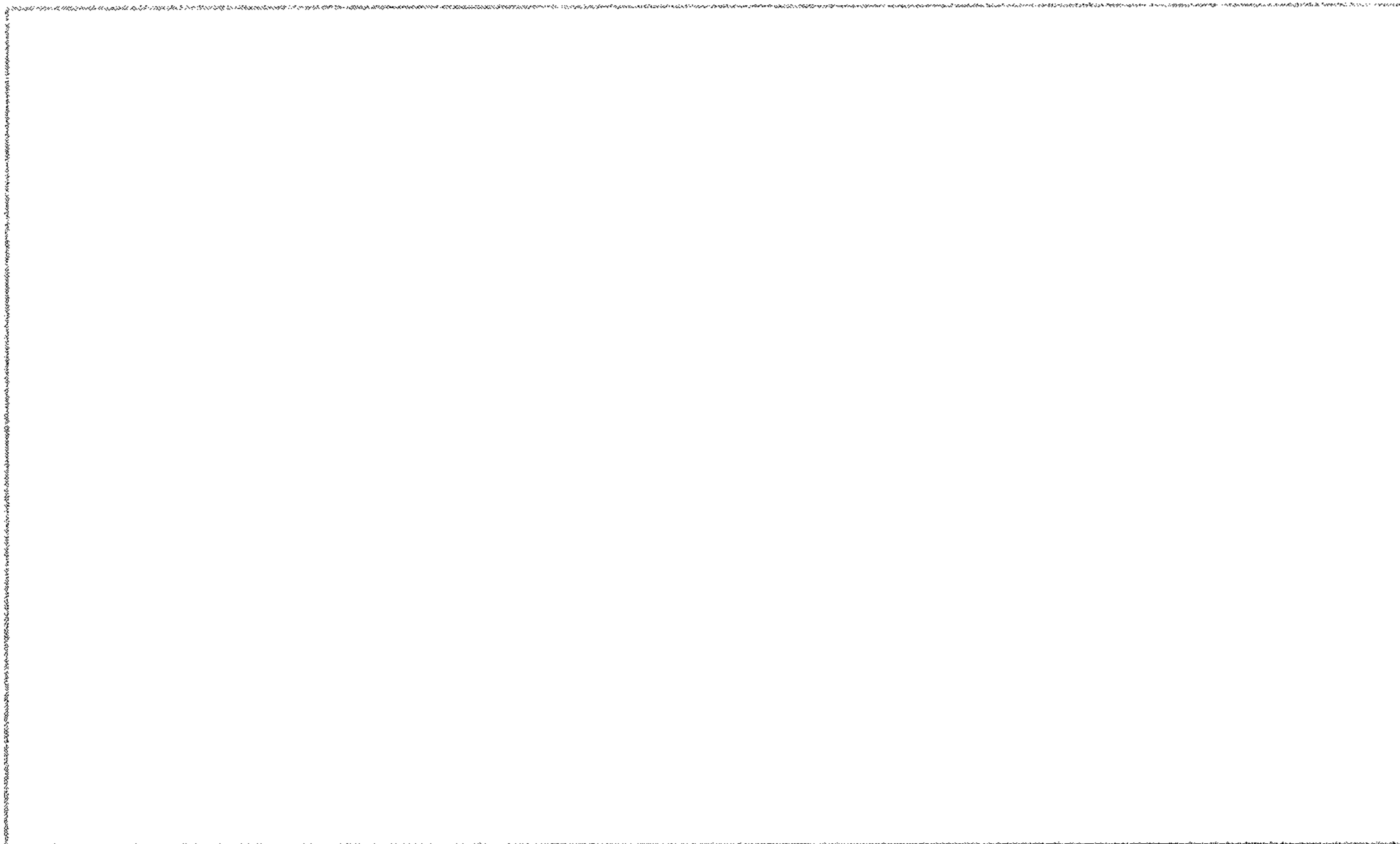

Fig. 3

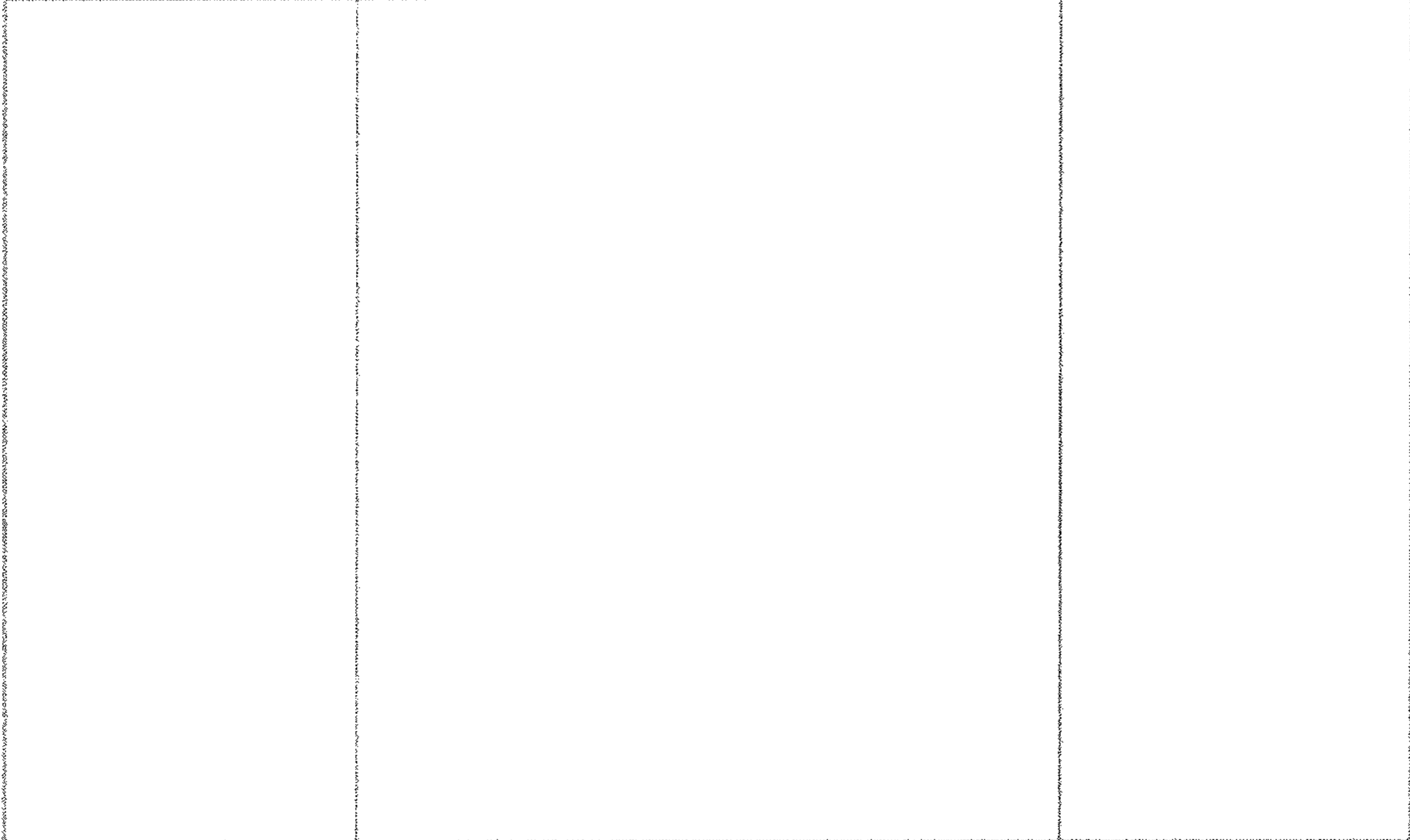

Fig. 4

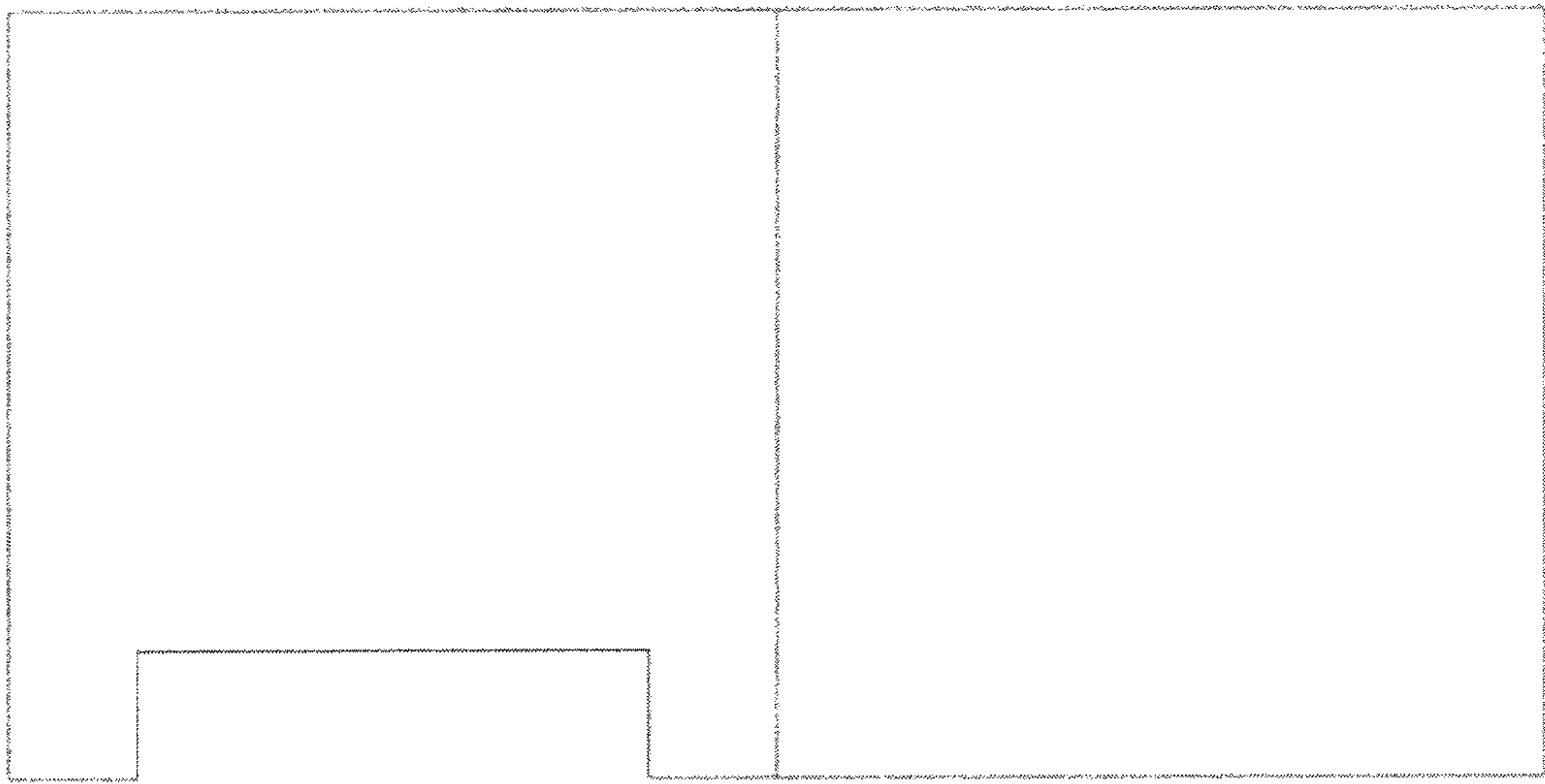

Fig. 5

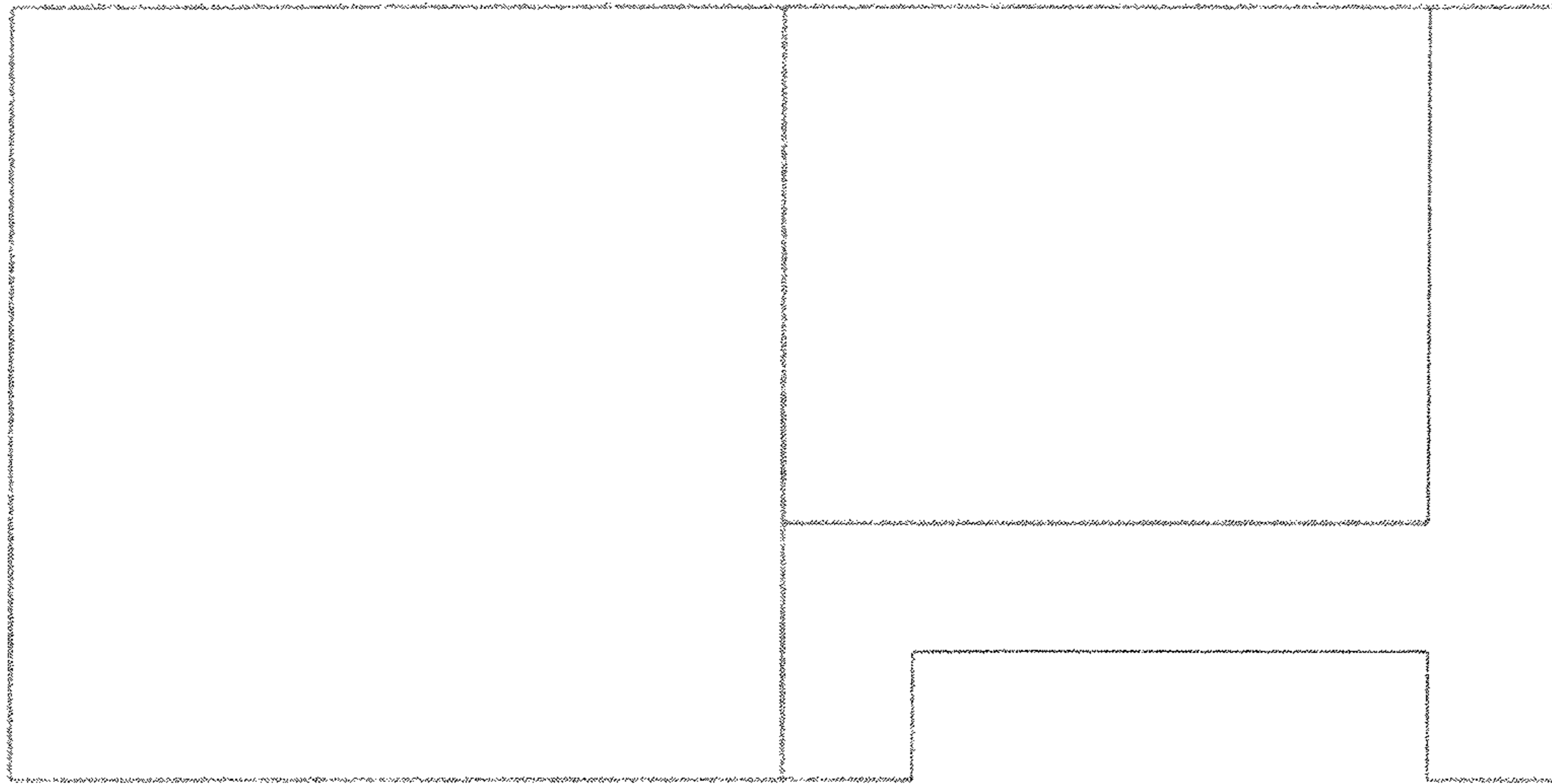

Fig. 6

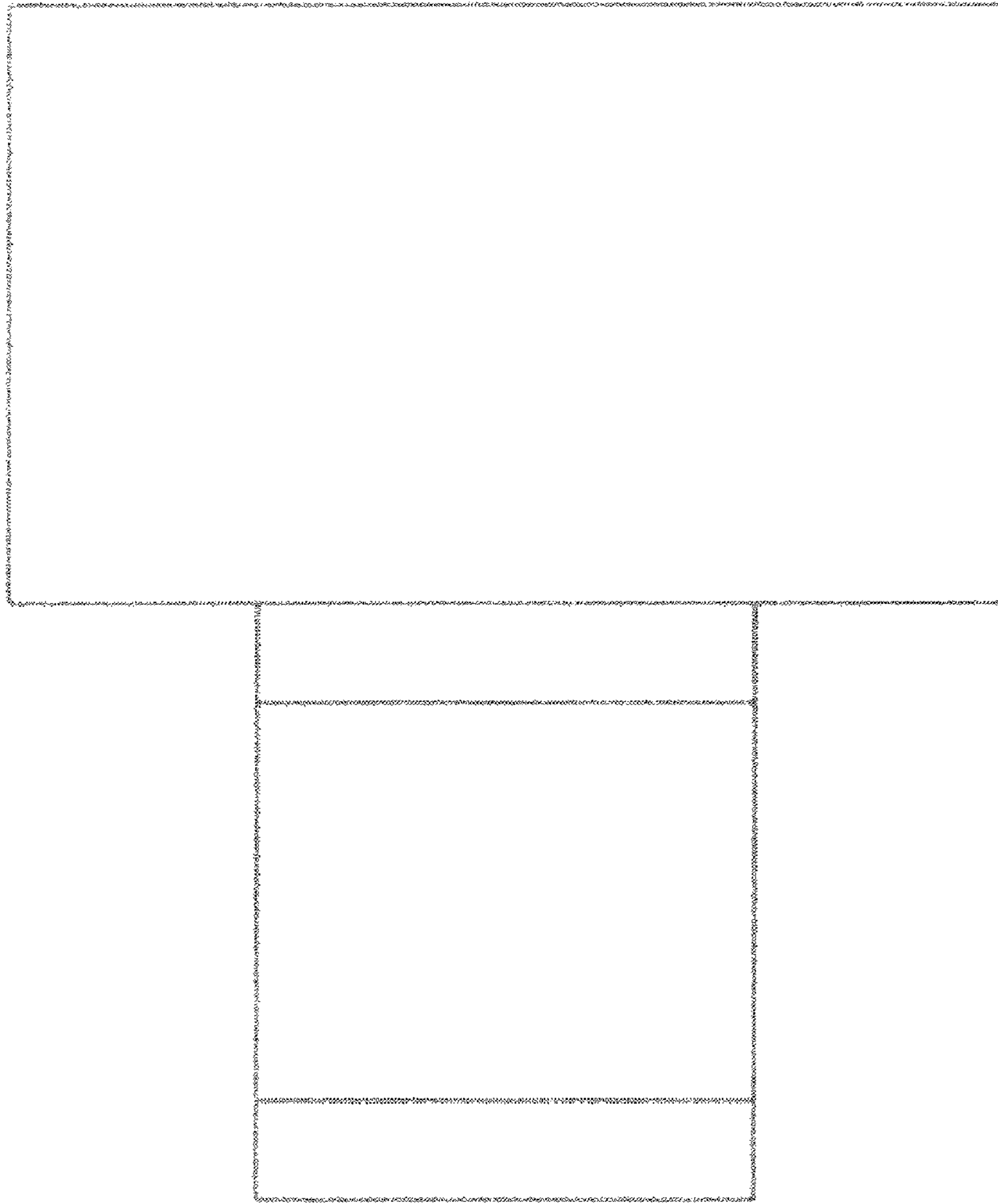

Fig. 7