



US00D618618S

(12) **United States Design Patent**
Lee et al.

(10) **Patent No.:** **US D618,618 S**
(45) **Date of Patent:** **** Jun. 29, 2010**

(54) **IN-CAR BATTERY CHARGER**

(75) Inventors: **Shawn Lee**, Shenzhen (CN); **Marcus Smith**, Cambridge (GB); **Jeremy David Osborne Ranger**, Farringdon (GB)

(73) Assignee: **Powertraveller Limited**

(**) Term: **14 Years**

(21) Appl. No.: **29/333,667**

(22) Filed: **Mar. 12, 2009**

(51) **LOC (9) Cl.** **13-03**

(52) **U.S. Cl.** **D13/144; D13/108; D13/110**

(58) **Field of Classification Search** D13/102, D13/107-110, 118-119, 133, 144, 184; D14/155, D14/251, 253, 432, 434; 320/107-115; 439/300, 439/620, 638, 668-669, 675, 825; 363/146
See application file for complete search history.

(56) **References Cited**

U.S. PATENT DOCUMENTS

D300,626 S *	4/1989	Crutcher et al.	D13/144
D401,222 S *	11/1998	LeBlanc	D13/144
D474,448 S *	5/2003	Bosch	D13/144
D481,355 S *	10/2003	Lee	D13/108
D492,249 S *	6/2004	Suomalainen et al.	D13/108
D505,389 S *	5/2005	Chang	D13/107
D525,938 S *	8/2006	Seil et al.	D13/144
D545,274 S *	6/2007	Dong	D13/144
D554,585 S *	11/2007	Nazar	D13/110

D557,658 S *	12/2007	Ledbetter et al.	D13/108
D563,873 S *	3/2008	Chen et al.	D13/144
D585,375 S *	1/2009	Andre et al.	D13/133
D592,594 S *	5/2009	Stiff et al.	D13/110
D604,699 S *	11/2009	Yamamoto	D13/144

* cited by examiner

Primary Examiner—Rosemary K Tarca

(74) *Attorney, Agent, or Firm*—Michael D. Eisenberg

(57) **CLAIM**

The ornamental design for a in-car battery charger, as shown and described.

DESCRIPTION

FIG. 1 is a right side view of a in-car battery charger showing our new design;

FIG. 2 is a left side view of the in-car battery charger;

FIG. 3 is a bottom view of the in-car battery charger;

FIG. 4 is a top view of the in-car battery charger;

FIG. 5 is a front view of the in-car battery charger

FIG. 6 is a back view of the in-car battery charger;

FIG. 7 is a perspective view of the in-car battery charger; and,

FIG. 8 is another perspective view of the in-car battery charger.

The broken lines shown in the drawings are included for the purpose of illustrating environmental structure and form no part of the claimed design.

1 Claim, 4 Drawing Sheets

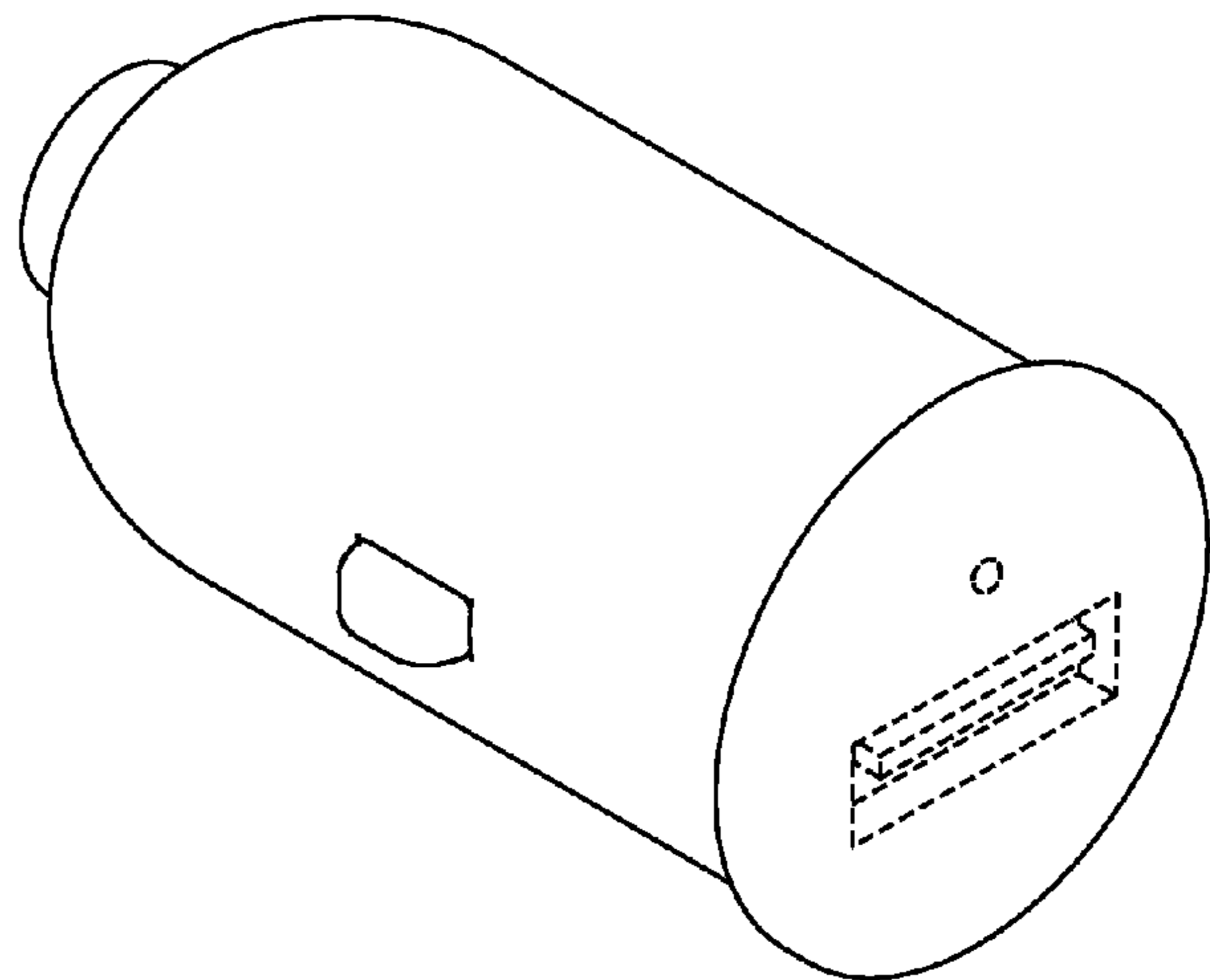
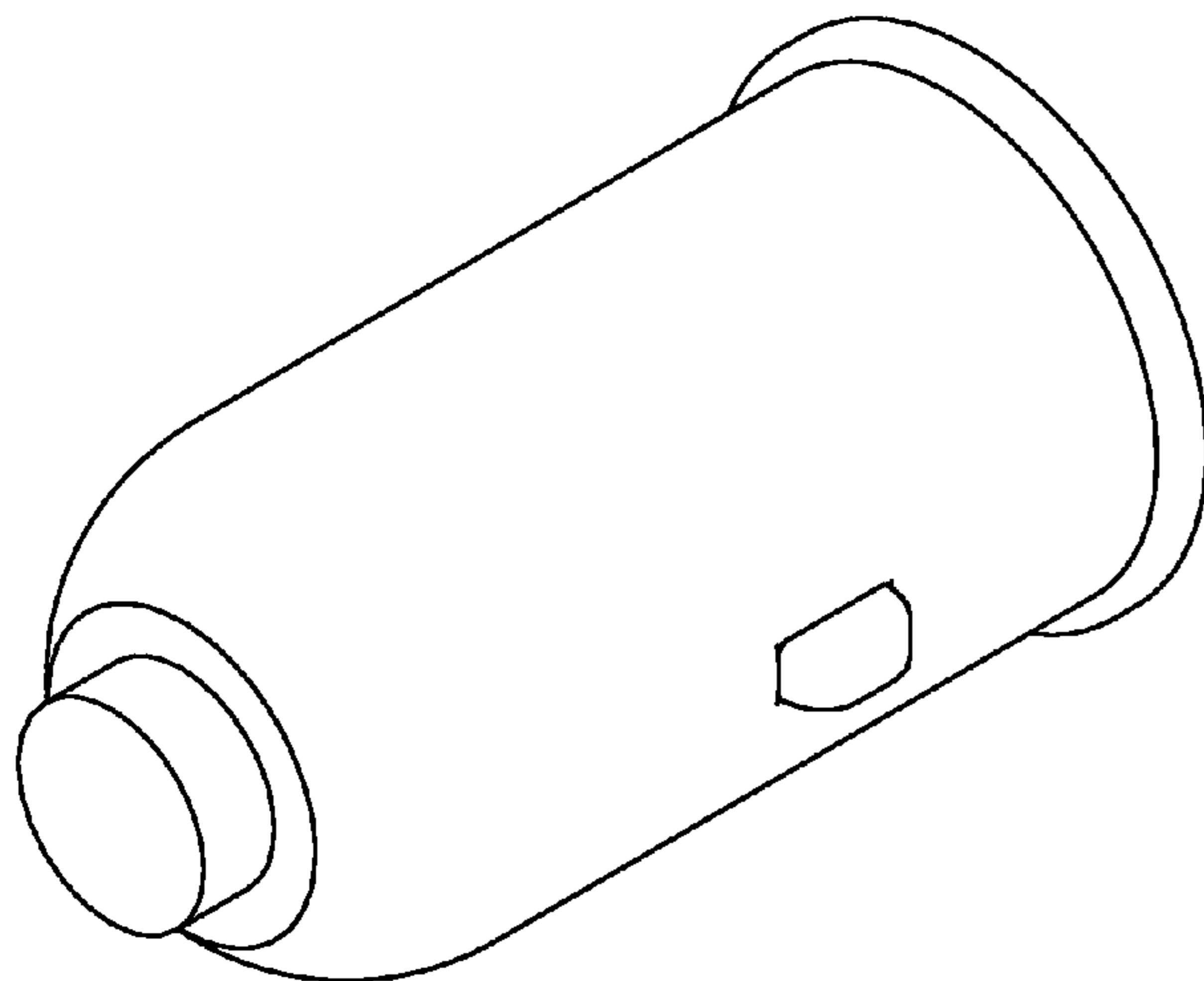

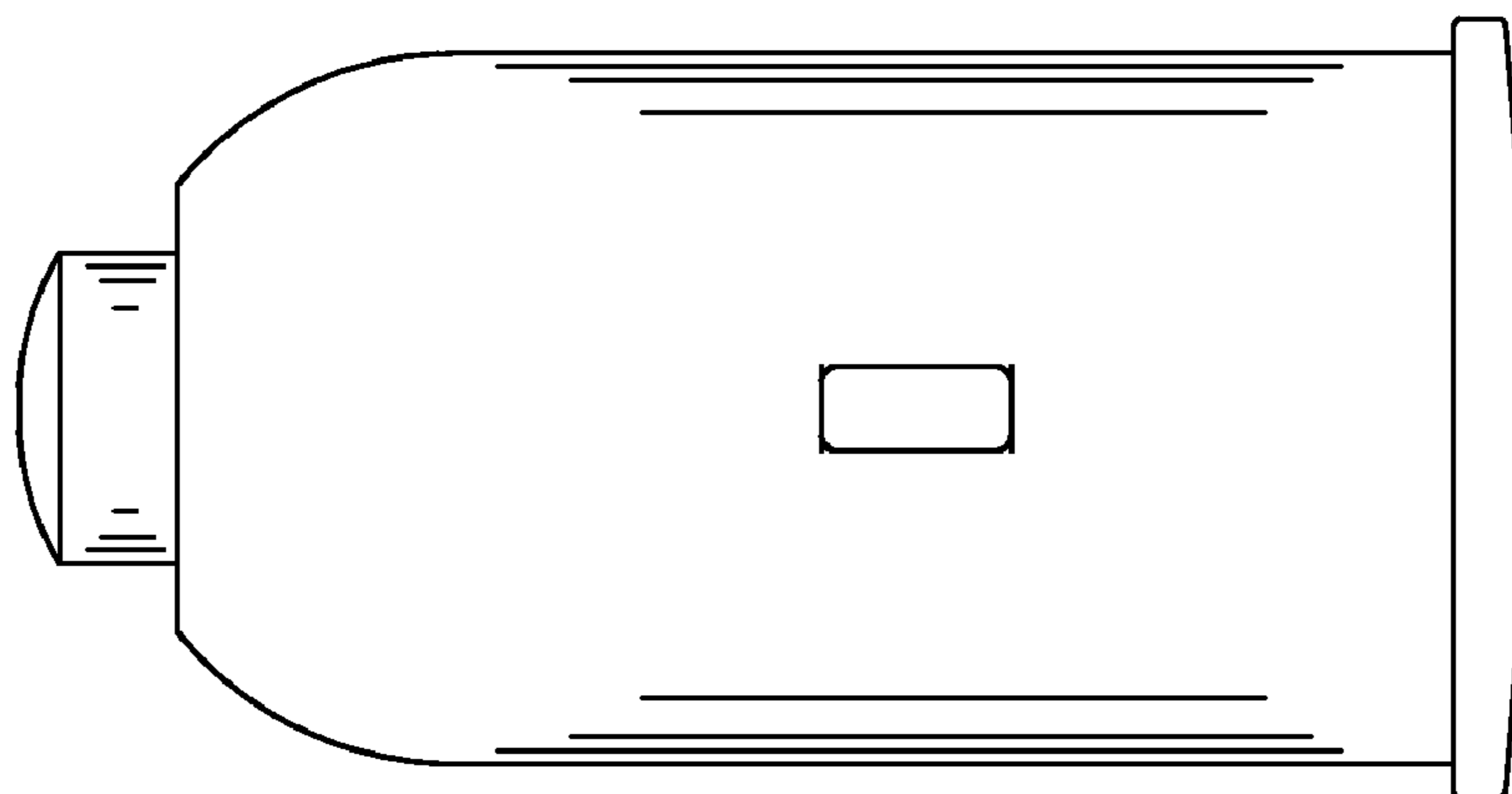

FIG. 1

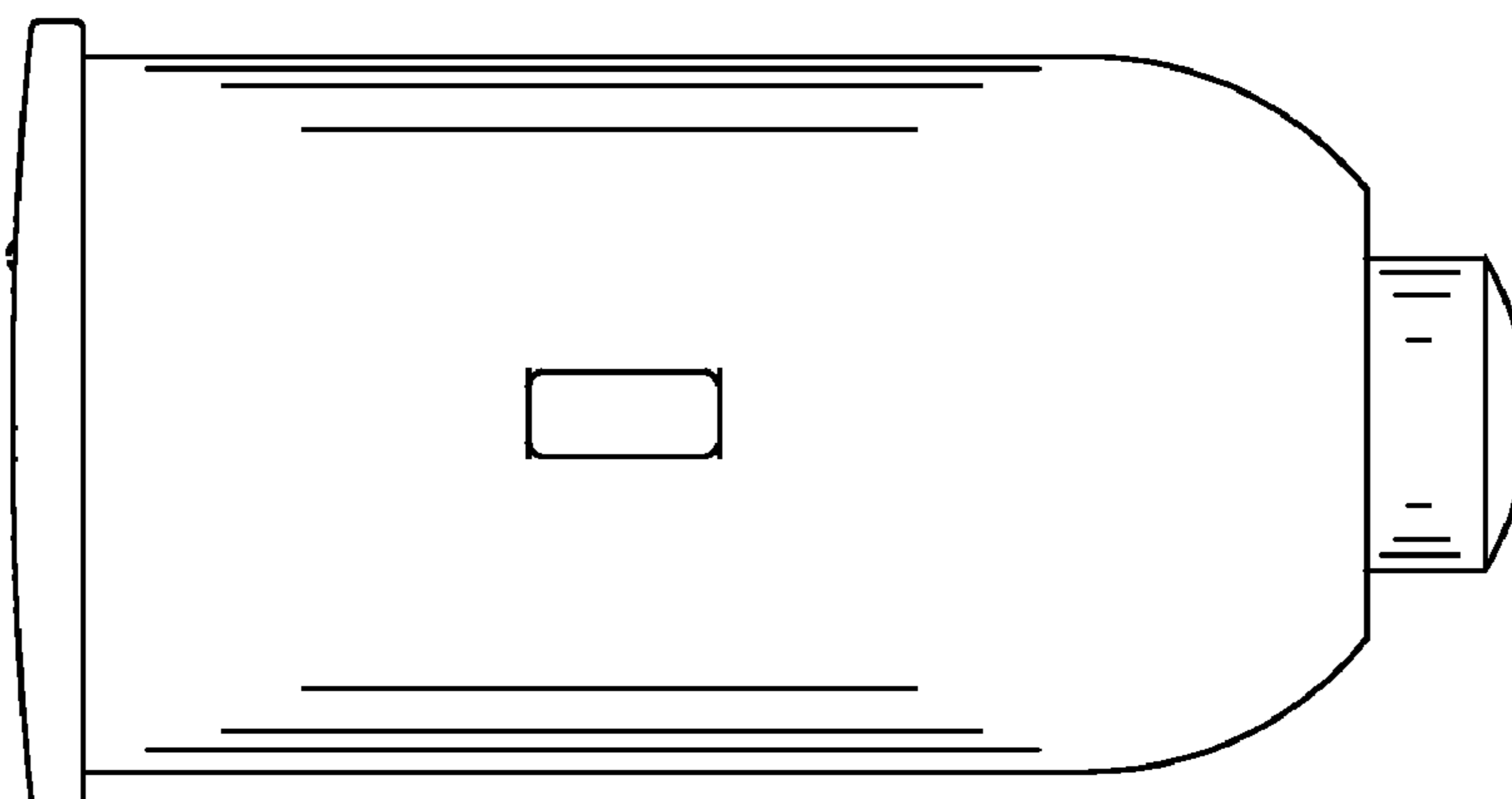

FIG. 2

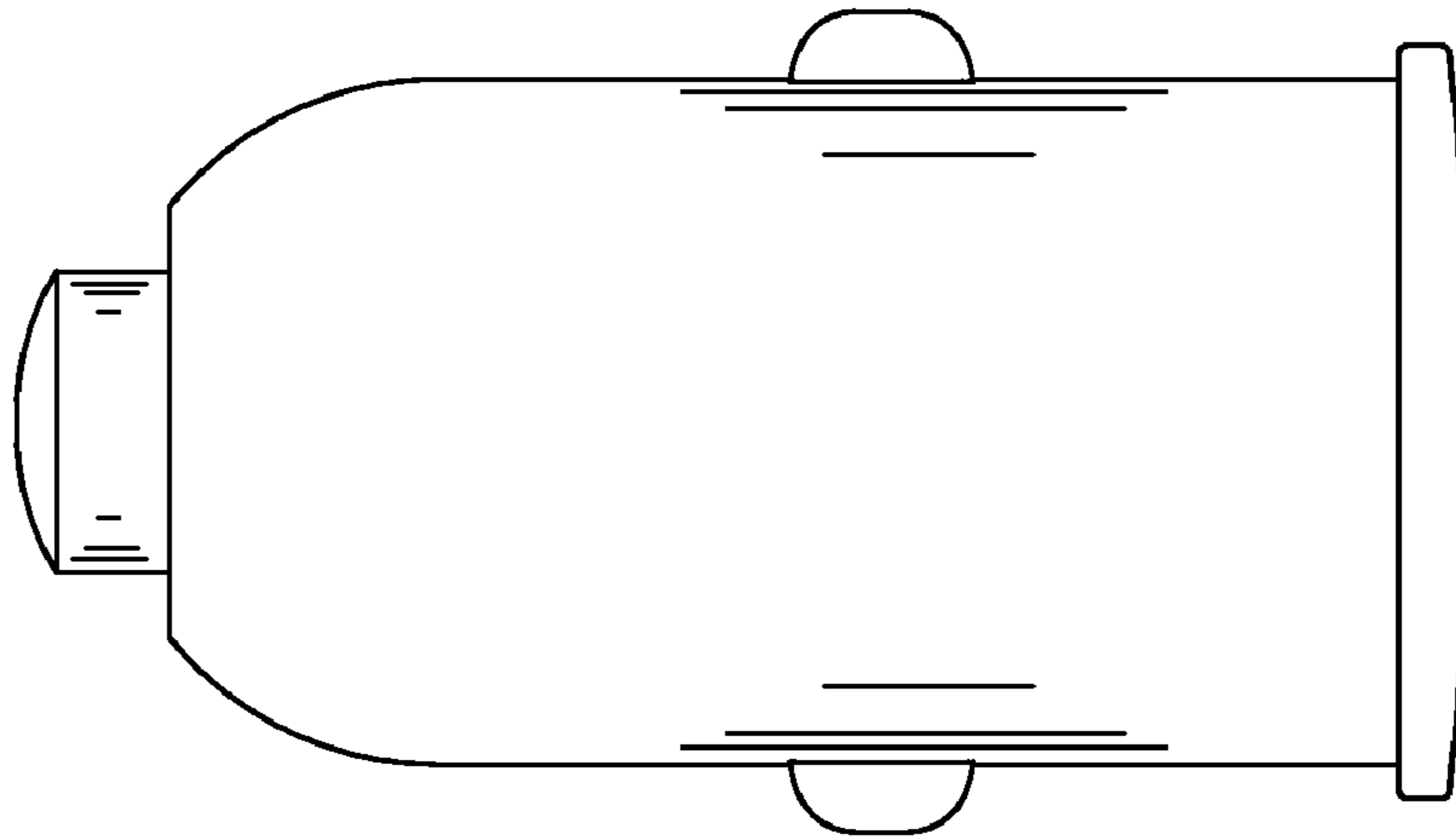

FIG. 3

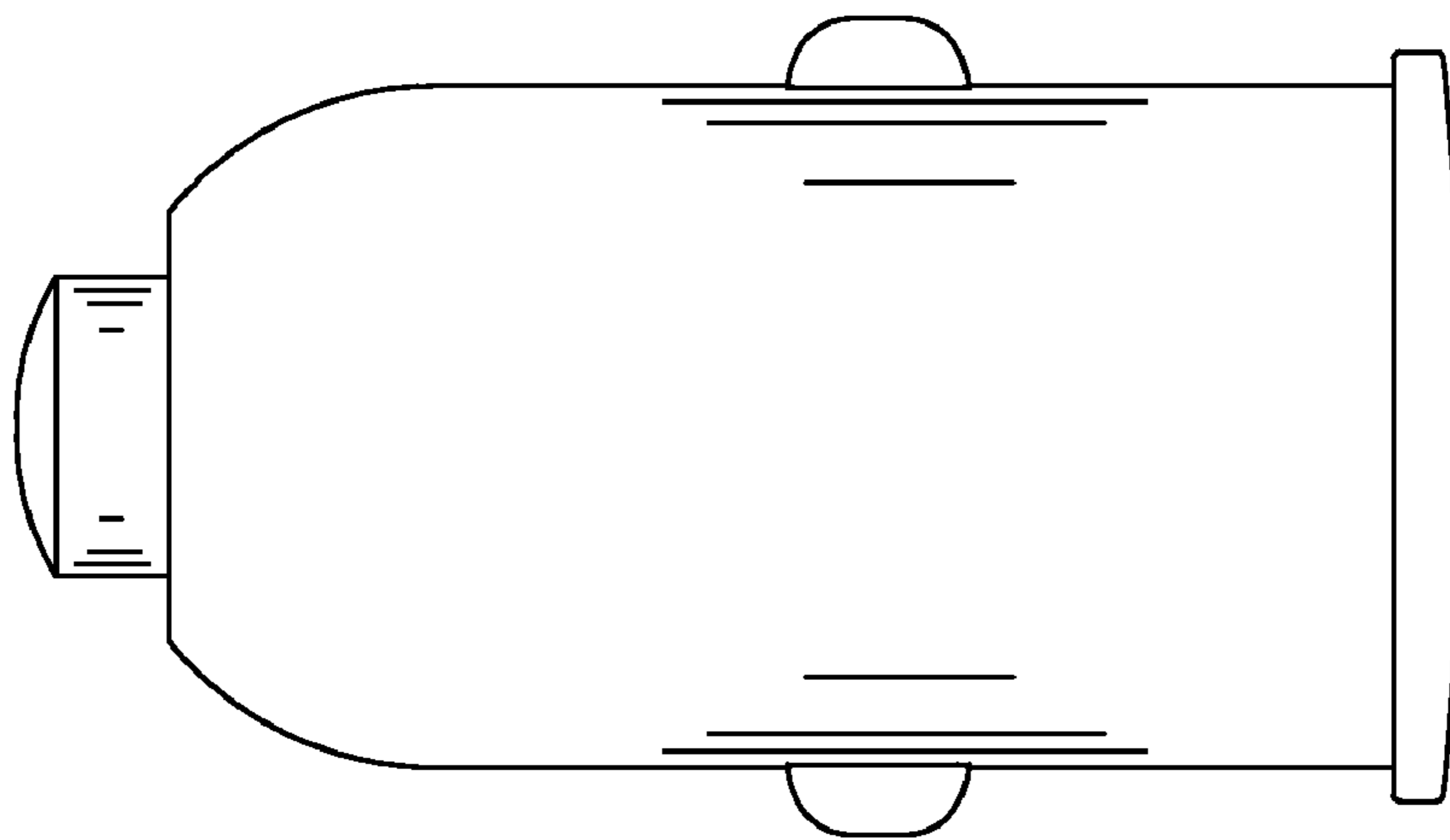

FIG. 4

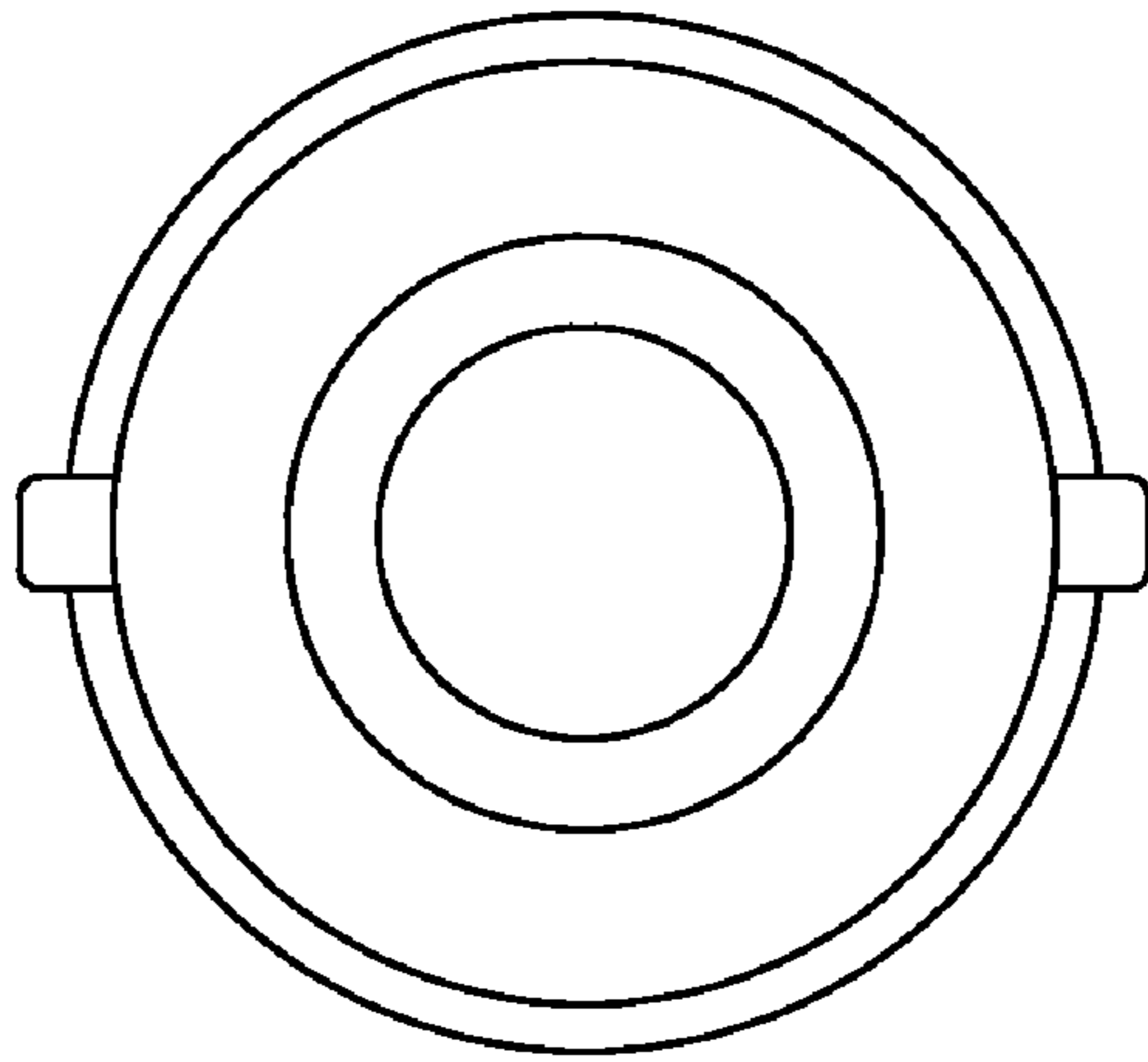

FIG. 5

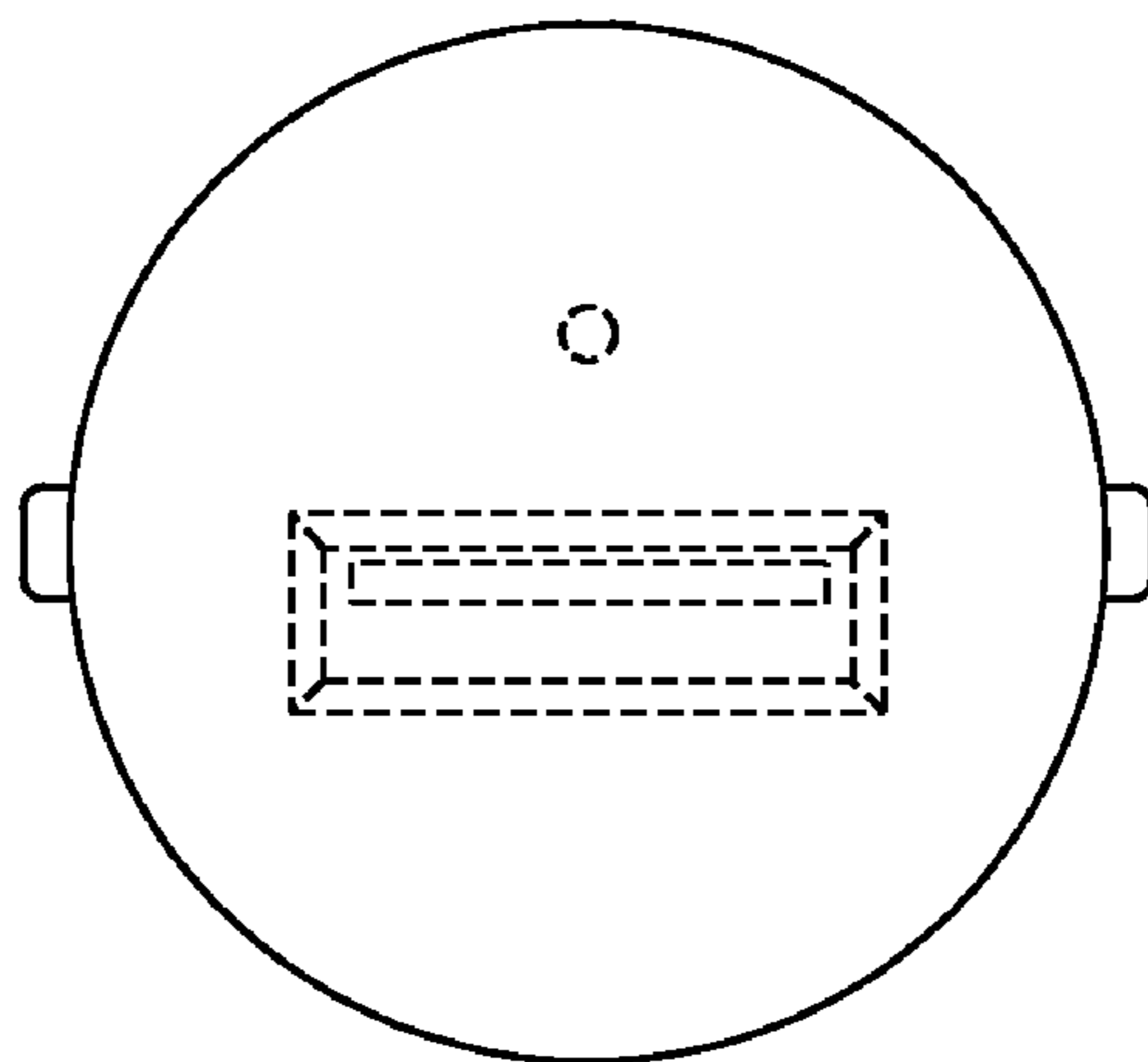

FIG. 6

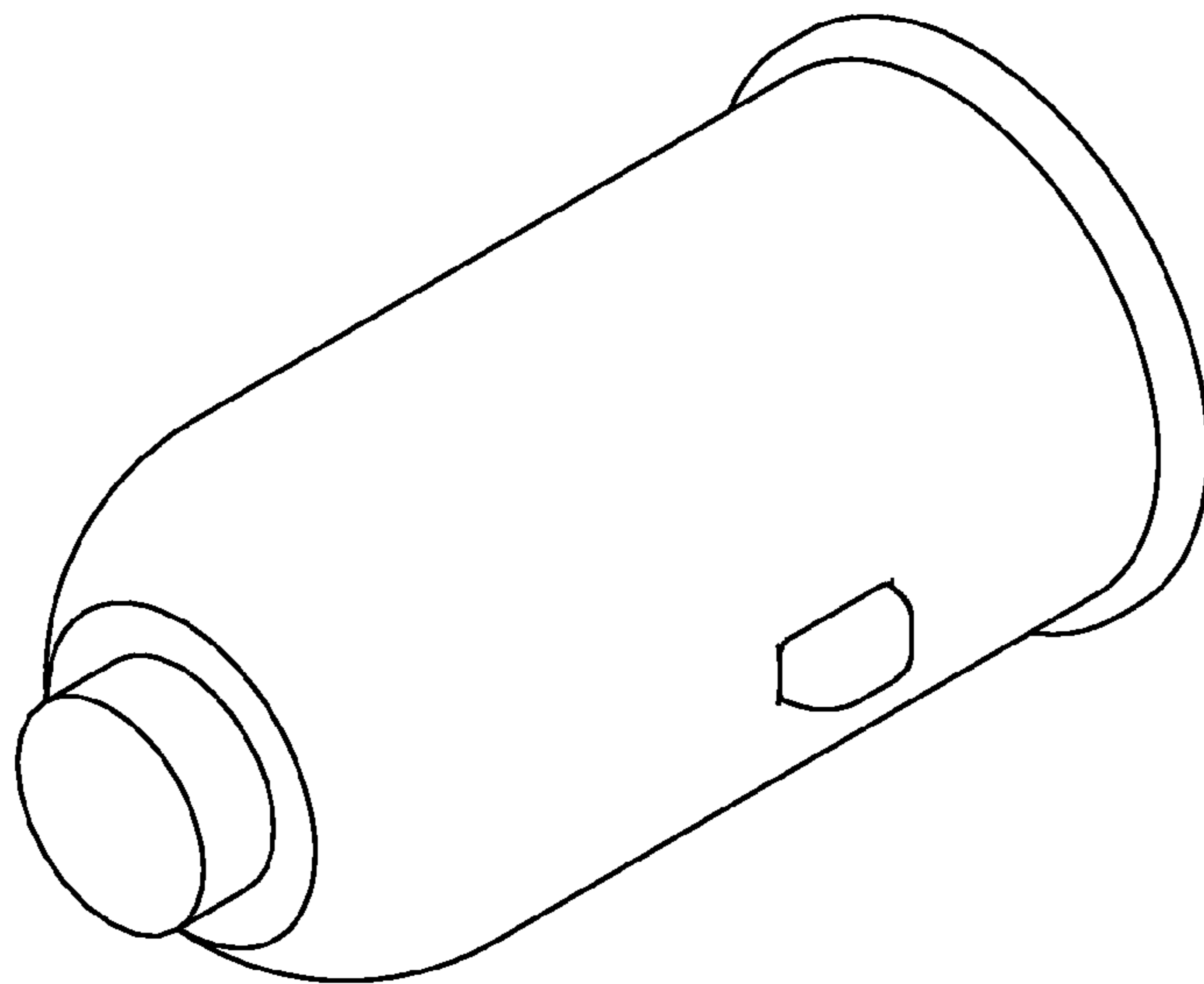

FIG. 7

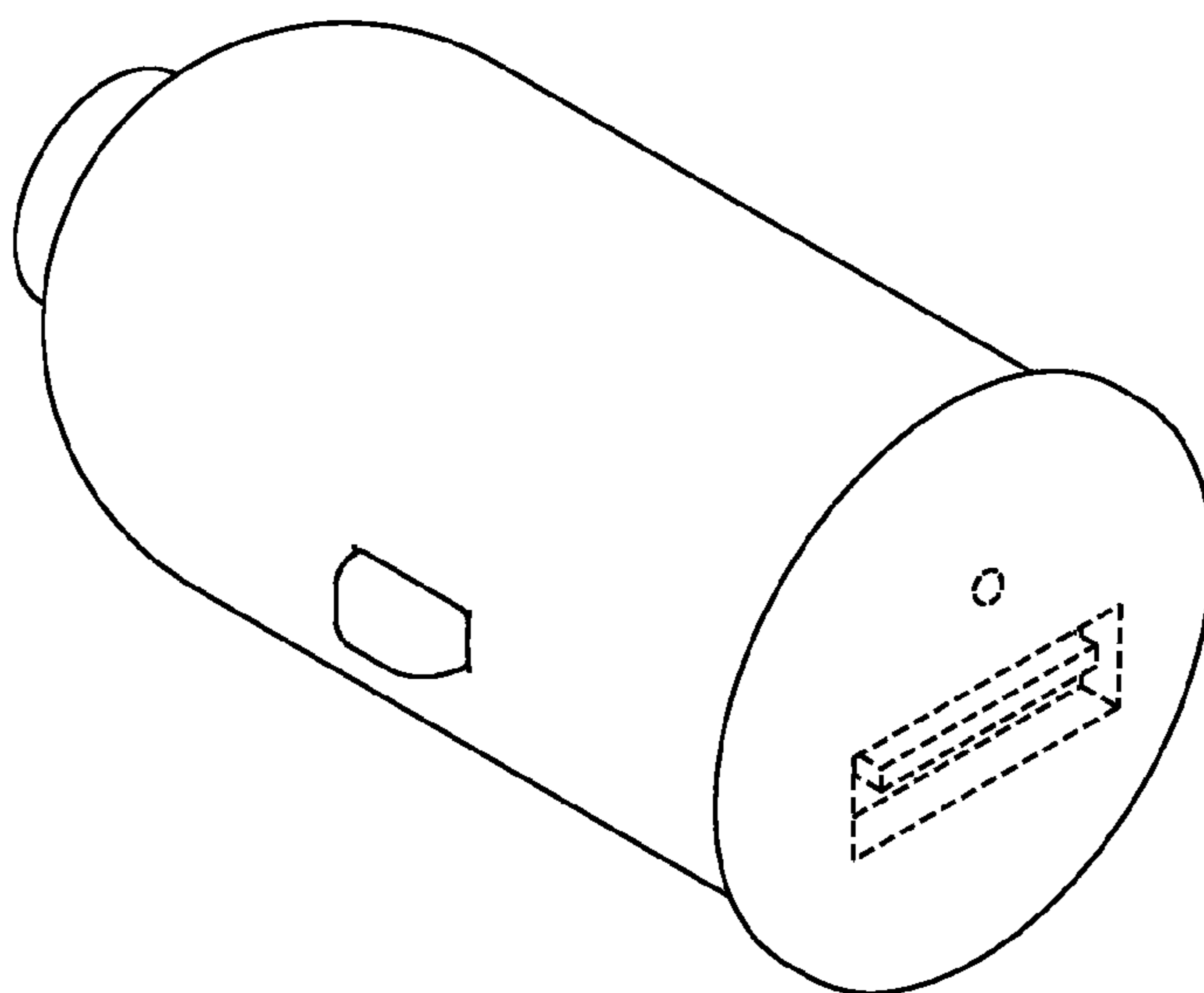

FIG. 8