



US00D616368S

(12) **United States Design Patent**  
**Keogh**

(10) **Patent No.:** **US D616,368 S**  
(45) **Date of Patent:** **\*\* May 25, 2010**

(54) **ELECTRICAL CONNECTOR OF AN  
ULTRAVIOLET LAMP BULB**

(75) Inventor: **Patrick Keogh**, Berkshire (GB)

(73) Assignee: **Nordson Corporation**, Westlake, OH  
(US)

(\*\*) Term: **14 Years**

(21) Appl. No.: **29/333,083**

(22) Filed: **Mar. 3, 2009**

(51) **LOC (9) Cl.** ..... **13-03**

(52) **U.S. Cl.** ..... **D13/134**

(58) **Field of Classification Search** ..... D13/133–136,  
D13/154, 184, 199; D26/24, 113; 313/318.01–318.05,  
313/318.12; 362/260, 581; 439/168, 220,  
439/226, 232, 280, 336, 419, 602  
See application file for complete search history.

(56) **References Cited**

**U.S. PATENT DOCUMENTS**

- 4,687,965 A \* 8/1987 Sanders et al. .... 313/318.05
- 5,973,331 A \* 10/1999 Stevens et al. .... 250/492.1
- D436,078 S \* 1/2001 Korte ..... D13/134
- 6,946,782 B1 9/2005 Beying et al.
- D551,624 S \* 9/2007 Ciancanelli et al. .... D13/136
- D553,569 S \* 10/2007 Ciancanelli et al. .... D13/136
- D575,742 S \* 8/2008 Scherer et al. .... D13/134

- D583,760 S \* 12/2008 Ohmori ..... D13/134
- D591,681 S \* 5/2009 Zayas ..... D13/139.1
- 2009/0317998 A1 \* 12/2009 Yu ..... 439/226

\* cited by examiner

*Primary Examiner*—Daniel D Bui

*Assistant Examiner*—Thomas J Johannes

(74) *Attorney, Agent, or Firm*—Wood, Herron & Evans,  
L.L.P.

(57) **CLAIM**

The ornamental design for an electrical connector of an ultra-  
violet lamp bulb, as shown and described.

**DESCRIPTION**

FIG. 1 is a perspective view of an electrical connector of an  
ultraviolet lamp bulb showing my new design.

FIG. 2 is a front view thereof.

FIG. 3 is a rear view thereof.

FIG. 4 is a left side view thereof.

FIG. 5 is a right side view thereof.

FIG. 6 is a top view thereof; and,

FIG. 7 is a bottom view thereof.

The broken line portion of the figure drawings is included to  
show unclaimed subject matter only and forms no part of the  
claimed design.

**1 Claim, 4 Drawing Sheets**

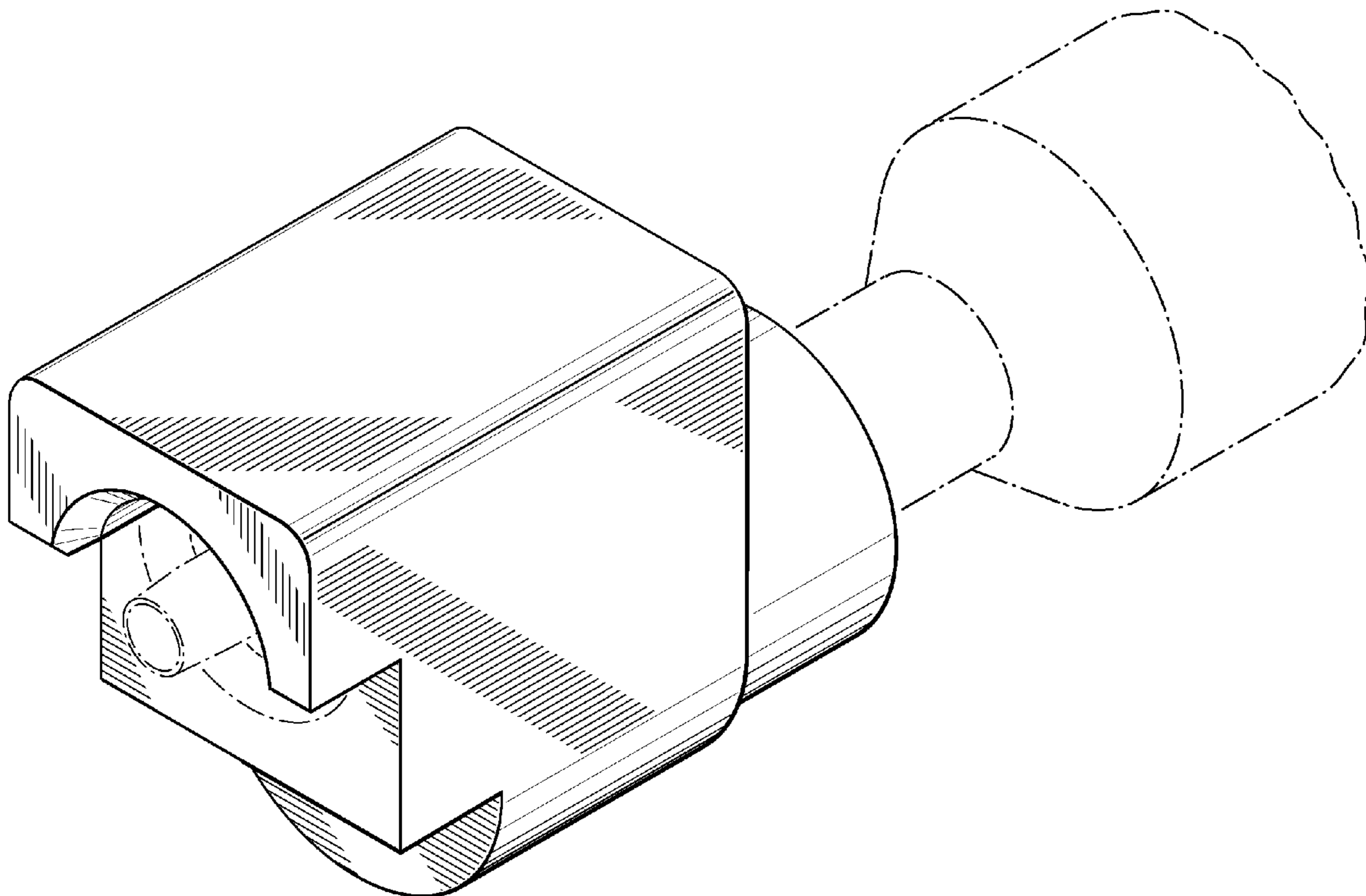

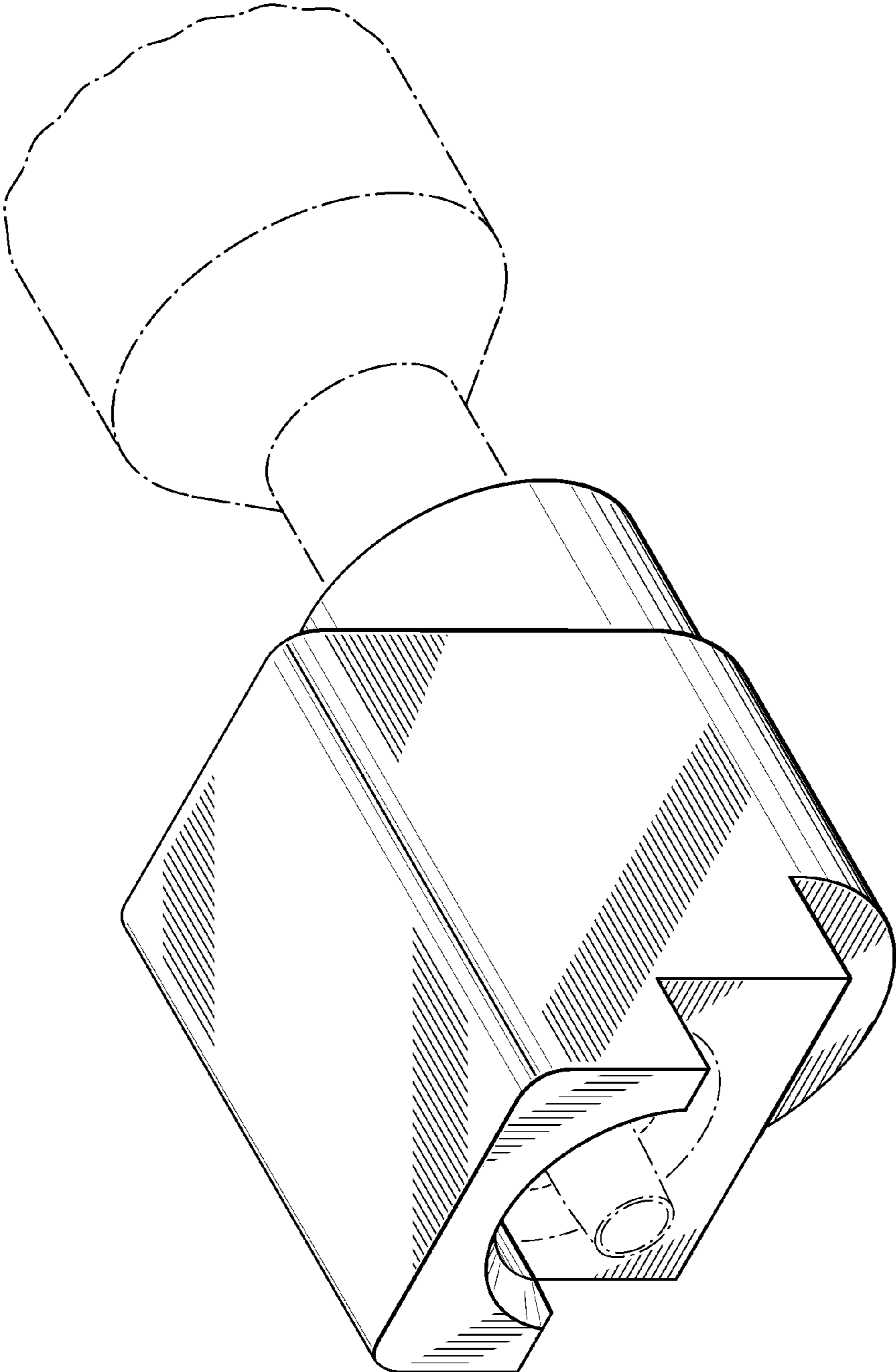

FIG. 1

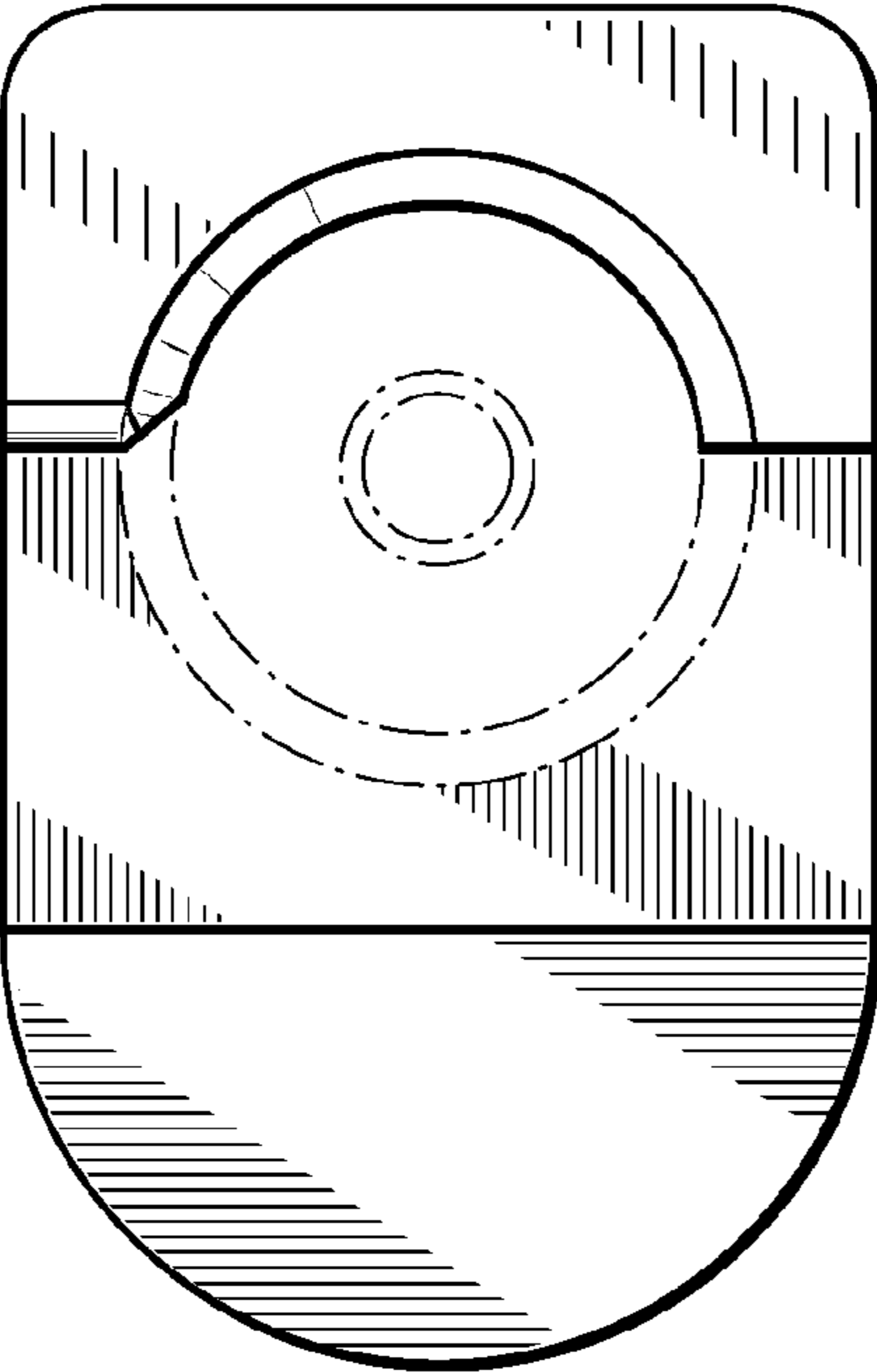

FIG. 2

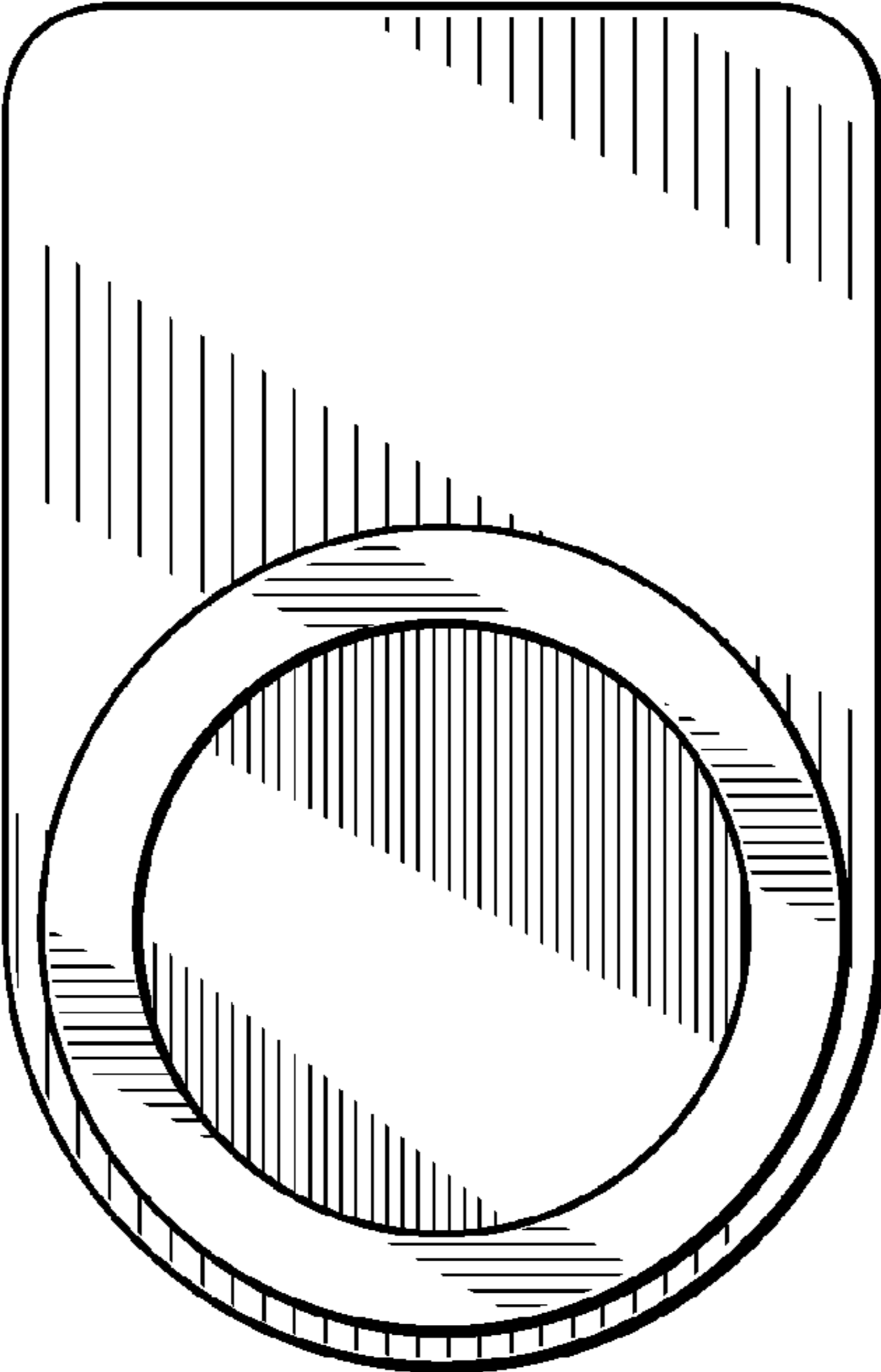

FIG. 3



FIG. 4

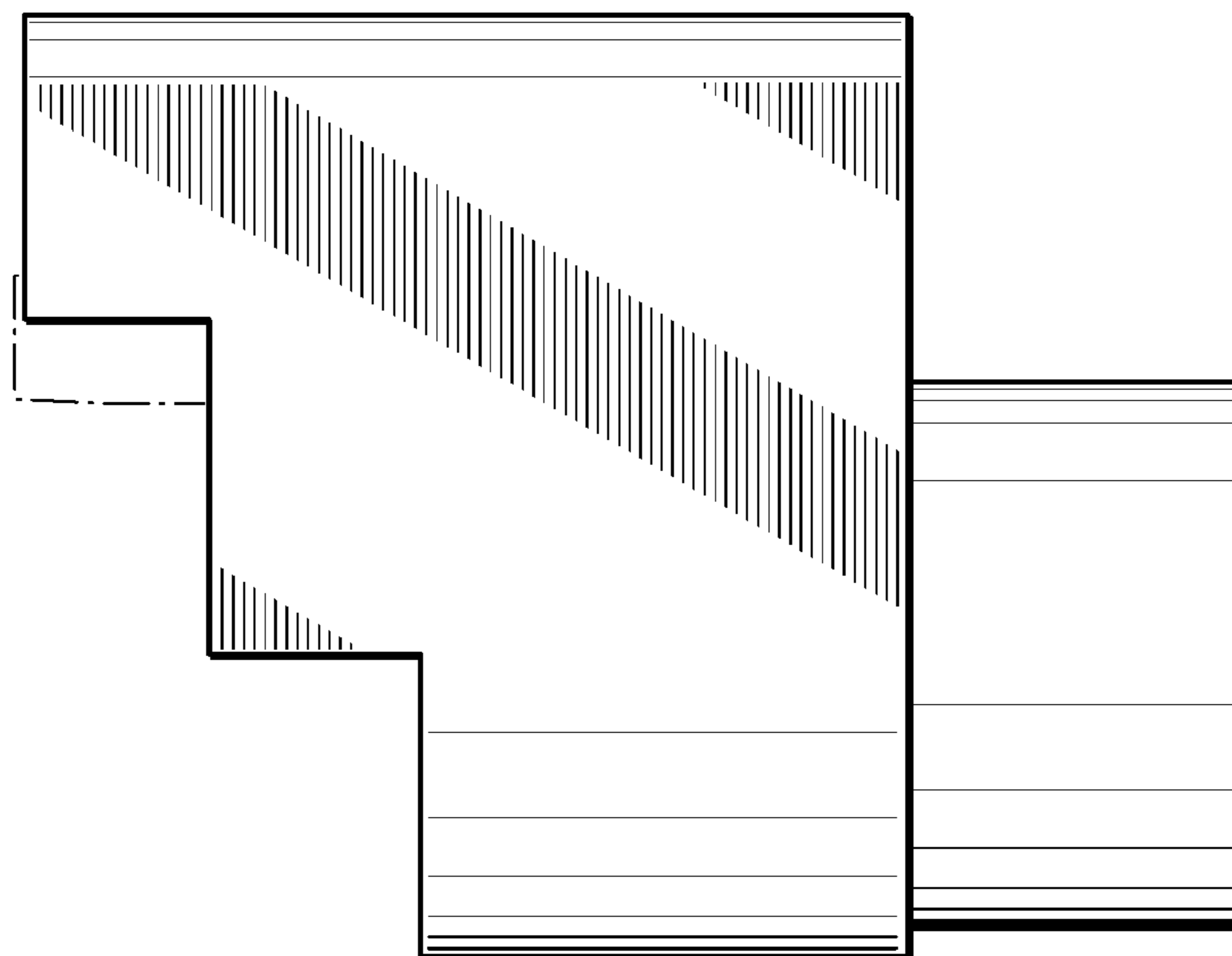

FIG. 5

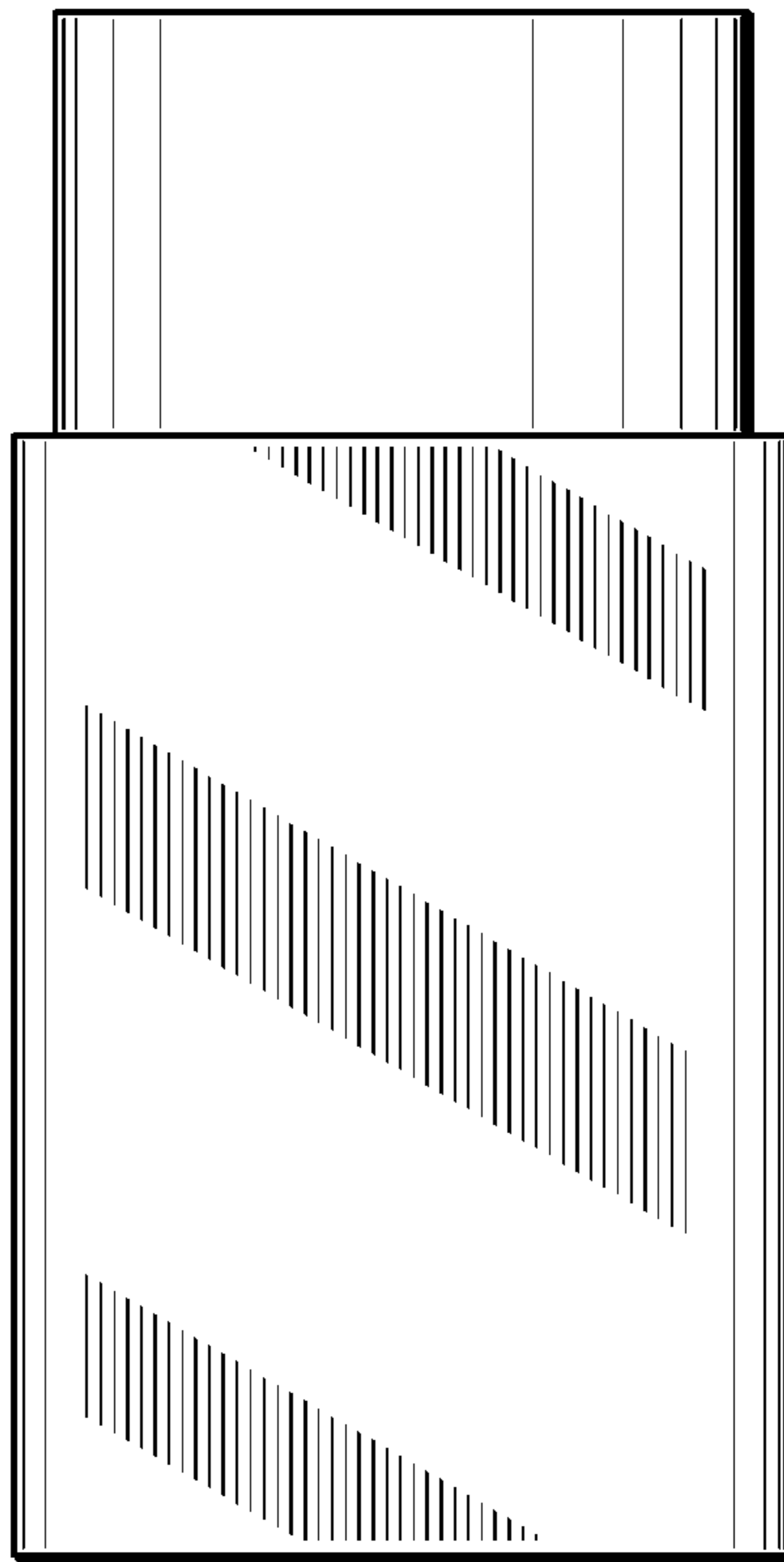

FIG. 6

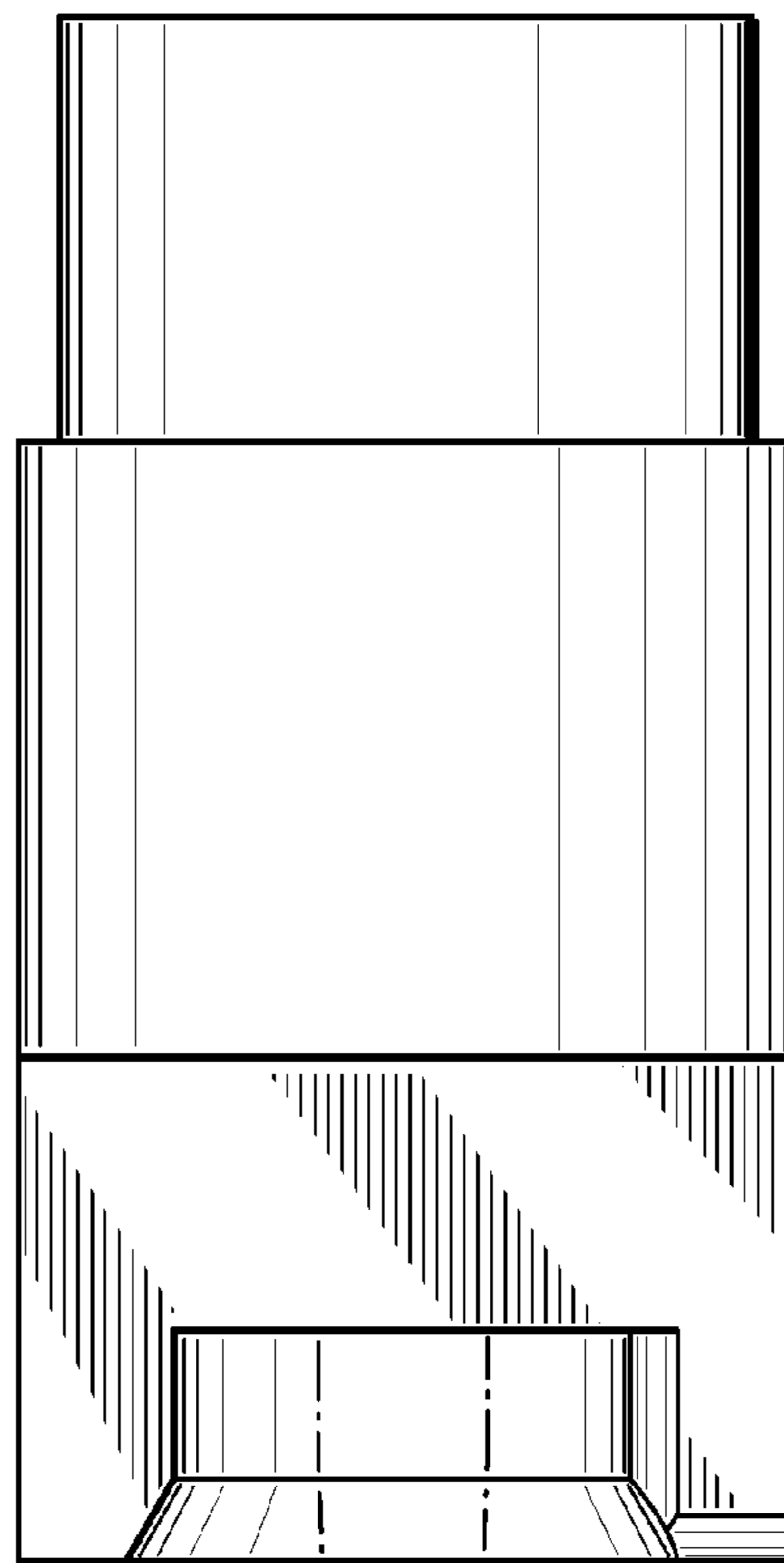

FIG. 7