



US00D616025S

(12) **United States Design Patent**
Yan

(10) **Patent No.:** **US D616,025 S**
(45) **Date of Patent:** **** May 18, 2010**

- (54) **PEN**
- (75) Inventor: **Jianfeng Yan**, Ningbo (CN)
- (73) Assignee: **Beifa Group Co., Ltd.**, Ningbo (CN)
- (**) Term: **14 Years**
- (21) Appl. No.: **29/334,008**
- (22) Filed: **Mar. 18, 2009**
- (30) **Foreign Application Priority Data**
Sep. 27, 2008 (CN) 2008 3 0211898
- (51) **LOC (9) Cl.** **19-06**
- (52) **U.S. Cl.** **D19/51**
- (58) **Field of Classification Search** D19/35,
D19/36, 41, 42, 43, 44, 45, 46, 47, 48, 49,
D19/50, 51, 54, 55, 56, 57; 24/11 F, 11 P,
24/11 R; 401/6, 52, 99, 100, 104, 105, 106,
401/107, 108, 109, 192, 195, 243, 244, 245,
401/246, 247
See application file for complete search history.

- (56) **References Cited**
U.S. PATENT DOCUMENTS
- | | | | | |
|--------------|---------|------------|-------|--------|
| D143,176 S * | 12/1945 | Whitehouse | | D19/51 |
| D260,101 S * | 8/1981 | Gomez | | D19/51 |
| D329,461 S * | 9/1992 | Katami | | D19/51 |
| D333,677 S * | 3/1993 | Giralt | | D19/48 |
| D401,278 S * | 11/1998 | Hu | | D19/51 |
| D403,704 S * | 1/1999 | Arita | | D19/48 |
| D404,427 S * | 1/1999 | Takanashi | | D19/48 |

- | | | | | |
|----------------|---------|-----------------|-------|---------|
| D427,238 S * | 6/2000 | Beneyto | | D19/43 |
| D480,421 S * | 10/2003 | Hui | | D19/43 |
| D484,537 S | 12/2003 | Arita | | |
| D487,771 S * | 3/2004 | Hwang | | D19/43 |
| D489,087 S * | 4/2004 | Kent | | D19/43 |
| 6,966,718 B2 * | 11/2005 | Furukawa et al. | | 401/247 |
| D541,339 S * | 4/2007 | Qiu | | D19/43 |
| 7,241,064 B2 * | 7/2007 | Yanagisako | | 401/6 |

FOREIGN PATENT DOCUMENTS

EM 000231303-0002 * 12/2004

* cited by examiner

Primary Examiner—Elizabeth A Albert

Assistant Examiner—Karen E Eldridge Powers

(74) *Attorney, Agent, or Firm*—Christensen O'Connor Johnson Kindness PLLC

(57) **CLAIM**

The ornamental design for a pen, as shown and described.

DESCRIPTION

FIG. 1 is an upper front right perspective view of a pen showing my new design;

FIG. 2 is a left side elevation view of the pen shown in FIG. 1;

FIG. 3 is an enlarged bottom plan view thereof;

FIG. 4 is a front elevation view thereof;

FIG. 5 is a right side elevation view thereof;

FIG. 6 is an enlarged top plan view thereof; and,

FIG. 7 is a rear elevation view thereof.

1 Claim, 3 Drawing Sheets

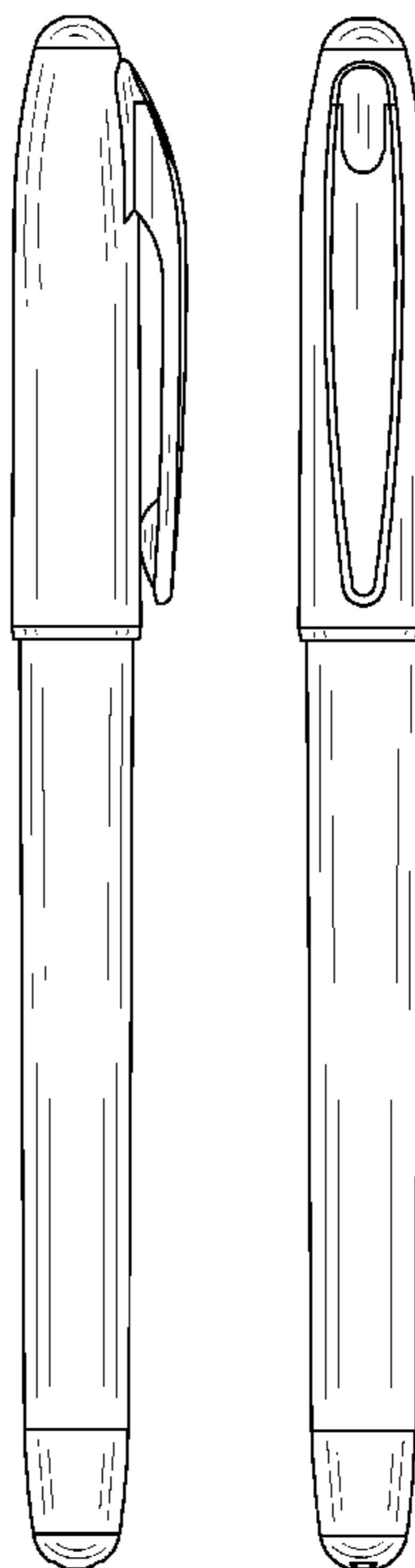

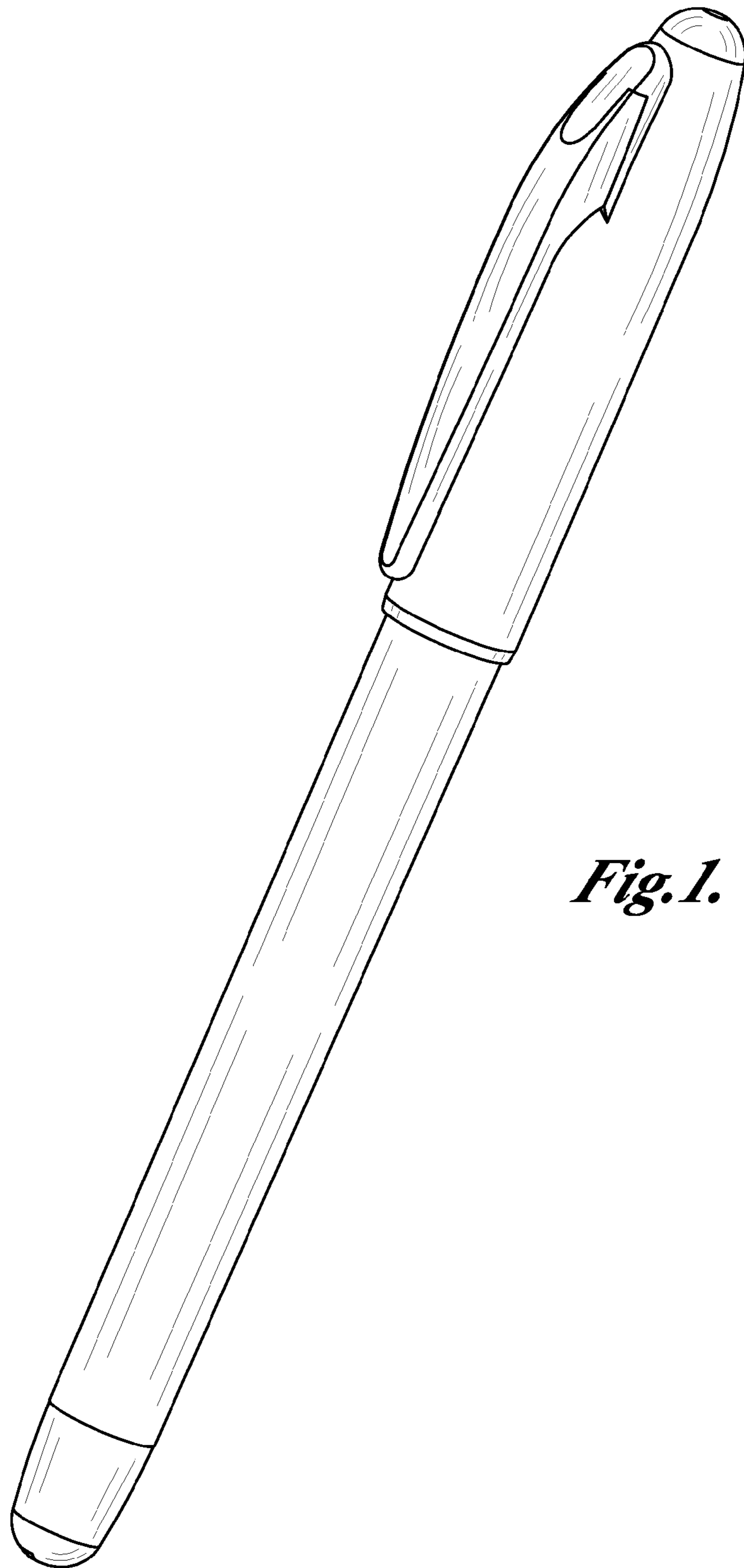

Fig. 1.

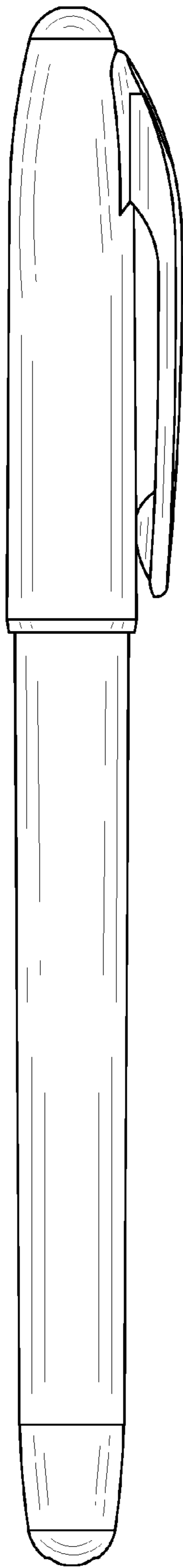

Fig. 2.

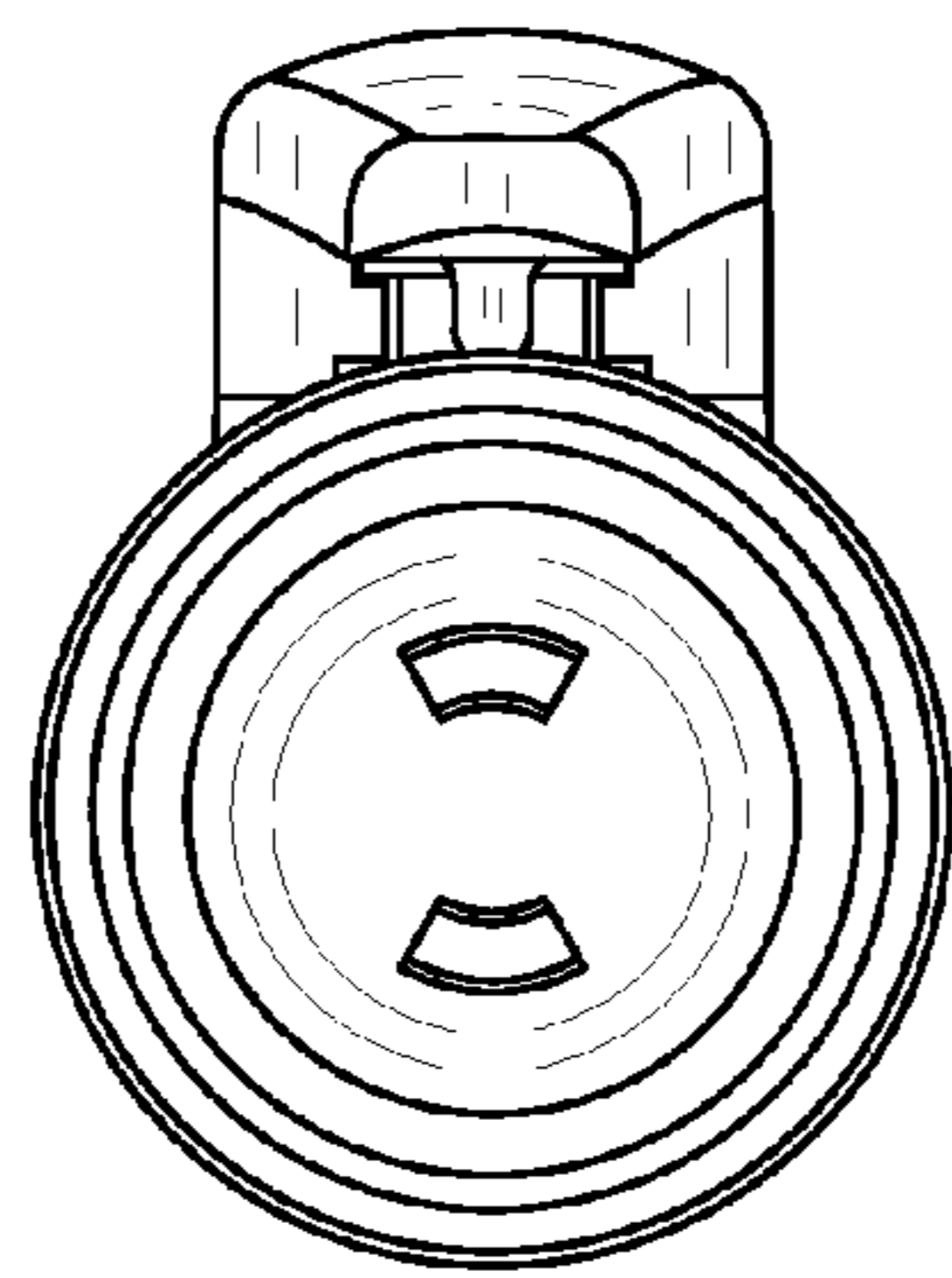

Fig. 3.

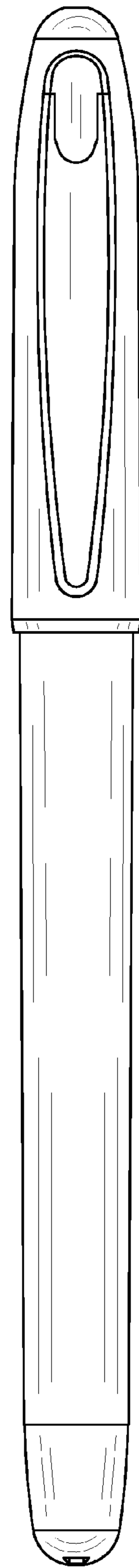

Fig. 4.

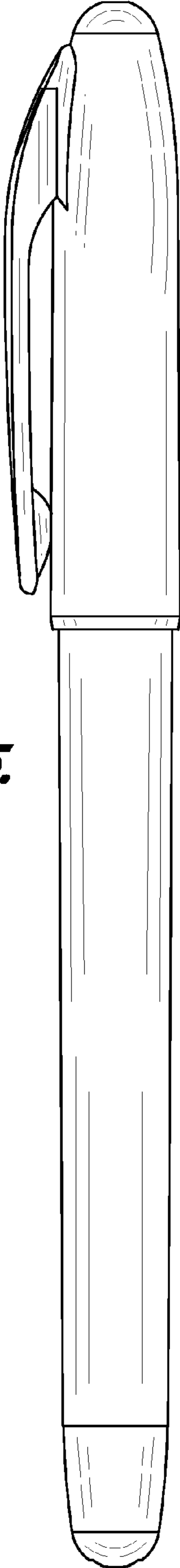

Fig. 5.

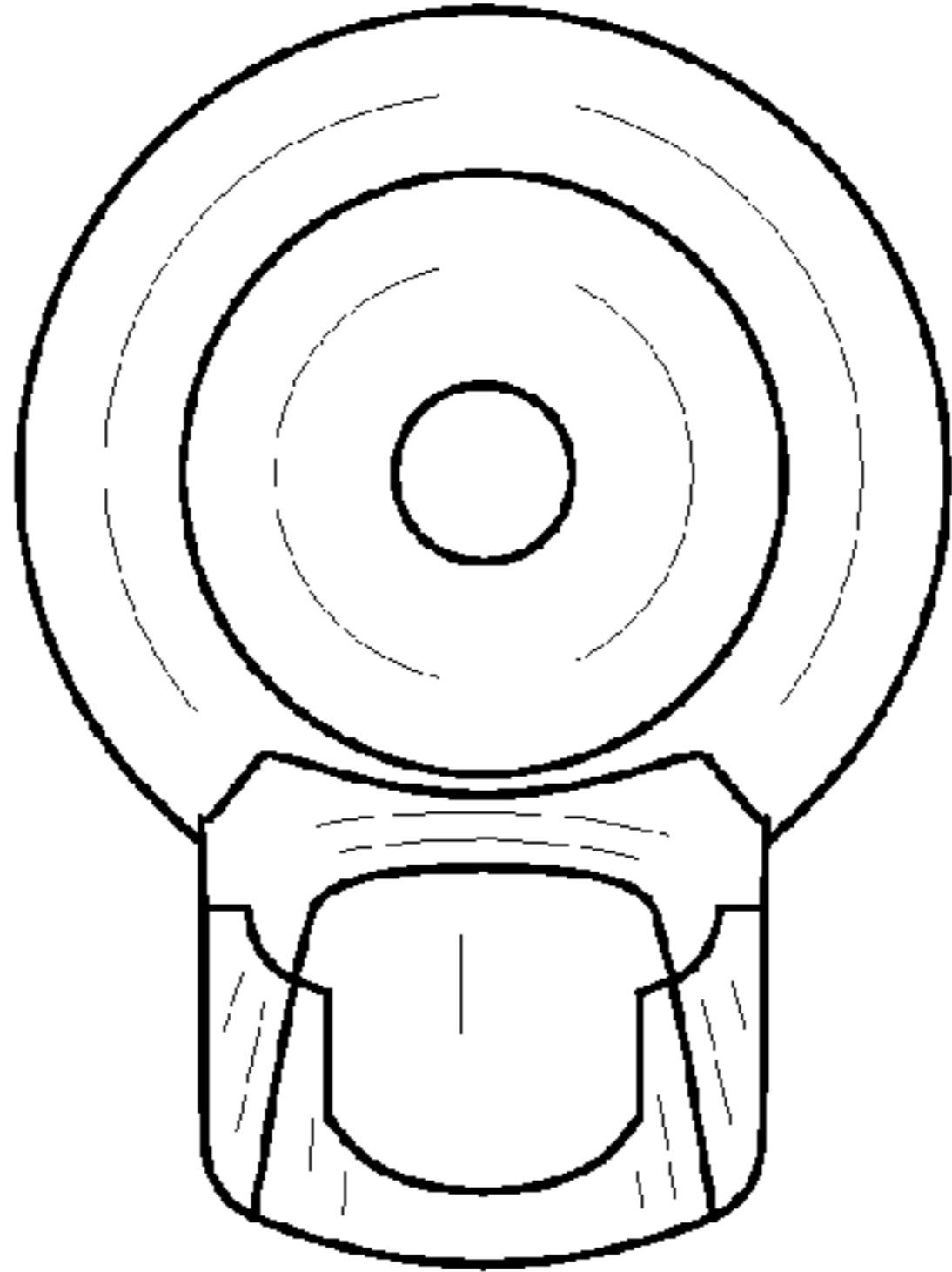

Fig. 6.

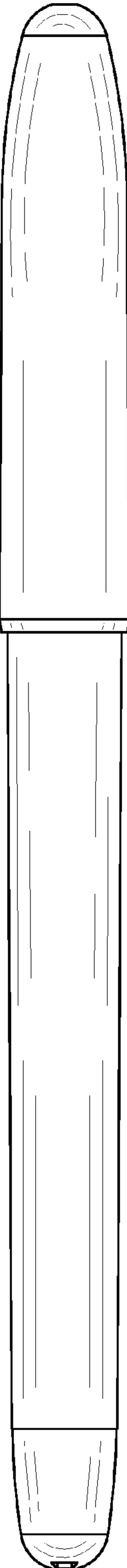

Fig. 7.