



US00D615983S

(12) **United States Design Patent**
Aoki

(10) **Patent No.:** **US D615,983 S**
(45) **Date of Patent:** **** May 18, 2010**

(54) **ADAPTER FOR MEMORY CARD**

(75) Inventor: **Yoshitaka Aoki**, Tokyo (JP)

(73) Assignee: **Sony Corporation**, Tokyo (JP)

(**) Term: **14 Years**

(21) Appl. No.: **29/343,544**

(22) Filed: **Sep. 15, 2009**

Related U.S. Application Data

(62) Division of application No. 29/300,961, filed on Jun. 5, 2008, now abandoned.

(30) **Foreign Application Priority Data**

Dec. 6, 2007	(JP)	D2007-033448
Dec. 6, 2007	(JP)	D2007-033449
Jun. 2, 2008	(JP)	D2008-013919
Jun. 2, 2008	(JP)	D2008-013920

(51) **LOC (9) Cl.** **14-02**

(52) **U.S. Cl.** **D14/436**

(58) **Field of Classification Search** D14/435-438,
D14/478-483, 474, 475, 335, 496, 125, 188,
D14/192, 204, 217, 265, 433, 432, 242; 235/441,
235/443, 487, 492, 493, 495, 486, 451, 479,
235/453; 361/737, 679, 752, 736, 728, 796,
361/797, 729, 730, 725-727, 740, 747, 759,
361/801, 816, 738, 766, 799, 807, 829; 257/678,
257/679, 693, E23.064; 439/946, 948, 159,
439/628, 638, 630, 267, 260, 945, 95, 140,
439/101, 67, 76.1, 108, 147, 148; 174/250,
174/260, 52.1, 52.2, 35 R, 51; 710/300-303,
710/62, 74; 438/121; D21/332, 333; 455/344-351;
369/1, 4, 6-12; 381/119, 120; 700/94; 345/156,
345/184; 312/233.2; 206/706, 701; 360/129,
360/132, 133, 135; D13/182

See application file for complete search history.

(56) **References Cited**

U.S. PATENT DOCUMENTS

D276,503	S	11/1984	Mansau
5,184,282	A	2/1993	Kaneda et al.
5,198,645	A	3/1993	Martin et al.

(Continued)

FOREIGN PATENT DOCUMENTS

RU	63706	S	8/2007
----	-------	---	--------

OTHER PUBLICATIONS

Office Action of Design Application No. 2008503751 mailed on Jul. 17, 2009 (Russia).

Primary Examiner—Susan Moon Lee

(74) *Attorney, Agent, or Firm*—Rader, Fishman & Grauer PLLC

(57) **CLAIM**

The ornamental design for an adapter for memory card, as shown and described.

DESCRIPTION

FIG. 1 is a perspective view of a first embodiment of an adapter for memory card showing my new design;

FIG. 2 is a front elevational view thereof;

FIG. 3 is a rear elevational view thereof;

FIG. 4 is a left side elevational view thereof;

FIG. 5 is a right side elevational view thereof;

FIG. 6 is a top plan view thereof; and,

FIG. 7 is a bottom plan view thereof.

The portions indicated in broken lines are for illustrative purposes only and form no part of the claimed design.

1 Claim, 7 Drawing Sheets

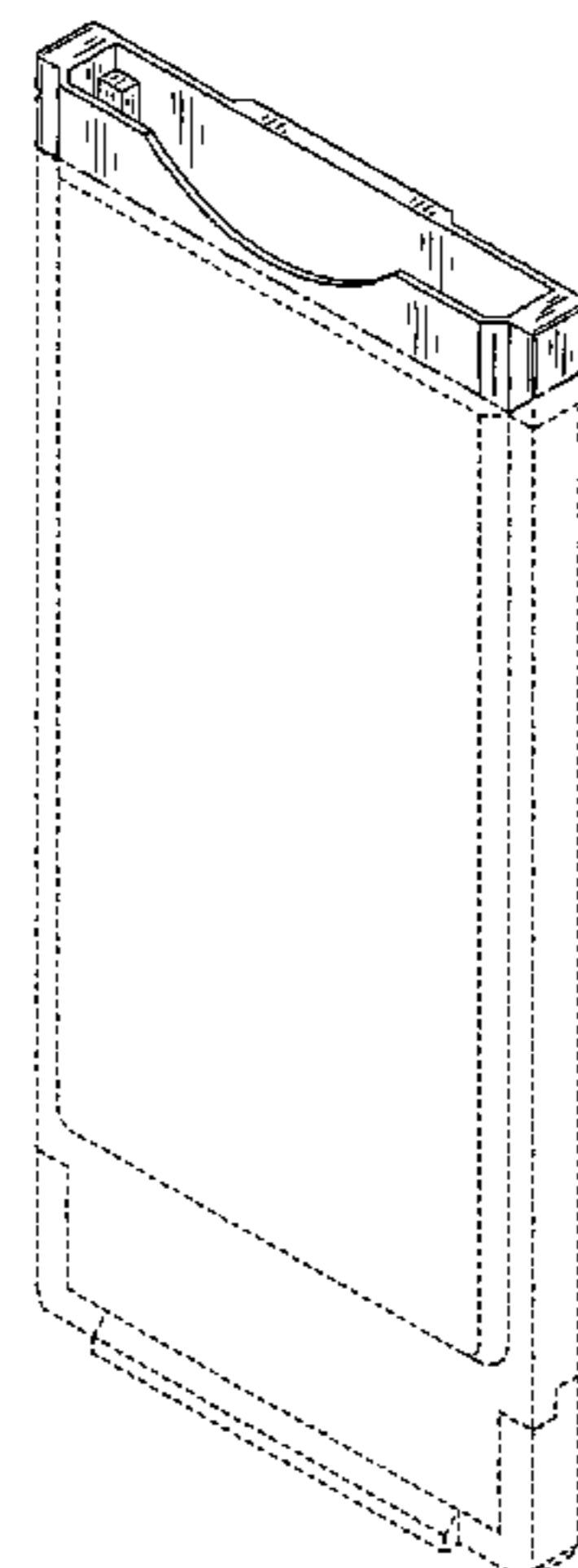

US D615,983 S

Page 2

U.S. PATENT DOCUMENTS

5,339,222	A	8/1994	Simmons et al.	6,527,188	B1	3/2003	Shobara et al.	
5,402,095	A	3/1995	Janniere	6,612,492	B1 *	9/2003	Yen	235/451
5,547,397	A	8/1996	Hirai	D486,830	S	2/2004	Kadonaga	
5,574,628	A	11/1996	Persia et al.	6,761,313	B2 *	7/2004	Hsieh et al.	235/451
5,674,080	A *	10/1997	Takemura	6,762,725	B2 *	7/2004	Beard et al.	343/702
D392,630	S	3/1998	Fussell	D494,975	S	8/2004	McClelland, II et al.	
5,739,515	A	4/1998	Takemura	6,817,523	B2 *	11/2004	Chen et al.	235/441
D394,050	S	5/1998	Funawatari	6,832,920	B2 *	12/2004	Glad et al.	439/131
5,752,857	A *	5/1998	Knights	D506,200	S	6/2005	Shih	
5,780,827	A	7/1998	Zolkos et al.	6,915,956	B2 *	7/2005	Liu et al.	235/492
5,846,092	A *	12/1998	Feldman et al.	7,008,240	B1	3/2006	Wang et al.	
5,877,488	A	3/1999	Klatt et al.	7,051,931	B2 *	5/2006	Sowa et al.	235/441
5,896,274	A	4/1999	Ishida	7,059,913	B1 *	6/2006	Chen	439/638
D410,908	S *	6/1999	Oba	7,094,106	B2 *	8/2006	Yamamoto et al.	439/630
D410,916	S	6/1999	Oba	7,097,512	B1 *	8/2006	Hsiao et al.	439/630
5,955,722	A *	9/1999	Kurz et al.	D529,029	S	9/2006	Sekine	
D418,692	S	1/2000	Funawatari	7,108,553	B2 *	9/2006	Zhu et al.	439/607.01
D421,597	S	3/2000	Oba et al.	7,162,547	B2 *	1/2007	Hosaka et al.	710/8
6,069,795	A	5/2000	Klatt et al.	7,226,318	B1 *	6/2007	Lee	439/630
6,097,605	A	8/2000	Klatt et al.	7,249,975	B1 *	7/2007	Liu	439/630
D432,505	S	10/2000	Oba et al.	D551,669	S *	9/2007	Kadonaga	D14/436
6,132,223	A	10/2000	Seeley et al.	7,285,023	B1 *	10/2007	Chang et al.	439/638
6,145,748	A *	11/2000	Neifer et al.	D556,202	S	11/2007	Kadonaga	
D435,256	S	12/2000	Hibino	7,319,715	B1 *	1/2008	Souissi et al.	375/220
6,266,017	B1	7/2001	Aldous	7,320,622	B2 *	1/2008	Ying et al.	439/630
6,272,017	B1	8/2001	Klatt et al.	D563,430	S	3/2008	Deguchi et al.	
6,315,205	B1	11/2001	Bates, III	D563,995	S	3/2008	Deguchi et al.	
D451,501	S	12/2001	Sward et al.	D582,419	S	12/2008	Sheba et al.	
D457,887	S	5/2002	Kadonaga	7,498,525	B2	3/2009	Aoka et al.	
6,400,931	B1	6/2002	Inkinen et al.	D591,752	S	5/2009	Aoki	
D460,453	S	7/2002	Homma et al.	2001/0043160	A1	11/2001	Hirai et al.	
6,443,361	B1	9/2002	Klatt et al.	2002/0032813	A1	3/2002	Hosaka et al.	
D466,119	S	11/2002	Funahashi et al.	2003/0054694	A1	3/2003	Takamori et al.	
D470,148	S	2/2003	Nishio et al.	2003/0141365	A1	7/2003	Sowa et al.	
6,524,137	B1 *	2/2003	Liu et al.	2003/0235040	A1 *	12/2003	Liu et al.	361/737

* cited by examiner

FIG. 1

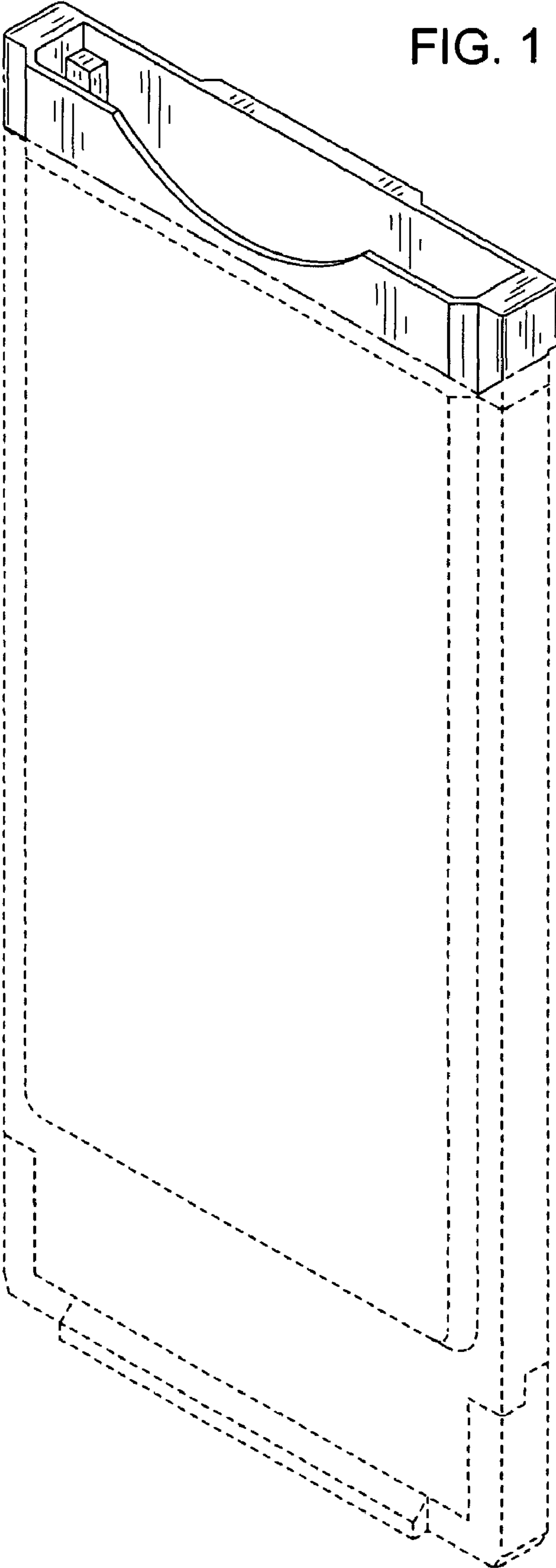

FIG. 2

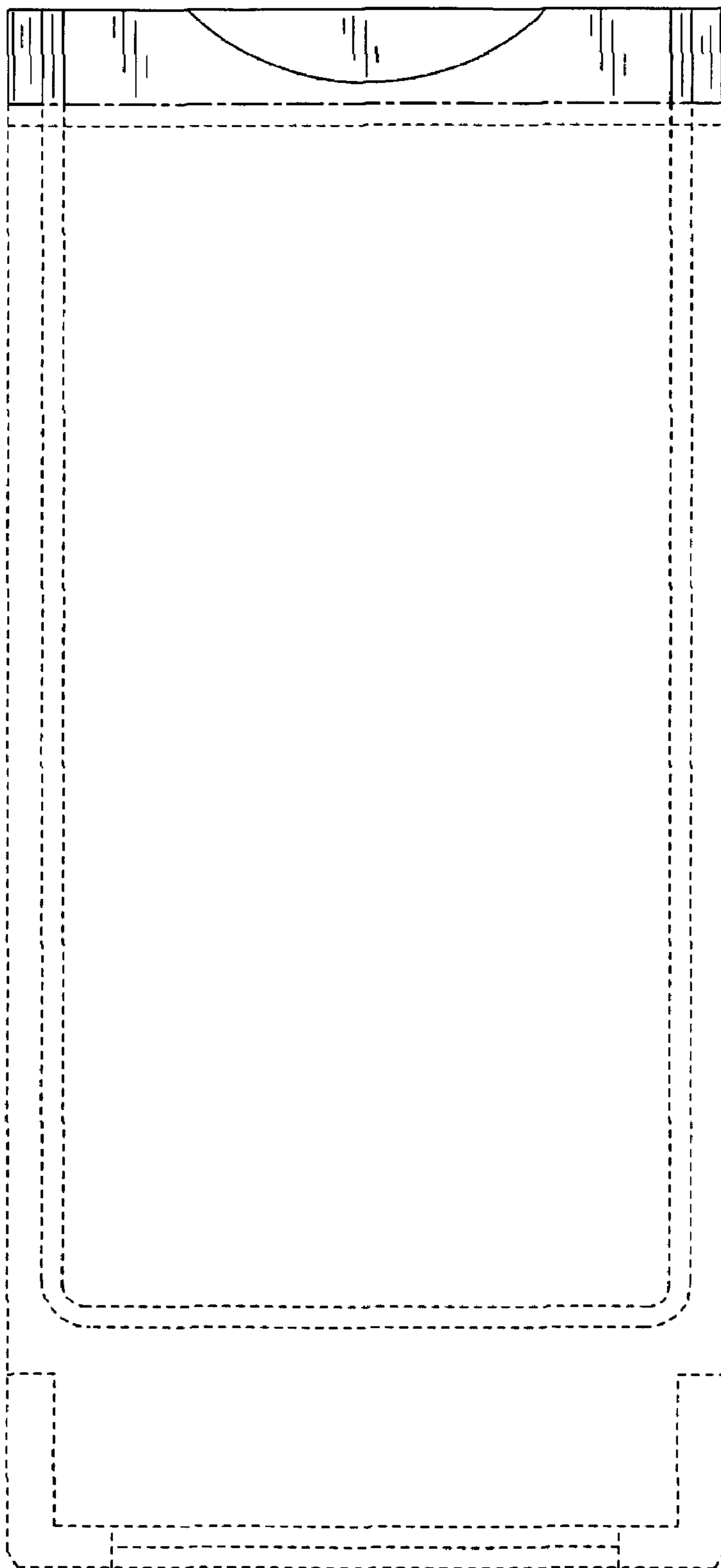

FIG. 3

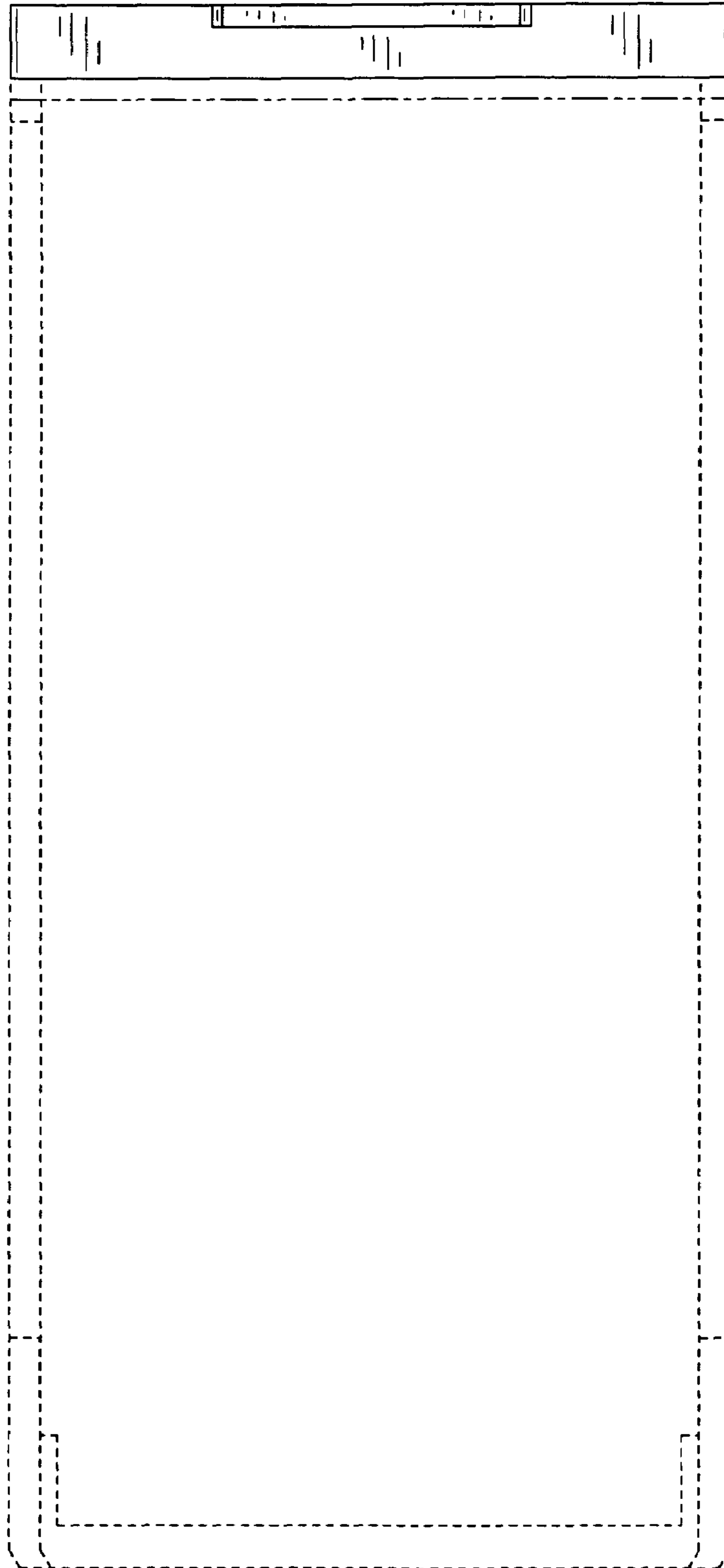

FIG. 4

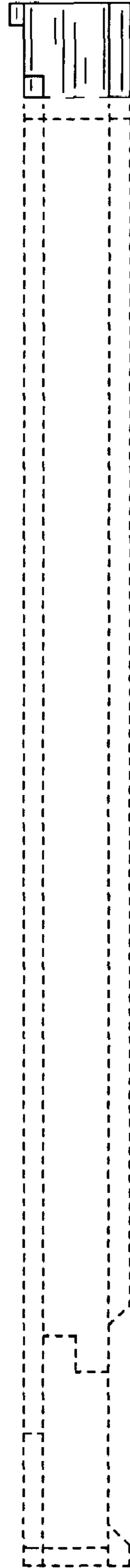

FIG. 5

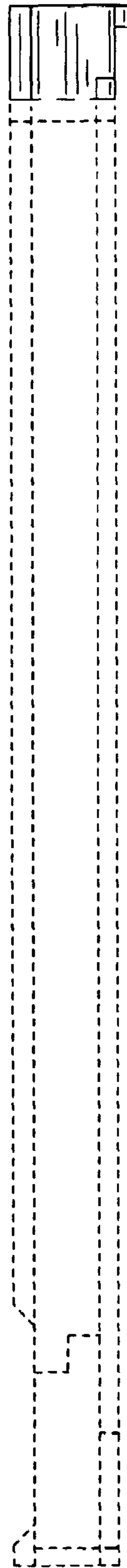

FIG. 6

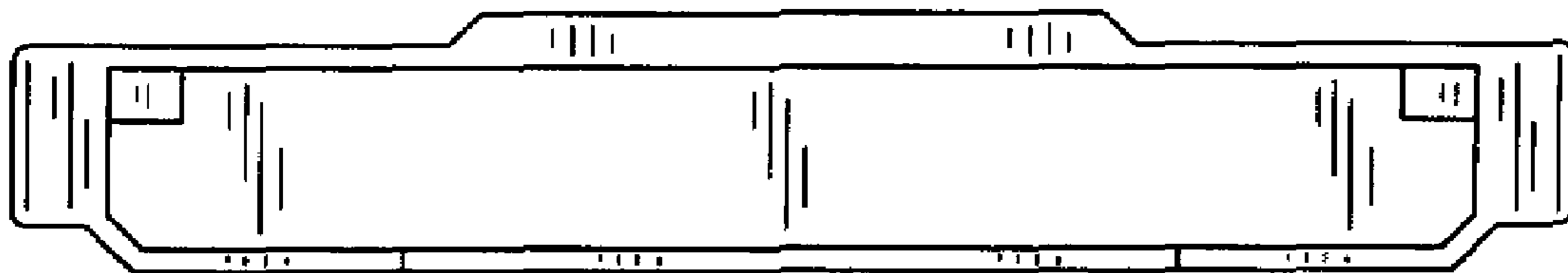

FIG. 7

