



US00D613969S

(12) **United States Design Patent**
Lenterman

(10) **Patent No.:** **US D613,969 S**
(45) **Date of Patent:** **** Apr. 20, 2010**

(54) **CHAIR CONTROL KNOB**

D559,159 S * 1/2008 Kazyaka D12/179
D569,216 S * 5/2008 Muchin et al. D8/300
D595,559 S * 7/2009 Banjo et al. D8/312

(75) Inventor: **Henri B. Lenterman**, Chino Hills, CA
(US)

* cited by examiner

(73) Assignee: **Intro-Tech Automotive, Inc.**, Chino, CA
(US)

Primary Examiner—Caron Veynar
Assistant Examiner—Abraham Bahta

(**) Term: **14 Years**

(74) *Attorney, Agent, or Firm*—Intellectual Property Law
Office of Joel Voelzke, APC

(21) Appl. No.: **29/305,615**

(57) **CLAIM**

(22) Filed: **Mar. 25, 2008**

The ornamental design for a chair control knob, as shown and described.

(51) **LOC (9) Cl.** **06-04**

(52) **U.S. Cl.** **D6/491**; D12/179

(58) **Field of Classification Search** D6/334–335,
D6/364–366, 373, 379, 491, 500–502; D8/300,
D8/303, 374, 355; D12/179, 174, 176; 74/523,
74/543, 551.9, 553, 557; 16/110.1, 421,
16/422, 441, DIG. 12; 248/578; 297/337,
297/301.1, 302, 411.2, 452.11, 452.21, 284.1,
297/354.1, 361.1, 364; D3/7, 10; 135/76;
150/155; 70/332

DESCRIPTION

See application file for complete search history.

This application is related to design patent application Ser. Nos. 29/305,602; 29/305,603; 29/305,605; 29/305,606; 29/305,607; 29/305,610; and 29/305,612, which are filed concurrently herewith.

(56) **References Cited**

FIG. 1 is a front, left side, and top perspective view of a chair control knob showing my new design;

U.S. PATENT DOCUMENTS

FIG. 2 is an enlarged perspective view thereof;

- D214,618 S * 7/1969 Waitman-Warner D8/301
- D321,993 S * 12/1991 Zagaroli et al. D6/366
- D401,075 S * 11/1998 Smith D6/366
- D405,970 S * 2/1999 Kaczmarek D6/366
- D409,404 S * 5/1999 Kaczmarek D6/366
- D497,265 S * 10/2004 Tai D6/366
- D497,266 S * 10/2004 Tai D6/366
- D516,299 S * 3/2006 Kilgore D3/14
- D535,486 S * 1/2007 Huang D6/366

FIG. 3 is an enlarged left side elevational view, the right side elevational view being a mirror image thereof; and,

FIG. 4 is an enlarged front elevational view thereof.

The characteristic feature of the design resides in the application of a part having the appearance of an automotive transmission shift knob to a chair control knob.

The broken line showing of chair is included for the purpose of illustrating environmental structure and forms no part of the claimed design.

1 Claim, 2 Drawing Sheets

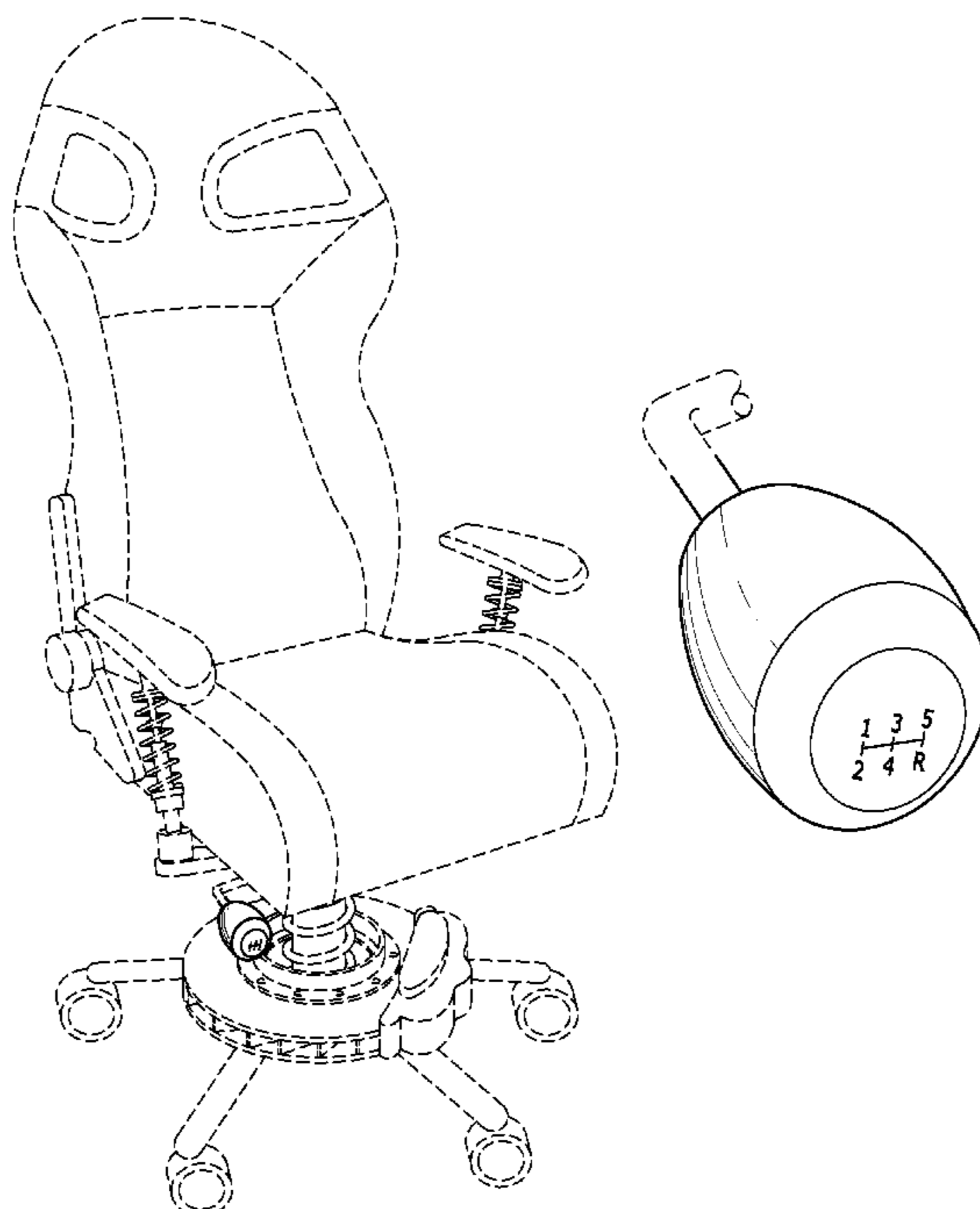

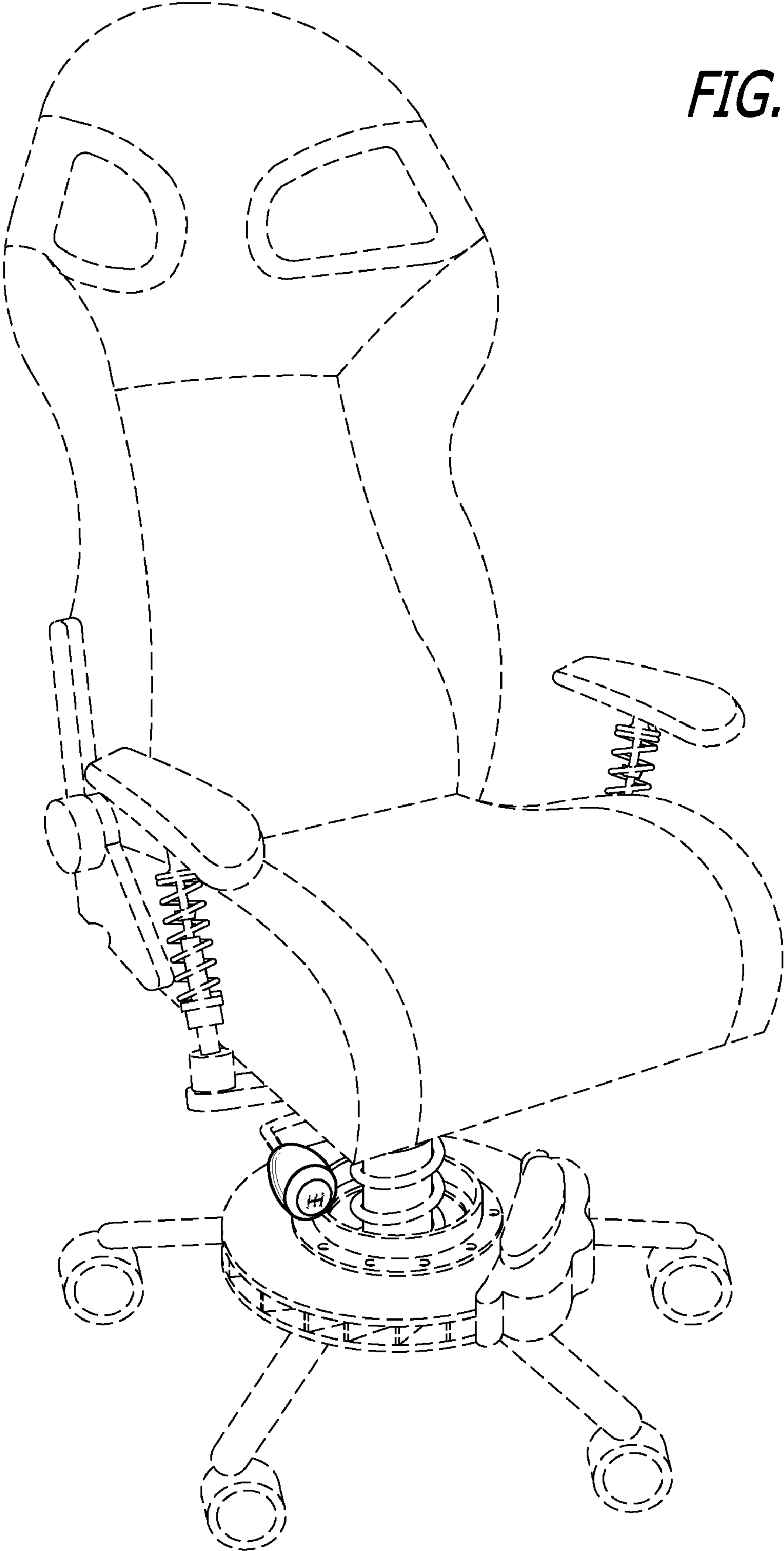

FIG. 1

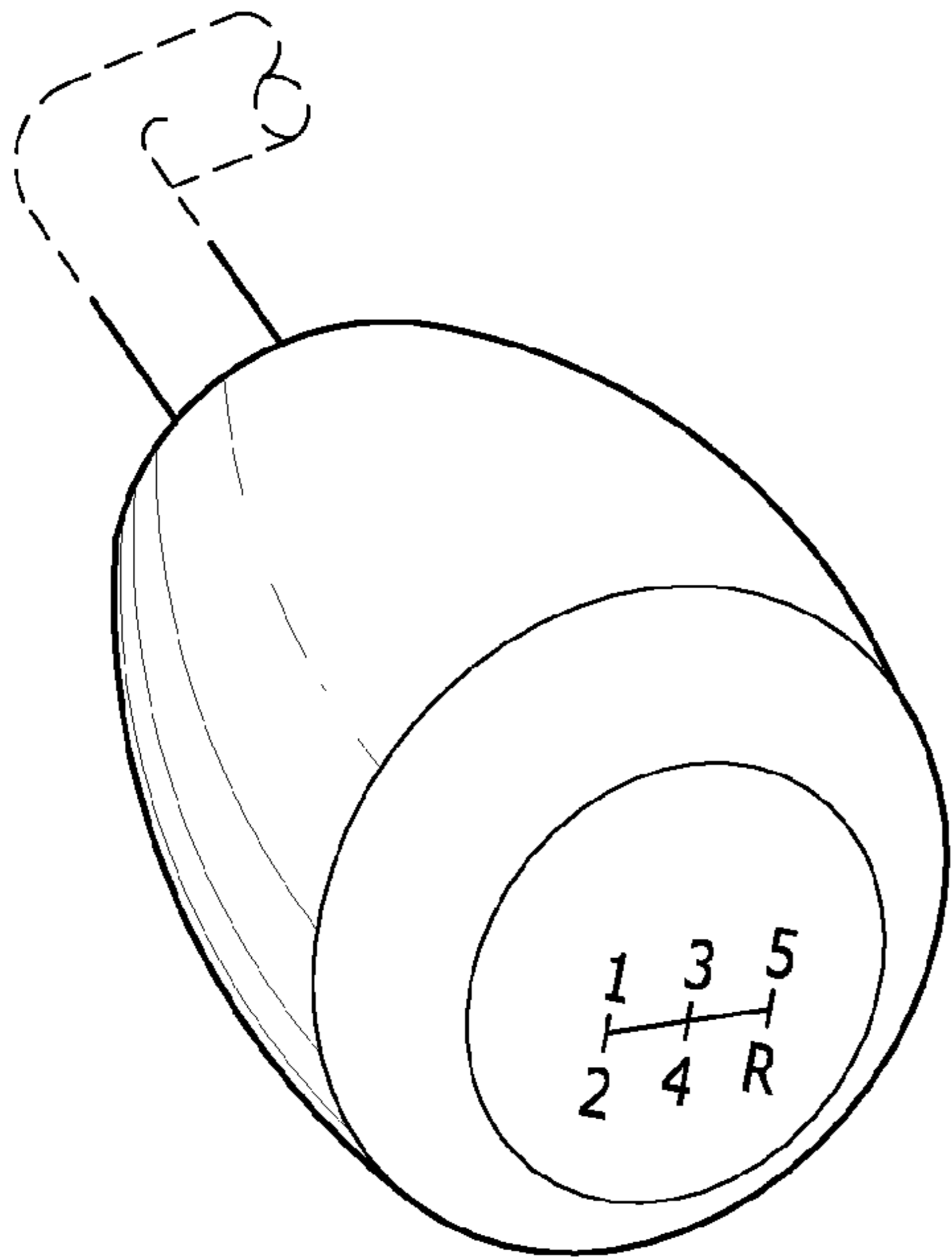

FIG. 2

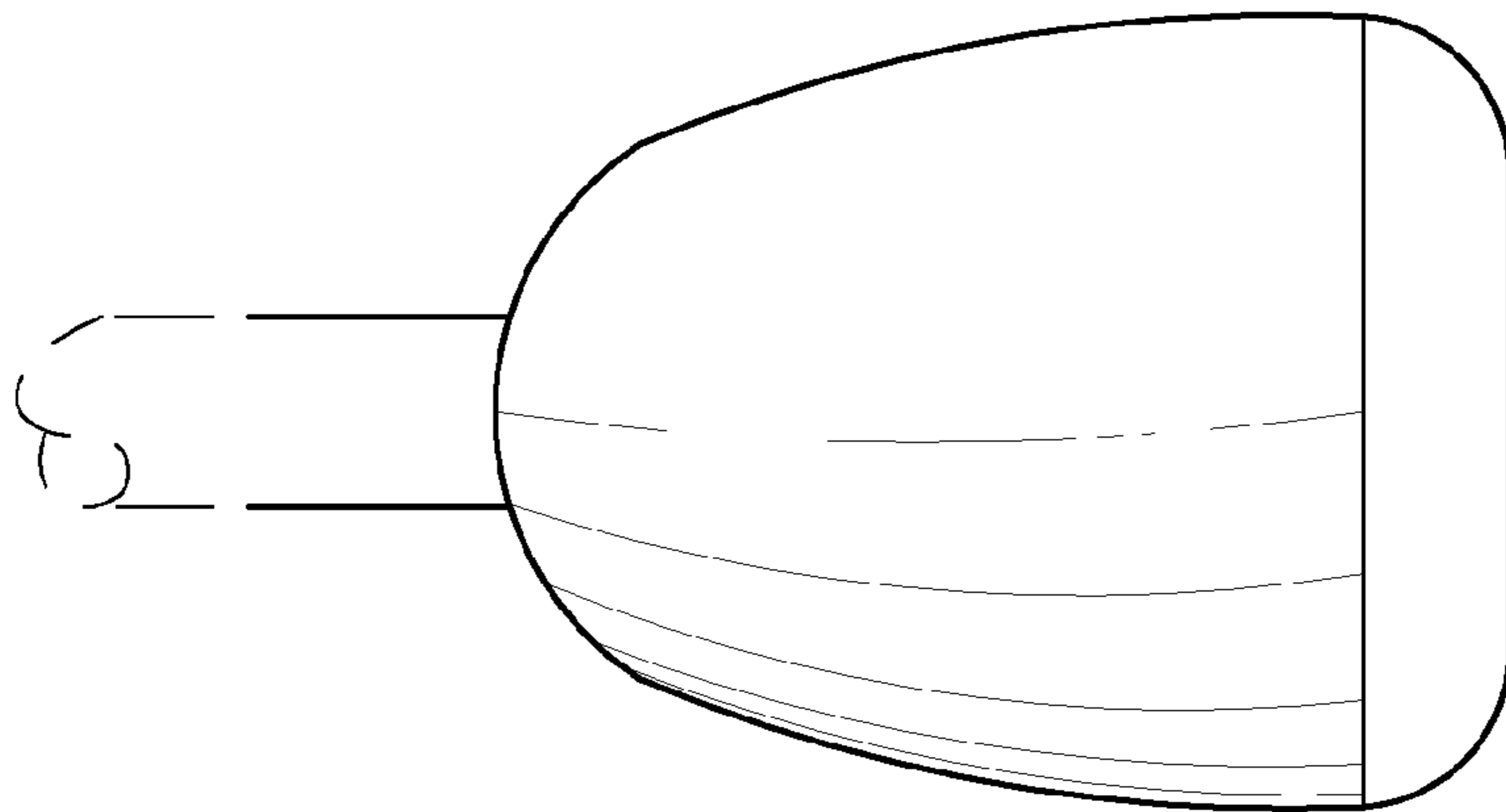

FIG. 3

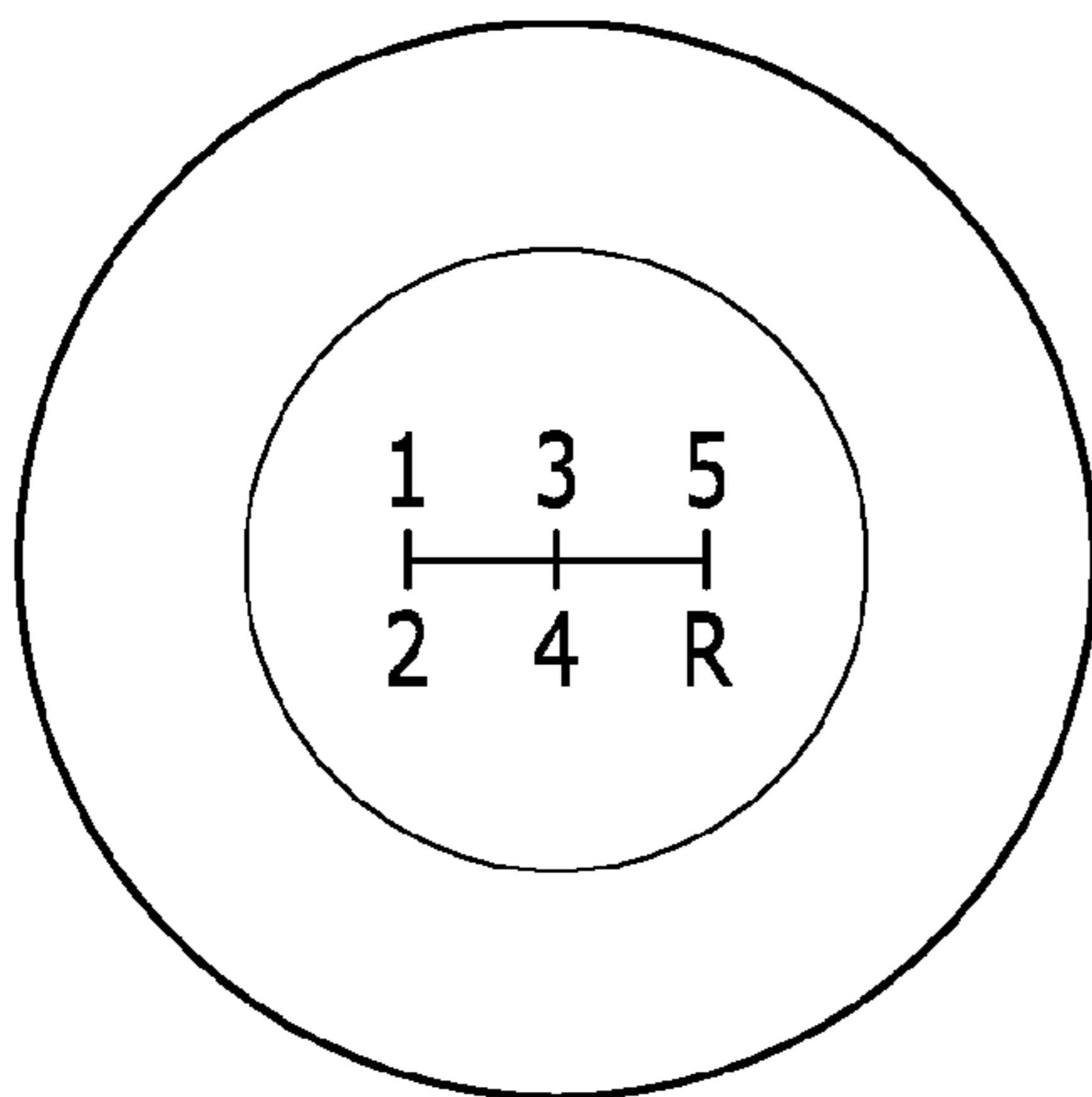

FIG. 4