



US00D612950S

(12) **United States Design Patent**  
**Berger et al.**

(10) **Patent No.:** **US D612,950 S**  
(45) **Date of Patent:** **\*\* Mar. 30, 2010**

(54) **GARDEN SHED**

(75) Inventors: **Maurice Berger**, Arbent (FR); **Andre Grosfillex**, Arbent (FR)

(73) Assignee: **Grosfillex SAS**, Oyonnax (FR)

(\*\*) Term: **14 Years**

(21) Appl. No.: **29/311,263**

(22) Filed: **Feb. 4, 2009**

(30) **Foreign Application Priority Data**

Aug. 4, 2008 (EM) ..... 000981626-0001

(51) **LOC (9) Cl.** ..... **25-01**

(52) **U.S. Cl.** ..... **D25/29**

(58) **Field of Classification Search** ..... D25/1,  
D25/16, 18, 25, 33; 52/36.2, 64, 79.1, 79.4,  
52/79.5; 137/87

See application file for complete search history.

(56) **References Cited**

**U.S. PATENT DOCUMENTS**

- 3,434,253 A \* 3/1969 Hatcher ..... 52/69
- 3,800,493 A \* 4/1974 Livingston ..... 52/745.03
- 4,034,527 A \* 7/1977 Jalasjaa ..... 52/233
- D305,690 S \* 1/1990 Paul et al. .... D25/22
- D349,348 S \* 8/1994 McGrath ..... D25/1
- D362,075 S \* 9/1995 Tebb ..... D25/16
- D416,091 S \* 11/1999 Ohanesian ..... D25/33
- D421,500 S \* 3/2000 Hampel ..... D25/16
- D452,912 S \* 1/2002 Ohanesian ..... D25/33
- D452,978 S \* 1/2002 Ohanesian ..... D25/33
- 6,550,216 B1 \* 4/2003 Ohanesian ..... 52/783.11
- 6,581,337 B1 \* 6/2003 Skov et al. .... 52/79.5
- D478,386 S \* 8/2003 Ohanesian ..... D25/33

- D489,461 S \* 5/2004 Ohanesian ..... D25/33
- D492,793 S \* 7/2004 Moon et al. .... D25/33
- D496,737 S \* 9/2004 Moon et al. .... D25/33
- 6,823,639 B2 \* 11/2004 Hampel ..... 52/598
- D506,266 S \* 6/2005 Astle et al. .... D25/59
- D525,715 S \* 7/2006 Richardson et al. .... D25/33
- D529,186 S \* 9/2006 Fullelove et al. .... D25/33
- D529,623 S \* 10/2006 Richardson et al. .... D25/33
- 2003/0024173 A1 \* 2/2003 Cohen ..... 52/79.1
- 2003/0029100 A1 \* 2/2003 Wetzel, III et al. .... 52/79.1
- 2004/0060245 A1 \* 4/2004 Loblick et al. .... 52/79.5
- 2005/0091932 A1 \* 5/2005 Roth ..... 52/79.1
- 2005/0223655 A1 \* 10/2005 Mower et al. .... 52/79.5

\* cited by examiner

*Primary Examiner*—T. Chase Nelson  
*Assistant Examiner*—Eric L Goodman

(74) *Attorney, Agent, or Firm*—Dowell & Dowell PC

(57) **CLAIM**

The ornamental design for a garden shed, as shown and described.

**DESCRIPTION**

FIG. 1 is a front perspective view of a garden shed showing our new design;

FIG. 2 is a front elevation view thereof;

FIG. 3 is a rear elevation view thereof;

FIG. 4 is a left side view thereof;

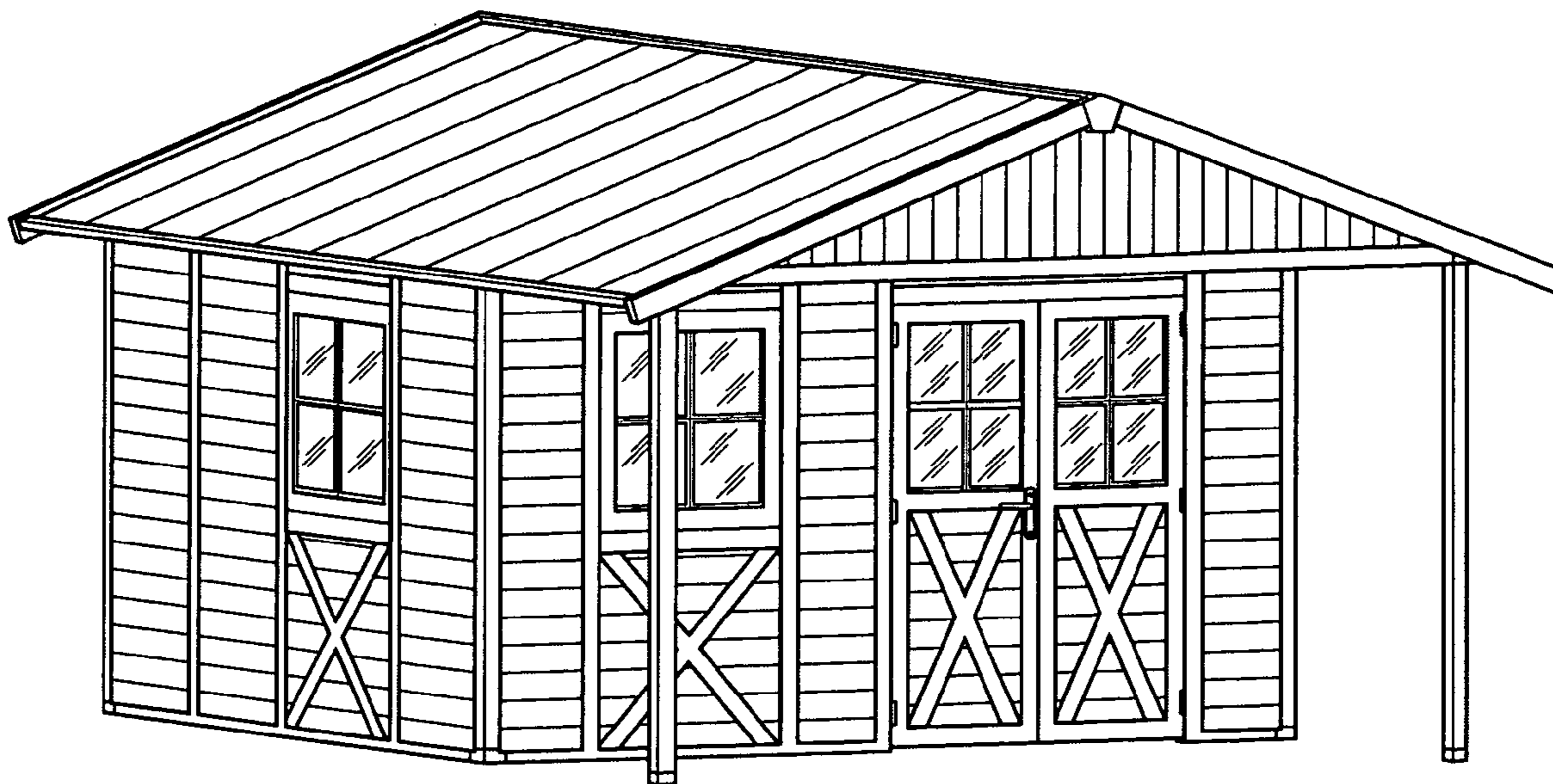
FIG. 5 is a right side thereof;

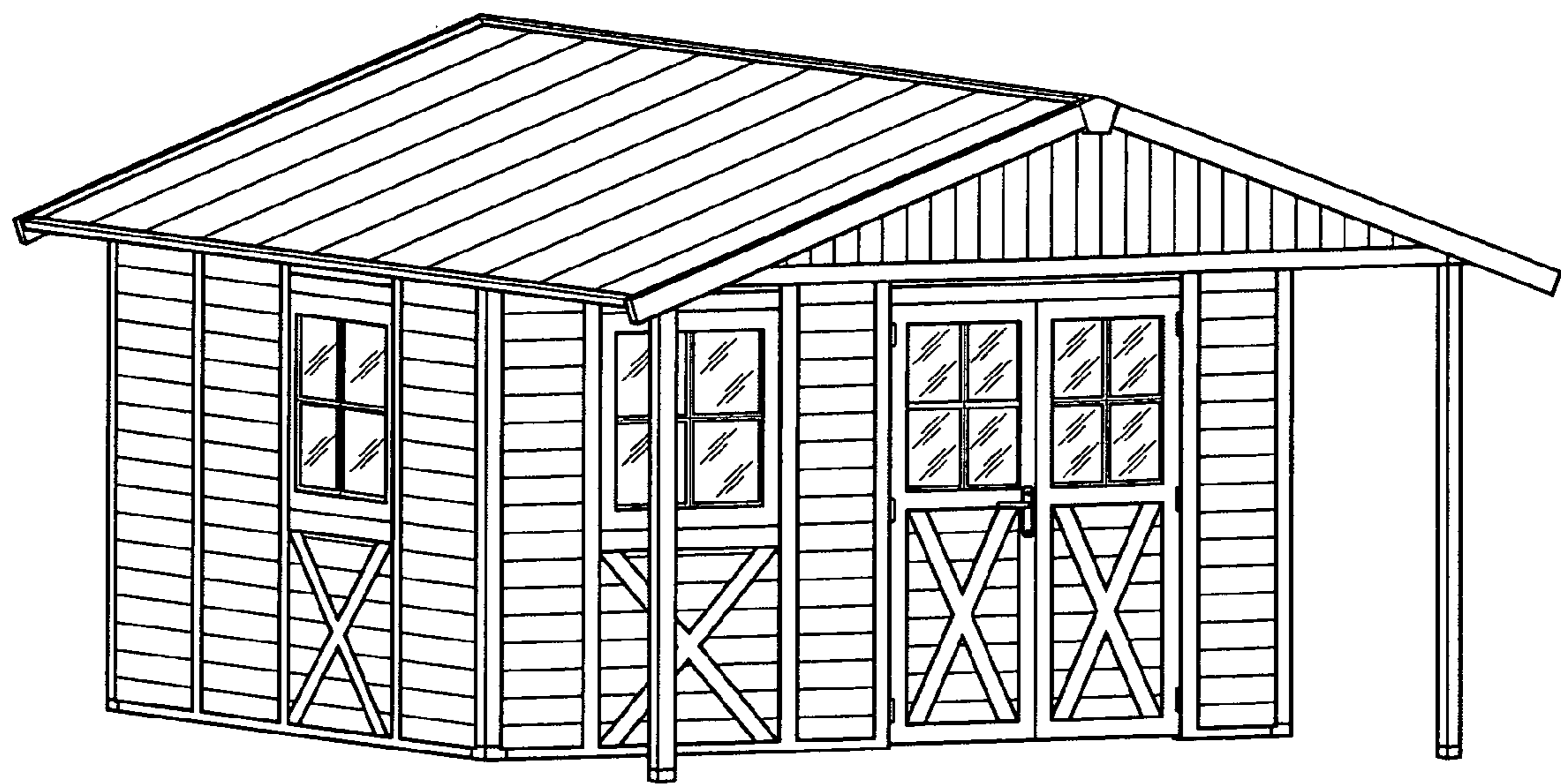
FIG. 6 is a top plan view thereof; and,

FIG. 7 is bottom plan view thereof.

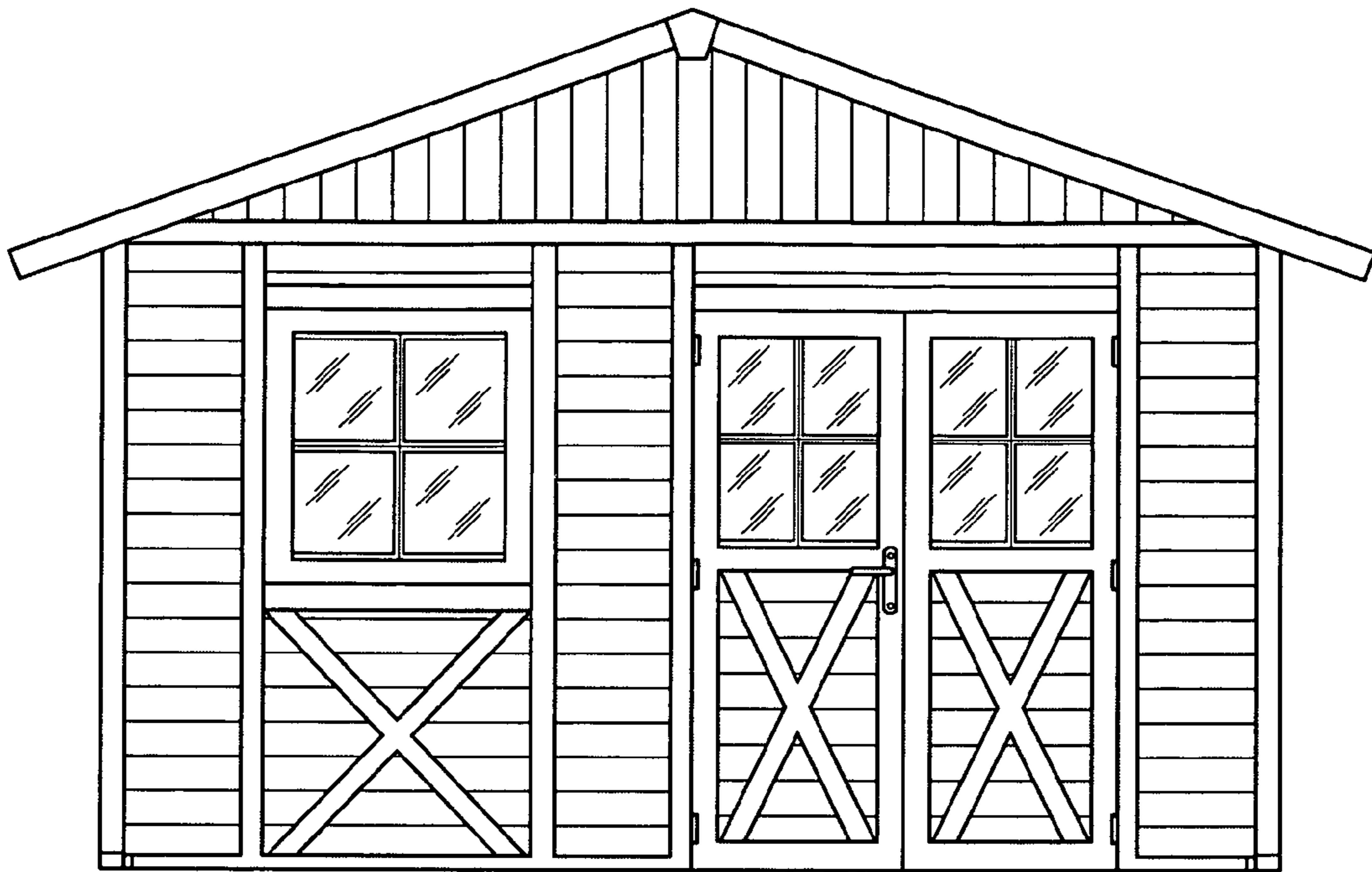
The broken lines are for illustrative purposes only and form no part of the claimed design.

**1 Claim, 5 Drawing Sheets**

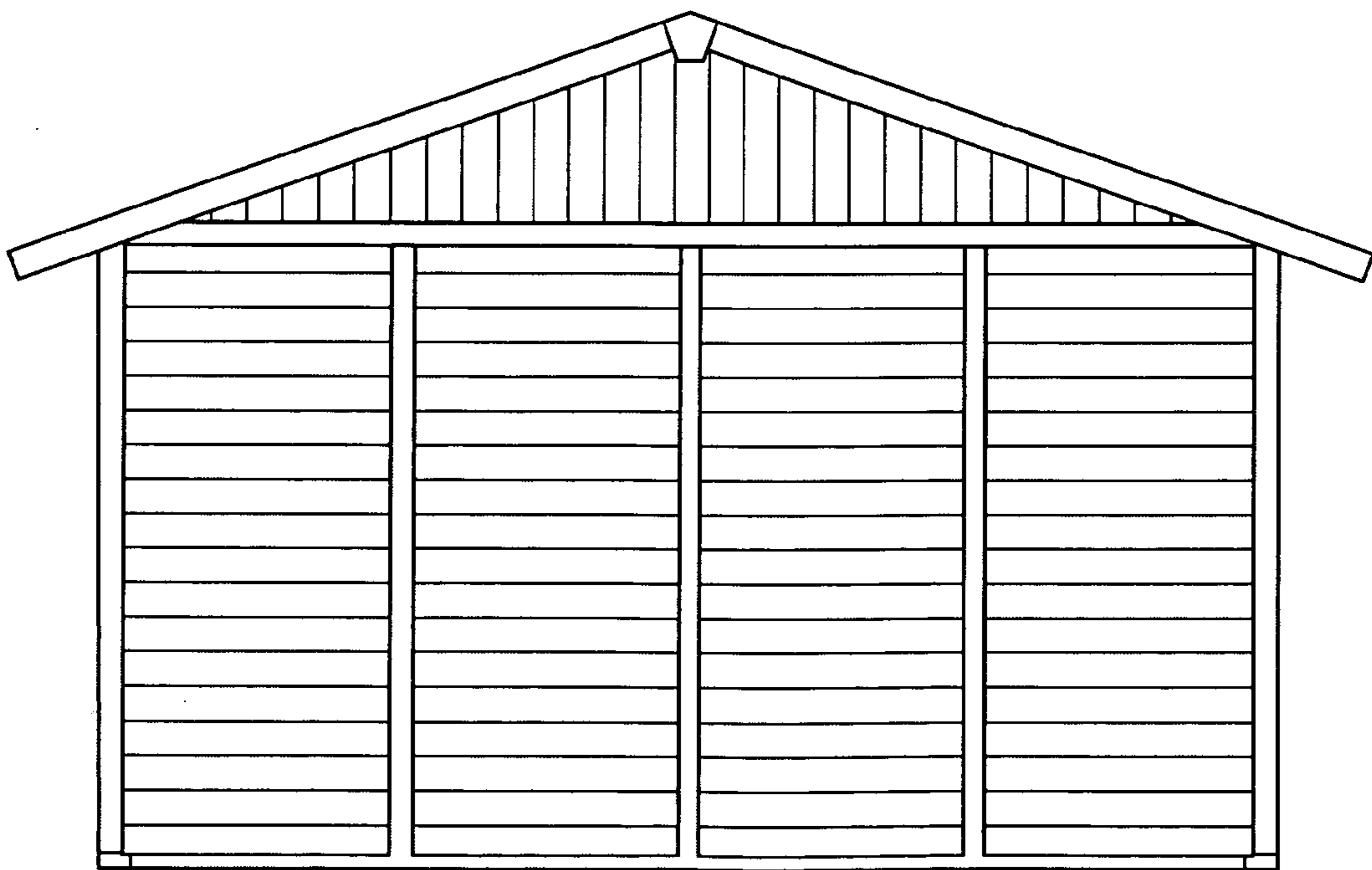




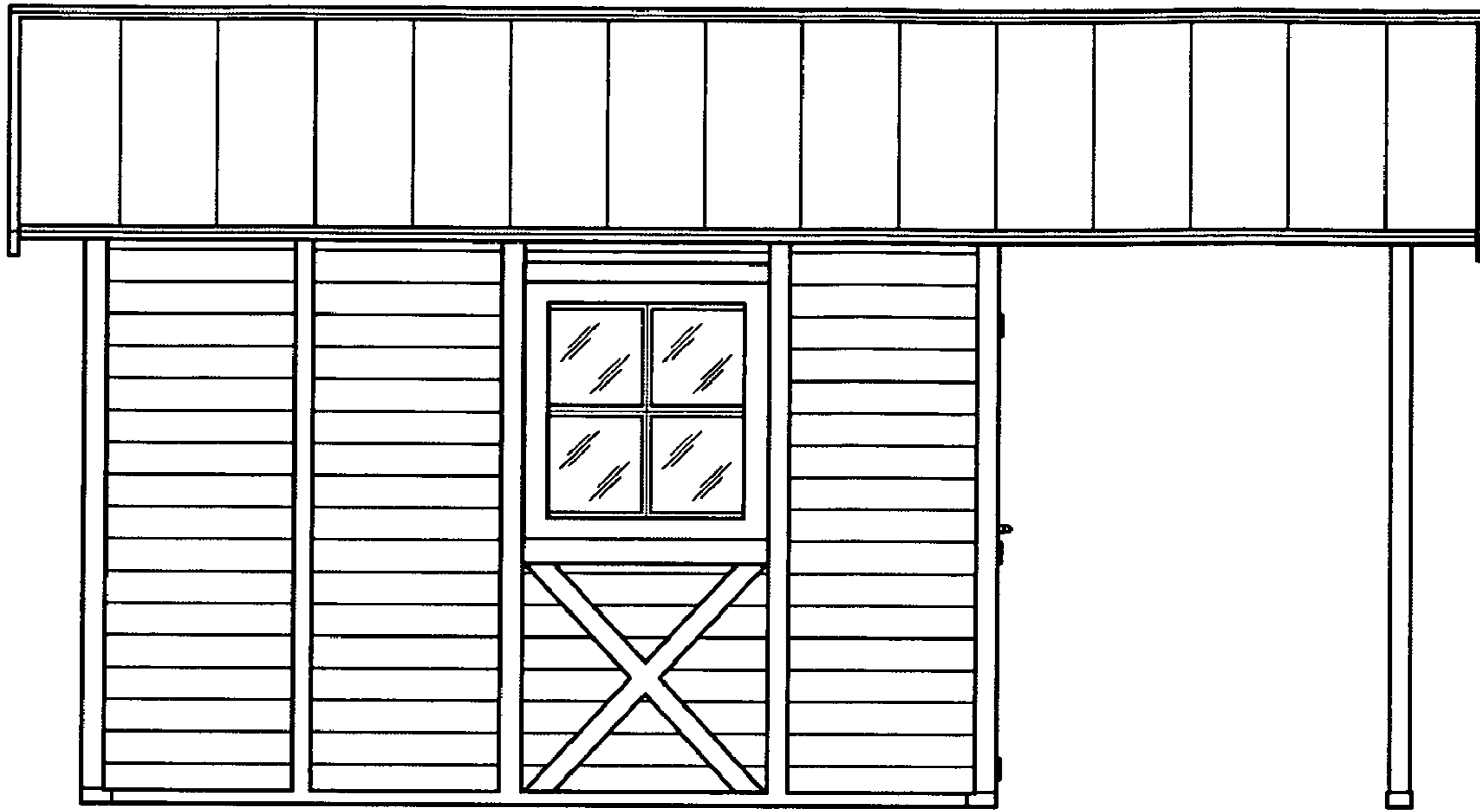
**FIG. 1**



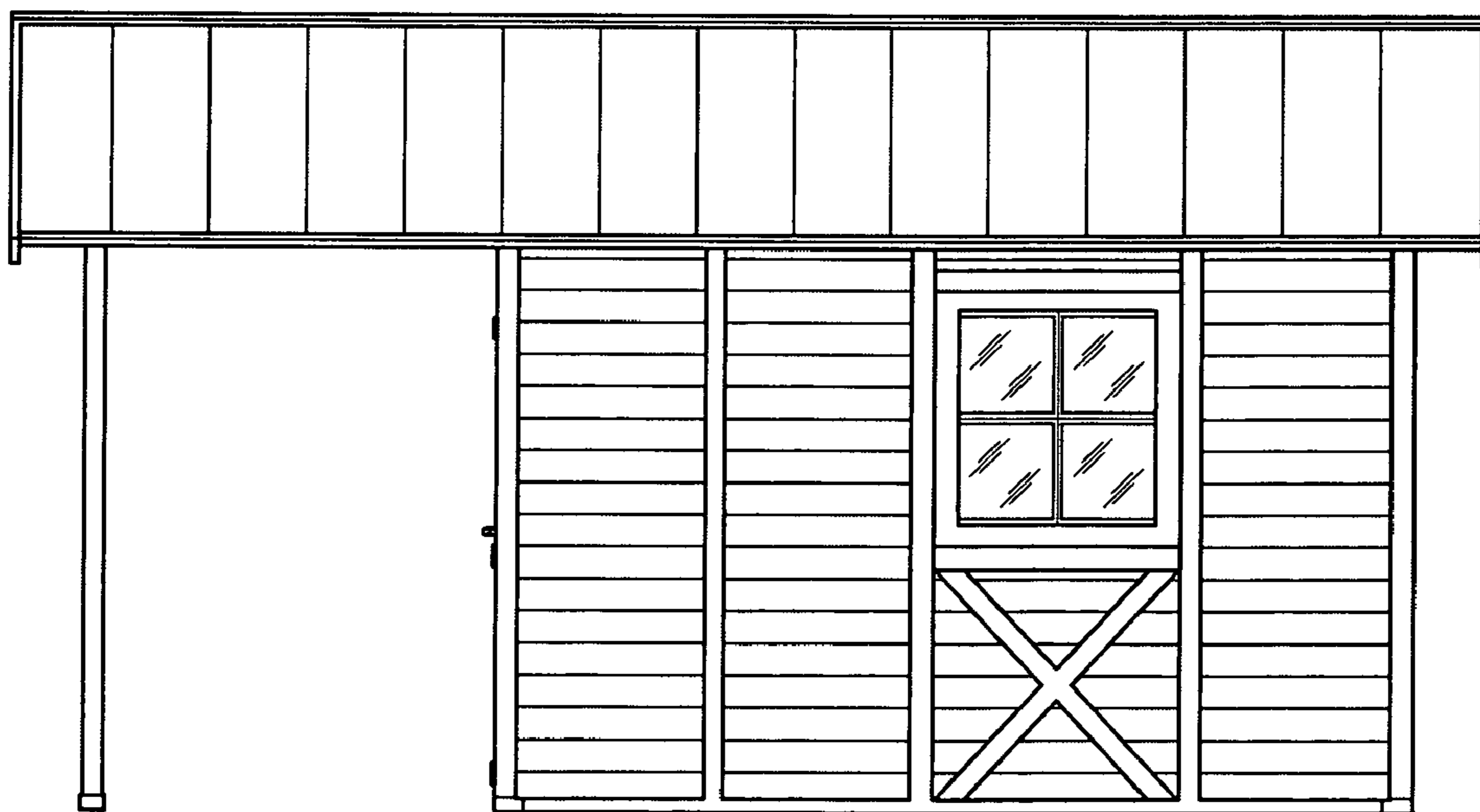
**FIG. 2**



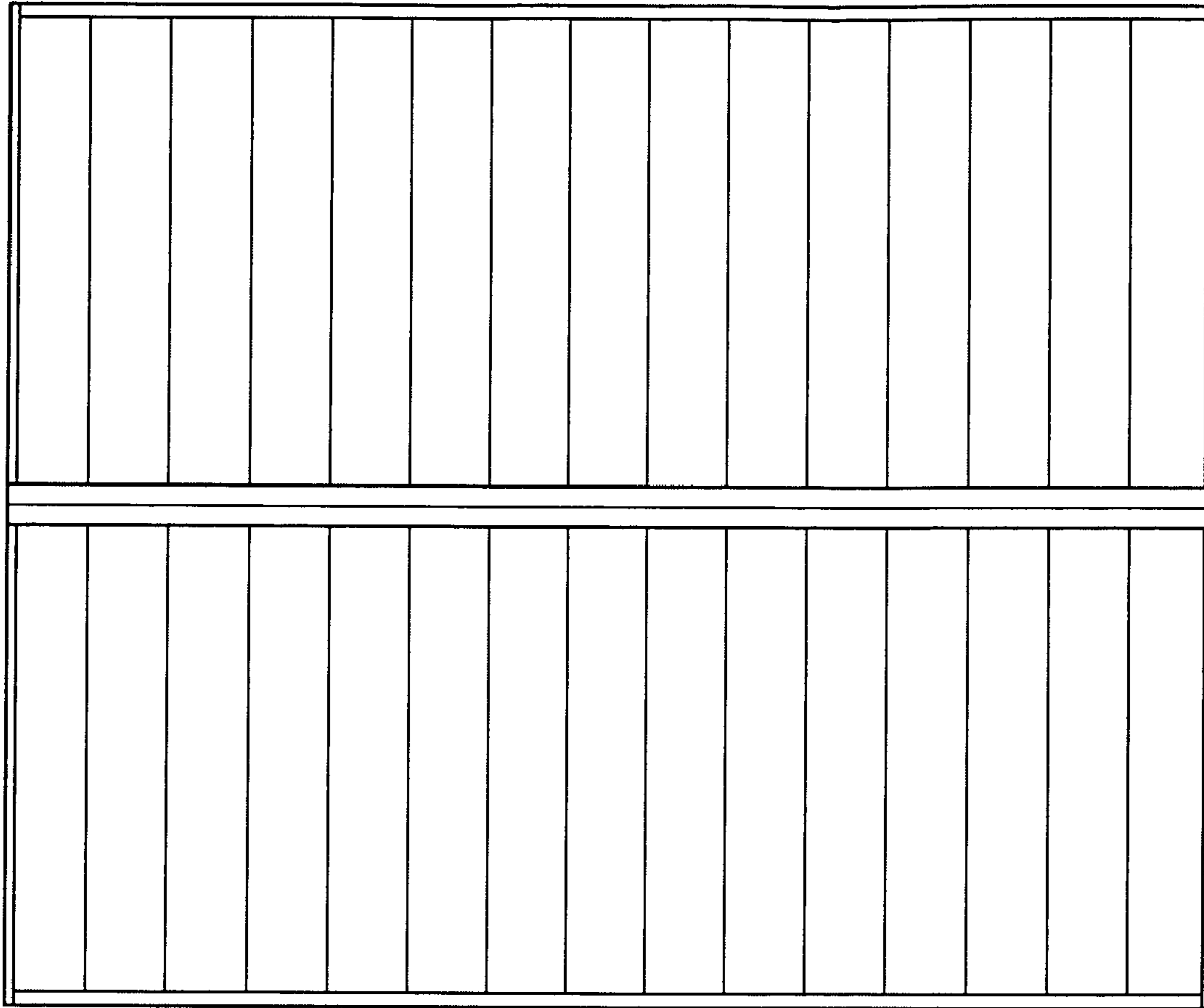
**FIG. 3**



**FIG. 4**

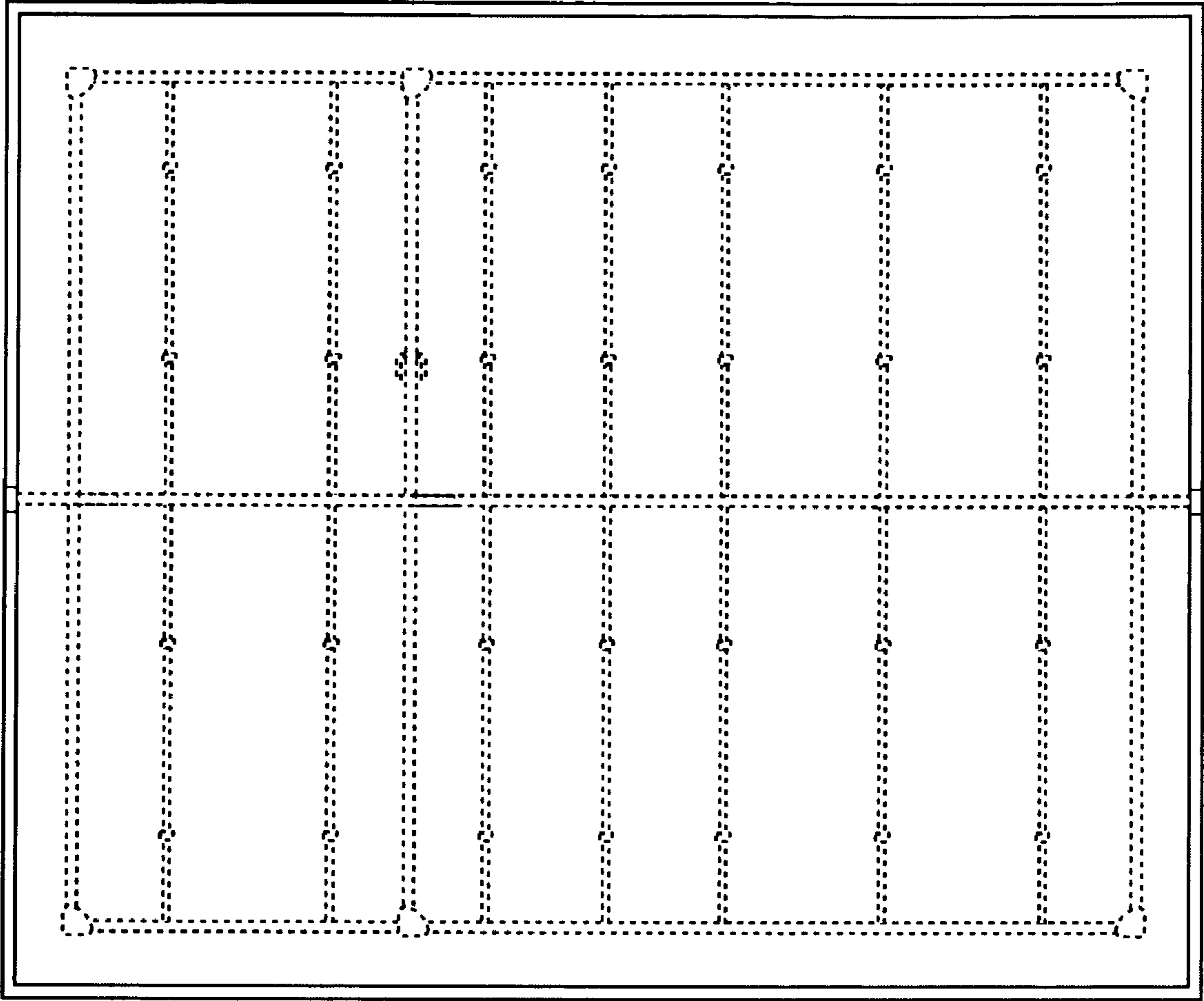


**FIG. 5**



**FIG. 6**





**FIG. 7**