



US00D612784S

(12) **United States Design Patent**
Emler

(10) **Patent No.:** **US D612,784 S**
(45) **Date of Patent:** **** Mar. 30, 2010**

(54) **RESONANCE CHAMBER DISPOSED ABOUT
A CONDUIT CONTOUR OF AN EMISSION
SYSTEM**

(76) Inventor: **Don Emler**, 18033 S. Santa Fe Ave.,
Rancho Dominguez, CA (US) 90221

(**) Term: **14 Years**

(21) Appl. No.: **29/339,827**

(22) Filed: **Jul. 8, 2009**

(51) **LOC (9) Cl.** **12-16**

(52) **U.S. Cl.** **D12/194**

(58) **Field of Classification Search** D12/194,
D12/190, 400, 114; D15/5; D21/145-147;
280/152.1-152.3, 160.1, 304.3, 770, 848,
280/552; 181/239-243, 227, 249, 255, 228,
181/247, 252, 284; 60/323, 276, 272; 123/41.73,
123/41.7, 184.34, 184.36

See application file for complete search history.

(56) **References Cited**

U.S. PATENT DOCUMENTS

D165,057 S *	11/1951	Deremer	D12/194
4,537,278 A *	8/1985	Okada et al.	181/227
4,693,338 A *	9/1987	Clerc	181/231
4,756,383 A *	7/1988	Sterrett	181/243
D452,694 S *	1/2002	Irie	D15/5
6,415,889 B1 *	7/2002	Wyatt	181/282
D488,755 S *	4/2004	Kulla	D12/194
6,827,173 B2 *	12/2004	Lai	180/309
6,892,852 B2 *	5/2005	Klein	181/227
7,044,266 B2 *	5/2006	Petracek	181/269
D533,189 S *	12/2006	Bender	D15/5
D534,848 S *	1/2007	Murkett	D12/194
D558,111 S *	12/2007	Banks, III	D12/194
7,331,422 B2 *	2/2008	Wall	181/279
7,380,397 B2 *	6/2008	Chang	60/324
D574,309 S *	8/2008	Unfried et al.	D12/194
D575,213 S *	8/2008	Kryssing et al.	D12/194

D578,050 S *	10/2008	Hsu	D12/194
D581,335 S *	11/2008	Contreras	D12/194
7,464,787 B2 *	12/2008	Davis, Jr.	181/227
7,506,722 B2	3/2009	Emler		
7,510,050 B2	3/2009	Emler		
7,552,797 B2	6/2009	Luttig		
2005/0139417 A1 *	6/2005	Quast	181/227

OTHER PUBLICATIONS

U.S. Appl. No. 29/339,825, filed Jul. 8, 2009, 1 page.
U.S. Appl. No. 29/339,826, filed Jul. 8, 2009, 1 page.

* cited by examiner

Primary Examiner—Robert M Spear

Assistant Examiner—Cynthia Underwood

(74) *Attorney, Agent, or Firm*—Shook Hardy & Bacon, LLP

(57) **CLAIM**

The ornamental design for a resonance chamber disposed about a conduit contour of an emission system, as shown and described.

DESCRIPTION

FIG. 1 is a perspective view of a resonance chamber disposed about a conduit contour of an emission system of the present invention;

FIG. 2 is a front side elevation view thereof;

FIG. 3 is a back side elevational view thereof;

FIG. 4 is a top plan view thereof, a bottom plan view thereof being a minor image thereof; and,

FIG. 5 is a right side elevational view thereof, a left side elevation view thereof being a minor image thereof.

The broken lines shown in the drawings are directed toward environment, are for informational purposes only, and form no part of the claimed design. The boundary lines of the conduit are shown in evenly spaced, dashed lines and are not intended to form part of the claimed design.

1 Claim, 2 Drawing Sheets

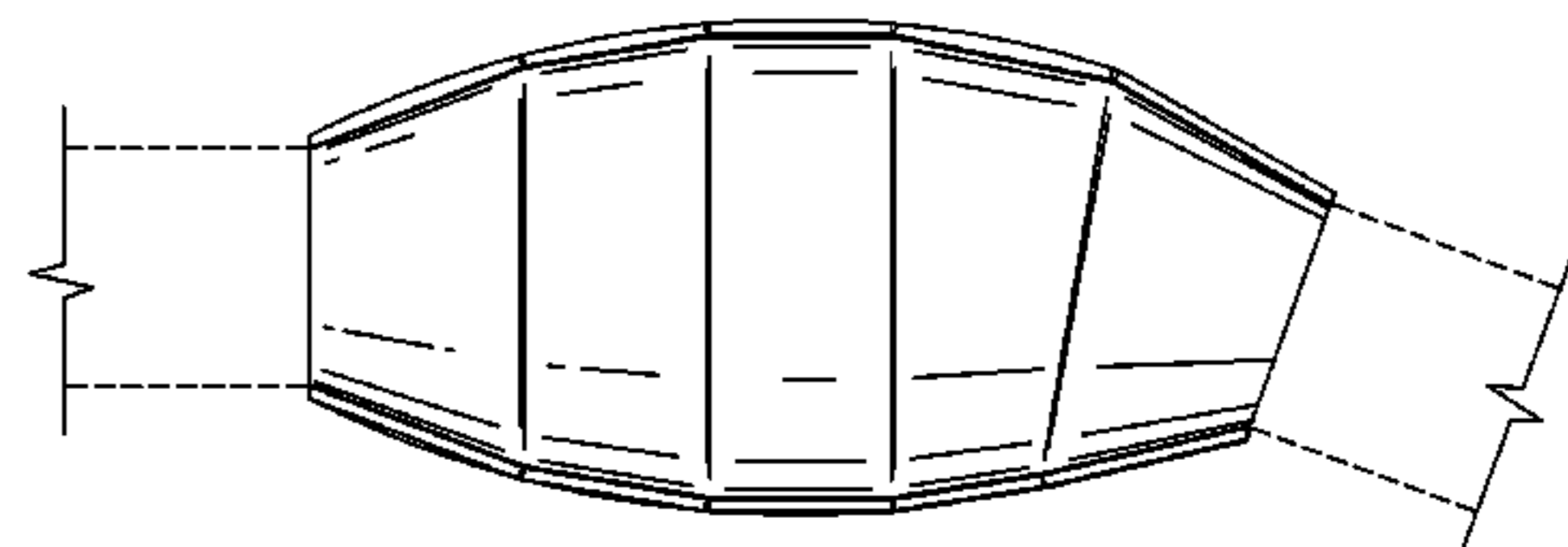
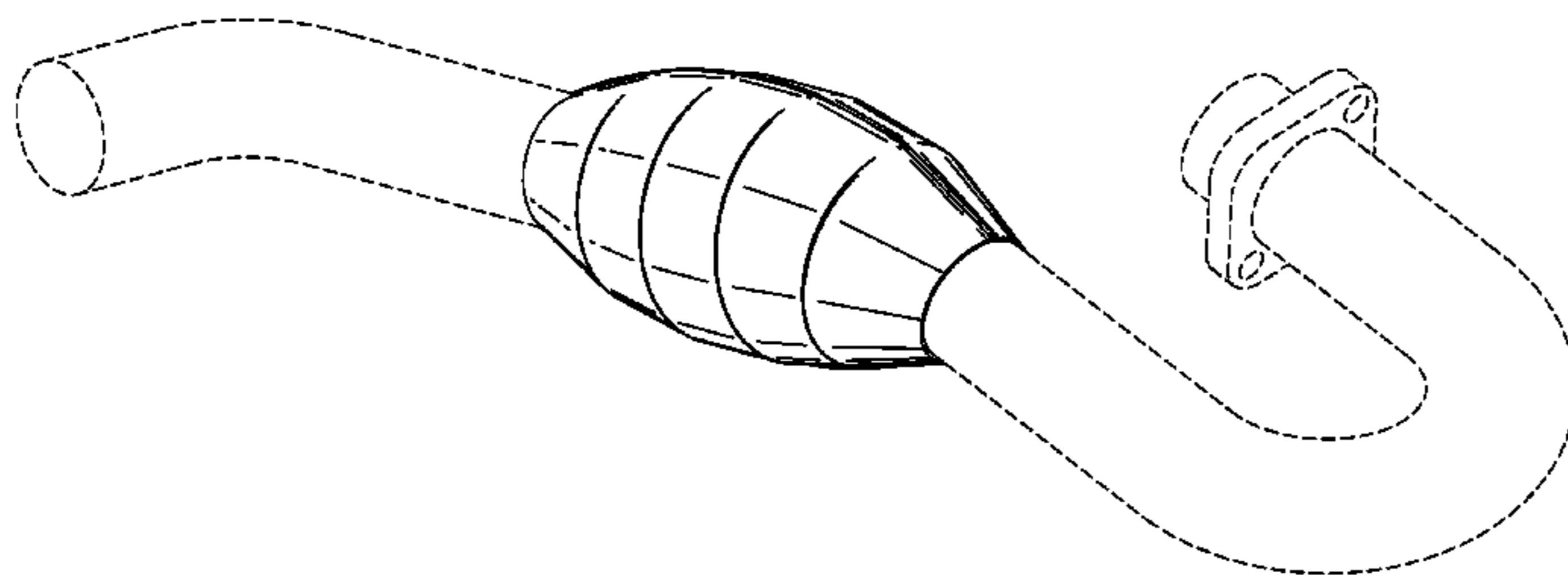

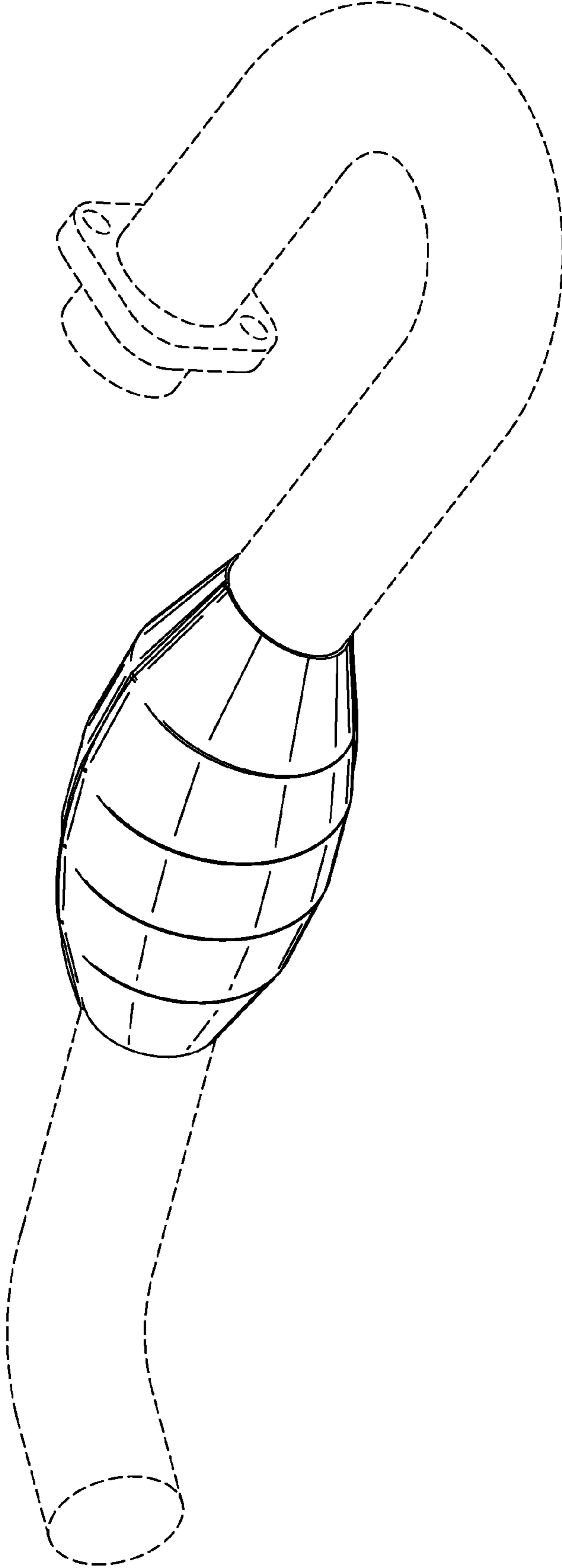

FIG. 1

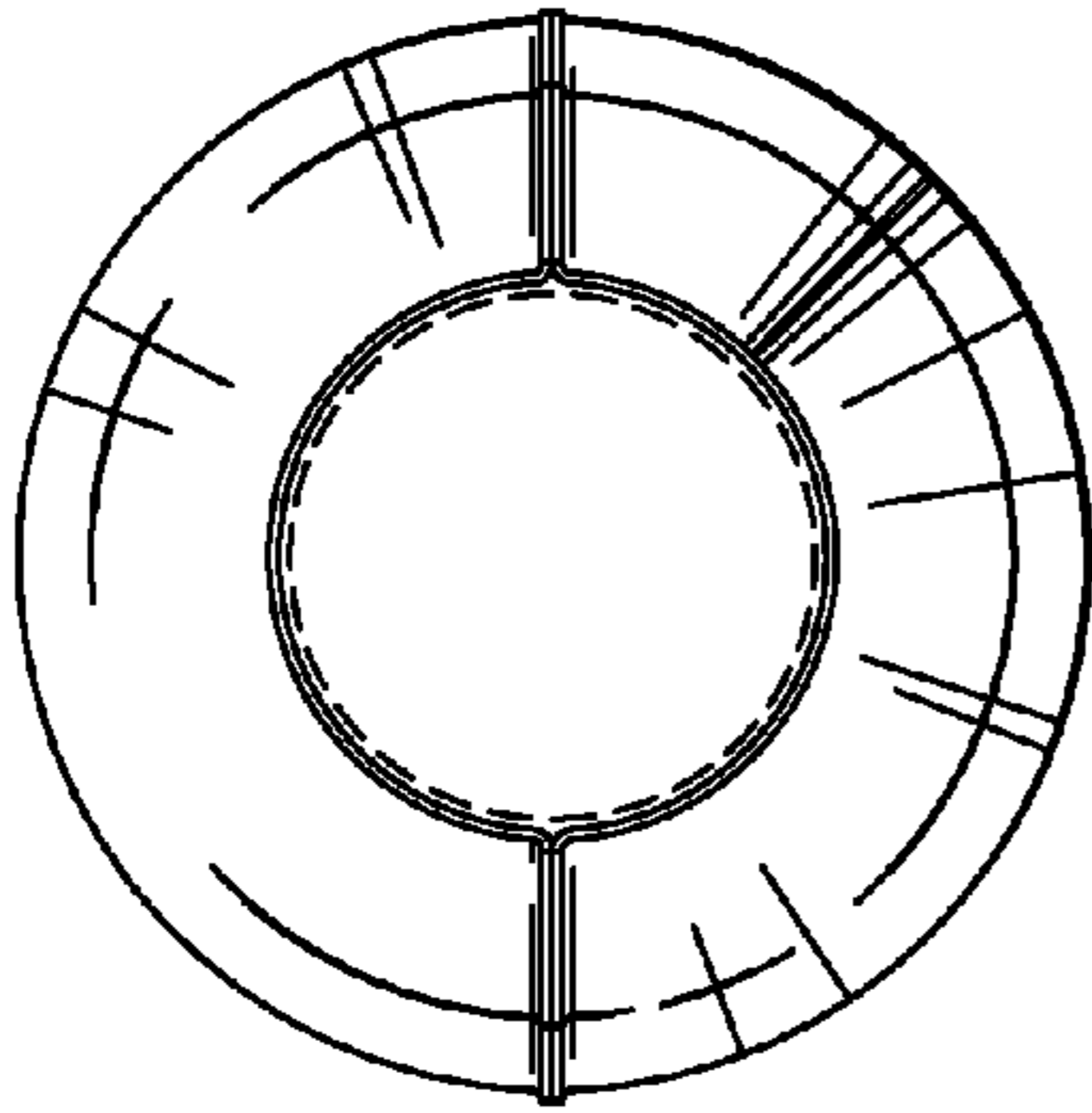

FIG. 2

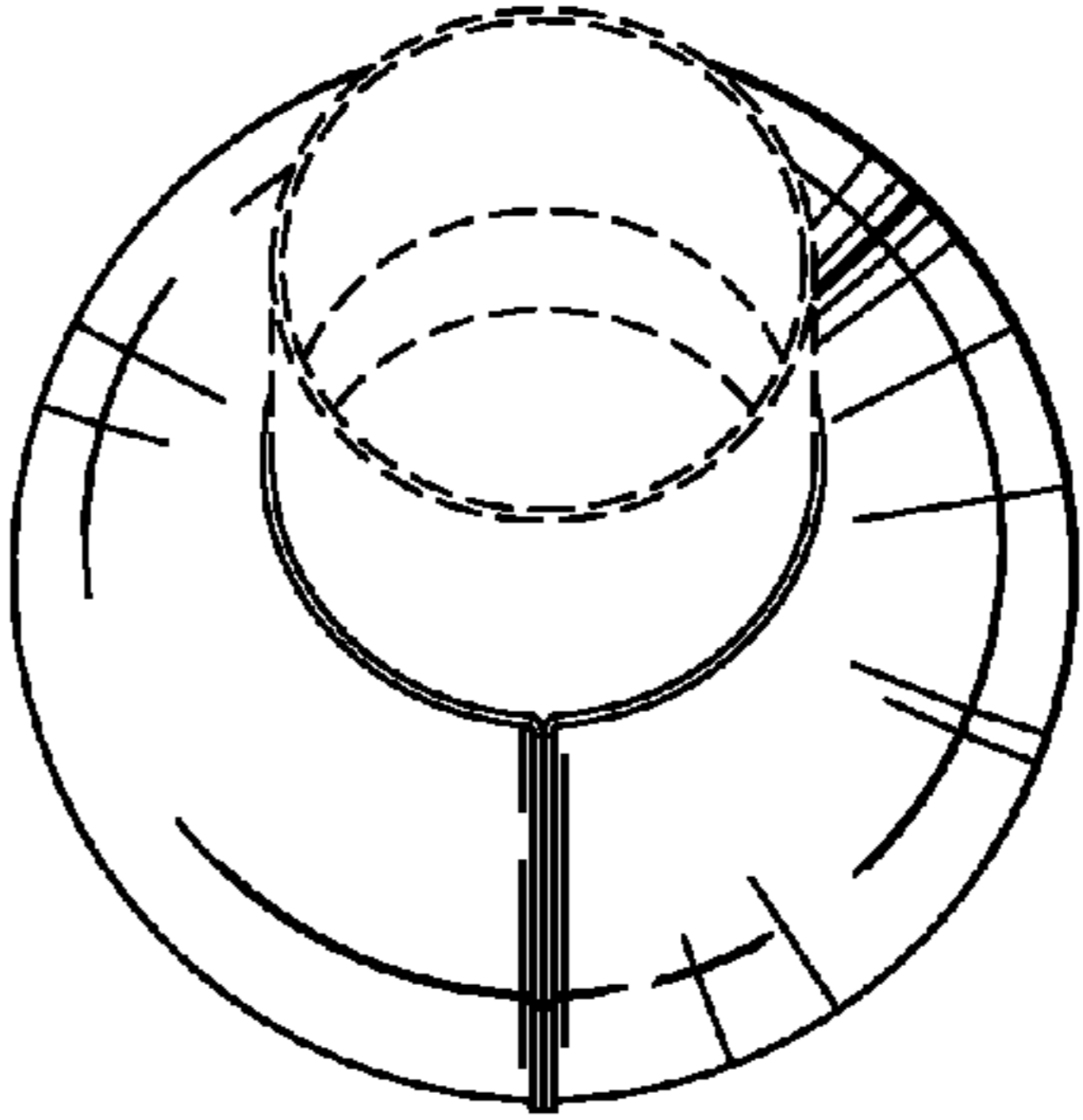

FIG. 3

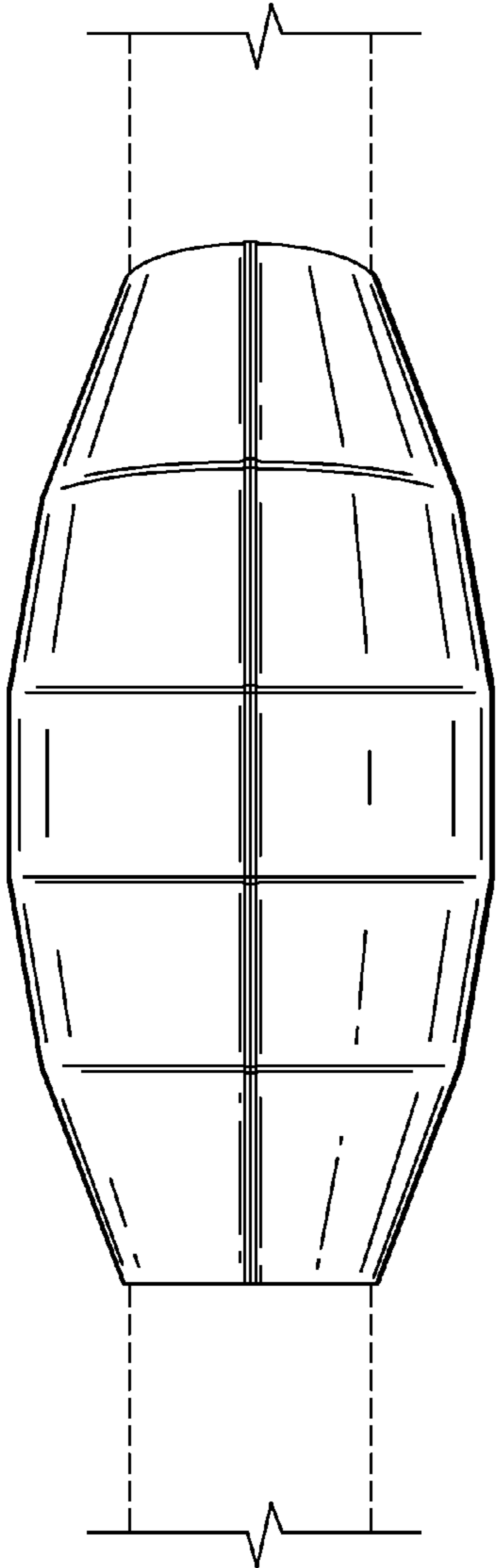

FIG. 4

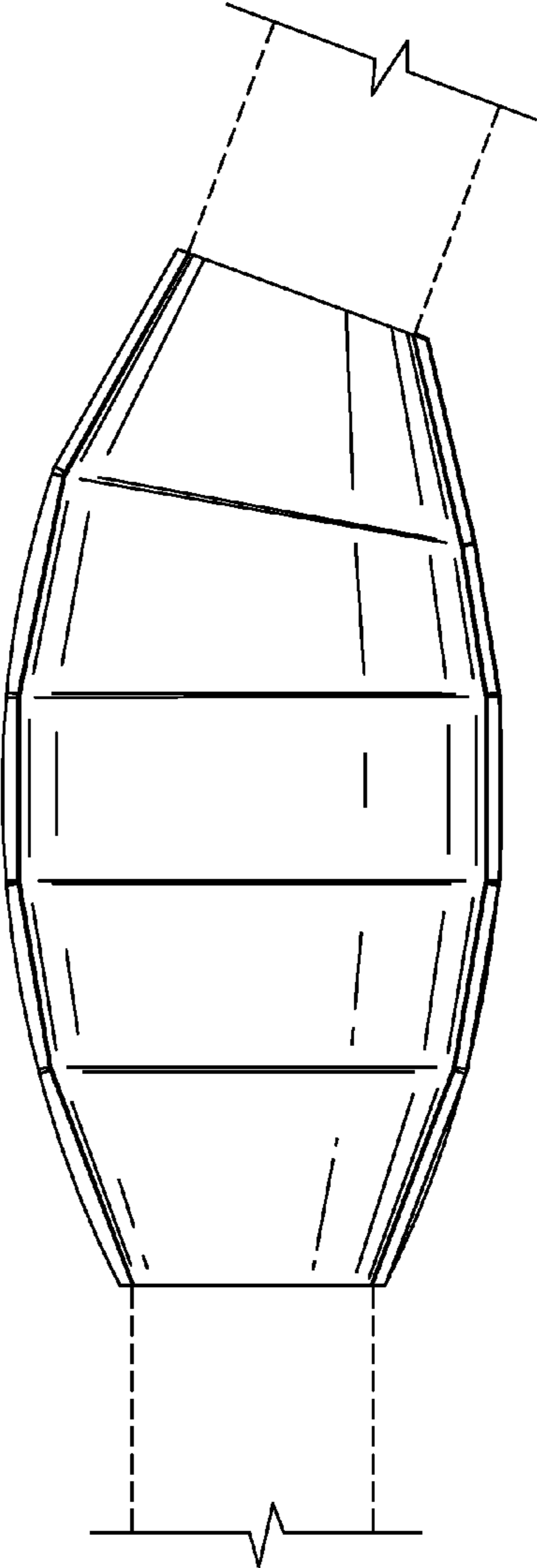

FIG. 5