



US00D612783S

(12) **United States Design Patent**
Emler

(10) **Patent No.:** **US D612,783 S**
(45) **Date of Patent:** **** Mar. 30, 2010**

(54) **RESONANCE CHAMBER OFFSET ON A CONDUIT OF AN EMISSION SYSTEM**

7,510,050 B2 3/2009 Emler
7,552,797 B2 6/2009 Luttig
2005/0139417 A1* 6/2005 Quast 181/227

(76) Inventor: **Don Emler**, 18033 S. Santa Fe Ave.,
Rancho Dominguez, CA (US) 90221

OTHER PUBLICATIONS

U.S. Appl. No. 29/339,827, filed Jul. 8, 2009, 1 page.
U.S. Appl. No. 29/339,826, filed Jul. 8, 2009, 1 page.

(**) Term: **14 Years**

* cited by examiner

(21) Appl. No.: **29/339,825**

Primary Examiner—Robert M Spear

(22) Filed: **Jul. 8, 2009**

Assistant Examiner—Cynthia Underwood

(51) **LOC (9) Cl.** **12-16**

(74) *Attorney, Agent, or Firm*—Shook Hardy & Bacon, LLP

(52) **U.S. Cl.** **D12/194**

(57) **CLAIM**

(58) **Field of Classification Search** D12/194,
D12/190, 400, 114; D15/5; D21/145; 280/152.1–152.3,
280/160.1, 304.3, 770, 848, 552; 181/239–243,
181/227, 249, 255, 228, 247, 252, 284; 60/323,
60/276, 272; 123/41.73, 41.7, 184.34, 184.36

The ornamental design for a resonance chamber offset on a conduit of an emission system, as shown and described.

See application file for complete search history.

DESCRIPTION

(56) **References Cited**

FIG. 1 is a perspective view of a resonance chamber offset on a conduit of an emission system of the present invention;

U.S. PATENT DOCUMENTS

FIG. 2 is a top plan view thereof, a bottom plan view thereof being a minor image thereof;

- D165,057 S * 11/1951 Deremer D12/194
- 4,537,278 A * 8/1985 Okada et al. 181/227
- 4,756,383 A * 7/1988 Sterrett 181/243
- 6,415,889 B1 * 7/2002 Wyatt 181/282
- D488,755 S * 4/2004 Kulla D12/194
- 6,827,173 B2 * 12/2004 Lai 180/309
- 6,892,852 B2 * 5/2005 Klein 181/227
- 7,044,266 B2 * 5/2006 Petracek 181/269
- D534,848 S * 1/2007 Murkett D12/194
- D574,309 S * 8/2008 Unfried et al. D12/194
- D578,050 S * 10/2008 Hsu D12/194
- 7,464,787 B2 * 12/2008 Davis, Jr. 181/227
- 7,506,722 B2 3/2009 Emler

FIG. 3 is a right side elevational view thereof, a left side elevation view thereof being a minor image thereof; and,

FIG. 4 is a front side elevation view thereof, a back side elevational view thereof being a mirror image thereof.

The broken lines shown in the drawings are directed toward environment, are for informational purposes only, and form no part of the claimed design. The boundary lines of the conduit are shown in evenly spaced, dashed lines and are not intended to form part of the claimed design.

1 Claim, 2 Drawing Sheets

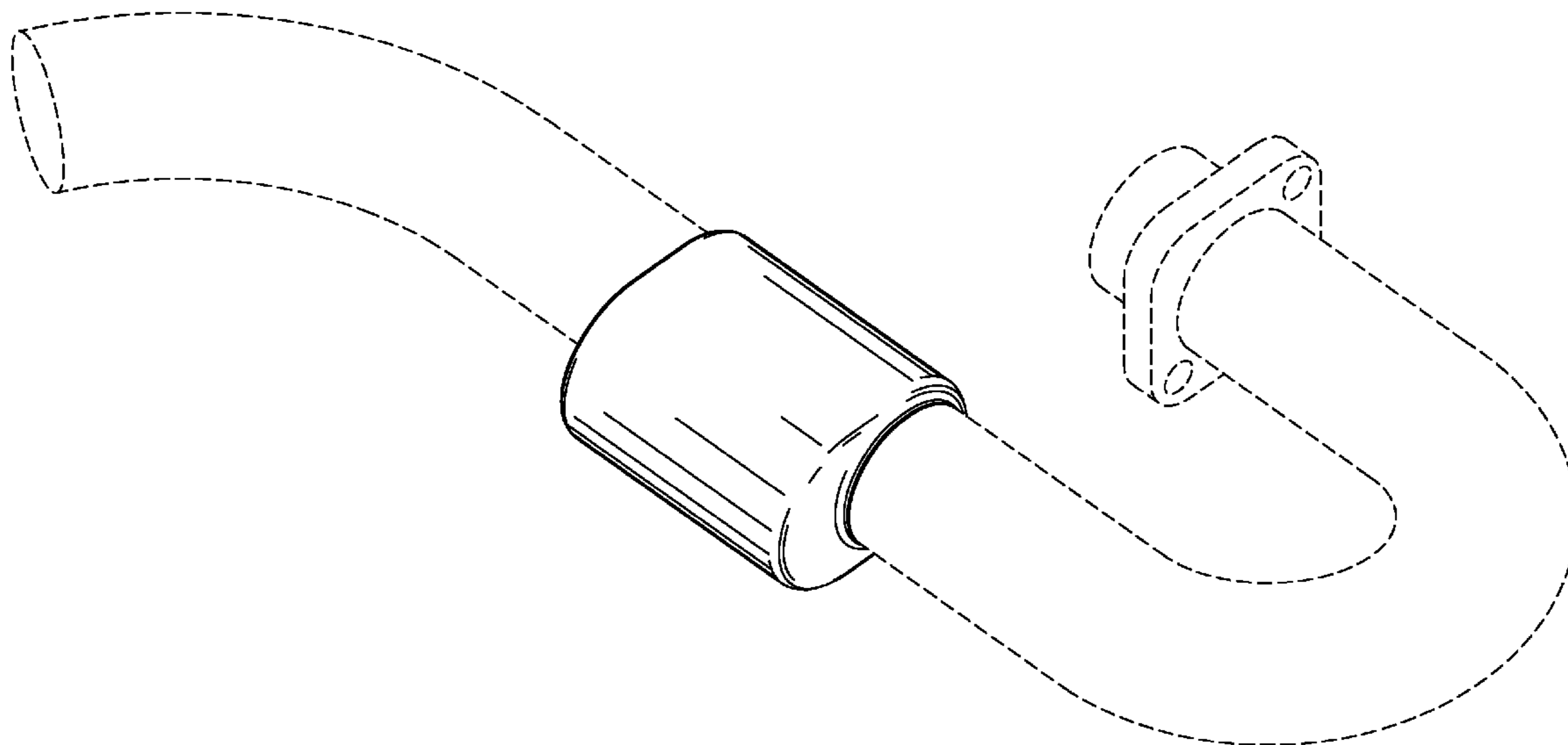

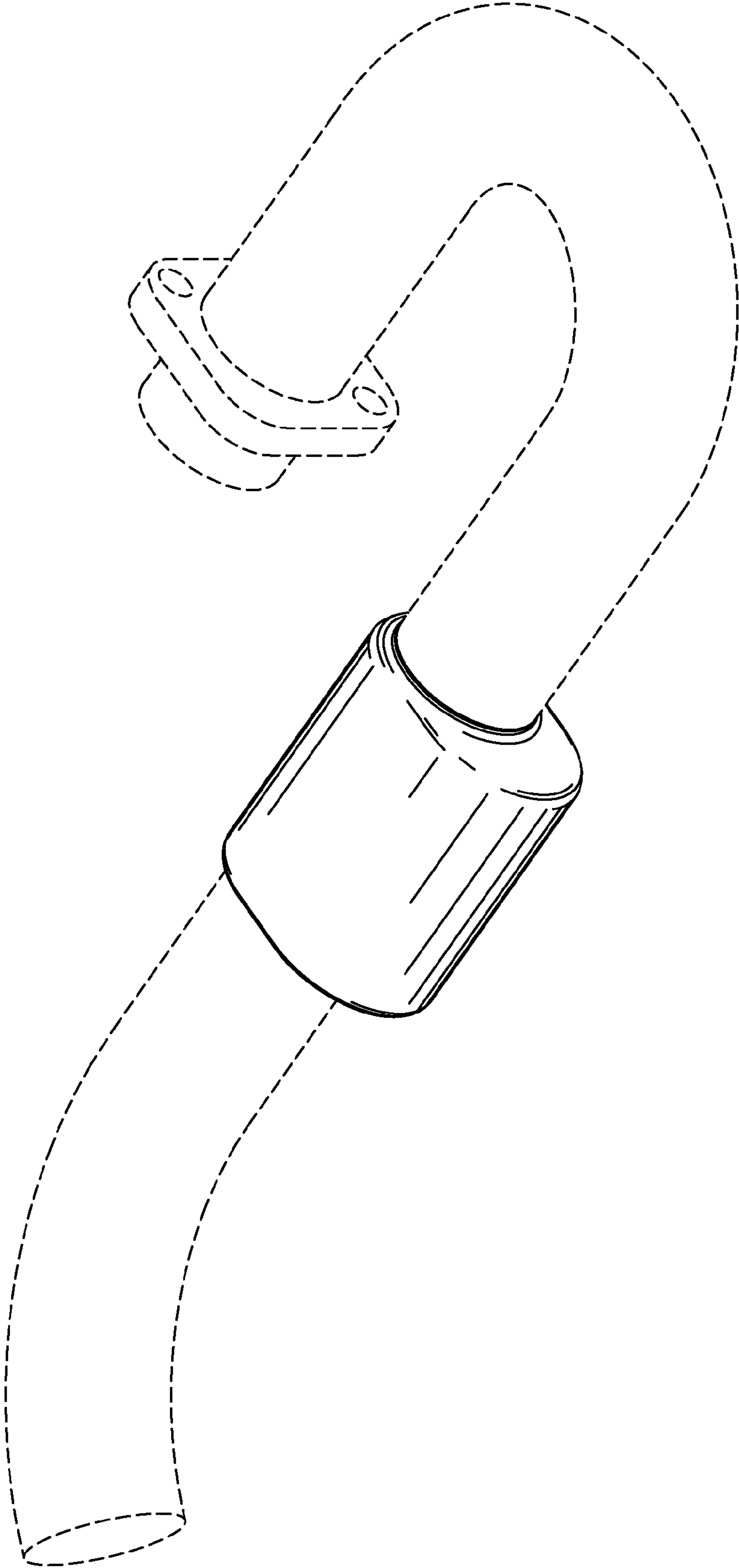

FIG. 1

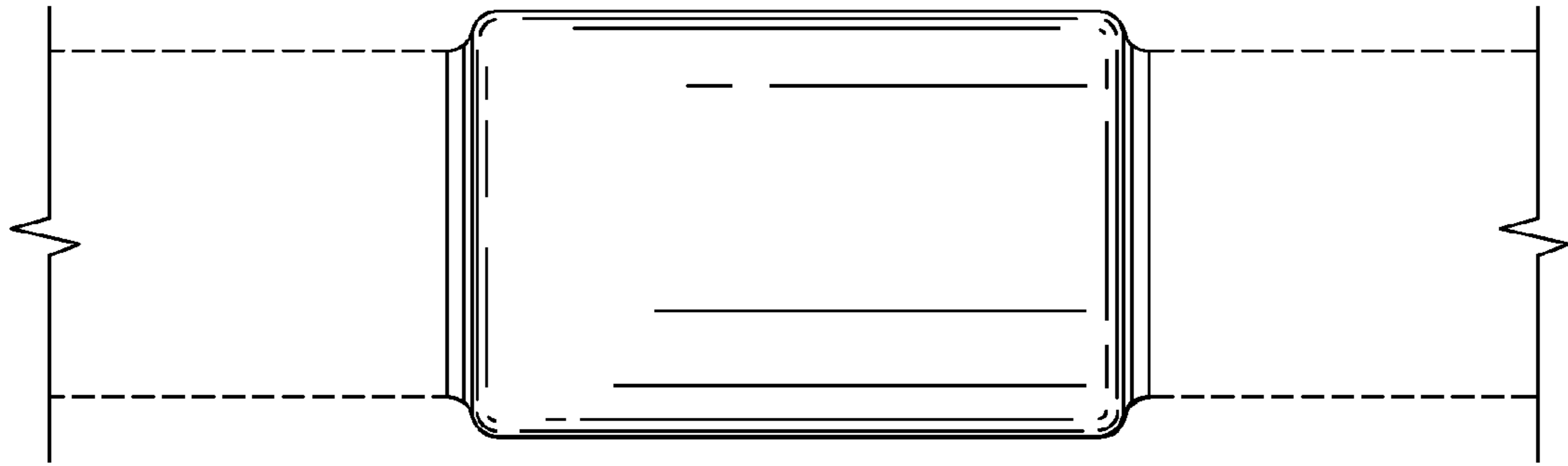

FIG. 2

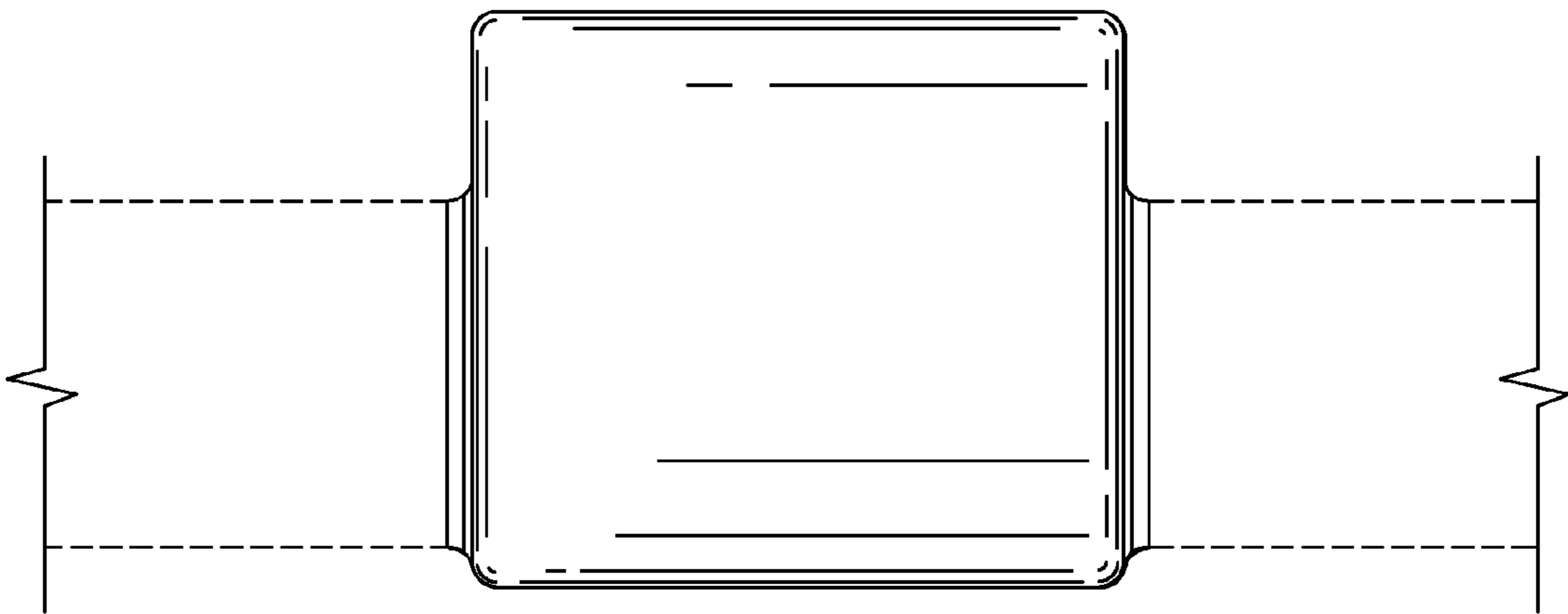

FIG. 3

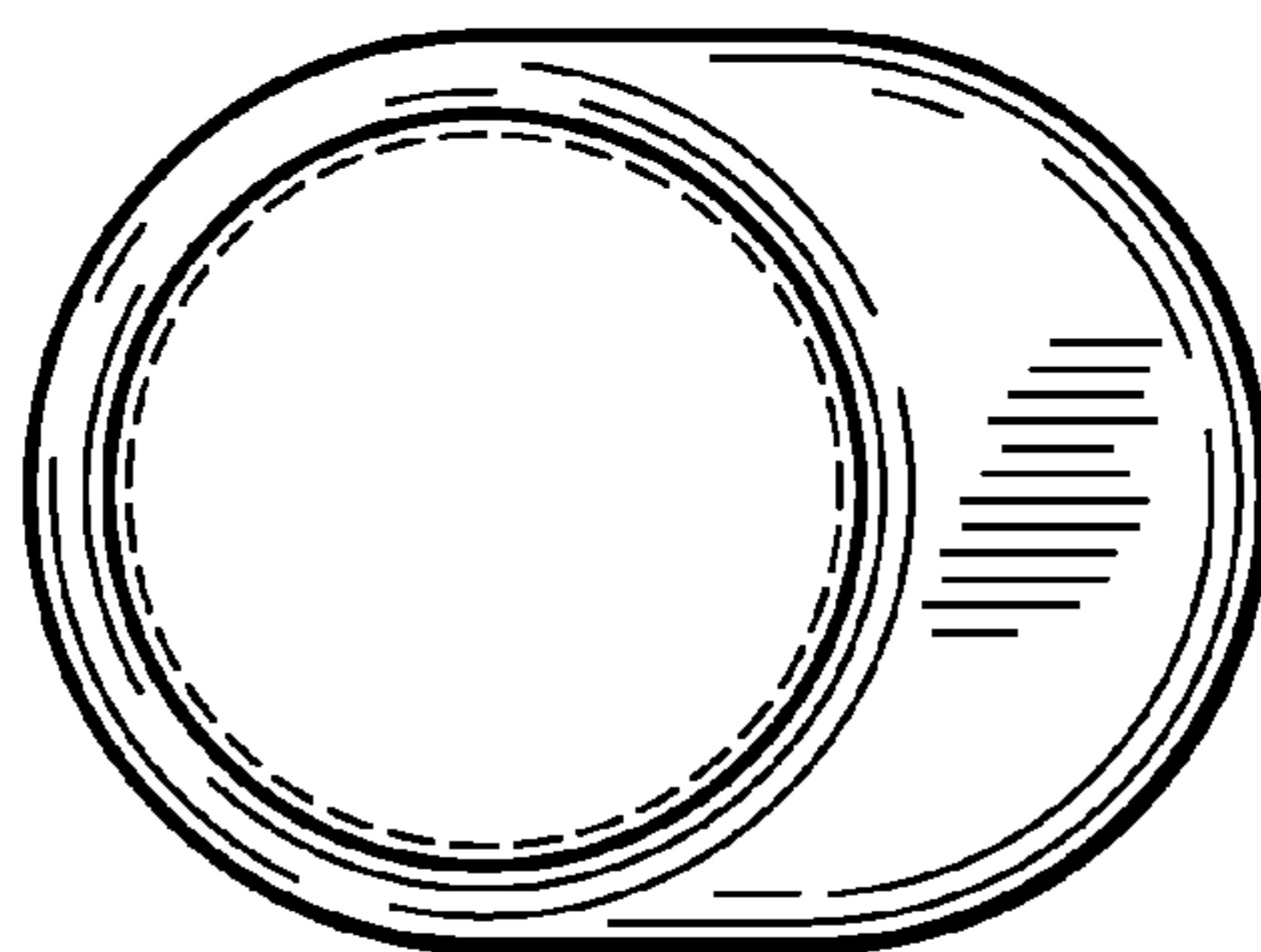

FIG. 4