



US00D612340S

(12) **United States Design Patent**
Mayo et al.

(10) **Patent No.:** **US D612,340 S**
(45) **Date of Patent:** **** Mar. 23, 2010**

(54) **KEYCARD SWITCH**

(75) Inventors: **Noel Mayo**, Philadelphia, PA (US);
Gregory Altonen, Easton, PA (US);
Elliot G. Jacoby, Glenside, PA (US);
Alexandre François Ledoux, Lower
Gwynedd, PA (US); **Michael Hash**, West
Conshohocken, PA (US)

(73) Assignee: **Lutron Electronics Co., Inc.**,
Coopersburg, PA (US)

(**) Term: **14 Years**

(21) Appl. No.: **29/340,015**

(22) Filed: **Jul. 13, 2009**

Related U.S. Application Data

(62) Division of application No. 29/317,001, filed on Apr.
21, 2008, now Pat. No. Des. 598,399.

(51) **LOC (9) Cl.** **13-03**

(52) **U.S. Cl.** **D13/174**

(58) **Field of Classification Search** D13/162,
D13/164, 171; 174/66; 200/5 R, 293, 296,
200/329, 333, 520, 530, 552; 315/291-296;
307/112, 125, 139; D8/330, 338; D14/385;
235/482

See application file for complete search history.

(56) **References Cited**

U.S. PATENT DOCUMENTS

3,706,874 A * 12/1972 Lockard 235/473

D260,259 S * 8/1981 Crowley et al. D14/385
6,012,636 A * 1/2000 Smith 235/380
D524,857 S * 7/2006 Graves et al. D19/9
D598,399 S * 8/2009 Mayo et al. D13/171

* cited by examiner

Primary Examiner—Selina Sikder

(74) *Attorney, Agent, or Firm*—Mark E. Rose; Philip N.
Smith

(57) **CLAIM**

We claim the ornamental design for a keycard switch, as
shown and described.

DESCRIPTION

FIG. 1 is a perspective view of a keycard switch according to
our new design.

FIG. 2 is a front view thereof.

FIG. 3 is a left side view thereof.

FIG. 4 is a right side view thereof.

FIG. 5 is a top view thereof; and,

FIG. 6 is a bottom view thereof.

The rear view forms no part of the design and is omitted. The
portions of the drawings appearing in broken line are for
environment only and do not form a part of the claimed
design.

1 Claim, 4 Drawing Sheets

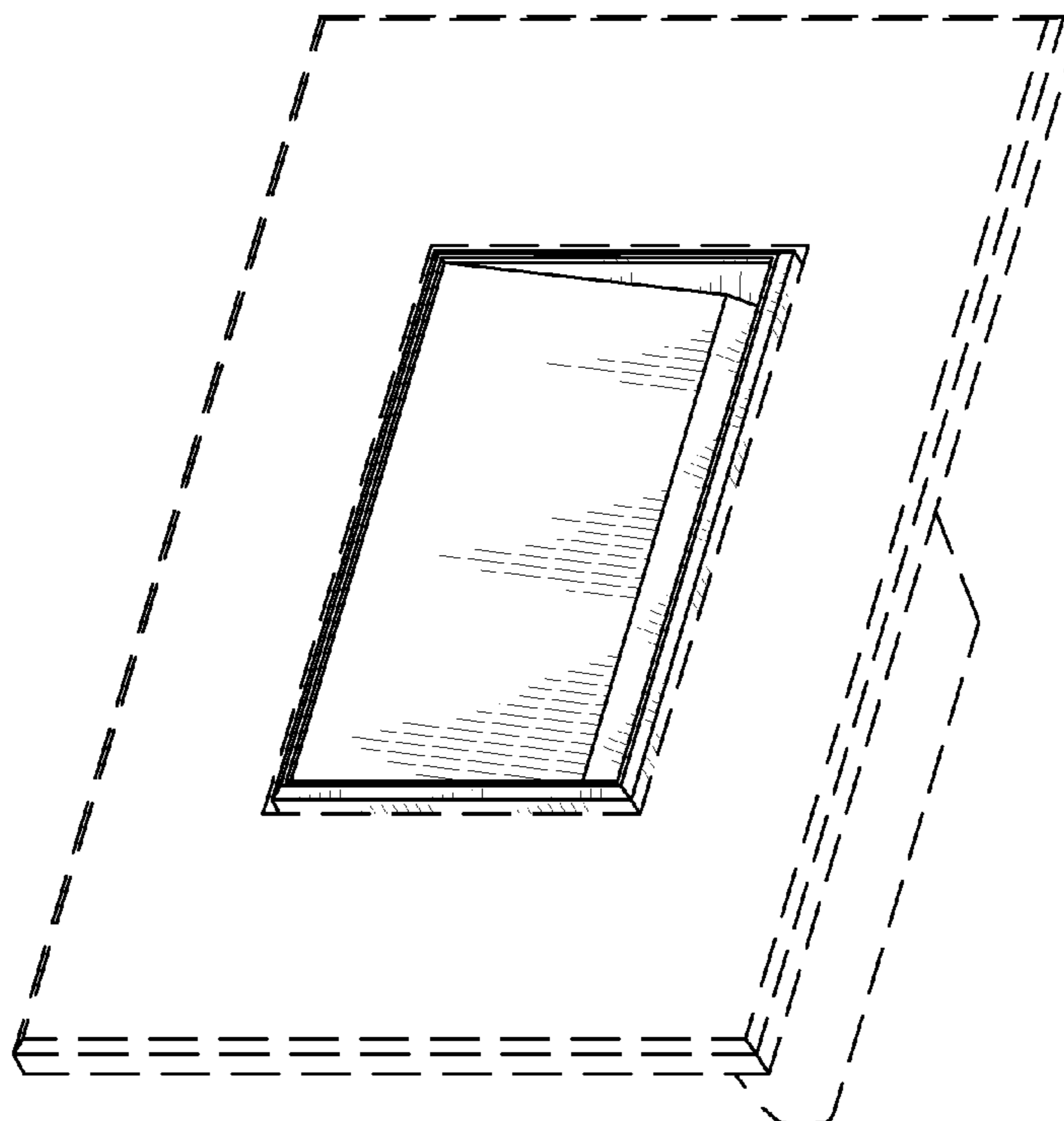

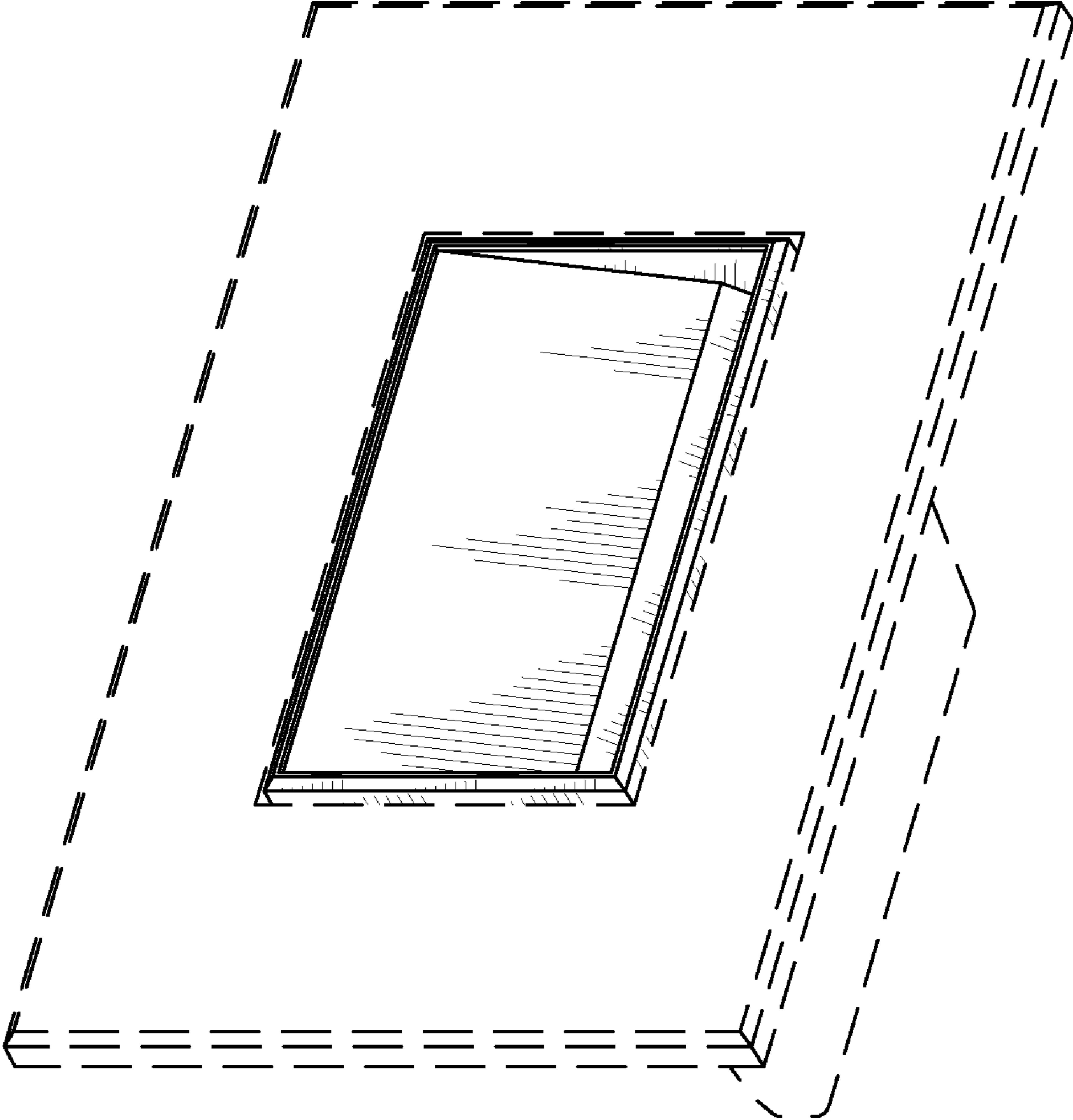

Fig. 1

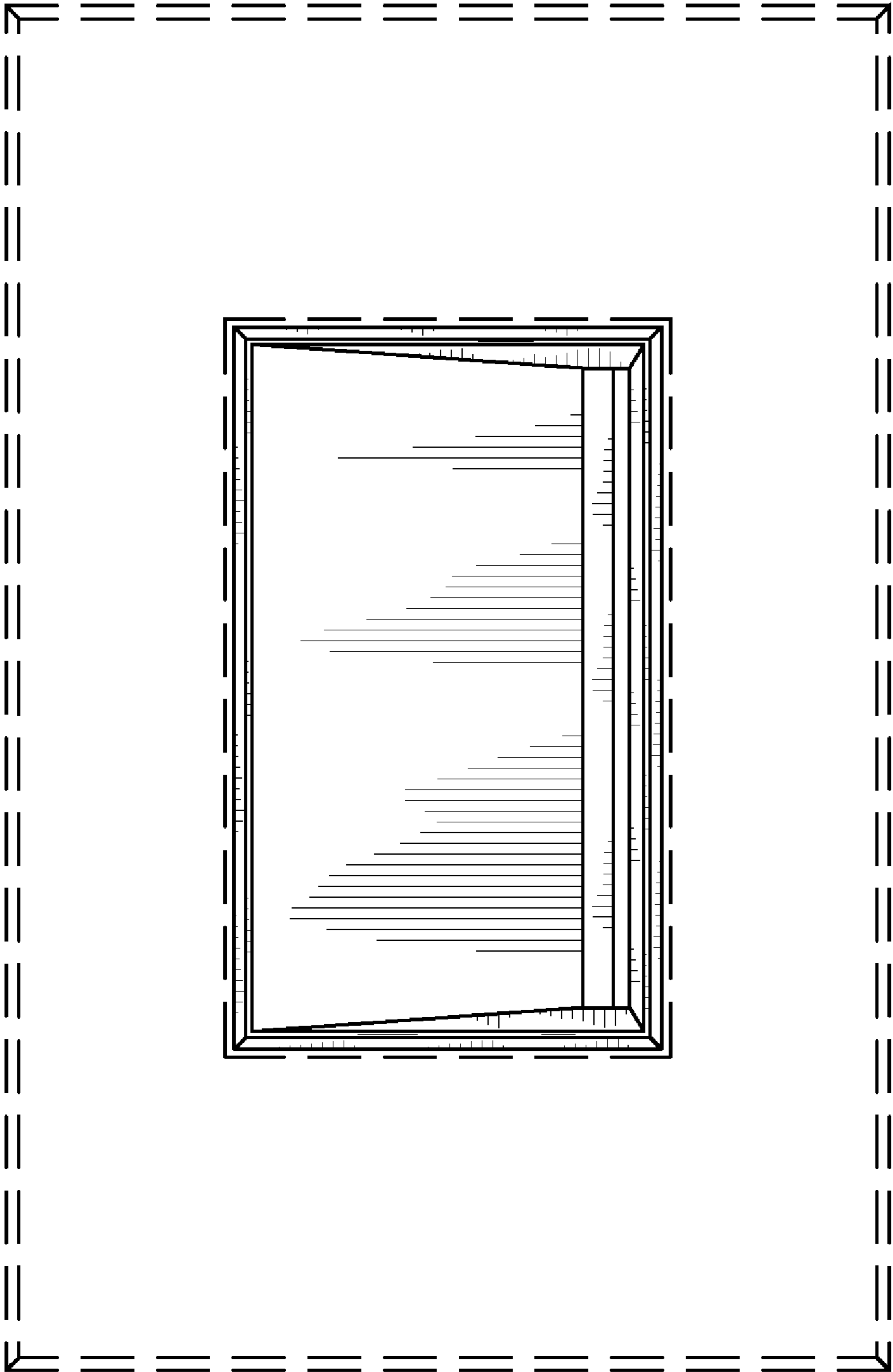

Fig. 2

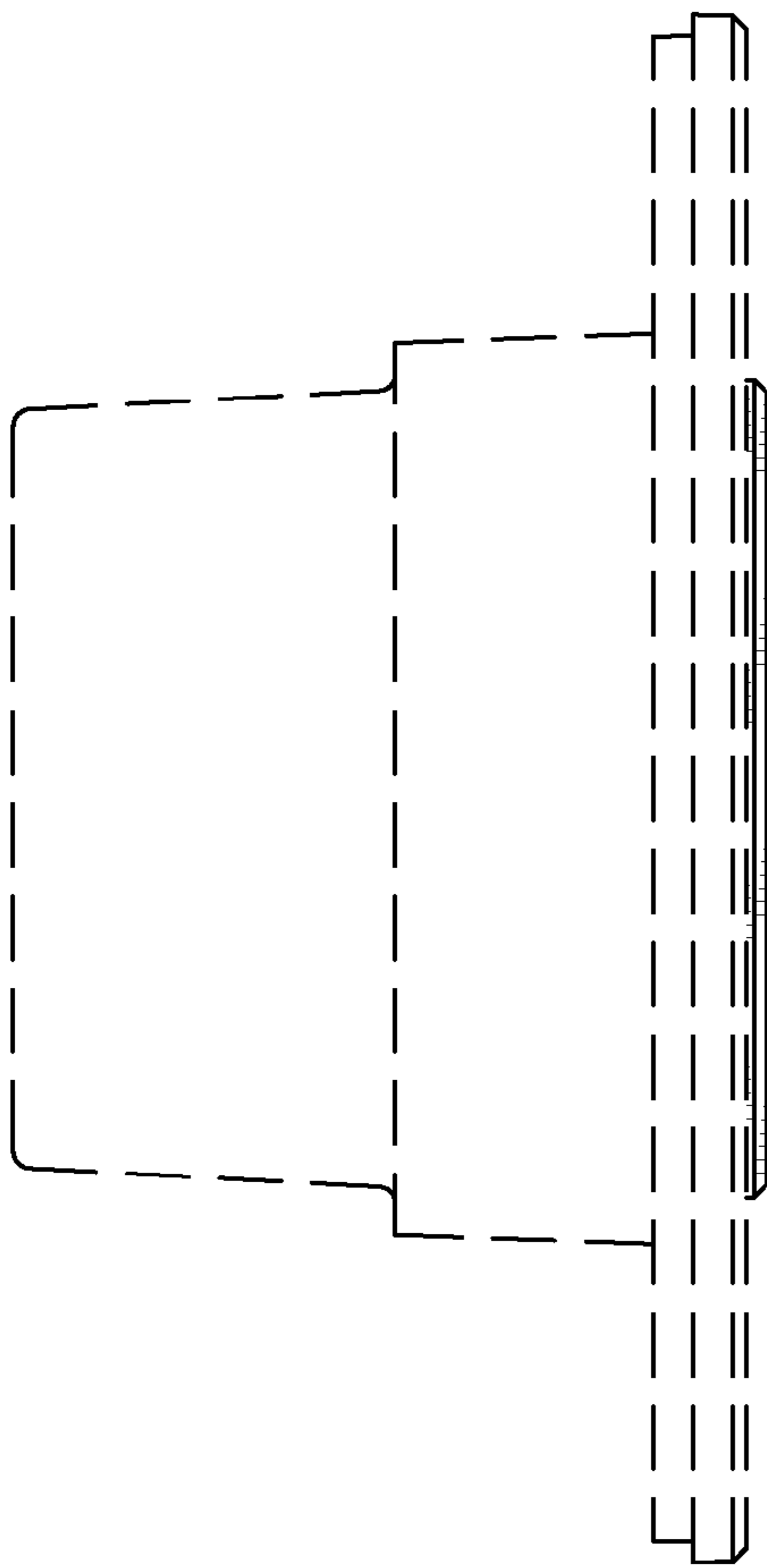

Fig. 3

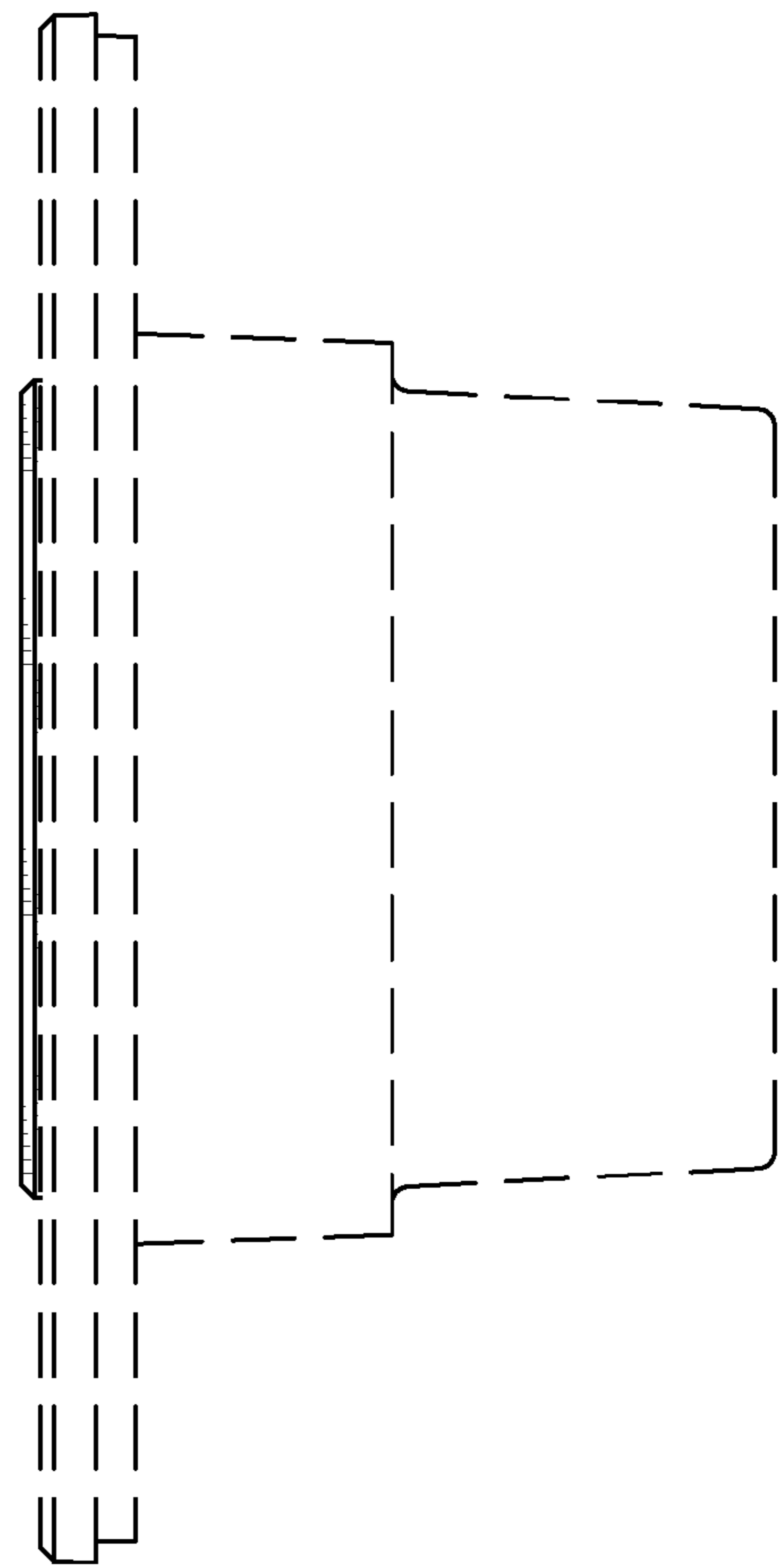

Fig. 4

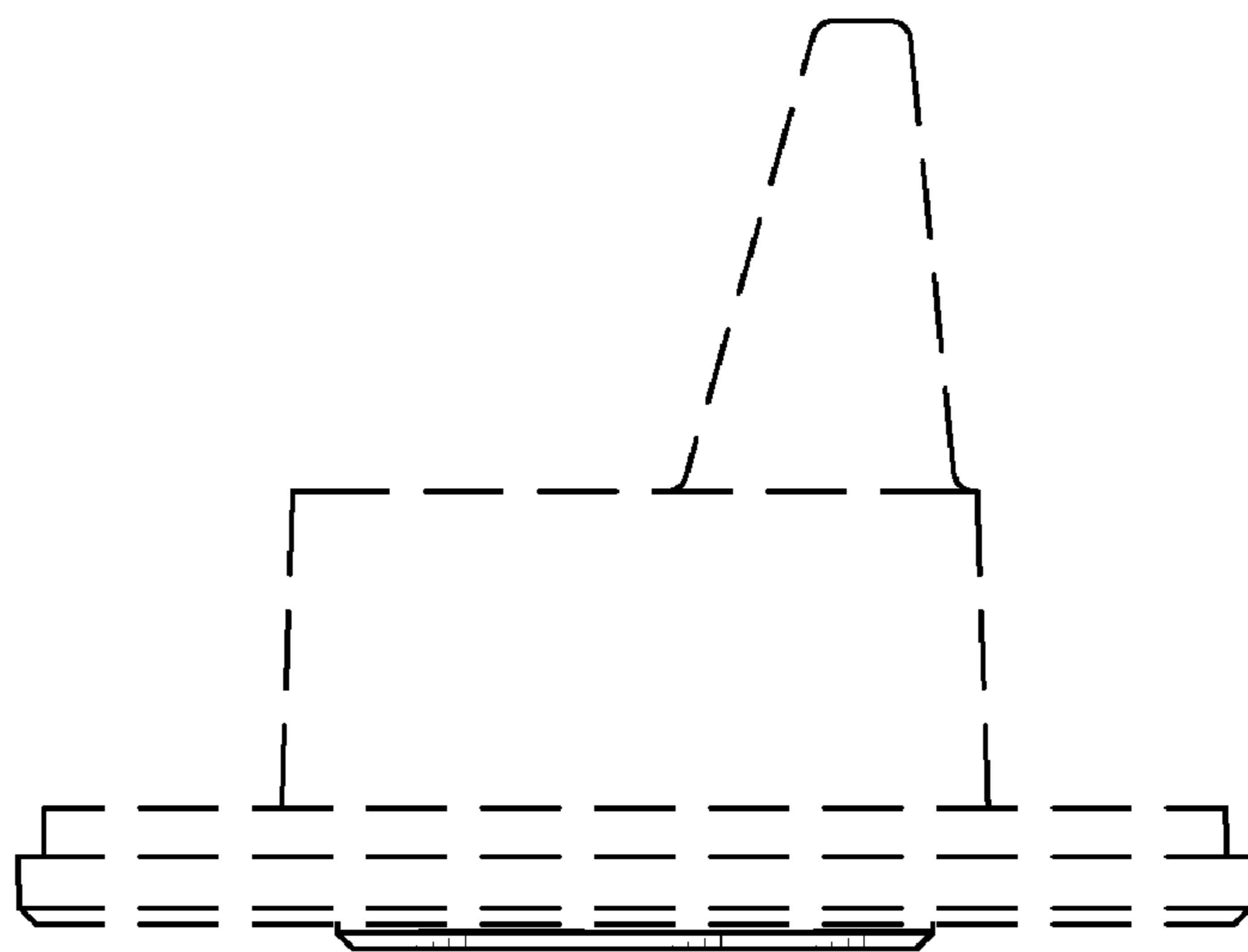

Fig. 5

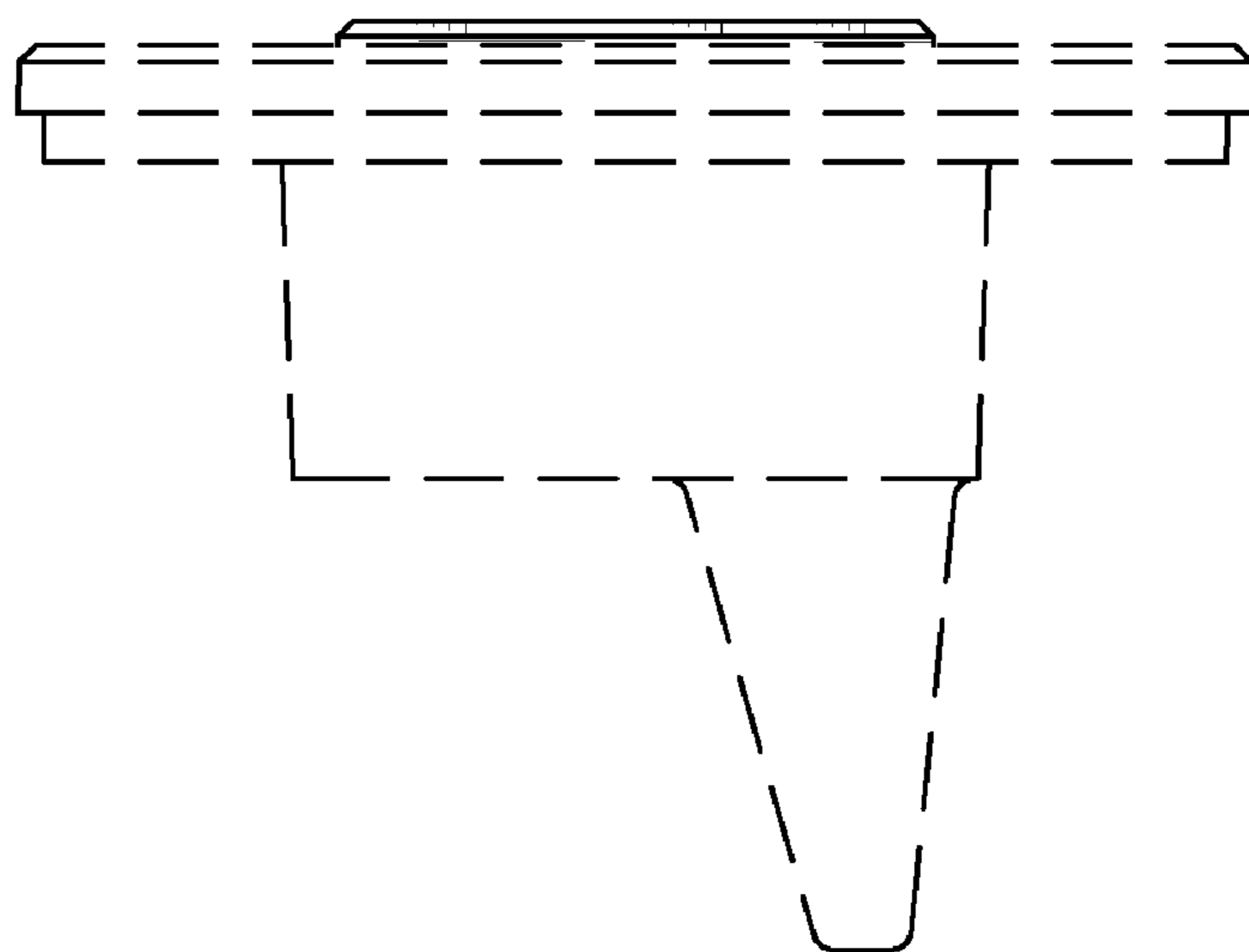

Fig. 6