



US00D611805S

(12) **United States Design Patent**  
**Barniquel**

(10) **Patent No.:** **US D611,805 S**

(45) **Date of Patent:** **\*\* Mar. 16, 2010**

(54) **CELLPHONE ACCESSORIES HOLDER**

(76) **Inventor:** **Marcelo Barniquel**, 1783 NW. 79th Ave., Miami, FL (US) 33126

(\*\*) **Term:** **14 Years**

(21) **Appl. No.:** **29/321,918**

(22) **Filed:** **Jul. 25, 2008**

(51) **LOC (9) Cl.** ..... **09-03**

(52) **U.S. Cl.** ..... **D9/415**

(58) **Field of Classification Search** ..... D9/600-681,  
D9/715, 721, 722, 414-434, 457, 499; 206/320,  
206/461-471, 775, 806, 822

See application file for complete search history.

(56) **References Cited**

**U.S. PATENT DOCUMENTS**

D218,403 S *	8/1970	Friedberg	.....	D9/415
D247,222 S *	2/1978	Paone et al.	.....	D9/415
D257,226 S *	10/1980	Kimball	.....	D9/415
D275,180 S *	8/1984	Bakus	.....	D9/415
D396,632 S *	8/1998	Lee	.....	D9/415
D406,753 S *	3/1999	Lee	.....	D9/415
D408,279 S *	4/1999	Fracassi et al.	.....	D9/415
6,273,252 B1 *	8/2001	Mitchell	.....	206/320
D450,239 S *	11/2001	Otto	.....	D9/415
D458,124 S *	6/2002	Kvame	.....	D9/415

6,968,951 B2 *	11/2005	Magnusson	.....	206/470
7,165,676 B2 *	1/2007	Dalessandro	.....	206/461
D554,492 S *	11/2007	Bochmann et al.	.....	D9/415
D581,264 S *	11/2008	Mapes, Jr.	.....	D9/415
2006/0060481 A1 *	3/2006	Hartman et al.	.....	206/305

\* cited by examiner

*Primary Examiner*—Catherine Tuttle

(74) *Attorney, Agent, or Firm*—Sanchelima & Associates, P.A.

(57) **CLAIM**

The ornamental design for the cellphone accessories holder, as shown and described.

**DESCRIPTION**

FIG. 1 is an isometric view of the cellphone accessories holder showing my new design;

FIG. 2 is a side elevational view thereof;

FIG. 3 is a side elevational view thereof opposite to the side shown in FIG. 2;

FIG. 4 is a top plan view thereof;

FIG. 5 is a bottom plan view thereof;

FIG. 6 is an elevation view of the opposing side of FIG. 1; and,

FIG. 7 is an elevation view of the side shown in FIG. 1.

**1 Claim, 5 Drawing Sheets**

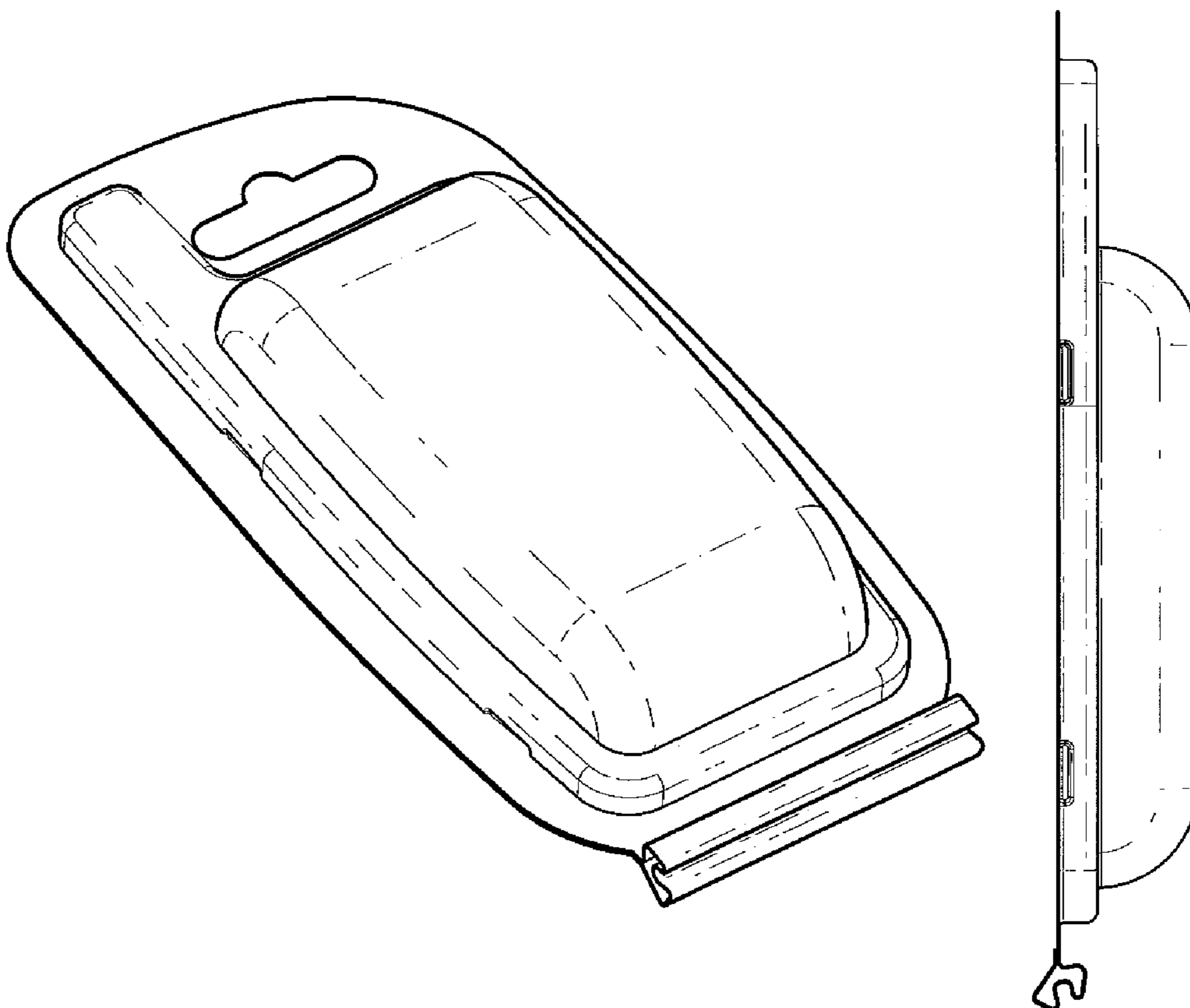

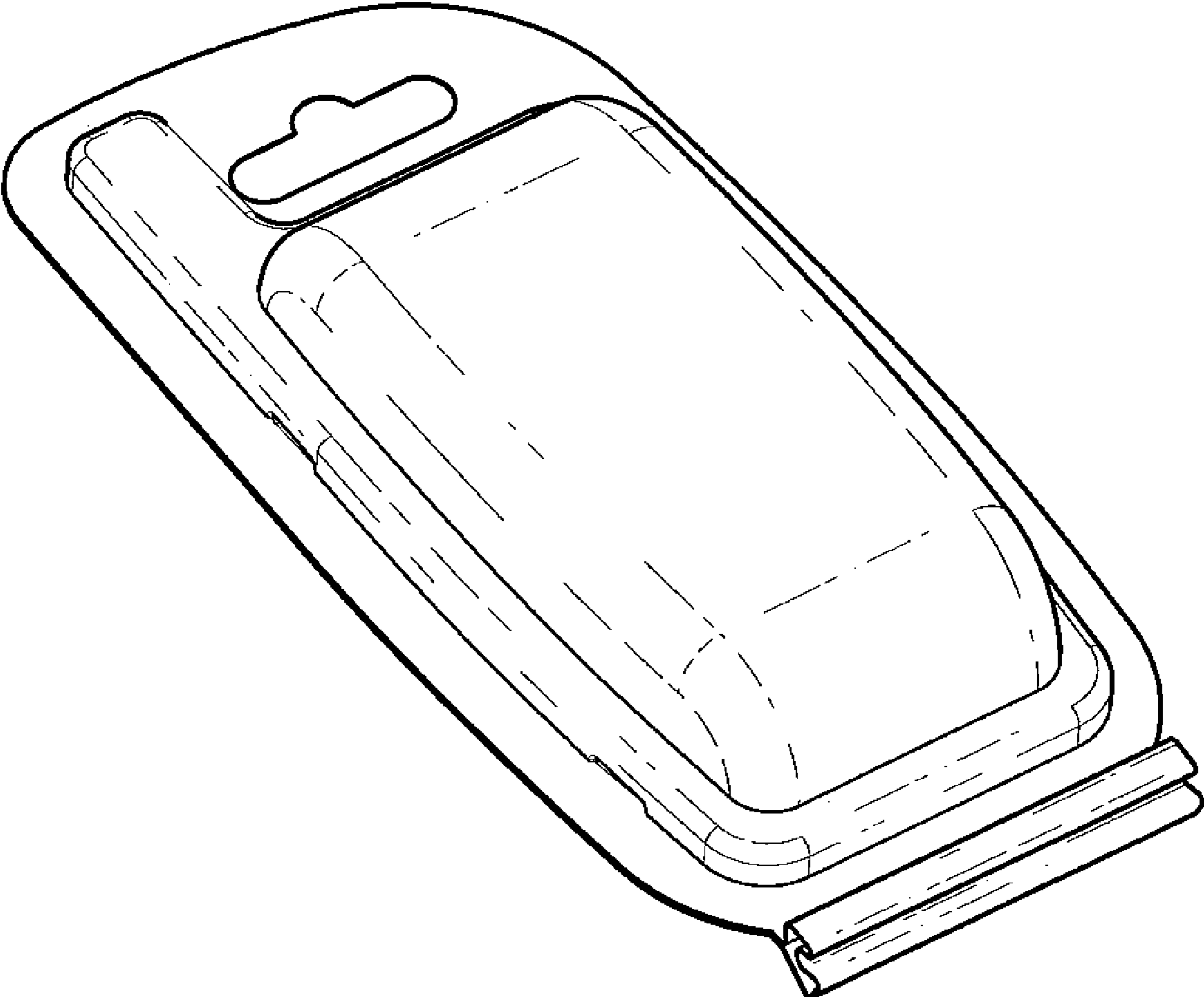

Fig. 1

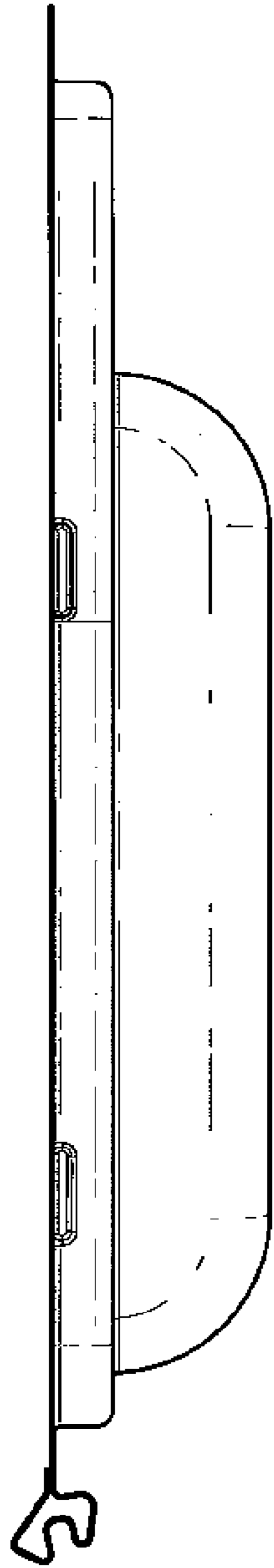

Fig. 2

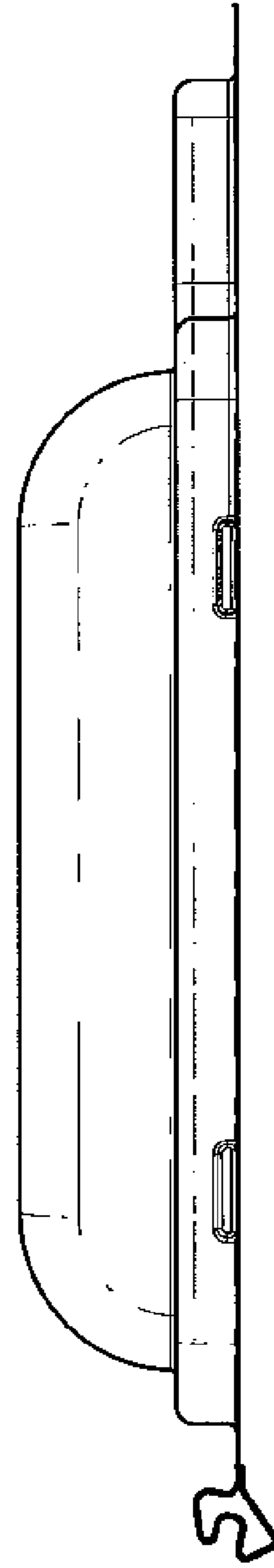

Fig. 3

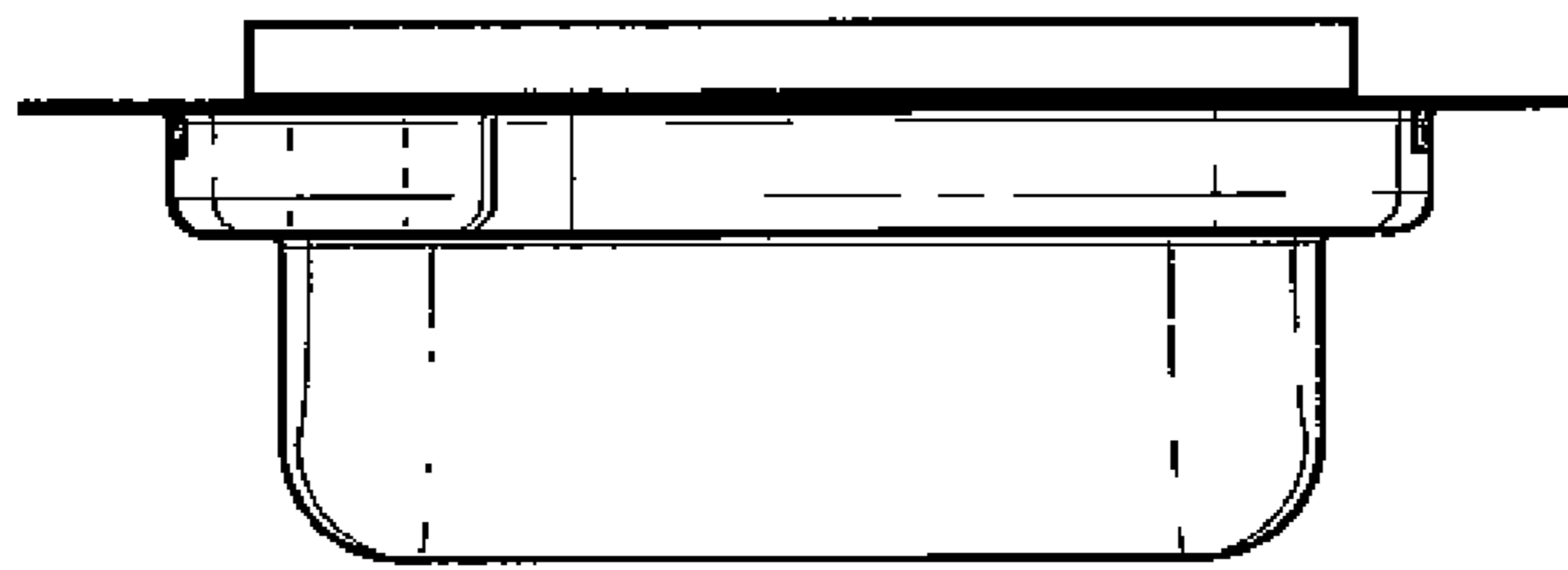

Fig. 4

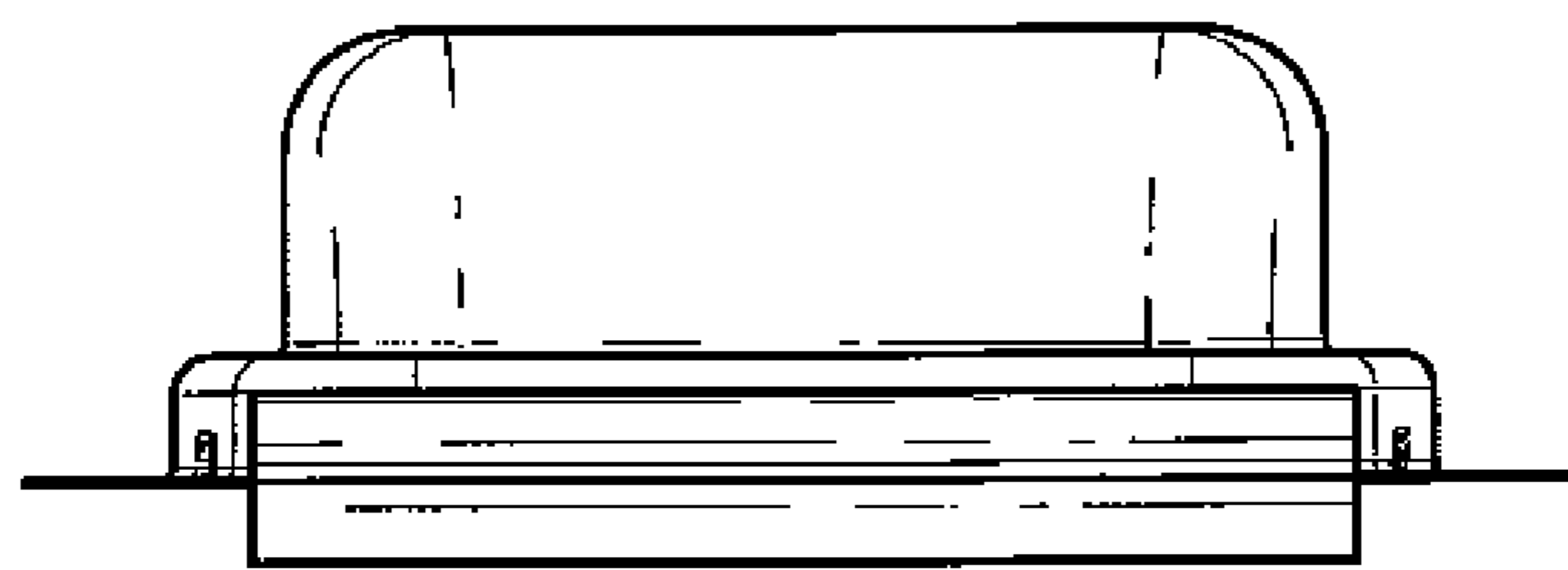

Fig. 5

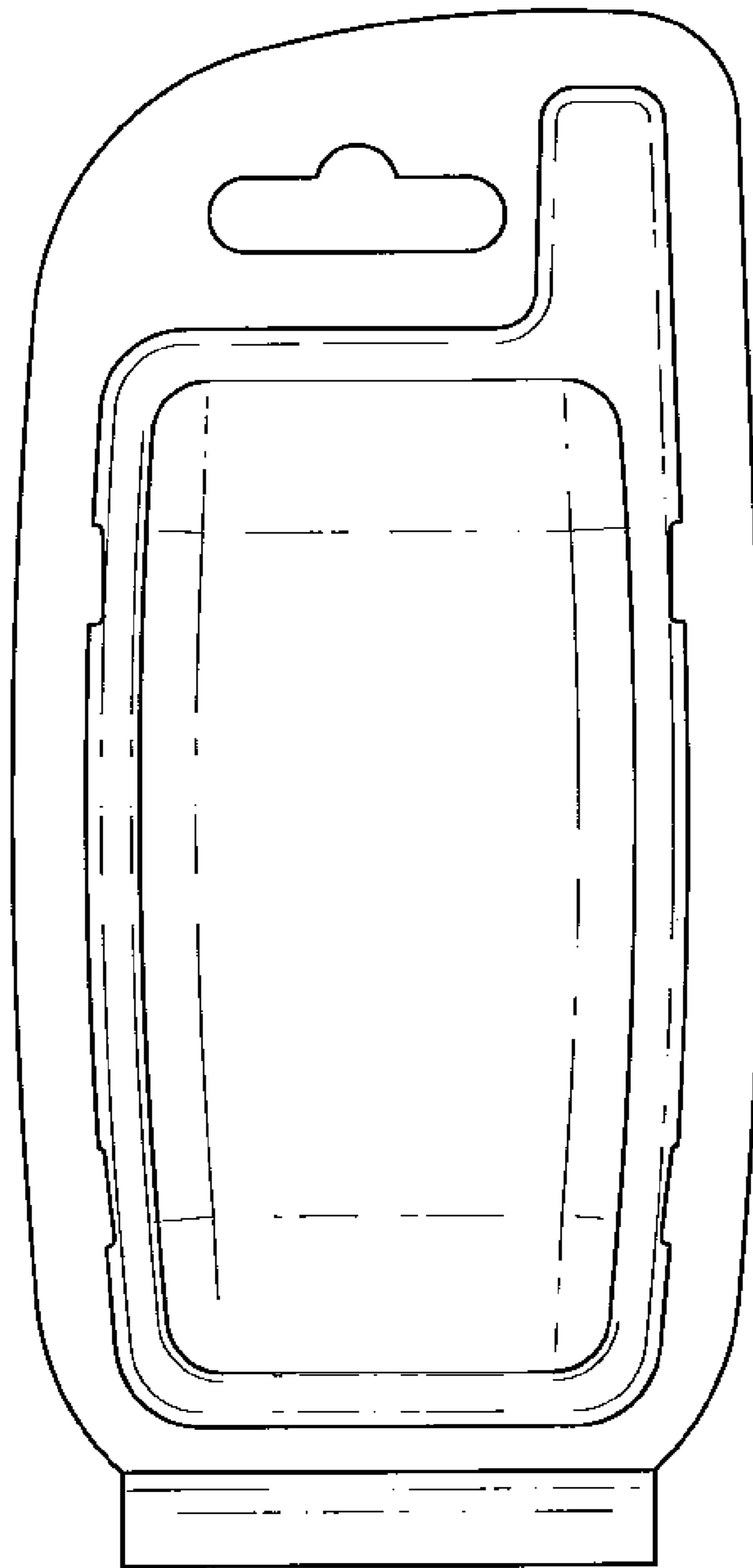

Fig. 6

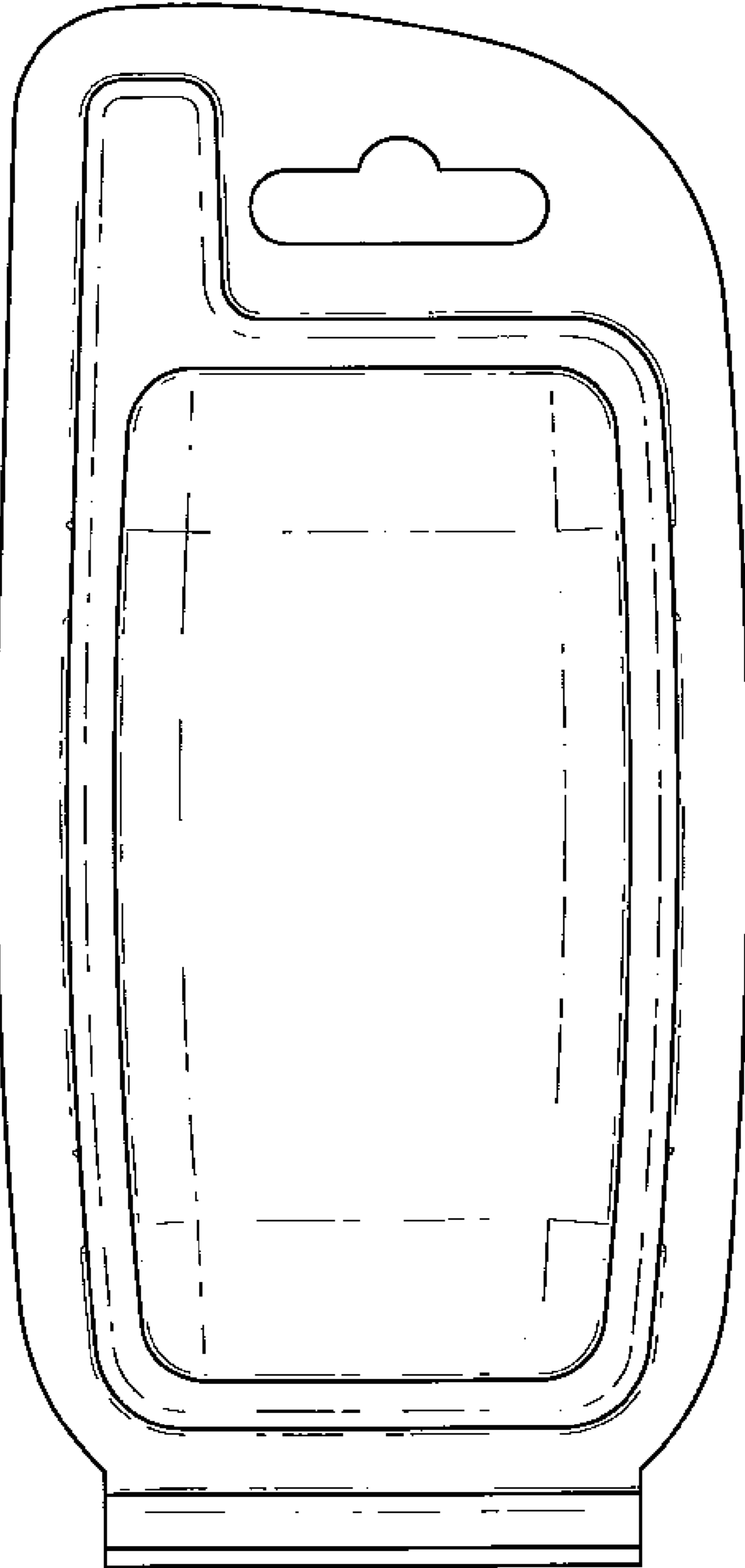

Fig. 7