



US00D611064S

(12) **United States Design Patent**
Takahata

(10) **Patent No.:** **US D611,064 S**
(45) **Date of Patent:** **** Mar. 2, 2010**

(54) **TURBOCHARGER COVER FOR INTERNAL COMBUSTION ENGINE**

(75) Inventor: **Terumitsu Takahata**, Osaka (JP)

(73) Assignee: **Yanmar Co., Ltd.**, Osaka (JP)

(**) Term: **14 Years**

(21) Appl. No.: **29/330,282**

(22) Filed: **Jan. 2, 2009**

(30) **Foreign Application Priority Data**

Sep. 1, 2008 (JP) 2008-22470

(51) **LOC (9) Cl.** **15-01**

(52) **U.S. Cl.** **D15/5**

(58) **Field of Classification Search** D15/1,
D15/5; 60/602; 415/144, 200, 201, 213.1;
181/272, 282

See application file for complete search history.

(56) **References Cited**

U.S. PATENT DOCUMENTS

1,075,435	A	10/1913	Neeley et al.	
D285,570	S *	9/1986	McInerney	D15/5
D293,114	S	12/1987	Brogdon	
D294,832	S	3/1988	Itou et al.	
D307,147	S	4/1990	Sasaki et al.	
D307,148	S	4/1990	Mikado	
D328,303	S *	7/1992	Griffith et al.	D15/5
D353,381	S	12/1994	Yoshida et al.	
D367,070	S	2/1996	Maeda et al.	
D368,269	S *	3/1996	Chapman	D15/5
D396,045	S	7/1998	Neeley	
D396,476	S	7/1998	Shimizu	
D397,342	S	8/1998	Shimizu	
D413,122	S *	8/1999	Chapman	D15/5
D474,783	S	5/2003	Momoi	
D482,045	S	11/2003	Iwata et al.	
D488,167	S	4/2004	Momoi	
D489,076	S	4/2004	Hiraiwa et al.	

D497,368	S	10/2004	Csiki	
D509,224	S	9/2005	Shiota et al.	
D522,021	S	5/2006	Miyazaki et al.	
D527,020	S	8/2006	Miyazaki et al.	
7,600,379	B2 *	10/2009	Fledersbacher et al. 60/602
7,600,380	B2 *	10/2009	Grissom et al. 60/612

OTHER PUBLICATIONS

Takahata et al., "Internal Combustion Engine", U.S. Appl. No. 29/330,281, filed Jan. 2, 2009.

* cited by examiner

Primary Examiner—Cathron C. Brooks

Assistant Examiner—Maurice Stevens

(74) *Attorney, Agent, or Firm*—Sterne, Kessler, Goldstein & Fox, P.L.L.C.

(57) **CLAIM**

The ornamental design for a turbocharger cover for internal combustion engine, as shown and described.

DESCRIPTION

FIG. 1 is a front perspective view of a turbocharger cover for internal combustion engine showing our new design;

FIG. 2 is a rear perspective view thereof;

FIG. 3 is a front view thereof;

FIG. 4 is a rear view thereof;

FIG. 5 is a left side view thereof;

FIG. 6 is a right side view thereof;

FIG. 7 is a top plan view thereof;

FIG. 8 is a bottom plan view thereof; and,

FIG. 9 is another front perspective view thereof, showing the turbocharger cover in an environment in which it may be used.

The broken lines in FIG. 9 are for illustrative purposes only and form no part of the claimed design.

1 Claim, 9 Drawing Sheets

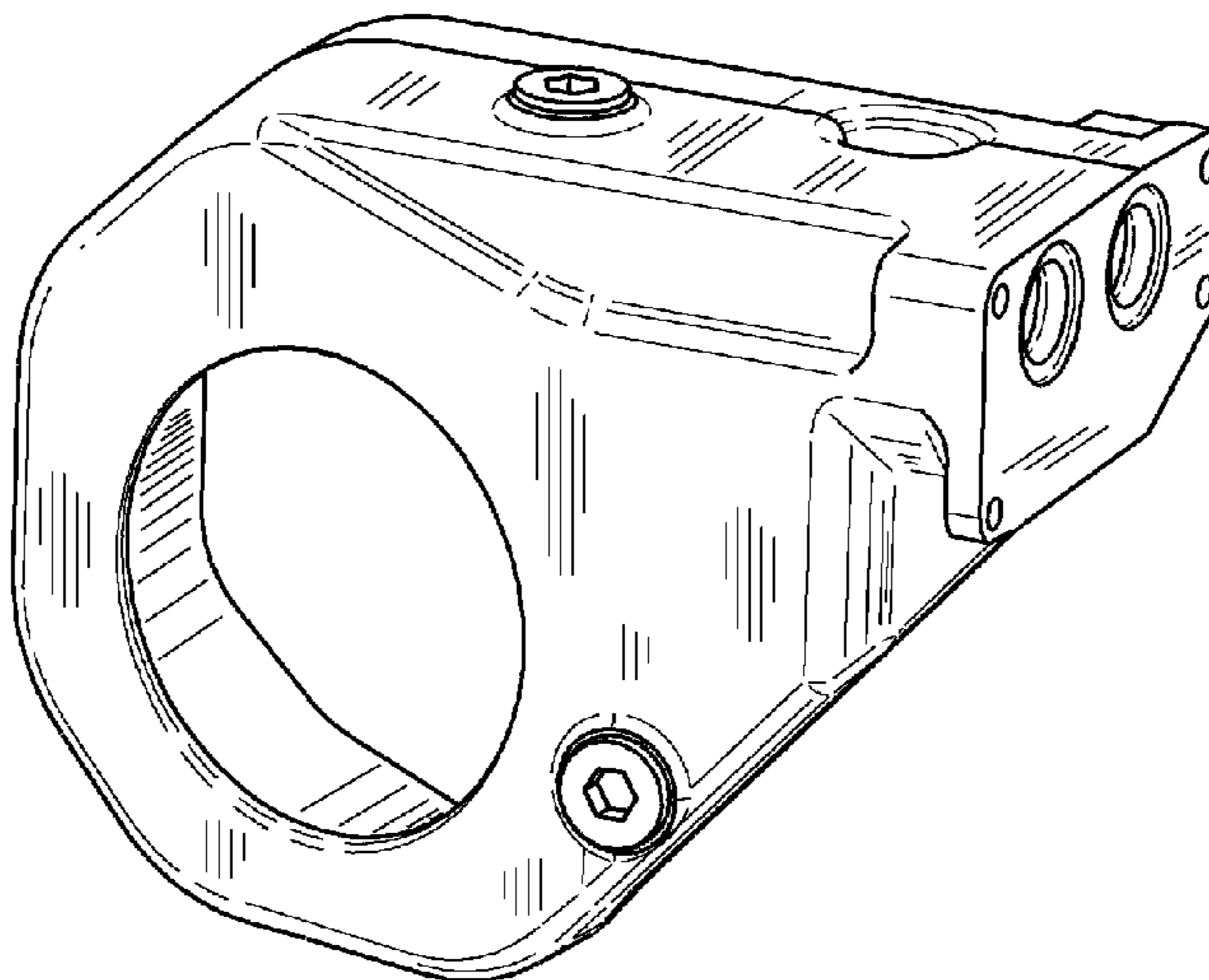

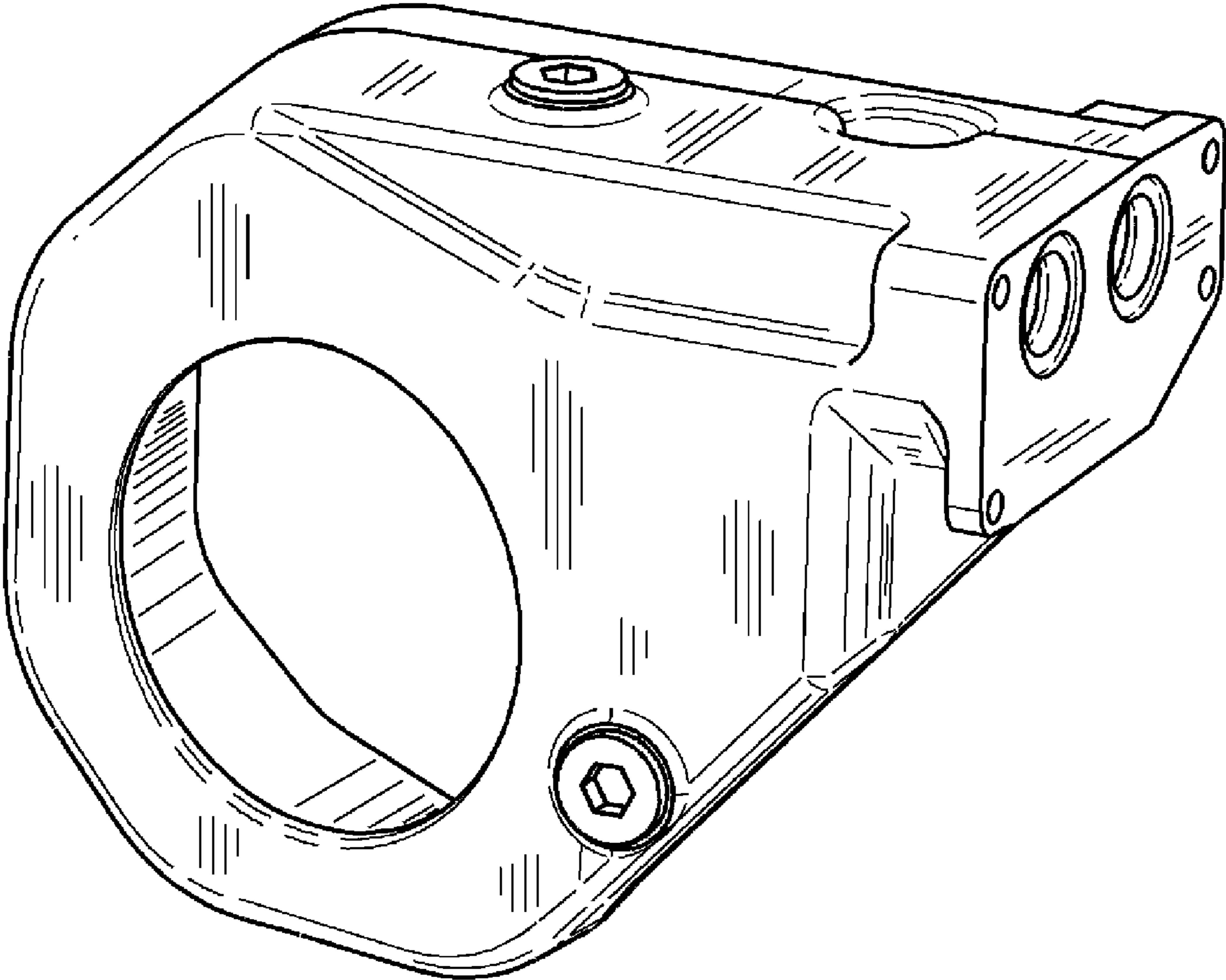

FIG. 1

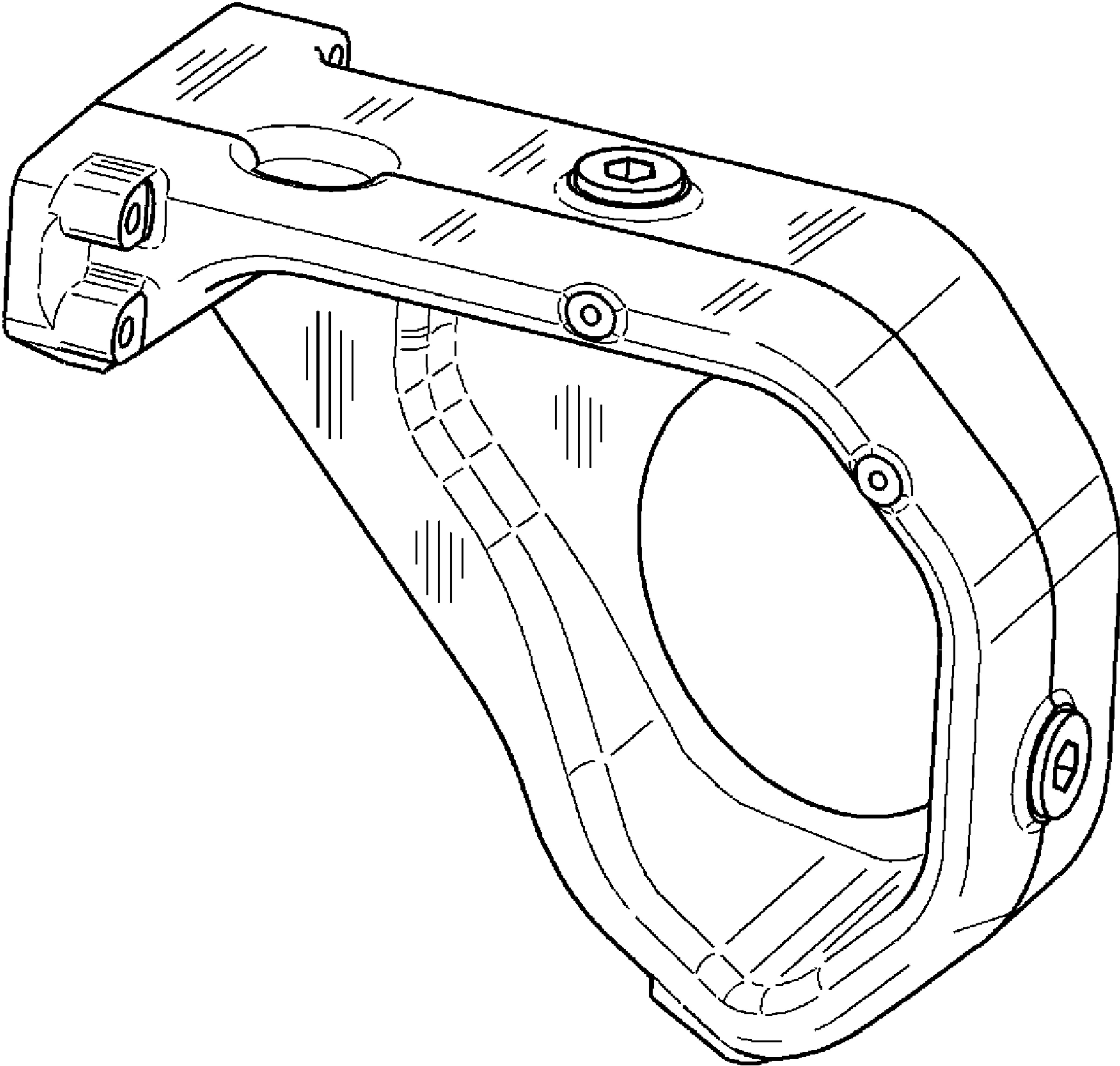

FIG. 2

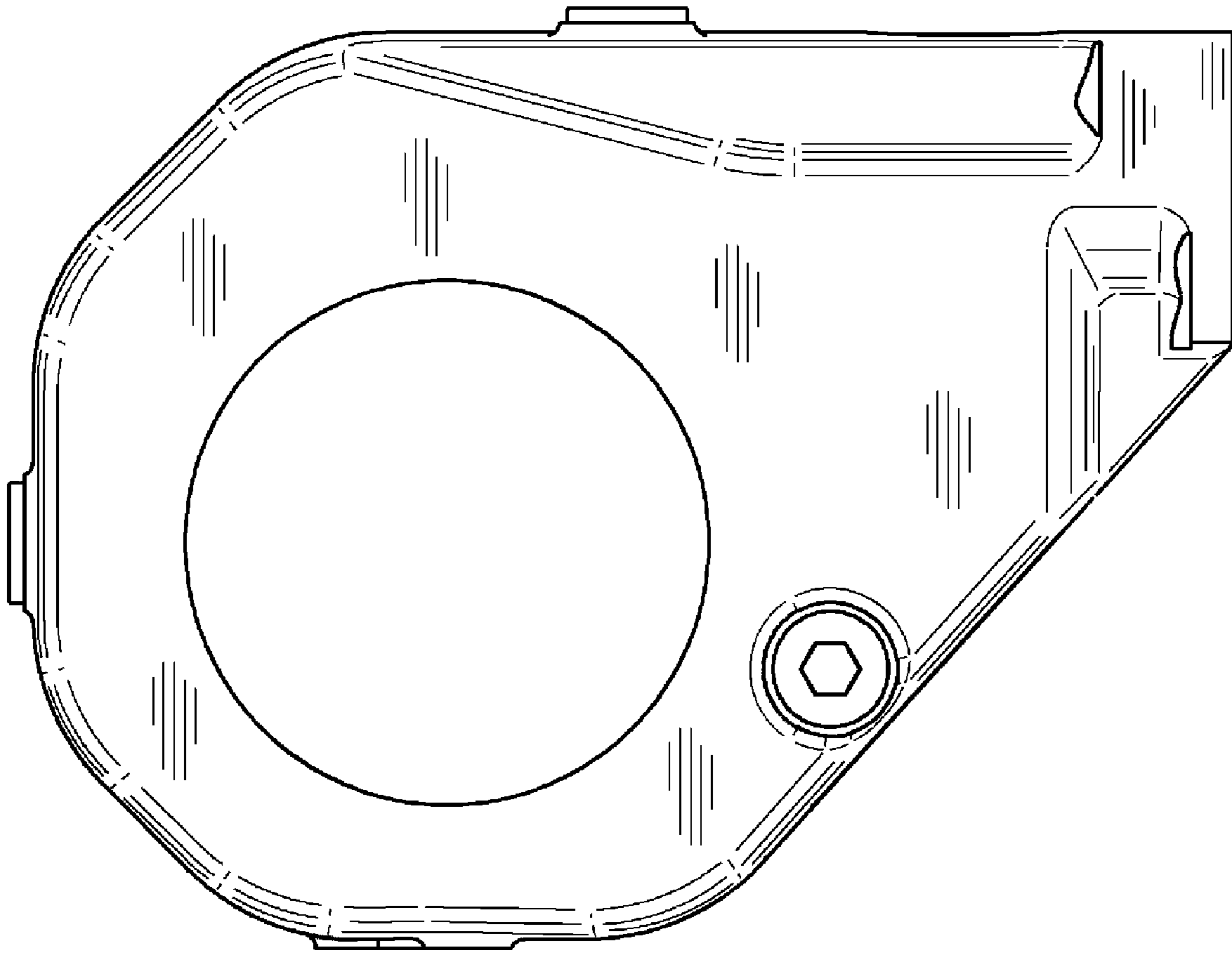

FIG. 3

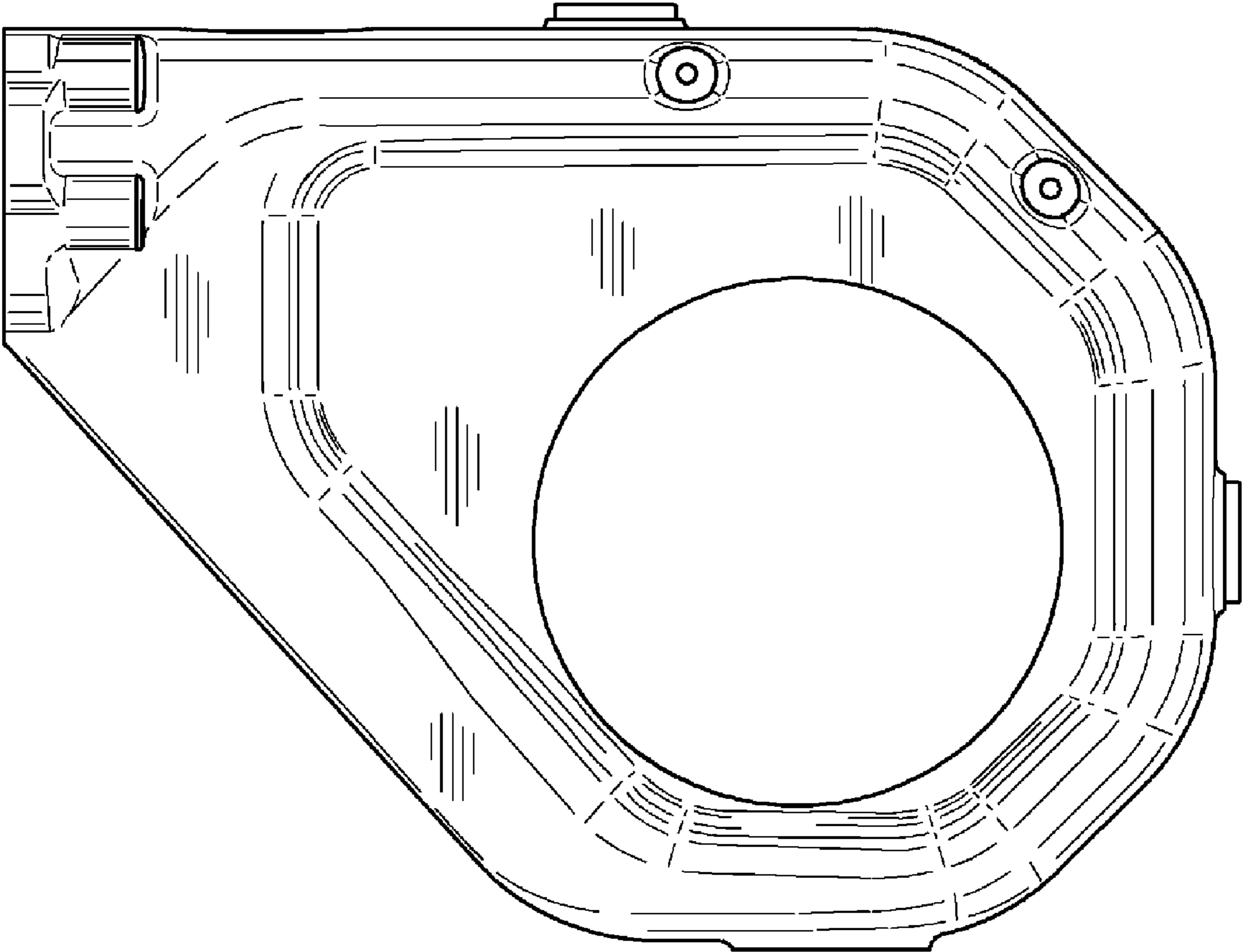

FIG. 4

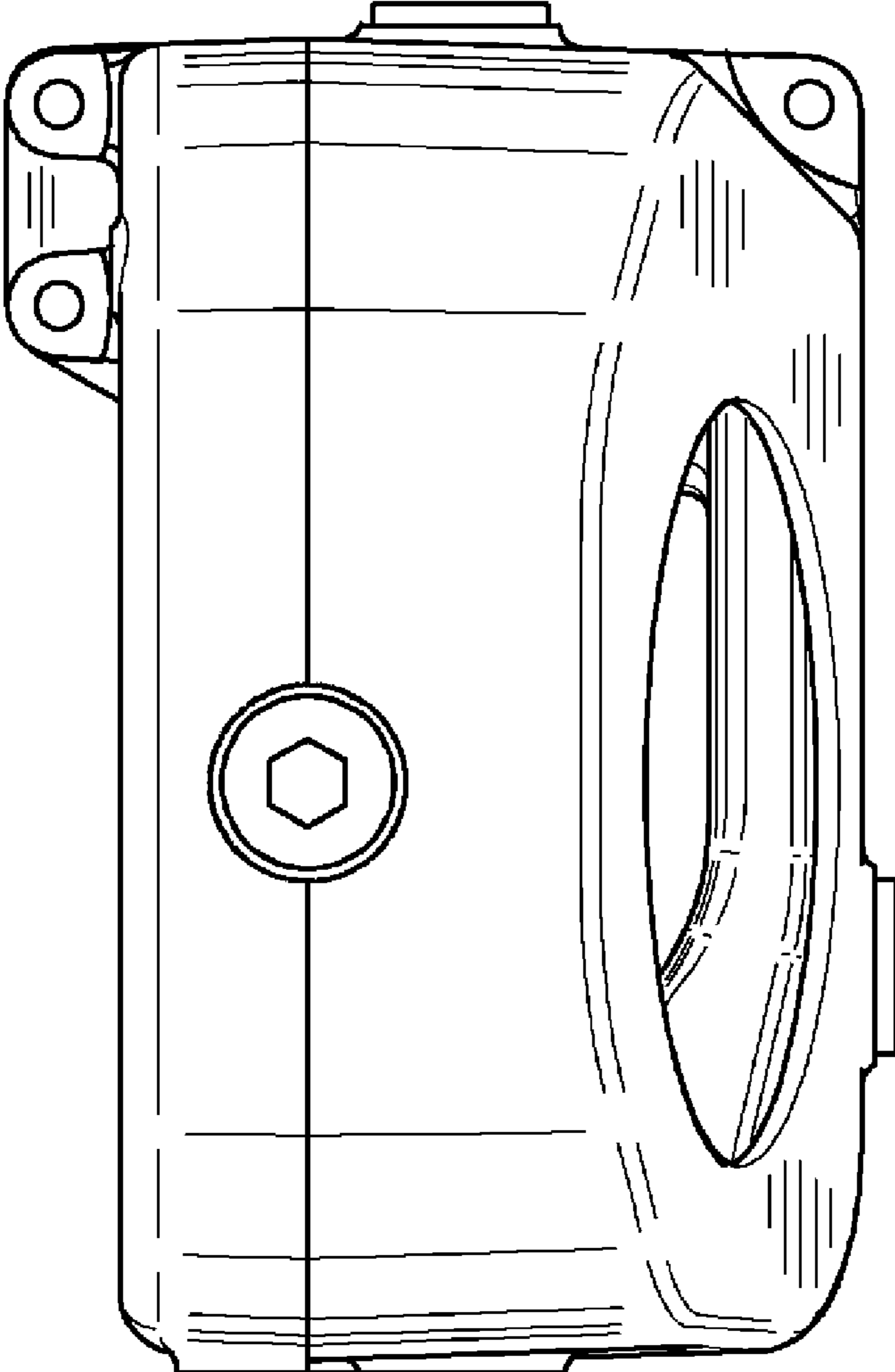

FIG. 5

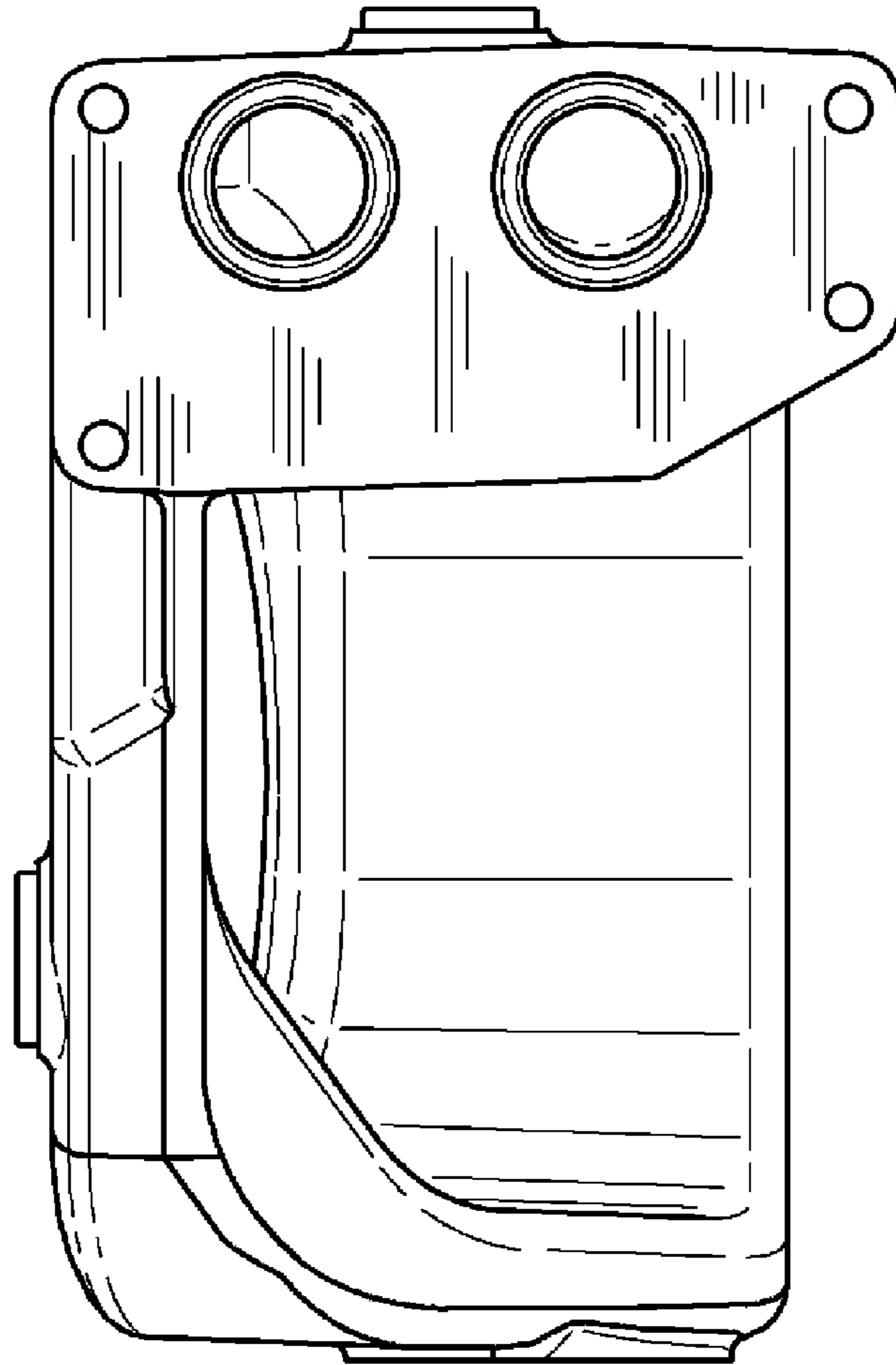

FIG. 6

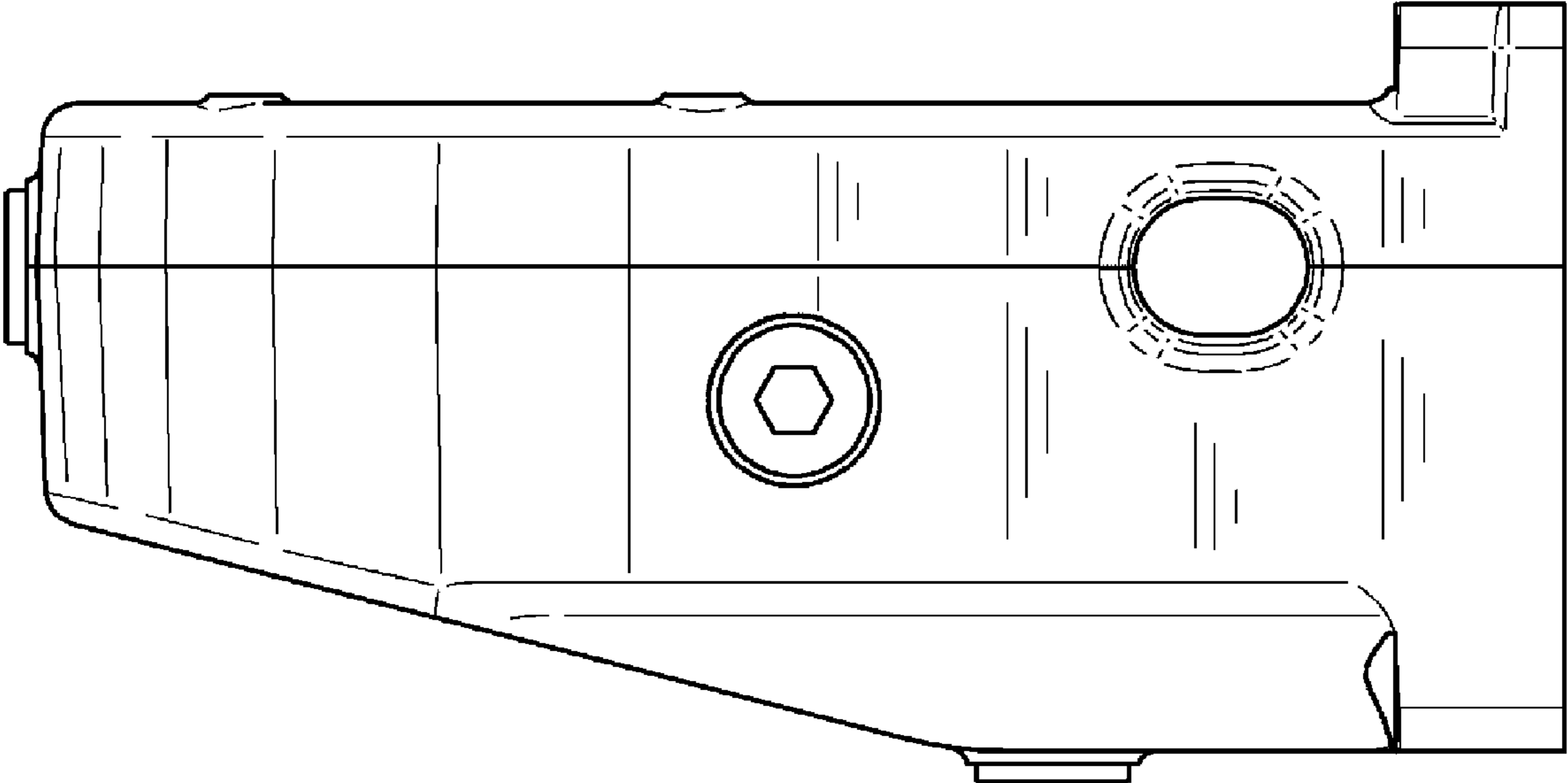

FIG. 7

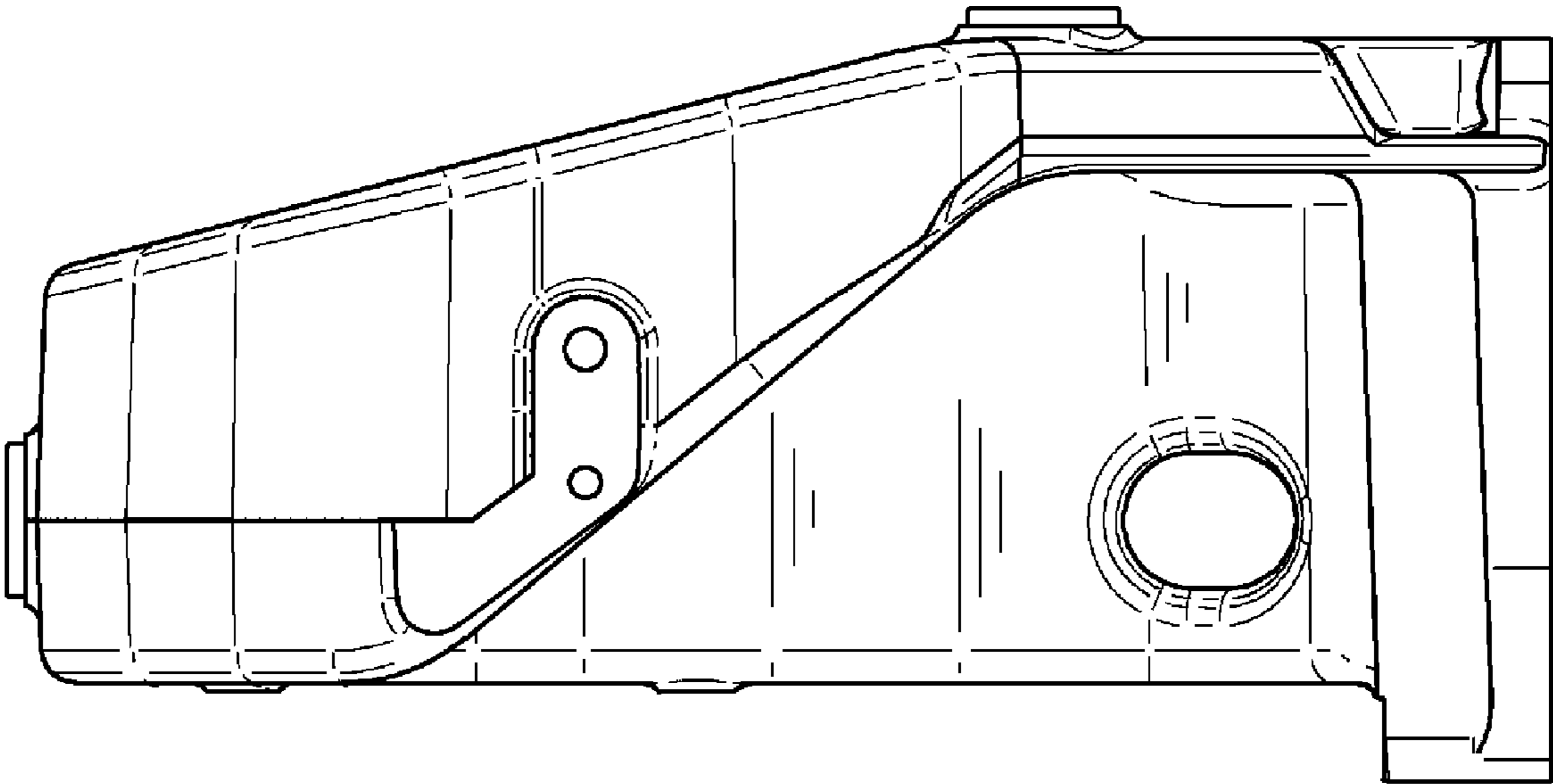

FIG. 8

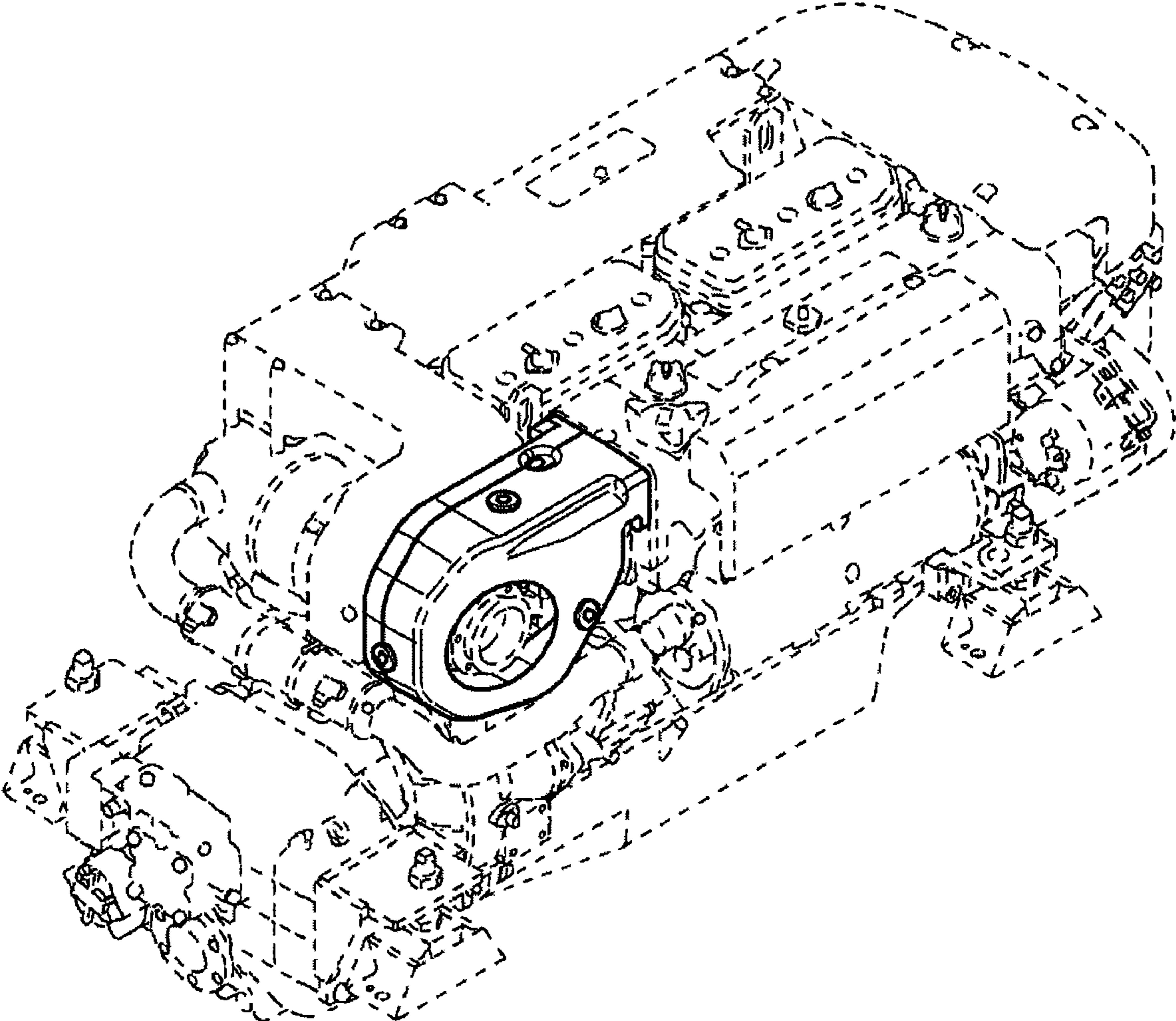

FIG. 9