



US00D610716S

(12) **United States Design Patent**
Edwards

(10) **Patent No.:** **US D610,716 S**

(45) **Date of Patent:** **** Feb. 23, 2010**

(54) **ADJUSTABLE BALUSTER**

(75) Inventor: **Matthew S. Edwards**, Bolivar, OH (US)

(73) Assignee: **Carolina Stair Supply, Inc.**,
Uhrichsville, OH (US)

(**) Term: **14 Years**

(21) Appl. No.: **29/341,590**

(22) Filed: **Aug. 9, 2009**

Related U.S. Application Data

(63) Continuation of application No. 11/656,599, filed on
Jan. 23, 2007, now Pat. No. 7,614,612.

(51) **LOC (9) Cl.** **25-01**

(52) **U.S. Cl.** **D25/126**

(58) **Field of Classification Search** D25/126;
52/831, 832, 301; 256/65.14, 65.02, 19,
256/21, 22

See application file for complete search history.

(56) **References Cited**

U.S. PATENT DOCUMENTS

2,676,652 A * 4/1954 Duncan 160/104
3,804,374 A * 4/1974 Thom 256/59
D399,980 S * 10/1998 Masse D25/126

D438,990 S * 3/2001 Alonso D25/126
D460,569 S * 7/2002 Cox D25/126
D495,065 S * 8/2004 Gonzato D25/126
D495,809 S * 9/2004 Gonzato D25/126
2003/0132426 A1 * 7/2003 Kang 256/22

* cited by examiner

Primary Examiner—Doris Clark

(74) *Attorney, Agent, or Firm*—Zollinger & Burleson Ltd.

(57) **CLAIM**

The ornamental design for an adjustable baluster, as shown
and described.

DESCRIPTION

FIG. 1 is a perspective view of an adjustable baluster showing
my new design;

FIG. 2 is a front elevation view thereof; the rear elevation
view being a mirror image thereof;

FIG. 3 is a left side elevation view of thereof;

FIG. 4 is a right side elevation thereof;

FIG. 5 is a top plan view thereof; and,

FIG. 6 is a bottom plan view of thereof.

Broken lines in the drawings form no part of the claimed
design.

1 Claim, 3 Drawing Sheets



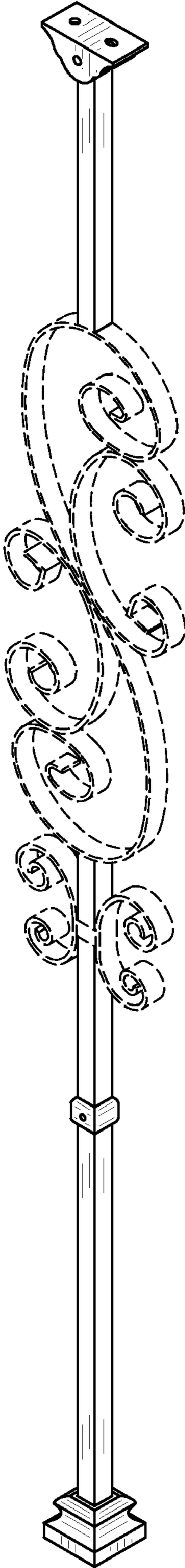

FIG. 1

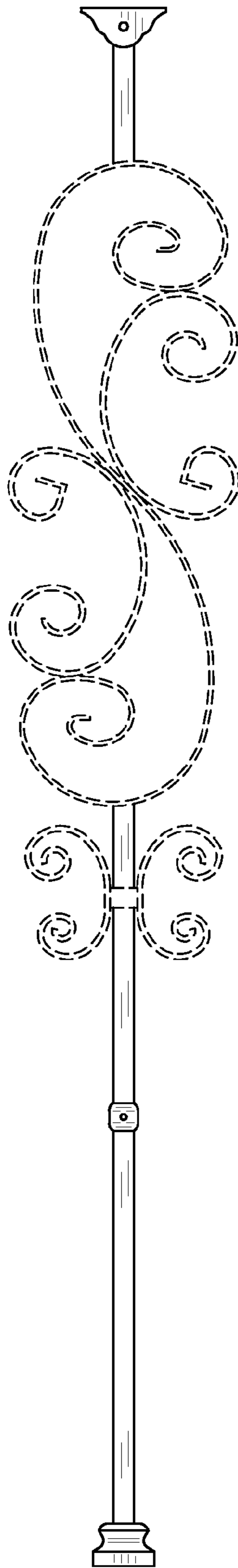

FIG. 2

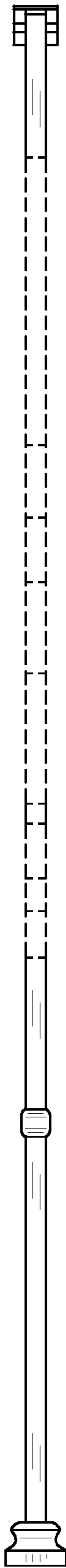

FIG. 3

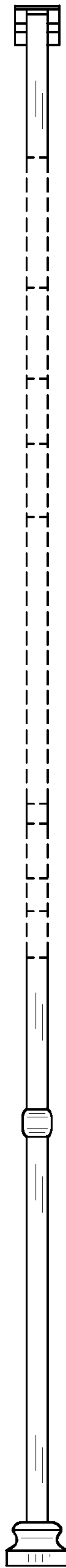

FIG. 4

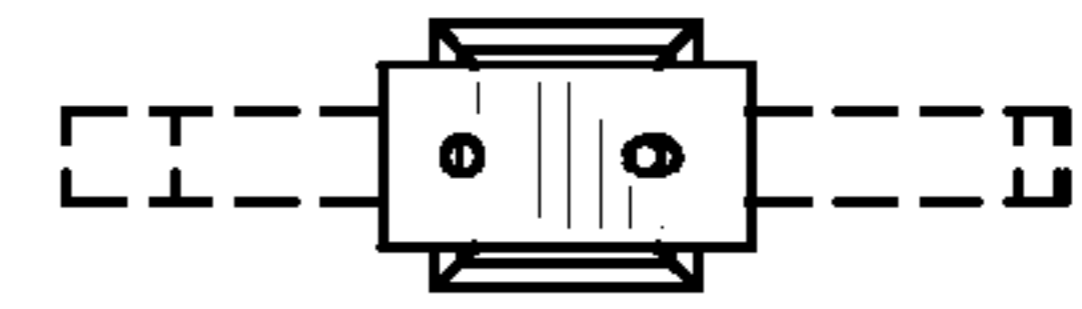

FIG. 5

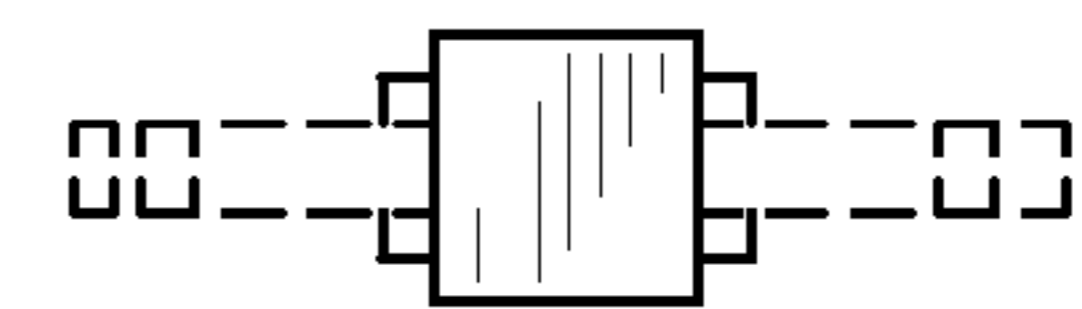

FIG. 6