



US00D610617S

(12) **United States Design Patent**
Zhang

(10) **Patent No.:** **US D610,617 S**

(45) **Date of Patent:** **** Feb. 23, 2010**

(54) **PEN**

(75) Inventor: **Binhui Zhang**, Ningbo (CN)

(73) Assignee: **Beifa Group Co., Ltd.**, Ningbo (CN)

(**) Term: **14 Years**

(21) Appl. No.: **29/333,929**

(22) Filed: **Mar. 17, 2009**

(30) **Foreign Application Priority Data**

Sep. 26, 2008 (CN) 2008 3 0211812

(51) **LOC (9) Cl.** **19-06**

(52) **U.S. Cl.** **D19/50**

(58) **Field of Classification Search** D19/35,
D19/36, 41, 42, 43, 44, 45, 46, 47, 48, 49,
D19/50, 51, 54, 55, 56, 57; 24/11 F, 11 P,
24/11 R; 401/6, 52, 99, 100, 104, 105, 106,
401/107, 108, 109, 192, 195, 243, 244, 245,
401/246, 247

See application file for complete search history.

(56) **References Cited**

U.S. PATENT DOCUMENTS

950,939 A * 3/1910 Martling et al. 401/246
D110,810 S * 8/1938 Kahn D19/49
D354,514 S 1/1995 de Baillon
D367,673 S * 3/1996 Compte D19/51
D368,930 S * 4/1996 Payne D19/51
D427,634 S * 7/2000 Izushima D19/56
D430,609 S * 9/2000 Keda D19/57

D445,130 S * 7/2001 Ginelli D19/36
6,283,661 B1 * 9/2001 Connors 401/195
D454,586 S * 3/2002 Qiu D19/43
D465,519 S * 11/2002 Kennedy et al. D19/43
D480,421 S * 10/2003 Hui D19/43
D500,519 S * 1/2005 Keda D19/50
D577,383 S * 9/2008 Loesel D19/48
D591,348 S 4/2009 Yu

OTHER PUBLICATIONS

Liu, L., "Pen," U.S. Appl. No. 29/338,432, filed Jun. 11, 2009.

* cited by examiner

Primary Examiner—Elizabeth A Albert

Assistant Examiner—Karen E Eldridge Powers

(74) *Attorney, Agent, or Firm*—Christensen O'Connor
Johnson Kindness PLLC

(57) **CLAIM**

The ornamental design for a pen, as shown and described.

DESCRIPTION

FIG. 1 is an upper front right perspective view of a pen showing my new design;

FIG. 2 is a left side elevation view of the pen shown in FIG. 1;

FIG. 3 is an enlarged top plan view thereof;

FIG. 4 is a front elevation view thereof;

FIG. 5 is a right side elevation view thereof;

FIG. 6 is an enlarged bottom plan view thereof; and,

FIG. 7 is a rear elevation view thereof.

1 Claim, 3 Drawing Sheets

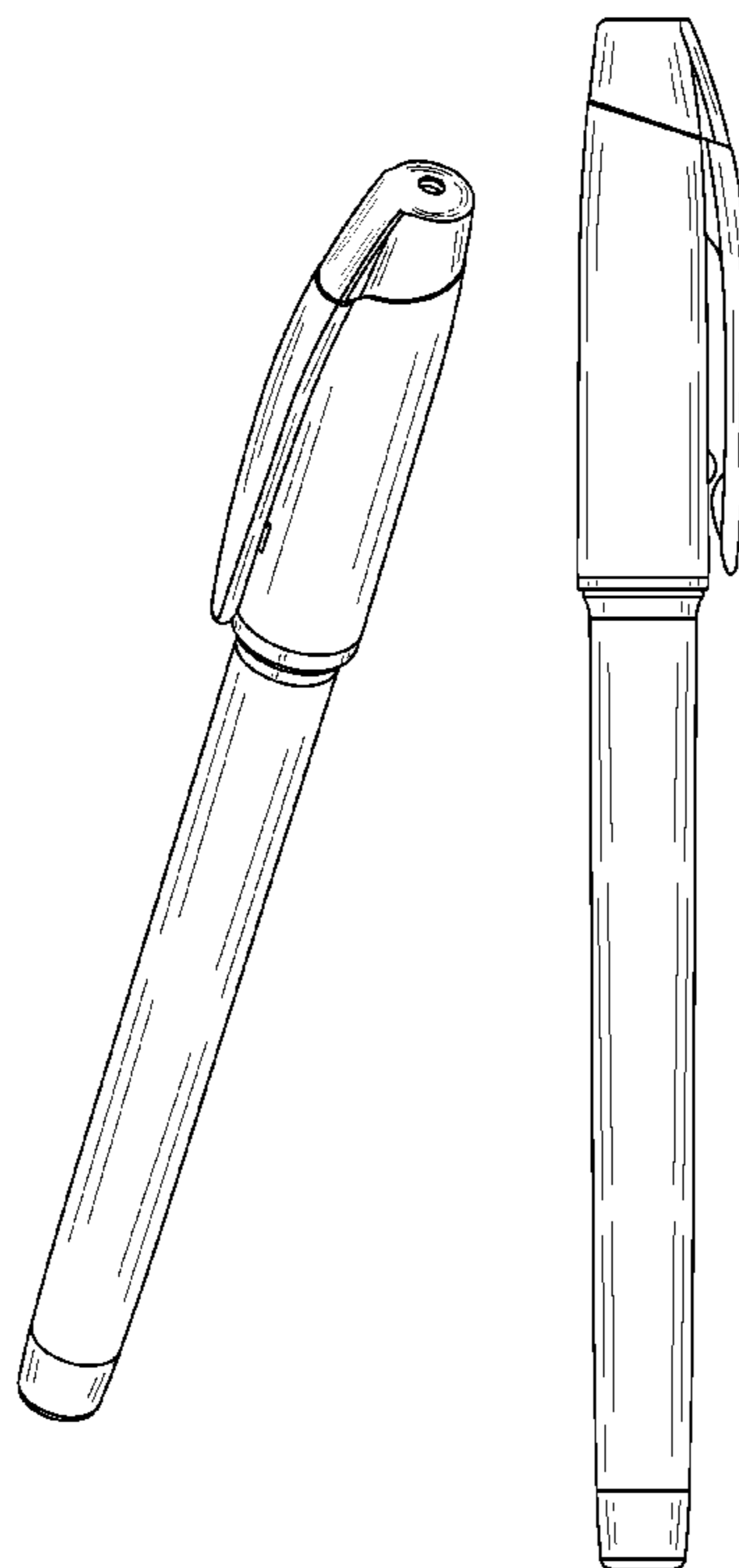

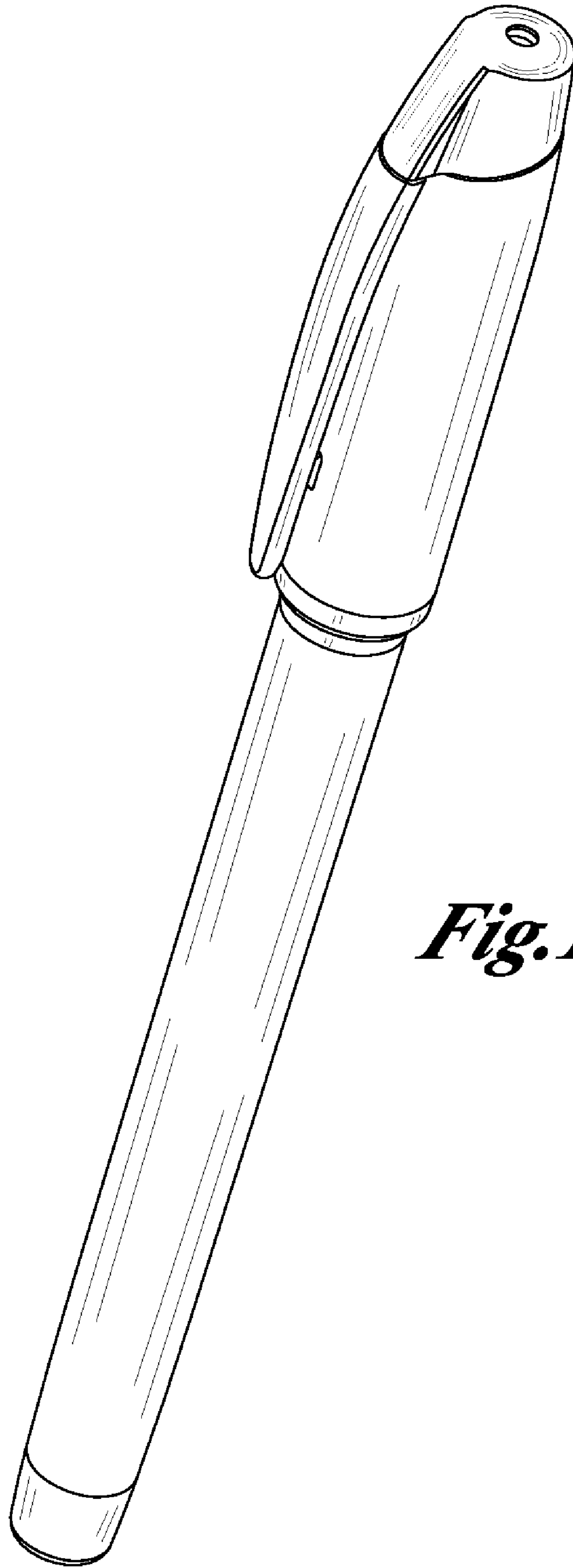

Fig. 1.

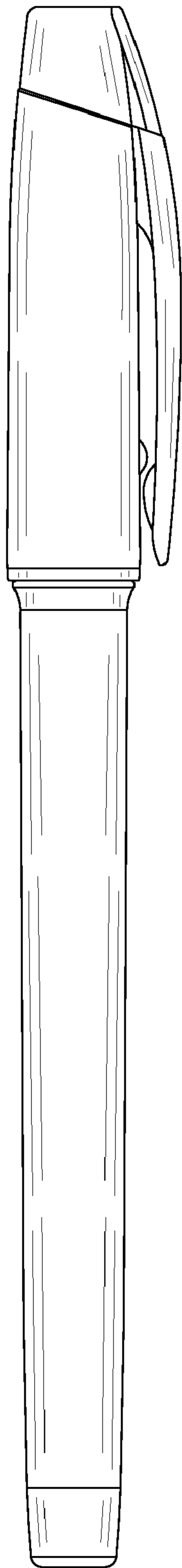

Fig. 2.

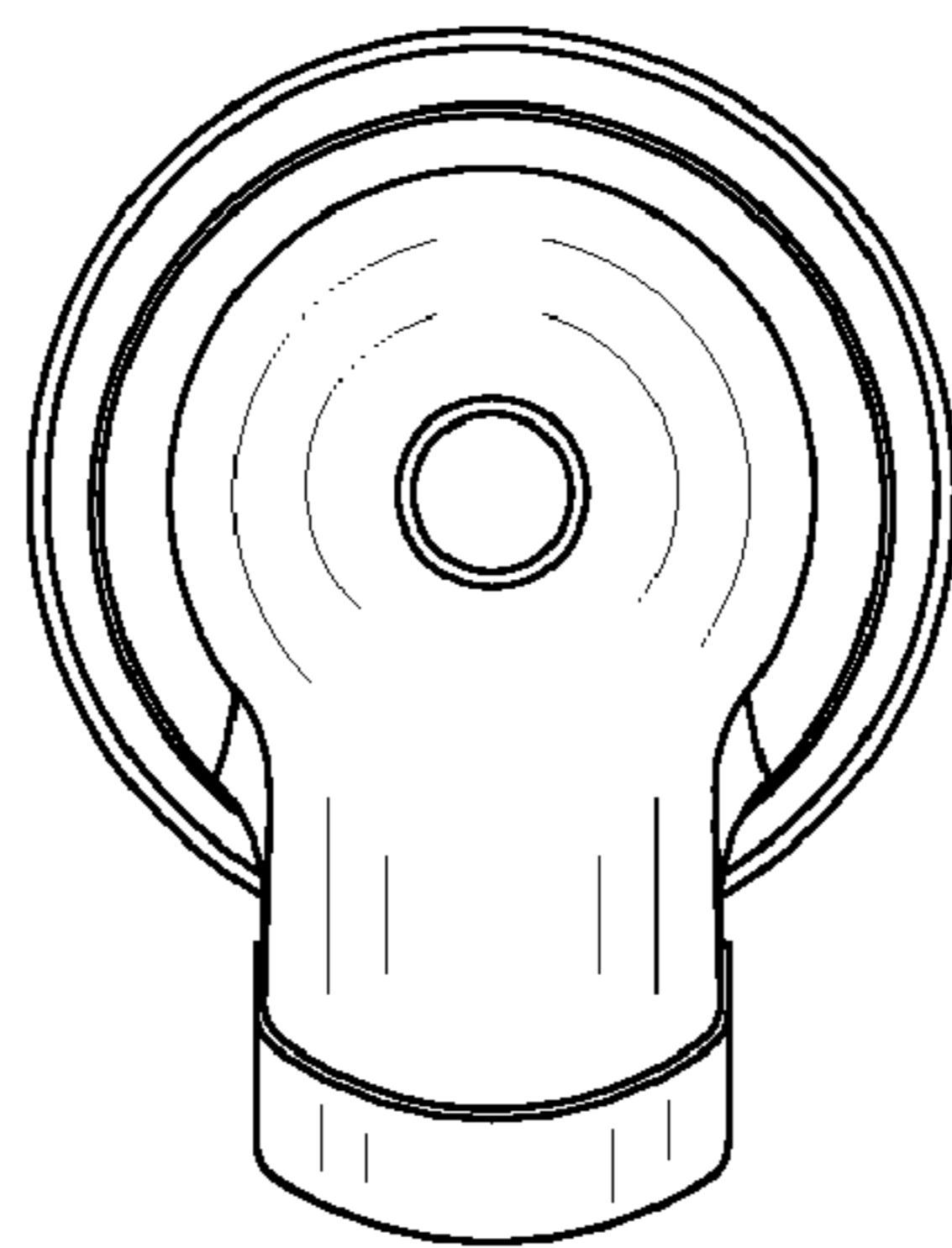

Fig. 3.

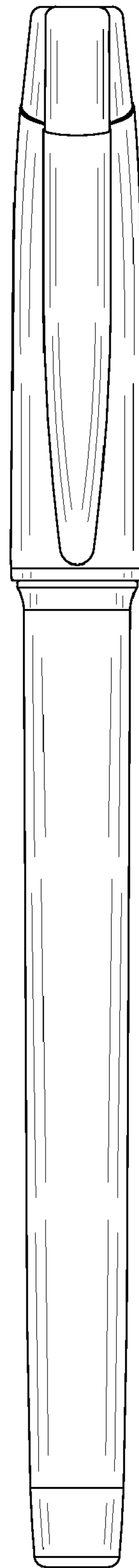

Fig. 4.

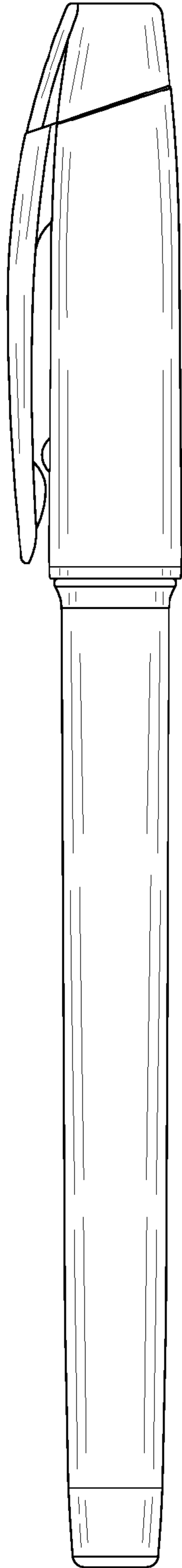

Fig. 5.

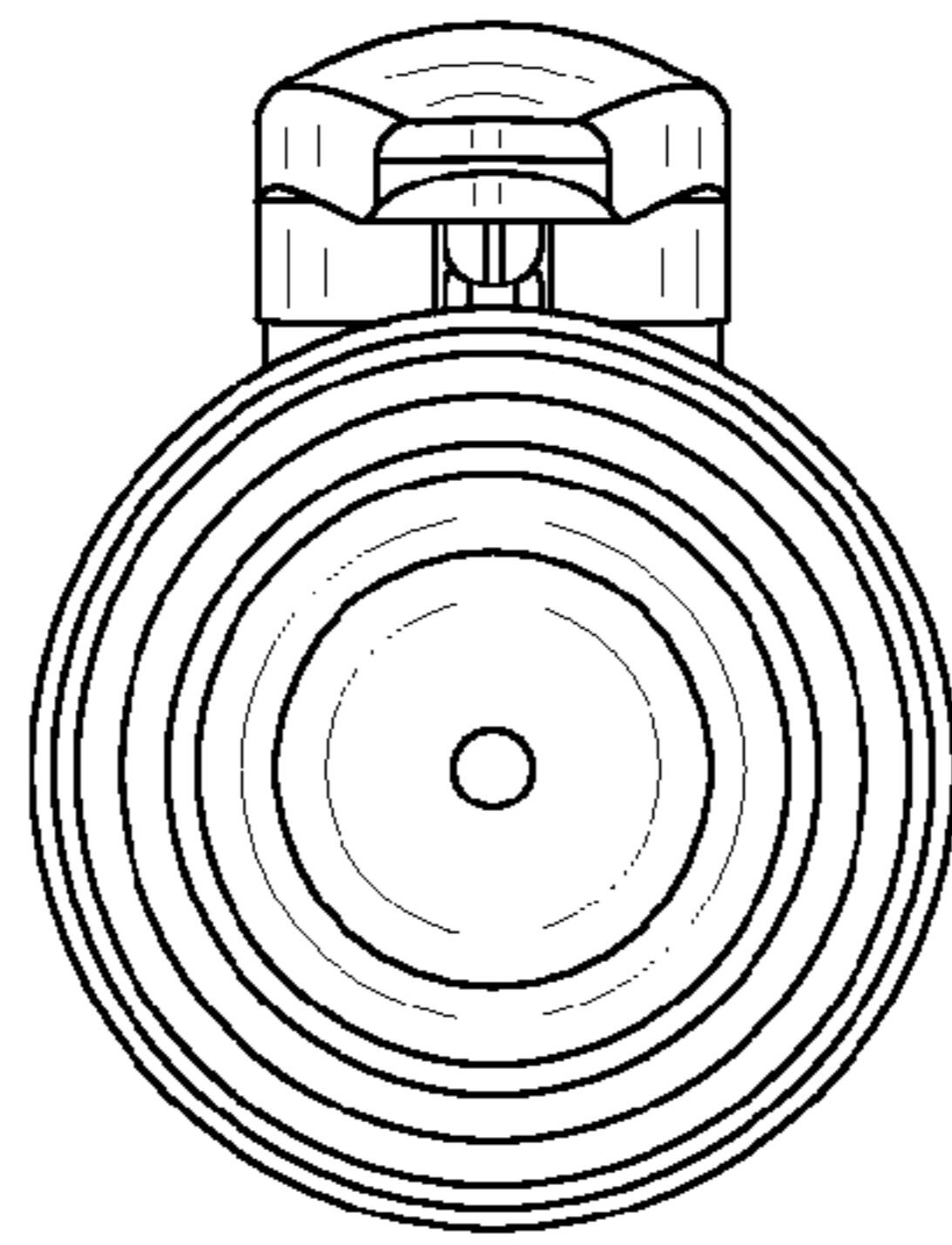

Fig. 6.

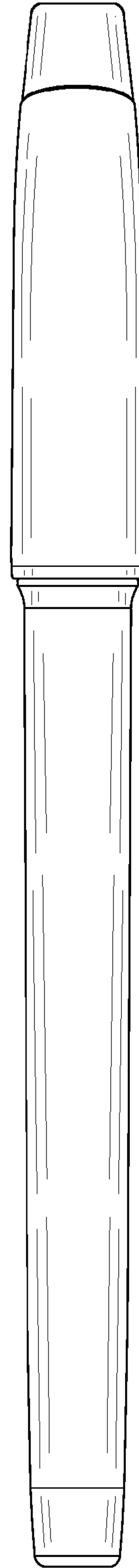

Fig. 7.