



US00D610465S

(12) **United States Design Patent**
Domingues et al.

(10) **Patent No.:** **US D610,465 S**
(45) **Date of Patent:** **** Feb. 23, 2010**

(54) **PACKAGED DOUGH PRODUCT**

(75) Inventors: **David J. Domingues**, Plymouth, MN (US); **Susan Hall**, New Hope, MN (US); **David A. Kirk**, Coon Rapids, MN (US); **Scott Kackman**, New Hope, MN (US)

(73) Assignee: **General Mills Marketing, Inc.**, Minneapolis, MN (US)

(**) Term: **14 Years**

(21) Appl. No.: **29/310,611**

(22) Filed: **Aug. 28, 2008**

(51) **LOC (9) Cl.** **09-05**

(52) **U.S. Cl.** **D9/702**

(58) **Field of Classification Search** D9/702,
D9/425, 418, 737, 730, 732, 733, 734, 757,
D9/759, 761, 424, 430, 432, 414, 711, 713;
206/223, 438, 484, 499, 525, 526, 528, 532,
206/820, 830; 426/128; 229/406, 905, 906,
229/245, 927, 125.015, 123.1, 123.2; 428/515;
220/507, 62.13, DIG. 12, 657, 659
See application file for complete search history.

(56) **References Cited**

U.S. PATENT DOCUMENTS

1,811,772 A * 6/1931 Willoughby 426/8
D211,448 S * 6/1968 Seiferth et al. D9/415
D211,449 S * 6/1968 Seiferth et al. D9/415
D349,456 S * 8/1994 Wilson D9/737
6,306,472 B1 10/2001 Buelow
6,602,529 B1 8/2003 Lonergan et al.

D560,490 S * 1/2008 Kirk et al. D9/416
D579,768 S * 11/2008 Kirk et al. D9/416
2007/0087212 A1 4/2007 Iyengar et al.

FOREIGN PATENT DOCUMENTS

WO WO 99/54120 10/1999
WO WO 2006/007239 1/2006
WO WO 2007/021665 2/2007
WO WO 2008/008804 1/2008

* cited by examiner

Primary Examiner—Caron Veynar

Assistant Examiner—Abraham Bahta

(74) *Attorney, Agent, or Firm*—Arlene L. Hornilla; Kevin Hubbard

(57) **CLAIM**

The ornamental design for a packaged dough product, as shown and described.

DESCRIPTION

FIG. 1 is a perspective view of a packaged dough product of the present design;

FIG. 2 is a front view of the packaged dough product of FIG. 1;

FIG. 3 is a top view of the packaged dough product of FIG. 1;

FIG. 4 is a bottom view of the packaged dough product of FIG. 1; and,

FIG. 5 is a right side view of the packaged dough product of FIG. 1.

The broken line portions of the drawings are for illustrative purposes only and form no part of the claimed design.

1 Claim, 3 Drawing Sheets

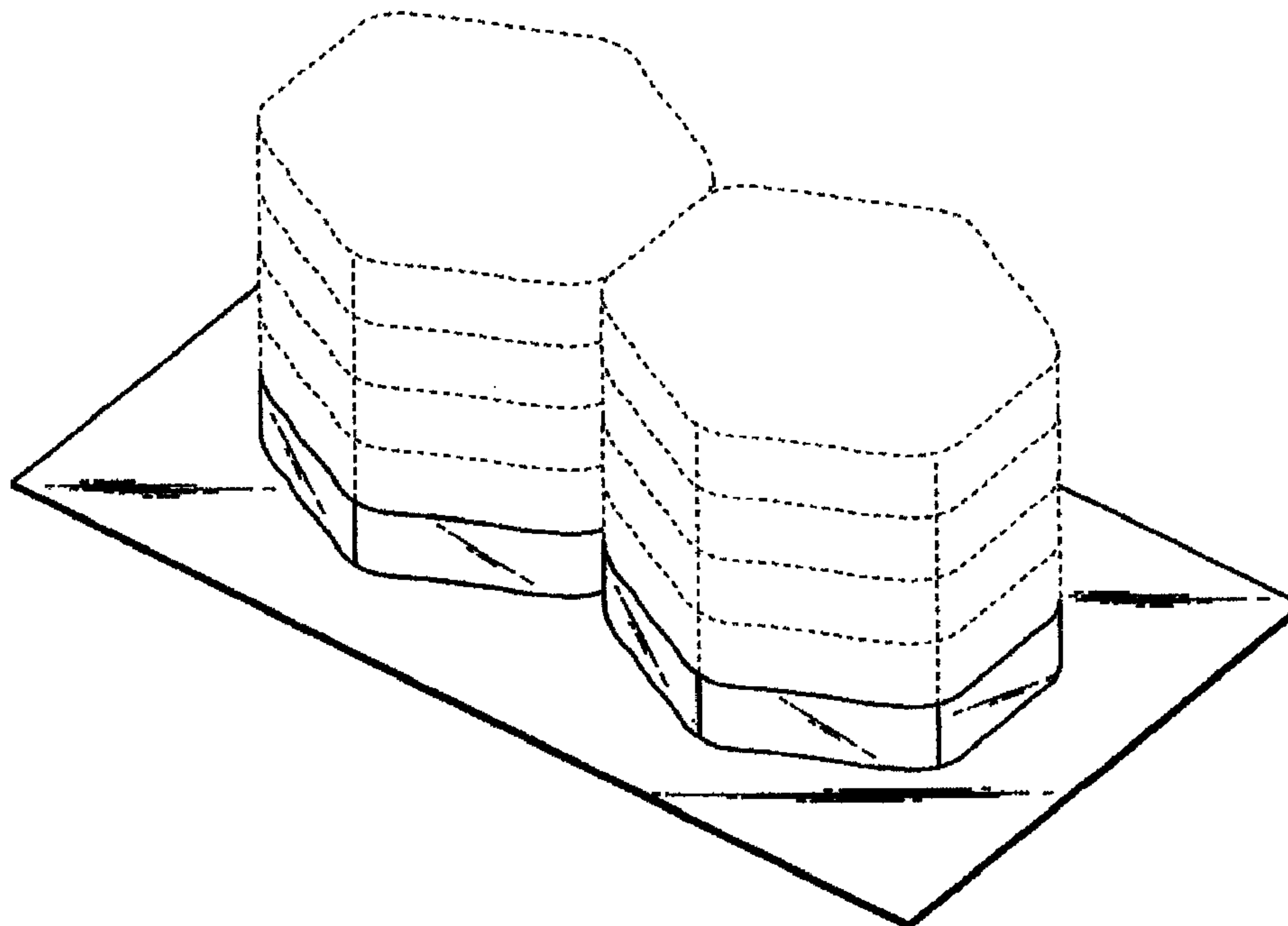

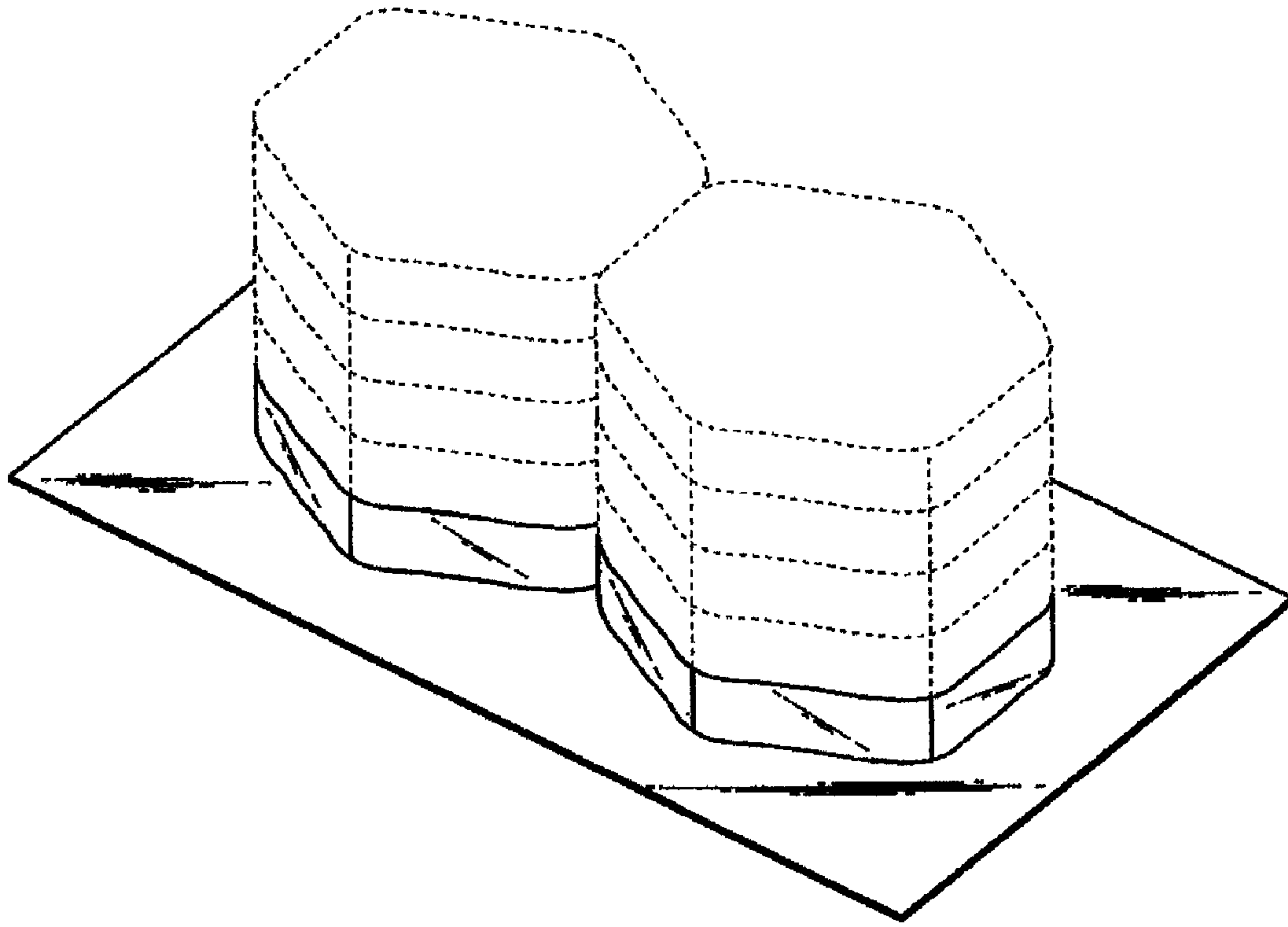

Fig. 1

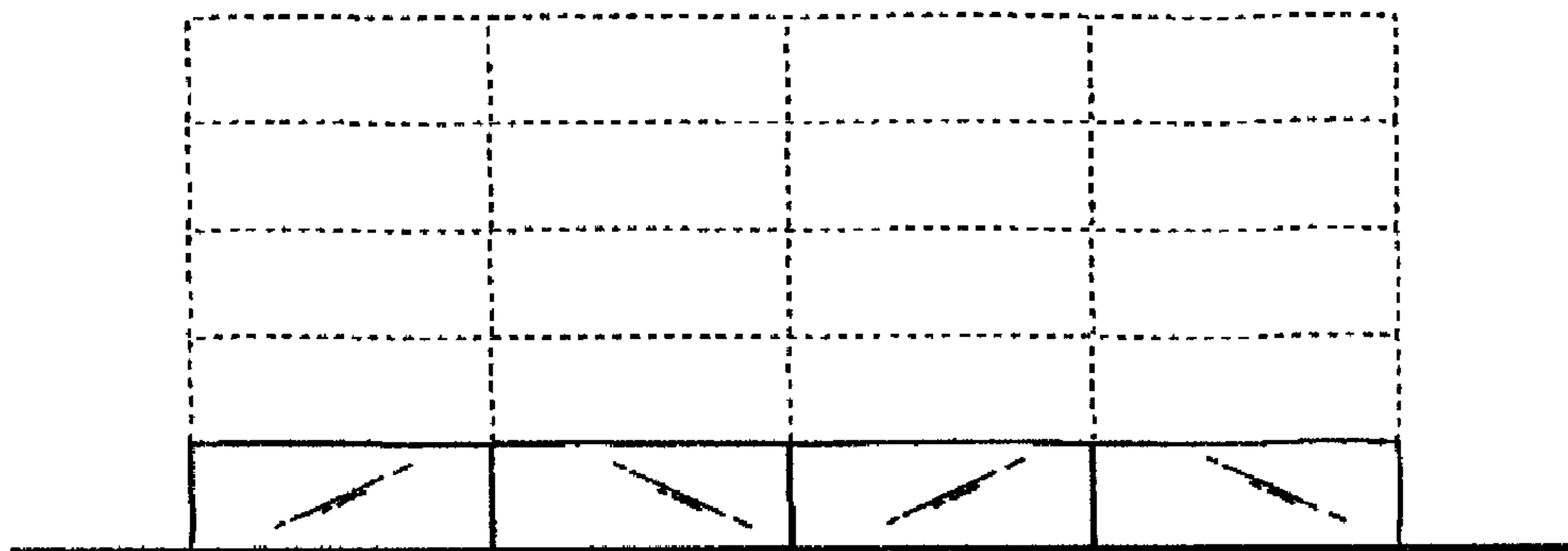

Fig. 2

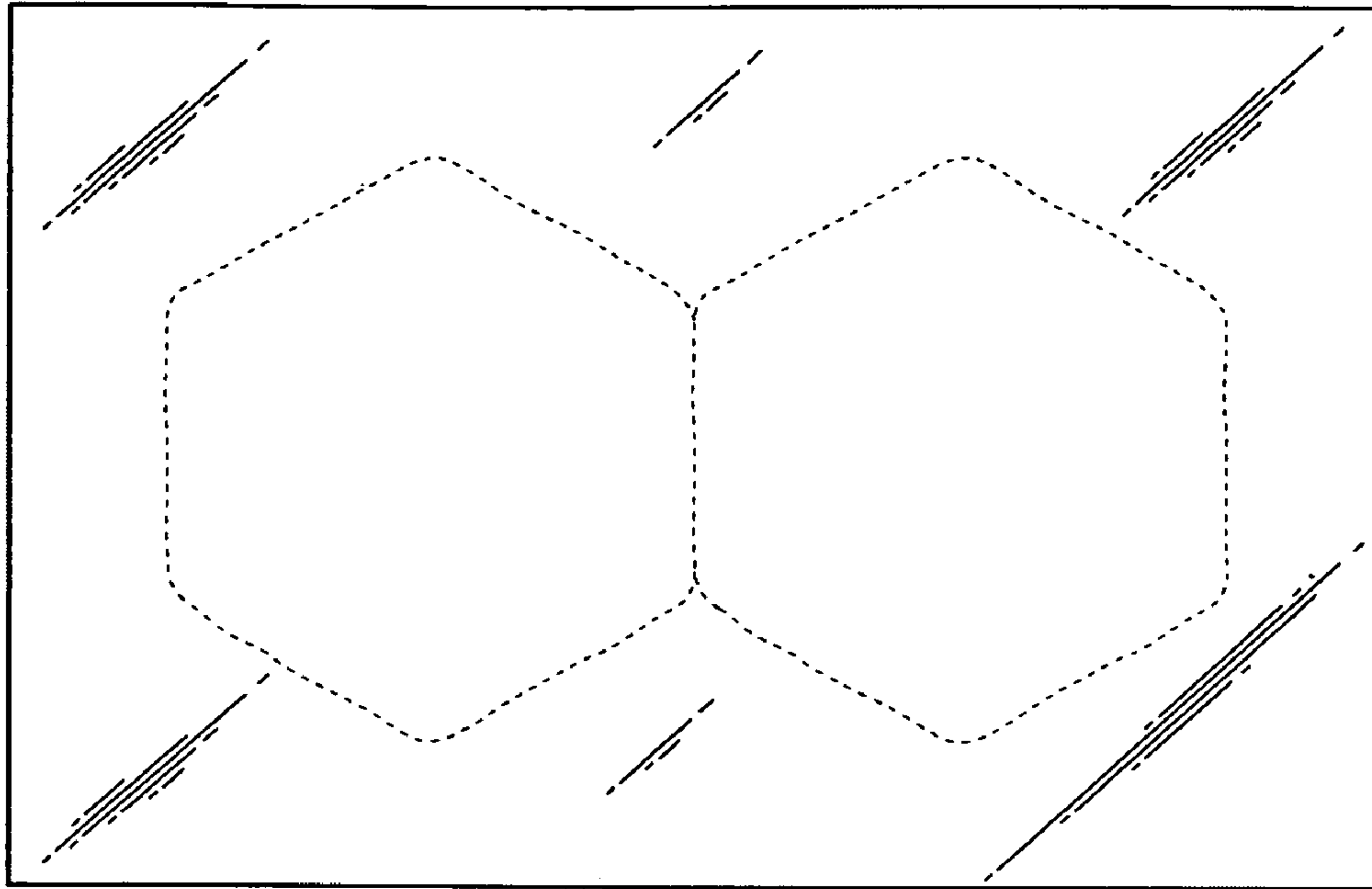

Fig. 3

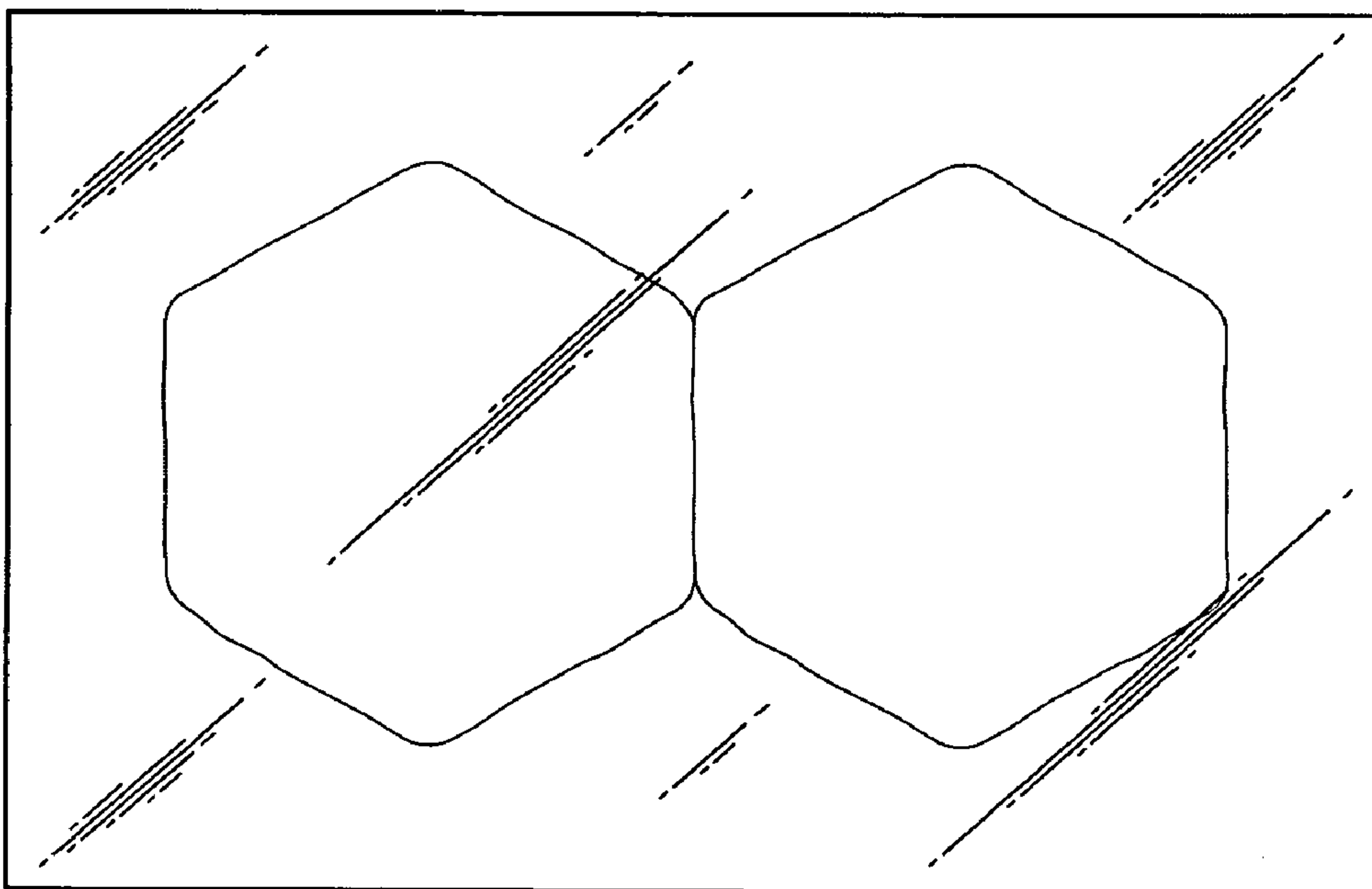

Fig. 4

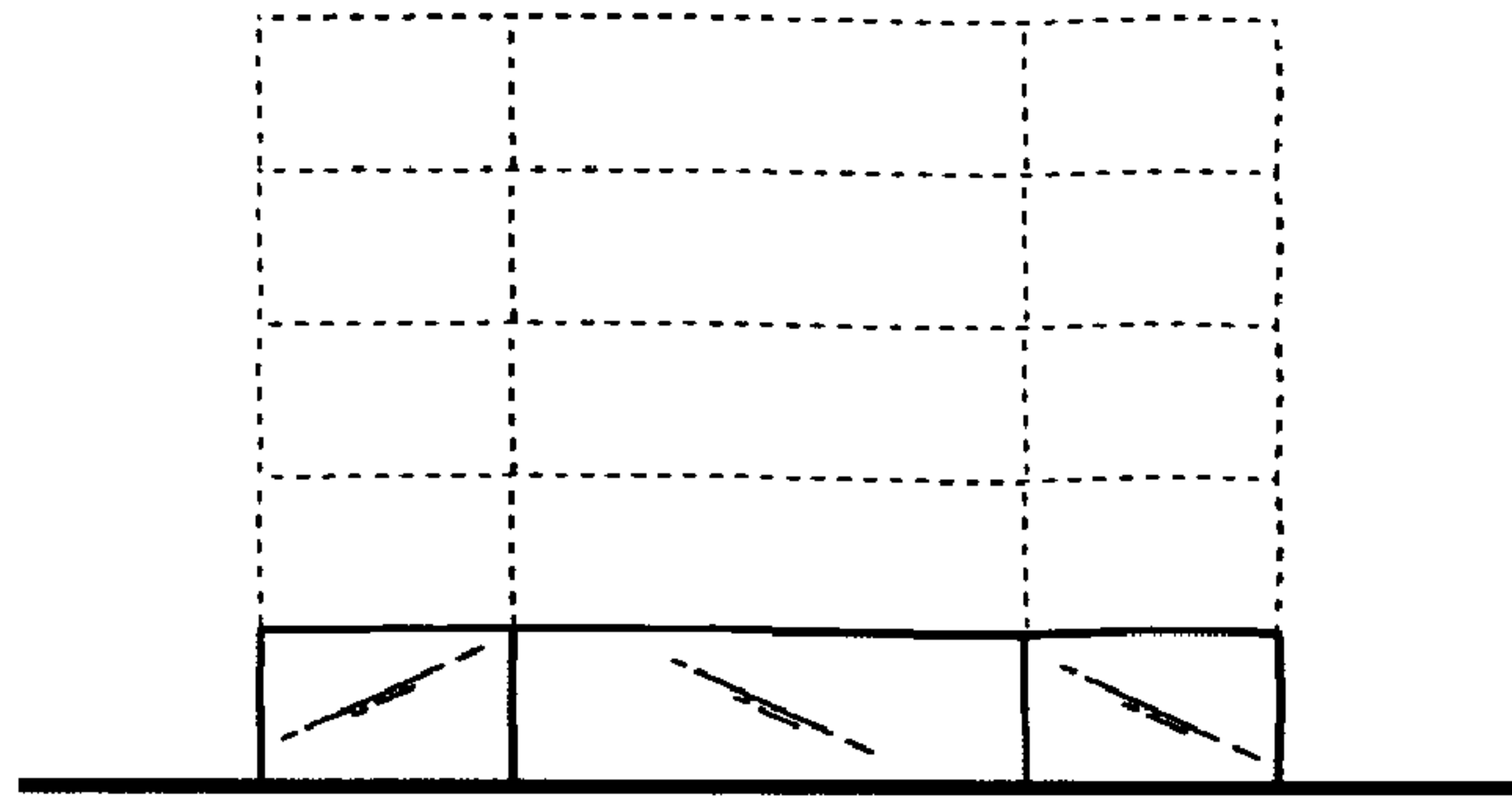

Fig. 5