



US00D609070S

(12) **United States Design Patent**  
**Tinius**

(10) **Patent No.:** **US D609,070 S**

(45) **Date of Patent:** **\*\* \*Feb. 2, 2010**

(54) **ANGLE GRINDER**

(75) Inventor: **Michael Tinius**, Elchingen (DE)

(73) Assignee: **Andreas Stihl AG & Co. KG**,  
Walblingen (DE)

(\*\*) Term: **14 Years**

(21) Appl. No.: **29/298,409**

(22) Filed: **Dec. 5, 2007**

(30) **Foreign Application Priority Data**

Jun. 5, 2007 (EM) ..... 000744024-0002

(51) **LOC (9) Cl.** ..... **08-01**

(52) **U.S. Cl.** ..... **D8/62**

(58) **Field of Classification Search** ..... D32/15,  
D32/17, 19; D8/67, 62, 61, 66; D4/102;  
451/456, 451, 359, 358, 357, 356, 355, 354,  
451/353, 351, 344; 310/50; 173/170; 125/13.01;  
123/189 E

See application file for complete search history.

(56) **References Cited**

**U.S. PATENT DOCUMENTS**

3,583,106	A *	6/1971	Dobbertin	.....	451/358
4,188,935	A *	2/1980	Tubesing	.....	125/13.01
4,809,438	A *	3/1989	Nagashima et al.	.....	30/390
5,038,474	A *	8/1991	Larsson et al.	.....	30/123.3
5,540,210	A *	7/1996	Jones	.....	125/13.01
5,826,478	A *	10/1998	Zerrer	.....	83/169
5,855,067	A *	1/1999	Taomo et al.	.....	30/122
6,374,501	B1 *	4/2002	Claesson	.....	30/389
6,546,631	B2 *	4/2003	Iida et al.	.....	30/124
6,591,826	B1 *	7/2003	Donnerdal	.....	125/13.01
6,955,152	B2 *	10/2005	Uhl et al.	.....	123/198 E

7,137,877	B2 *	11/2006	Uhl et al.	.....	451/358
D533,757	S *	12/2006	Arvidsson et al.	.....	D8/66
D561,551	S *	2/2008	Tinius	.....	D8/66
2001/0003983	A1 *	6/2001	Iida et al.	.....	125/13.01
2004/0261754	A1 *	12/2004	Uhl et al.	.....	123/198 E
2006/0137653	A1 *	6/2006	Amend et al.	.....	123/400

\* cited by examiner

*Primary Examiner*—Cathron C Brooks

*Assistant Examiner*—Austin Murphy

(74) *Attorney, Agent, or Firm*—McGuireWoods LLP

(57) **CLAIM**

I claim the ornamental design for an angle grinder, as shown and described.

**DESCRIPTION**

FIG. 1 is a left side view of the ornamental appearance of the angle grinder;

FIG. 2 is a right side view of the angle grinder shown in FIG. 1;

FIG. 3 is a front view of the angle grinder shown in FIG. 1;

FIG. 4 is a rear view of the angle grinder shown in FIG. 1;

FIG. 5 is a top view of the angle grinder shown in FIG. 1;

FIG. 6 is a front left perspective view of the angle grinder shown in FIG. 1; and,

FIG. 7 is a rear right perspective view of the angle grinder shown in FIG. 1.

The broken lines shown in the drawings represent portions of the angle grinder that form no part of the claimed design.

Any surfaces of the design not shown, including interior or bottom surfaces, form no part of the claimed invention.

**1 Claim, 7 Drawing Sheets**

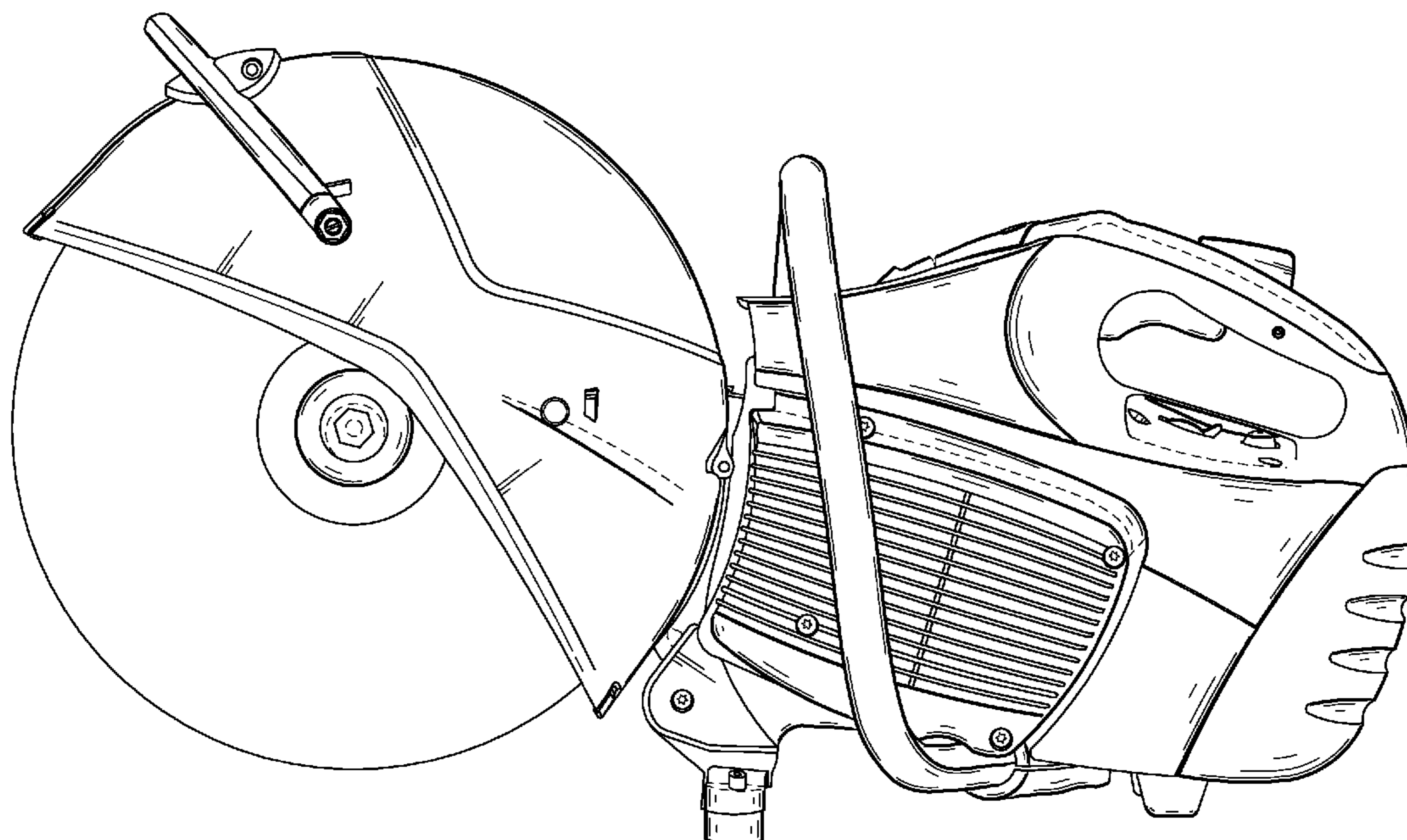

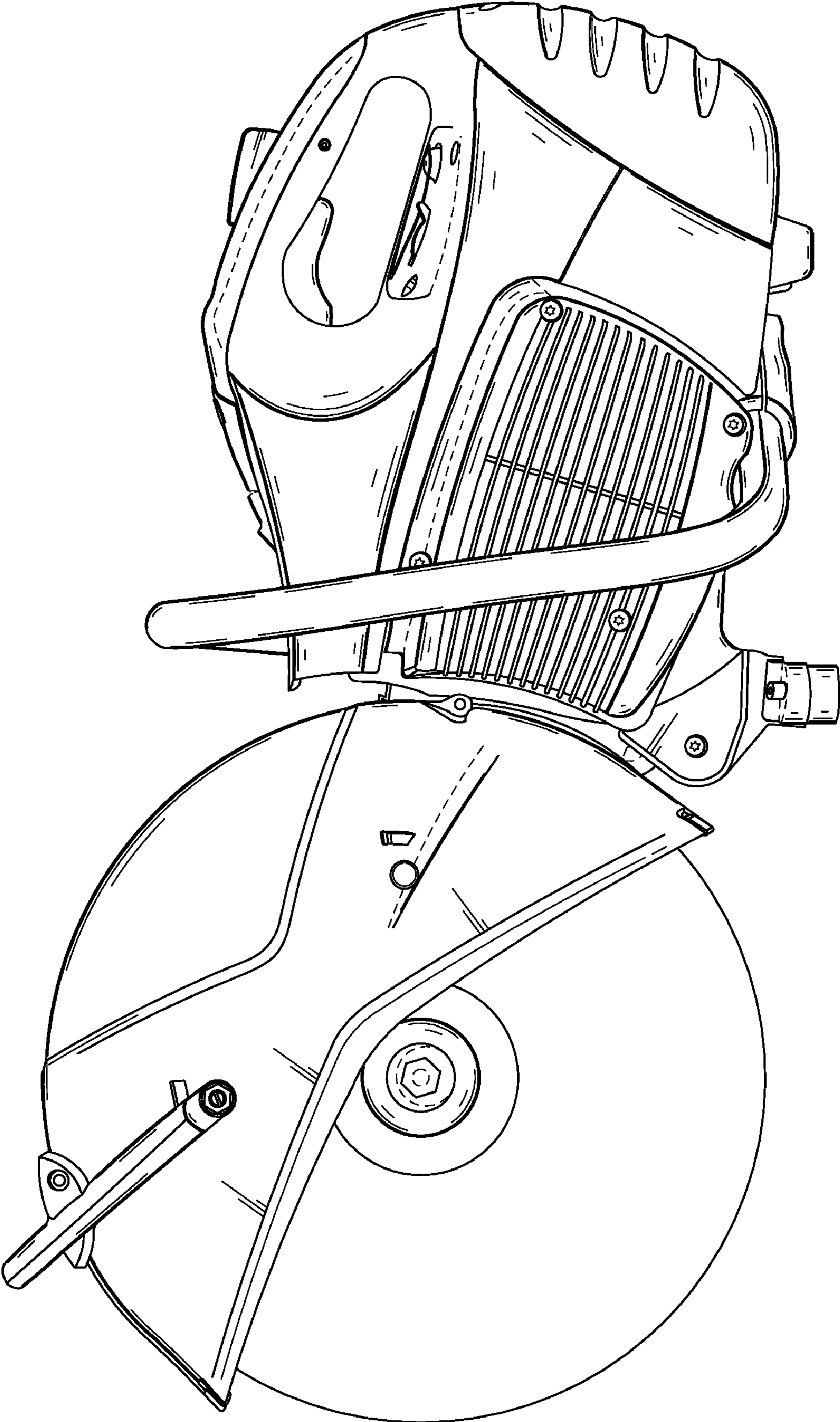

*FIG. 1*

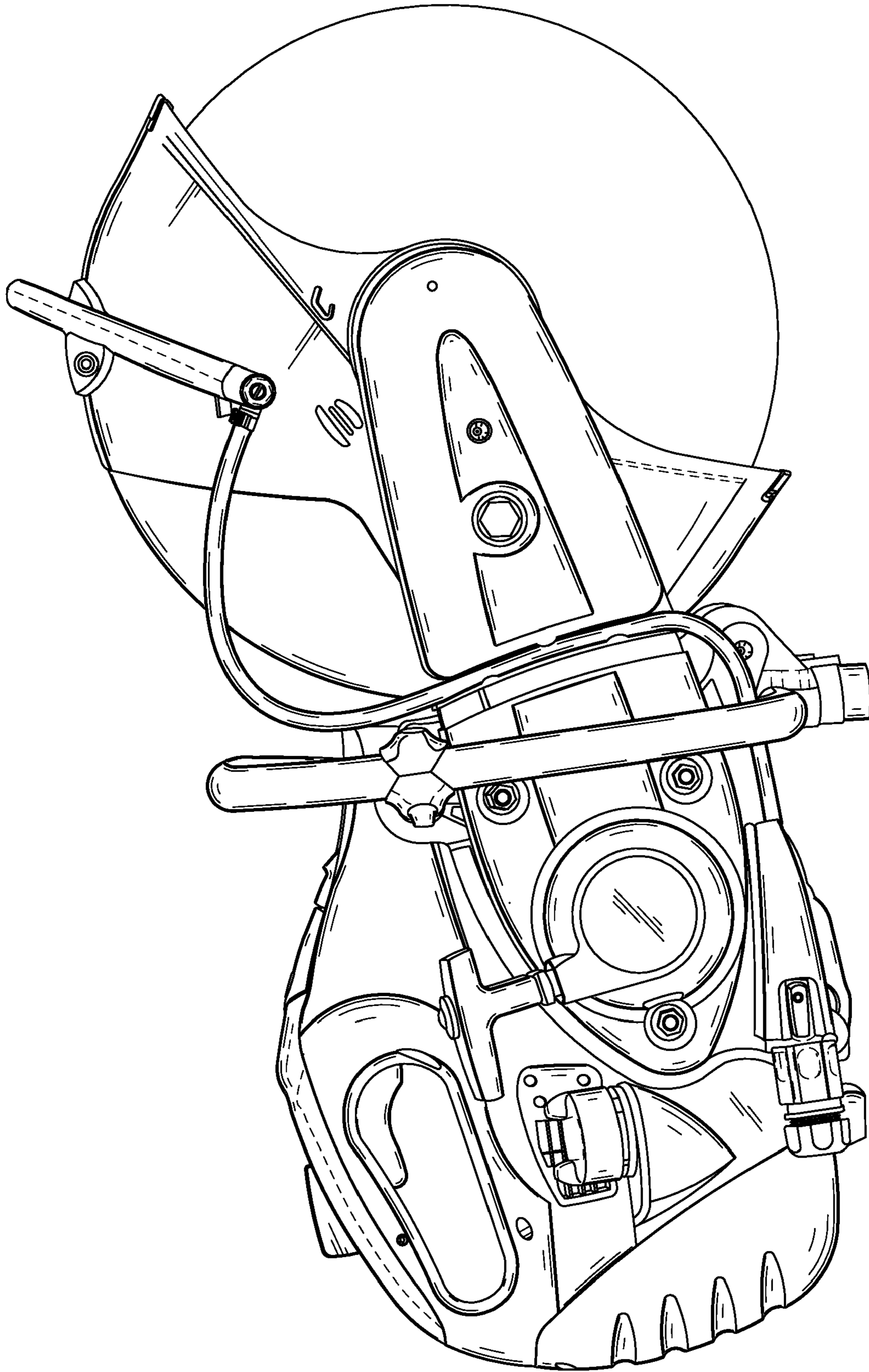
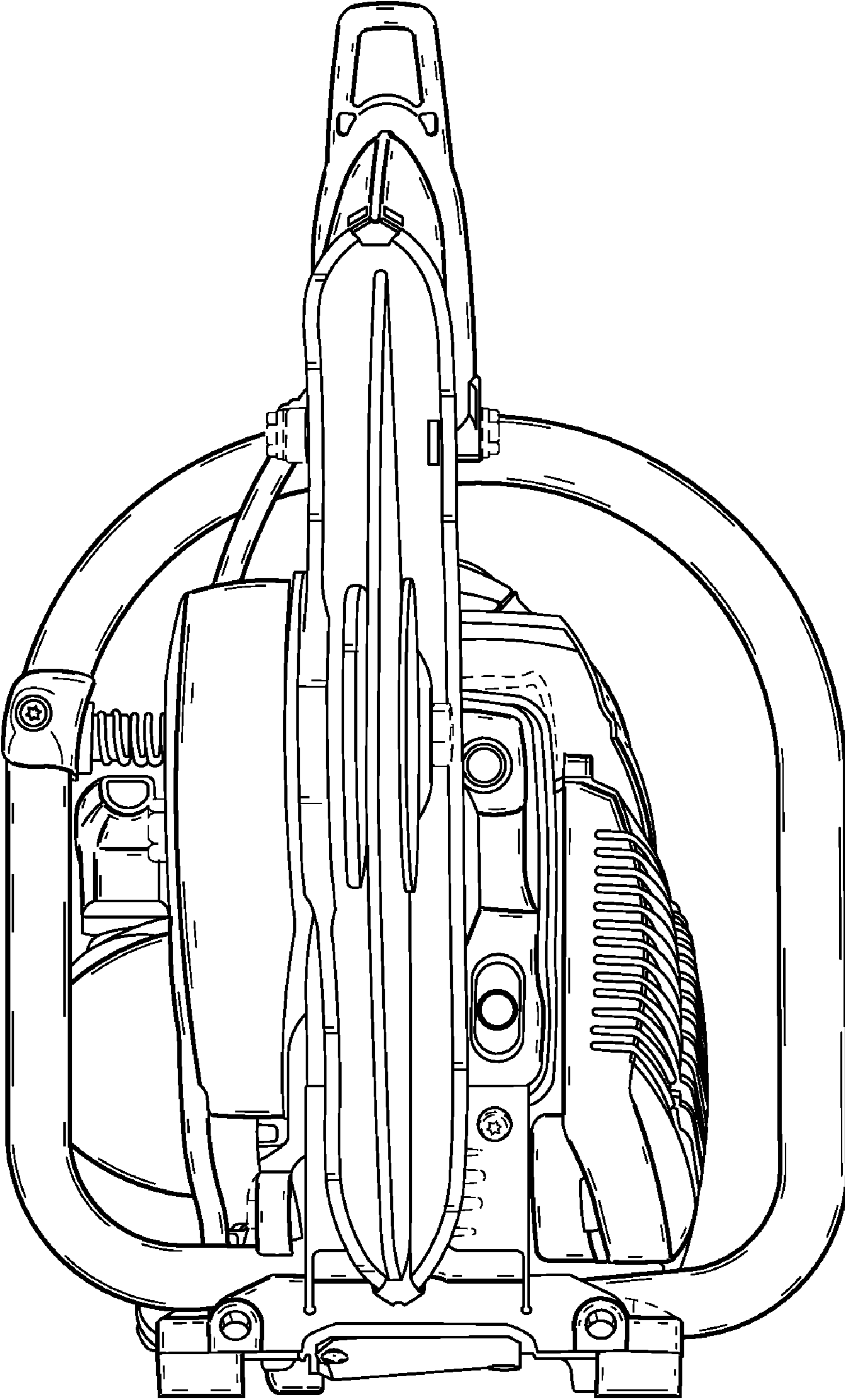
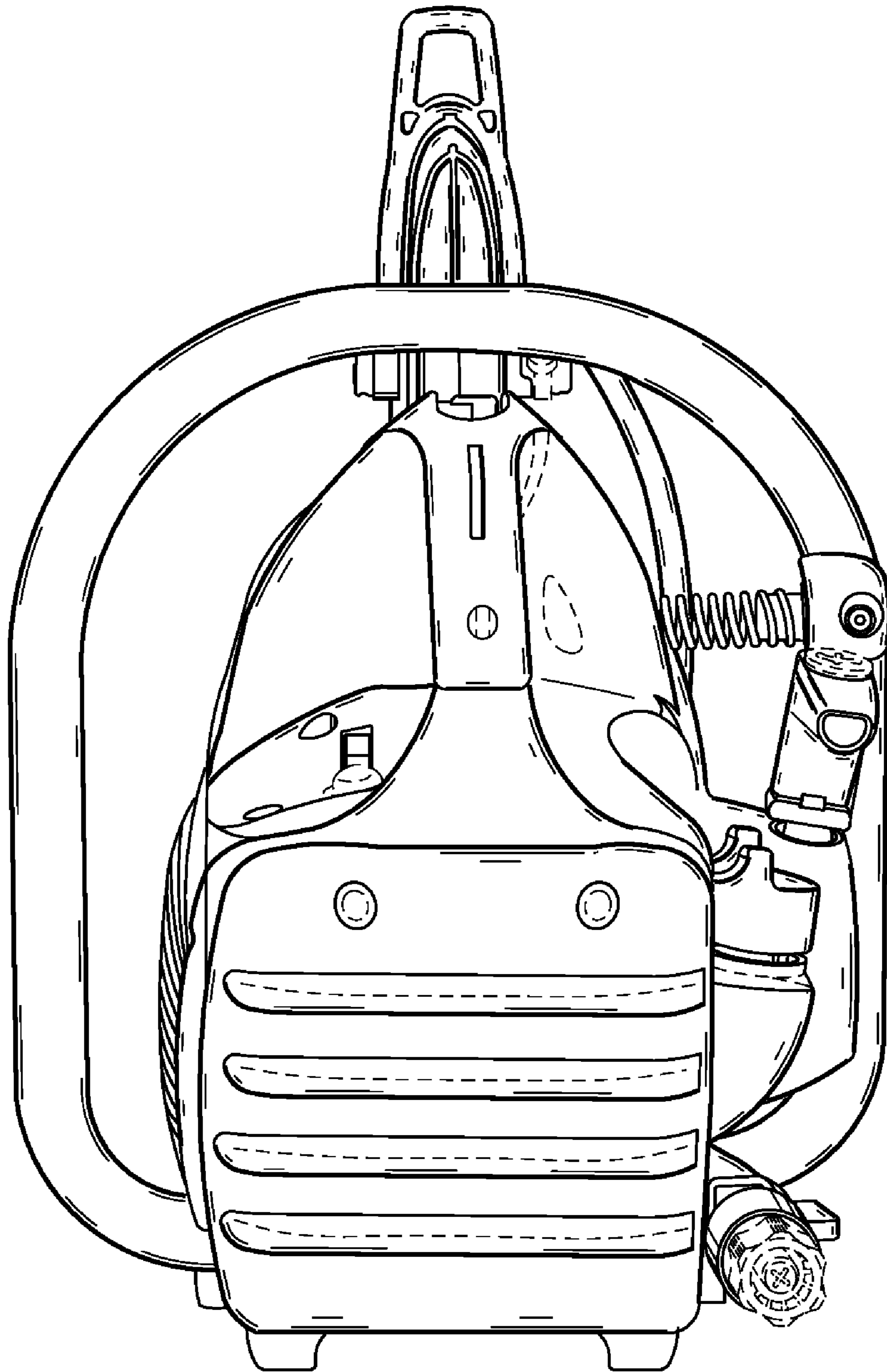

FIG. 2



*FIG. 3*



*FIG. 4*

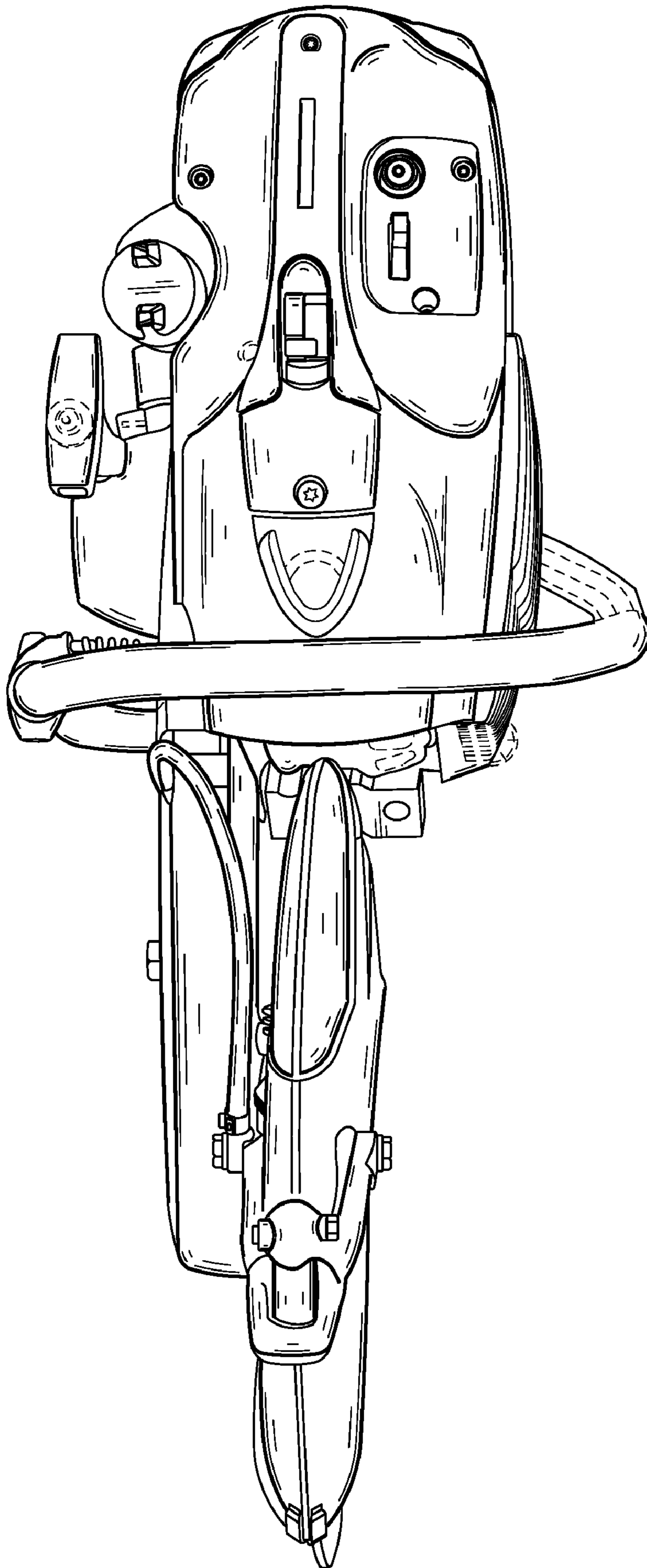

*FIG. 5*

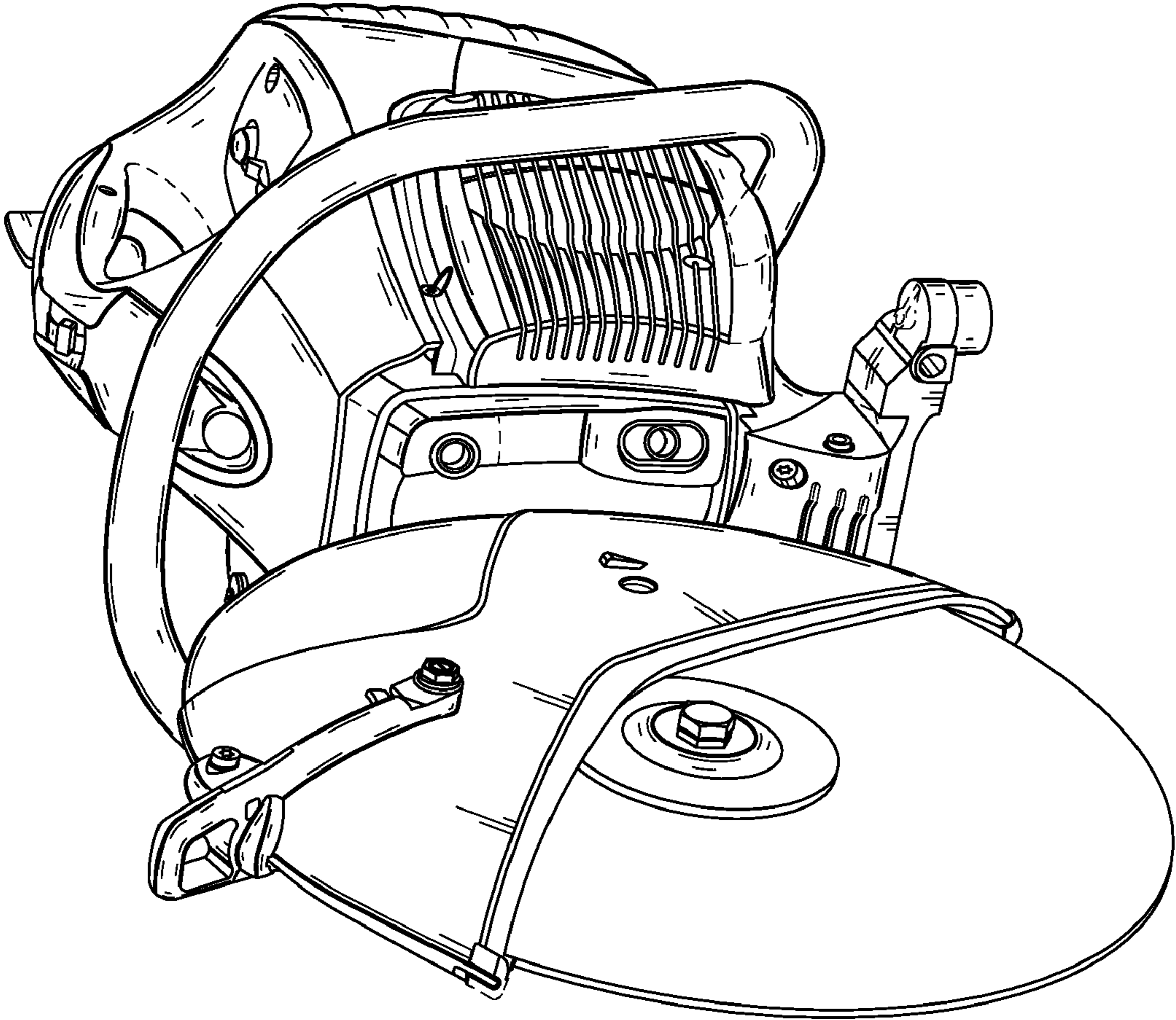
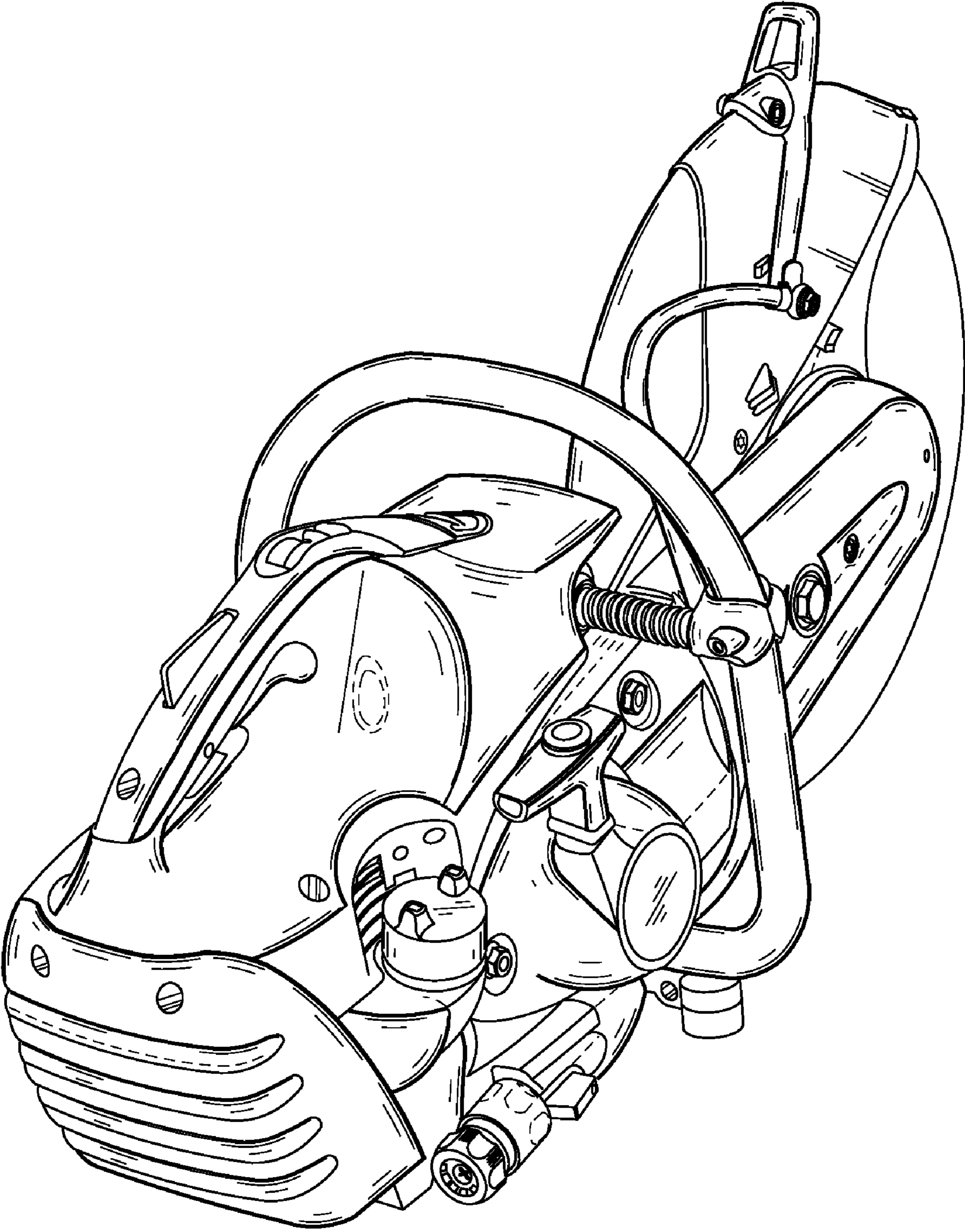

FIG. 6



*FIG. 7*