



US00D608114S

(12) **United States Design Patent**
Yung Lang

(10) **Patent No.:** **US D608,114 S**
(45) **Date of Patent:** **** Jan. 19, 2010**

(54) **BENCH TOP ORGANIZER**

(75) Inventor: **Hau Yung Lang**, Diamond Bar, CA
(US)

(73) Assignee: **Tung Hsin Trading Corp.**, City of
Industry, CA (US)

(**) Term: **14 Years**

(21) Appl. No.: **29/302,171**

(22) Filed: **Jan. 11, 2008**

Related U.S. Application Data

(63) Continuation of application No. 11/272,162, filed on
Nov. 10, 2005, now abandoned.

(51) **LOC (9) Cl.** **06-04**

(52) **U.S. Cl.** **D6/475**

(58) **Field of Classification Search** D6/475;
D19/65, 74-75, 81-86, 90-92, 95, 99, 100;
206/214, 224; 211/10-11, 45, 50, 55
See application file for complete search history.

(56) **References Cited**

U.S. PATENT DOCUMENTS

D234,727	S	*	4/1975	Mark	D3/273
D252,409	S	*	7/1979	Rose et al.	D3/275
D304,842	S	*	11/1989	Barone et al.	D19/75
4,894,581	A		1/1990	Roberts		
4,916,917	A		4/1990	Jackson et al.		
D313,520	S	*	1/1991	Block	D6/467
5,037,165	A		8/1991	Rapp et al.		

D332,630	S	*	1/1993	Brussing	D19/77
D334,852	S	*	4/1993	Beirise	D6/436
D367,948	S	*	3/1996	Hsu	D28/73
D387,498	S	*	12/1997	Sussman	D28/73
D422,436	S	*	4/2000	Fisher	D6/511
6,397,515	B1		6/2002	Brown et al.		
D502,509	S	*	3/2005	DeCarlo et al.	D19/75
D580,987	S	*	11/2008	Diller	D19/77

* cited by examiner

Primary Examiner—Elizabeth A Albert

Assistant Examiner—Kelley A Donnelly

(74) *Attorney, Agent, or Firm*—Timothy X. Gibson; Gibson
& Dernier LLP

(57)

CLAIM

The ornamental design for a bench top organizer, as shown
and described.

DESCRIPTION

FIG. 1 is a perspective view of the bench top organizer of the
present invention;

FIG. 2 is a front view thereof;

FIG. 3 is a rear view thereof;

FIG. 4 is a right side view thereof;

FIG. 5 is a left side view thereof;

FIG. 6 is a top view thereof; and,

FIG. 7 is a bottom view thereof.

The broken lines in the drawings are for environmental pur-
poses only and form no part of the claimed design.

1 Claim, 6 Drawing Sheets

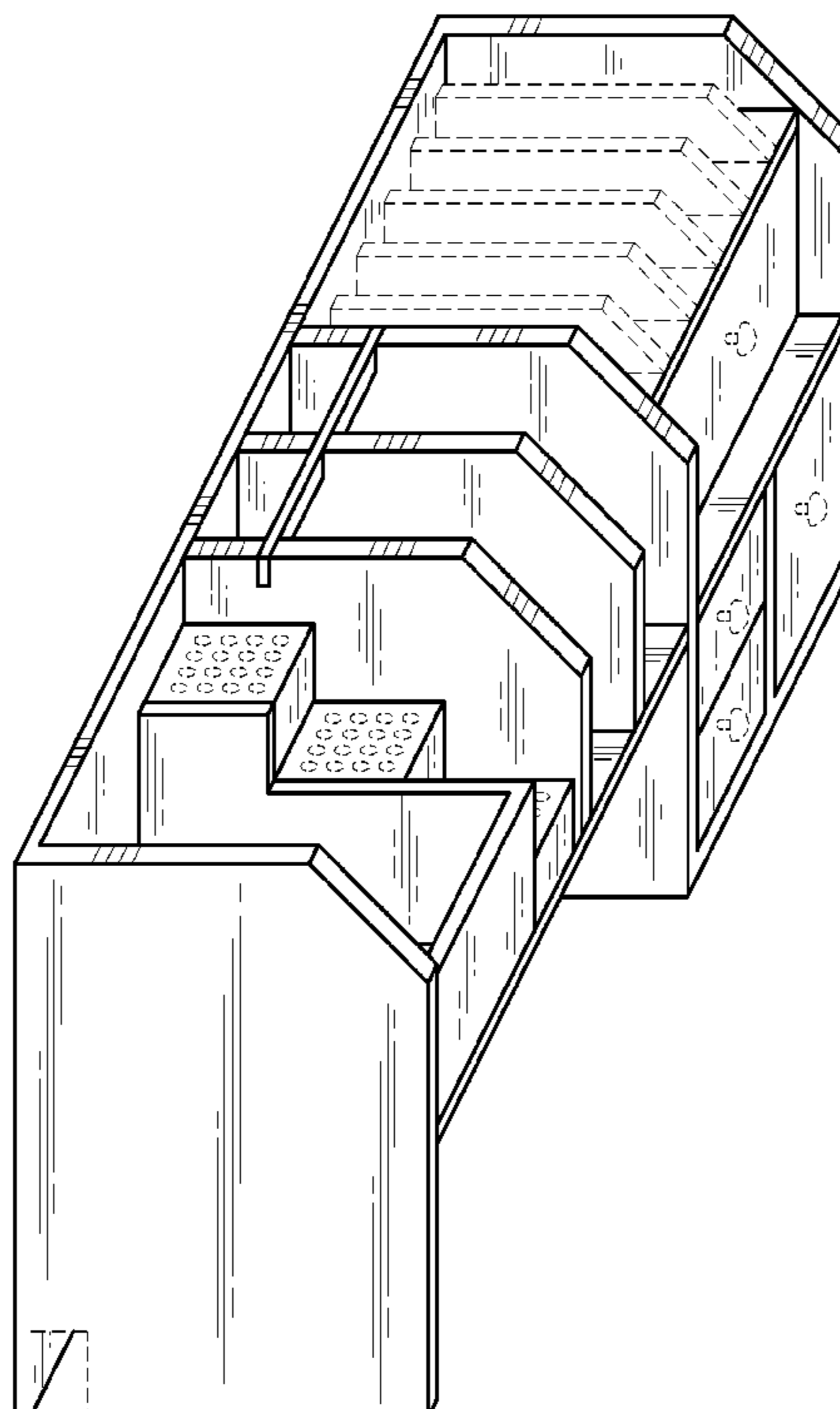

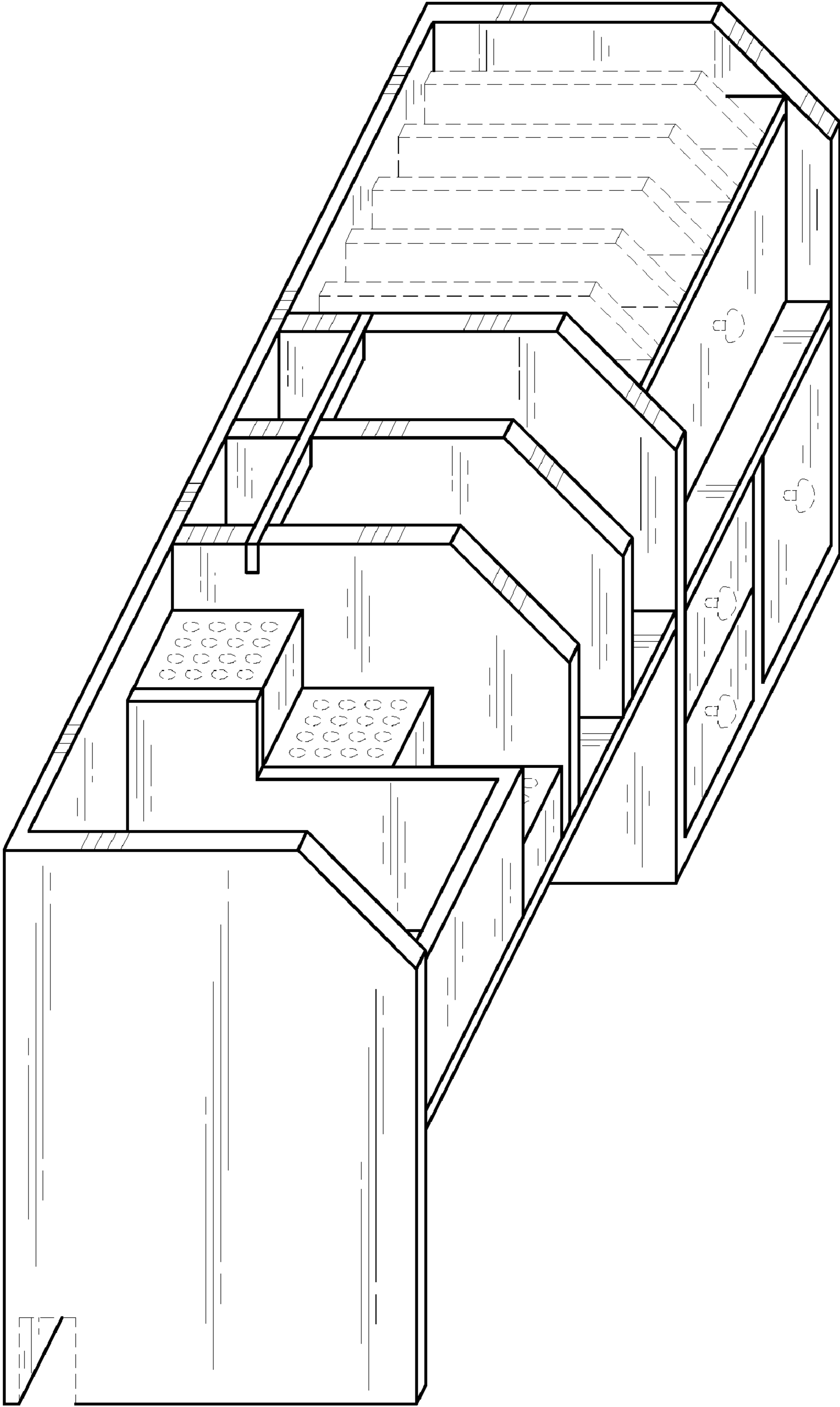

FIG. 1

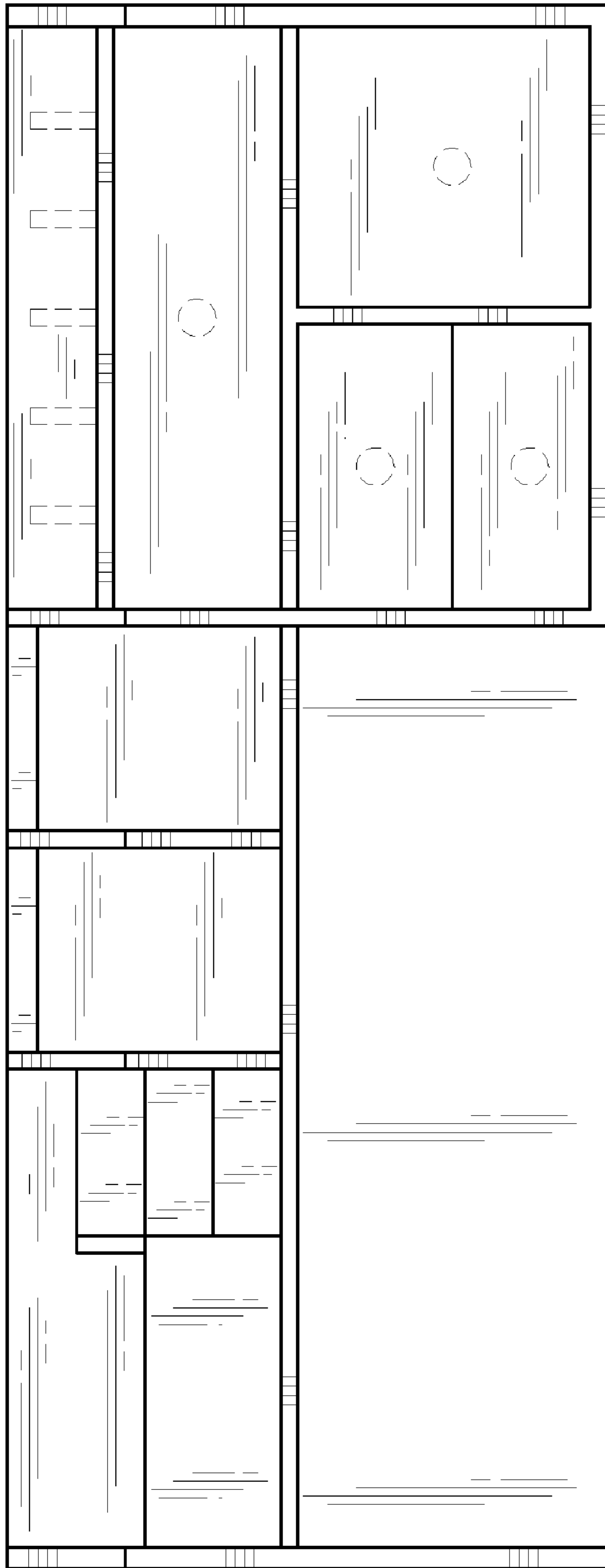

FIG. 2

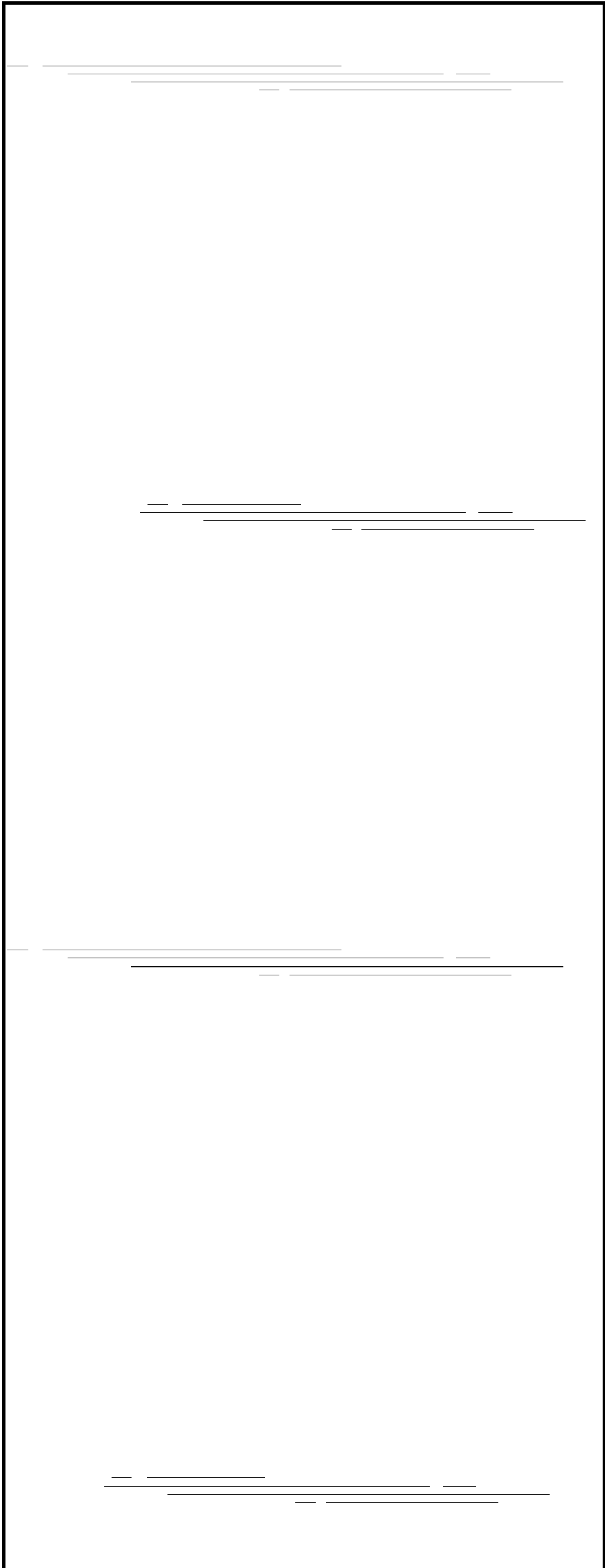

FIG. 3

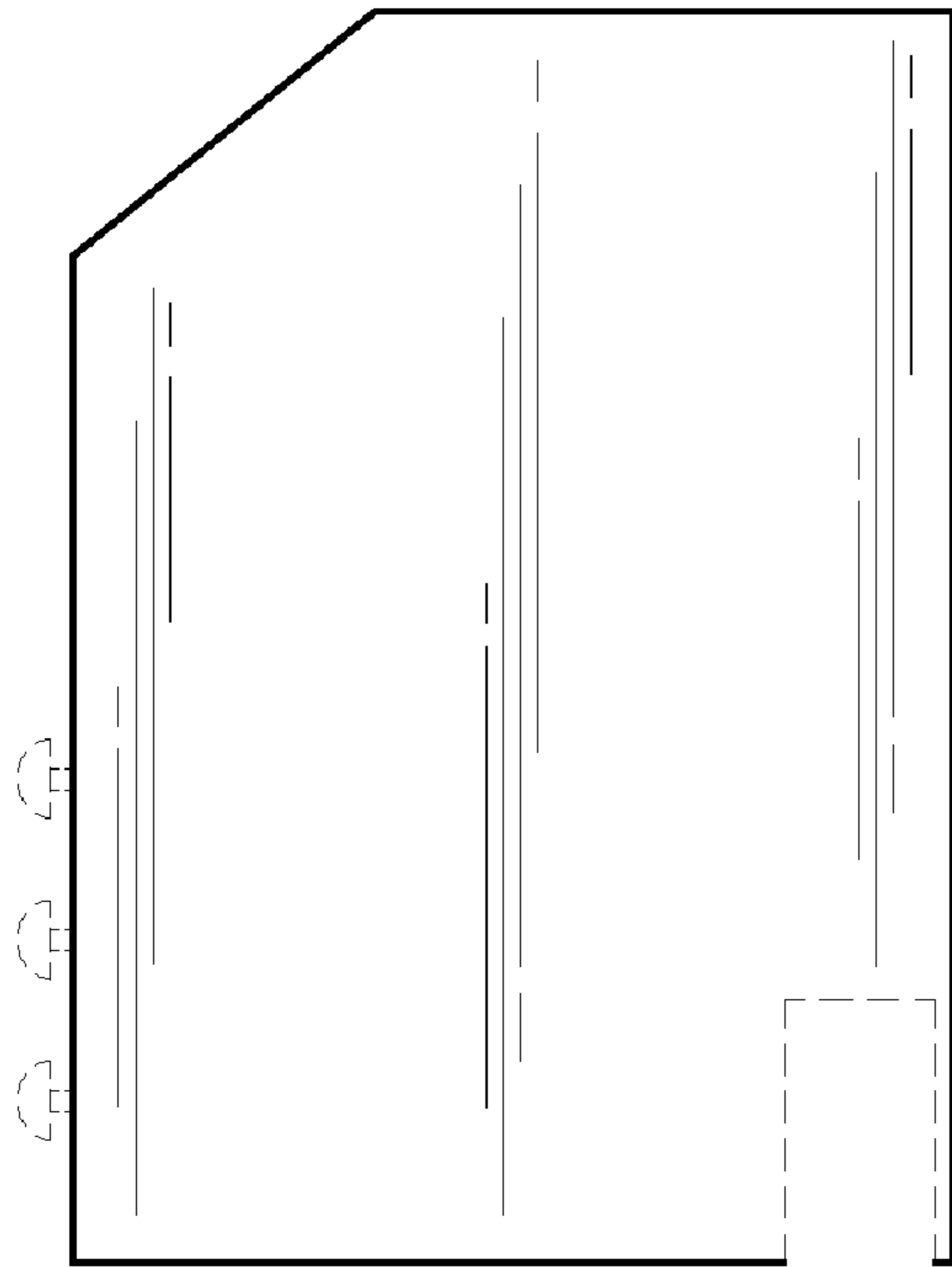

FIG. 4

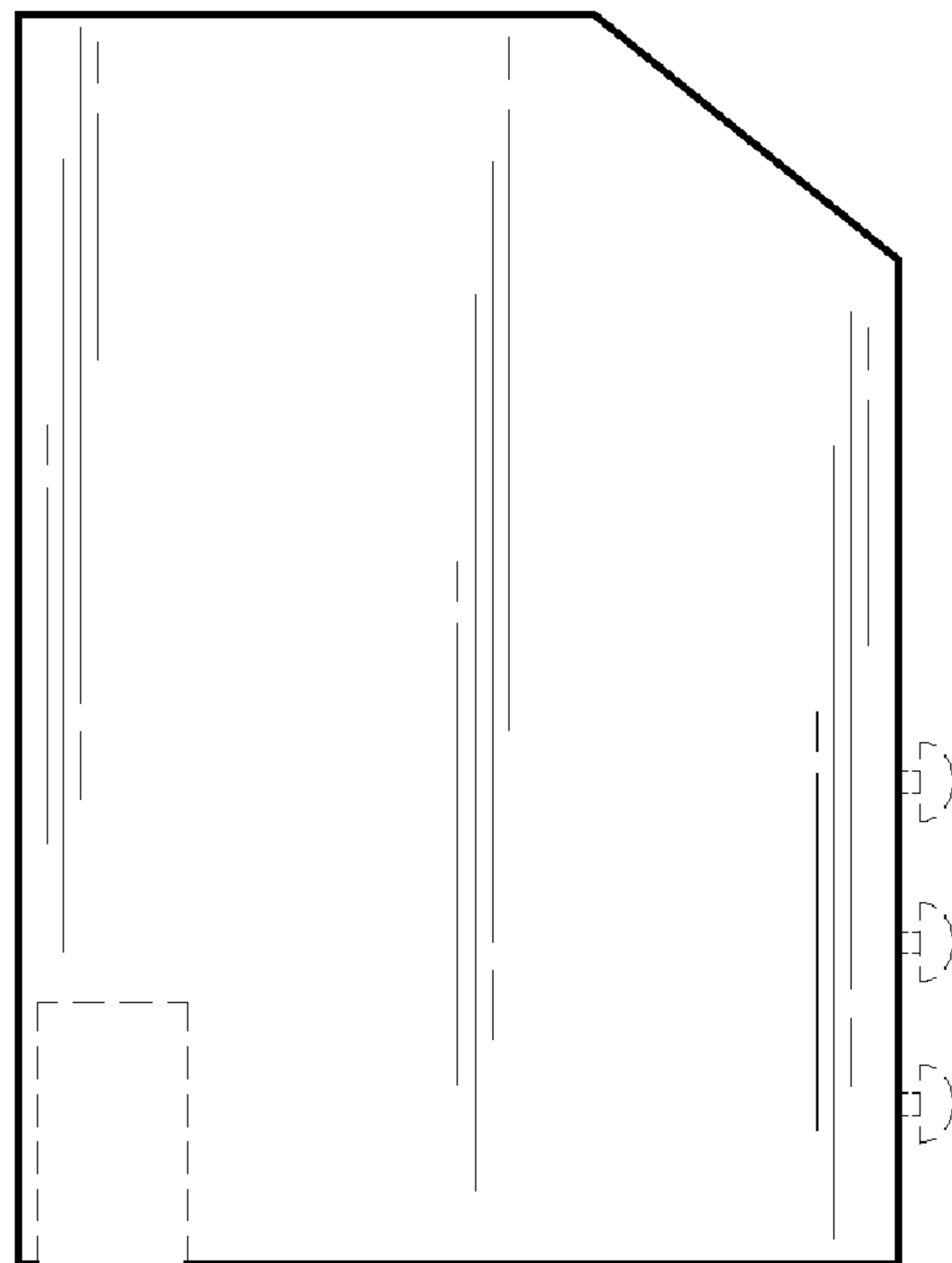

FIG. 5

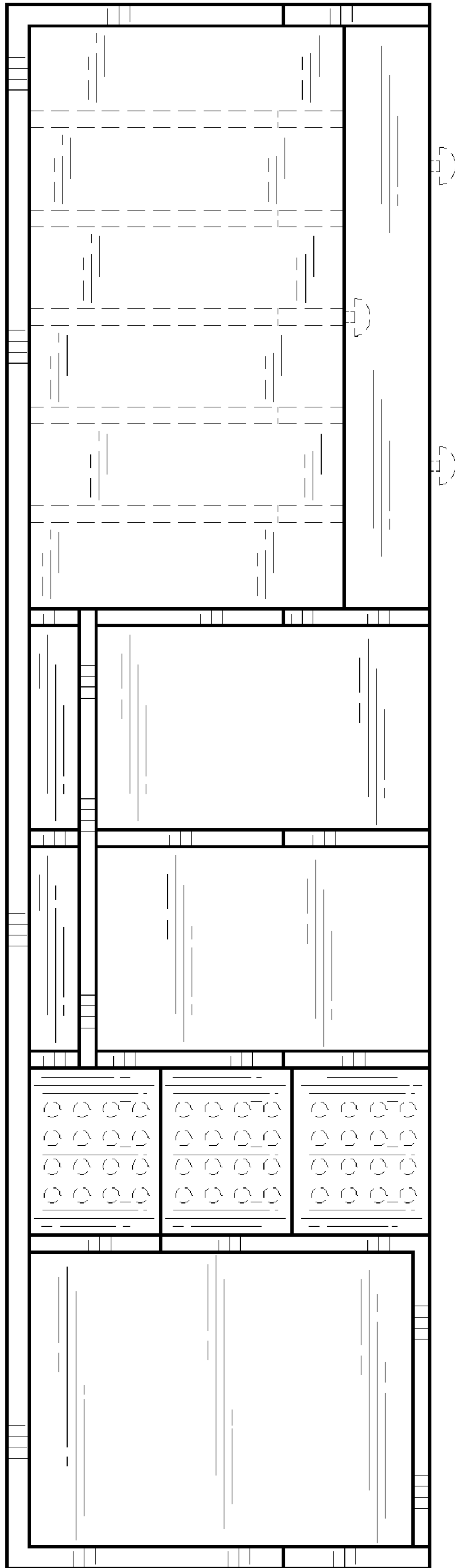

FIG. 6

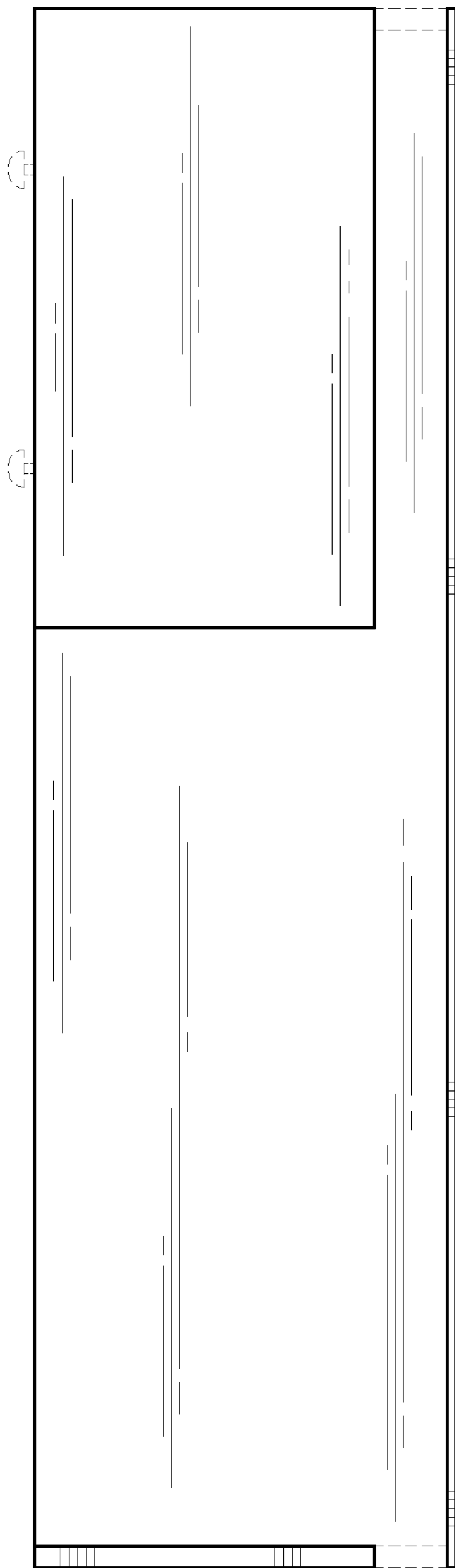

FIG. 7