

US00D603674S

(12) **United States Design Patent**
Werner

(10) **Patent No.:** **US D603,674 S**

(45) **Date of Patent:** **** Nov. 10, 2009**

(54) **HAMMER DRILL**

(75) Inventor: **Immanuel Werner**, St. Johann (DE)

(73) Assignee: **Robert Bosch GmbH**, Stuttgart (DE)

(**) Term: **14 Years**

(21) Appl. No.: **29/334,804**

(22) Filed: **Apr. 2, 2009**

(30) **Foreign Application Priority Data**

Feb. 11, 2009 (EM) 001086755

(51) **LOC (9) Cl.** **08-02**

(52) **U.S. Cl.** **D8/67**

(58) **Field of Classification Search** D8/61-70;
81/57.11, 54, 57.42; 173/170, 271; 74/55

See application file for complete search history.

(56) **References Cited**

U.S. PATENT DOCUMENTS

- D77,676 S * 2/1929 Decker D8/69
- D77,937 S * 3/1929 Decker D8/69
- 1,860,736 A * 5/1932 Gartin 91/232
- 1,887,762 A * 11/1932 Horton 74/55
- D111,005 S * 8/1938 Sperry D8/61
- 2,533,487 A * 12/1950 Maurer et al. 173/170
- 2,776,653 A * 1/1957 Eaton 254/30
- 3,270,369 A * 9/1966 Mandell 452/160
- 3,978,576 A * 9/1976 Mustoe, Jr. 254/18
- D242,427 S * 11/1976 Wilsgaard D8/67
- 4,036,085 A * 7/1977 Sjostrand et al. 81/464
- 4,078,766 A * 3/1978 Saurwein 254/18
- 4,303,131 A * 12/1981 Clark 173/207
- D272,710 S * 2/1984 Antonick et al. D8/67
- 4,440,237 A * 4/1984 Casperovich 173/206

- 4,483,402 A * 11/1984 Vonhoff, Jr. 173/207
- 4,548,279 A * 10/1985 Zaruba 173/170
- 4,673,042 A * 6/1987 Steiner 173/219
- D292,368 S * 10/1987 Mikiya D8/61
- D301,967 S * 7/1989 Sakamoto et al. D8/67
- D329,794 S * 9/1992 Graham D8/68
- D335,619 S * 5/1993 Ogawa et al. D8/67
- D343,345 S * 1/1994 Ogawa et al. D8/69
- 5,845,719 A * 12/1998 Matsumoto et al. 173/114
- D411,426 S * 6/1999 Morita D8/69
- 6,050,345 A * 4/2000 Jarvinen et al. 173/31
- D447,677 S * 9/2001 Stirm D8/69
- 7,013,984 B2 * 3/2006 Atkinson et al. 173/1
- D570,174 S * 6/2008 Stirm D8/67
- D580,250 S * 11/2008 Strim D8/67

* cited by examiner

Primary Examiner—Cathron C Brooks

Assistant Examiner—Austin Murphy

(74) *Attorney, Agent, or Firm*—Victor A. Henzi

(57) **CLAIM**

The ornamental design for the hammer drill, as shown and described.

DESCRIPTION

FIG. 1 is a front right perspective view of the hammer drill;

FIG. 2 is a right elevational view thereof;

FIG. 3 is a left elevational view thereof;

FIG. 4 is a front elevational view thereof;

FIG. 5 is a rear elevational view thereof;

FIG. 6 is a top plan view thereof; and,

FIG. 7 is a bottom plan view thereof.

1 Claim, 6 Drawing Sheets

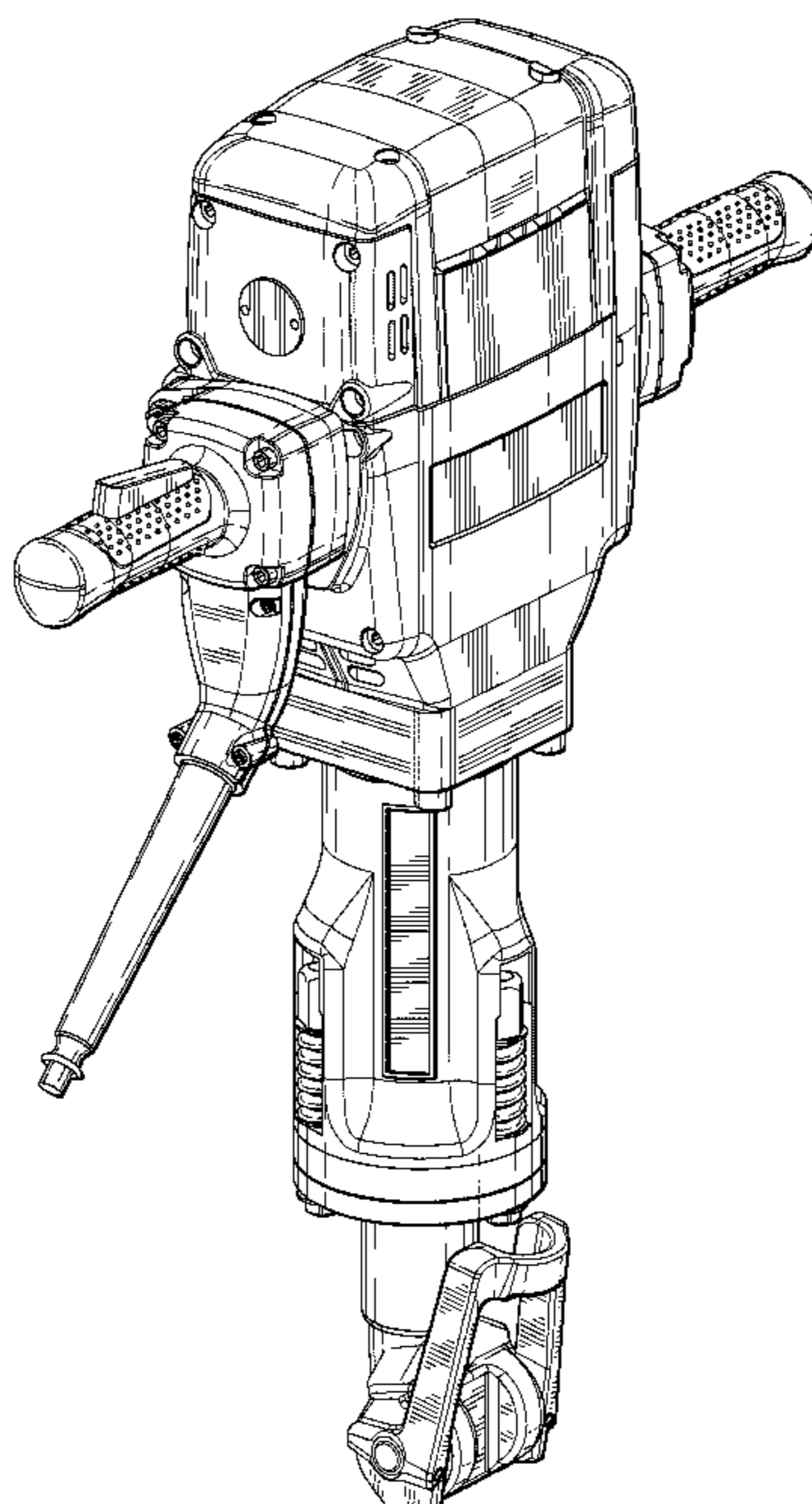

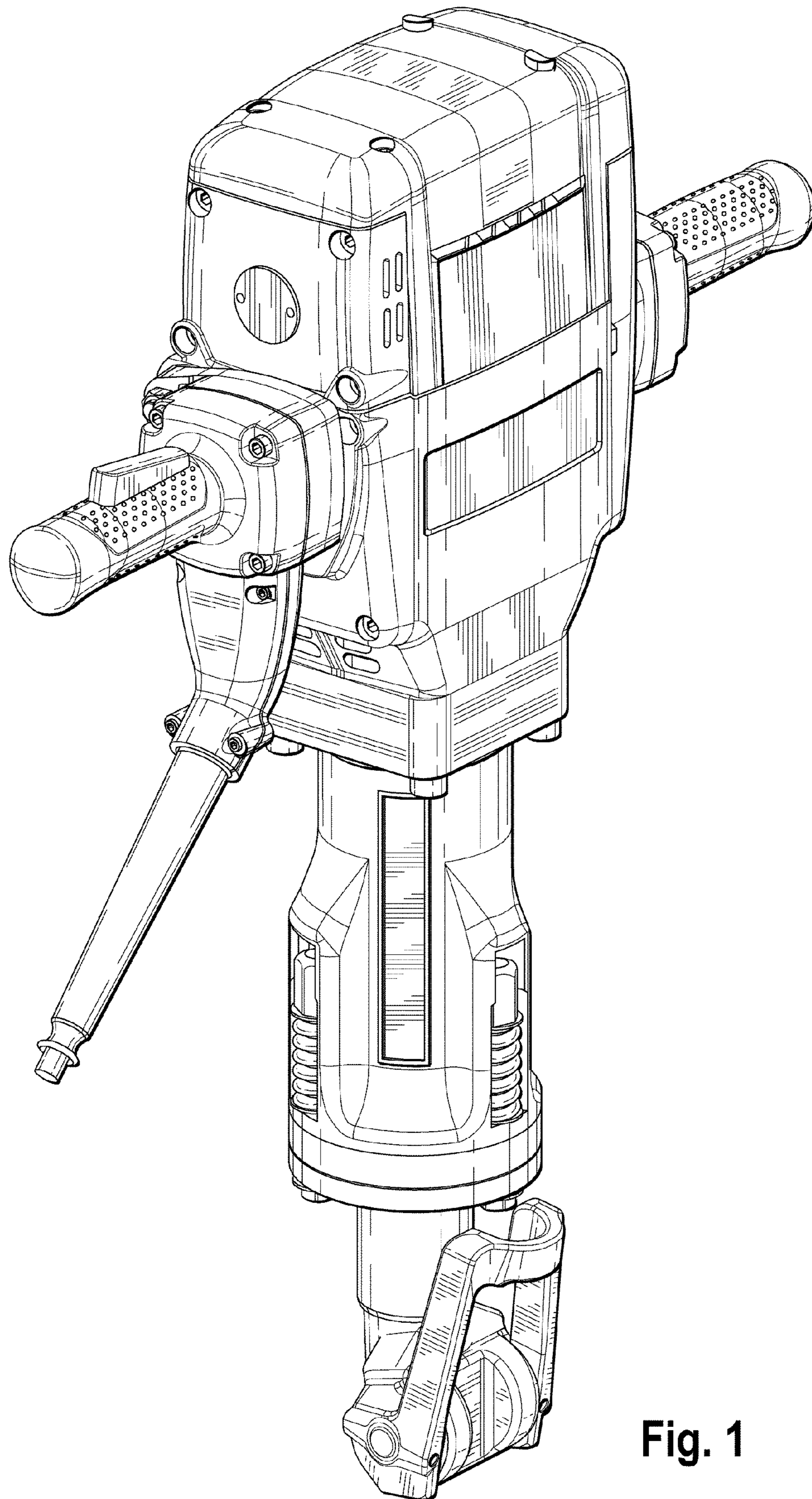

Fig. 1

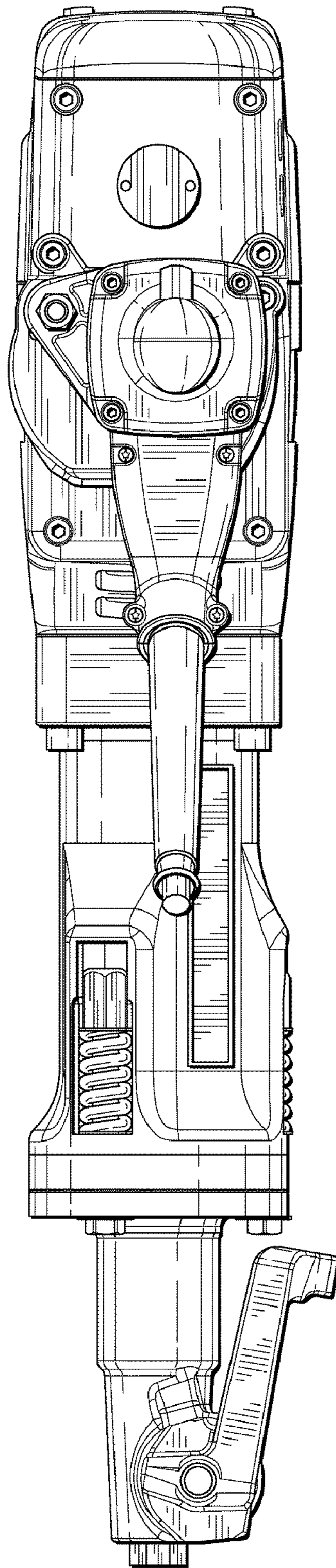

Fig. 2

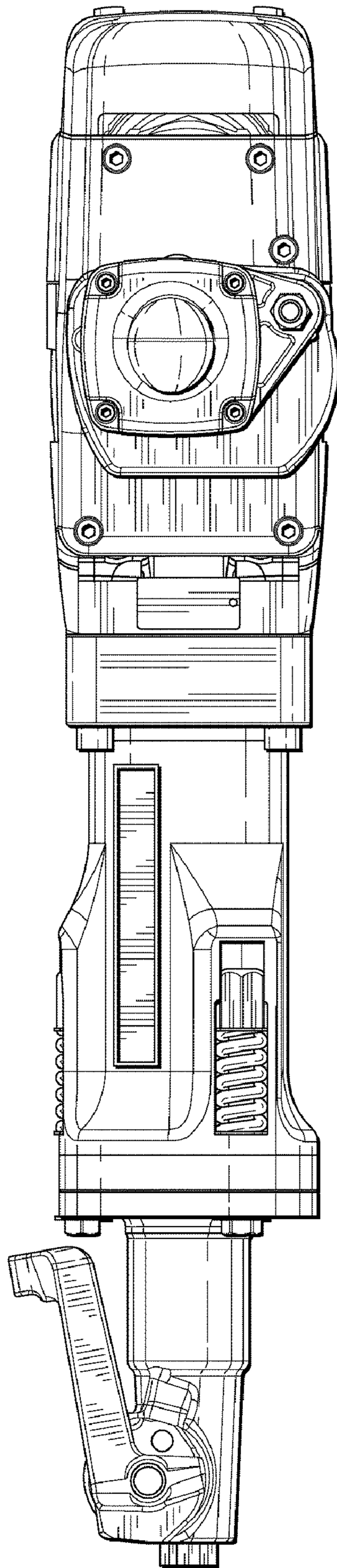

Fig. 3

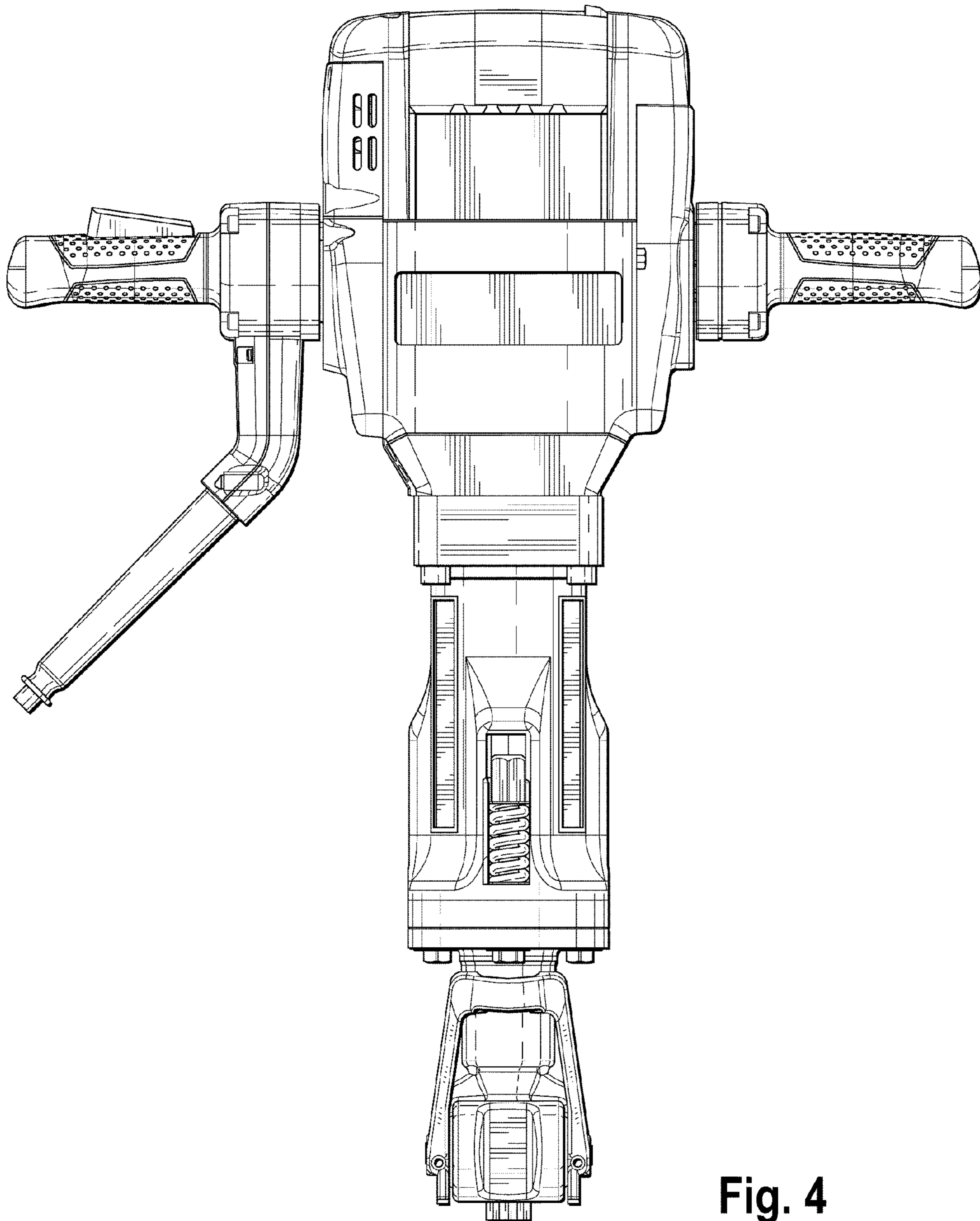

Fig. 4

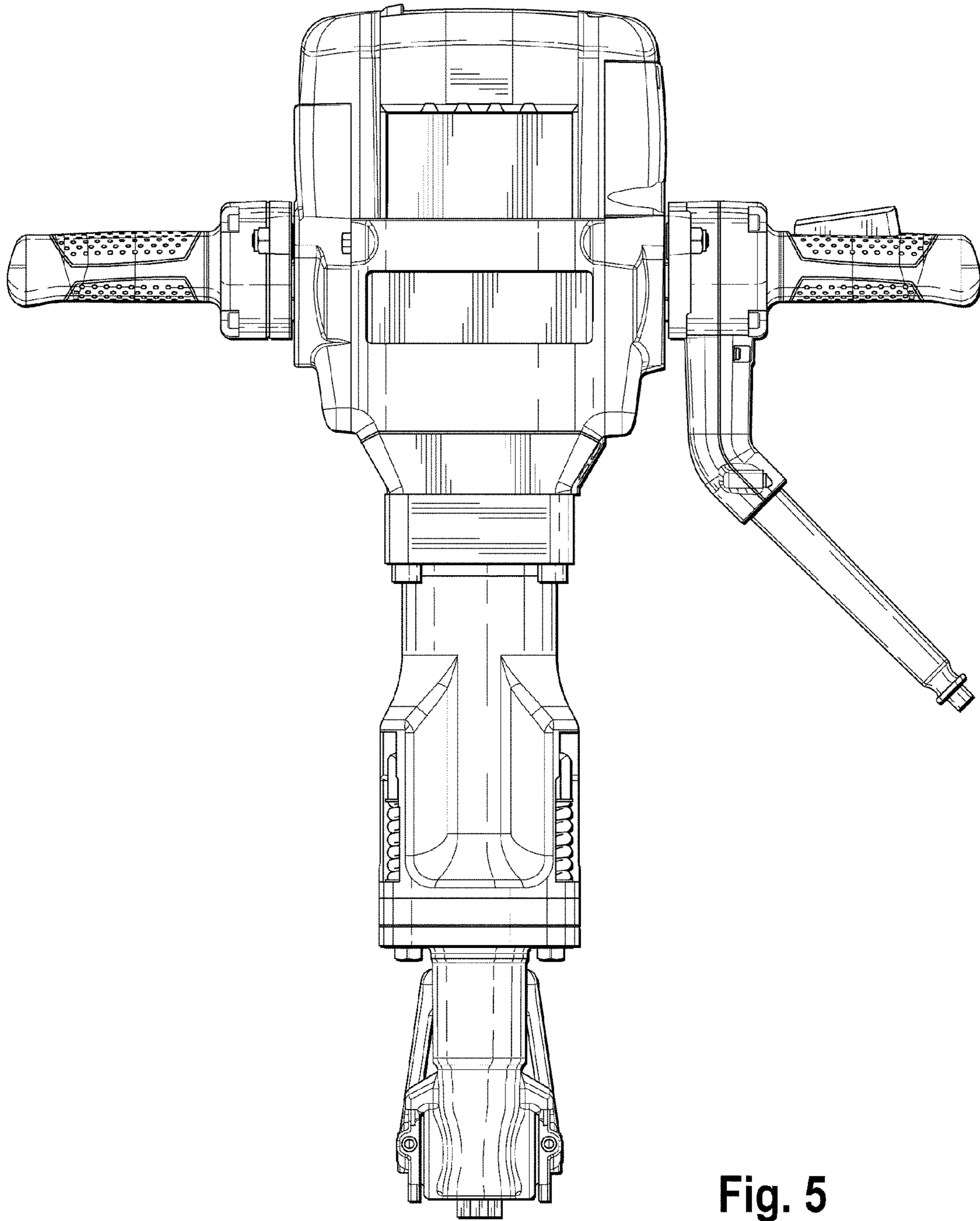

Fig. 5

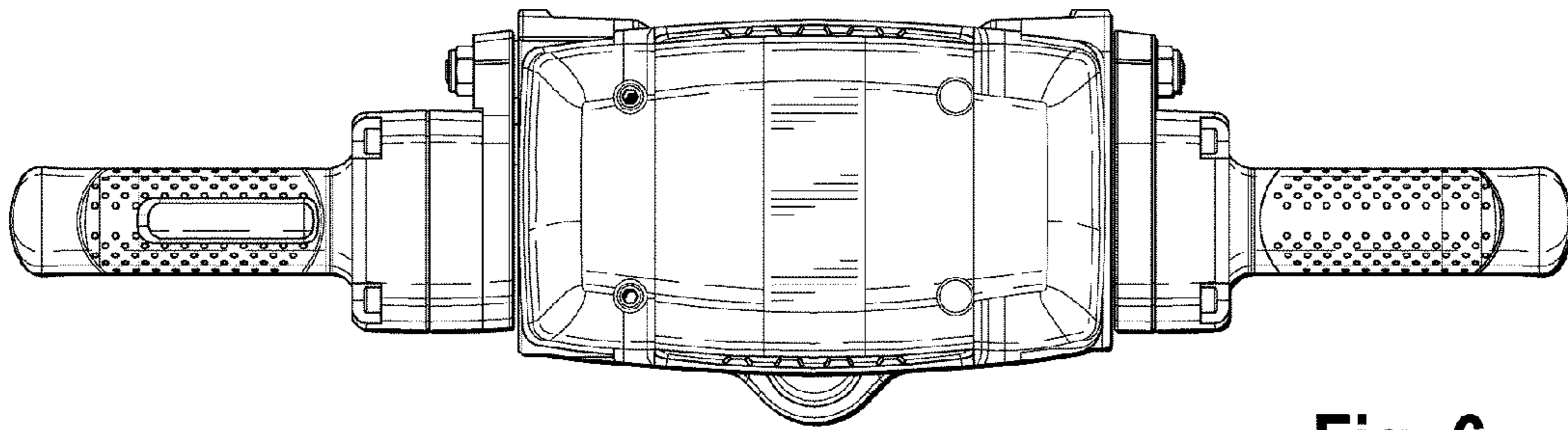

Fig. 6

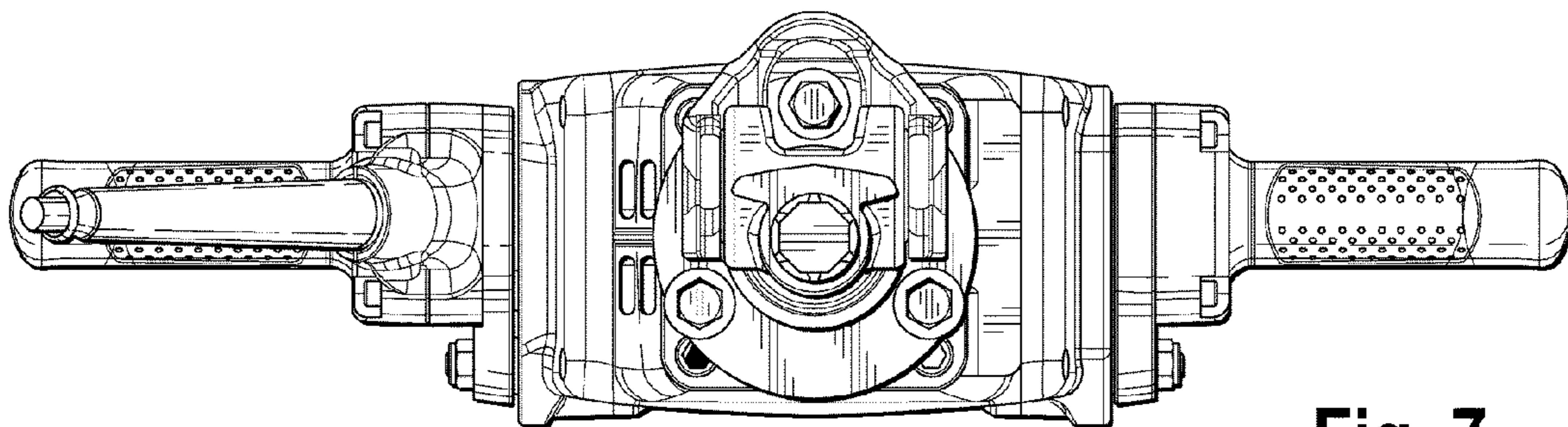

Fig. 7