

US00D603626S

(12) **United States Design Patent**
Weatherly

(10) **Patent No.:** **US D603,626 S**

(45) **Date of Patent:** **** Nov. 10, 2009**

(54) **DESK**

6,609,465 B2 * 8/2003 Kolavo 108/50.01
D521,770 S * 5/2006 Madison D6/425

(75) Inventor: **Matthew Weatherly**, Fairfax, VA (US)

* cited by examiner

(73) Assignee: **Becker Designed, Inc.**, Chantilly, VA (US)

Primary Examiner—Janice E Seeger

(74) *Attorney, Agent, or Firm*—Design IP

(**) Term: **14 Years**

(57) **CLAIM**

(21) Appl. No.: **29/326,600**

The ornamental design for a desk, as shown and described.

(22) Filed: **Oct. 21, 2008**

DESCRIPTION

(51) **LOC (9) Cl.** **06-03**

(52) **U.S. Cl.** **D6/483**

(58) **Field of Classification Search** D6/480–489,
D6/495–499, 429–431, 422; 108/153.1,
108/155, 156, 161, 50.01, 50.02; 248/188,
248/188.1, 188.8

FIG. 1 is a perspective view of a first embodiment of a desk showing my new design;

FIG. 2 is a front orthographic view thereof;

FIG. 3 is a top orthographic view thereof;

FIG. 4 is a left side orthographic view thereof; and,

FIG. 5 is a right side orthographic view thereof.

See application file for complete search history.

The broken lines shown in FIGS. 1 through 5 are included for the purpose of illustrating environmental elements only and form no part of the claimed design. The four feet located at the bottom of the desk form no part of the claimed design. The rear and bottom views are omitted and form no part of the claimed designs.

(56) **References Cited**

U.S. PATENT DOCUMENTS

D352,845 S * 11/1994 Hellwig et al. D6/422
5,447,099 A * 9/1995 Adams et al. 108/147
D366,781 S * 2/1996 Cartwright D6/422
D394,175 S * 5/1998 Olson D6/495
6,076,473 A * 6/2000 Conte 108/50.01

1 Claim, 4 Drawing Sheets

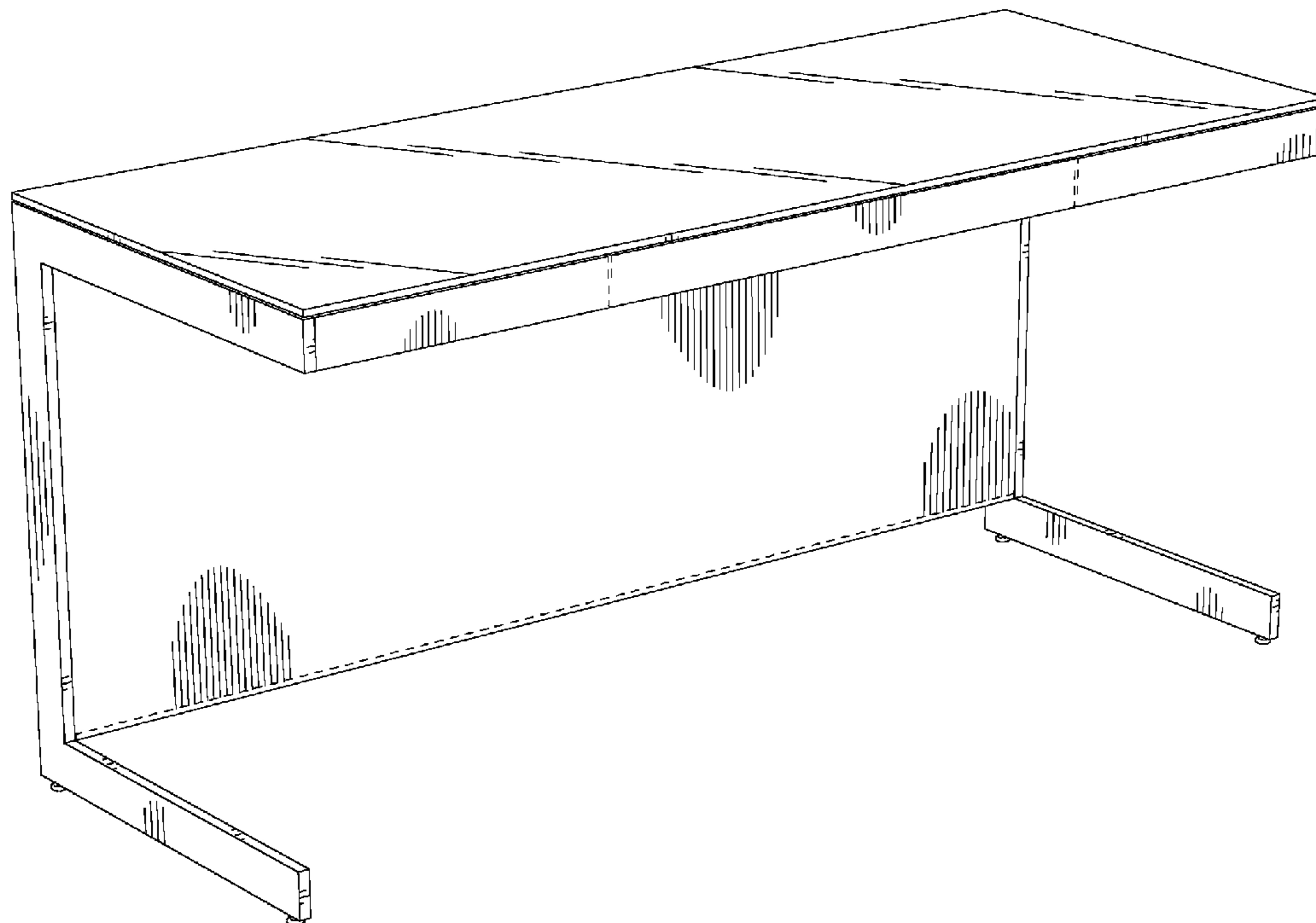

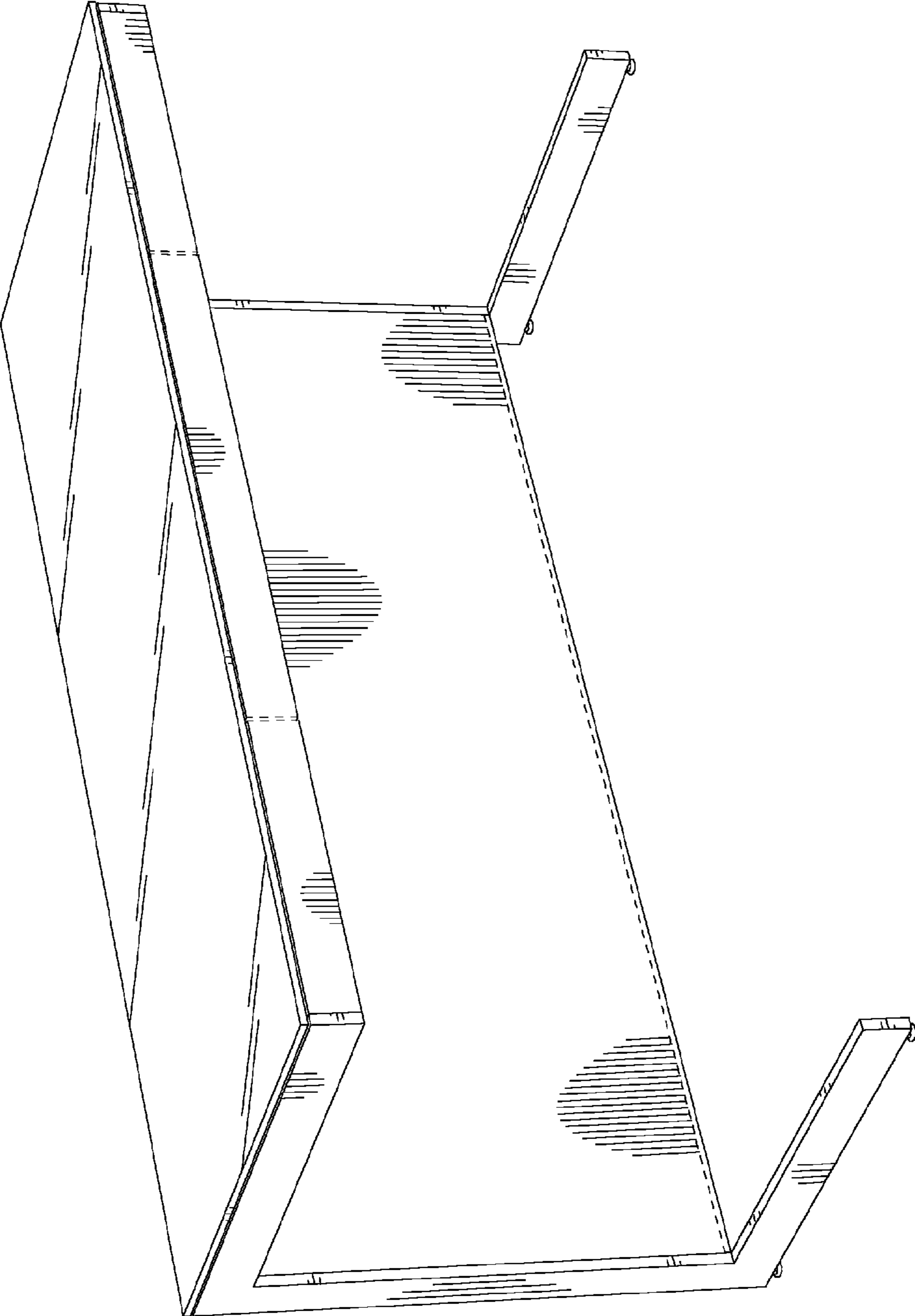

Fig. 1

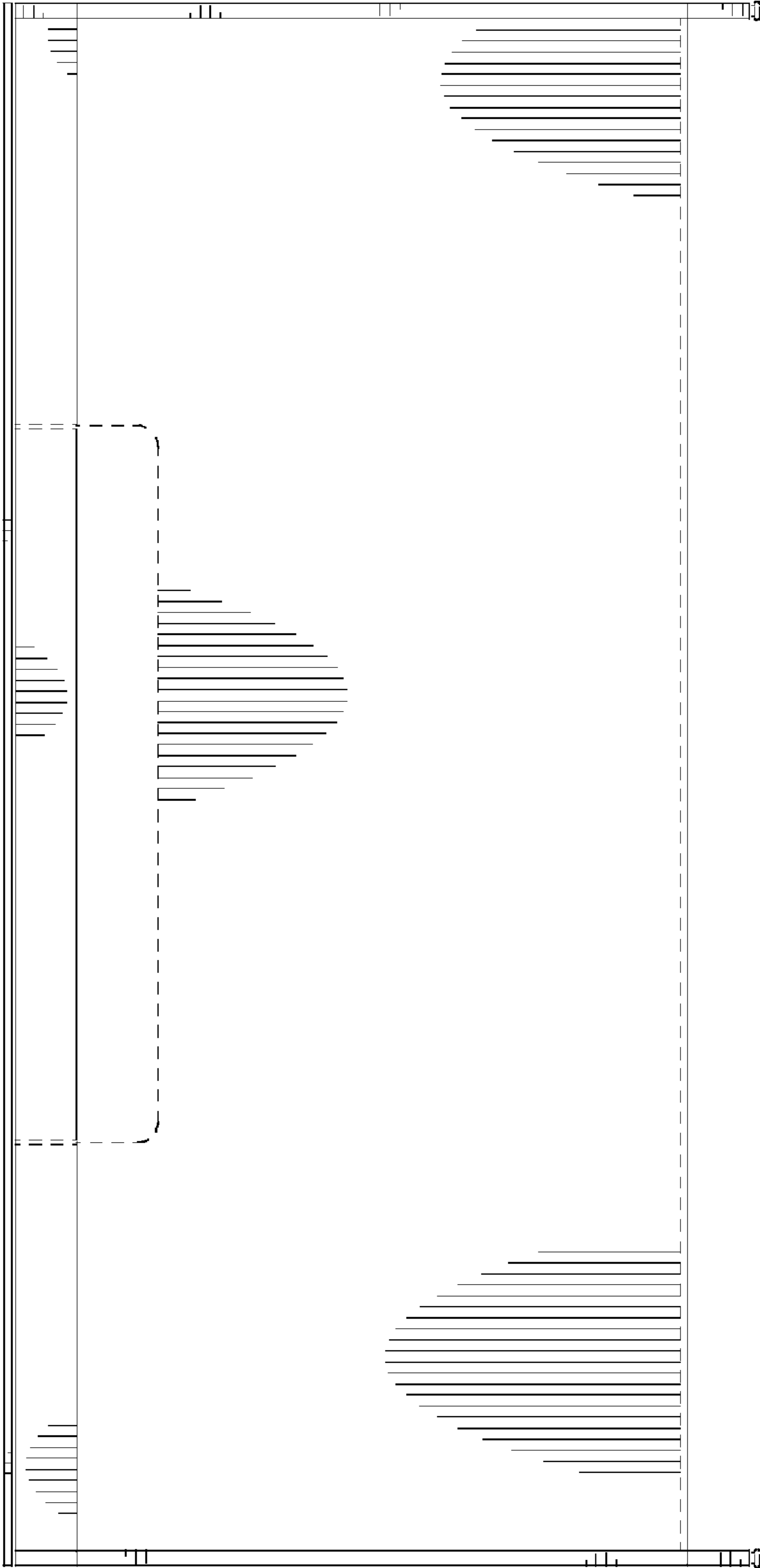

Fig. 2

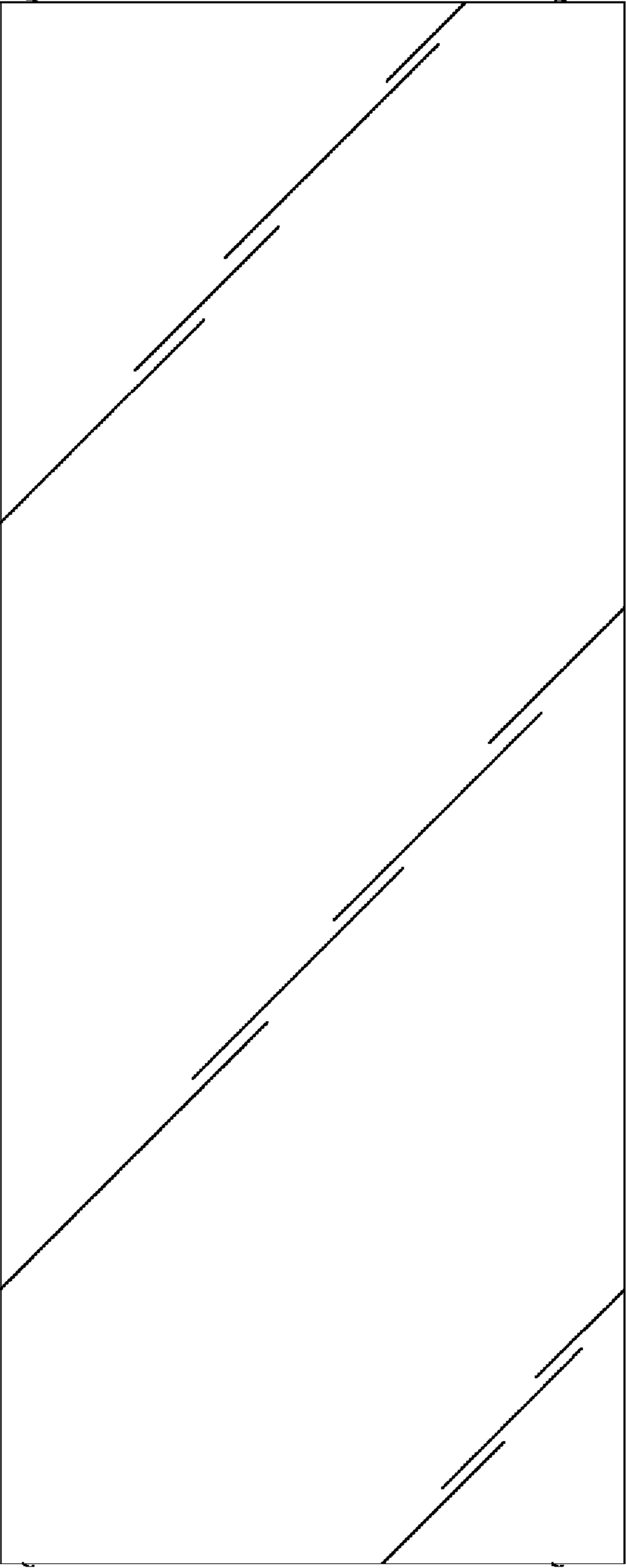

Fig. 3

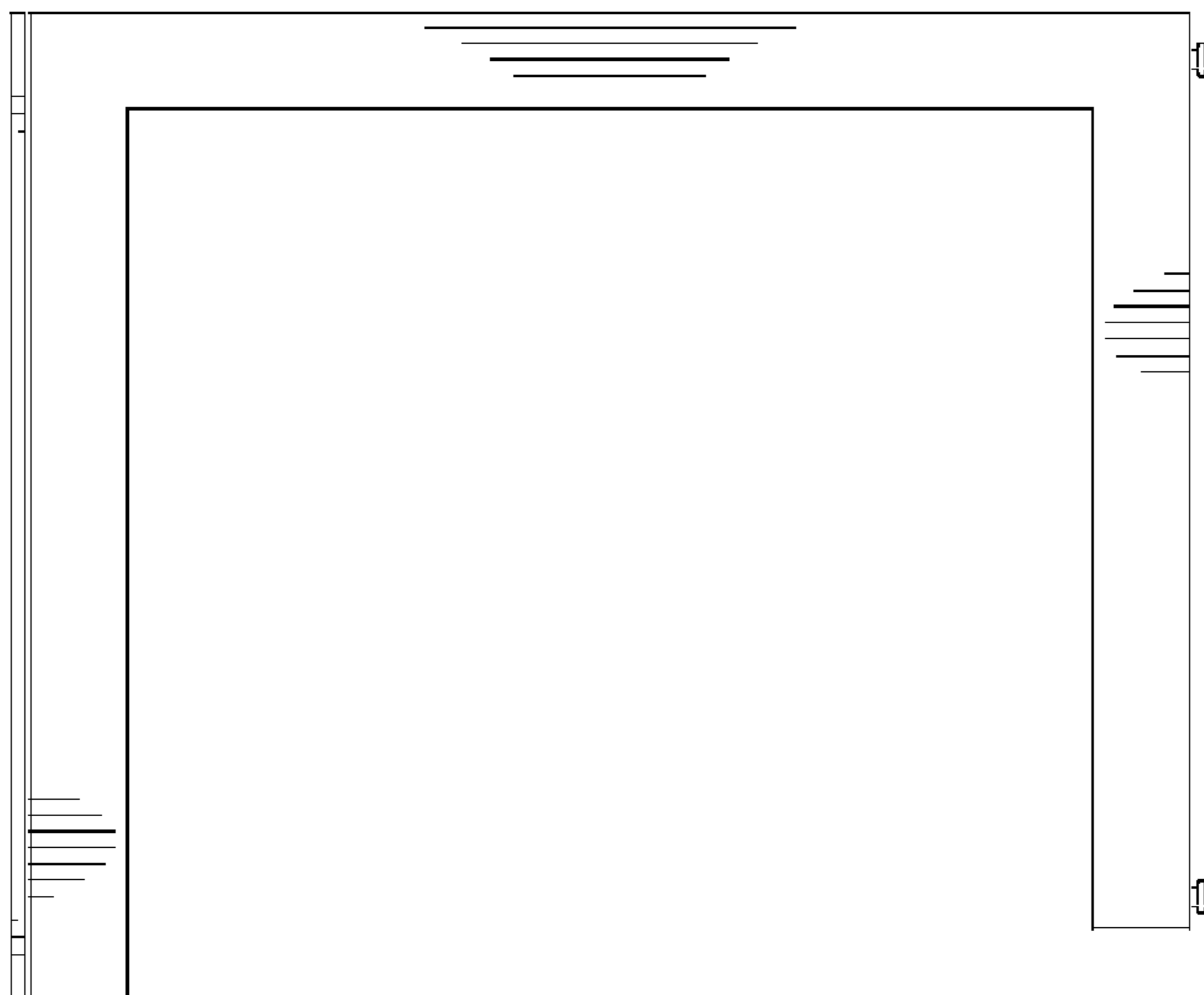

Fig. 5

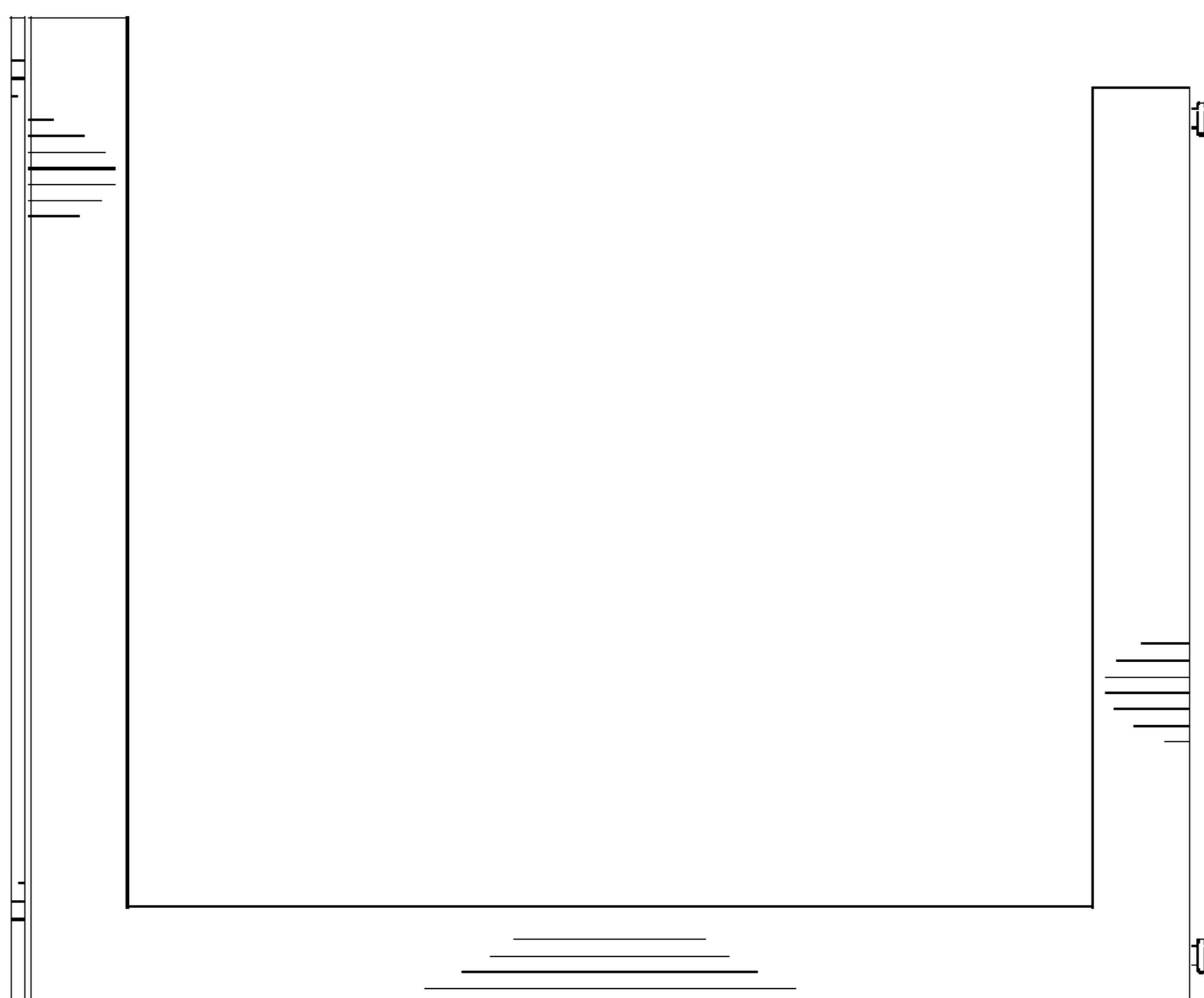

Fig. 4