



(12) **United States Design Patent**  
**Greene**

(10) **Patent No.:** **US D603,096 S**  
(45) **Date of Patent:** **\*\* Oct. 27, 2009**

(54) **FOLDING SHAVER**

(75) Inventor: **Todd M. Greene**, Los Angeles, CA (US)

(73) Assignee: **HeadBlade, Inc.**, Culver City, CA (US)

(\*\*) Term: **14 Years**

(21) Appl. No.: **29/330,840**

(22) Filed: **Jan. 14, 2009**

(51) **LOC (9) Cl.** ..... **28-03**

(52) **U.S. Cl.** ..... **D28/46**

(58) **Field of Classification Search** ..... 30/32,  
30/34.05, 34.1, 34.2, 41-41.8, 44-45, 47-51,  
30/53-58, 526-533, 537; D28/44.1-48

See application file for complete search history.

(56) **References Cited**

**U.S. PATENT DOCUMENTS**

5,784,785	A *	7/1998	Polites	.....	30/53
6,266,888	B1 *	7/2001	Zowaski	.....	30/527
7,093,363	B1 *	8/2006	Kuo	.....	30/47
D560,032	S *	1/2008	Lopez	.....	D28/48
2003/0177648	A1 *	9/2003	Zeiter	.....	30/526
2004/0107585	A1 *	6/2004	Helmrich	.....	30/537

\* cited by examiner

*Primary Examiner*—Jennifer Rivard

(74) *Attorney, Agent, or Firm*—Joseph G. Swan, P.C.

(57) **CLAIM**

The ornamental design for a folding shaver, as shown and described.

**DESCRIPTION**

FIG. 1 is a top left perspective view of a fully opened folding shaver according to the present invention.

FIG. 2 is a top plan view of the fully opened folding shaver.

FIG. 3 is a bottom plan view of the fully opened folding shaver.

FIG. 4 is a left side elevational view of the fully opened folding shaver.

FIG. 5 is a right side elevational view of the fully opened folding shaver.

FIG. 6 is a front elevational view of the fully opened folding shaver.

FIG. 7 is a rear elevational view of the fully opened folding shaver.

FIG. 8 is a bottom left perspective view of the folding shaver in its folded or closed configuration; and,

FIG. 9 is a left side elevational view of the folding shaver in its folded or closed configuration.

The portions shown in broken lines are solely for the purpose of illustrating context and form no part of the claimed design.

**1 Claim, 5 Drawing Sheets**

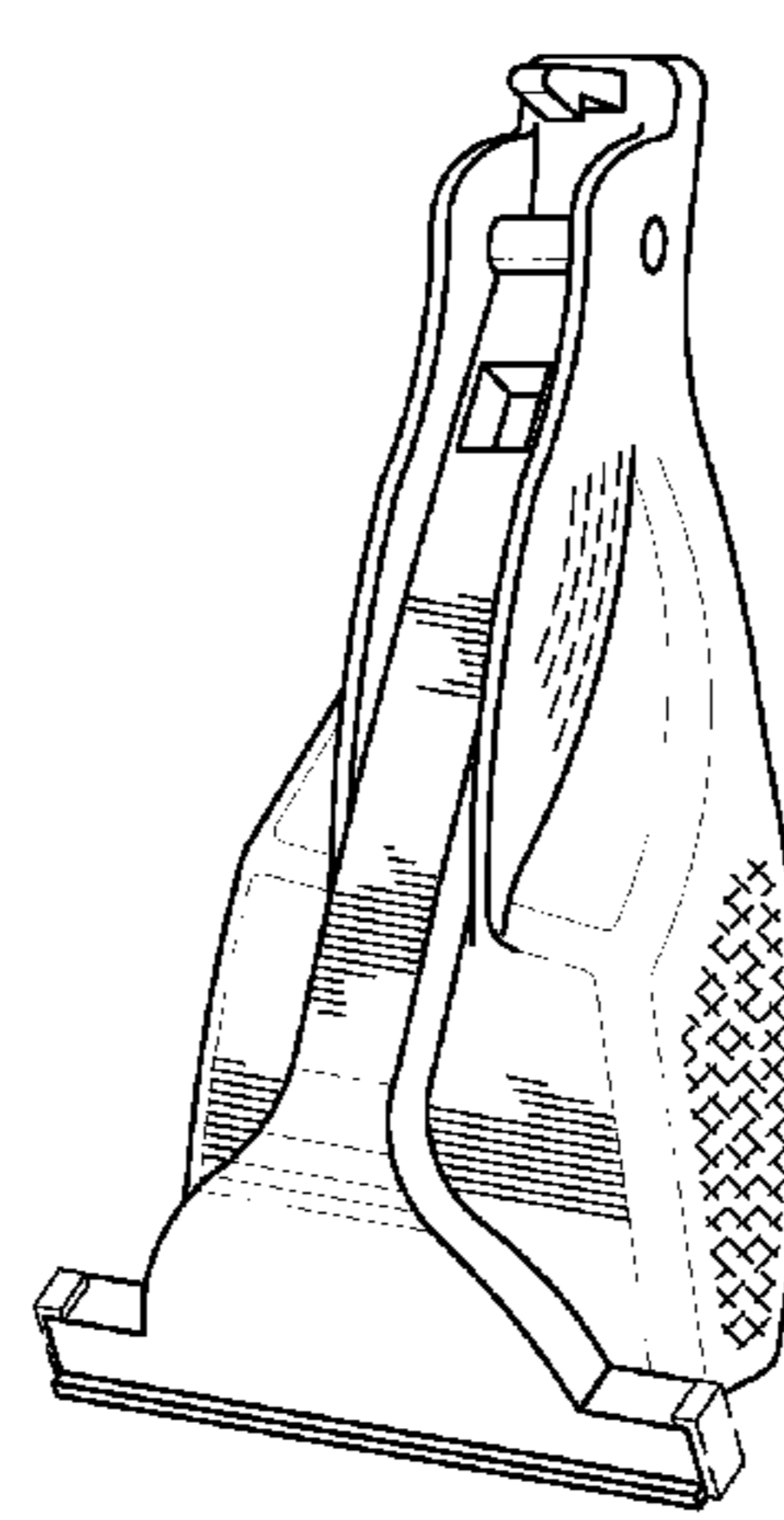
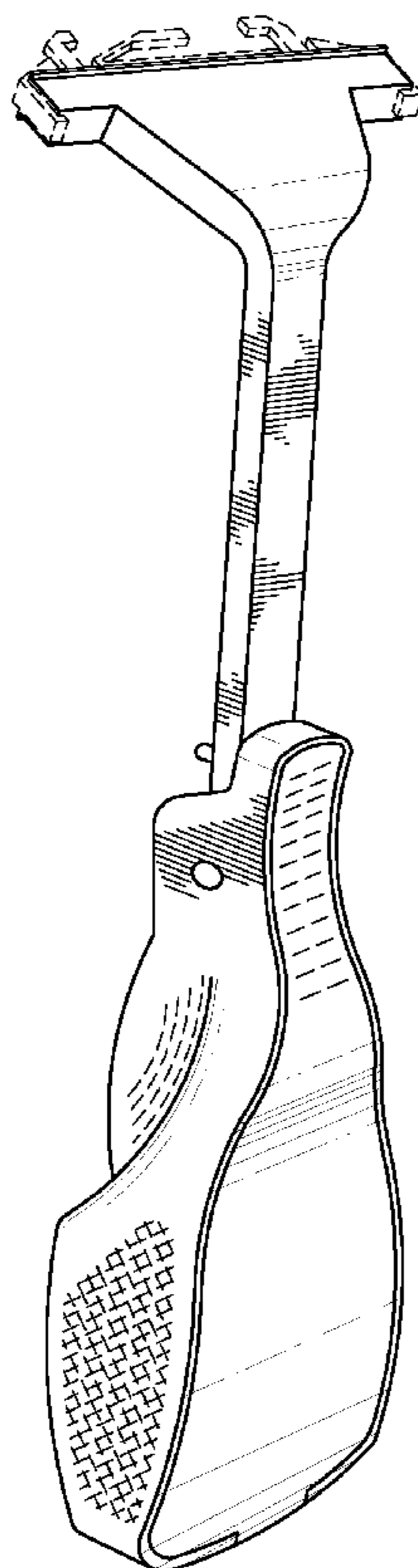

*FIG. 1*

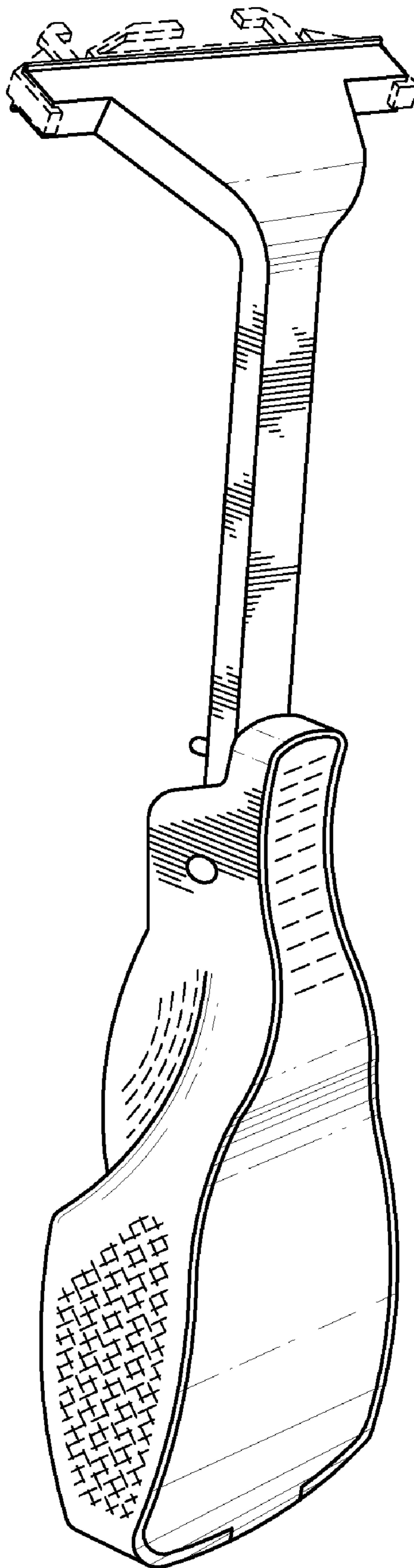

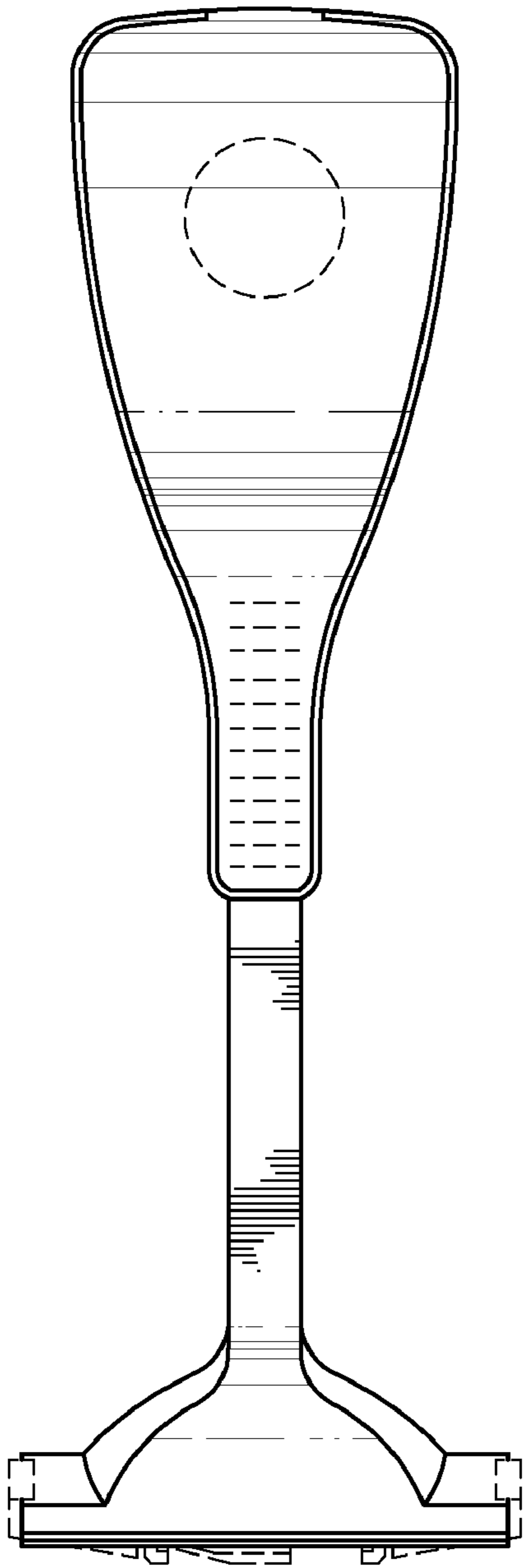

FIG. 2

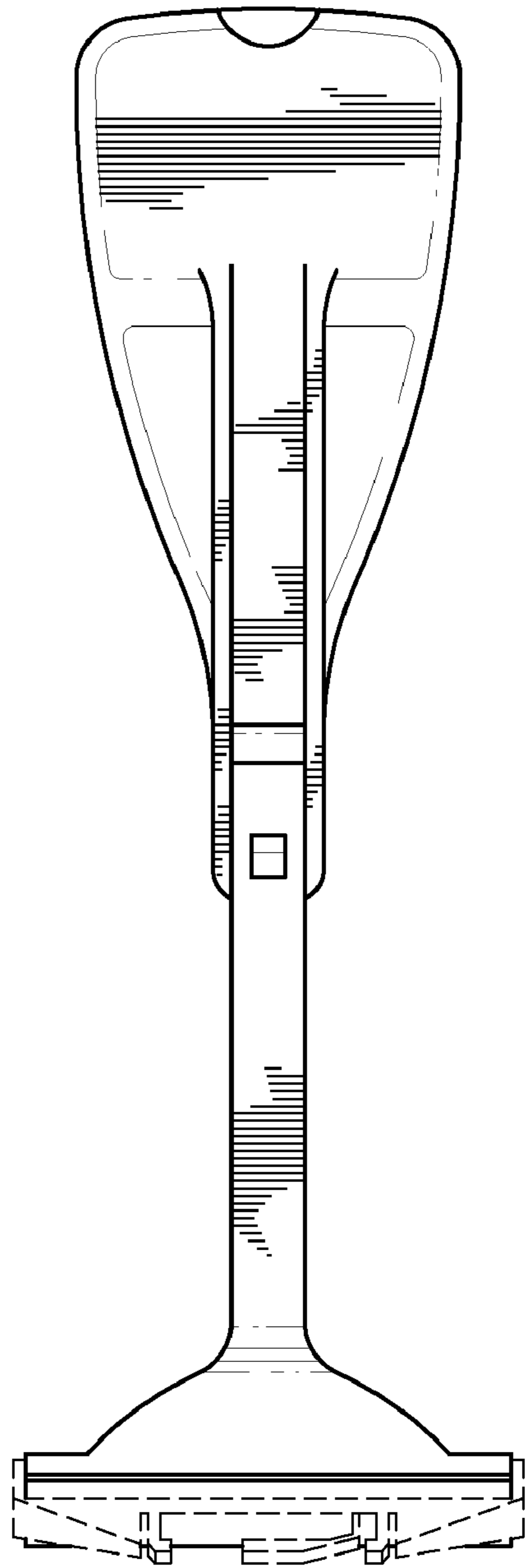

FIG. 3

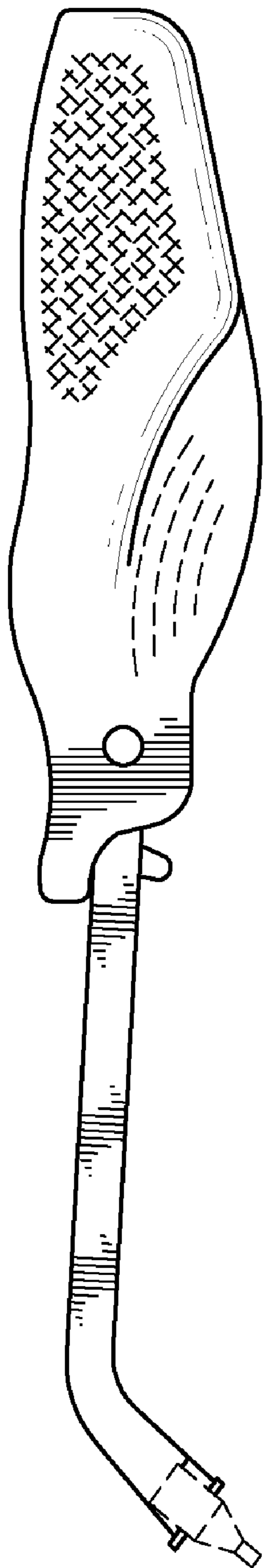

FIG. 4

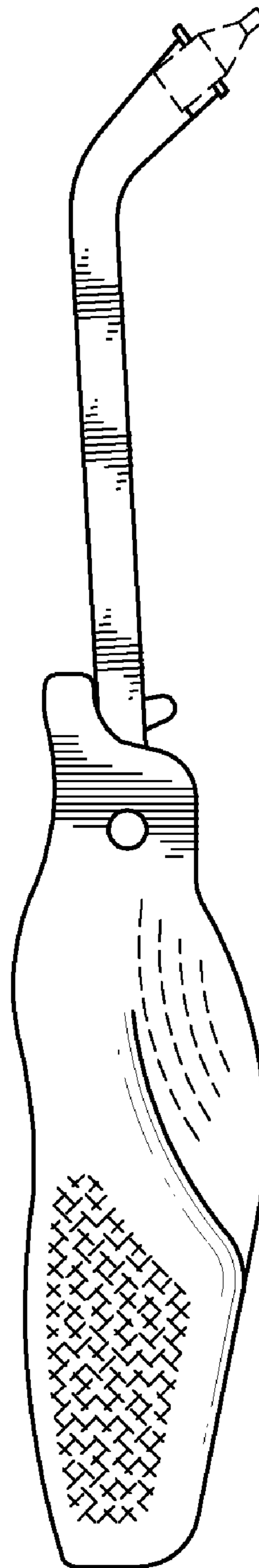
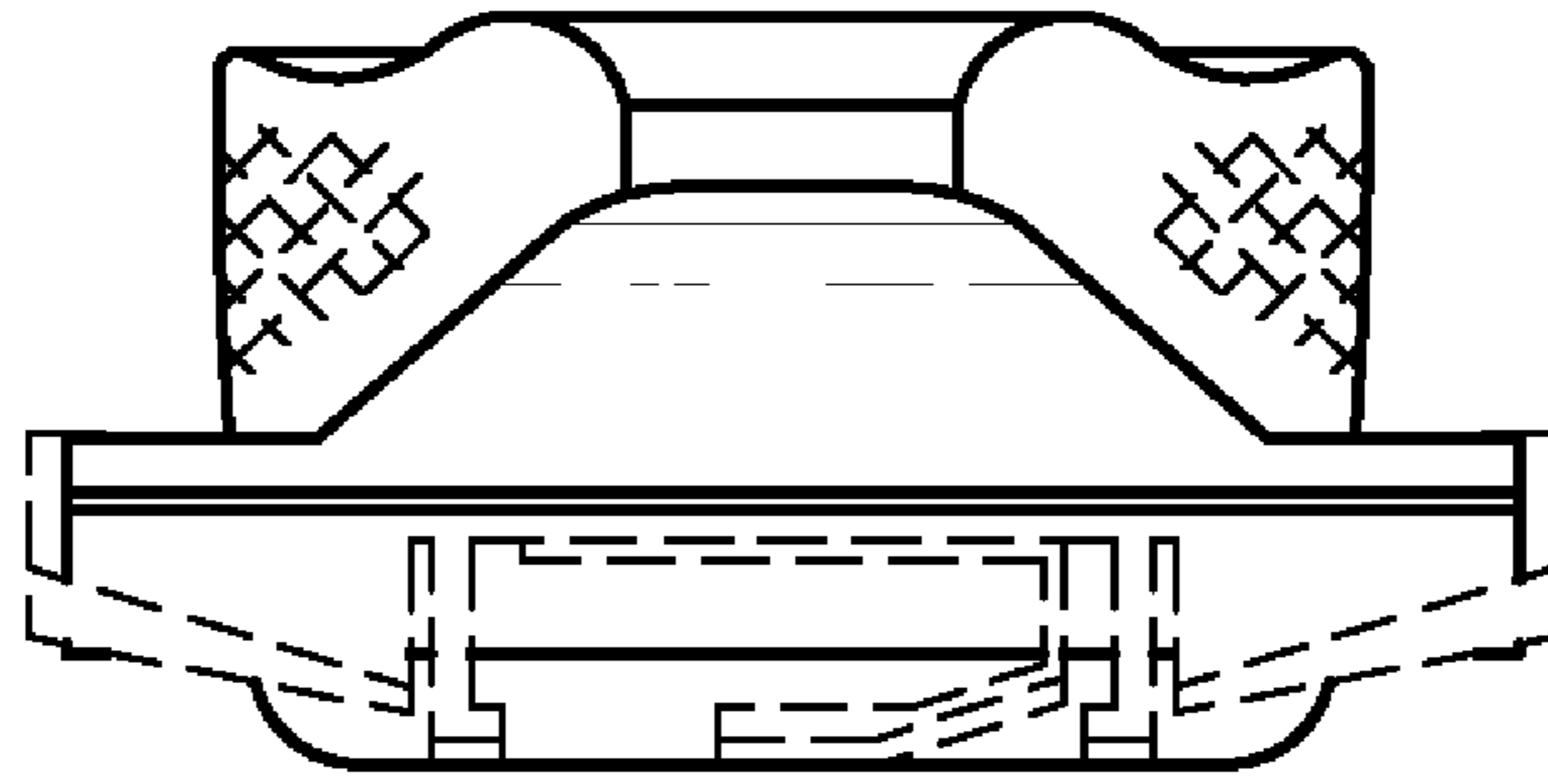
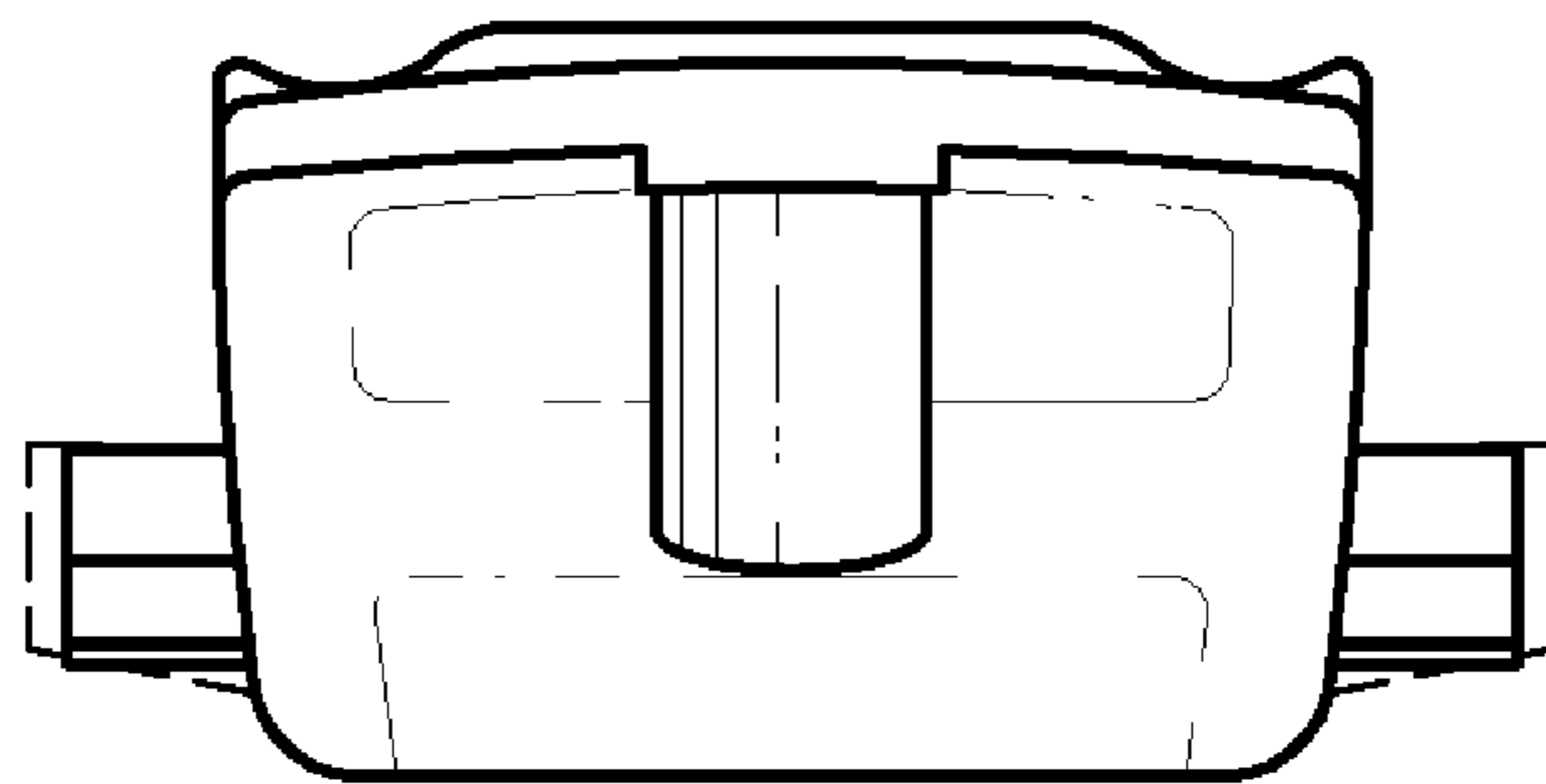

FIG. 5



*FIG. 6*



*FIG. 7*

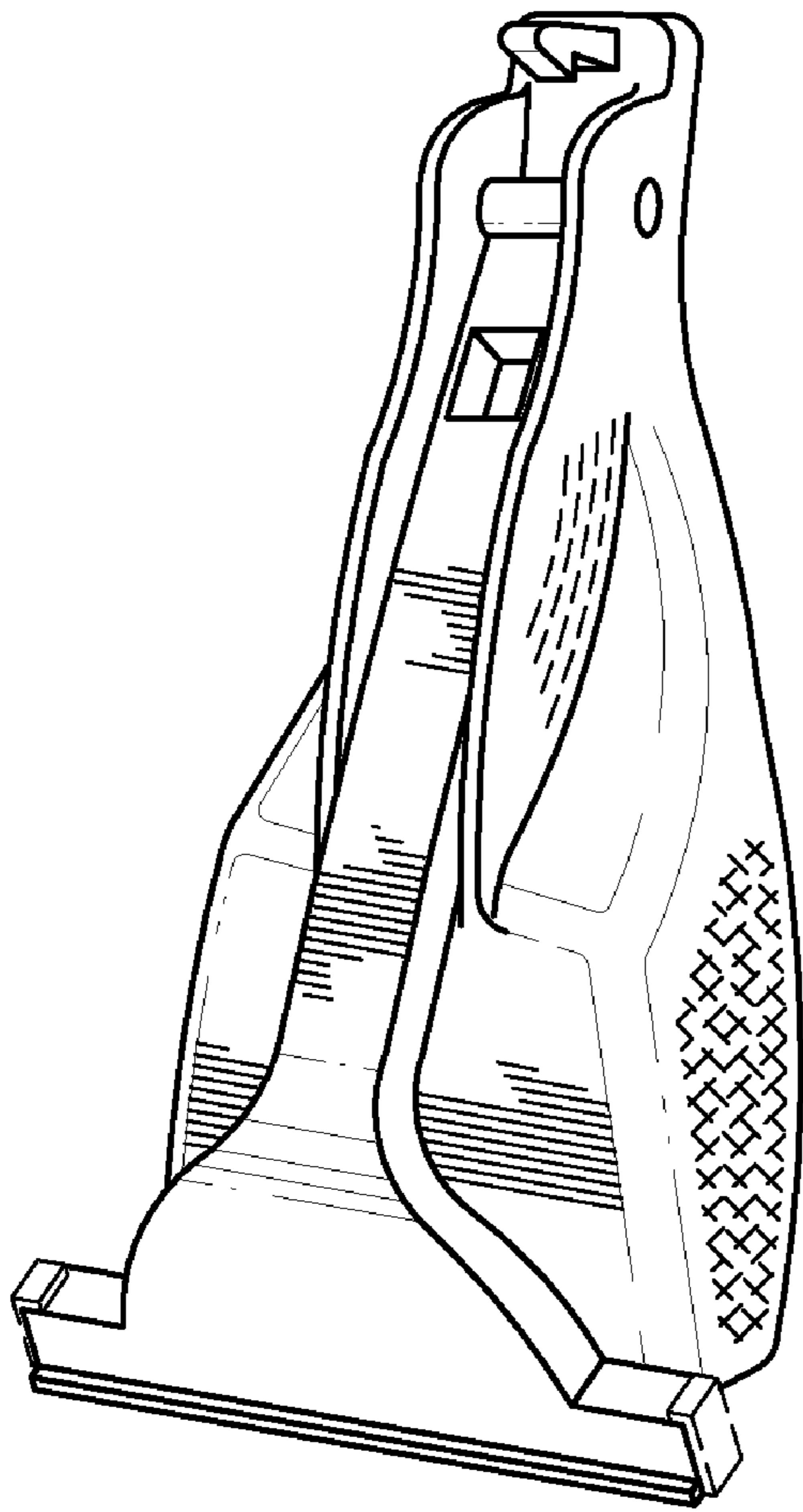

*FIG. 8*

*FIG. 9*

