

US00D602316S

(12) **United States Design Patent**  
**Cerretto**

(10) **Patent No.:** **US D602,316 S**

(45) **Date of Patent:** **\*\* Oct. 20, 2009**

(54) **ENGINE UNIT OF A BRUSHCUTTER**

(75) Inventor: **Nicola Cerretto**, Bagnolo in Piano (IT)

(73) Assignee: **Emak S.p.A.**, Reggio Emilia (IT)

(\*\*) Term: **14 Years**

(21) Appl. No.: **29/323,742**

(22) Filed: **Aug. 29, 2008**

(30) **Foreign Application Priority Data**

Jul. 16, 2008 (EM) ..... 000971023-0001

(51) **LOC (9) Cl.** ..... **08-01**

(52) **U.S. Cl.** ..... **D8/8**

(58) **Field of Classification Search** ..... D8/8,  
D8/9; D15/1, 17; 30/276, 208-210; 56/12.7,  
56/233-234

See application file for complete search history.

(56) **References Cited**

**U.S. PATENT DOCUMENTS**

- D342,875 S \* 1/1994 Franke et al. .... D8/8
- D355,198 S \* 2/1995 Kikuchi ..... D15/1
- D355,572 S \* 2/1995 Griffin ..... D8/8
- D361,336 S \* 8/1995 Tinius ..... D15/1
- D361,702 S \* 8/1995 Kidwell et al. .... D8/8
- D375,963 S \* 11/1996 Braun et al. .... D15/17

- D474,947 S \* 5/2003 Holmdahl et al. .... D8/8
- D478,793 S \* 8/2003 Holmdahl et al. .... D8/8
- D548,029 S \* 8/2007 Evans et al. .... D8/8
- D560,983 S \* 2/2008 Tinius ..... D8/8
- 7,541,700 B2 \* 6/2009 Cobb, Jr. .... 310/50

\* cited by examiner

*Primary Examiner*—Holly H Baynham

*Assistant Examiner*—Sheryl Lane

(74) *Attorney, Agent, or Firm*—Occhiuti Rohlicek & Tsao LLP

(57) **CLAIM**

The ornamental design for an engine unit of a brushcutter, as shown.

**DESCRIPTION**

FIG. 1 is a front view of the design for an engine unit of a brushcutter.

FIG. 2 is a rear view thereof.

FIG. 3 is a right view thereof.

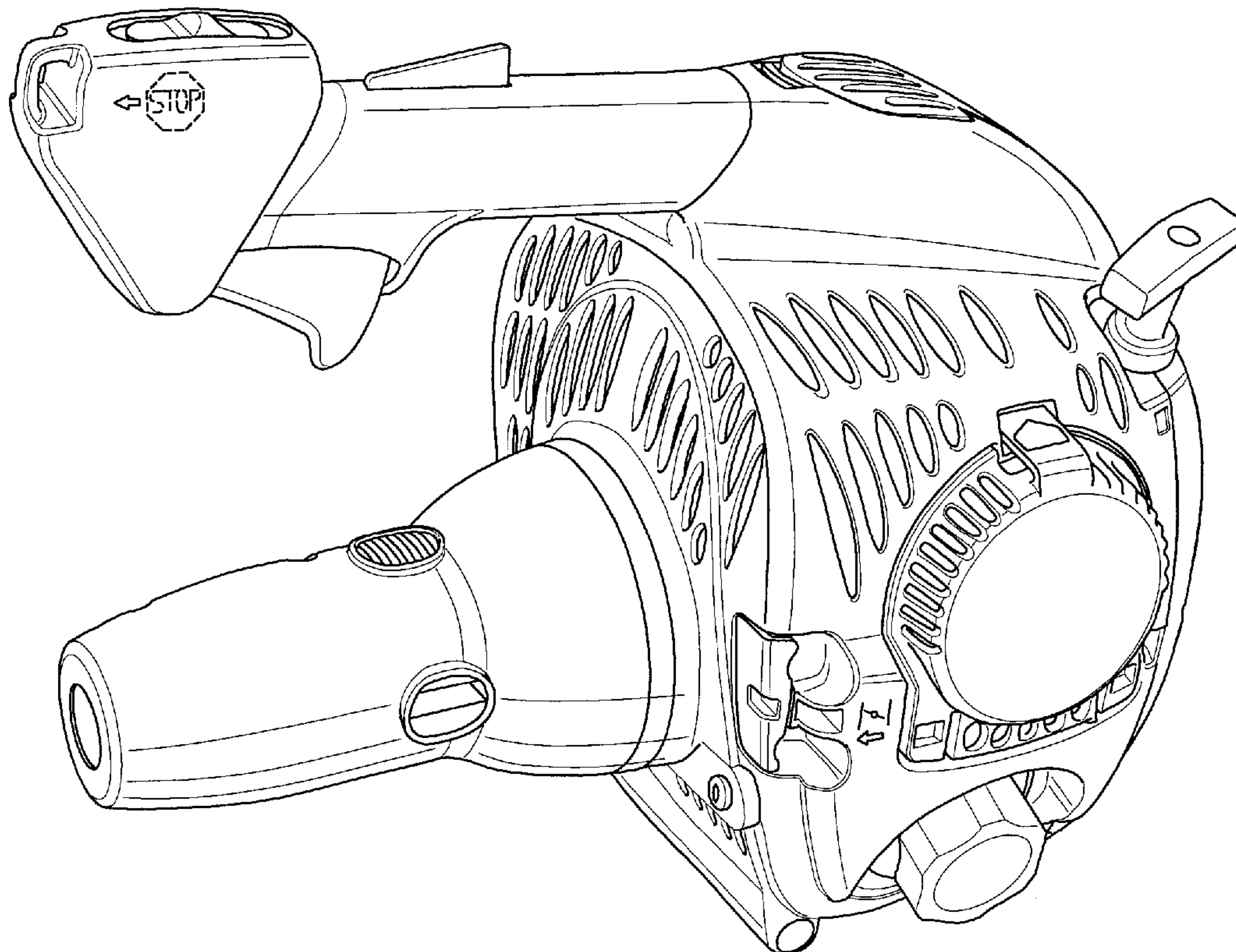
FIG. 4 is a left view thereof.

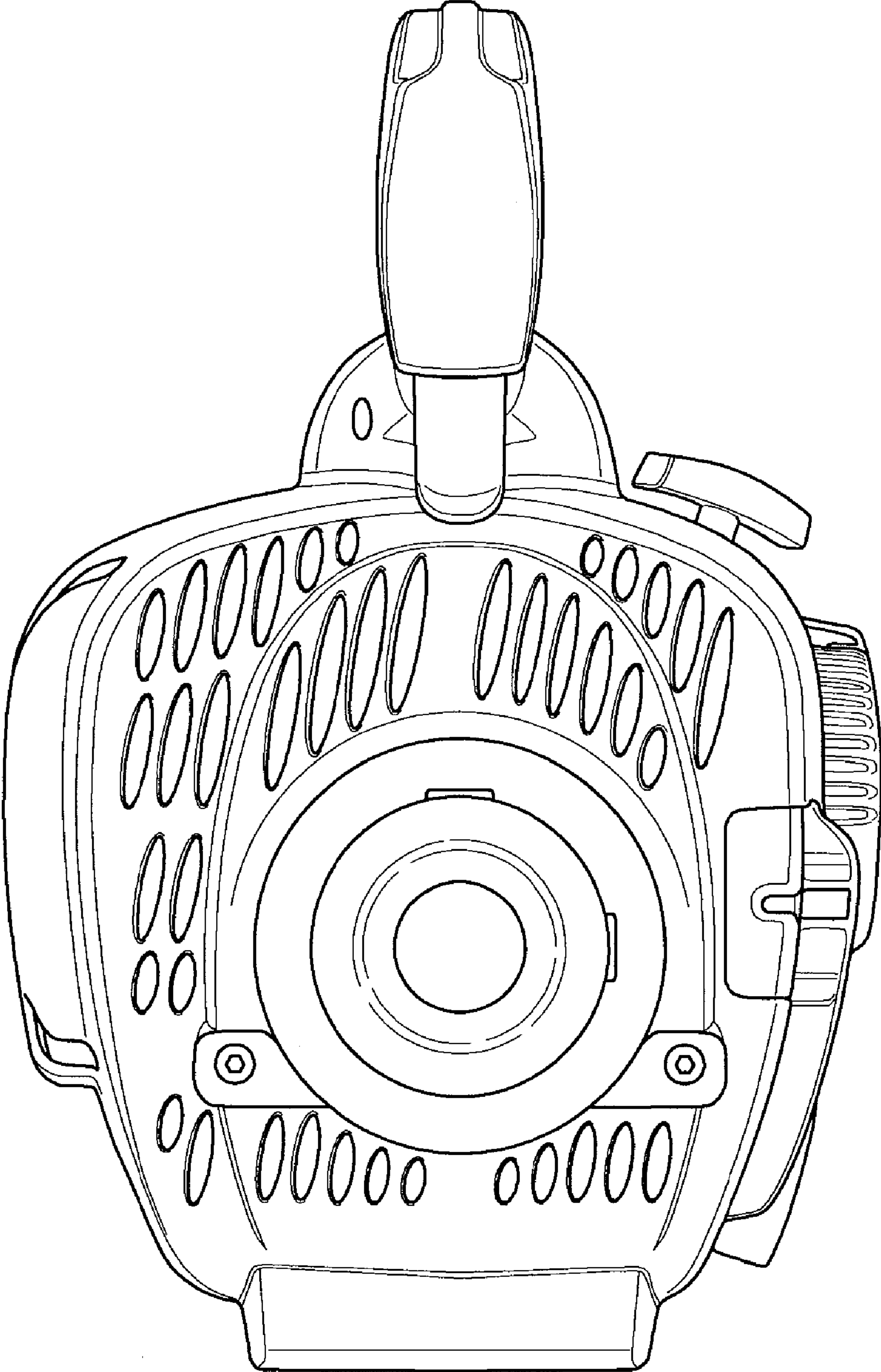
FIG. 5 is a top view thereof.

FIG. 6 is a bottom view thereof; and,

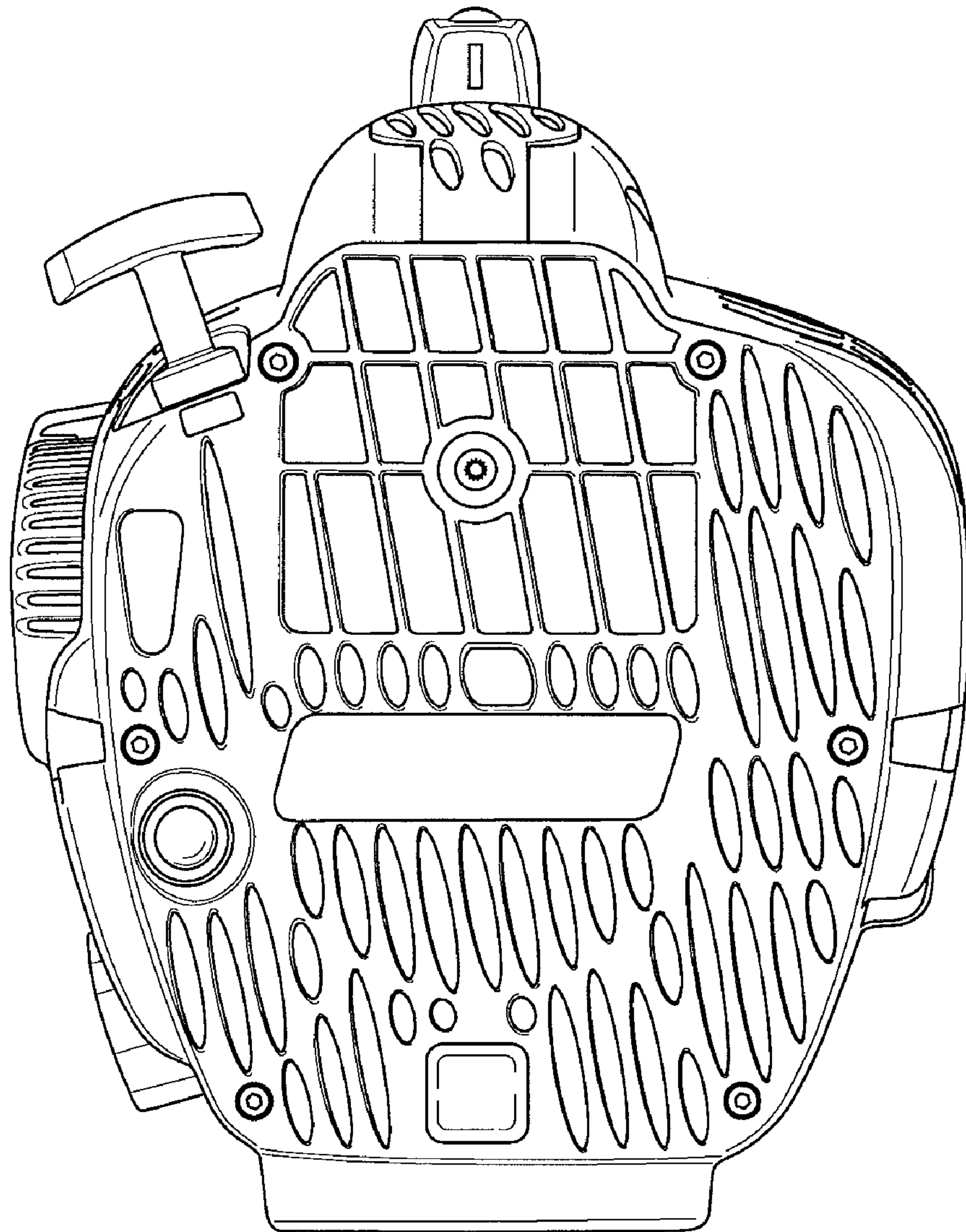
FIG. 7 is a perspective view thereof.

**1 Claim, 7 Drawing Sheets**



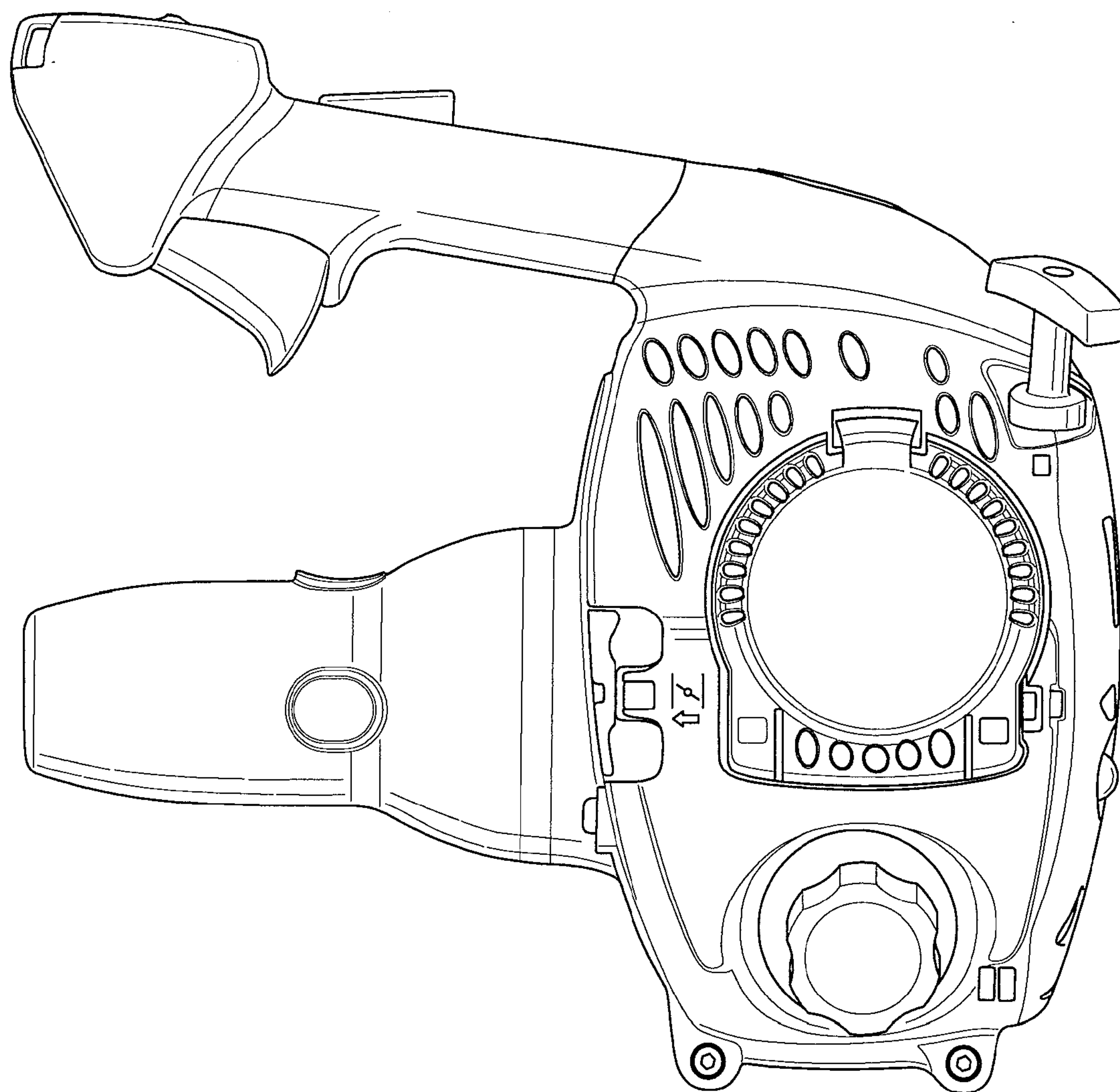


**FIG. 1**

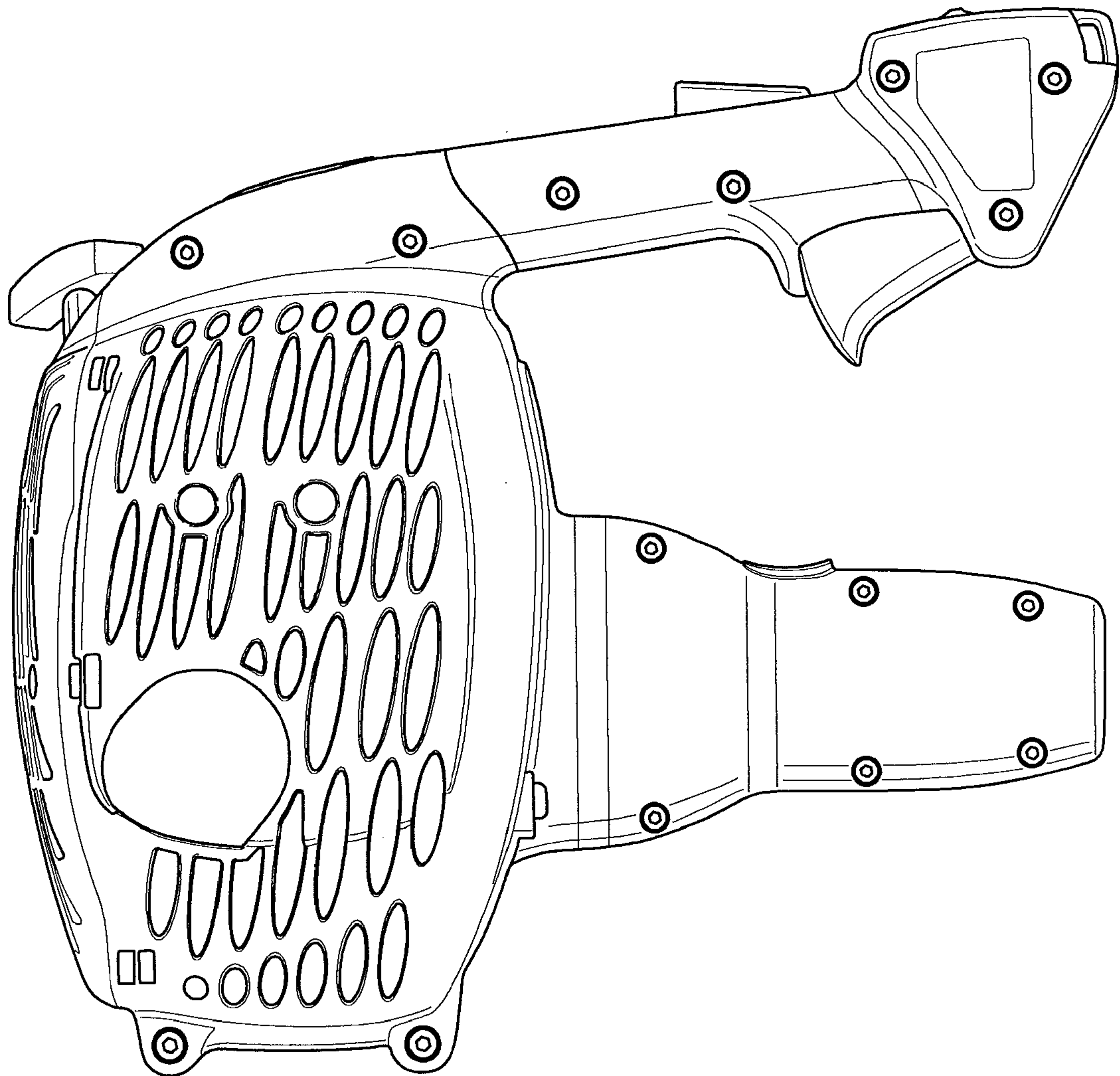


**FIG. 2**

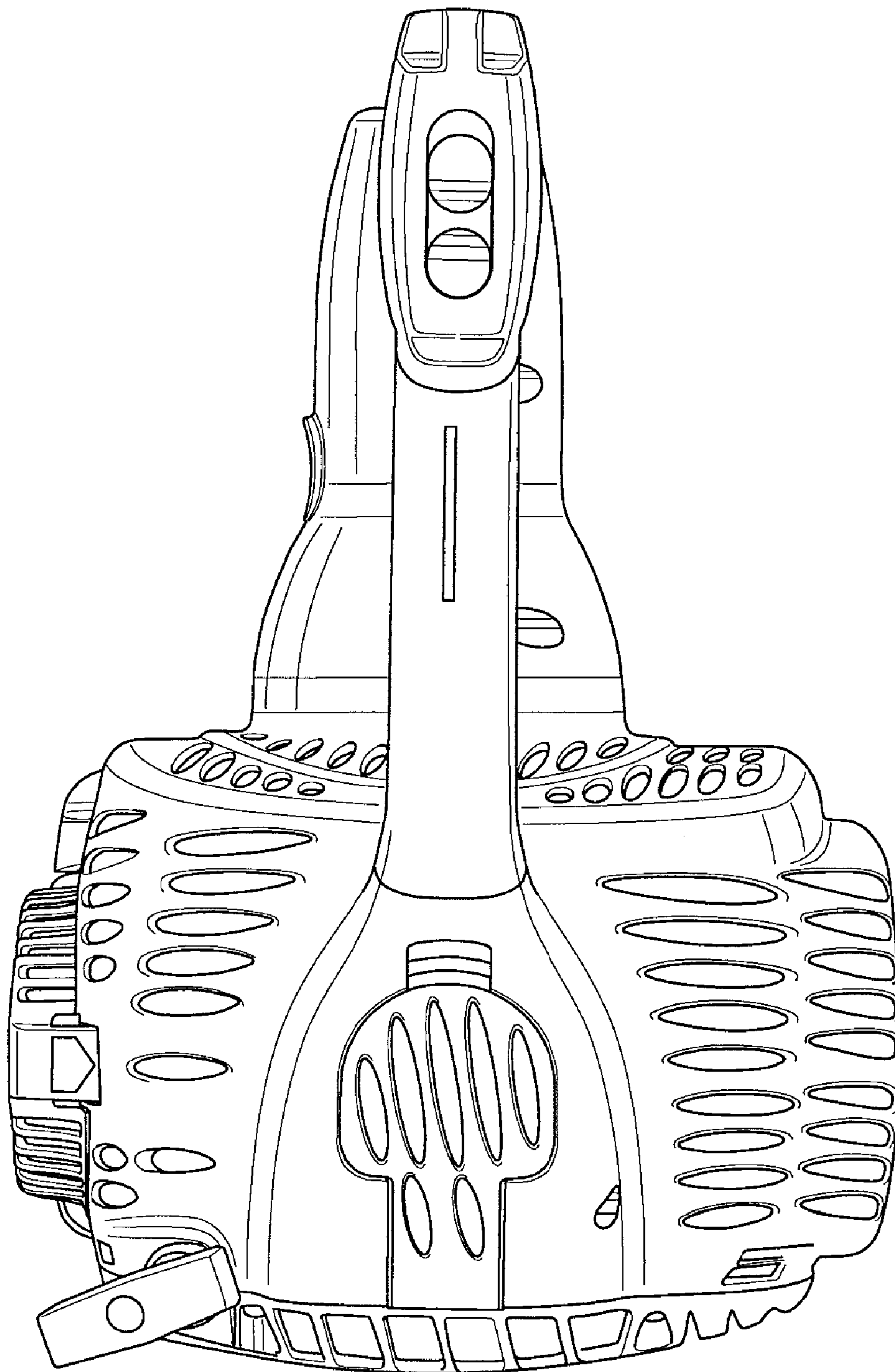




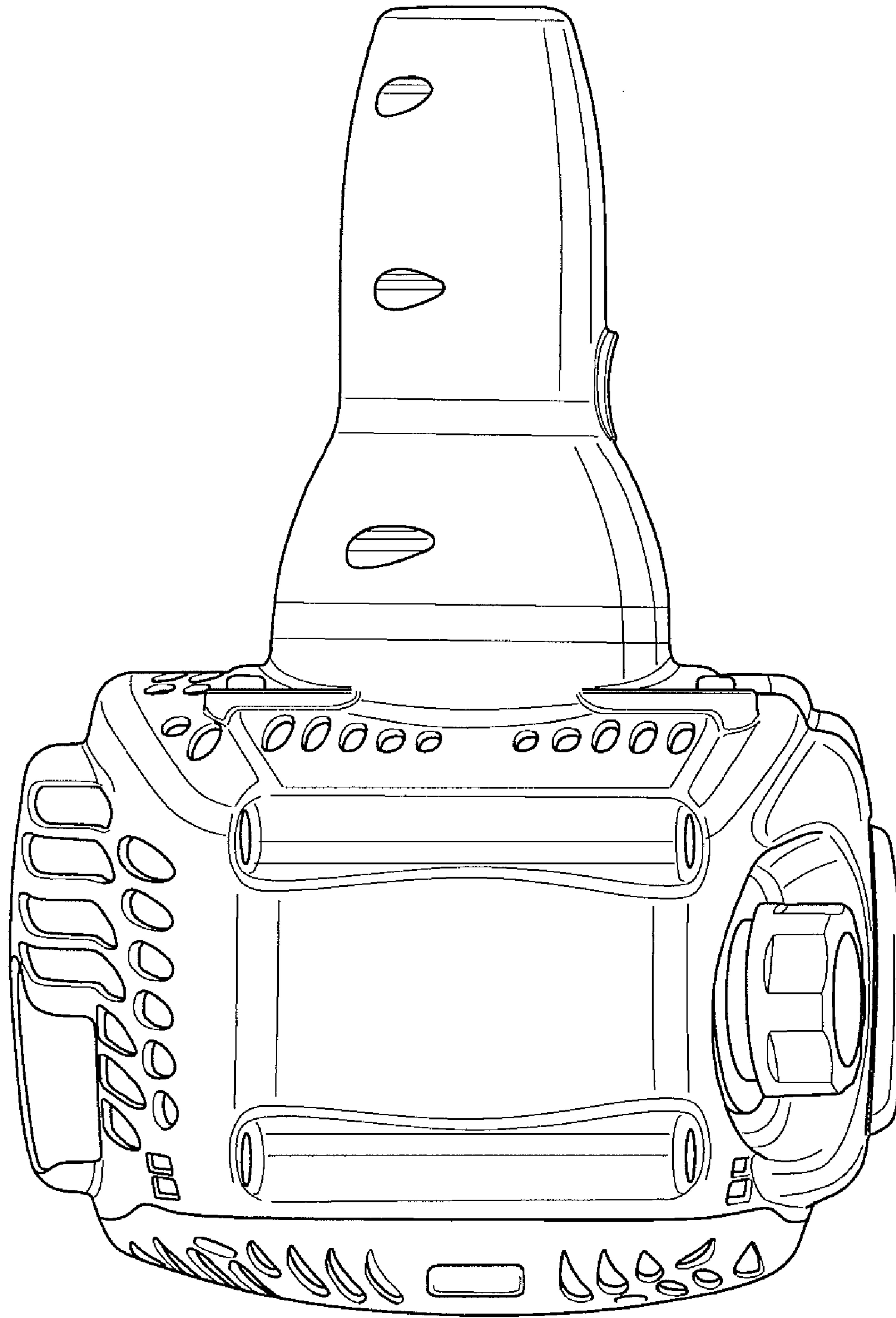
**FIG. 3**



**FIG. 4**



**FIG. 5**



**FIG. 6**



FIG. 7

