



US00D602130S

(12) **United States Design Patent**
Morita

(10) **Patent No.:** **US D602,130 S**

(45) **Date of Patent:** **** *Oct. 13, 2009**

(54) **HOSE CLAMP**

FOREIGN PATENT DOCUMENTS

(75) Inventor: **Naoki Morita**, Yokohama (JP)

JP 1299343 S 3/2007

(73) Assignee: **Piolax Inc.**, Yokohama-Shi (JP)

OTHER PUBLICATIONS

(*) Notice: This patent is subject to a terminal disclaimer.

Related U.S. Appl. No. 29/308,407, filed Jun. 16, 2008; Inventor: Naoki Morita; Title: Hose Clamp.

Related U.S. Appl. No. 29/308,409, filed Jun. 16, 2008; Inventor: Naoki Morita; Title: Hose Clamp.

Related U.S. Appl. No. 29/308,410, filed Jun. 16, 2008; Inventor: Naoki Morita; Title: Hose Clamp.

Related U.S. Appl. No. 29/308,411, filed Jun. 16, 2008; Inventor: Naoki Morita; Title: Hose Clamp.

(**) Term: **14 Years**

(21) Appl. No.: **29/308,408**

Japanese Office Action dated Sep. 24, 2008 and English Abstract thereof issued in counterpart Japanese Application No. 2007-034906.

(22) Filed: **Jun. 16, 2008**

* cited by examiner

(30) **Foreign Application Priority Data**

Dec. 19, 2007 (JP) 2007-034906

Primary Examiner—T. Chase Nelson

Assistant Examiner—Michael A Pratt

(51) **LOC (9) Cl.** **23-01**

(52) **U.S. Cl.** **D23/265**

(58) **Field of Classification Search** D23/213,
D23/249, 257, 259, 260, 261, 262, 263, 264,
D23/265, 266, 267, 268; D8/354–356, 371,
D8/394–396, 382; 24/16 R, 270, 271, 279;
248/49, 62, 74.1–74.4, 73

(74) *Attorney, Agent, or Firm*—Frishauf, Holtz, Goodman & Chick, P.C.

See application file for complete search history.

(57) **CLAIM**

The ornamental design for the hose clamp, as shown and described.

(56) **References Cited**

DESCRIPTION

U.S. PATENT DOCUMENTS

- 4,305,179 A * 12/1981 Sakurada 24/20 R
- 4,315,348 A * 2/1982 Oetiker 24/20 CW
- 4,380,096 A * 4/1983 Nishida et al. 24/20 R
- D317,351 S * 6/1991 Takeuchi D23/265
- D317,352 S * 6/1991 Takeuchi D23/265
- D335,079 S * 4/1993 Sachs D8/396
- RE35,253 E * 5/1996 Worley et al. 285/243
- 5,616,205 A * 4/1997 Cogdill et al. 156/229
- 6,098,251 A * 8/2000 Zielinski 24/20 R
- 7,225,706 B2 * 6/2007 Kassabian 81/9.3
- D583,027 S * 12/2008 Morita D23/265
- 2003/0159255 A1 * 8/2003 Senovich et al. 24/20 R
- 2004/0025304 A1 * 2/2004 Senovich et al. 24/20 R
- 2006/0278044 A1 * 12/2006 Kassabian 81/9.3

FIG. 1 is a perspective view of the hose clamp showing my new design;

FIG. 2 is a rear view thereof;

FIG. 3 is a front view thereof;

FIG. 4 is a top plan view thereof;

FIG. 5 is a bottom plan view thereof;

FIG. 6 is a left side view thereof;

FIG. 7 is a right side view thereof; and,

FIG. 8 is a perspective view thereof in a state of use.

The broken lines shown in FIGS. 1–8 are included for the purpose of illustrating environment and form no part of the claimed design.

1 Claim, 4 Drawing Sheets

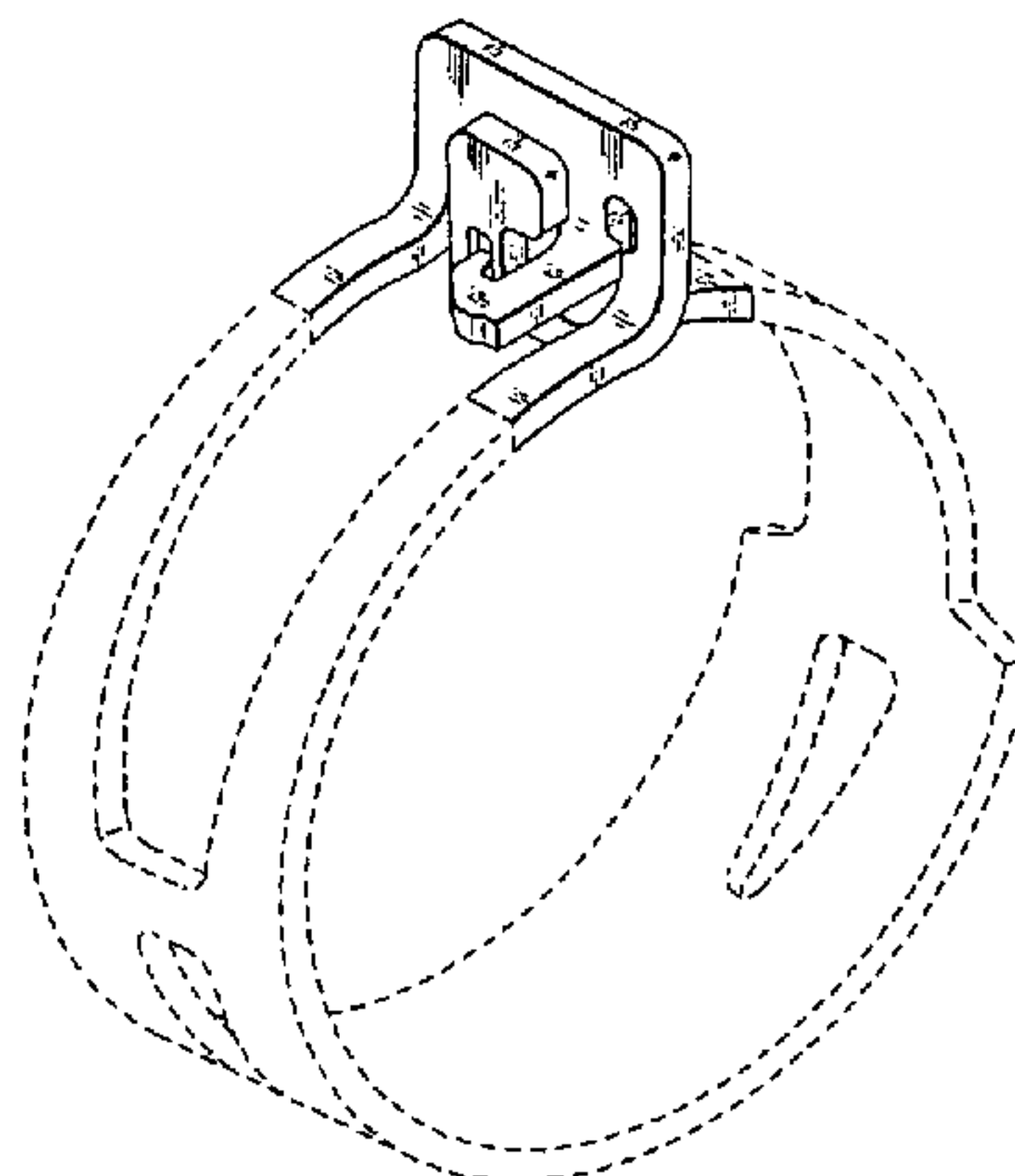

FIG.1

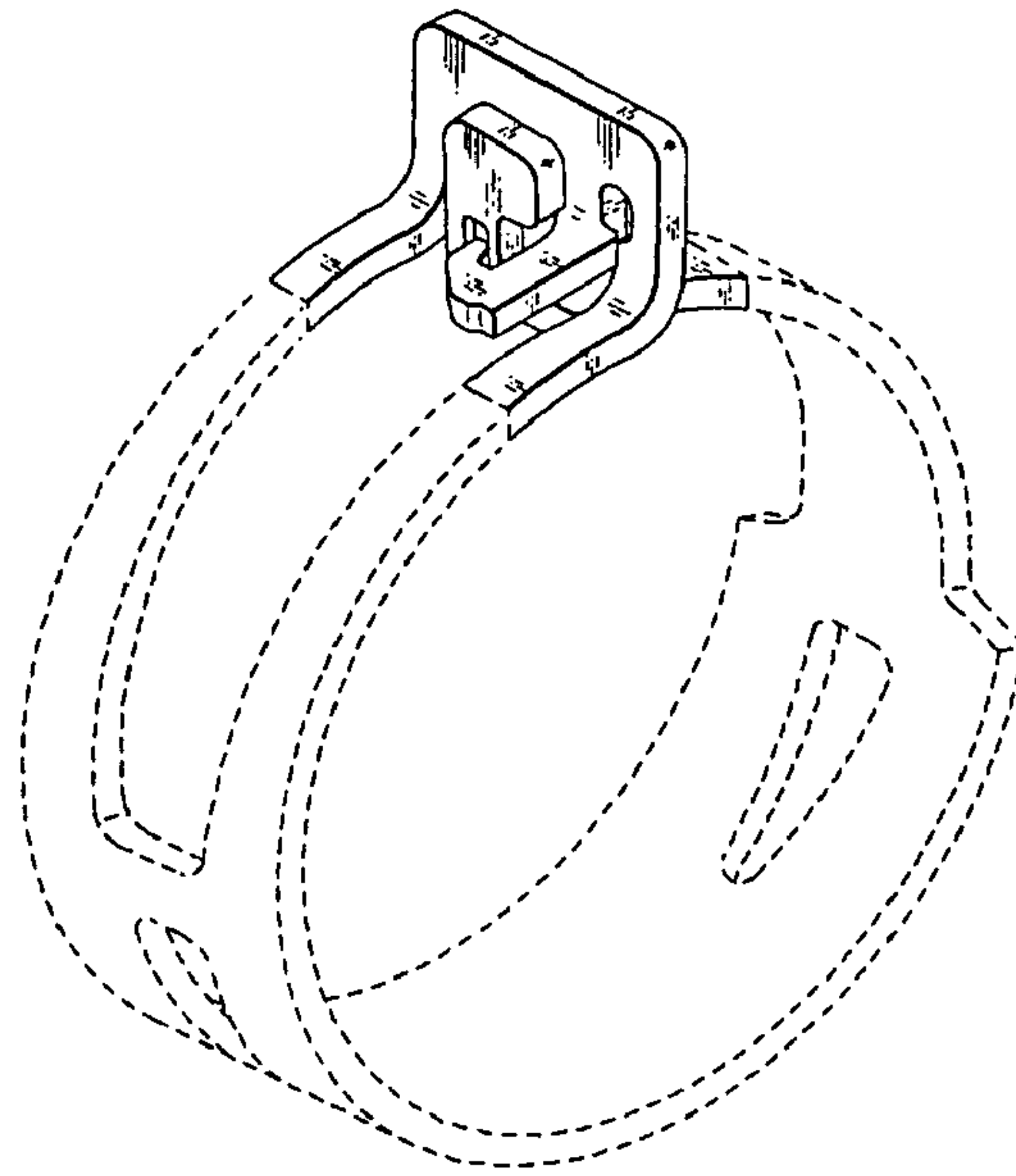

FIG.2

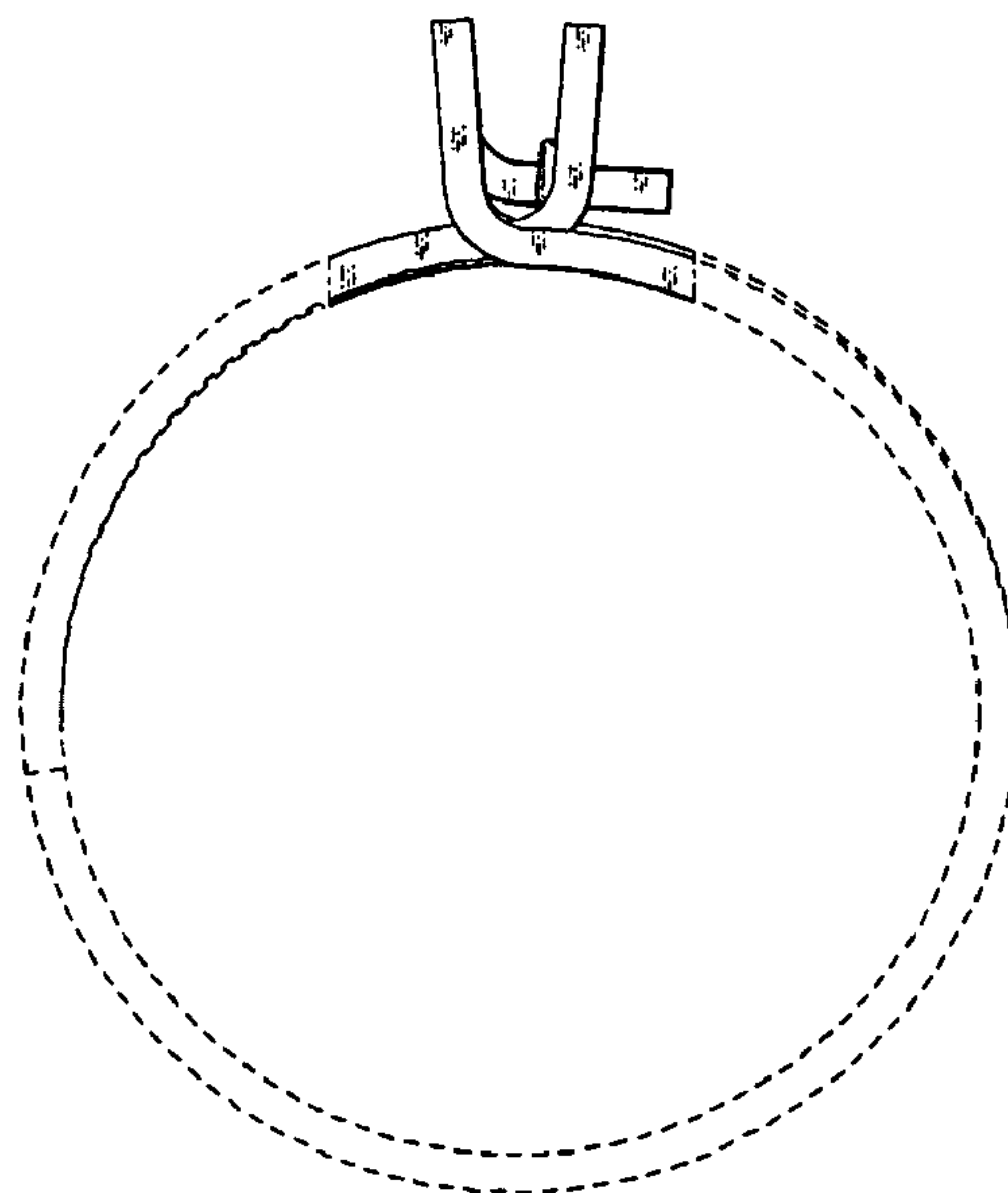

FIG.3

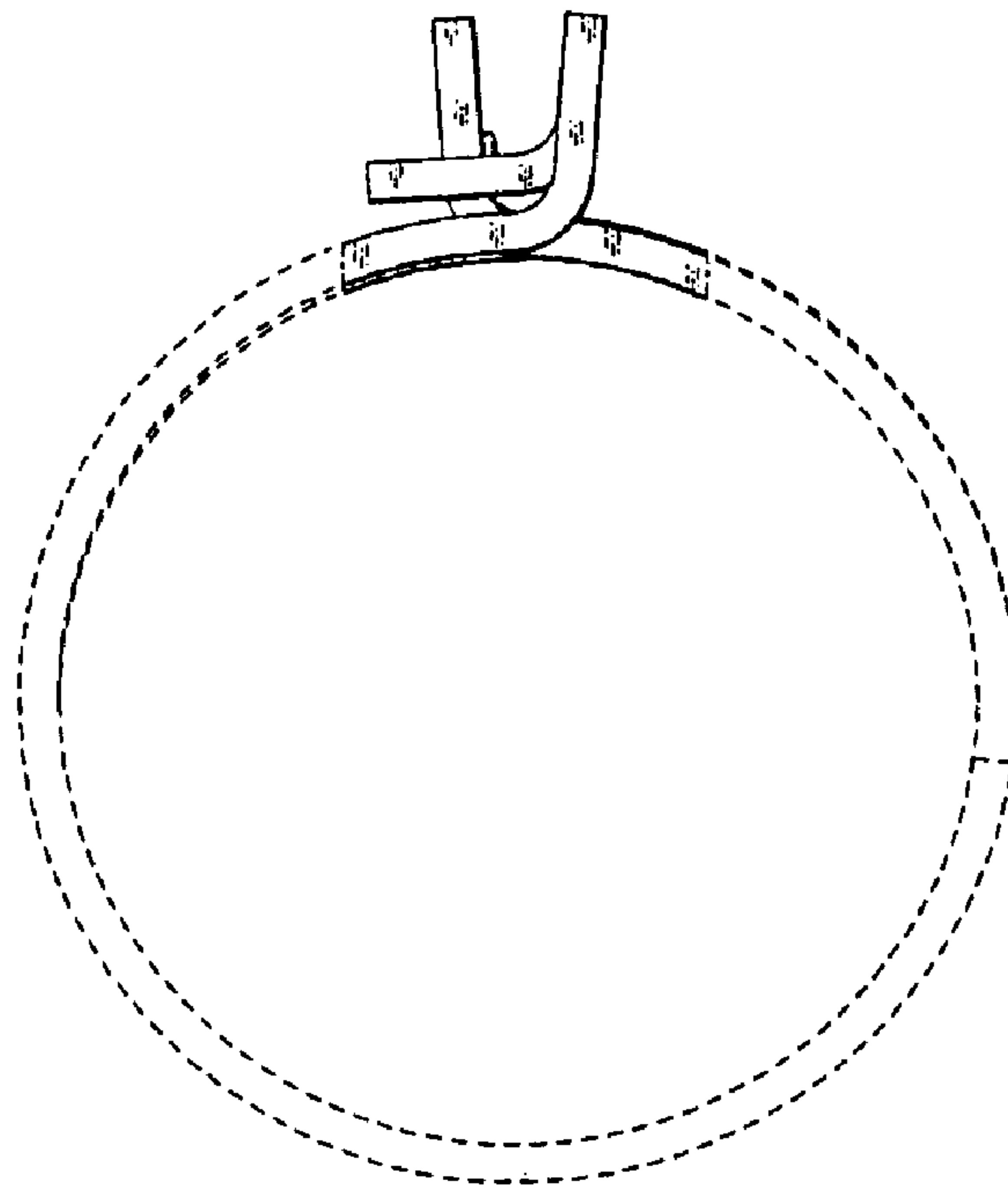

FIG.4

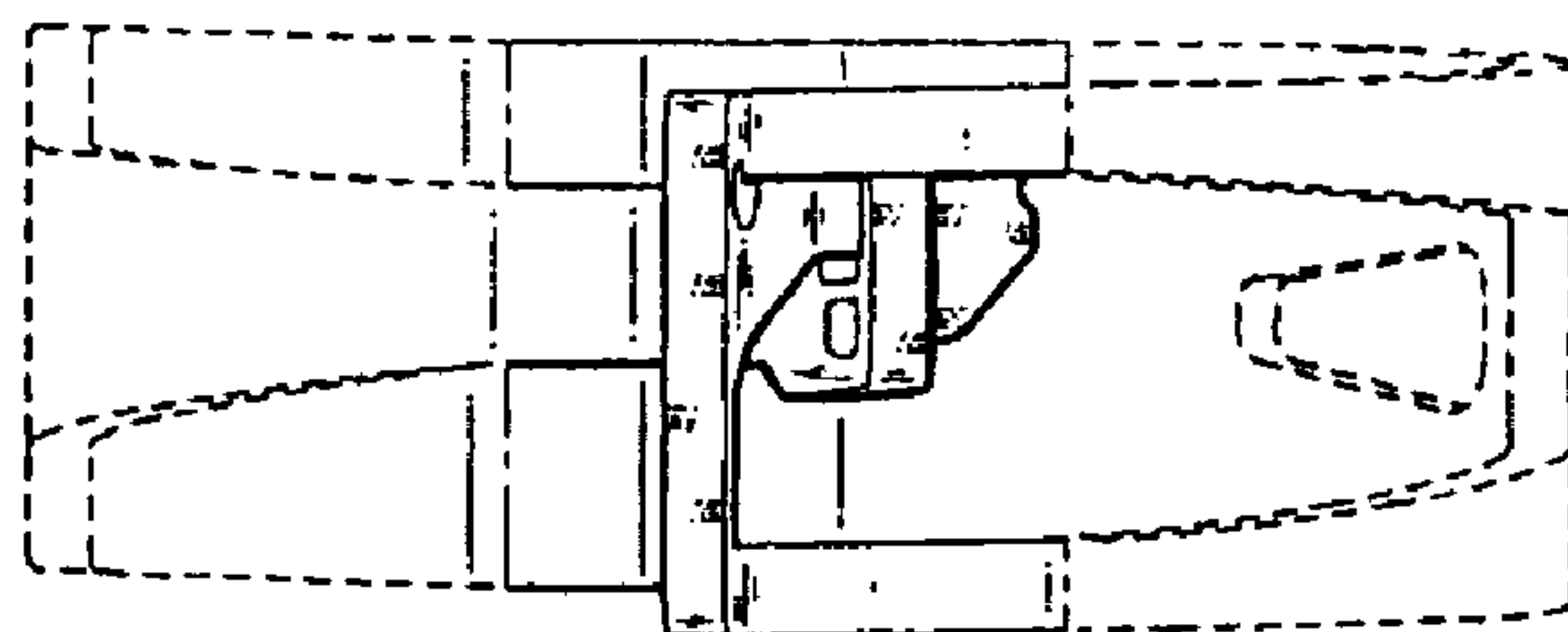

FIG.5

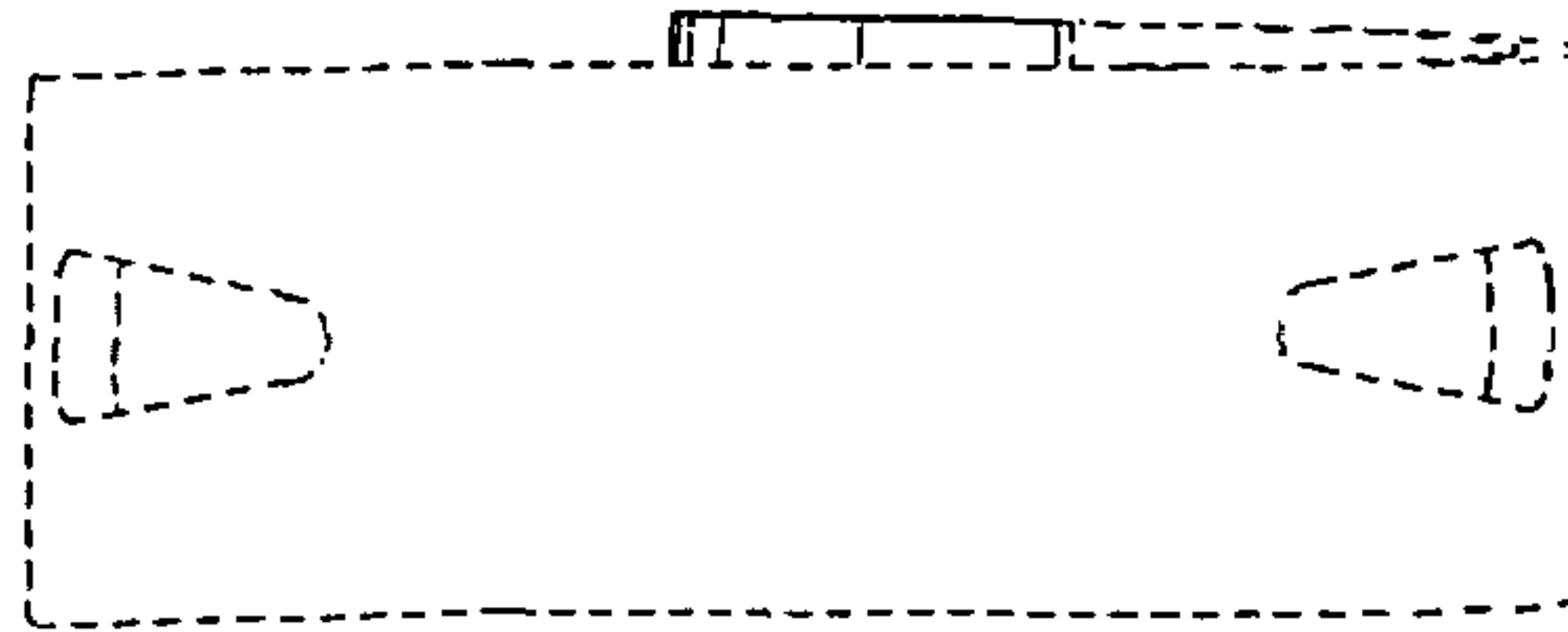

FIG.6

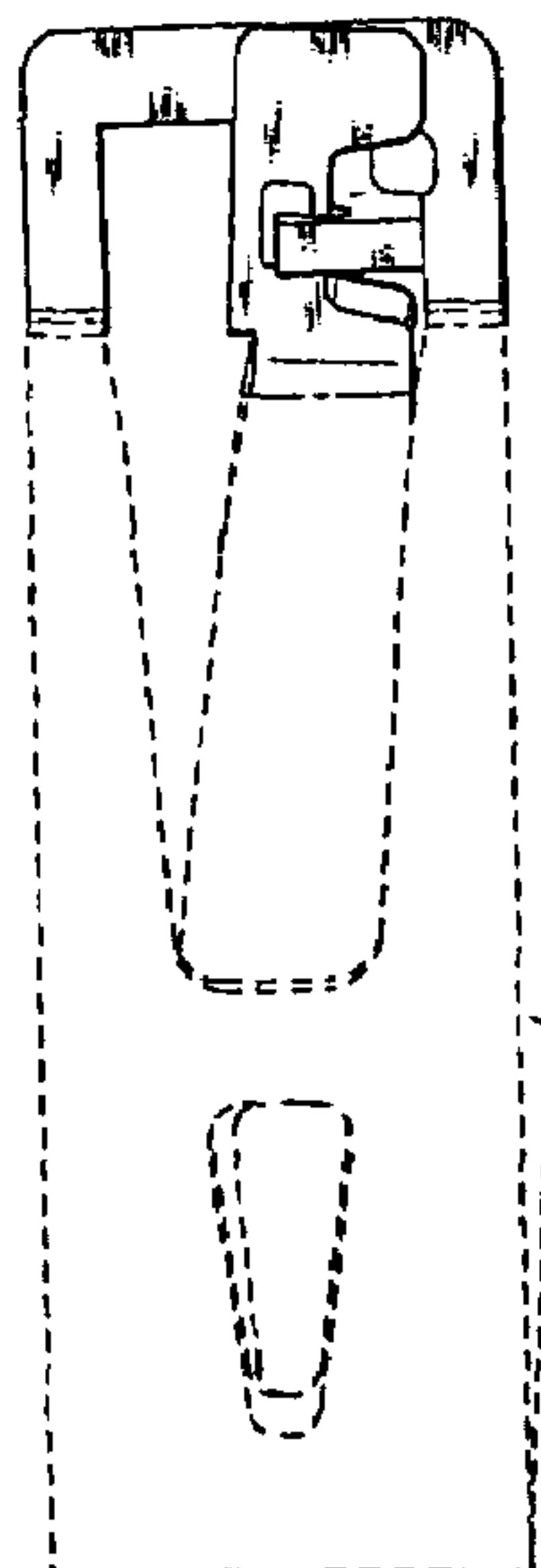

FIG.7

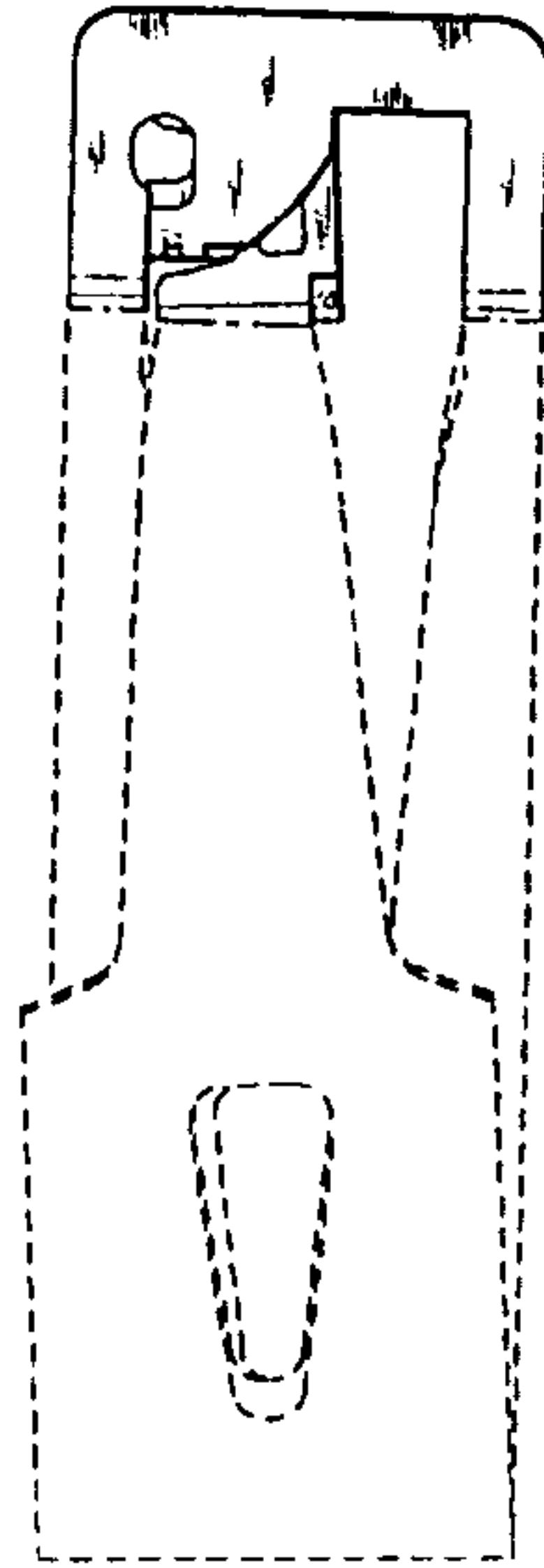

FIG.8

