



US00D601453S

(12) **United States Design Patent**
Brew et al.

(10) **Patent No.:** **US D601,453 S**

(45) **Date of Patent:** **** Oct. 6, 2009**

(54) **SNOWMOBILE**

(75) Inventors: **Gregory C. Brew**, Minnetonka, MN (US); **Cameron Fisher**, Minneapolis, MN (US)

(73) Assignee: **Polaris Industries Inc.**, Medina, MN (US)

(**) Term: **14 Years**

(21) Appl. No.: **29/301,572**

(22) Filed: **Mar. 7, 2008**

(51) **LOC (9) Cl.** **12-14**

(52) **U.S. Cl.** **D12/7**

(58) **Field of Classification Search** D12/7,
D12/110, 111, 9, 112, 307, 400, 86, 85, 88;
D21/533; 180/182, 190, 184-186, 9.25,
180/180, 219, 193, 194; 280/845; D6/354
See application file for complete search history.

(56) **References Cited**

U.S. PATENT DOCUMENTS

D479,813	S	*	9/2003	Cadotte et al.	D12/7
D495,973	S	*	9/2004	Cadotte et al.	D12/7
D505,889	S	*	6/2005	Girouard et al.	D12/7
D576,522	S		9/2008	Longpre et al.		
2002/0112909	A1	*	8/2002	Nishijima	180/190
2003/0047368	A1	*	3/2003	Morin et al.	180/190
2003/0070854	A1	*	4/2003	Bergman	180/182
2003/0150658	A1	*	8/2003	Nakano et al.	180/190
2004/0016583	A1	*	1/2004	Pyykonen	180/193
2004/0188159	A1	*	9/2004	Yatagai et al.	180/182

2004/0211608	A1	*	10/2004	Morin et al.	180/190
2006/0191728	A1	*	8/2006	Aoshima	180/190
2007/0034435	A1	*	2/2007	Berg et al.	180/190
2007/0062751	A1	*	3/2007	Rasidescu et al.	180/190

OTHER PUBLICATIONS

Photograph of the Polaris "Fusion".
Photograph of the Polaris "IQ 440".

* cited by examiner

Primary Examiner—T. Chase Nelson

Assistant Examiner—Ania K Dworzecka

(74) *Attorney, Agent, or Firm*—Baker & Daniels LLP

(57) **CLAIM**

We claim the ornamental design for the snowmobile, as shown and described.

DESCRIPTION

FIG. 1 is front left perspective view;
FIG. 2 is a front right perspective view;
FIG. 3 is a left rear perspective view;
FIG. 4 is a right rear perspective view;
FIG. 5 is a front view;
FIG. 6 is a left side view;
FIG. 7 is a right side view;
FIG. 8 is a rear view; and,
FIG. 9 is a top view.

In the drawings, the broken lines shown depict environmental subject matter only and form no part of the claimed design.

1 Claim, 8 Drawing Sheets

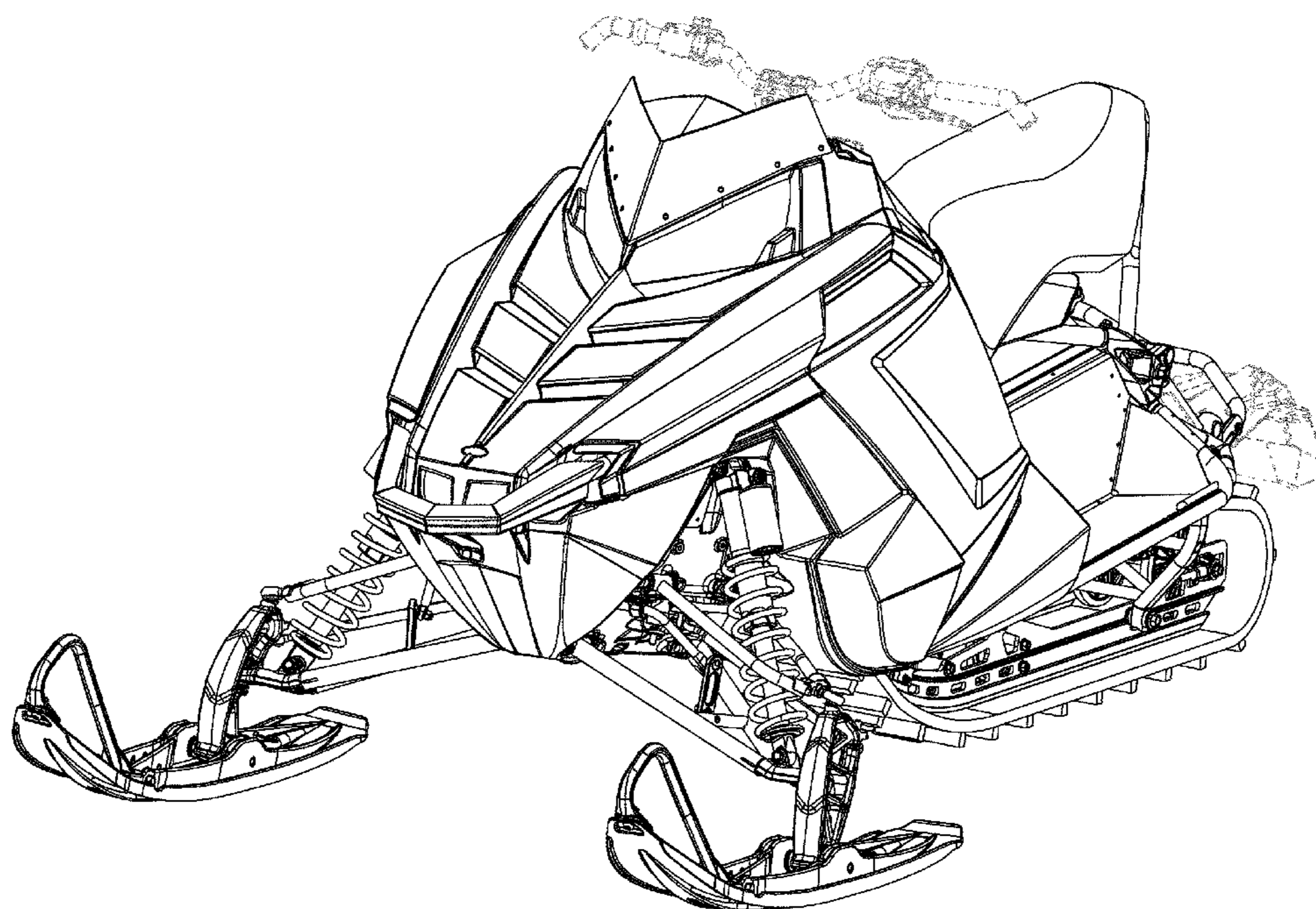

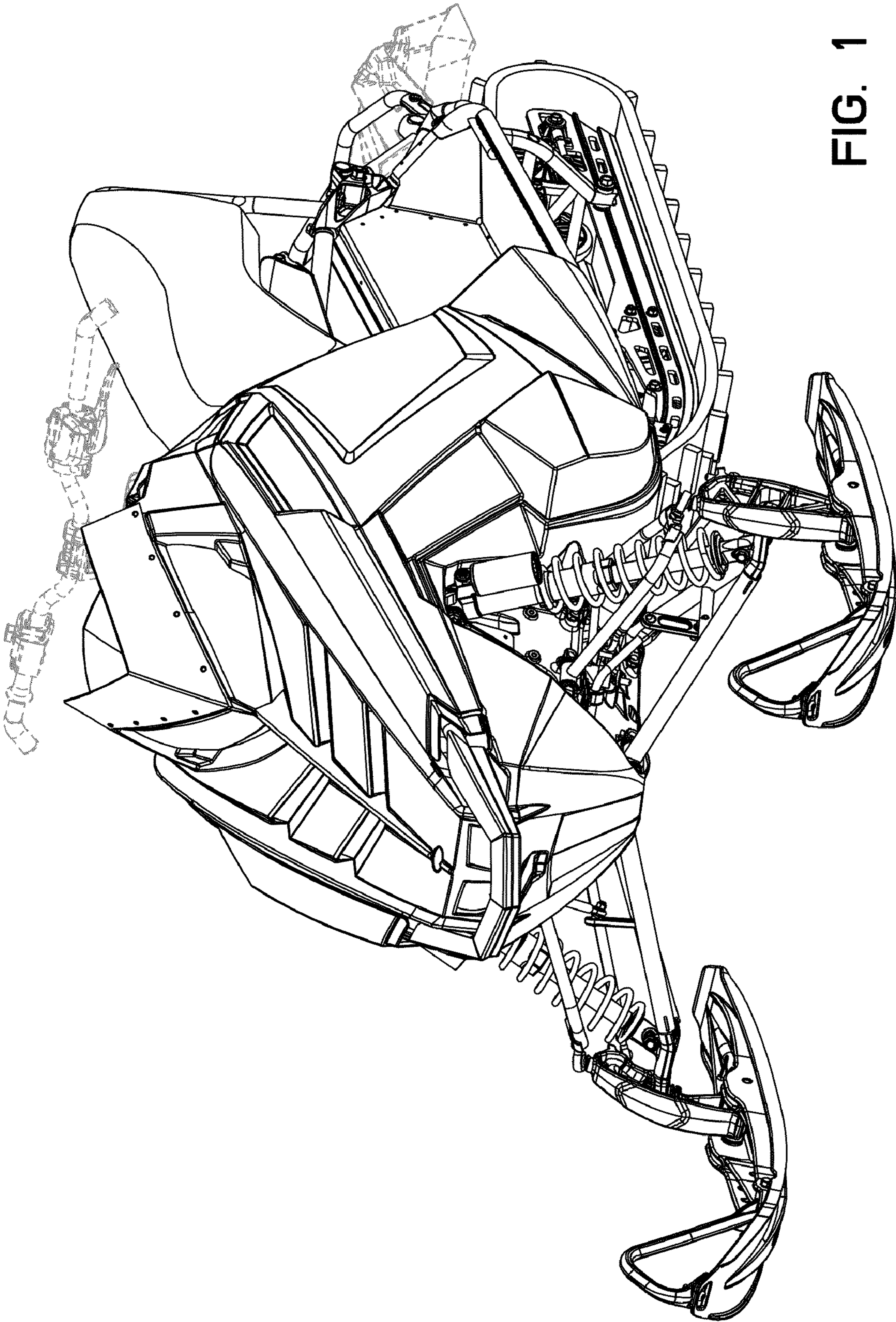

FIG. 1

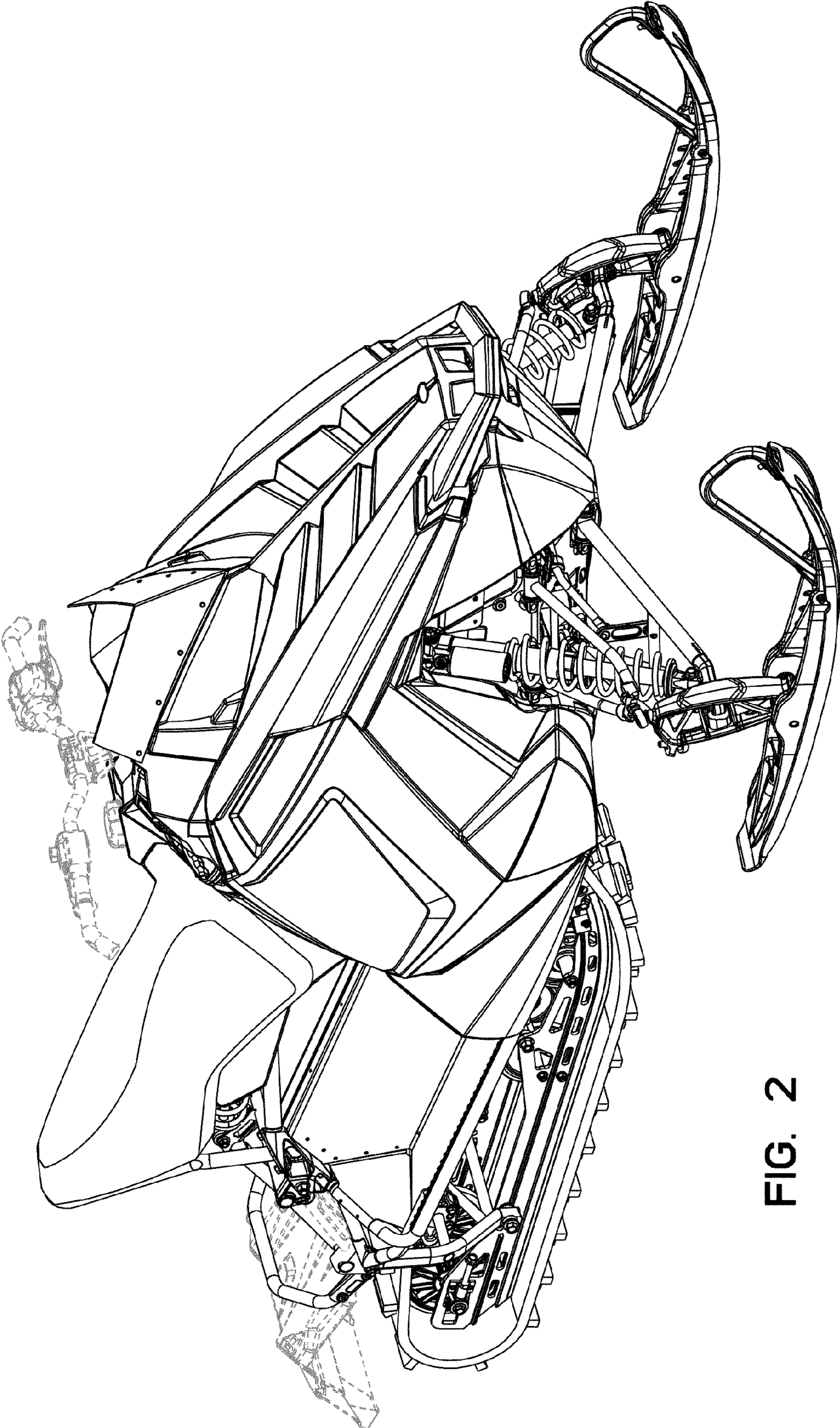

FIG. 2

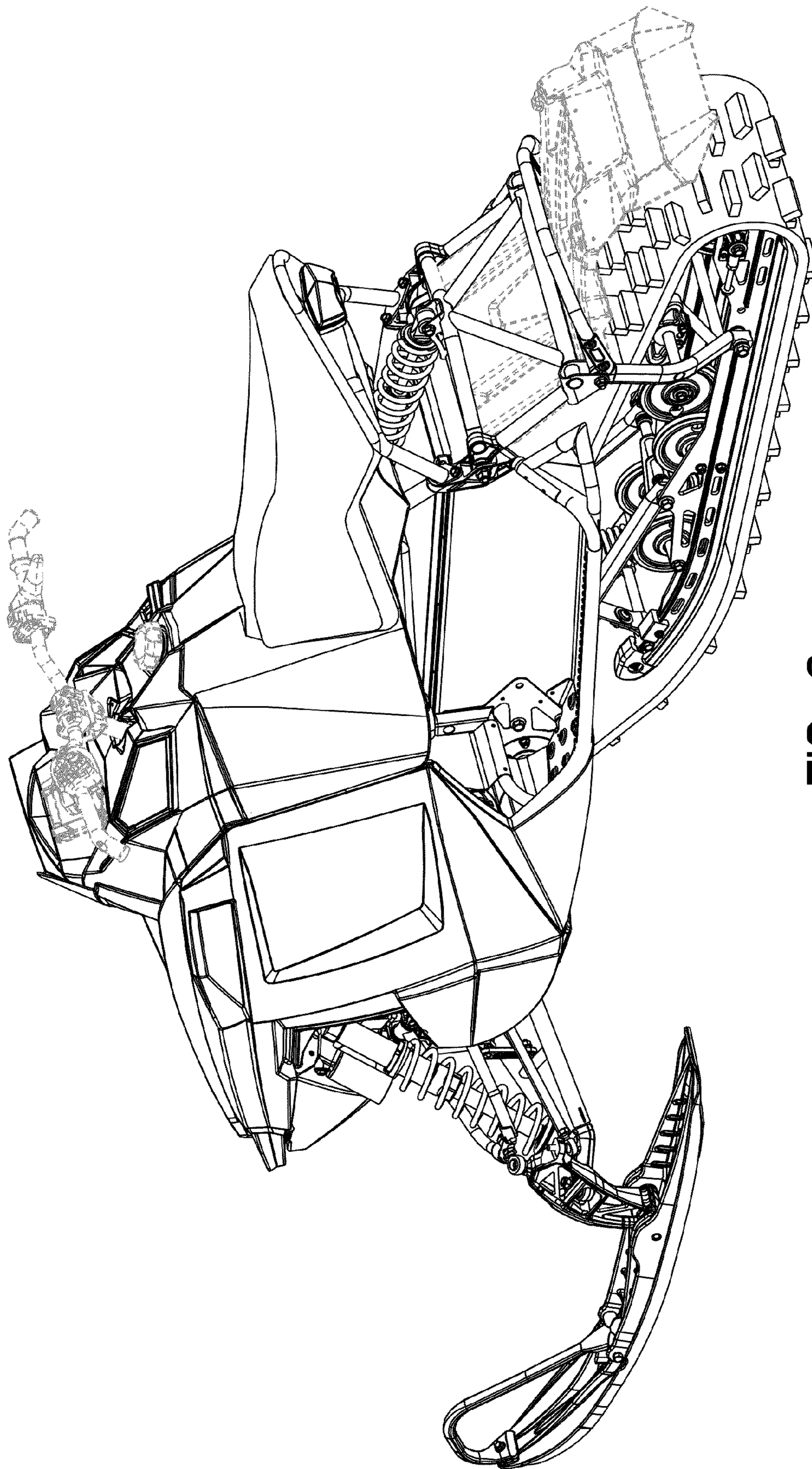

FIG. 3

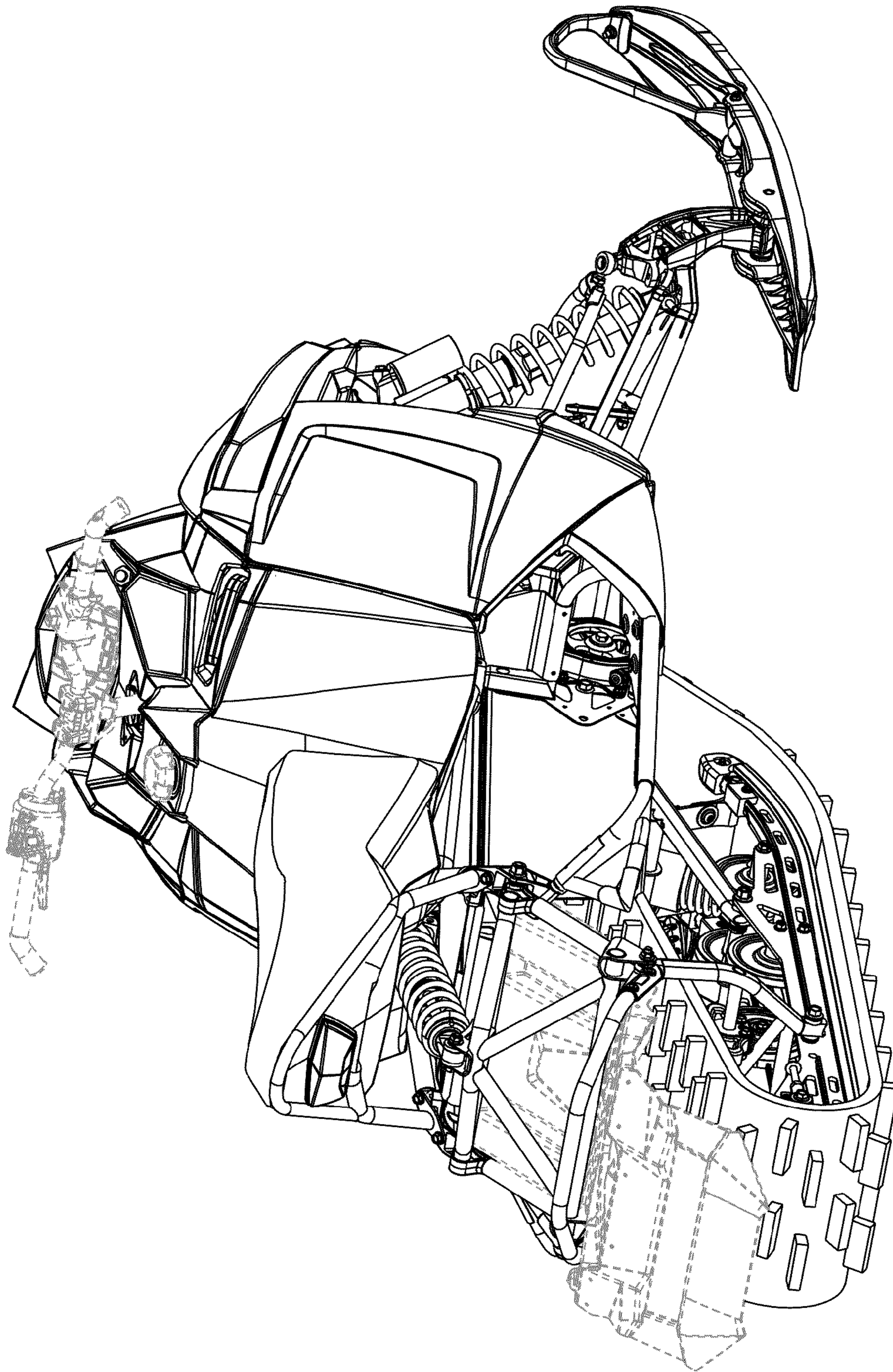

FIG. 4

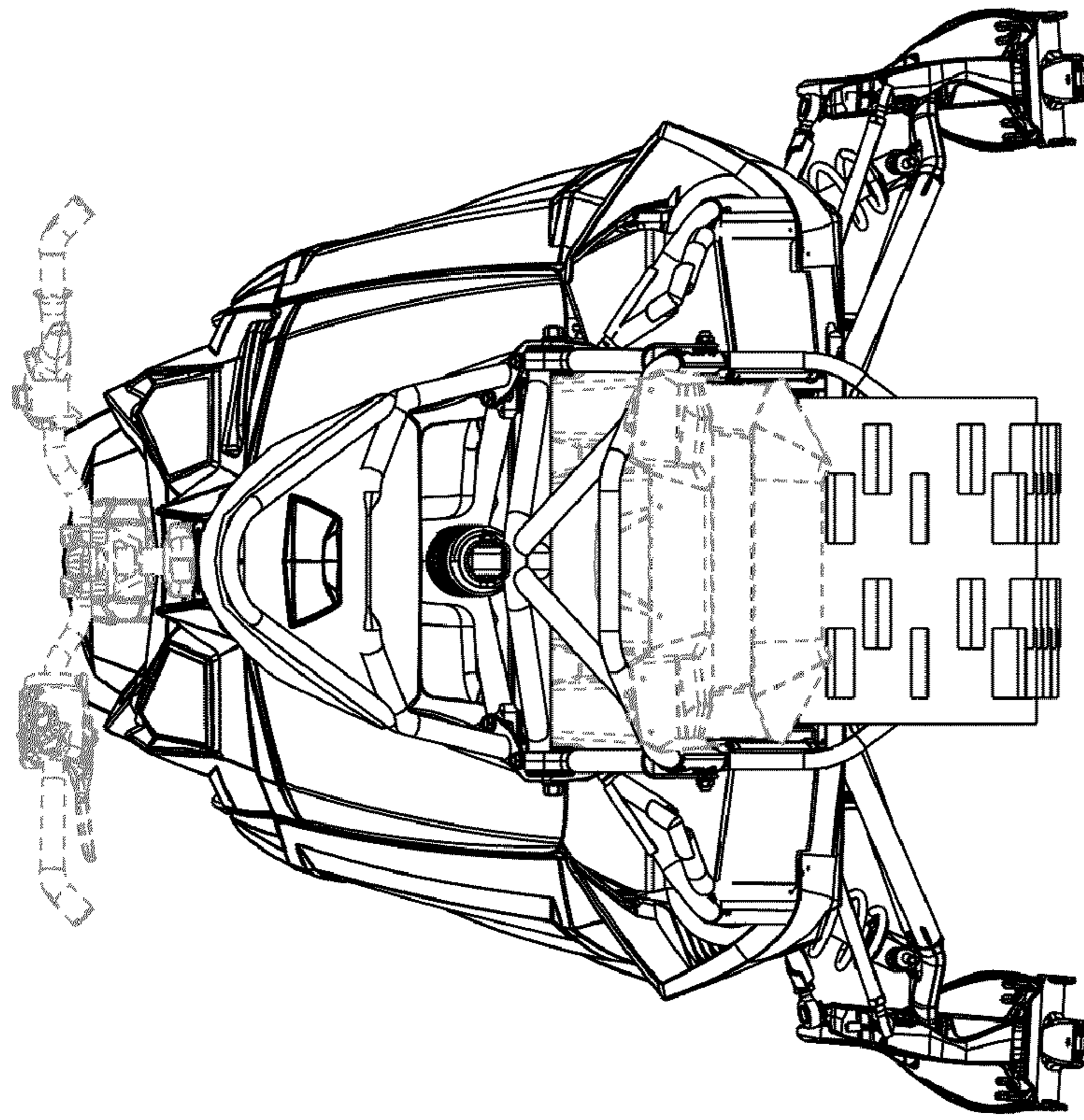

FIG. 8

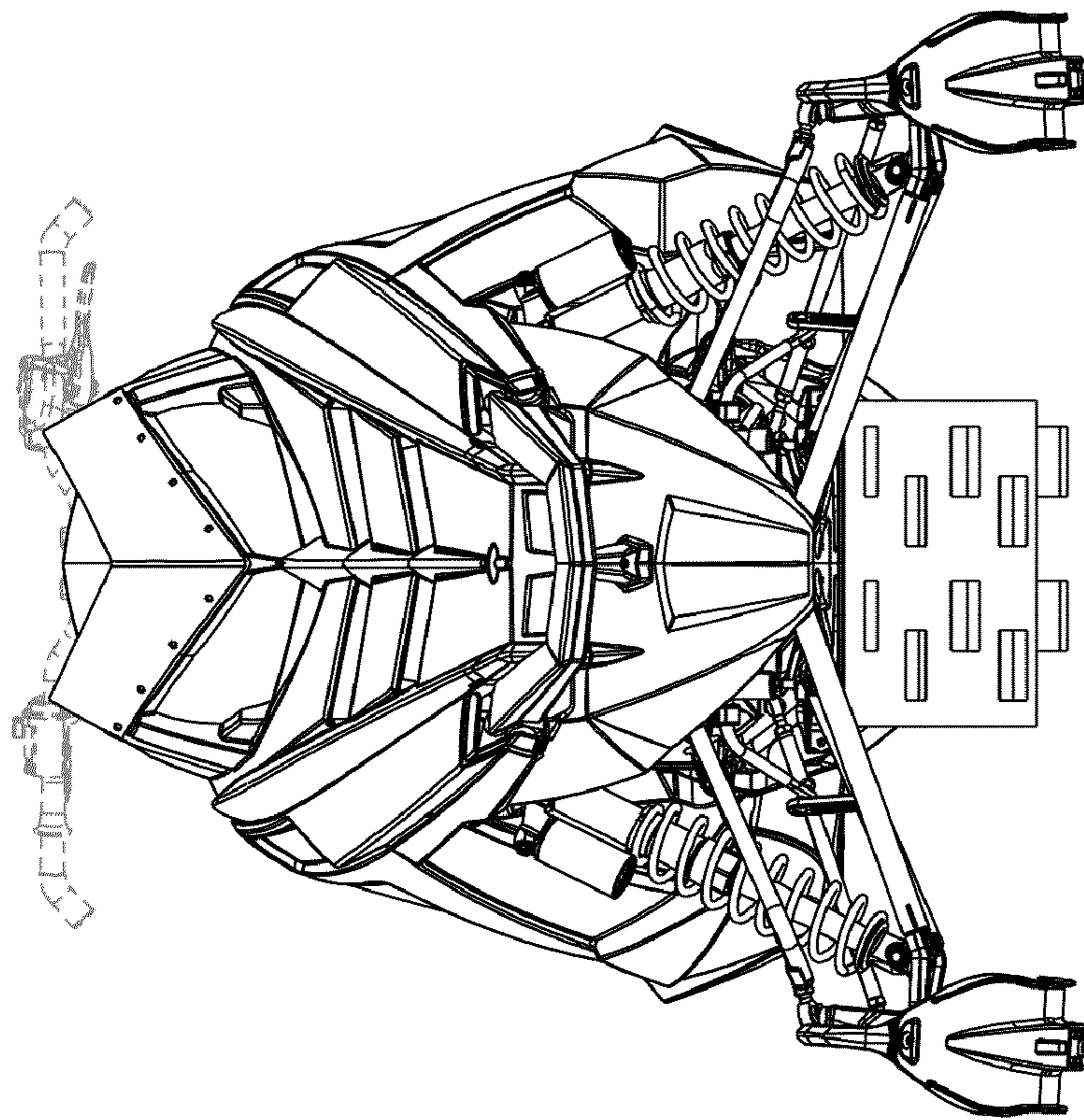

FIG. 5

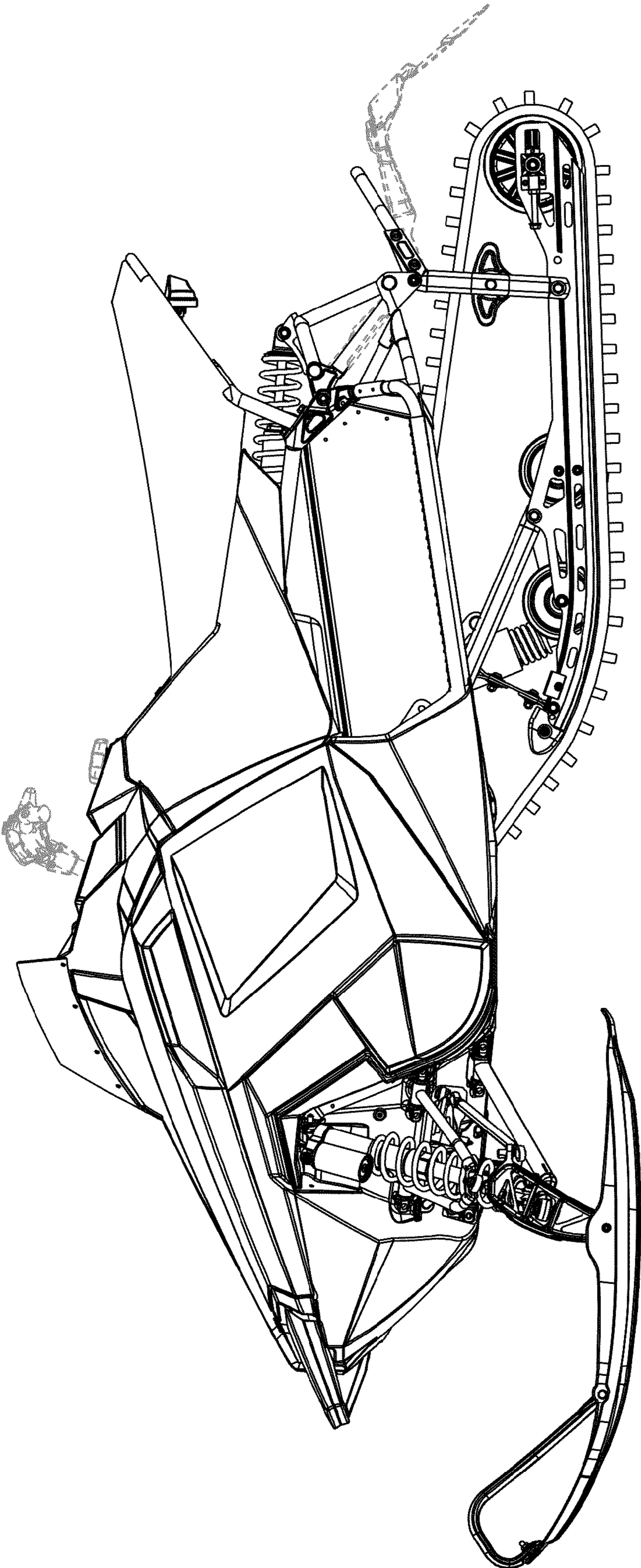

FIG. 6

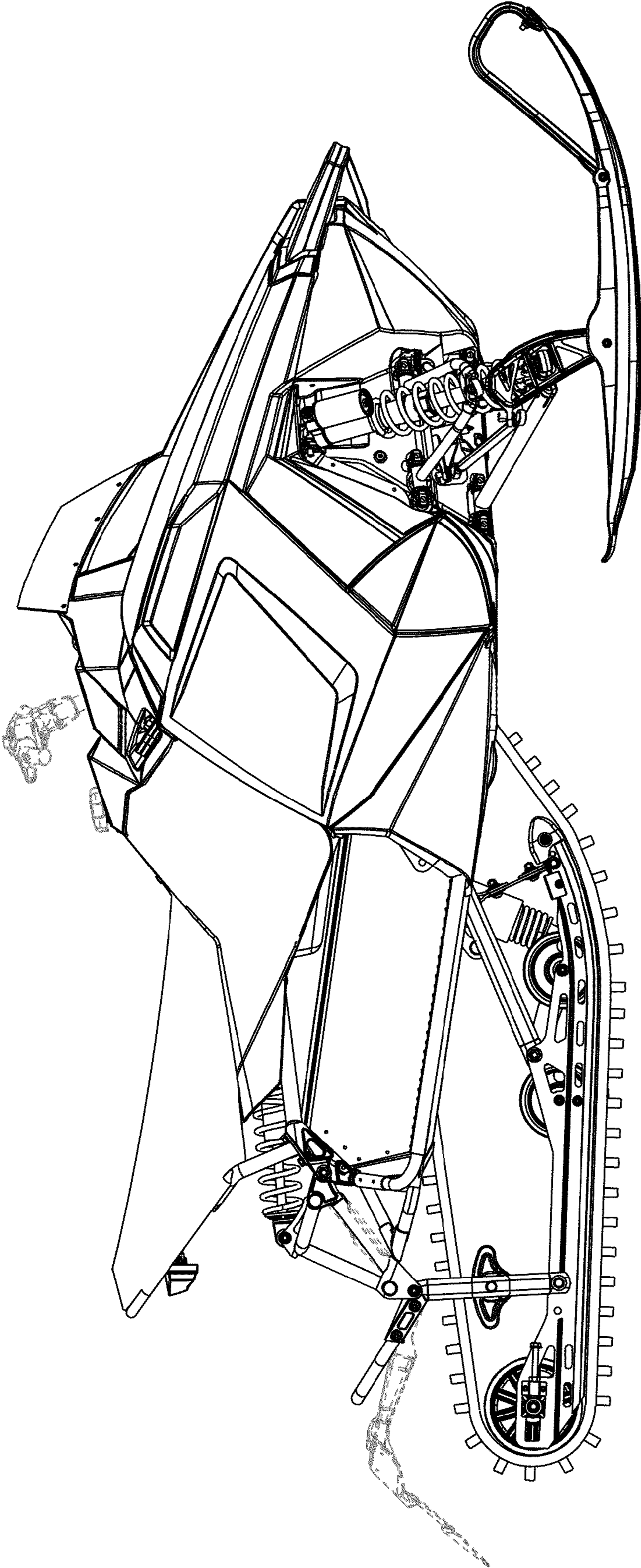

FIG. 7

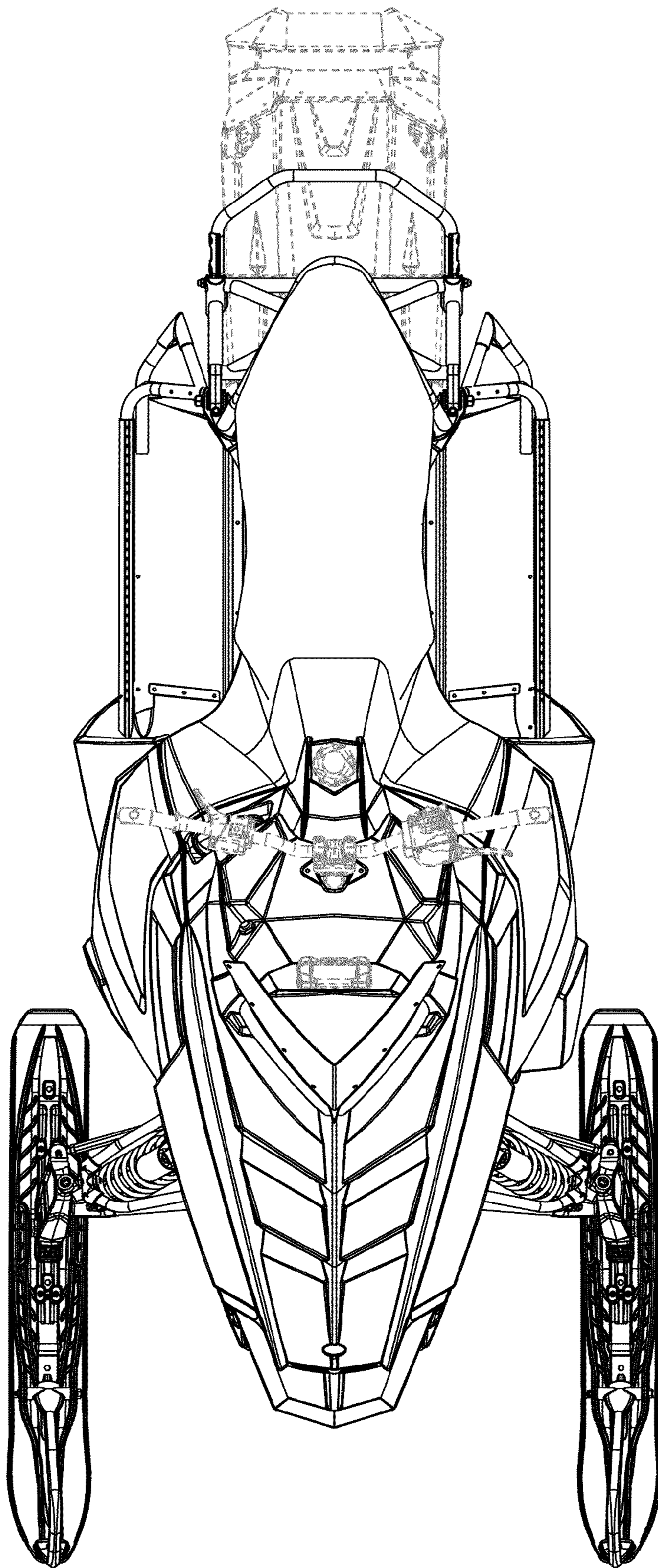

FIG. 9