



US00D601190S

(12) **United States Design Patent**  
**Liu**

(10) **Patent No.:** **US D601,190 S**  
(45) **Date of Patent:** **\*\* Sep. 29, 2009**

(54) **COMBINATION PEN AND LASER POINTER**

(75) Inventor: **Liang Liu**, Ningbo (CN)

(73) Assignee: **Beifa Group Co., Ltd.**, Ningbo (CN)

(\*\*) Term: **14 Years**

(21) Appl. No.: **29/330,034**

(22) Filed: **Dec. 26, 2008**

(30) **Foreign Application Priority Data**

Jun. 30, 2008 (CN) ..... 2008 3 0139529

(51) **LOC (9) Cl.** ..... **19-06**

(52) **U.S. Cl.** ..... **D19/36**

(58) **Field of Classification Search** ..... D19/35,  
D19/36, 41-51, 53-57; 24/11 F, 11 P, 11 R;  
401/52, 99, 100, 104-109, 192, 195, 196;  
D26/37; 362/109, 118

See application file for complete search history.

(56) **References Cited**

**U.S. PATENT DOCUMENTS**

- D155,532 S \* 10/1949 Morrison ..... D19/48
- D181,244 S 10/1957 Zierhut
- D182,162 S \* 2/1958 Carreiro ..... D19/51
- D182,216 S 2/1958 Zierhut
- D305,551 S \* 1/1990 Oka ..... D19/57
- D319,845 S \* 9/1991 Grotsch et al. .... D19/48
- D482,397 S 11/2003 Hui
- 6,682,202 B2 \* 1/2004 Wong ..... 362/118
- D500,522 S \* 1/2005 Rommel ..... D19/51
- D502,507 S 3/2005 Wang

- D502,737 S \* 3/2005 Bodino ..... D19/43
- D508,264 S \* 8/2005 Losel ..... D19/50
- D538,343 S \* 3/2007 Morton et al. .... D19/50
- D548,281 S 8/2007 Tien
- D576,677 S \* 9/2008 Jeon ..... D19/50
- D591,350 S \* 4/2009 Beyer ..... D19/50
- 2007/0223214 A1 \* 9/2007 Yen ..... 362/118

**FOREIGN PATENT DOCUMENTS**

- EM 000665419-0017 \* 2/2007
- WO DM/068901 \* 2/2007

\* cited by examiner

*Primary Examiner*—Elizabeth A Albert  
(74) *Attorney, Agent, or Firm*—Christensen O'Connor Johnson Kindness PLLC

(57) **CLAIM**

The ornamental design for a combination pen and laser pointer, as shown and described.

**DESCRIPTION**

FIG. 1 is an upper front right perspective view of a combination pen and laser pointer showing my new design;

FIG. 2 is left side elevation view thereof;

FIG. 3 is an enlarged top plan view thereof;

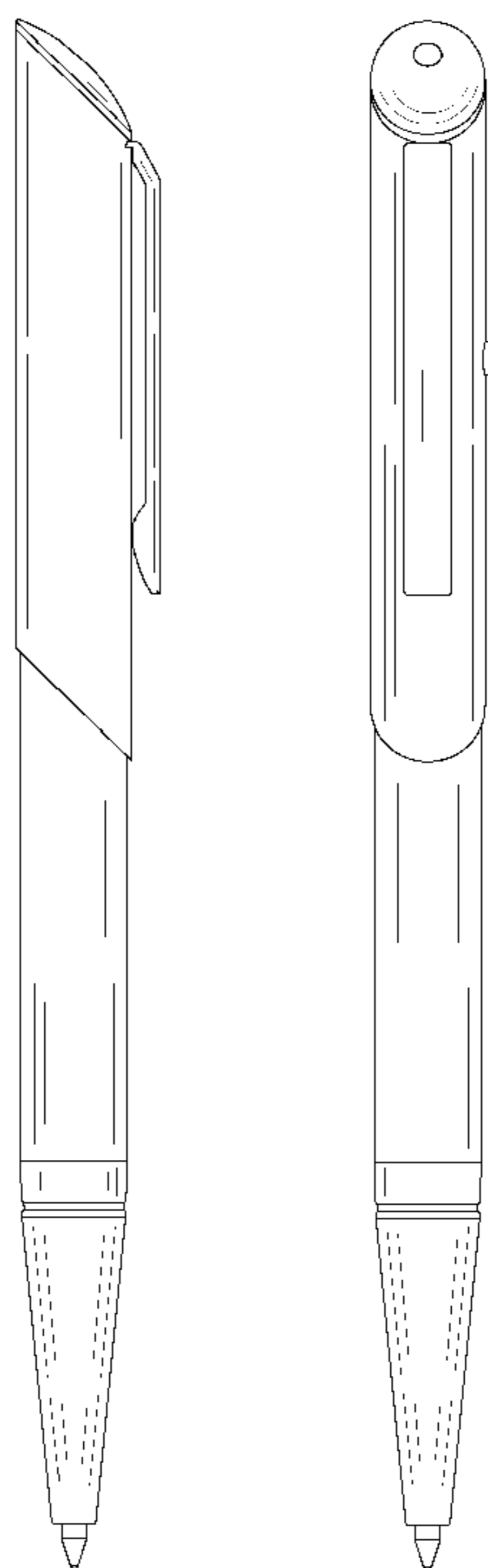
FIG. 4 is a front elevation view thereof;

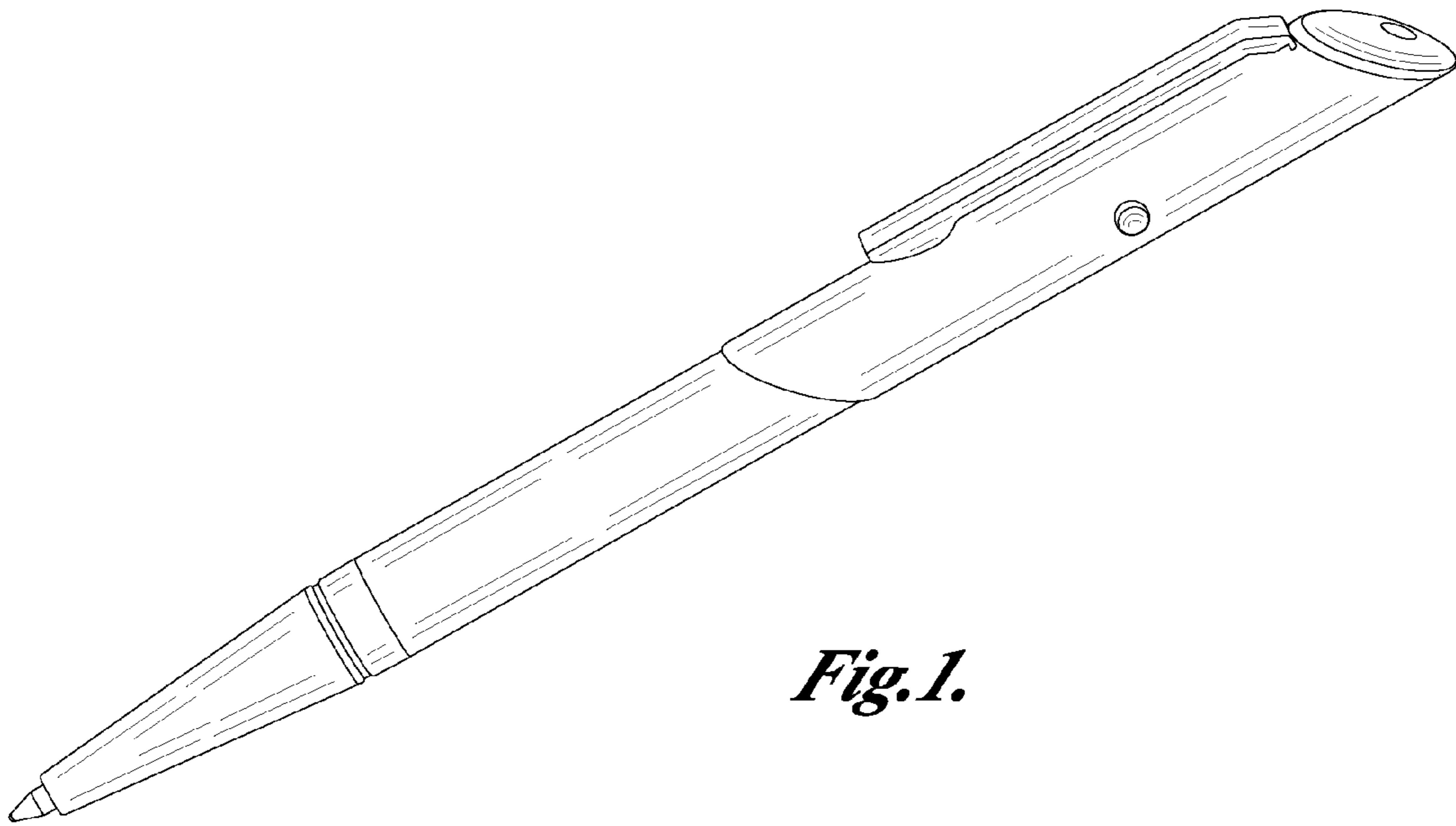
FIG. 5 is a right side elevation view thereof;

FIG. 6 is an enlarged bottom plan view thereof; and,

FIG. 7 is a rear elevation view thereof.

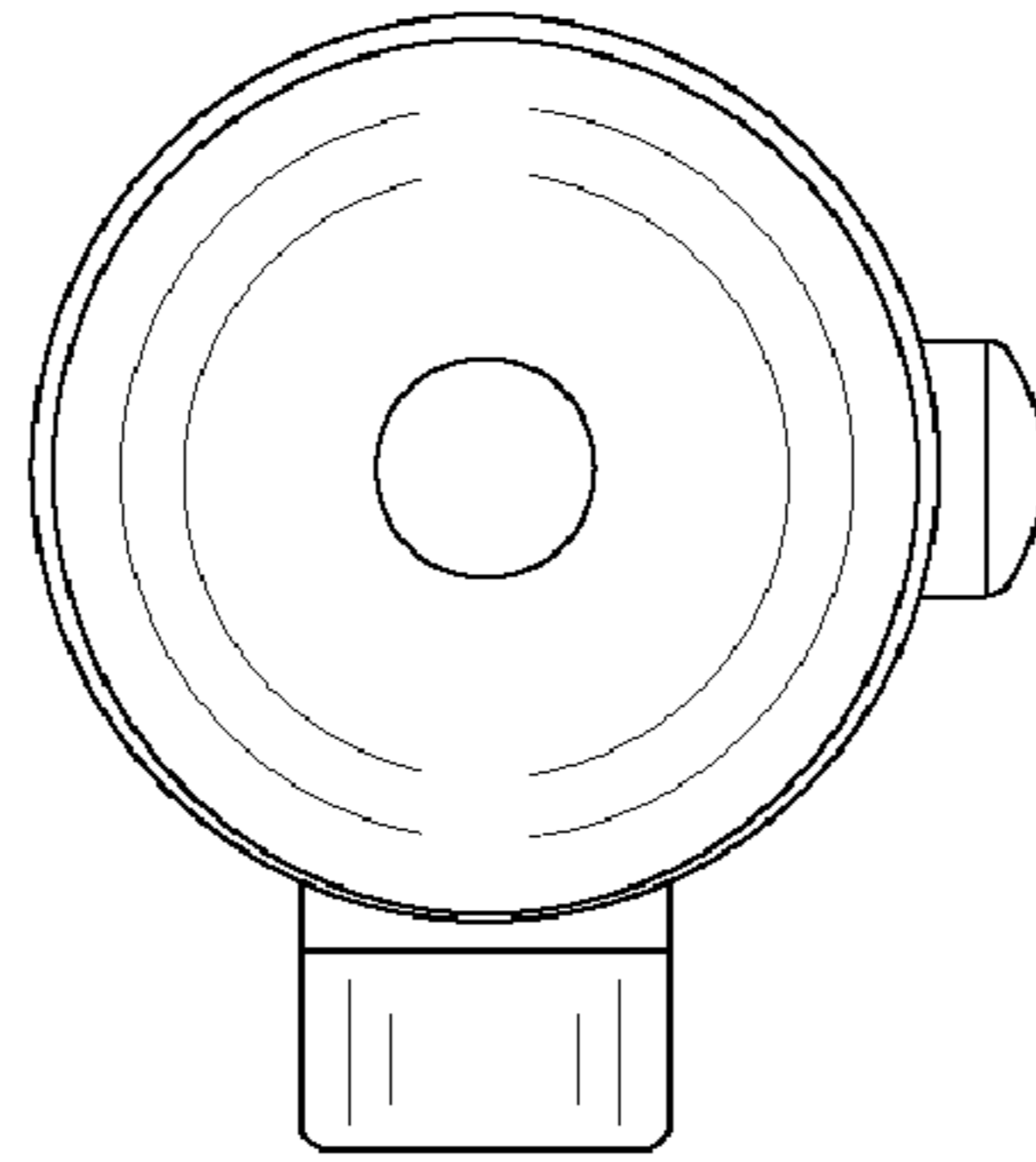
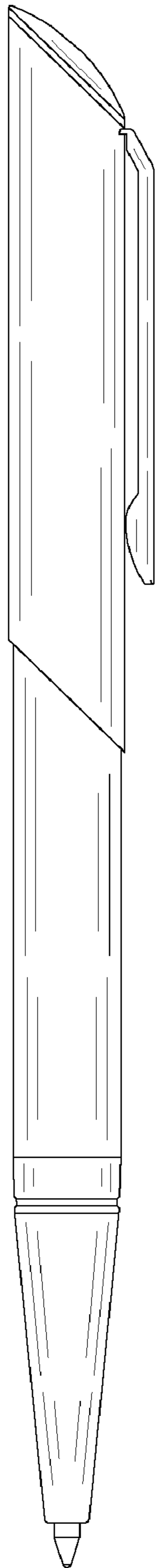
**1 Claim, 3 Drawing Sheets**





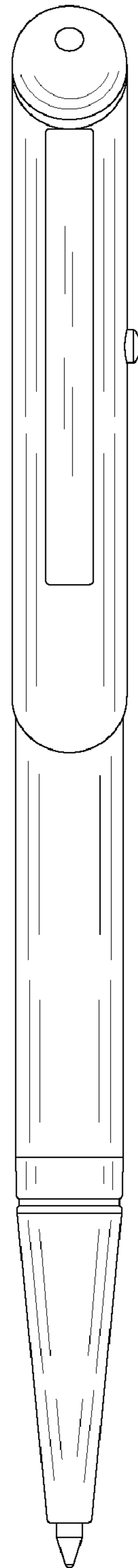
*Fig. 1.*

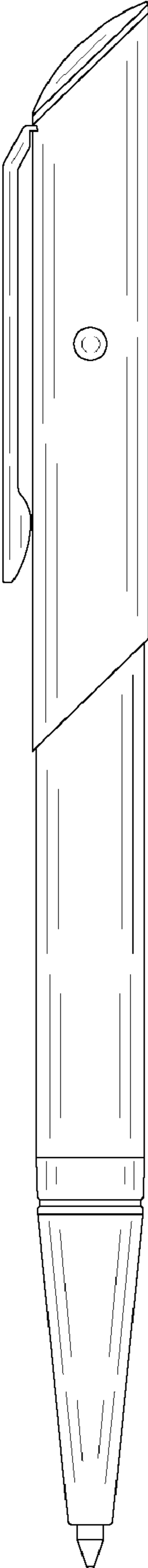
*Fig.2.*



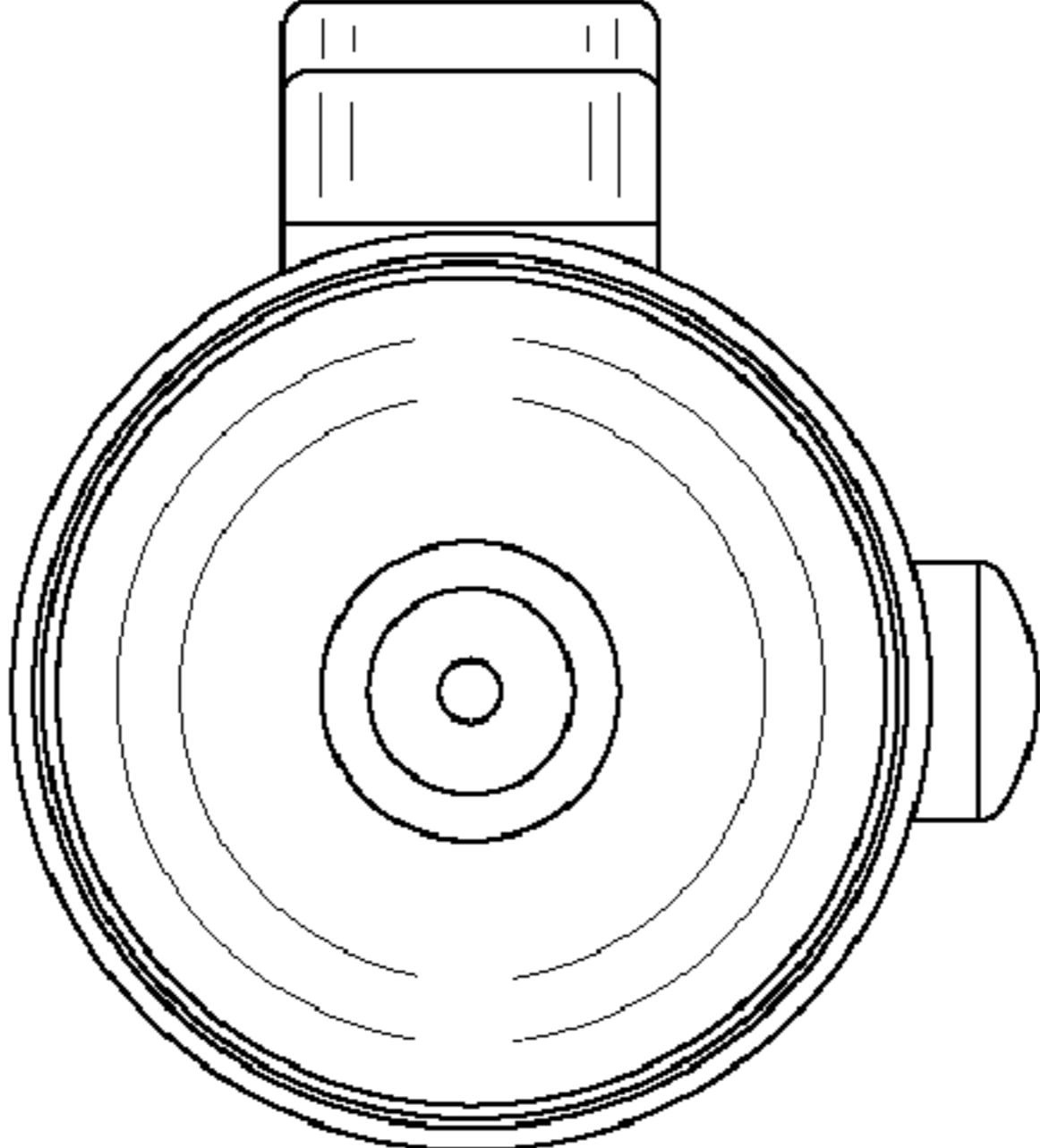
*Fig.3.*

*Fig.4.*

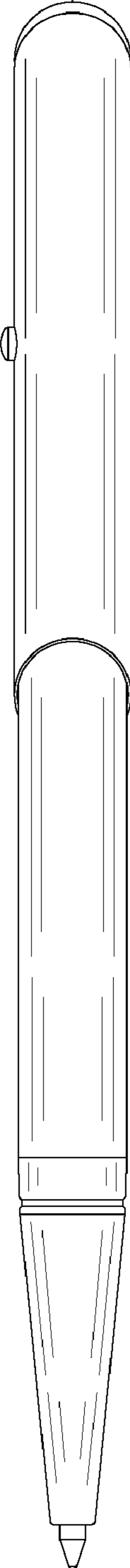




*Fig. 5.*



*Fig. 6.*



*Fig. 7.*