



US00D600819S

(12) **United States Design Patent**
Walsh et al.

(10) **Patent No.:** **US D600,819 S**
(45) **Date of Patent:** **** Sep. 22, 2009**

(54) **DOOR FACING**

(75) Inventors: **Jason M. Walsh**, Batavia, IL (US);
Steven K. Lynch, St. Charles, IL (US);
Mark A. Ruggie, Franklin Park, IL (US)

(73) Assignee: **Masonite Corporation**, Tampa, FL (US)

(**) Term: **14 Years**

(21) Appl. No.: **29/287,145**

(22) Filed: **Jul. 2, 2007**

(51) **LOC (9) Cl.** **25-02**

(52) **U.S. Cl.** **D25/48; D25/138**

(58) **Field of Classification Search** D25/48,
D25/49, 138; 52/455, 456, 311, 311.2, 764,
52/784.1, 630, 311.3, 782.1, 313, 457, 458,
52/474, 475.1, 778, 507, 779; 428/45; 49/504,
49/501

See application file for complete search history.

(56) **References Cited**

U.S. PATENT DOCUMENTS

| | | | | |
|----------------|---------|-------------------|-------|----------|
| D382,350 S * | 8/1997 | Lynch | | D25/138 |
| D411,022 S * | 6/1999 | Schafernak et al. | | D25/150 |
| D529,625 S * | 10/2006 | Walsh et al. | | D25/48 |
| D530,431 S * | 10/2006 | Walsh et al. | | D25/48 |
| 7,185,468 B2 * | 3/2007 | Clark et al. | | 52/794.1 |
| D551,776 S * | 9/2007 | Hackett et al. | | D25/48 |
| D576,314 S * | 9/2008 | Mock et al. | | D25/138 |
| D576,315 S * | 9/2008 | Mock et al. | | D25/138 |

* cited by examiner

Primary Examiner—T. Chase Nelson

Assistant Examiner—Michael A Pratt

(74) *Attorney, Agent, or Firm*—Berenato, White & Stavish, LLC

(57) **CLAIM**

The ornamental design for a door facing, as shown and described.

DESCRIPTION

FIG. 1 is a front perspective view of our design;

FIG. 2 is a front elevational view thereof, with the rear elevational view being a mirror image thereof;

FIG. 3 is a top plan view;

FIG. 4 is a bottom plan view;

FIG. 5 is a cross-sectional view taken along the line 5—5 of FIG. 2 and viewed in the direction of the arrows;

FIG. 6 is a significantly enlarged cross-sectional view of the ovalo of FIG. 5;

FIG. 7 is a left side elevational view;

FIG. 8 is a right side elevational view; and,

FIG. 9 is a cross-sectional view taken along the line 9—9 of FIG. 2 and viewed in the direction of the arrows.

In order to allow for a detailed depiction of the claimed design, the views of FIGS. 7 through 9 are split in the center to allow for significant enlargement. The broken lines in these views indicate how the split portions are connected and forms no part of the claimed design.

1 Claim, 4 Drawing Sheets

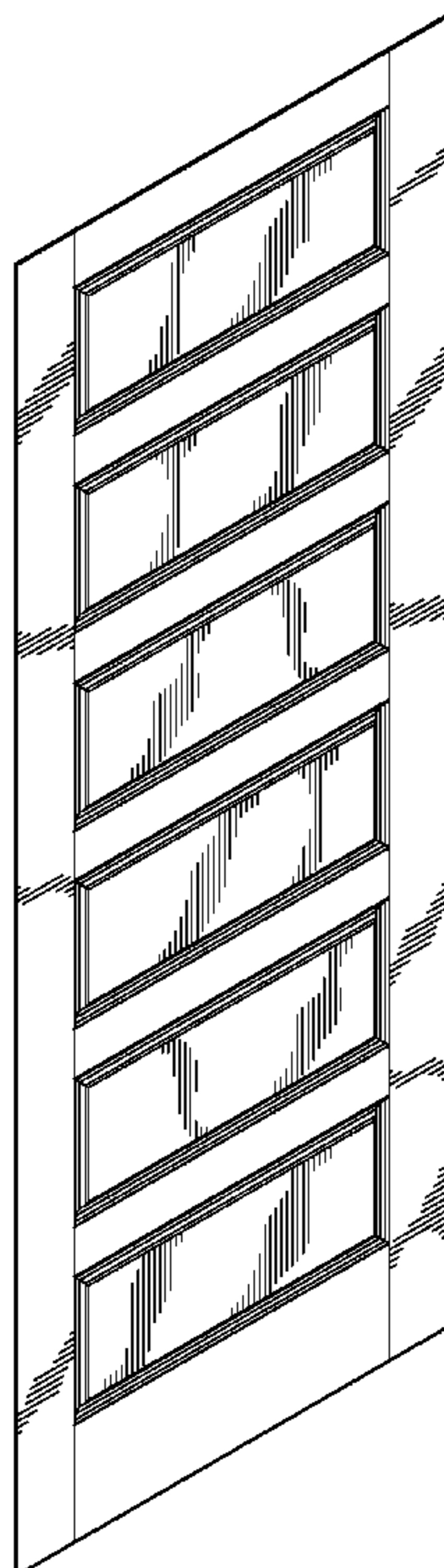

Fig. 1

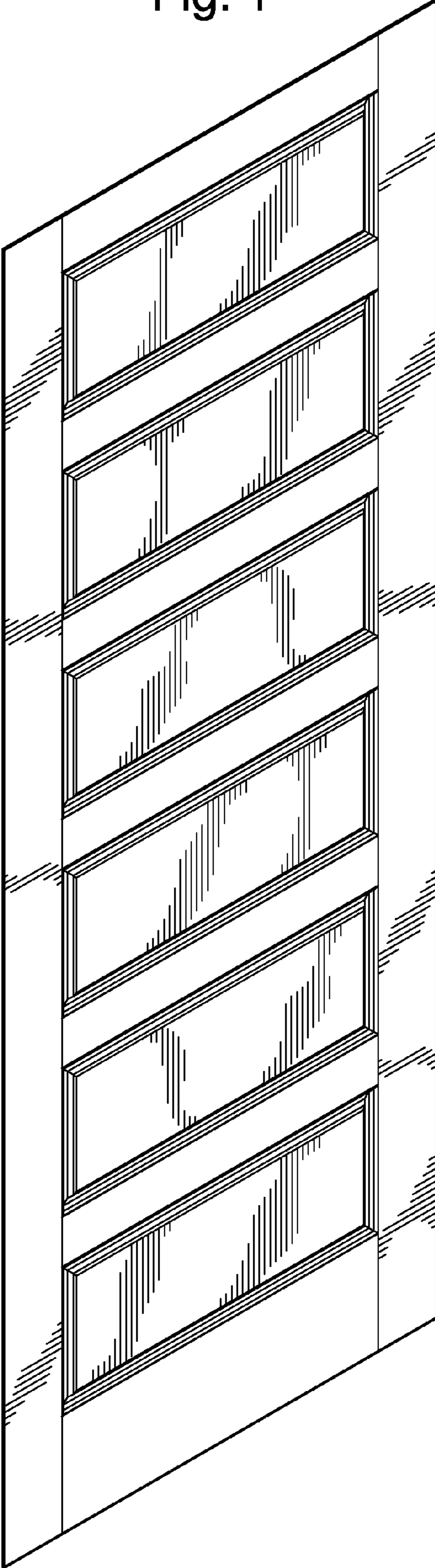

Fig. 2

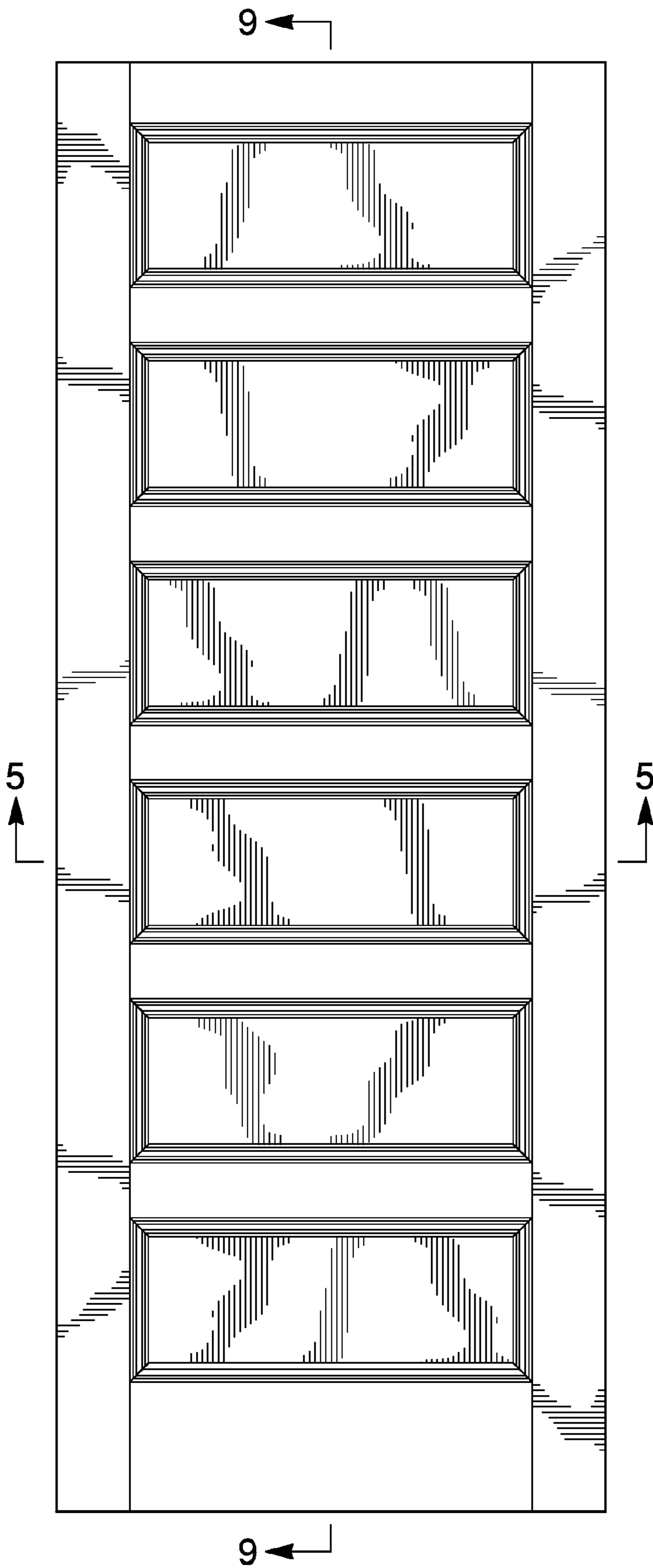

Fig. 3

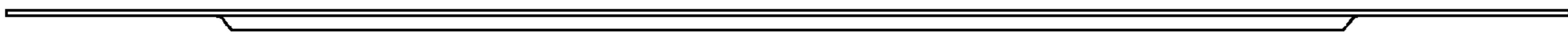

Fig. 4

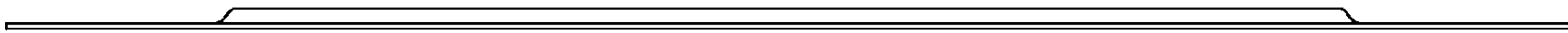

Fig. 5

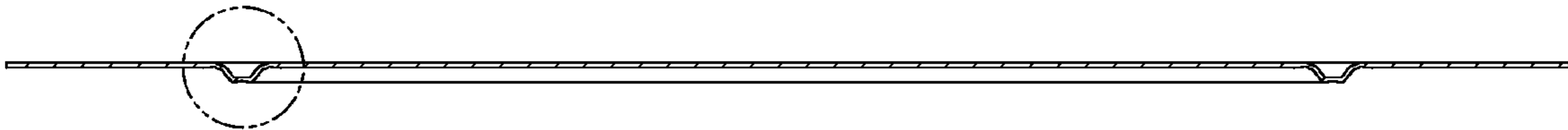

Fig. 6

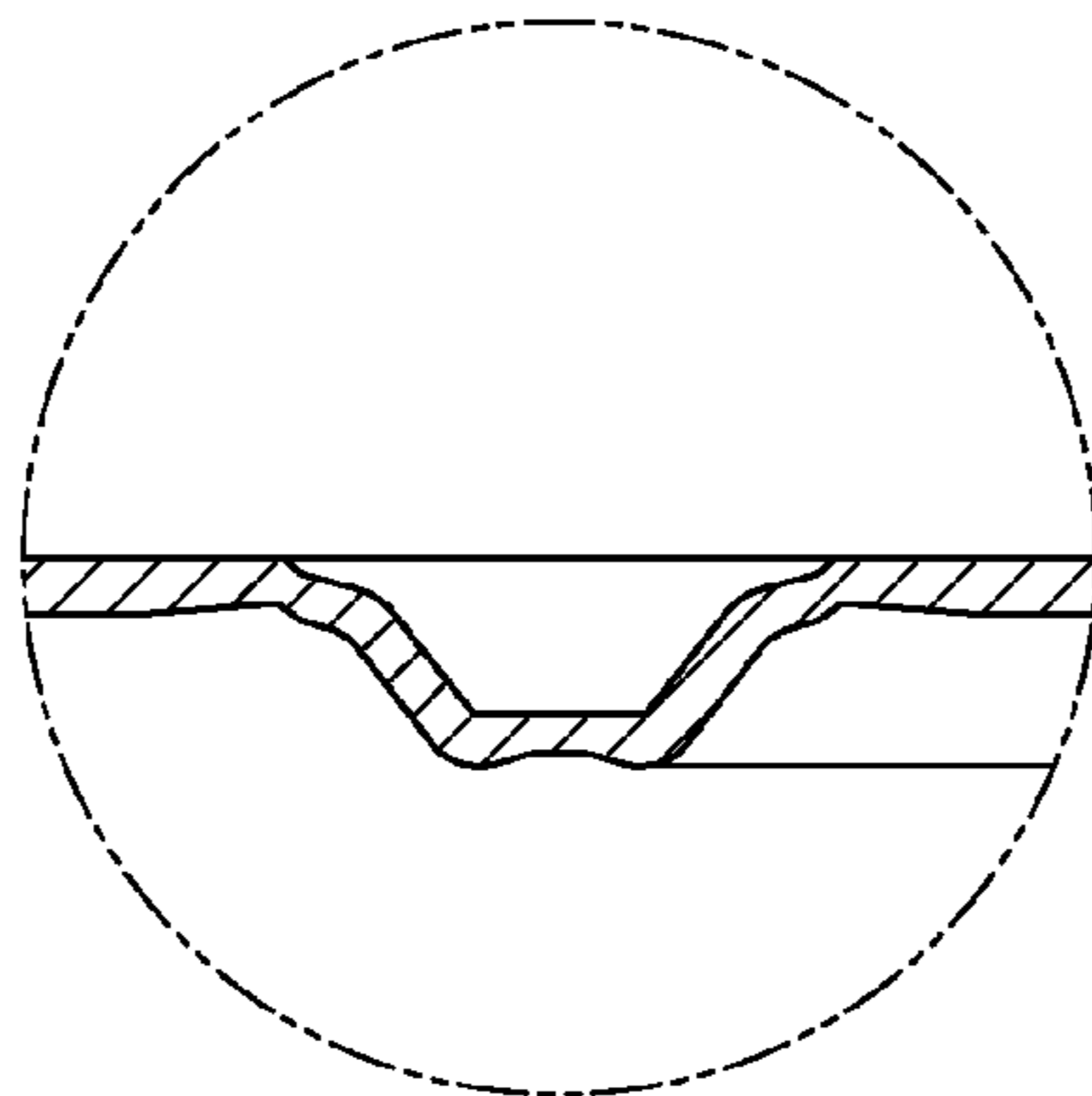

Fig. 7

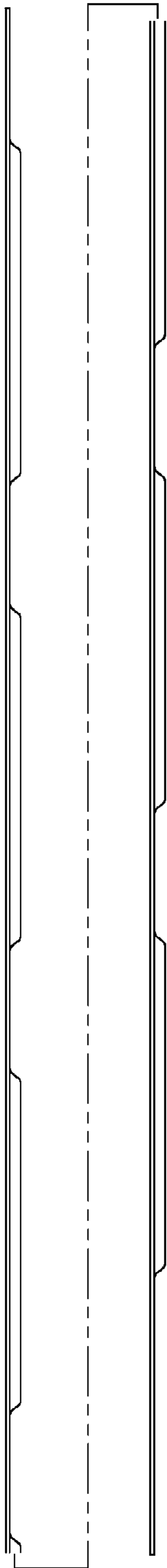

Fig. 8

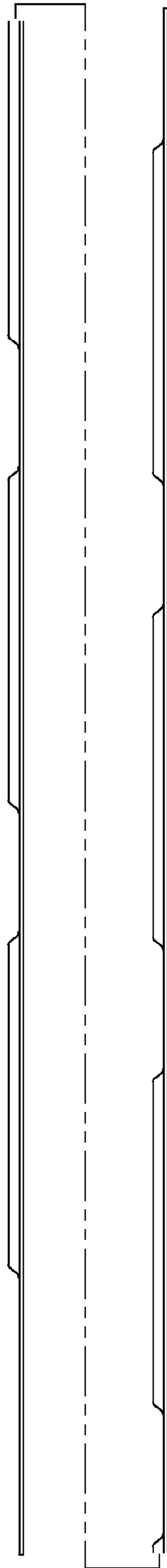

Fig. 9

