



US00D600517S

(12) **United States Design Patent**
Tinius

(10) **Patent No.:** **US D600,517 S**

(45) **Date of Patent:** **** Sep. 22, 2009**

(54) **BRANCH CLIPPING MACHINE**

(75) Inventor: **Michael Tinius**, Ulm (DE)

(73) Assignee: **Andreas Stihl AG & Co. KG**,
Waiblingen (DE)

(**) Term: **14 Years**

(21) Appl. No.: **29/321,074**

(22) Filed: **Jul. 10, 2008**

(30) **Foreign Application Priority Data**

Jan. 11, 2008 (EM) 000859095-0004

(51) **LOC (9) Cl.** **08-01**

(52) **U.S. Cl.** **D8/8**

(58) **Field of Classification Search** D8/7,
D8/8; 56/12.7; 30/276

See application file for complete search history.

(56) **References Cited**

U.S. PATENT DOCUMENTS

- D324,051 S * 2/1992 Tuggle et al. D15/1
- D342,875 S * 1/1994 Franke et al. D8/8
- D355,198 S * 2/1995 Kikuchi D15/1
- D355,818 S * 2/1995 Nakadachi D8/8
- D358,308 S * 5/1995 Griffin D8/8
- D360,341 S * 7/1995 Hirooka et al. D8/8
- D361,336 S * 8/1995 Tinius D15/1
- 5,855,069 A * 1/1999 Matsubayashi et al. 30/276
- 6,065,214 A * 5/2000 Nagashima 30/276
- 6,125,547 A * 10/2000 Nagashima 30/276
- D446,699 S * 8/2001 Marshall et al. D8/8
- D457,925 S * 5/2002 Grafton D21/532
- 6,508,004 B2 * 1/2003 Tezuka et al. 30/276
- 6,918,451 B2 * 7/2005 Nagashima et al. 173/221
- D519,336 S * 4/2006 Ono et al. D8/8
- D530,163 S * 10/2006 Xue-Feng D8/8
- D551,921 S * 10/2007 Houghton D8/8

- D563,740 S * 3/2008 Andriolo D8/8
- 7,395,601 B2 * 7/2008 Berfield 30/276
- D578,842 S * 10/2008 Houghton D8/8
- D580,237 S * 11/2008 Bradford D8/8
- D580,719 S * 11/2008 Baxter D8/8
- D582,224 S * 12/2008 Bochmann et al. D8/8

* cited by examiner

Primary Examiner—Holly H Baynham

Assistant Examiner—Sheryl Lane

(74) *Attorney, Agent, or Firm*—McGuireWoods LLP

(57) **CLAIM**

I claim the ornamental design for a branch clipping machine, as shown and described.

DESCRIPTION

FIG. 1 is a left perspective view of the branch clipping machine;

FIG. 2 is a right side partial view of the branch clipping machine shown in FIG. 1;

FIG. 3 is a left side partial view of the branch clipping machine shown in FIG. 1;

FIG. 4 is a bottom view of the branch clipping machine shown in FIG. 1;

FIG. 5 is a top partial view of the branch clipping machine shown in FIG. 1

FIG. 6 is a rear view of the branch clipping machine shown in FIG. 1; and,

FIG. 7 is a top partial view of the branch clipping machine shown in FIG. 1.

Any surfaces of the design not shown, including interior surfaces, form no part of the claimed invention.

The clipping machine is shown fragmented for ease and clarity of illustration.

1 Claim, 7 Drawing Sheets

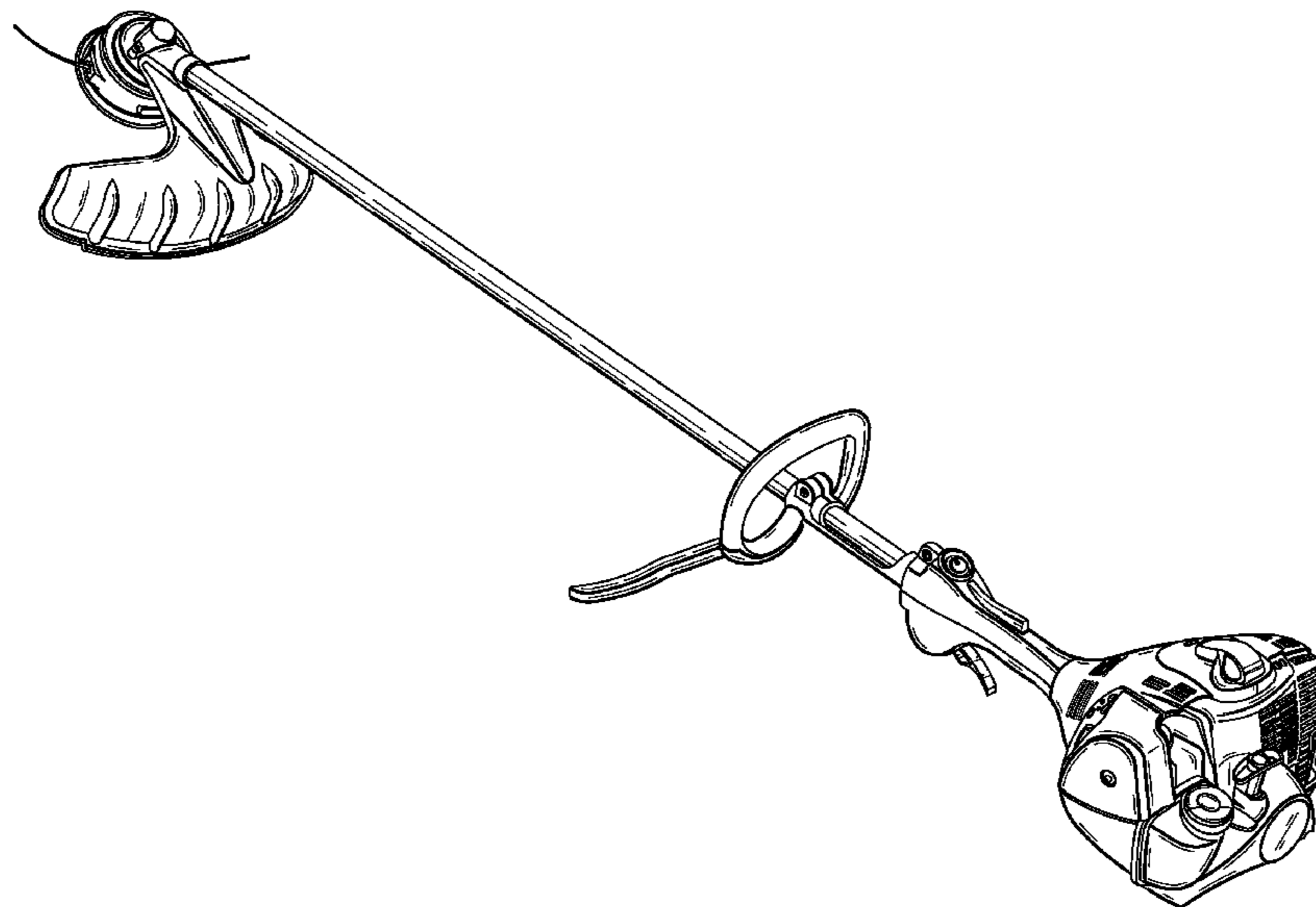

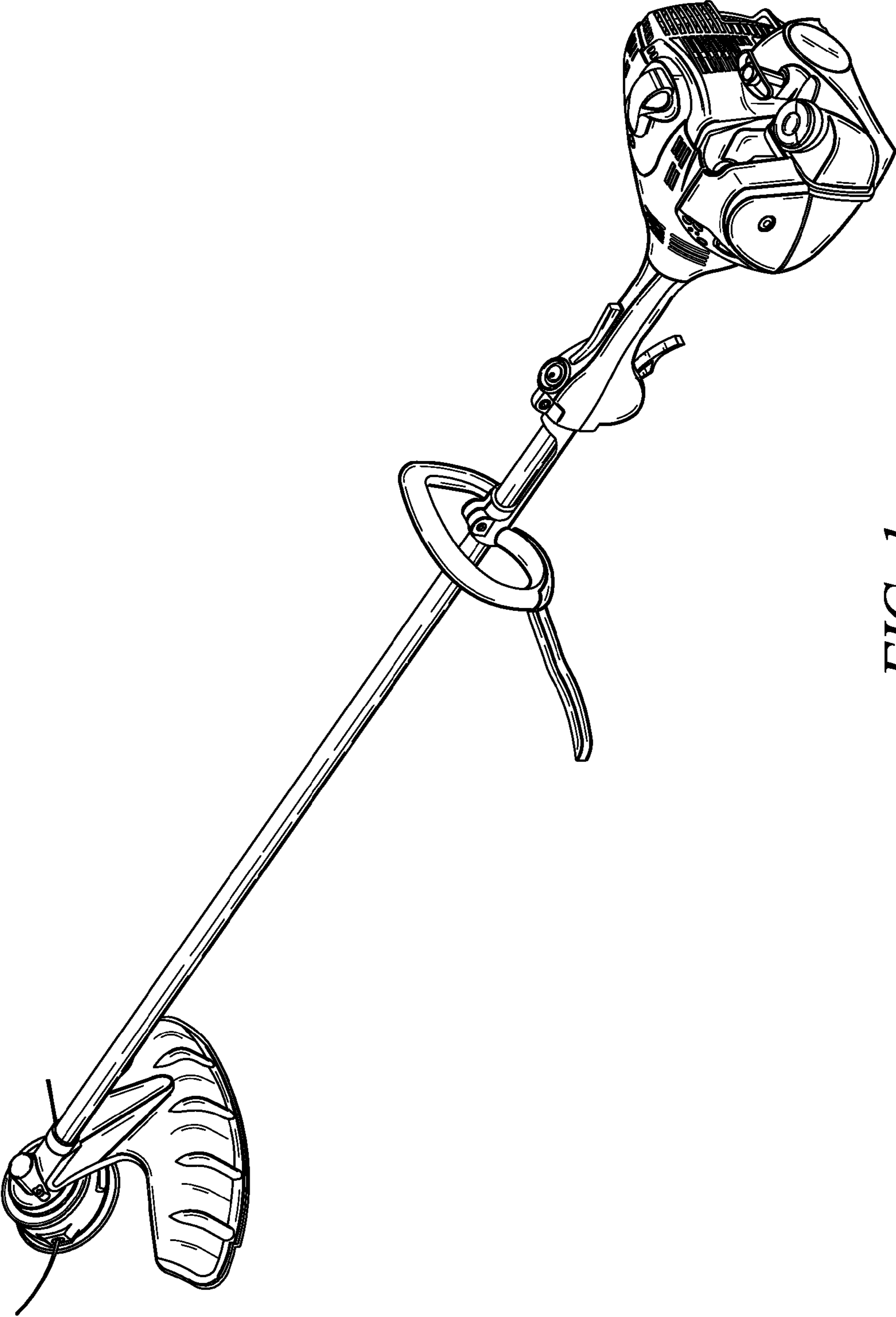

FIG. 1

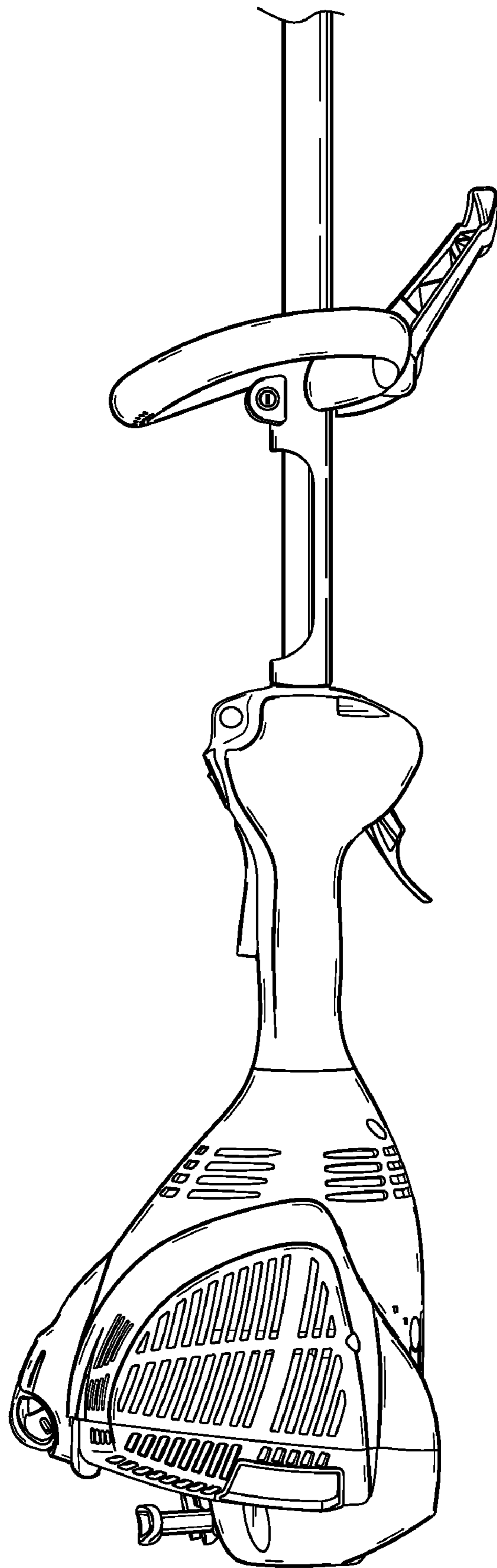

FIG. 2

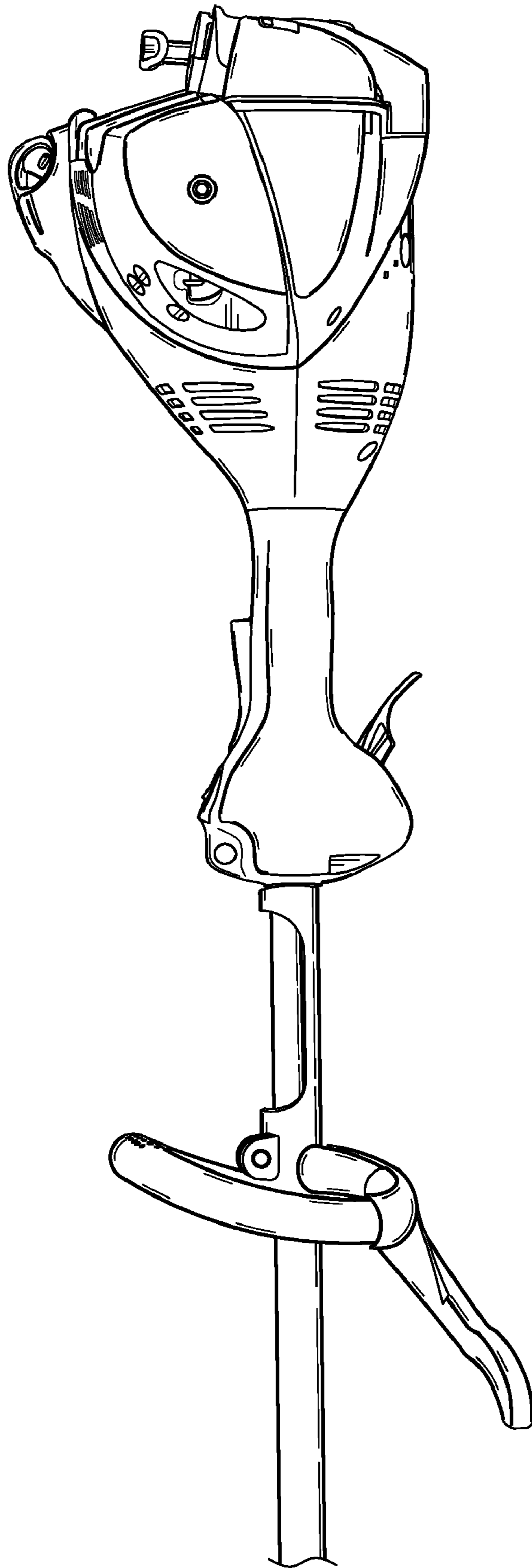

FIG. 3

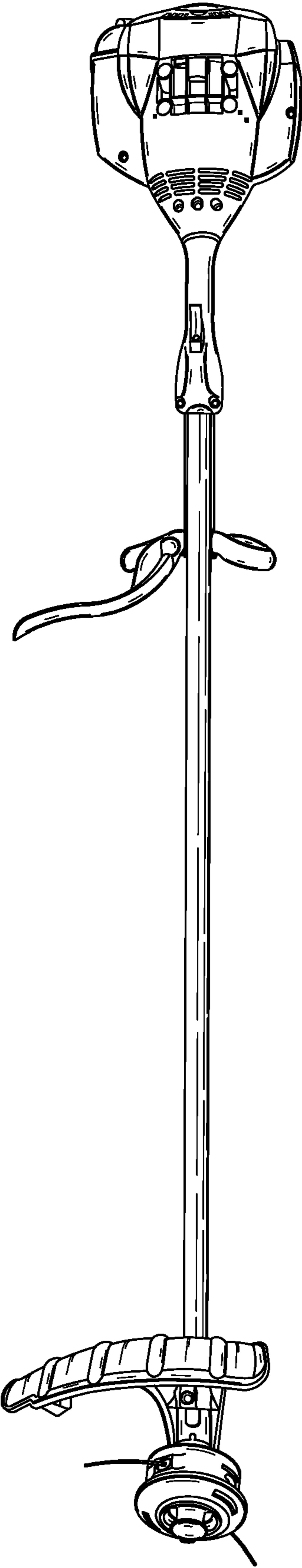

FIG. 4

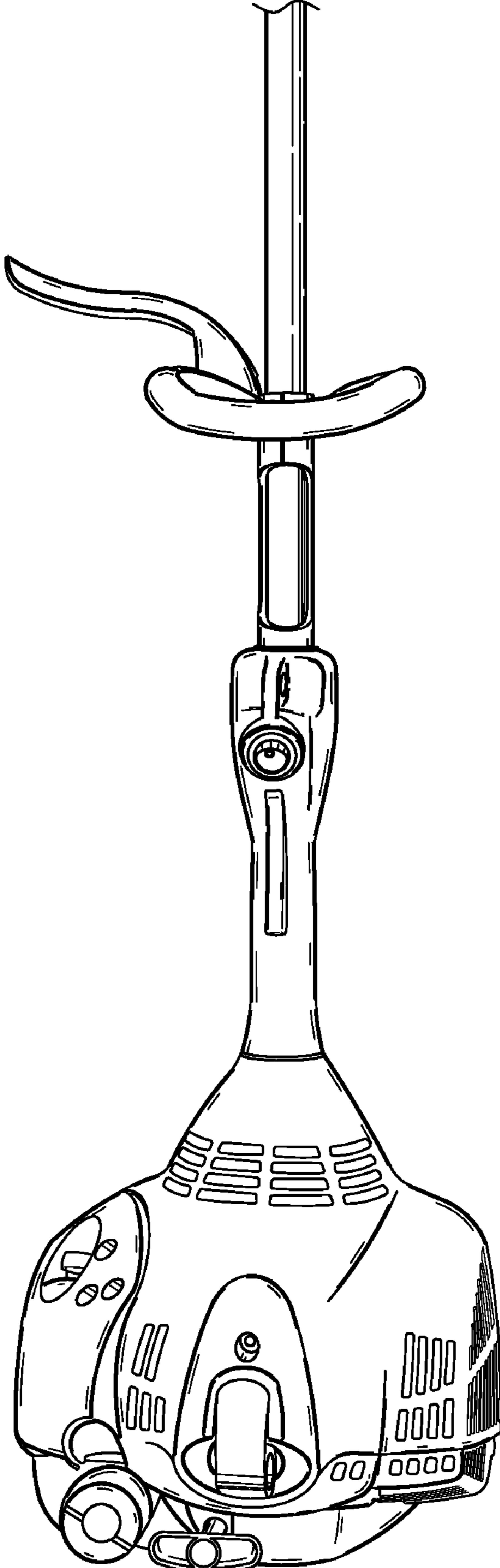

FIG. 5

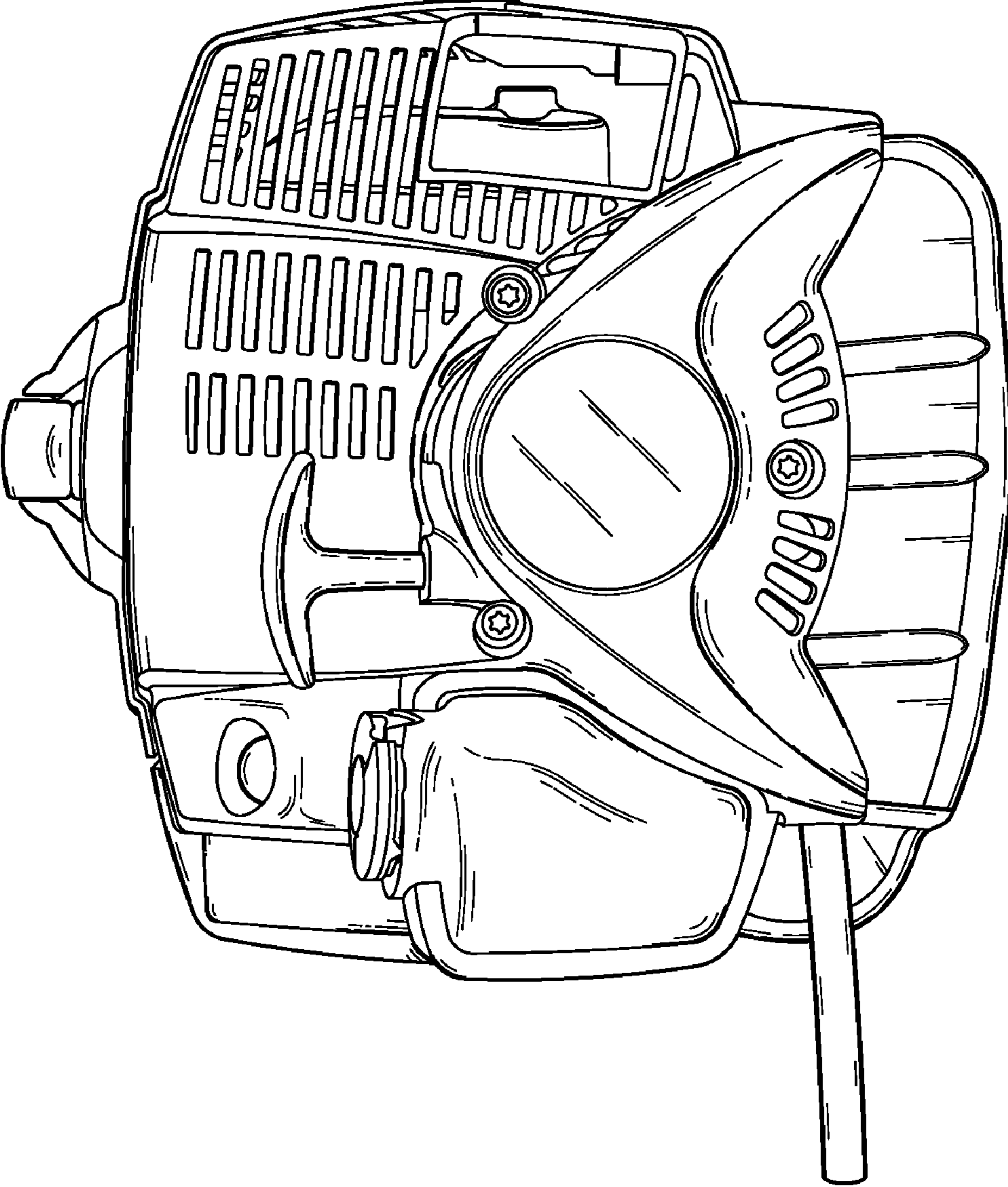

FIG. 6

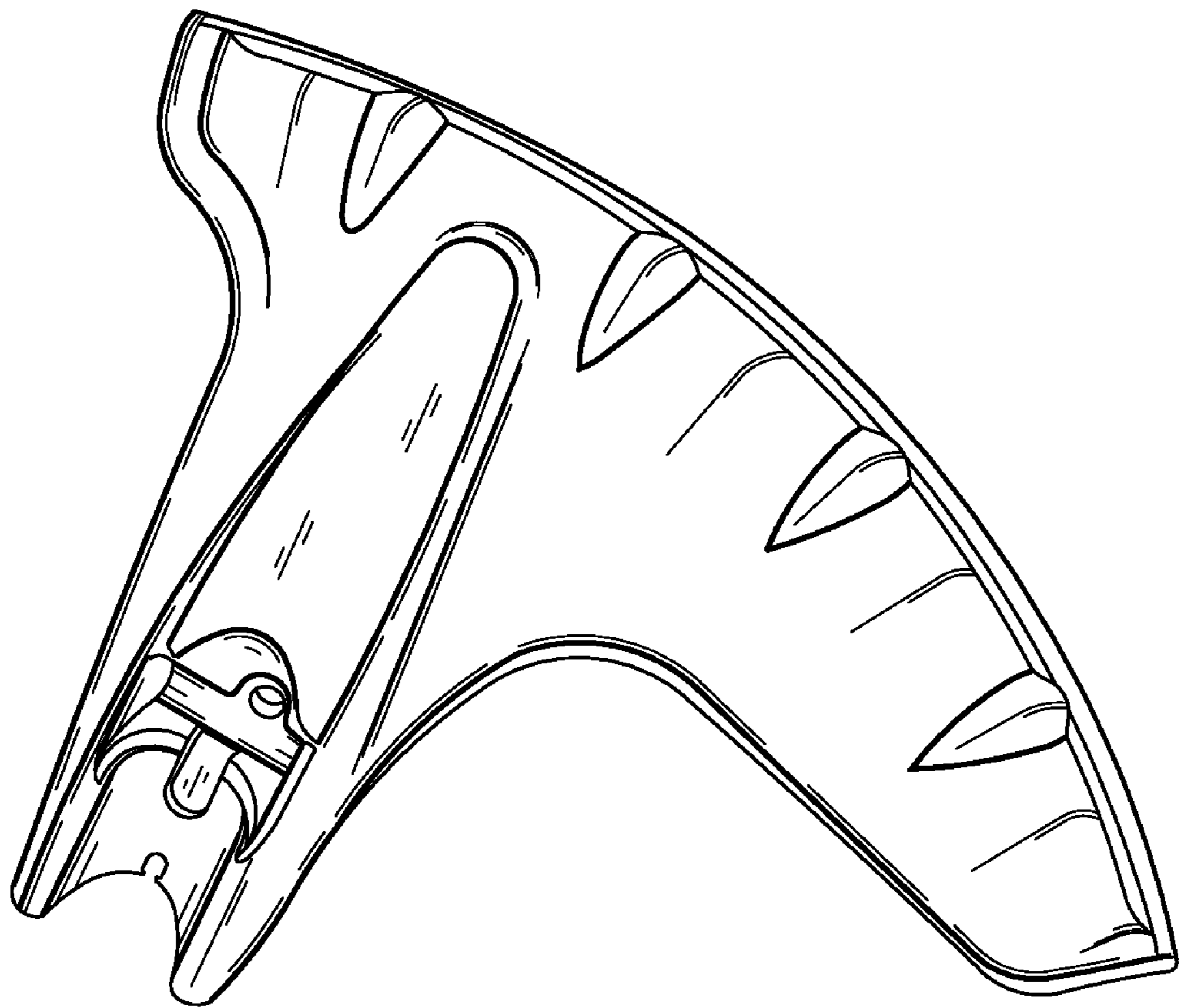

FIG. 7