



US00D599323S

(12) **United States Design Patent**
Petersen

(10) **Patent No.:** **US D599,323 S**

(45) **Date of Patent:** **** Sep. 1, 2009**

(54) **ELECTRONIC KEY LOCATOR SET**

D535,971 S * 1/2007 Andrade et al. D14/155

(75) Inventor: **Christopher M. Petersen**, Milford, NH
(US)

OTHER PUBLICATIONS

(73) Assignee: **Brookstone Purchasing, Inc.**,
Merrimack, NH (US)

“SmartFinder Locator—Key Finder Wireless Gadgets”, I-Love-Gadgets.com, <<http://www.i-love-gadgets.com/smartfinder-locator-key-finder-wireless-gadgets.html>>, dated Oct. 12, 2008, (accessed Apr. 9, 2009), 1pg.*

(**) Term: **14 Years**

* cited by examiner

(21) Appl. No.: **29/312,390**

Primary Examiner—Stella M Reid

Assistant Examiner—Keli L Hill

(22) Filed: **Oct. 17, 2008**

(74) *Attorney, Agent, or Firm*—Grossman Tucker Perreault & Pflieger

(51) **LOC (9) Cl.** **14-01**

(52) **U.S. Cl.** **D14/191**

(58) **Field of Classification Search** D14/137,
D14/155, 159, 191–193, 299, 496; D10/106;
340/7.1, 7.2–7.28, 7.63, 539.13–539.15;
380/31–34, 270, 271; 455/3.01–3.05, 90.1–90.3,
455/95, 128, 347, 351

(57) **CLAIM**

The ornamental design for an electronic key locator set, as shown and described.

See application file for complete search history.

DESCRIPTION

FIG. 1 is a front perspective view of an electronic key ring locator set embodying my new design, showing a control unit and two key ring fobs.

(56) **References Cited**

U.S. PATENT DOCUMENTS

D304,944 S	*	12/1989	Behringer	D14/188
D384,667 S	*	10/1997	Kokkinis	D14/194
D401,239 S	*	11/1998	Delong	D14/191
D405,793 S	*	2/1999	Engelke et al.	D14/191
D423,010 S	*	4/2000	Wicks	D14/191
D423,510 S	*	4/2000	Pizarro et al.	D14/191
D427,099 S	*	6/2000	Hunter	D10/104
D476,588 S	*	7/2003	Lee	D10/104
D497,611 S	*	10/2004	Borsboom	D14/214
D506,741 S	*	6/2005	Juszkiewicz et al.	D14/167
D518,399 S	*	4/2006	Breslow	D10/109

FIG. 2 is a front elevation view thereof.

FIG. 3 is a rear elevation view thereof.

FIG. 4 is a right-side elevation view thereof.

FIG. 5 is a left-side elevation view thereof.

FIG. 6 is a top plan view thereof; and,

FIG. 7 is a bottom plan view thereof.

The broken lines shown on the drawings are for illustrative purposes only and form no part of the claimed design.

1 Claim, 5 Drawing Sheets

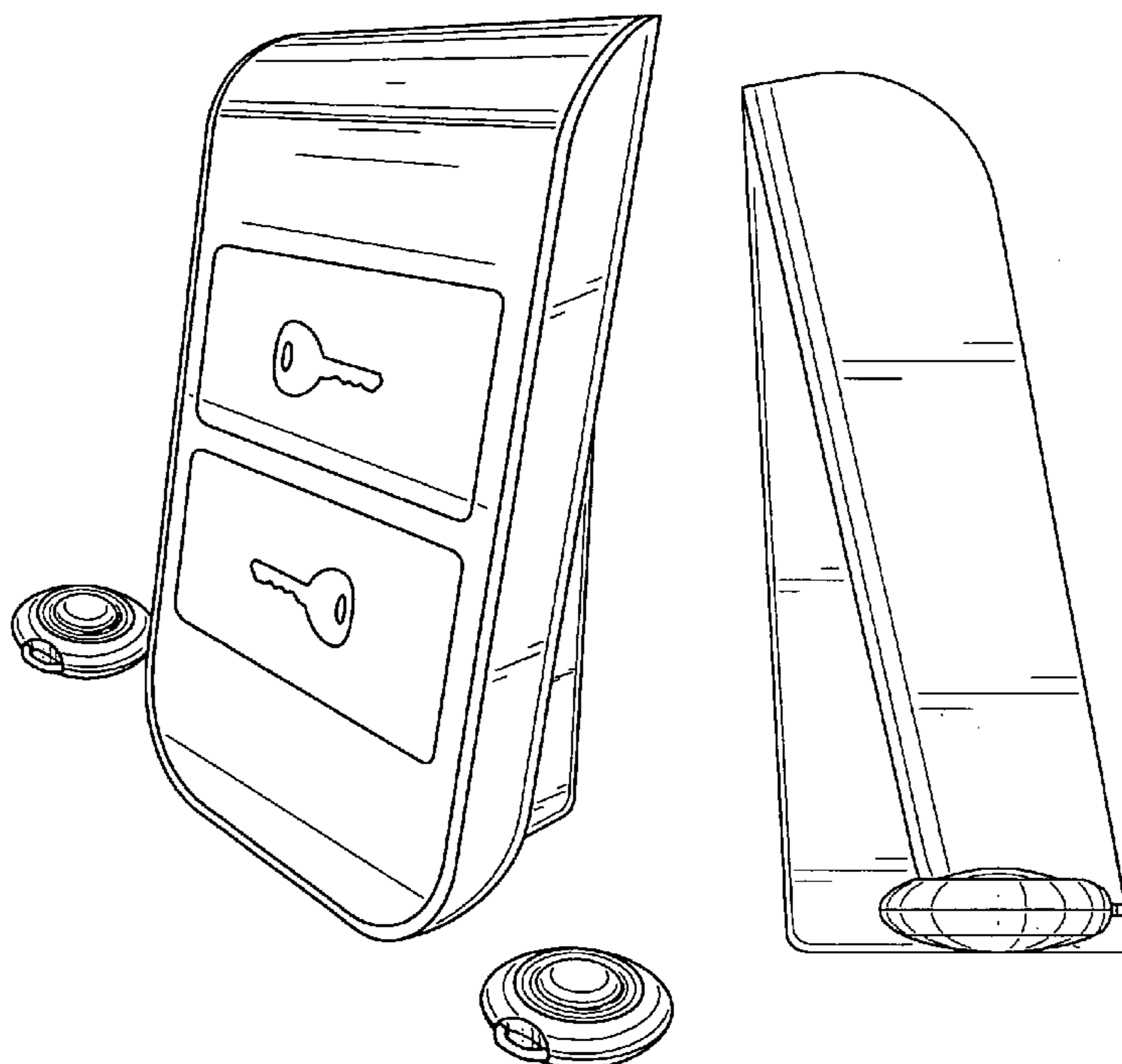

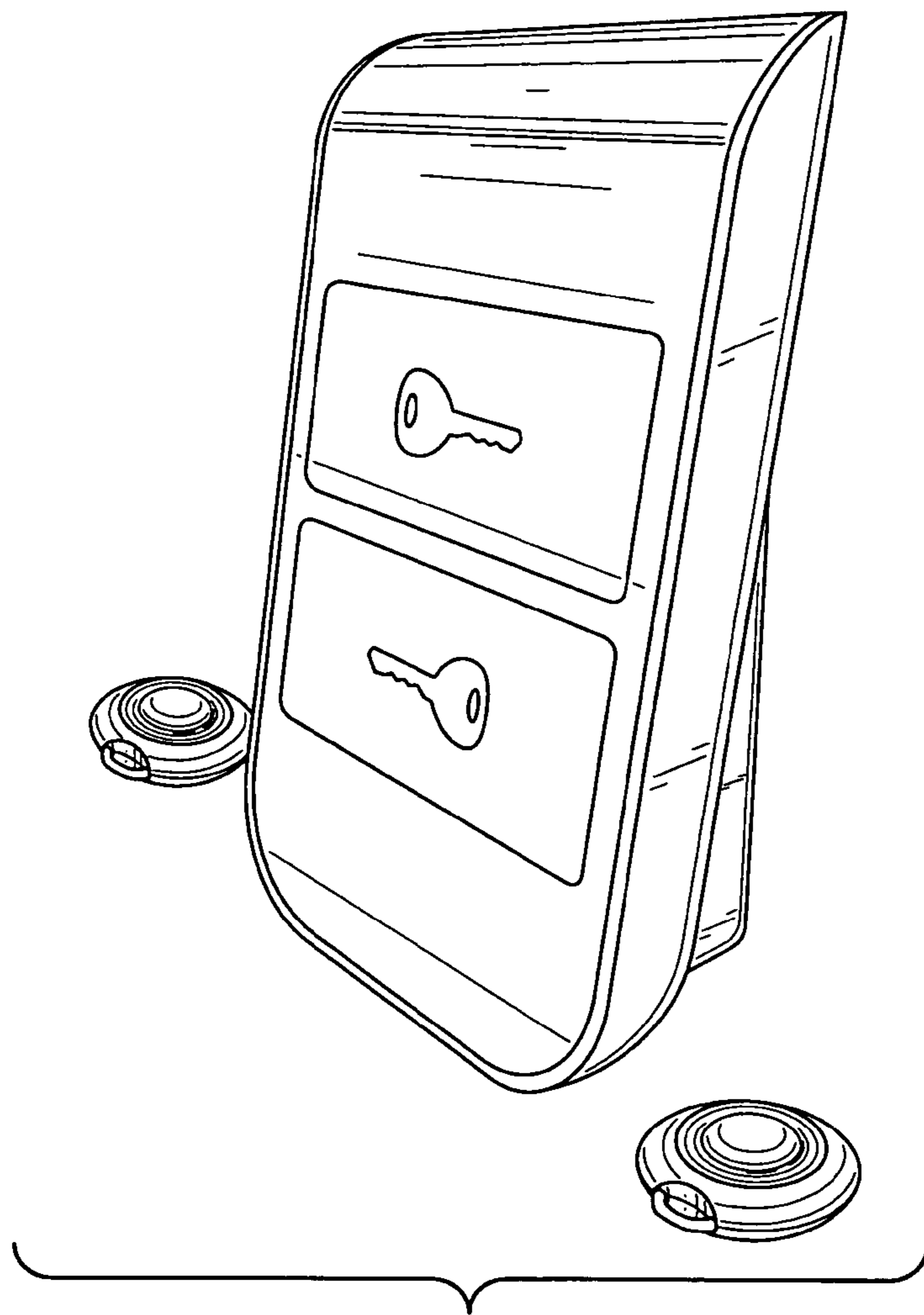

FIG. 1

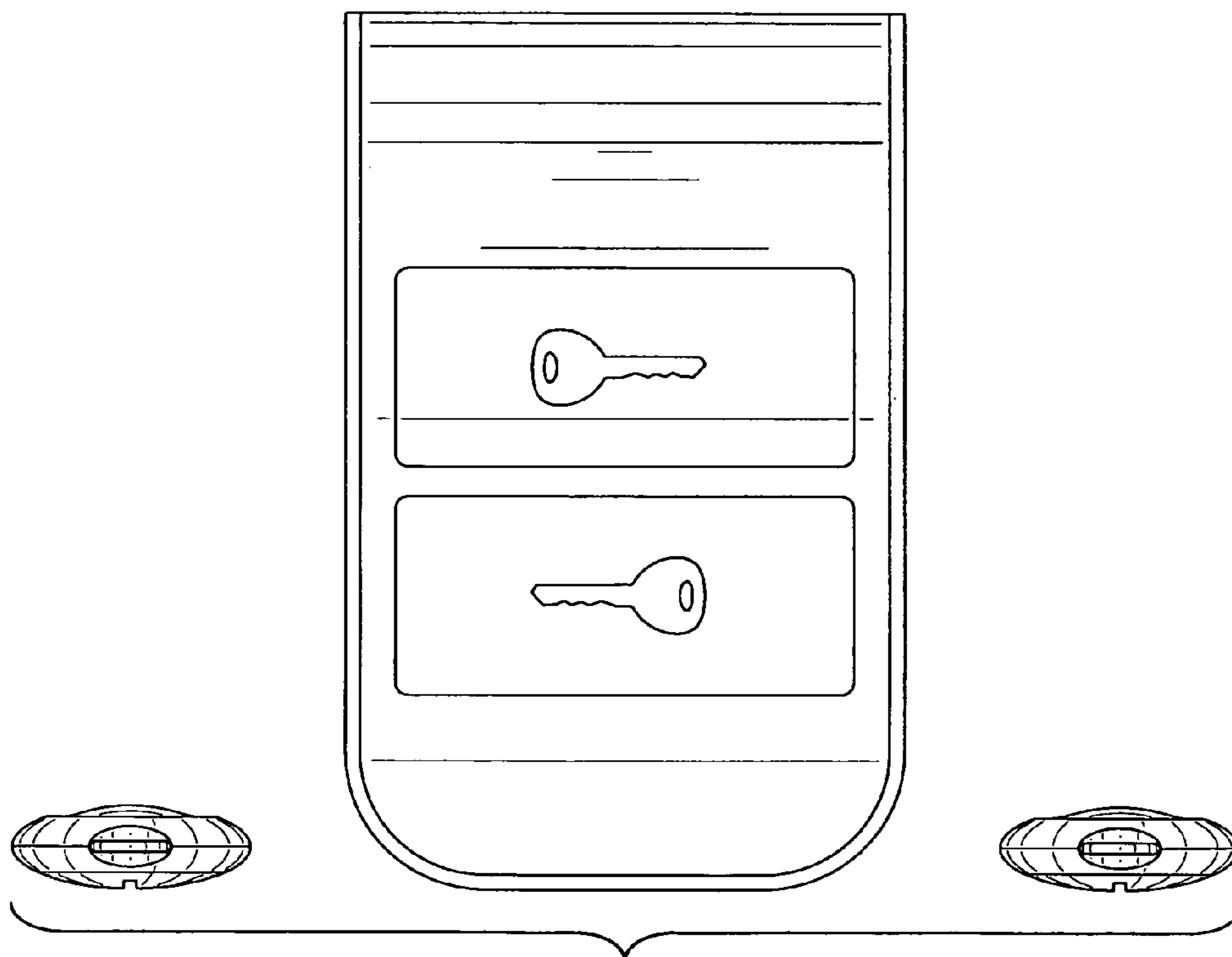

FIG. 2

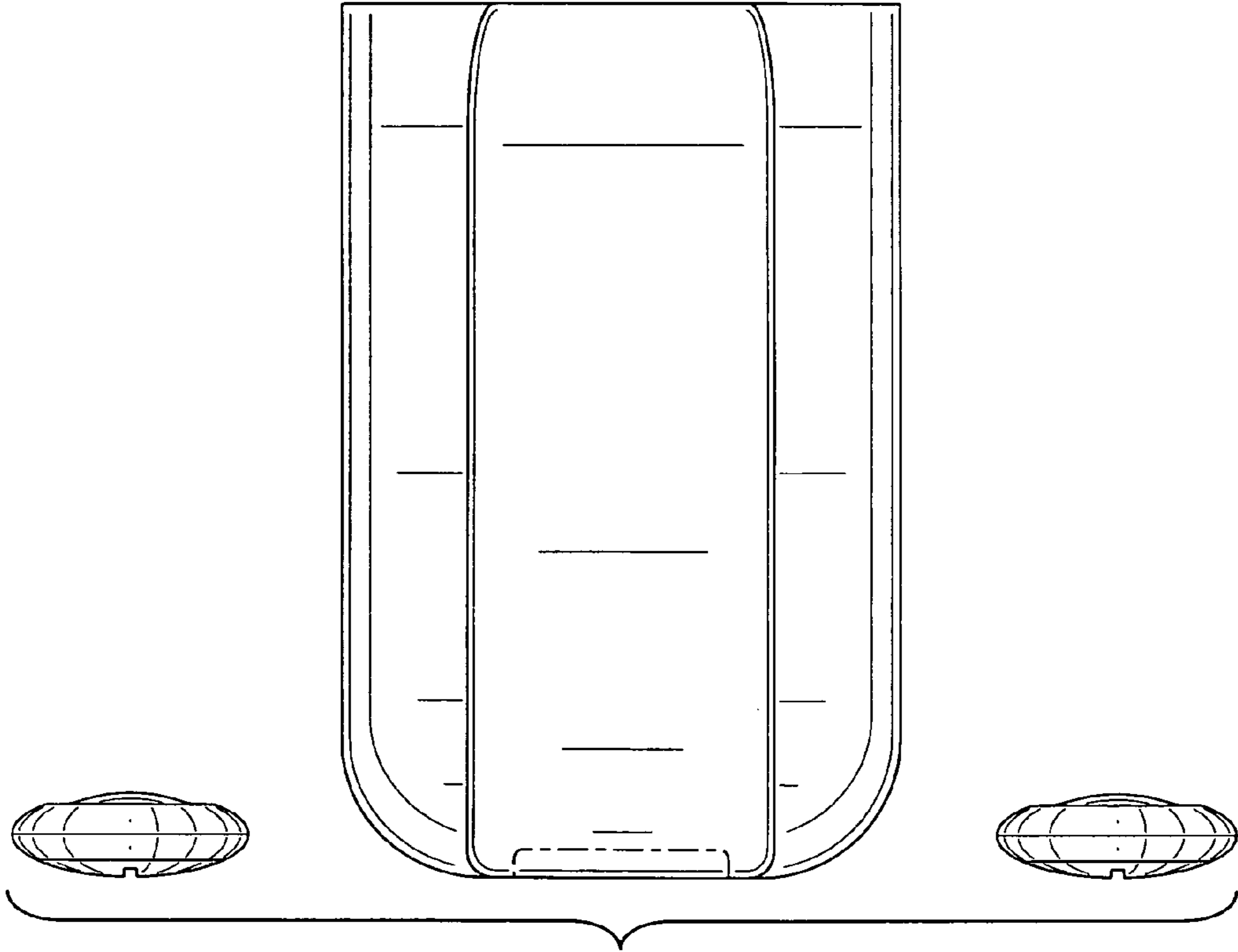

FIG. 3

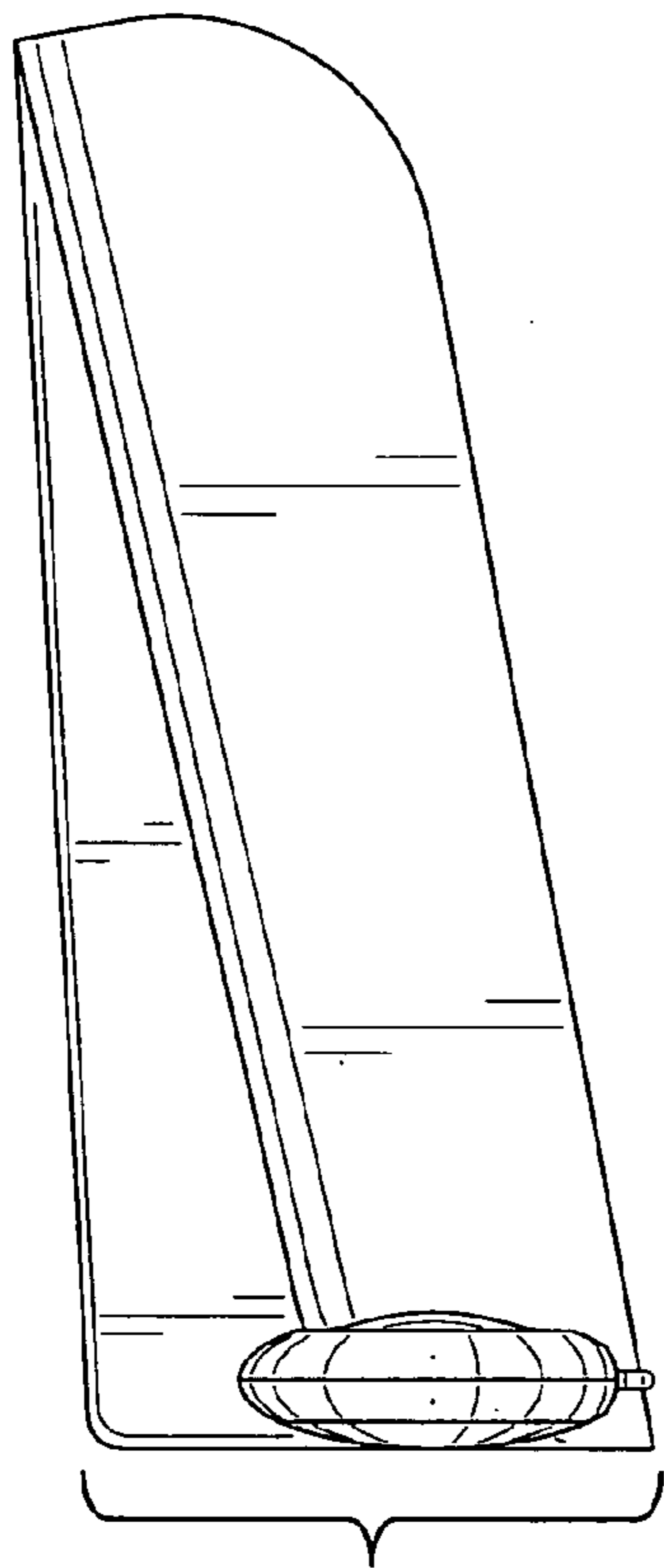

FIG. 4

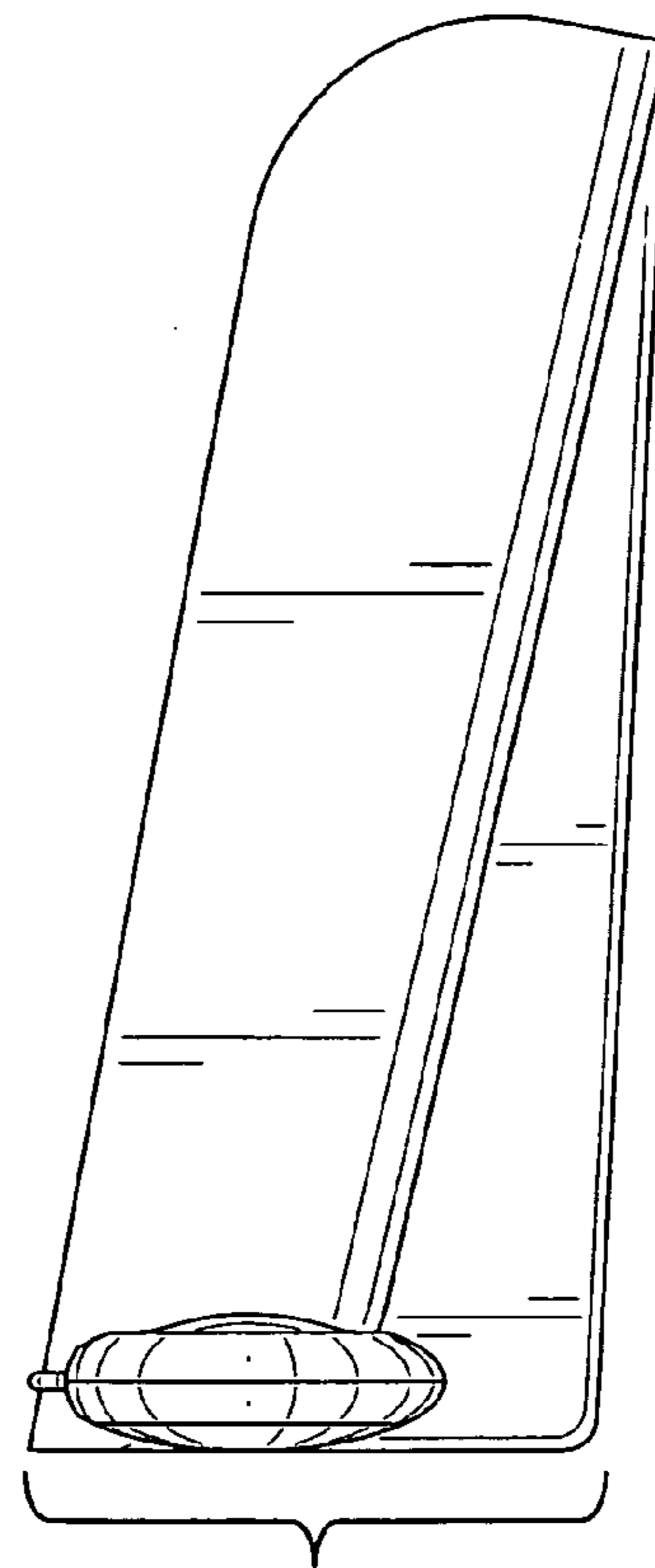

FIG. 5

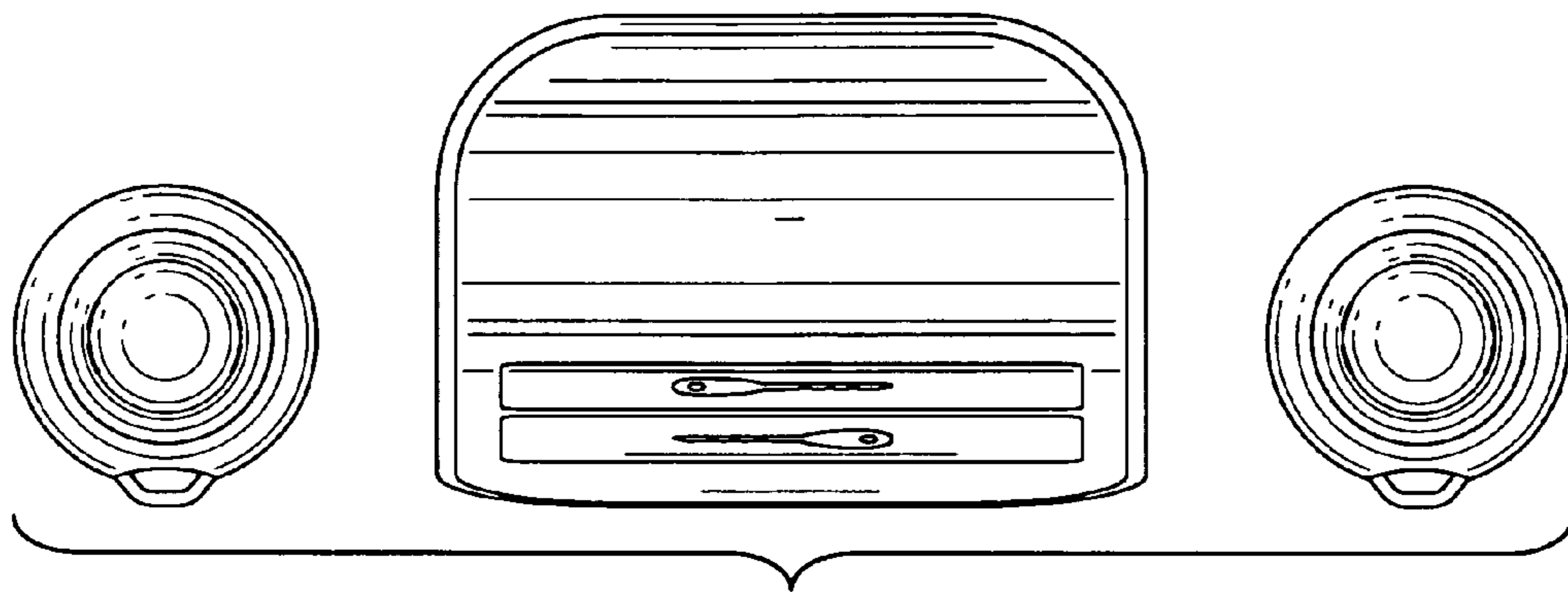

FIG. 6

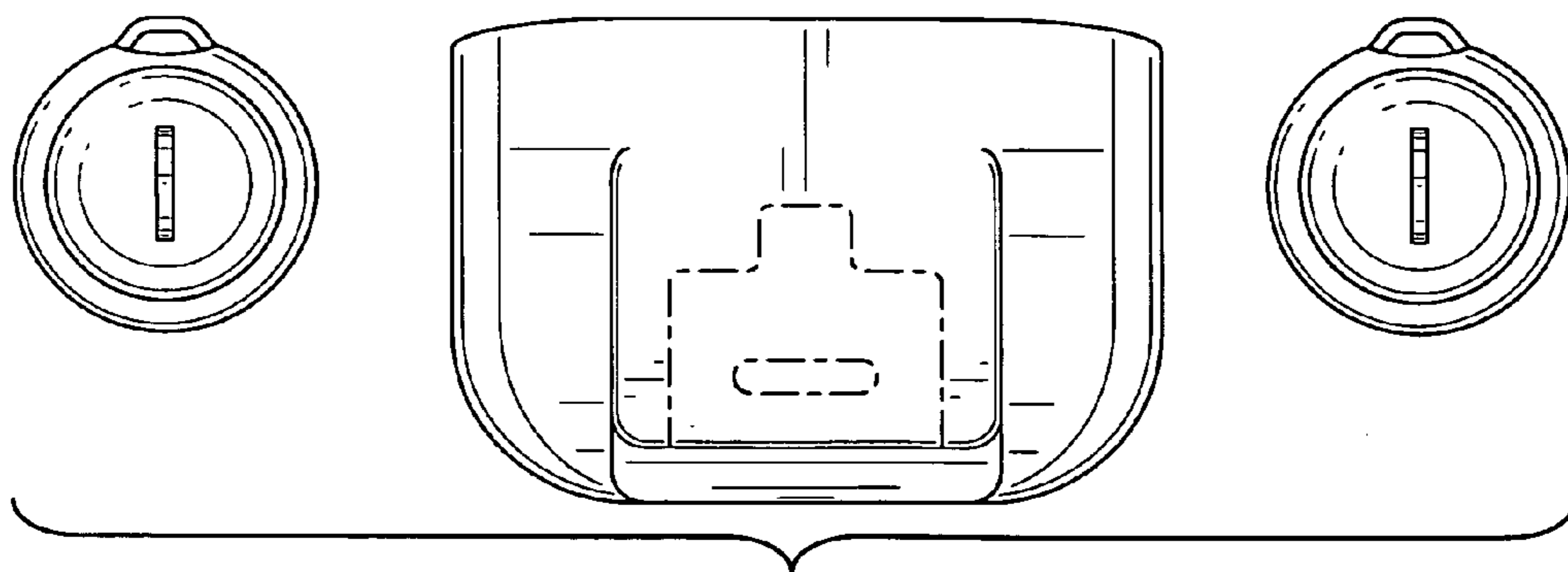

FIG. 7