



US00D598724S

(12) **United States Design Patent**  
**Hsieh**

(10) **Patent No.:** **US D598,724 S**

(45) **Date of Patent:** **\*\* Aug. 25, 2009**

(54) **CHISEL**

2008/0244913 A1\* 10/2008 Lin ..... 30/167

(76) Inventor: **San-Long Hsieh**, No. 72, Chaoguei Rd.,  
Situn District, Taichung City 407 (TW)

\* cited by examiner

*Primary Examiner*—Philip S Hyder

(74) *Attorney, Agent, or Firm*—Banger Shia

(\*\*) Term: **14 Years**

(21) Appl. No.: **29/324,140**

(57) **CLAIM**

(22) Filed: **Sep. 6, 2008**

I claim the ornamental design for a chisel, as shown and described.

(51) **LOC (9) Cl.** ..... **08-05**

(52) **U.S. Cl.** ..... **D8/47**

(58) **Field of Classification Search** ..... D8/14,  
D8/45, 47, 107, 303; D32/46, 49; 30/167,  
30/167.1, 169; 81/489; D7/395; 16/422  
See application file for complete search history.

**DESCRIPTION**

FIG. 1 is a perspective view of a chisel, showing my new design;

FIG. 2 is a front elevational view thereof;

FIG. 3 is a rear elevational view thereof;

FIG. 4 is a left side elevational view thereof;

FIG. 5 is a right side elevational view thereof;

FIG. 6 is a top plan view thereof; and

FIG. 7 is a bottom plan view thereof; and,

FIG. 8 is another perspective view of the chisel wherein the broken line showing of the bit is for environmental purposes only and forms no part of the claimed design.

(56) **References Cited**

U.S. PATENT DOCUMENTS

D237,037	S	*	10/1975	Brunosson	.....	D8/47
4,624,323	A	*	11/1986	Burrola	.....	173/90
D402,179	S	*	12/1998	Scott	.....	D8/107
D421,890	S	*	3/2000	Alexander et al.	.....	D14/203.7
6,578,457	B2	*	6/2003	Eichhorn	.....	82/160
D492,178	S	*	6/2004	Wright et al.	.....	D8/70
D494,824	S	*	8/2004	Hernandez	.....	D8/47
D554,455	S	*	11/2007	Ranieri	.....	D8/47

**1 Claim, 8 Drawing Sheets**

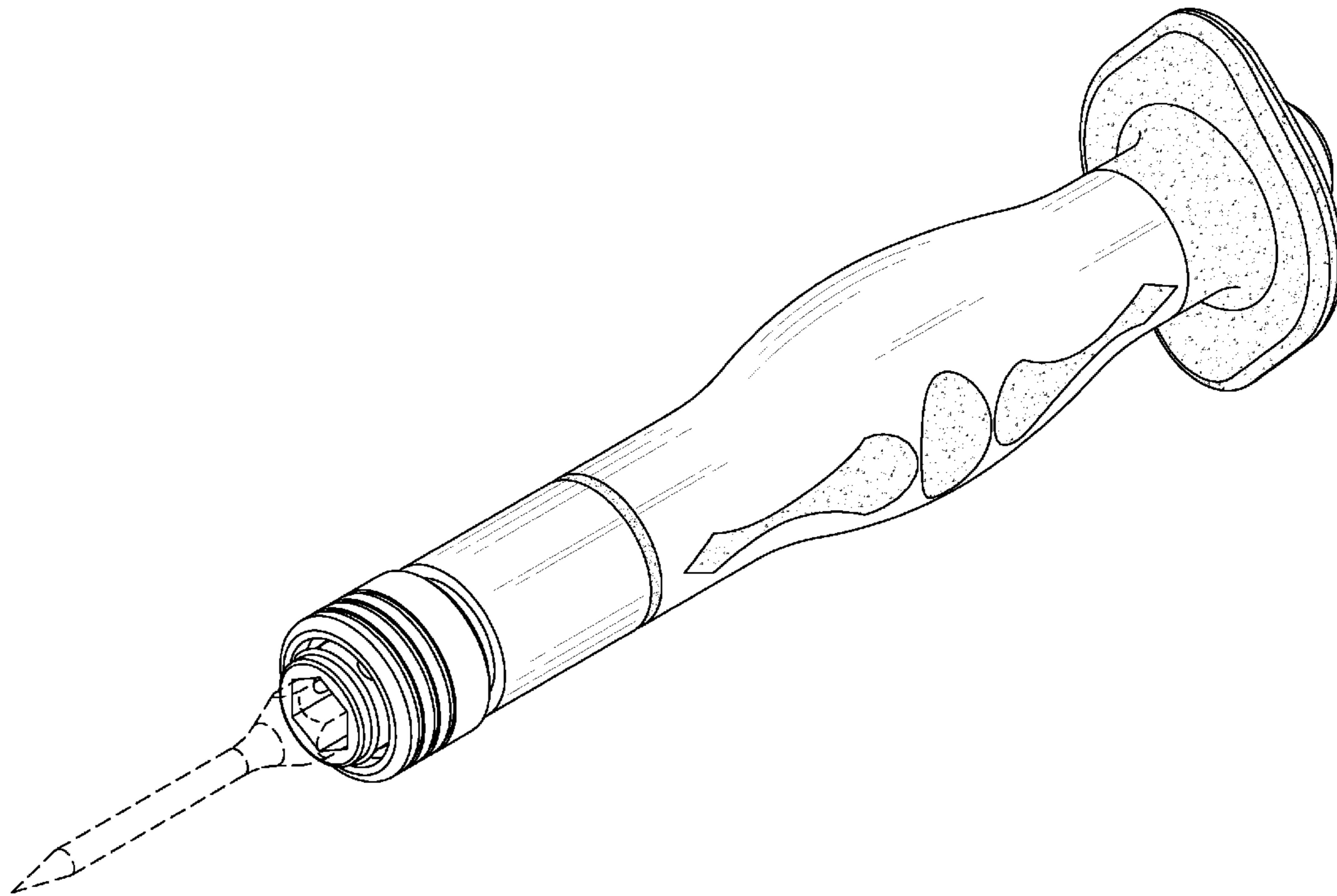

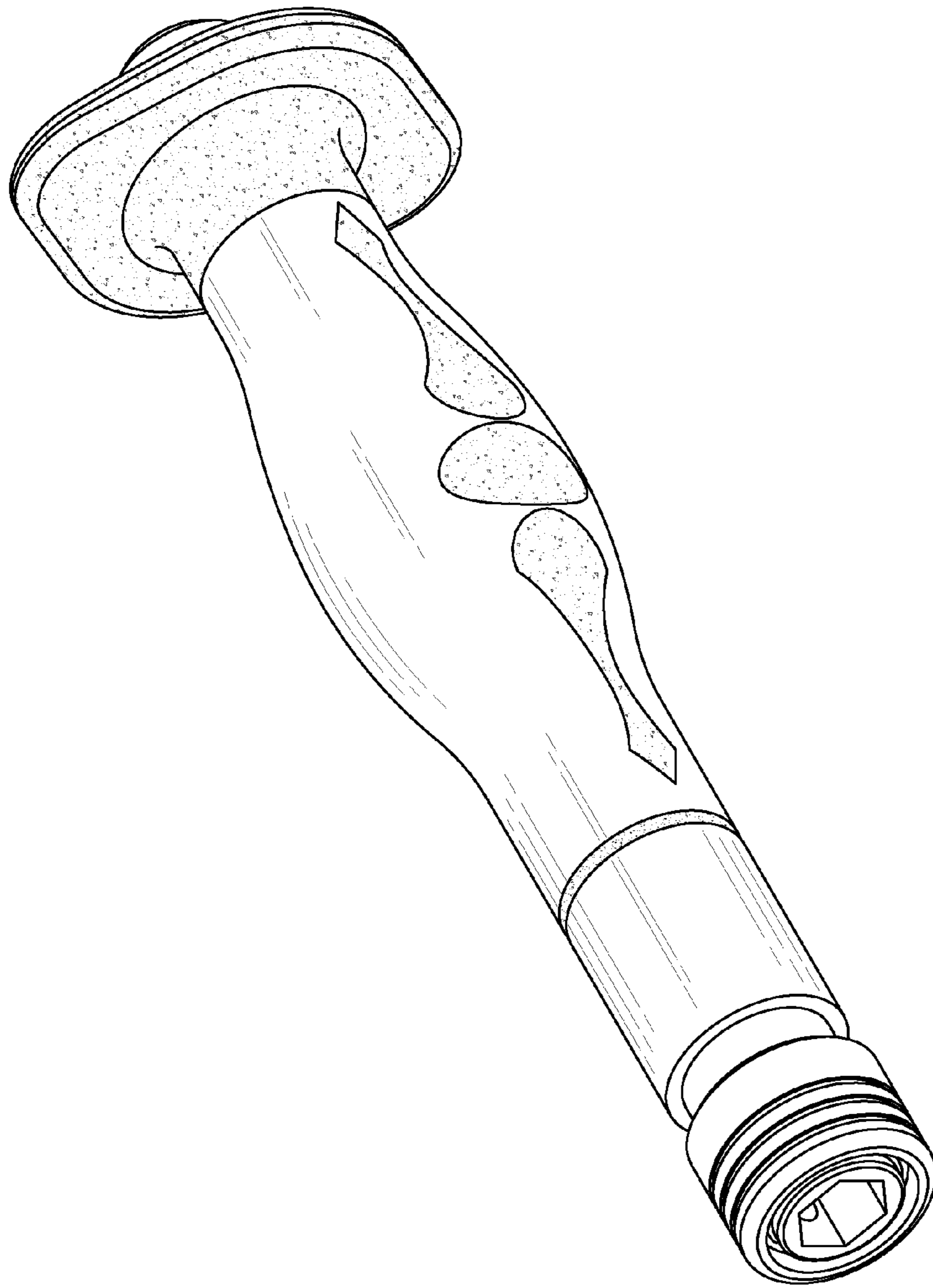

FIG. 1

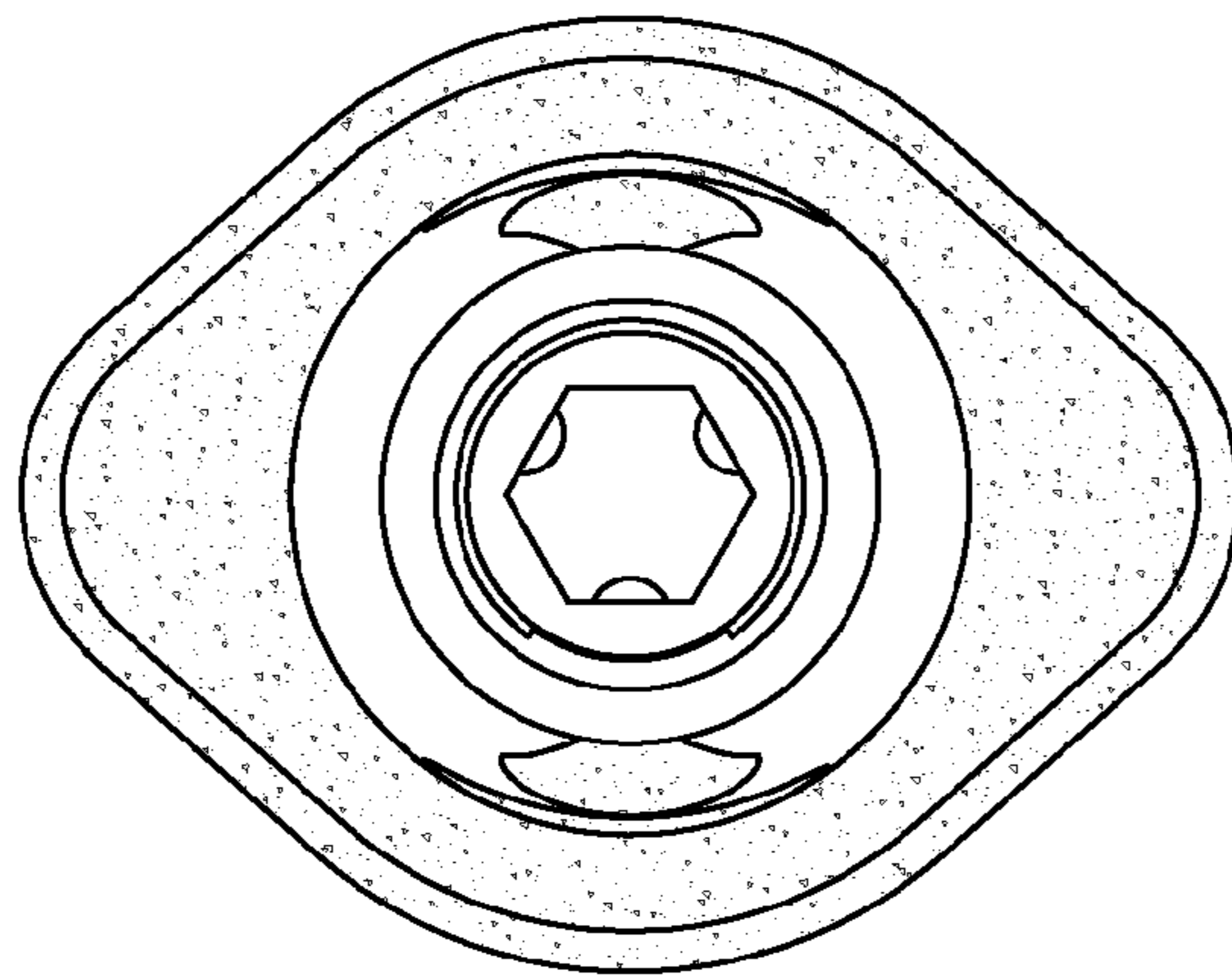

FIG. 2

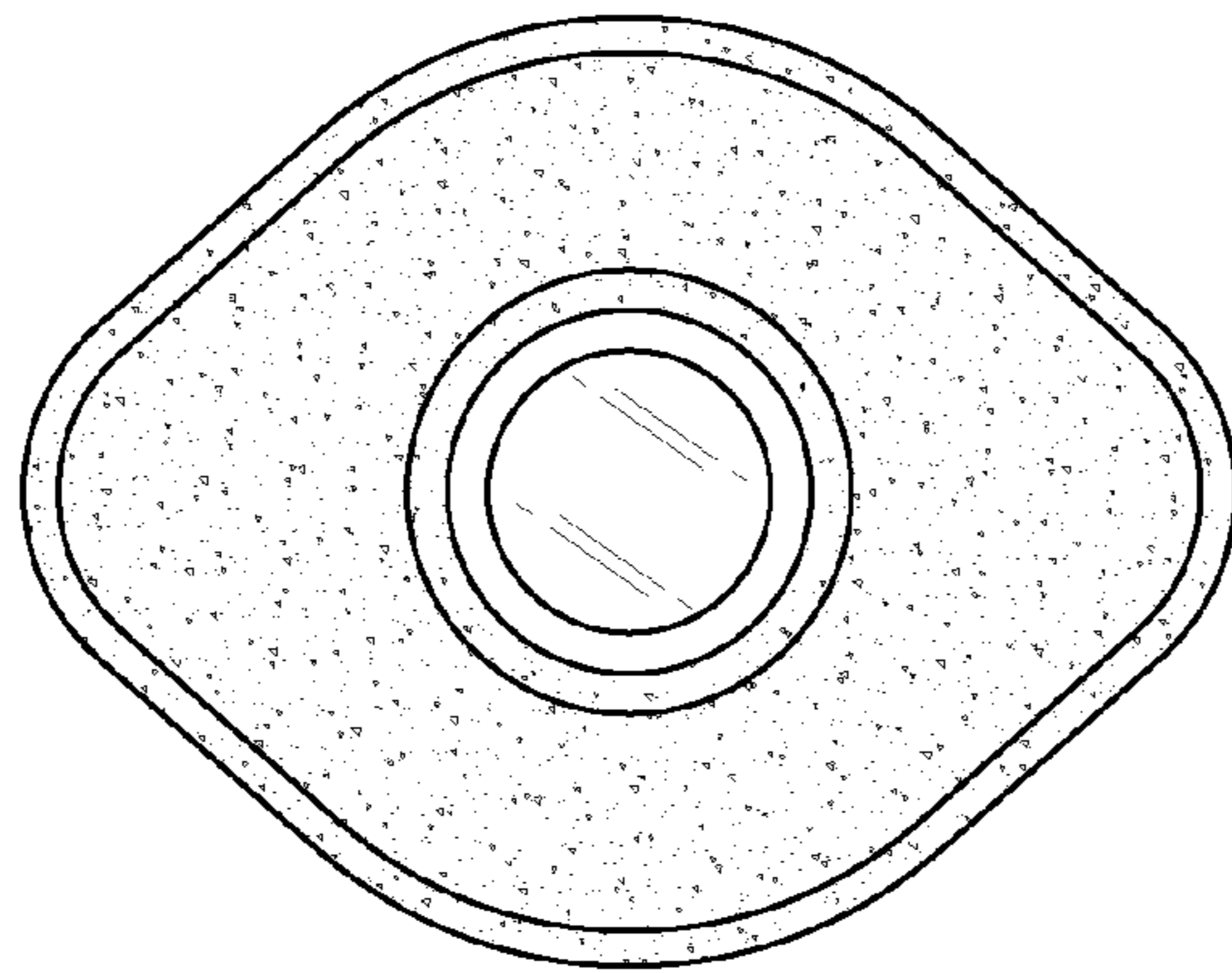

FIG. 3

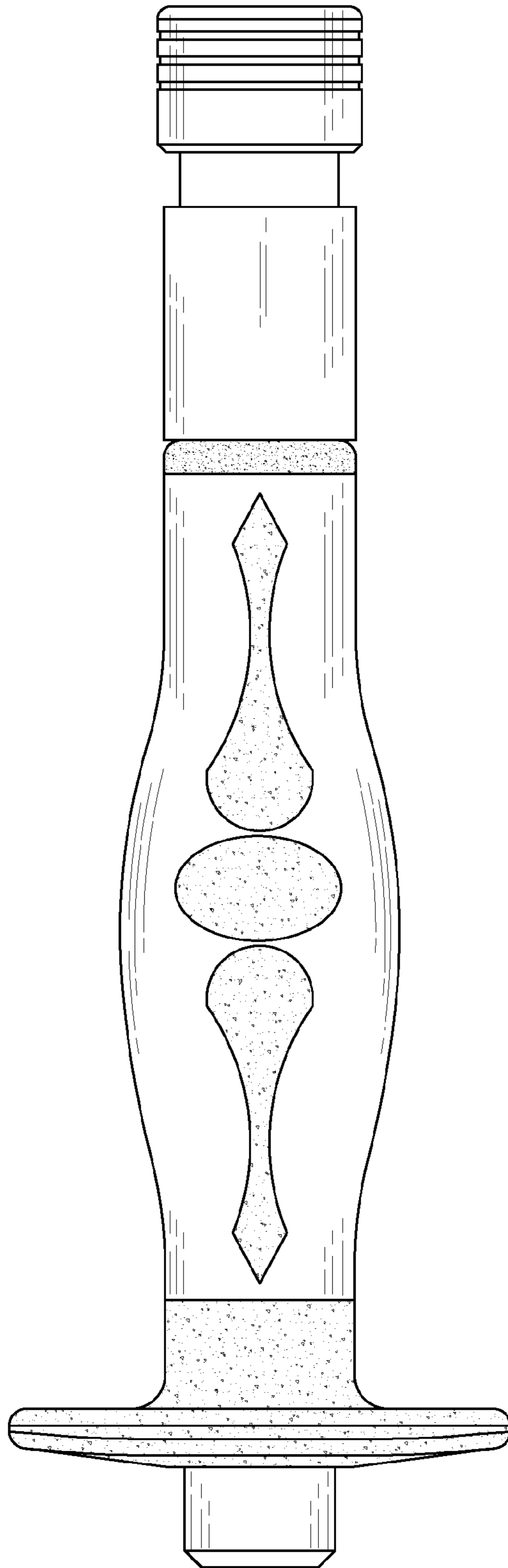

FIG. 4

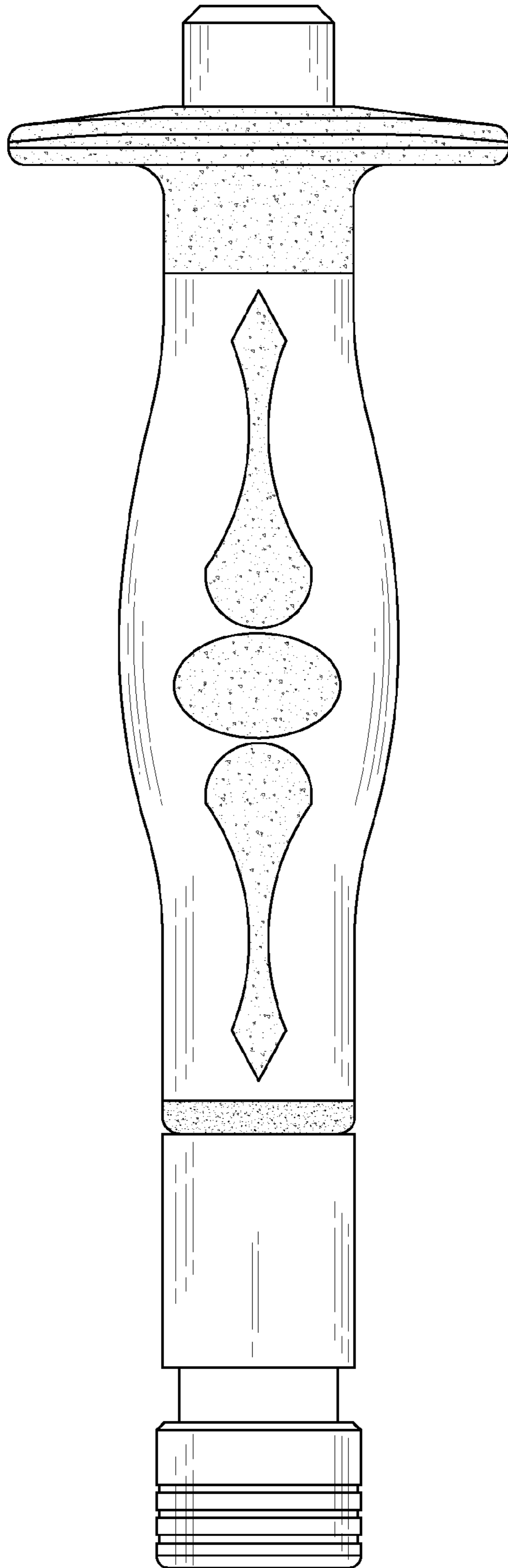

FIG. 5

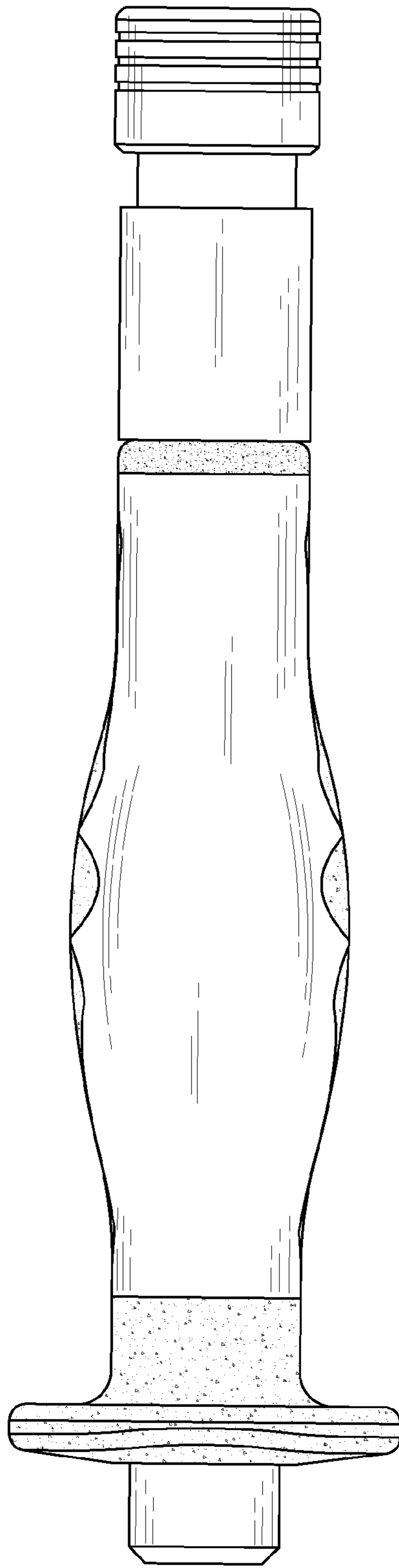

FIG. 6

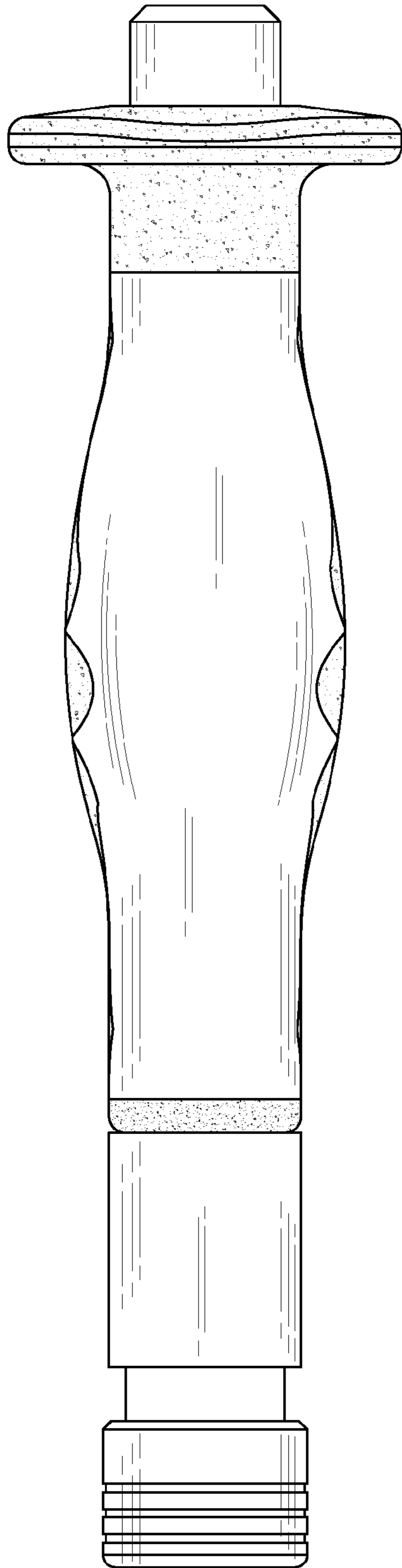

FIG. 7



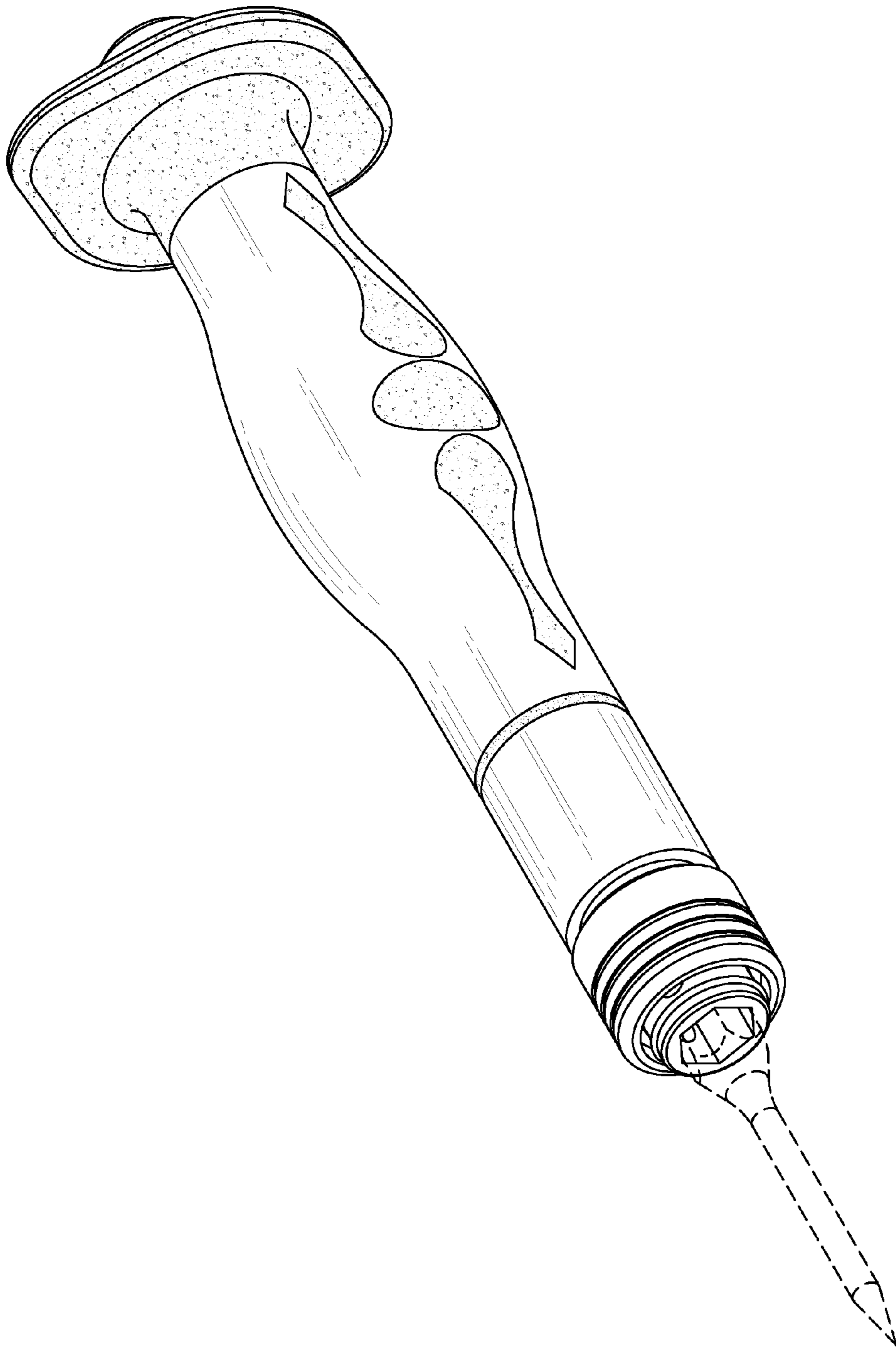

FIG. 8