



US00D598526S

(12) **United States Design Patent**
Pitchford et al.

(10) **Patent No.:** **US D598,526 S**

(45) **Date of Patent:** **** Aug. 18, 2009**

(54) **PORTABLE HEATER**

(76) Inventors: **Eric Pitchford**, 2701 Industrial Dr., Bowling Green, KY (US) 42101; **Griffin Bland**, 2701 Industrial Dr., Bowling Green, KY (US) 42101; **Craig Higginbotham**, 2701 Industrial Dr., Bowling Green, KY (US) 42101; **Pete Moyer**, 2701 Industrial Dr., Bowling Green, KY (US) 42101; **Jerry McColgin**, 17040 Eagletown Rd., Westfield, IN (US) 46074

2,818,717 A	1/1958	Morris
2,822,800 A	2/1958	Hines
3,051,227 A	8/1962	Robson
3,140,740 A	7/1964	Lagreid et al.
3,158,193 A	11/1964	Anderson
3,174,477 A	3/1965	Wilson
3,176,728 A	4/1965	Baumann
3,229,070 A	1/1966	Wells
3,409,040 A	11/1968	Weston et al.
3,503,379 A	3/1970	Kuhn et al.
3,557,772 A	1/1971	Kofink
3,603,711 A	9/1971	Downs
3,734,677 A	5/1973	Murase et al.
3,749,551 A	7/1973	Alms et al.
3,774,654 A	11/1973	Hjermstad

(**) Term: **14 Years**

(21) Appl. No.: **29/296,152**

(22) Filed: **Oct. 15, 2007**

(51) **LOC (9) Cl.** **23-03**

(52) **U.S. Cl.** **D23/317**

(58) **Field of Classification Search** D23/314, D23/317, 332, 342, 333, 334, 335, 337, 351, D23/355, 378, 370, 387, 364, 336, 341, 383; 237/56, 67, 61, 62; 416/244 R, 247 R, 53.1, 416/53.2, 53.3; 392/365, 367, 347, 350, 392/373, 407, 433, 78 A

See application file for complete search history.

(56) **References Cited**

U.S. PATENT DOCUMENTS

1,116,789 A	11/1914	Bothwell
1,679,359 A	9/1928	Jessen
2,094,915 A	10/1937	Dawson
2,191,100 A	2/1940	Starling
2,261,514 A	11/1941	Dumogan
2,410,881 A	11/1946	Hunter
2,425,026 A	8/1947	Breese
2,686,516 A	8/1954	Yawman, Jr.
2,744,516 A	5/1956	Hubbard
2,758,590 A	8/1956	Besser
2,780,218 A	2/1957	Allen
2,548,987 A	4/1957	Mayo
2,811,962 A	11/1957	Pelsue et al.

(Continued)

FOREIGN PATENT DOCUMENTS

JP 55035876 3/1980

Primary Examiner—T. Chase Nelson

Assistant Examiner—Ania K Dworzecka

(74) *Attorney, Agent, or Firm*—John Salazar; Chad Bruggeman; Middleton Reutlinger

(57) **CLAIM**

The ornamental design for a portable heater, as shown and described.

DESCRIPTION

FIG. 1 is a perspective view of the portable heater design;

FIG. 2 is a top view thereof;

FIG. 3 is a front view thereof;

FIG. 4 is a left side view thereof;

FIG. 5 is a right side view thereof;

FIG. 6 is a rear view thereof; and,

FIG. 7 is a bottom view thereof.

The broken lines shown on the drawings are for illustrative purposes only and form no part of the claimed design.

1 Claim, 7 Drawing Sheets

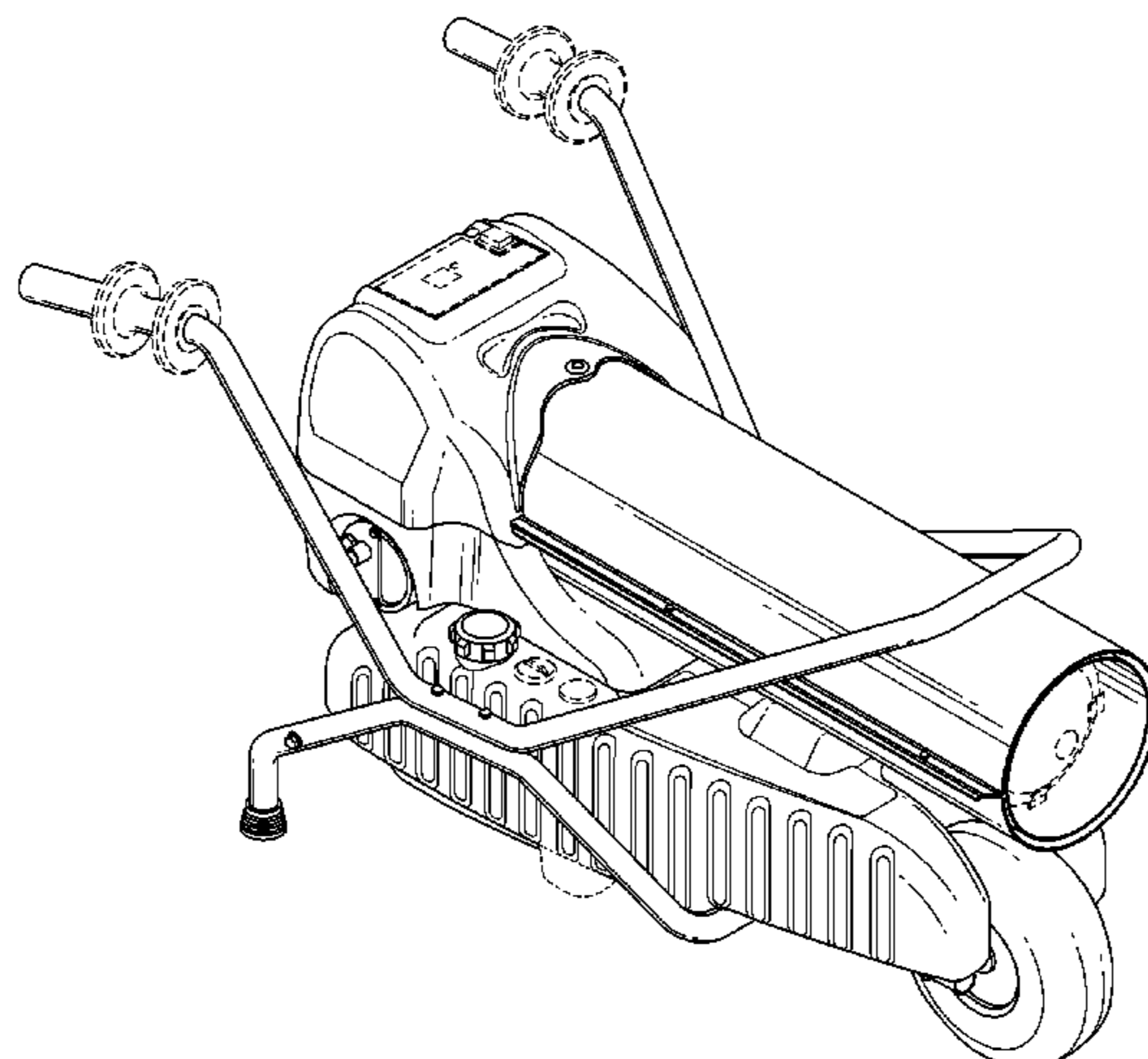

US D598,526 S

Page 2

U.S. PATENT DOCUMENTS

3,982,524 A	9/1976	Diggs		5,516,282 A	5/1996	Somerville	
4,005,976 A	2/1977	Rombach et al.		5,540,213 A	7/1996	Shell et al.	
4,263,886 A	4/1981	Batchelor		D393,702 S *	4/1998	Haeck	D23/328
4,276,018 A	6/1981	Robbins		5,766,003 A	6/1998	Vogelzang	
D264,374 S *	5/1982	Briggs et al.	D23/338	5,775,315 A	7/1998	Baykal	
4,340,362 A	7/1982	Chalupsky et al.		5,848,585 A	12/1998	Long et al.	
4,363,621 A	12/1982	Nakamura et al.		5,893,711 A *	4/1999	Vogelzang et al.	432/222
4,443,187 A *	4/1984	Shaftner et al.	432/222	D409,737 S *	5/1999	Nilsson	D23/332
4,537,232 A	8/1985	Barber		6,065,466 A	5/2000	Baykal	
4,543,057 A	9/1985	Nakamura et al.		6,142,141 A	11/2000	Long	
4,596,277 A	6/1986	Djordjevic		6,397,902 B1	6/2002	Murphy	
4,651,711 A	3/1987	Velie		D468,952 S	1/2003	Graham et al.	
4,653,552 A	3/1987	Friedle		6,595,200 B1	7/2003	Dai	
4,691,687 A	9/1987	Mutchler		6,619,281 B2	9/2003	Resmo et al.	
4,788,963 A	12/1988	Mutchler		6,648,635 B2	11/2003	Vandrak et al.	
4,848,313 A	7/1989	Velie		6,760,543 B1	7/2004	Orr et al.	
4,850,853 A	7/1989	Gruber et al.		6,843,244 B2	1/2005	McCalley et al.	
4,941,452 A	7/1990	Thrasher et al.		6,857,870 B2 *	2/2005	Topp	431/350
4,998,878 A *	3/1991	Gruber	431/90	6,880,549 B2	4/2005	Topp	
D330,756 S *	11/1992	Davies et al.	D23/338	D530,002 S *	10/2006	Ching	D23/317
D340,765 S *	10/1993	Joss et al.	D23/336	D541,916 S *	5/2007	Noyer et al.	D23/314
5,445,196 A	8/1995	Tyree, Jr.		D547,846 S *	7/2007	Pitchford et al.	D23/317

* cited by examiner

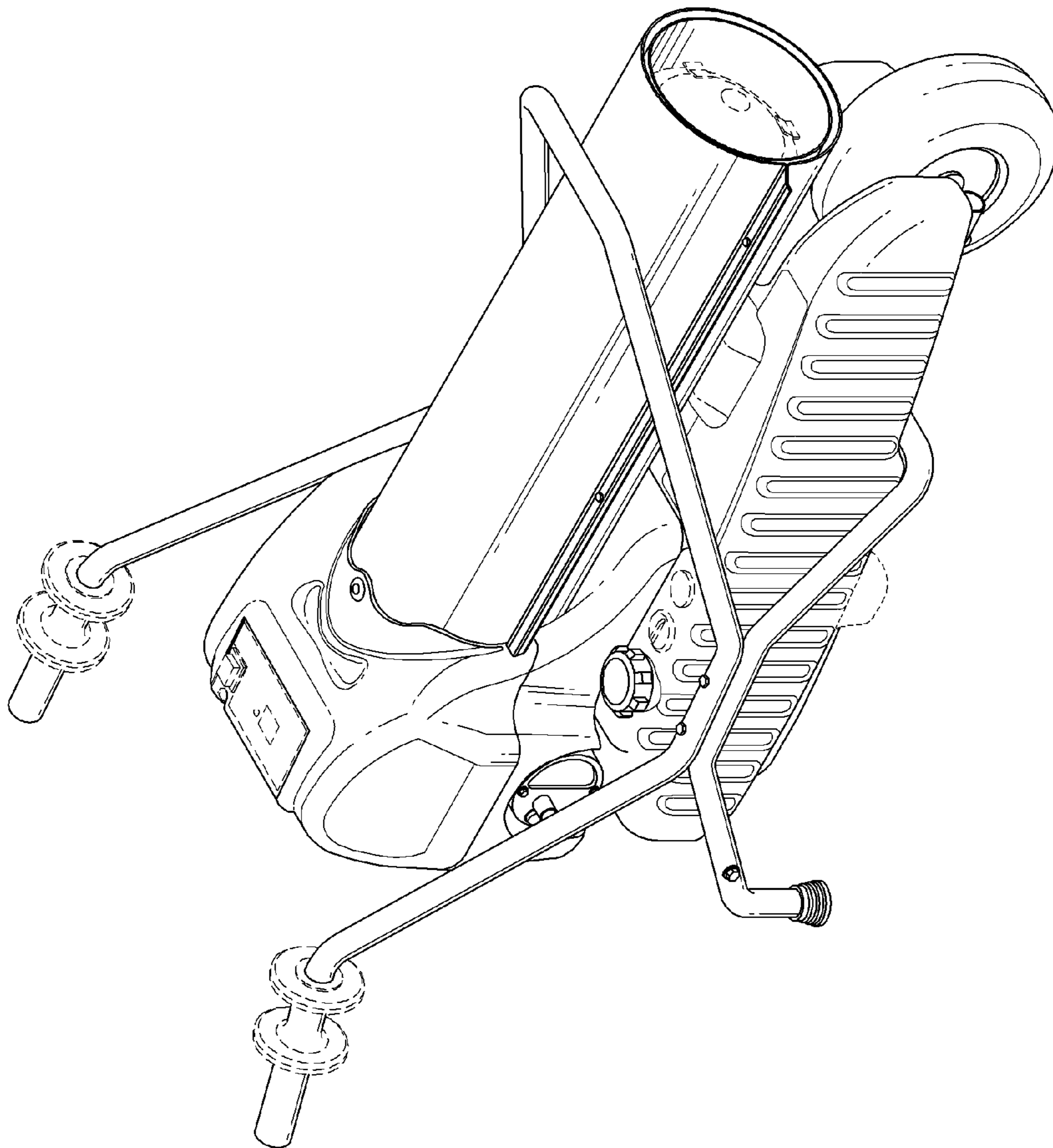

FIG. 1

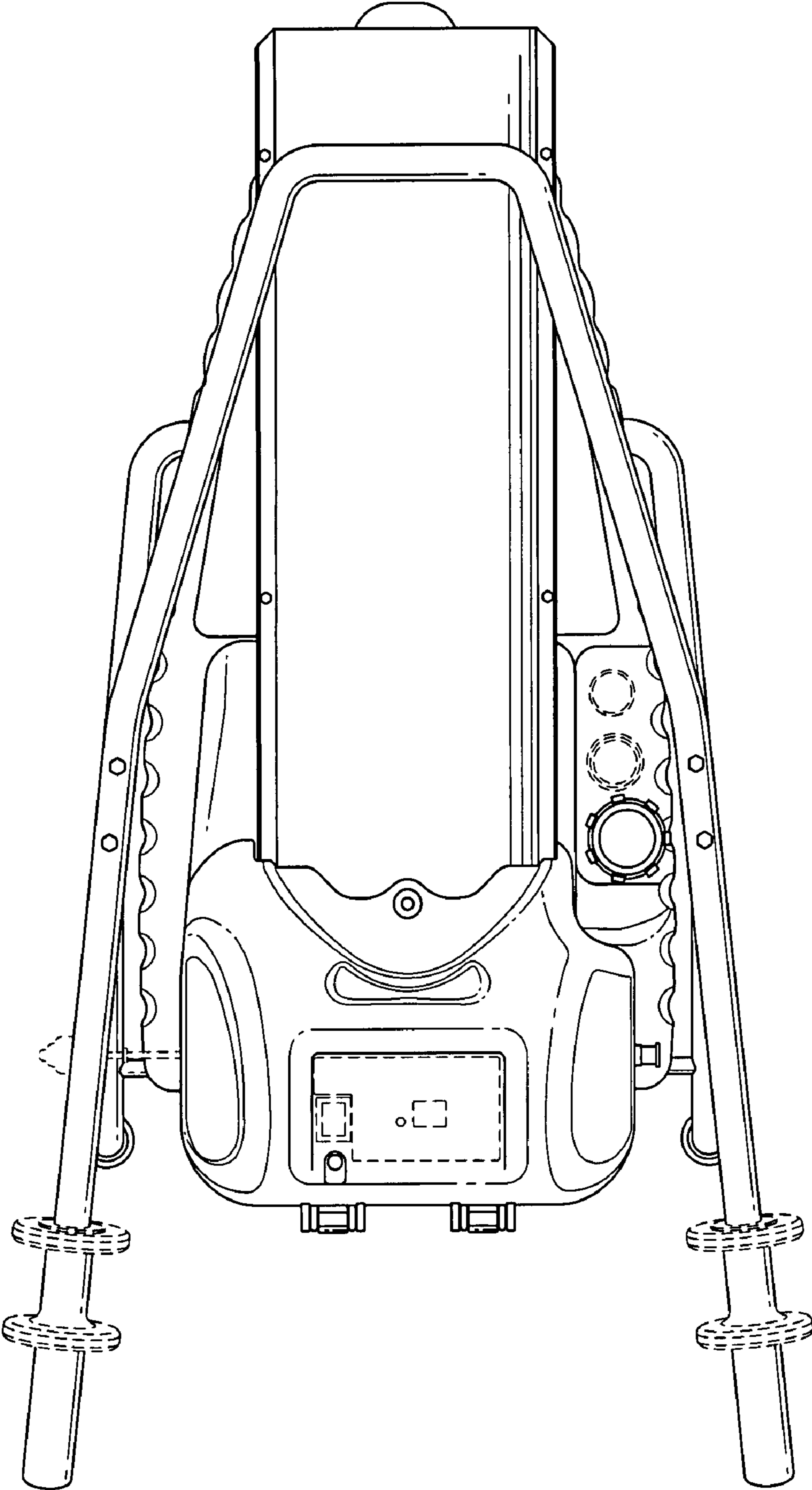

FIG. 2

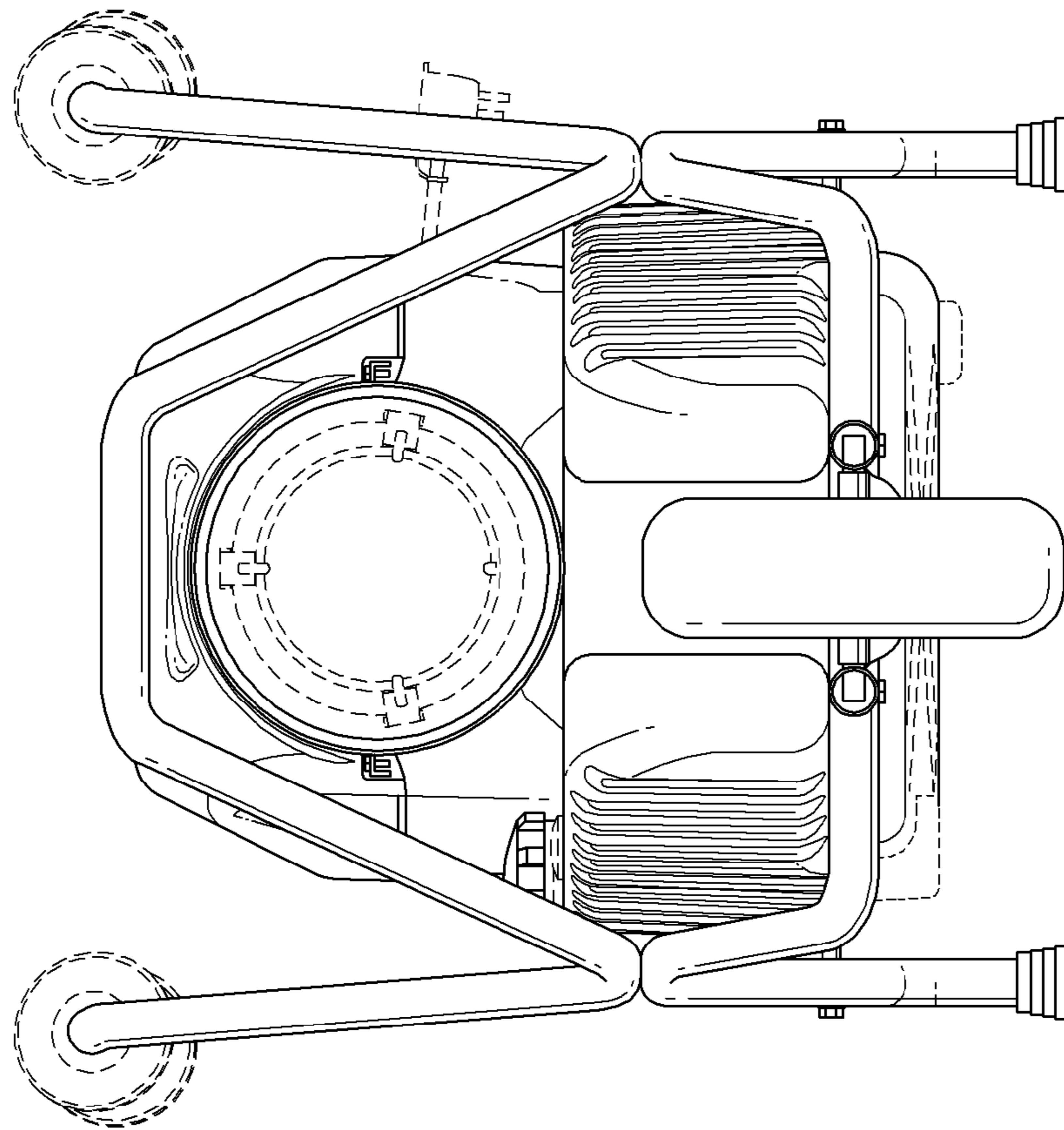

FIG. 3

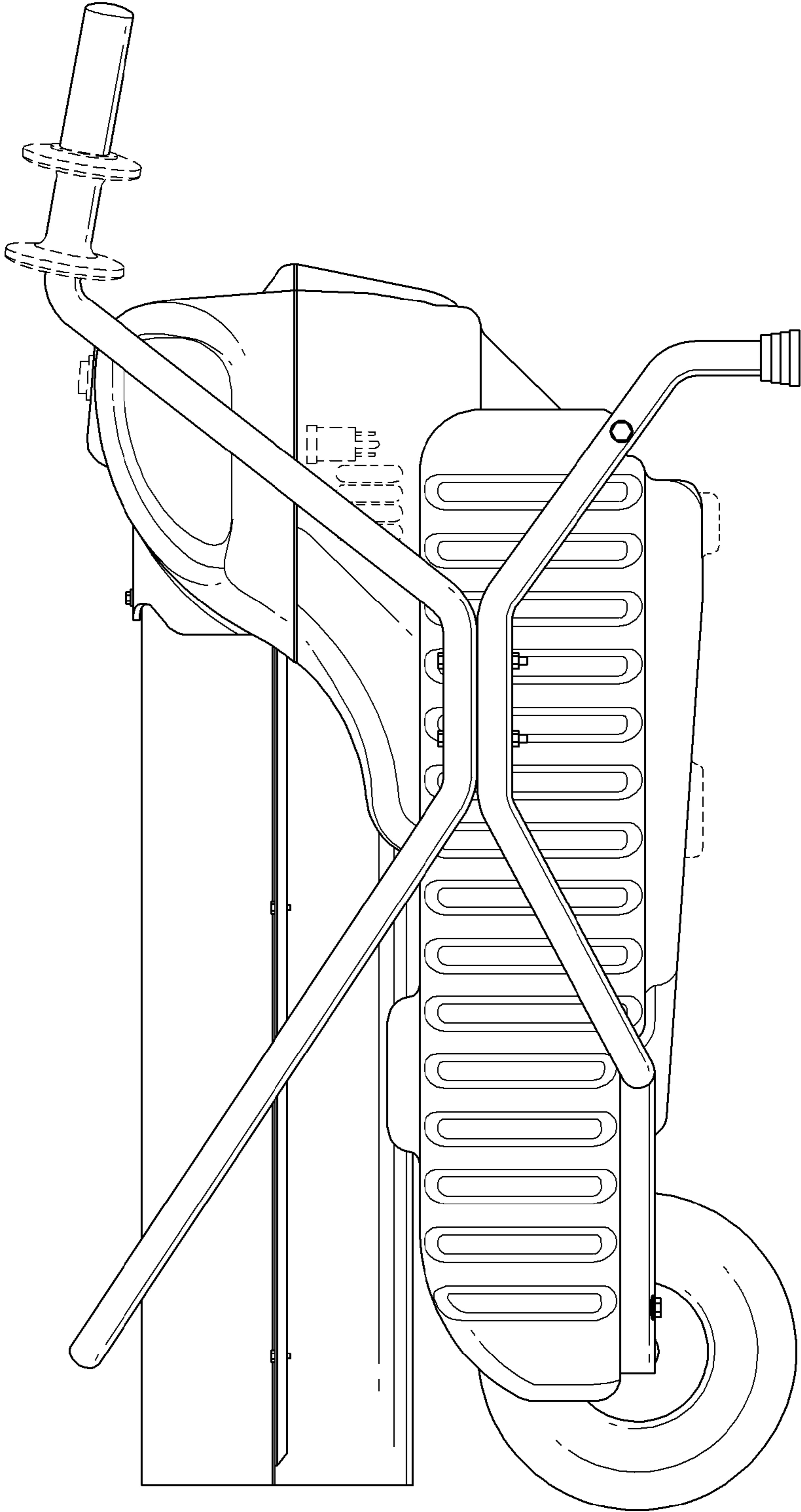

FIG. 4

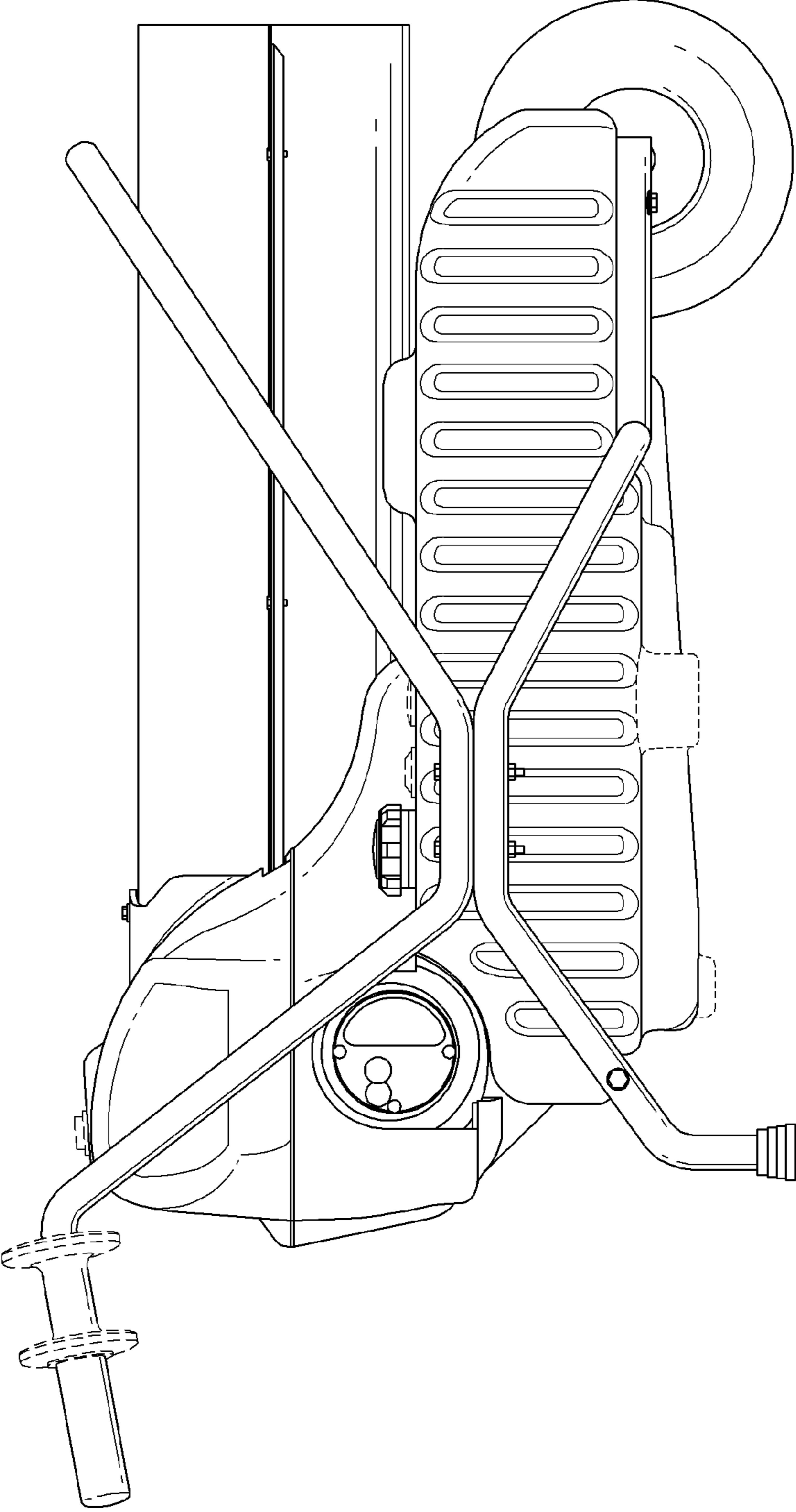

FIG. 5

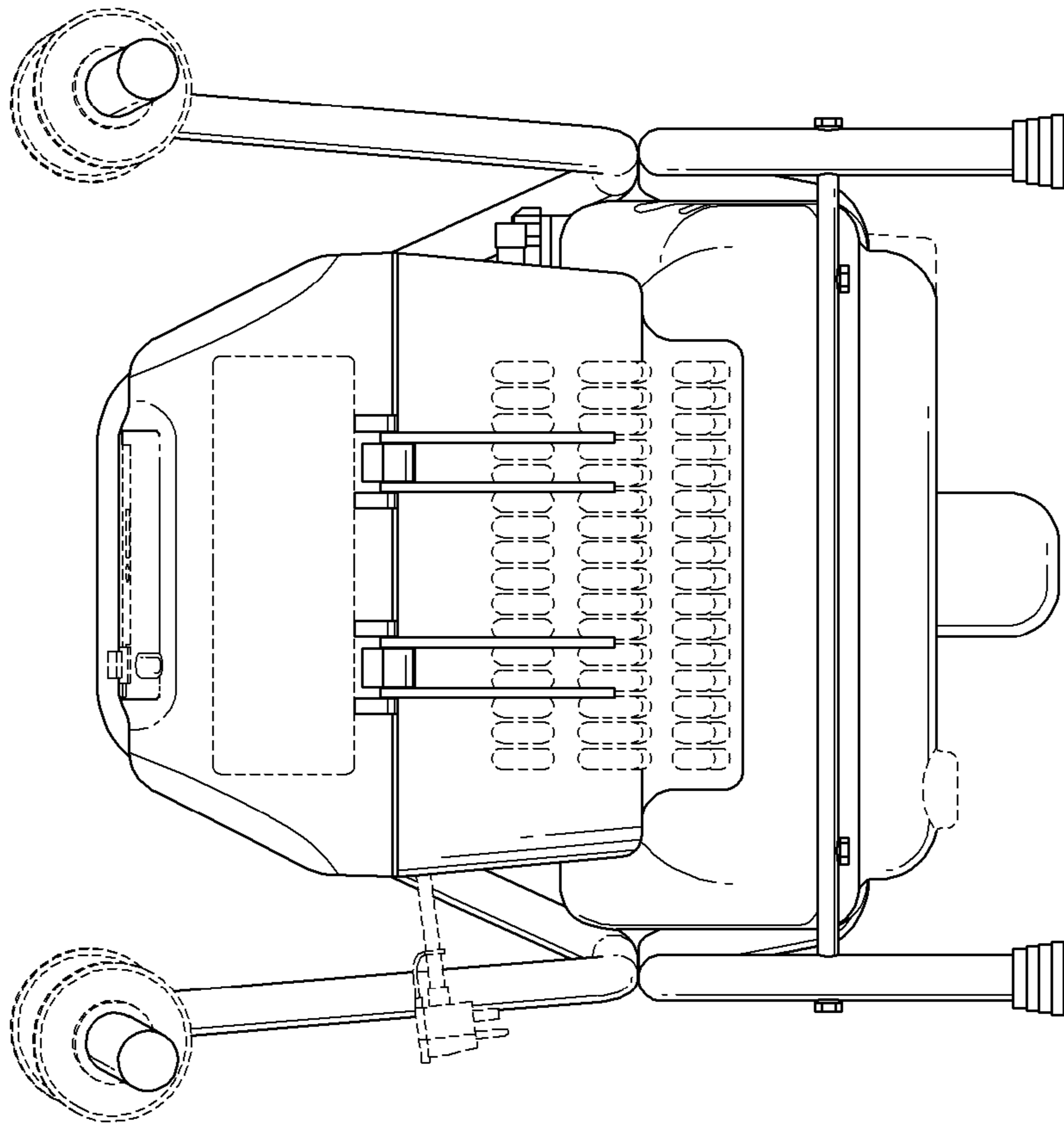

FIG. 6

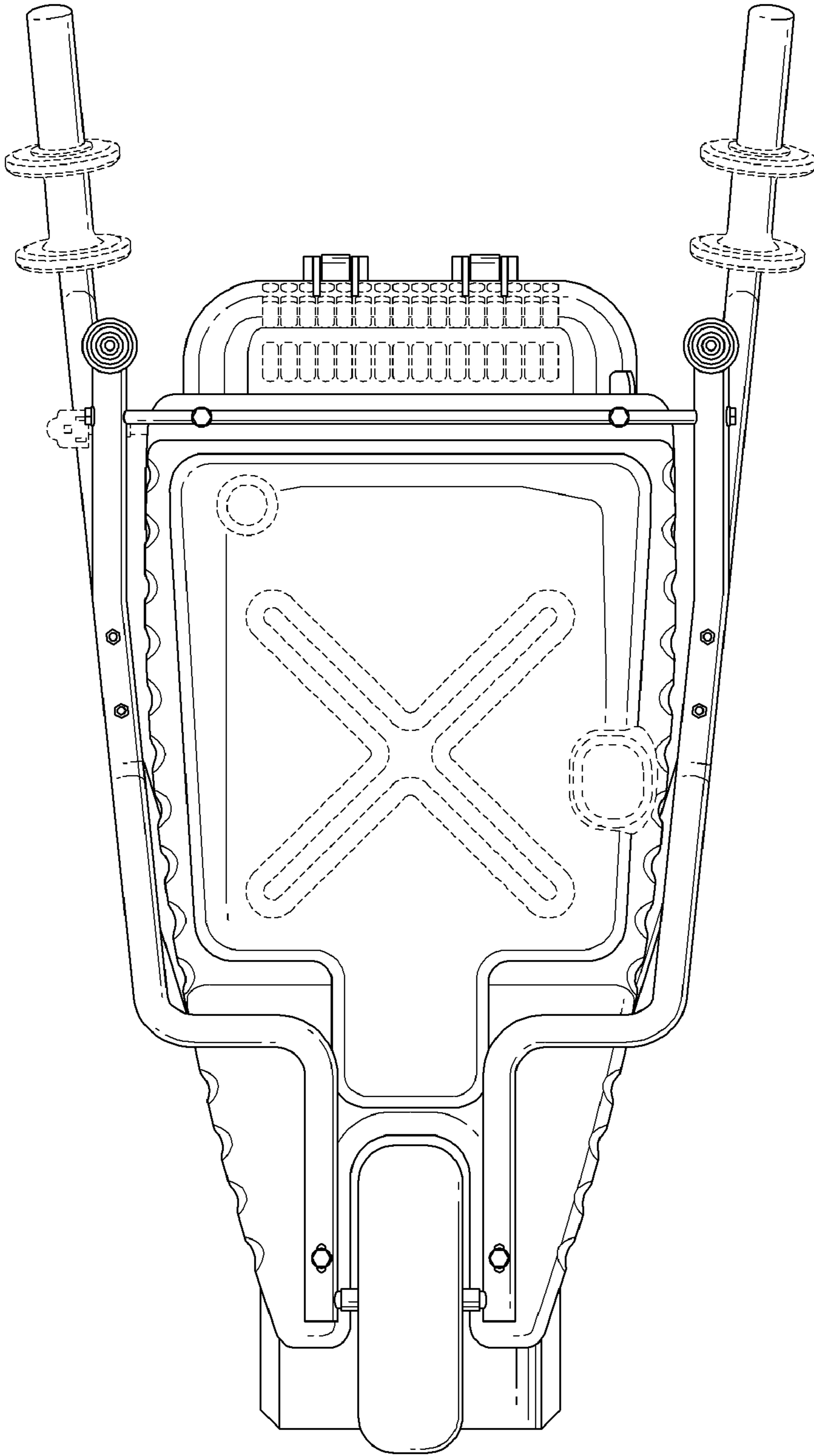

FIG. 7