



US00D598430S

(12) **United States Design Patent**
Nakatani

(10) **Patent No.:** **US D598,430 S**

(45) **Date of Patent:** **** Aug. 18, 2009**

(54) **PHASE CORRECTING PLATE FOR SPEAKERS**

(75) Inventor: **Eiji Nakatani**, Kadoma (JP)

(73) Assignee: **Panasonic Corporation**, Osaka (JP)

(**) Term: **14 Years**

(21) Appl. No.: **29/306,278**

(22) Filed: **Apr. 4, 2008**

(30) **Foreign Application Priority Data**

Dec. 13, 2007	(JP)	2007-034160
Dec. 13, 2007	(JP)	2007-034161
Dec. 13, 2007	(JP)	2007-034162

(51) **LOC (9) Cl.** **14-01**

(52) **U.S. Cl.** **D14/217; D14/214**

(58) **Field of Classification Search** D14/204,
D14/210–217, 219–222, 168, 135, 138 R,
D14/138 AA, 147–148, 248, 172; 181/143–144,
181/147–148, 150–153, 157, 198–199; 381/300–303,
381/306, 332–333, 336, 345, 361–364, 386–388;
D3/201; D6/487, 511; D9/499; D32/61;
24/563, 30.5 P, 30.5 S; 206/306; 385/136
See application file for complete search history.

(56) **References Cited**

U.S. PATENT DOCUMENTS

1,958,993	A *	5/1934	Friend	439/115
4,470,180	A *	9/1984	Blomgren	24/563
D319,903	S *	9/1991	Barner	D32/61
D324,680	S *	3/1992	Alves et al.	D14/138 AA
5,205,530	A *	4/1993	Fish	248/690
D371,455	S *	7/1996	Ronson et al.	D3/201
D413,326	S *	8/1999	Chao	D14/138 R
D438,858	S *	3/2001	del Castillo	D14/217
D445,980	S *	7/2001	Tjugum	D32/61
D456,645	S *	5/2002	Iverson	D6/487
D460,350	S *	7/2002	Davis	D9/499
D465,475	S *	11/2002	Ishibashi	D14/217
D474,755	S *	5/2003	Senda et al.	D14/135

* cited by examiner

Primary Examiner—Nanda Bondade
(74) *Attorney, Agent, or Firm*—Brinks Hofer Gilson & Lione

(57) **CLAIM**

I claim the ornamental design for a phase correcting plate for speakers, as shown and described.

DESCRIPTION

FIG. 1 is a top perspective view of a first embodiment of a phase correcting plate for speakers of the present invention;

FIG. 2 is a front view thereof;

FIG. 3 is a rear view thereof;

FIG. 4 is a first side view thereof;

FIG. 5 is a second side view thereof;

FIG. 6 is a top view thereof;

FIG. 7 is a bottom view thereof;

FIG. 8 is a top perspective view of a second embodiment of a phase correcting plate for speakers of the present invention;

FIG. 9 is a front view thereof;

FIG. 10 is a rear view thereof;

FIG. 11 is a first side view thereof;

FIG. 12 is a second side view thereof;

FIG. 13 is a top view thereof;

FIG. 14 is a bottom view thereof;

FIG. 15 is a top perspective view of a third embodiment of a phase correcting plate for speakers of the present invention;

FIG. 16 is a front view thereof;

FIG. 17 is a rear view thereof;

FIG. 18 is a first side view thereof;

FIG. 19 is a second side view thereof;

FIG. 20 is a top view thereof; and,

FIG. 21 is a bottom view thereof.

The broken line showing of speaker is included for the purpose of illustrating environment and forms no part of the claimed design.

1 Claim, 21 Drawing Sheets

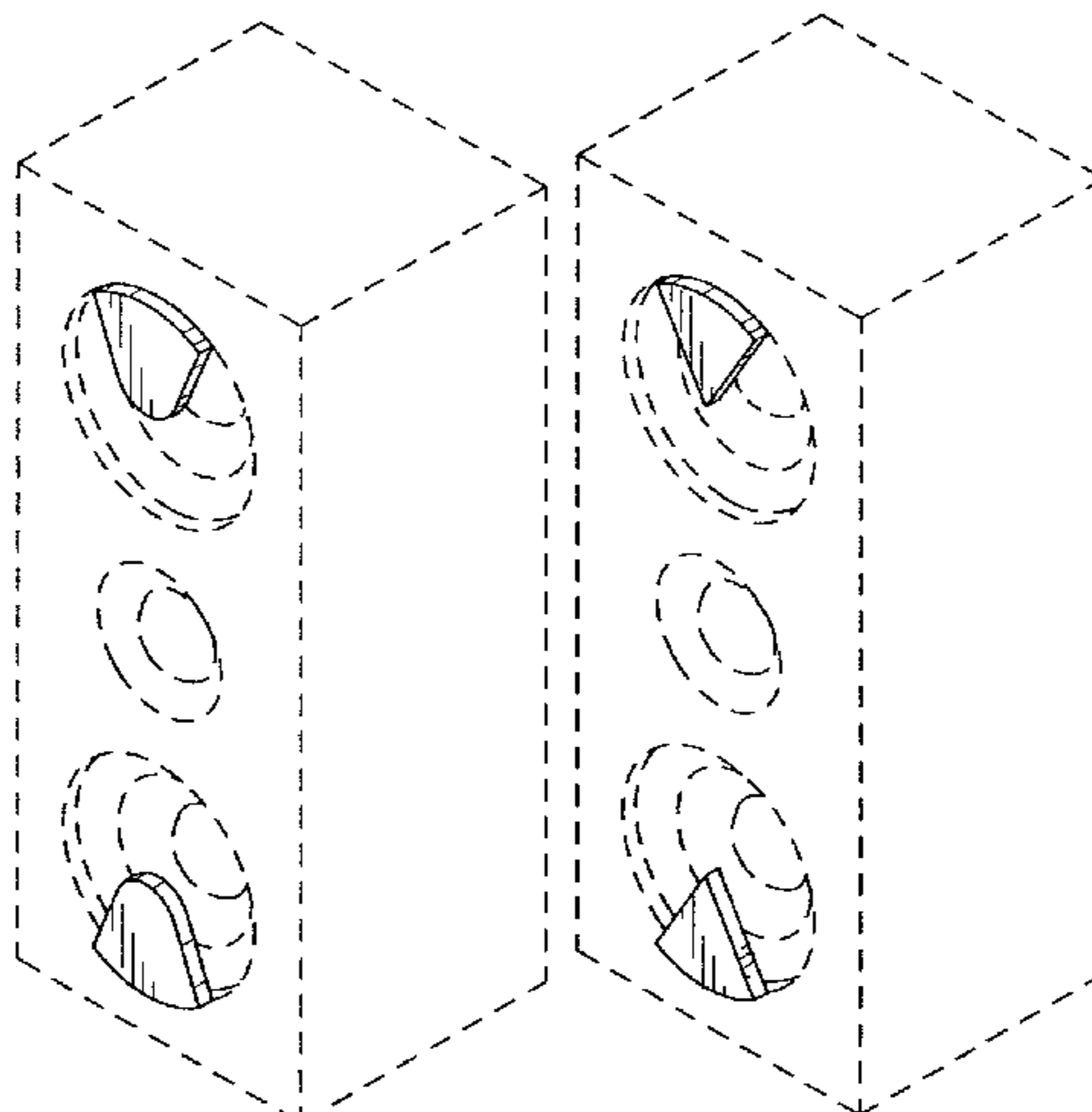

FIG. 1

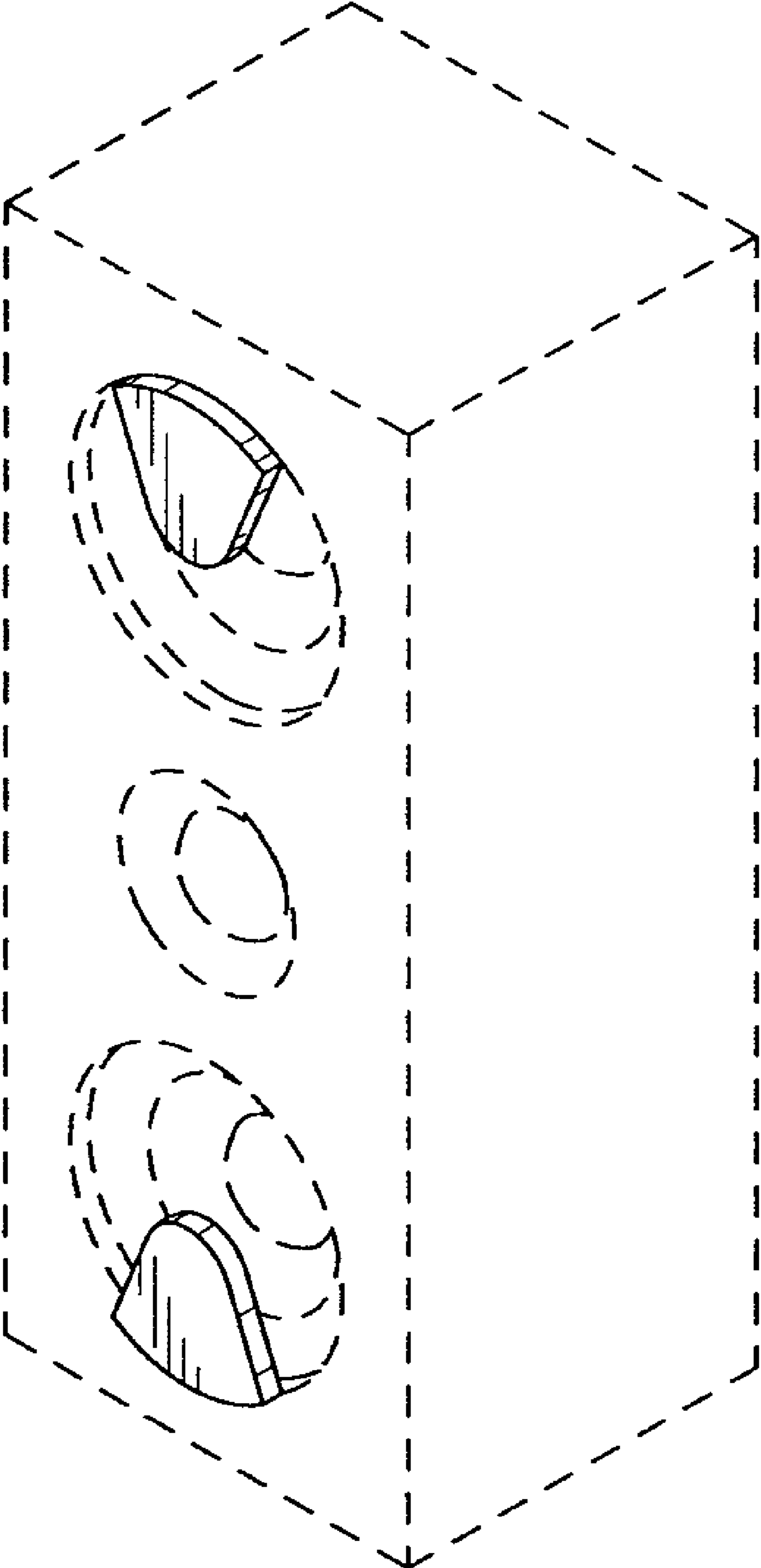

FIG. 2

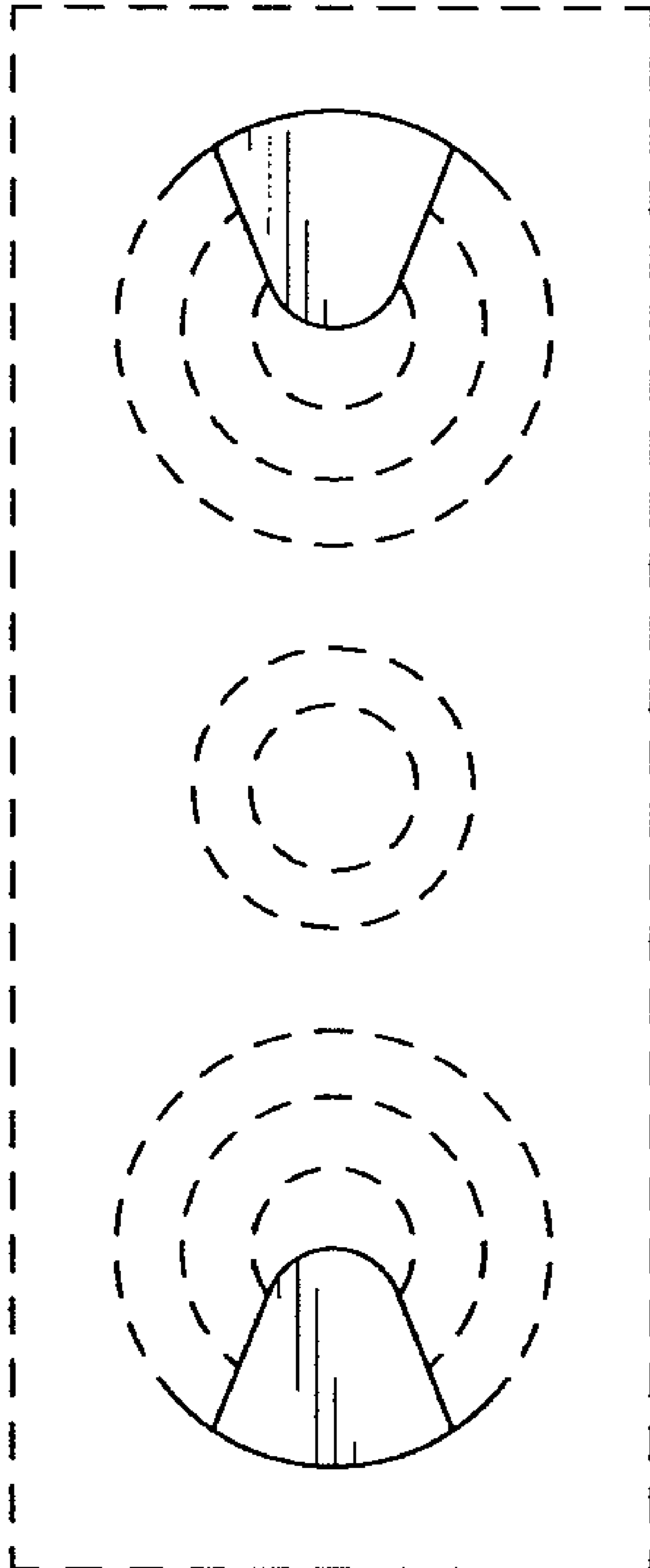

FIG. 3

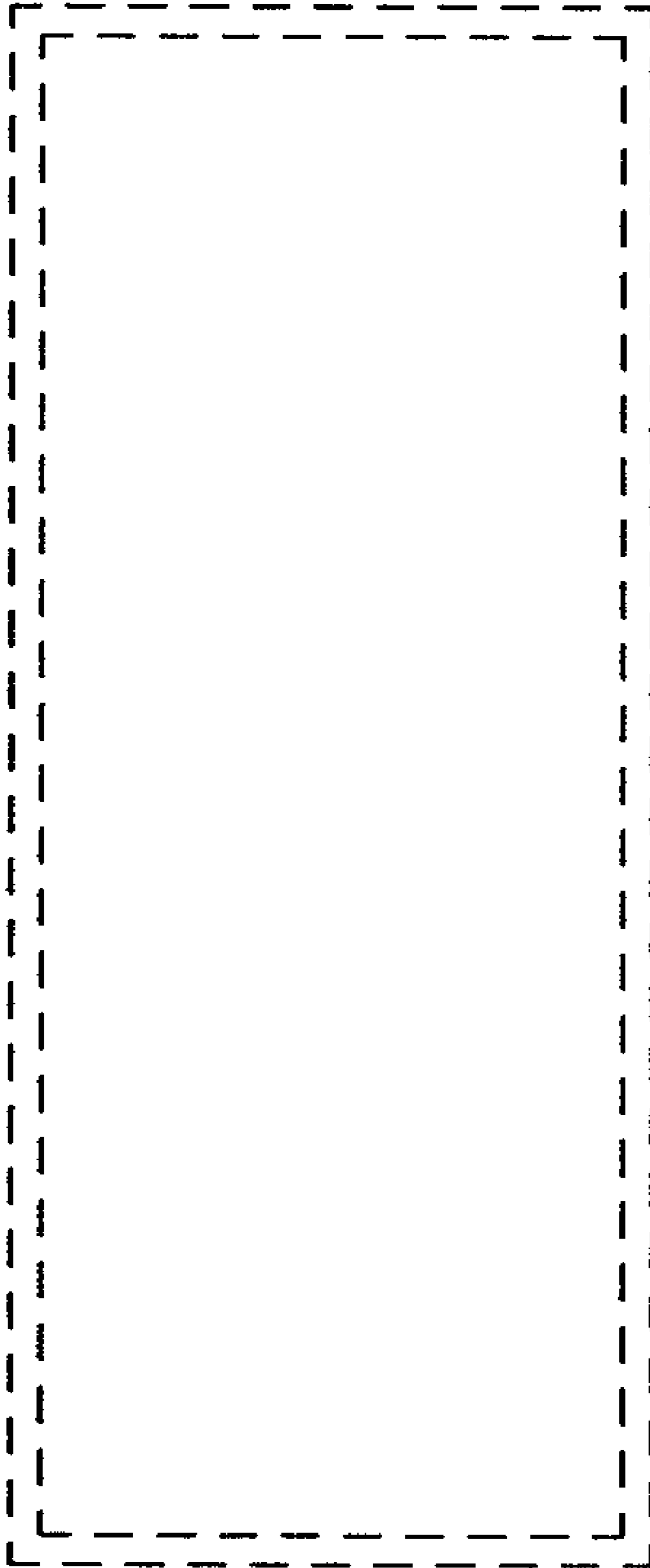

FIG. 4

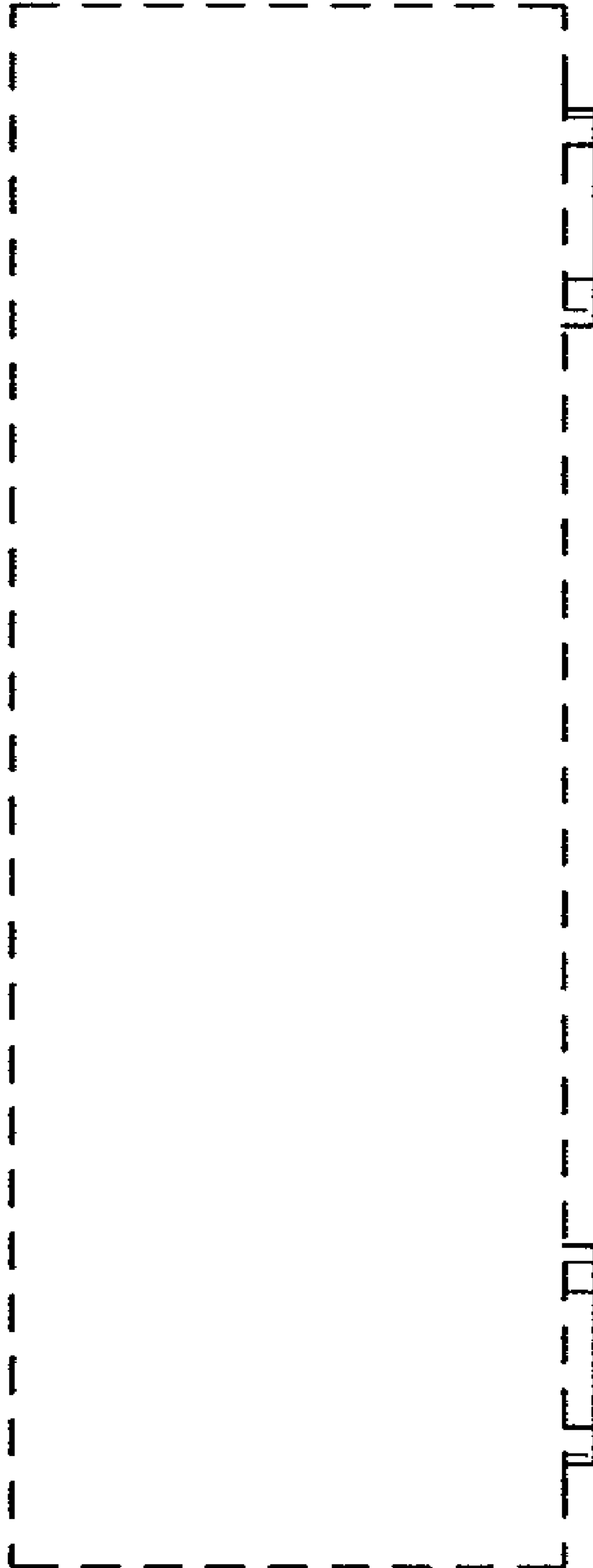

FIG. 5

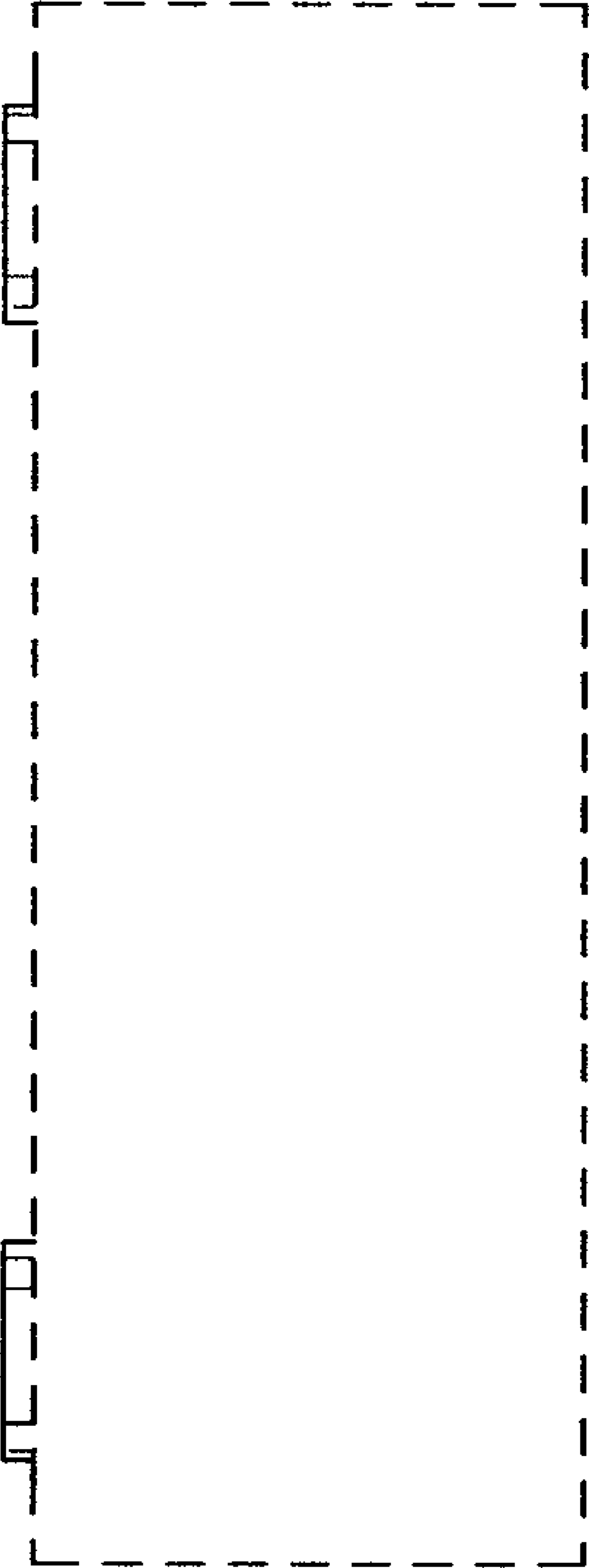

FIG. 6



FIG. 7

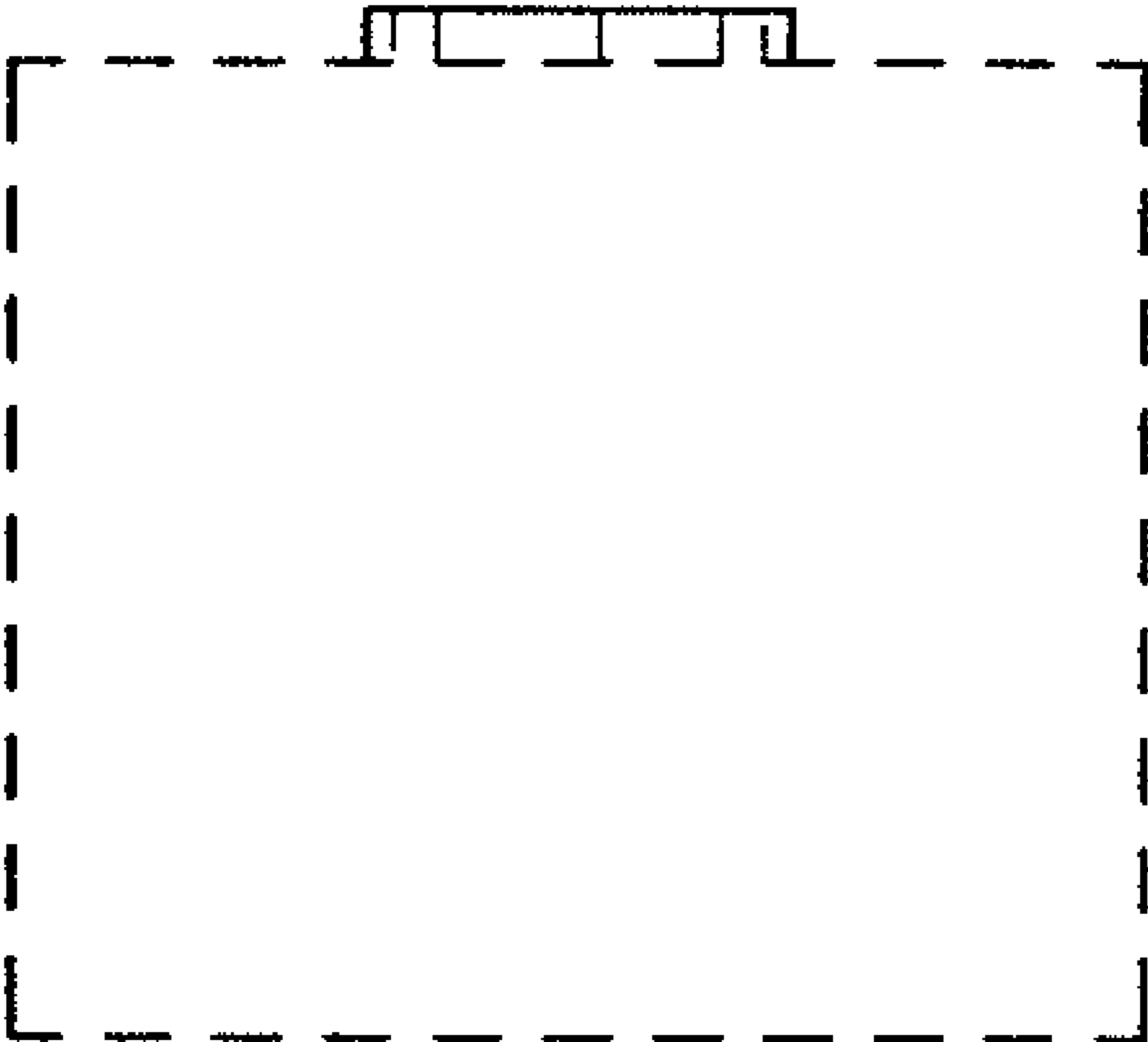

FIG. 8

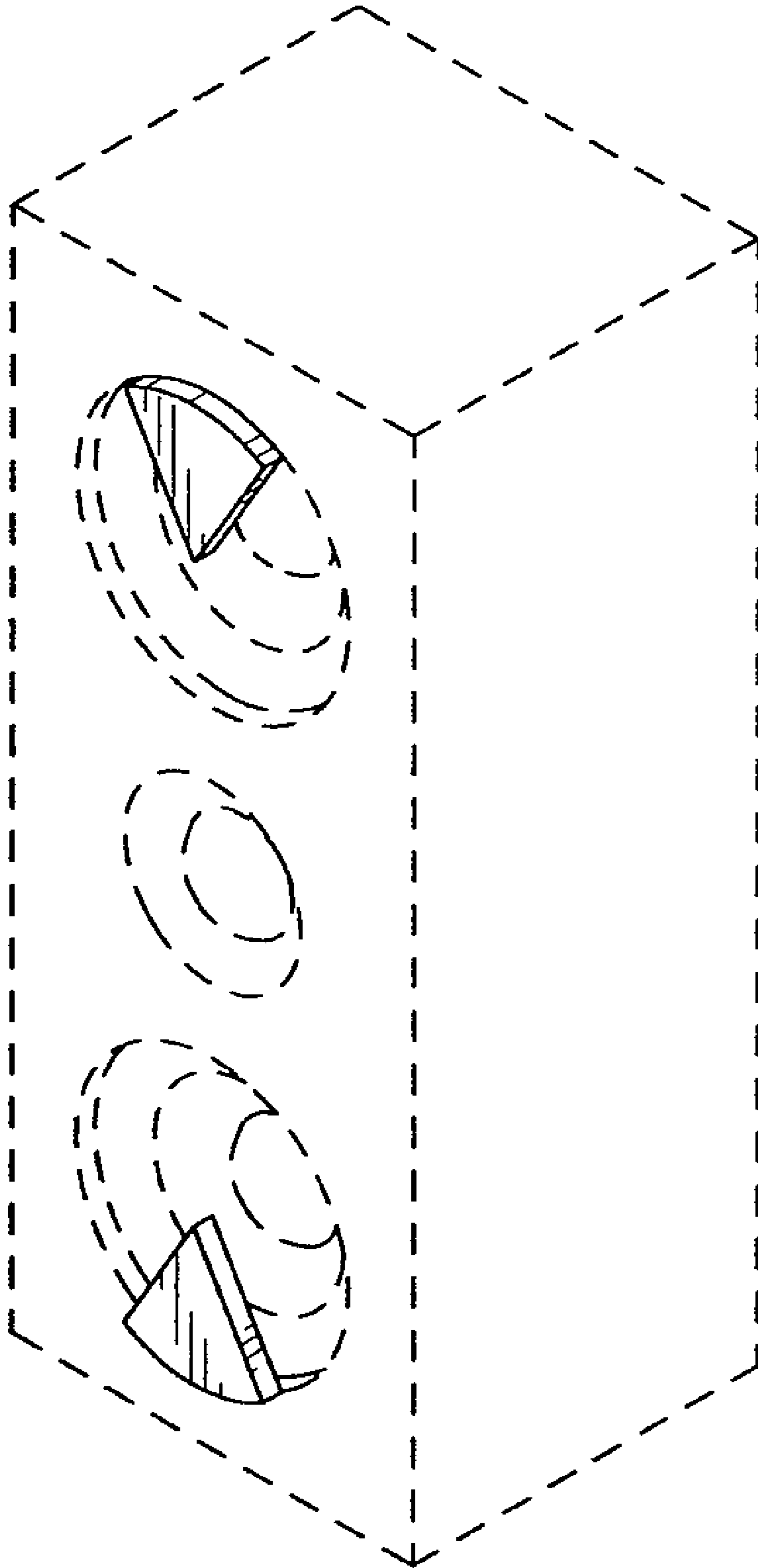

FIG. 9

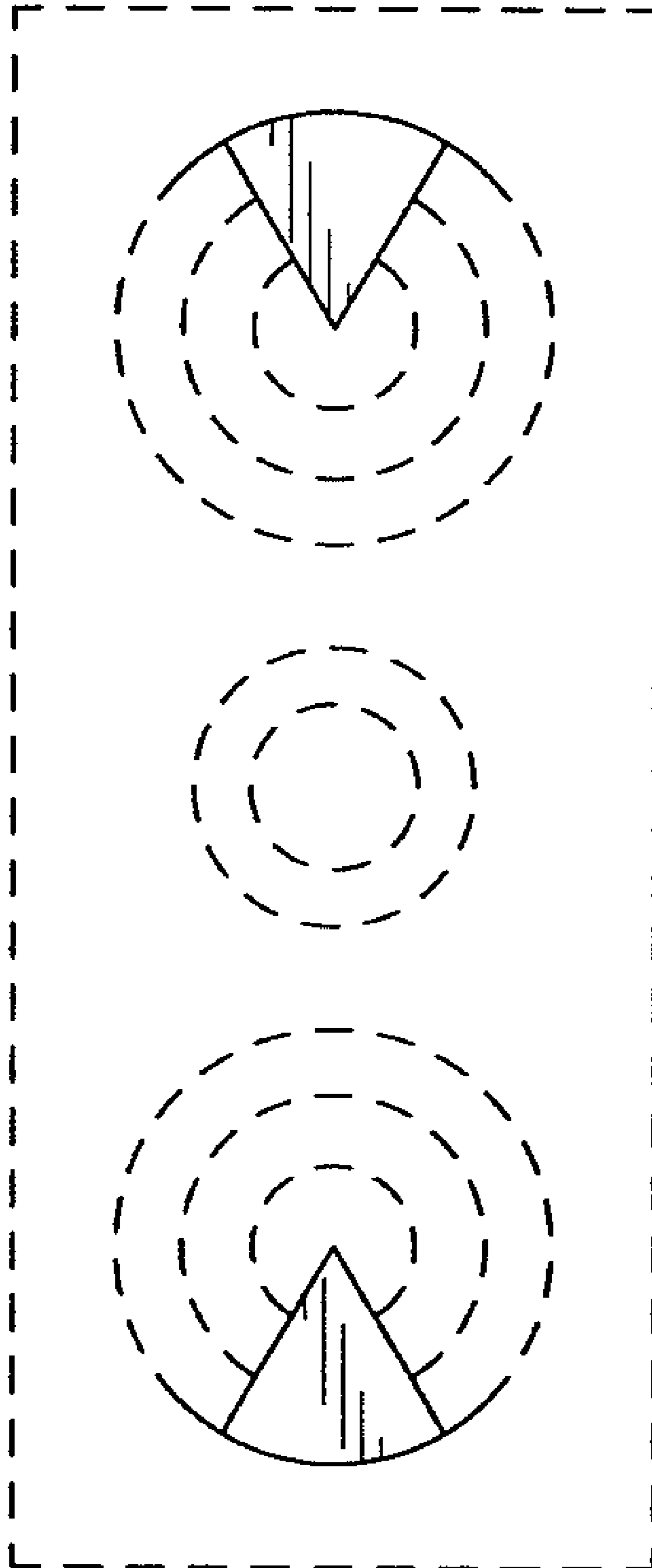

FIG. 10

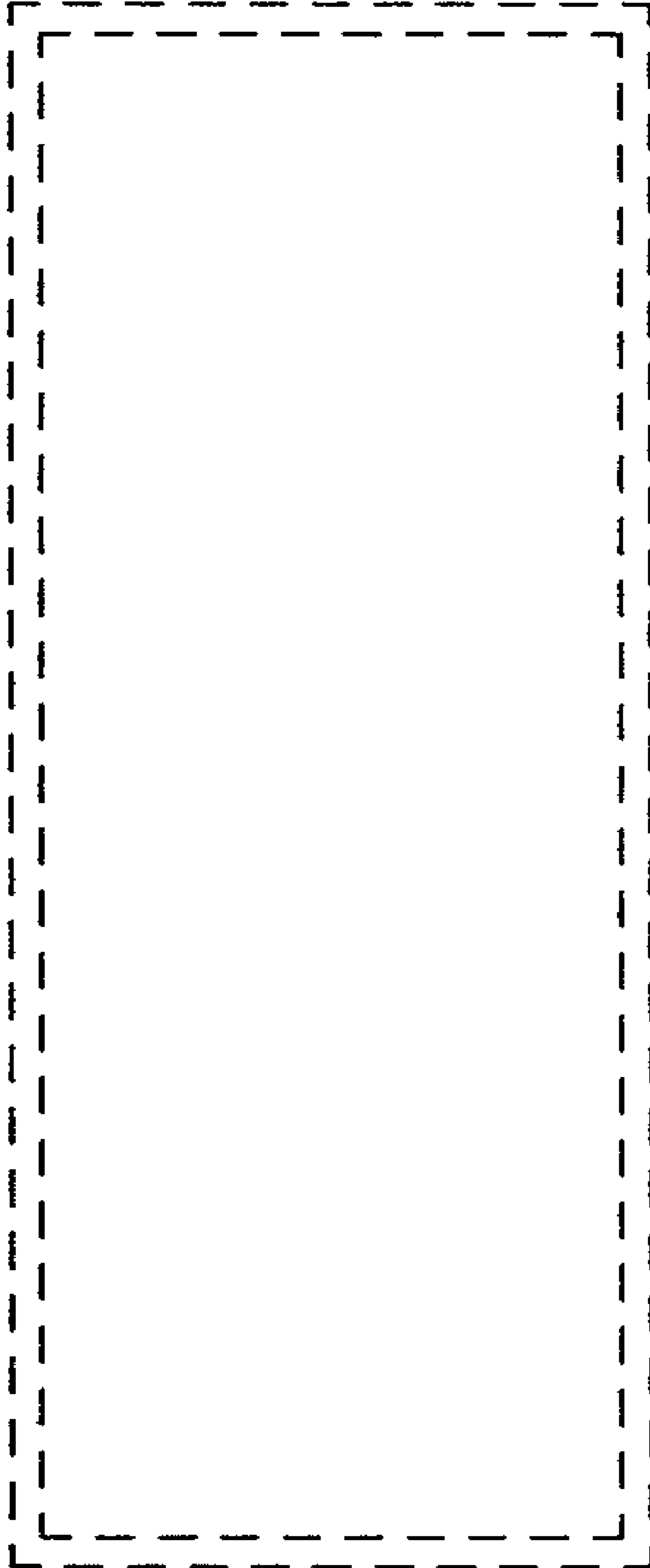

FIG. 11

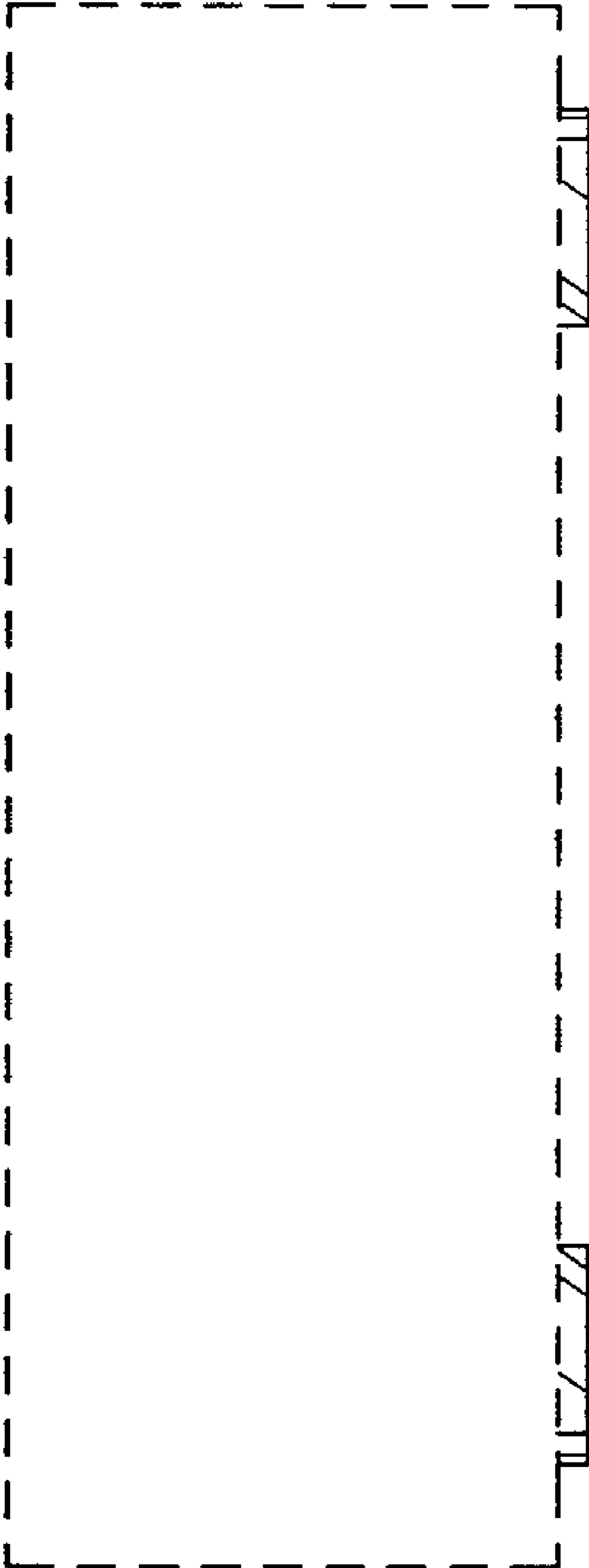

FIG. 12

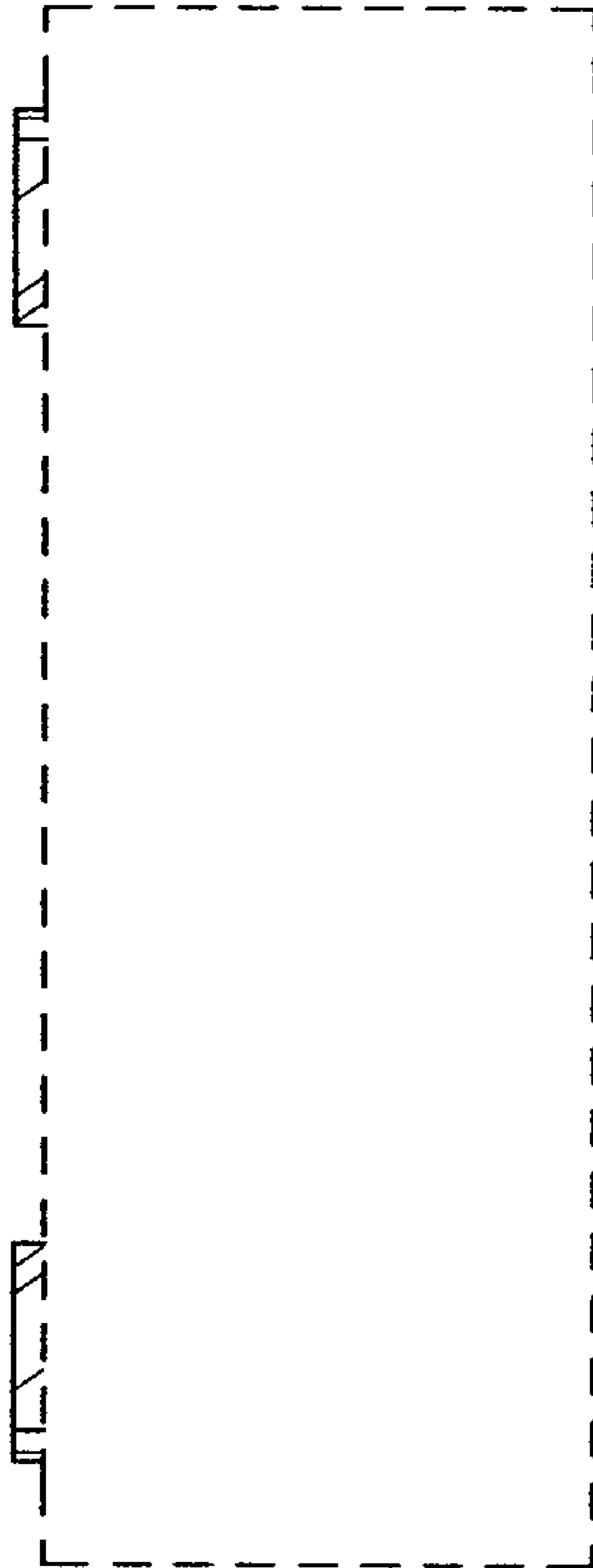

FIG. 13



FIG. 14

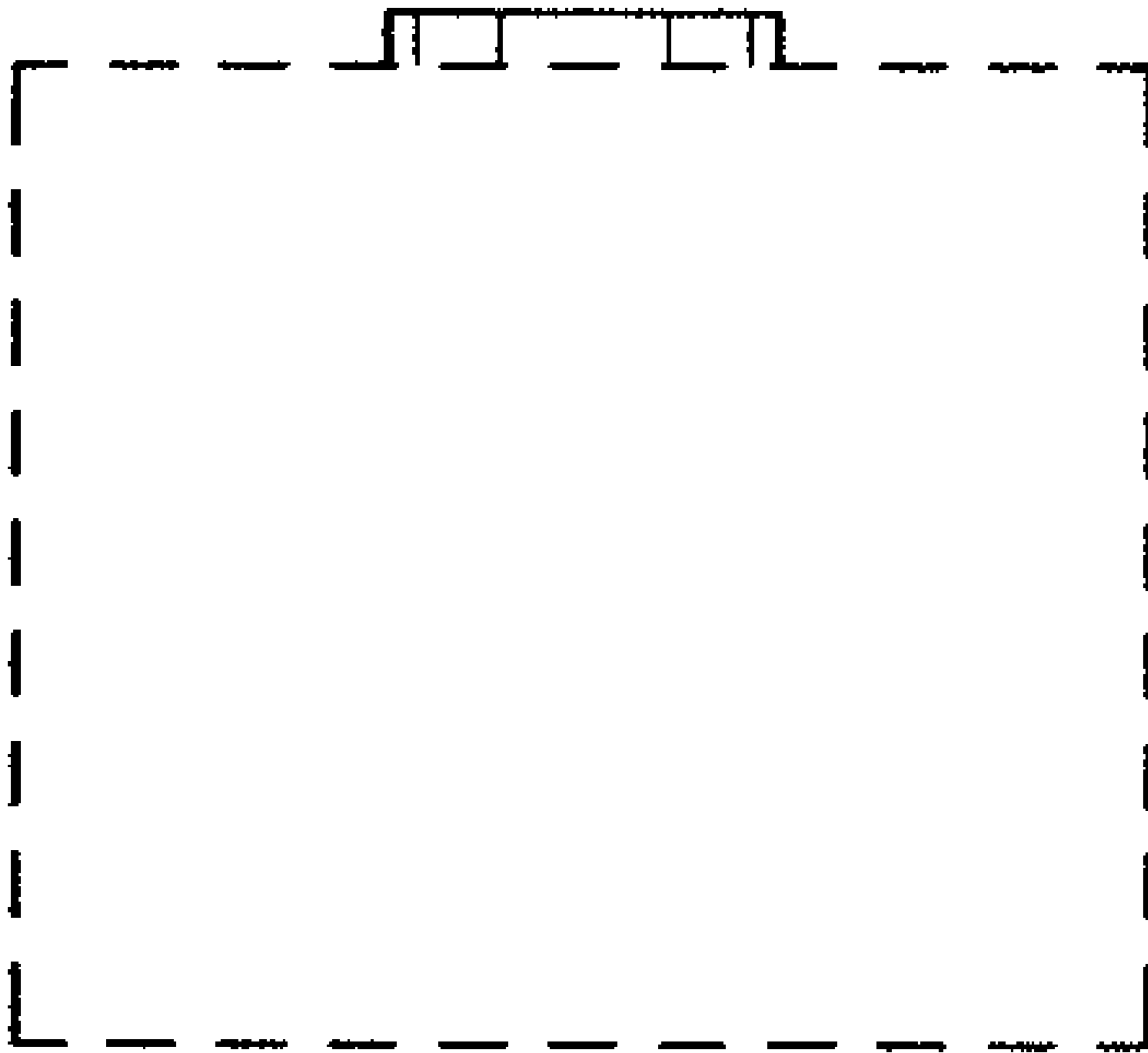

FIG. 15

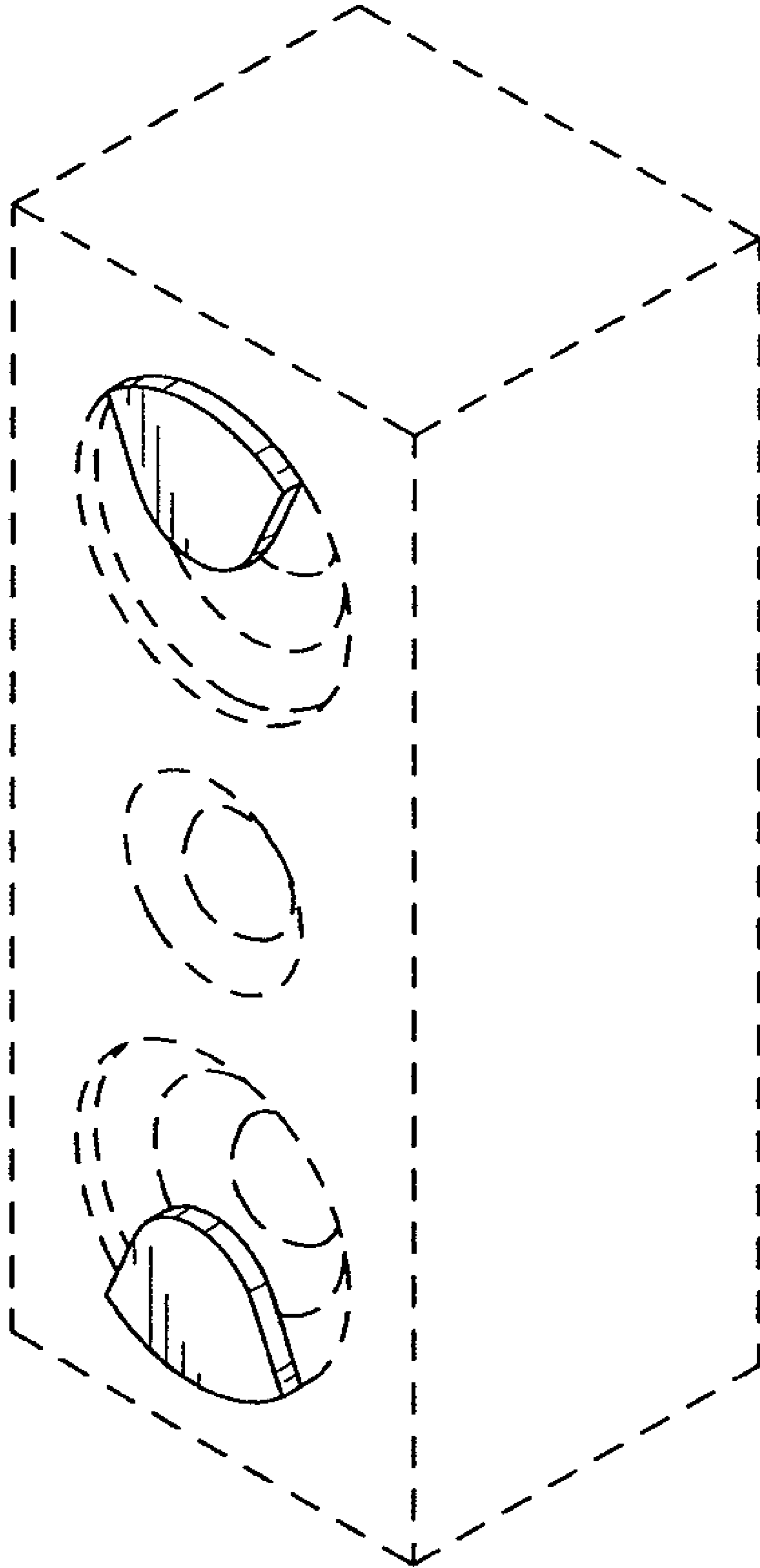

FIG. 16

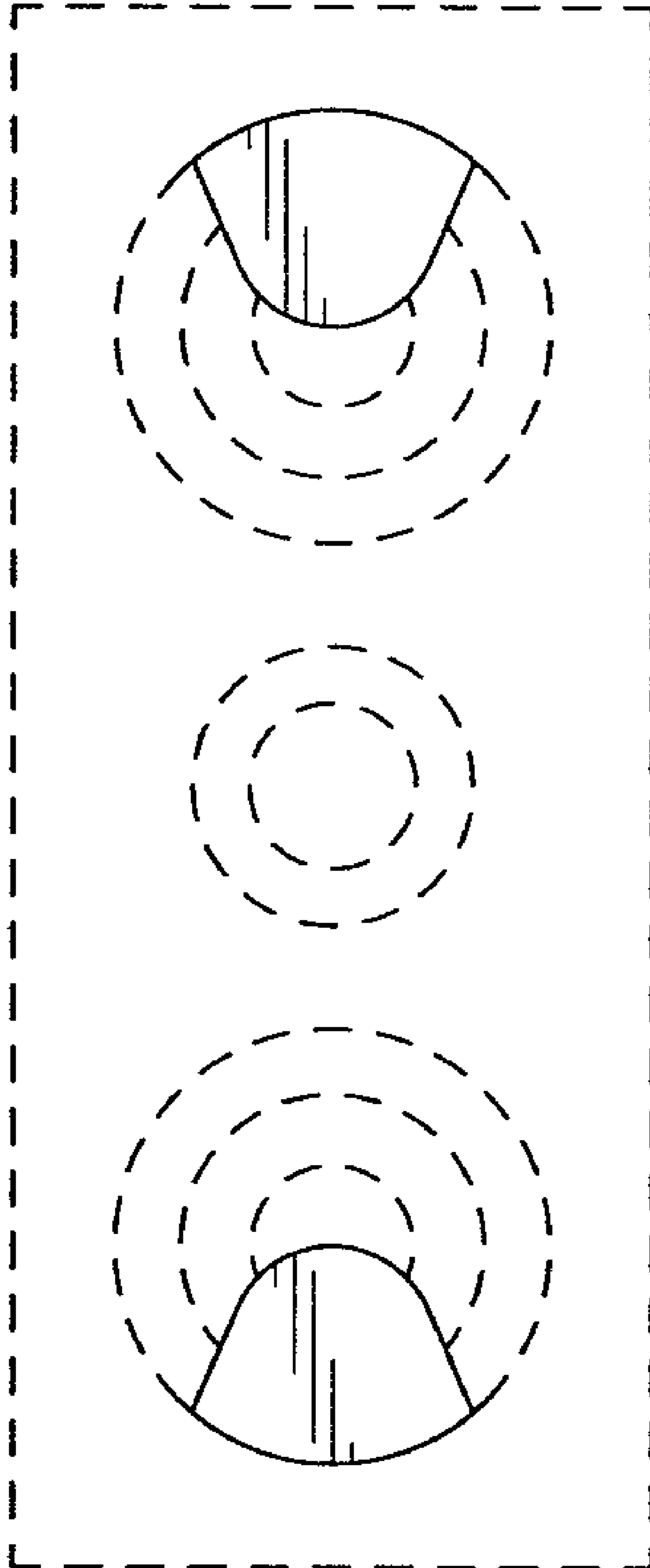

FIG. 17

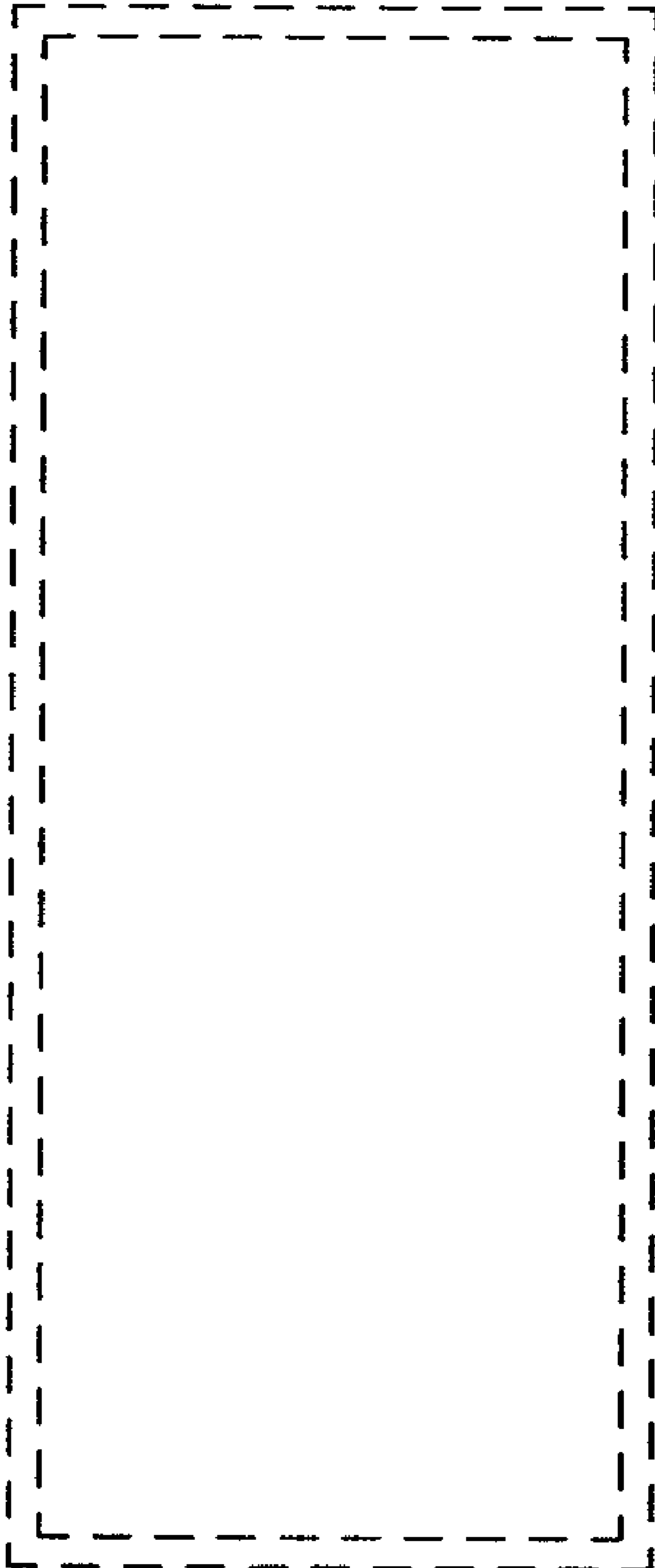

FIG. 18

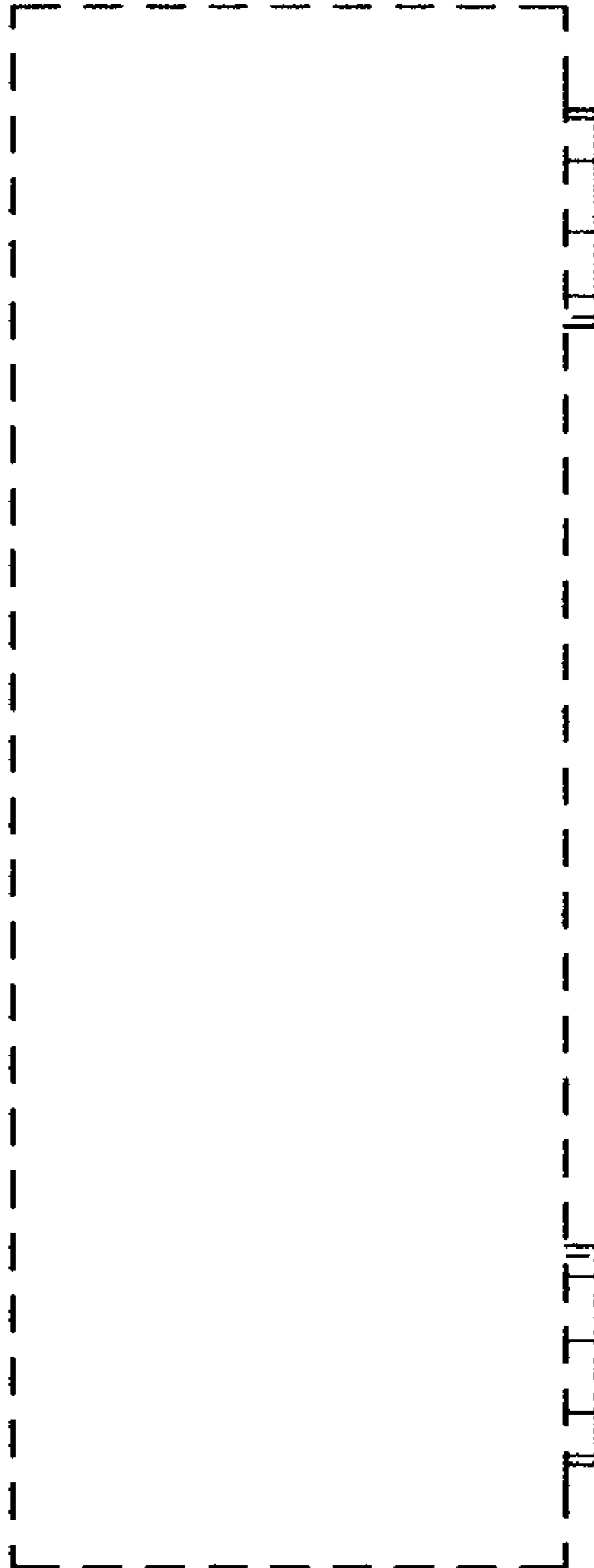

FIG. 19

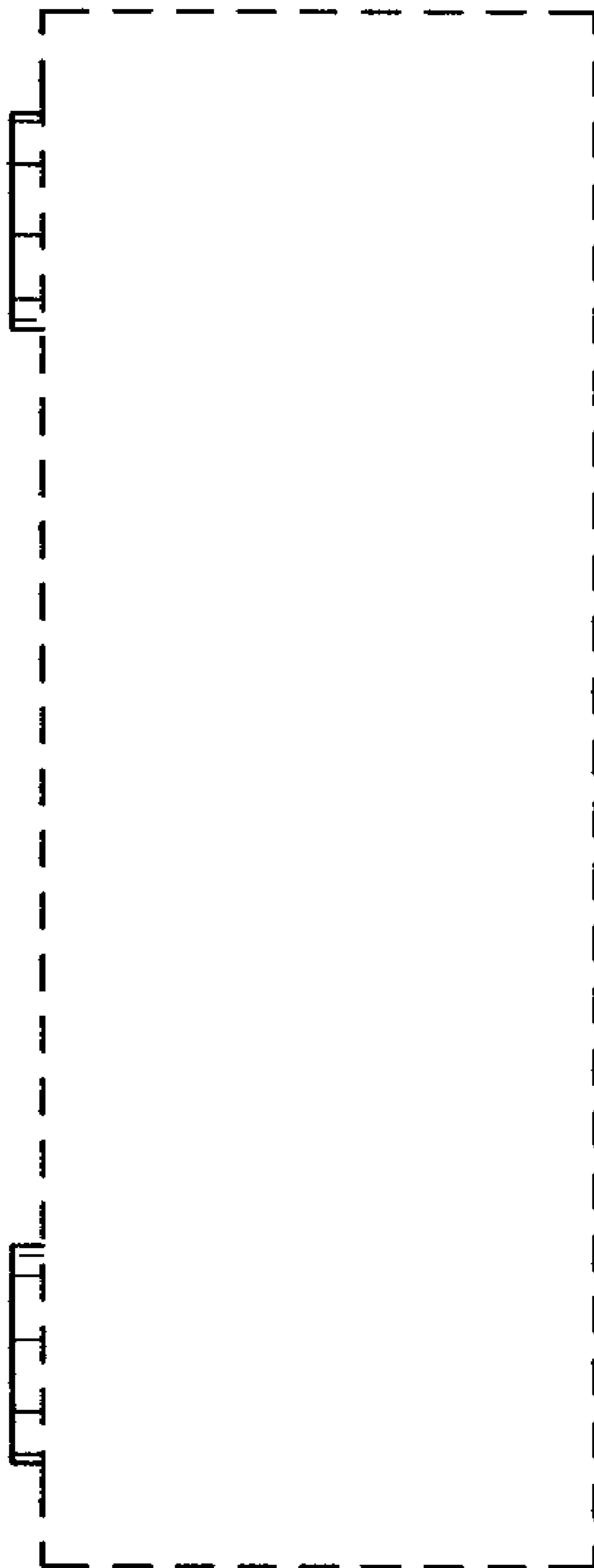

FIG. 20



FIG. 21

