



US00D597822S

(12) **United States Design Patent**
Olsen

(10) **Patent No.:** **US D597,822 S**
(45) **Date of Patent:** **** Aug. 11, 2009**

(54) **FITTING**

(75) Inventor: **Steen Olsen**, Fredericia (DK)

(73) Assignee: **BSI. A/S** (DK)

(**) Term: **14 Years**

(21) Appl. No.: **29/282,223**

(22) Filed: **Jul. 13, 2007**

(30) **Foreign Application Priority Data**

Jan. 17, 2007 (EM) 000652995

(51) **LOC (9) Cl.** **08-05**

(52) **U.S. Cl.** **D8/356**

(58) **Field of Classification Search** D8/105,
D8/107, 333, 349, 354, 356, 358, 360, 360.1,
D8/367, 373, 382, 383, 394-396, 400; D23/261;
D26/38; 24/18, 197, 561; 174/153 G, 650,
174/656; 242/400.1, 405.1, 405.2, 600, 603,
242/604, 604.1, 607, 608, 608.6, 608.7, 609,
242/916; 248/65, 74.1-74.4, 201, 214, 215,
248/229.26, 302, 304, 316.7, 316.8; 439/501,
439/535; 16/2.1; D13/147

See application file for complete search history.

(56) **References Cited**

U.S. PATENT DOCUMENTS

2,521,226 A * 9/1950 Keller 242/395
D160,994 S * 11/1950 Brummel D8/367
2,856,470 A * 10/1958 Hyde 191/12.4
4,360,177 A * 11/1982 Dulhunty 248/63
D269,410 S * 6/1983 Johansson D8/367

D270,329 S * 8/1983 Hardy D8/395
D293,881 S * 1/1988 Hartlmeier et al. D8/360
4,721,268 A * 1/1988 Lerner et al. 242/388
D298,214 S * 10/1988 Adachi D8/359
D360,530 S * 7/1995 Bobeczko D3/315
6,135,254 A * 10/2000 Liao 191/12.4
6,937,725 B2 * 8/2005 Liao 379/438
D539,122 S * 3/2007 Tsai D8/358

FOREIGN PATENT DOCUMENTS

NO 000179791-0001 * 5/2004

* cited by examiner

Primary Examiner—T. Chase Nelson

Assistant Examiner—Karen Acker

(74) *Attorney, Agent, or Firm*—St. Onge Steward Johnston & Reens LLC

(57) **CLAIM**

The ornamental design for fitting, as shown and described.

DESCRIPTION

FIG. 1 is a front, right side and top perspective view of a fitting in accordance with the new design;

FIG. 2 is a rear, left side and top perspective view thereof;

FIG. 3 is a rear elevation view thereof;

FIG. 4 is a front elevation view thereof;

FIG. 5 is a left side elevation view thereof;

FIG. 6 is a right side elevation view thereof; and,

FIG. 7 is a top plan view thereof.

The broken lines in the drawing represent the portions of the design that form no part of the claimed design.

1 Claim, 7 Drawing Sheets

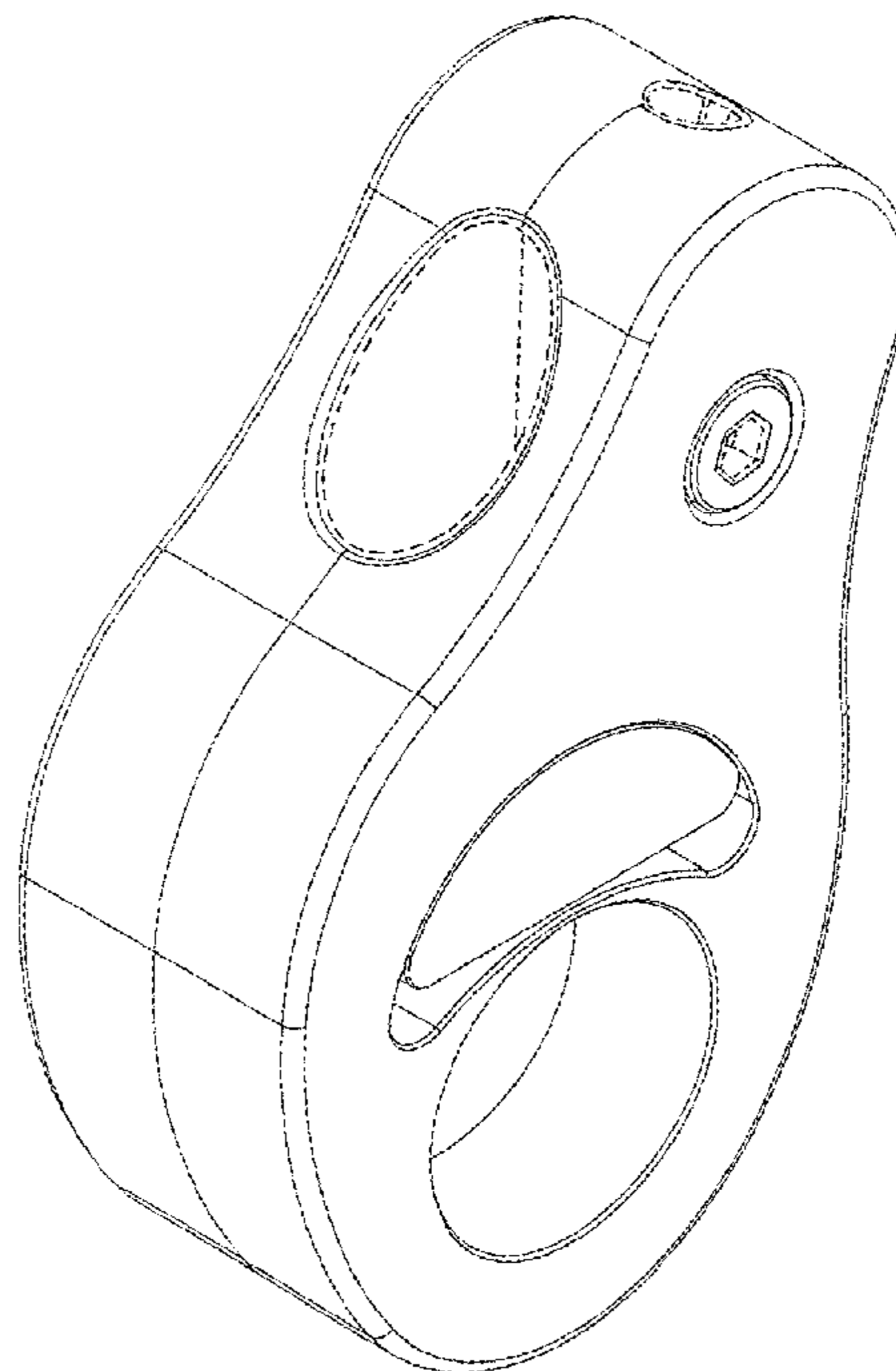

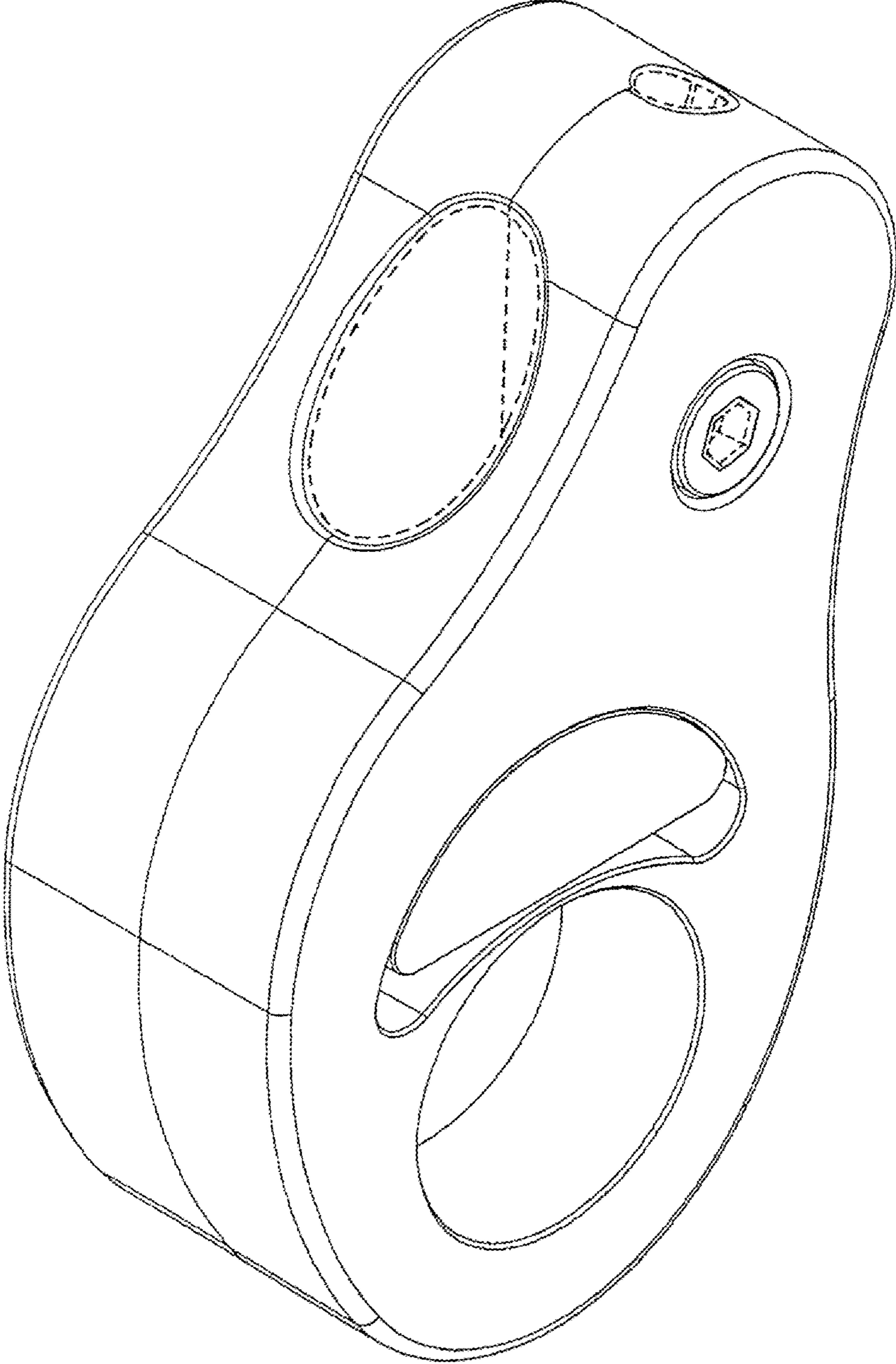

FIG. 1

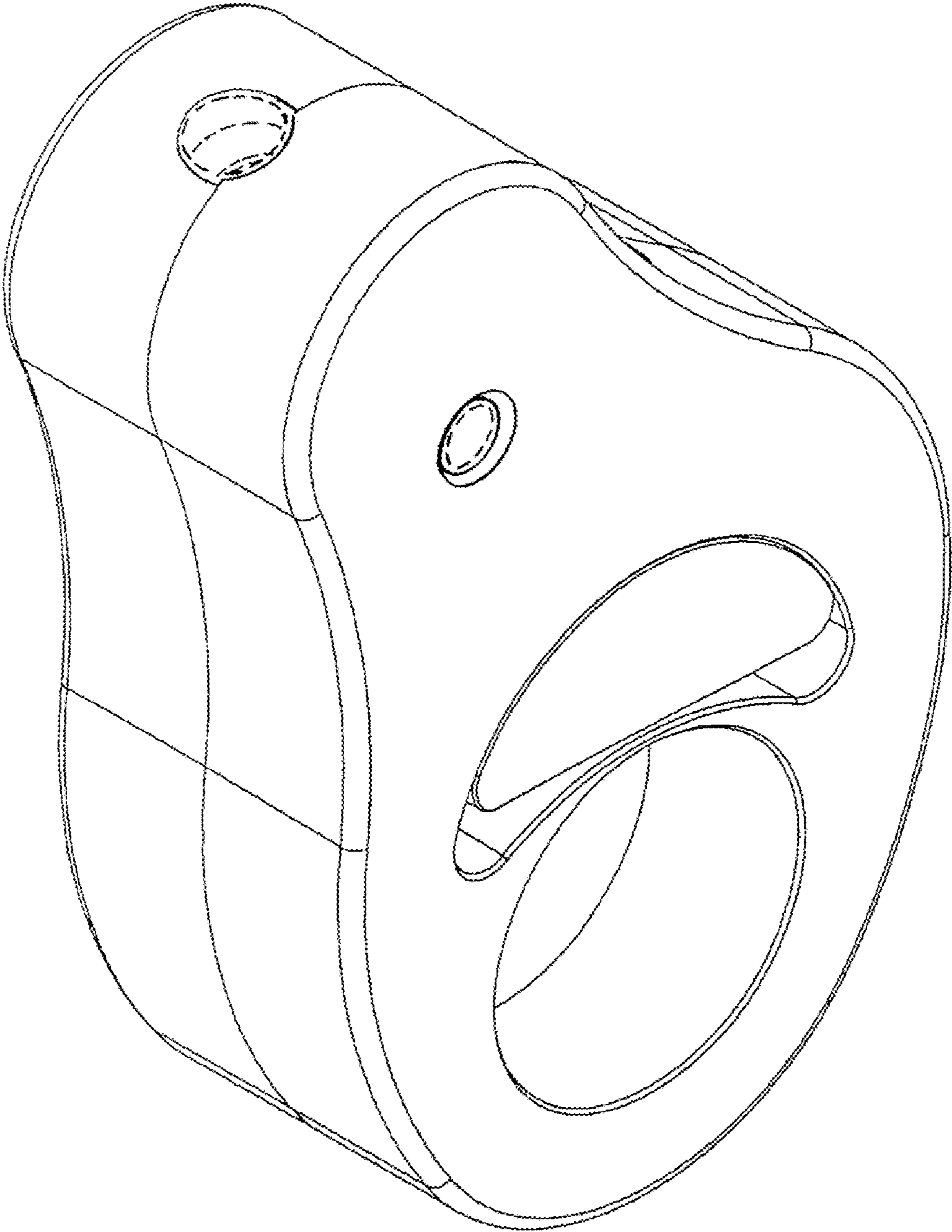

FIG. 2

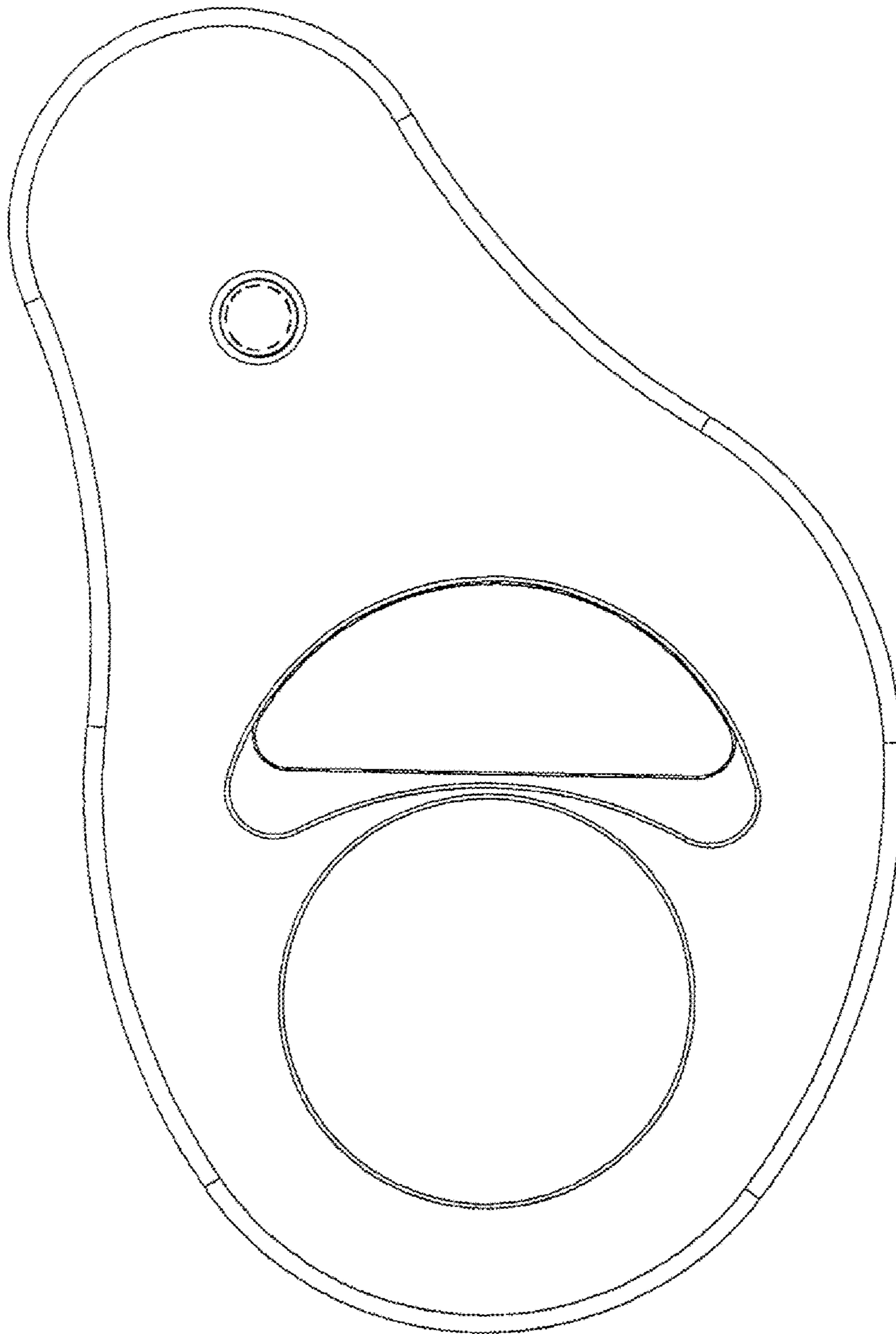

FIG. 3

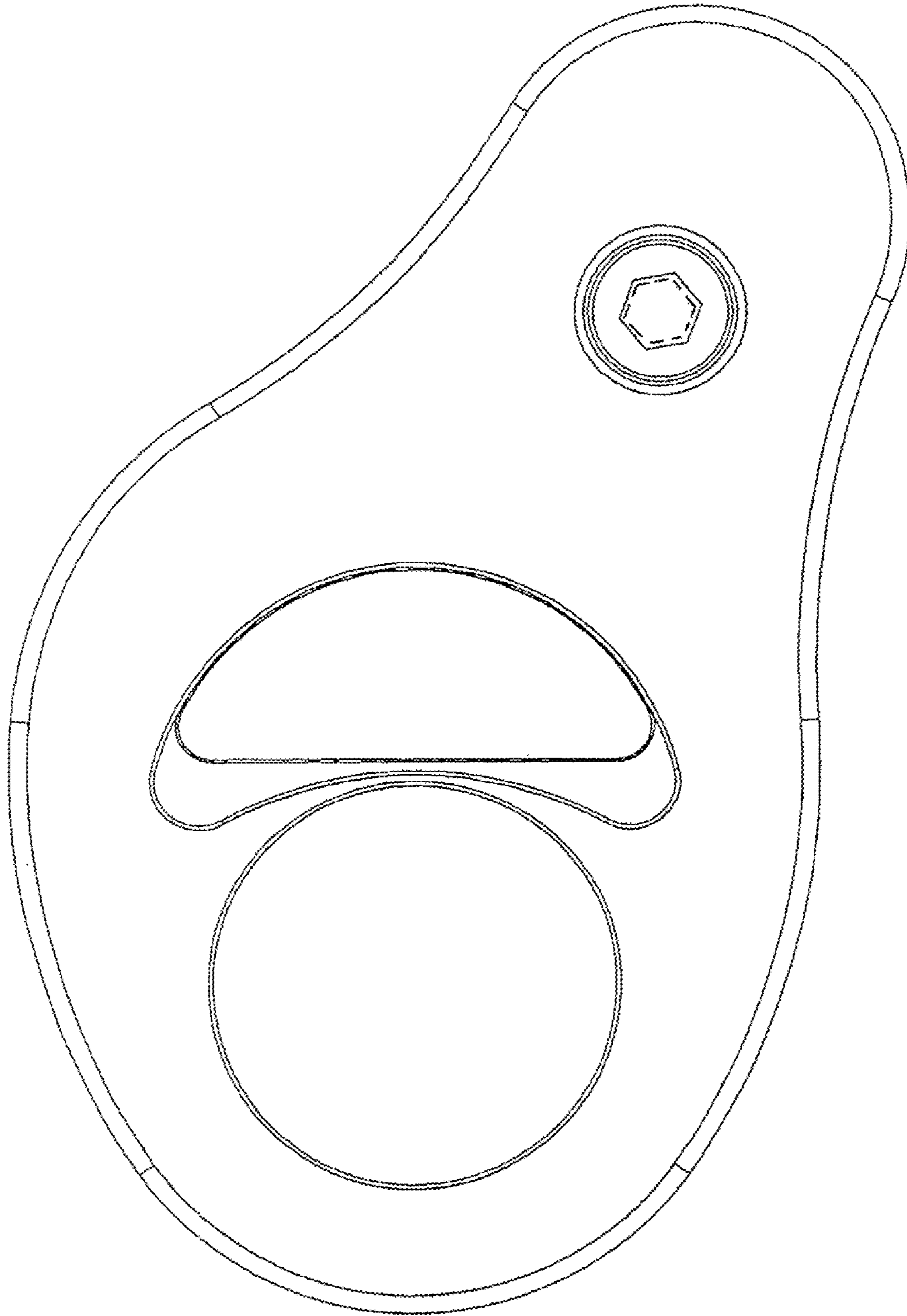

FIG. 4

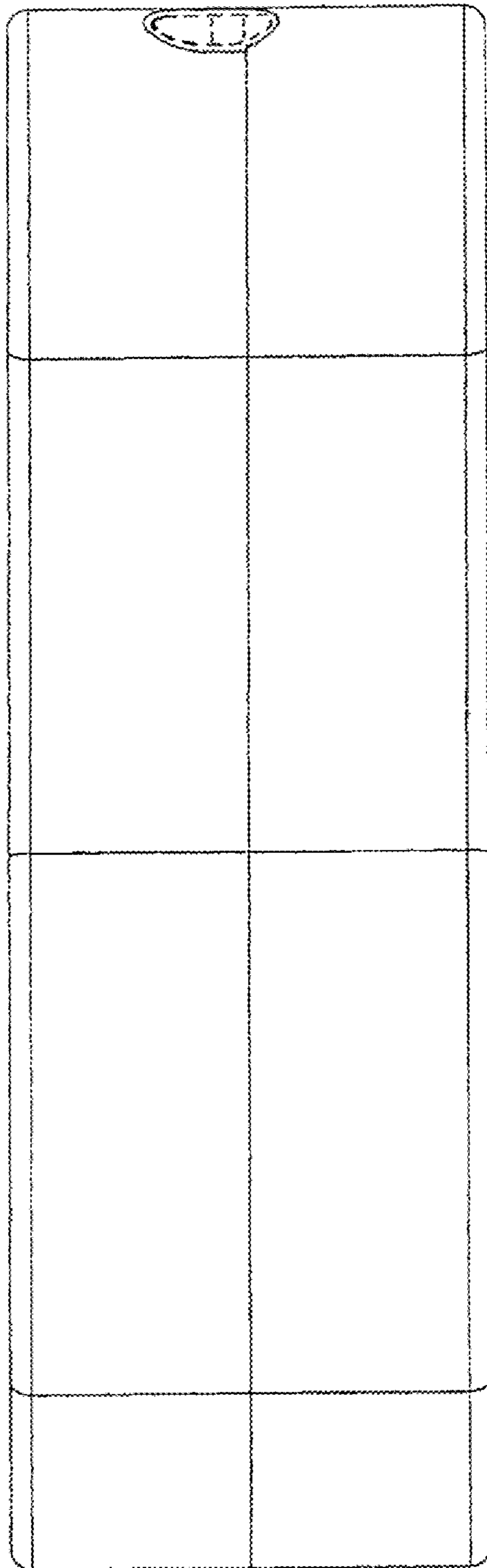

FIG. 5

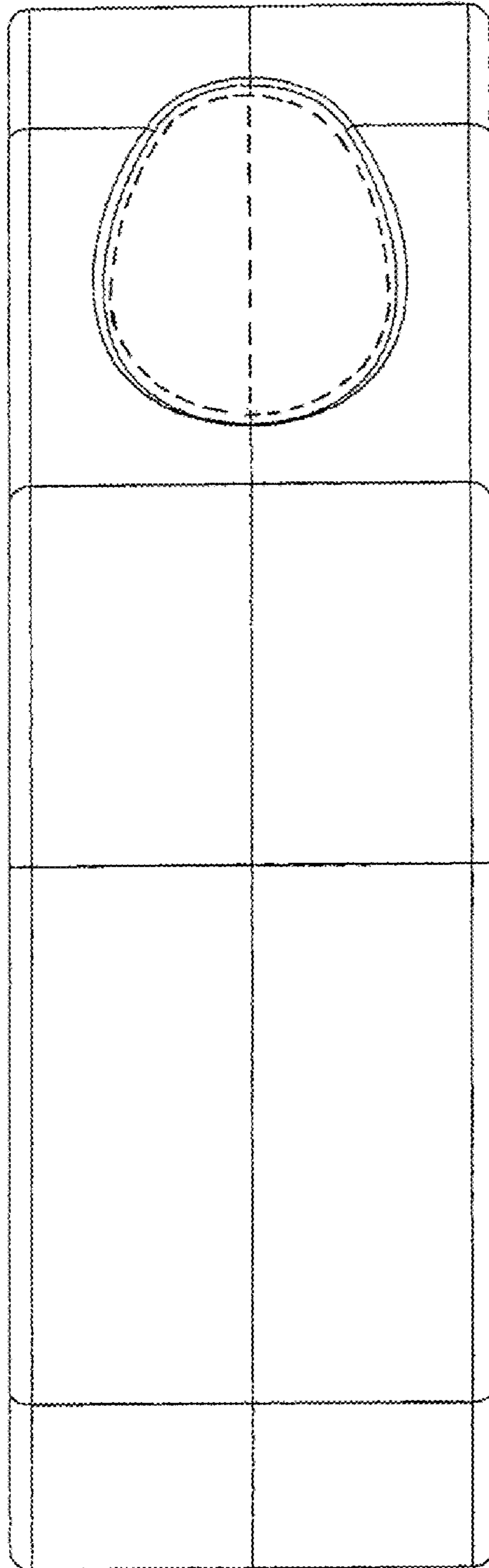

FIG. 6

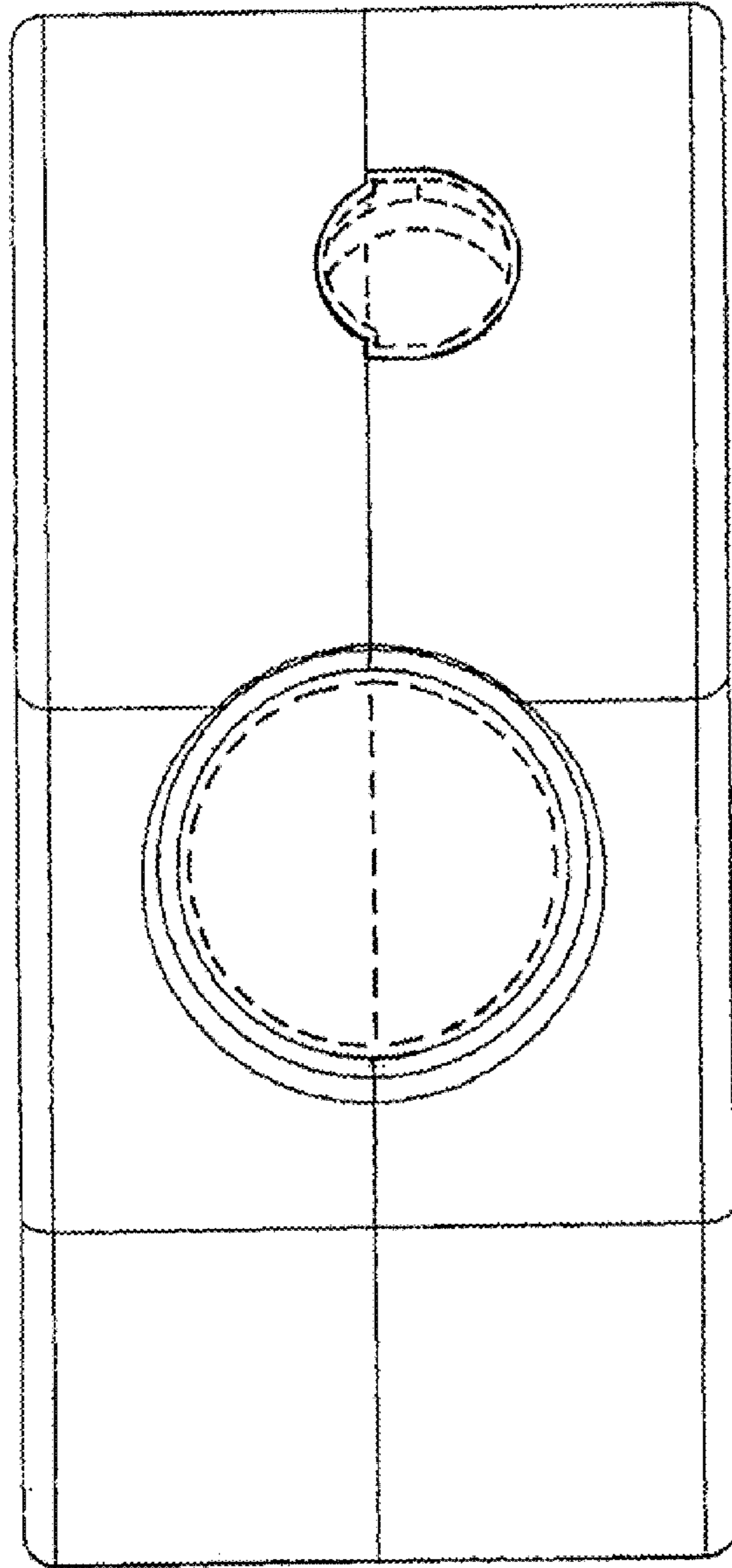

FIG. 7