



US00D597452S

(12) **United States Design Patent**  
**Nakajima et al.**

(10) **Patent No.:** **US D597,452 S**

(45) **Date of Patent:** **\*\* Aug. 4, 2009**

(54) **FRONT GRILLE FOR AN AUTOMOBILE**

D583,722 S \* 12/2008 Sonoda et al. .... D12/163

(75) Inventors: **Yoshiharu Nakajima**, Toyota (JP);  
**Kazuhiko Hasui**, Yokosuka (JP)

(73) Assignee: **Toyota Jidosha Kabushiki Kaisha** (JP)

(\*\*) Term: **14 Years**

(21) Appl. No.: **29/325,663**

(22) Filed: **Oct. 3, 2008**

(51) **LOC (9) Cl.** ..... **12-16**

(52) **U.S. Cl.** ..... **D12/163**

(58) **Field of Classification Search** ..... D12/163,  
D12/171, 196, 216, 90-92, 86; 180/68.1,  
180/68.6; 296/193.11

See application file for complete search history.

(56) **References Cited**

**U.S. PATENT DOCUMENTS**

- D558,104 S \* 12/2007 Hieke ..... D12/163
- D562,192 S \* 2/2008 Kushima et al. .... D12/163
- D565,480 S \* 4/2008 McMahan ..... D12/163
- D571,692 S \* 6/2008 Hayashi ..... D12/163
- D575,687 S \* 8/2008 Hatake ..... D12/163
- D575,689 S \* 8/2008 Chang et al. .... D12/163
- D579,829 S \* 11/2008 Hokao et al. .... D12/163

**OTHER PUBLICATIONS**

Toyota Corolla Axio, Brochure of Corolla Axio, Mar. 2008, Toyota Jidosha Kabushiki Kaisha.

Mazda Axela Sport, www.carsensor.net, Oct. 2003, Mazda Motor Corporation.

\* cited by examiner

*Primary Examiner*—Melody N Brown

(74) *Attorney, Agent, or Firm*—SAIDMAN DesignLaw Group

(57) **CLAIM**

The ornamental design for a front grille for an automobile, as shown and described.

**DESCRIPTION**

FIG. 1 is a perspective view of a front grille for an automobile showing our new design;

FIG. 2 is a front view thereof;

FIG. 3 is a rear view thereof;

FIG. 4 is a top view thereof;

FIG. 5 is a bottom view thereof;

FIG. 6 is a right-side thereof; and,

FIG. 7 is a left-side view thereof.

**1 Claim, 2 Drawing Sheets**



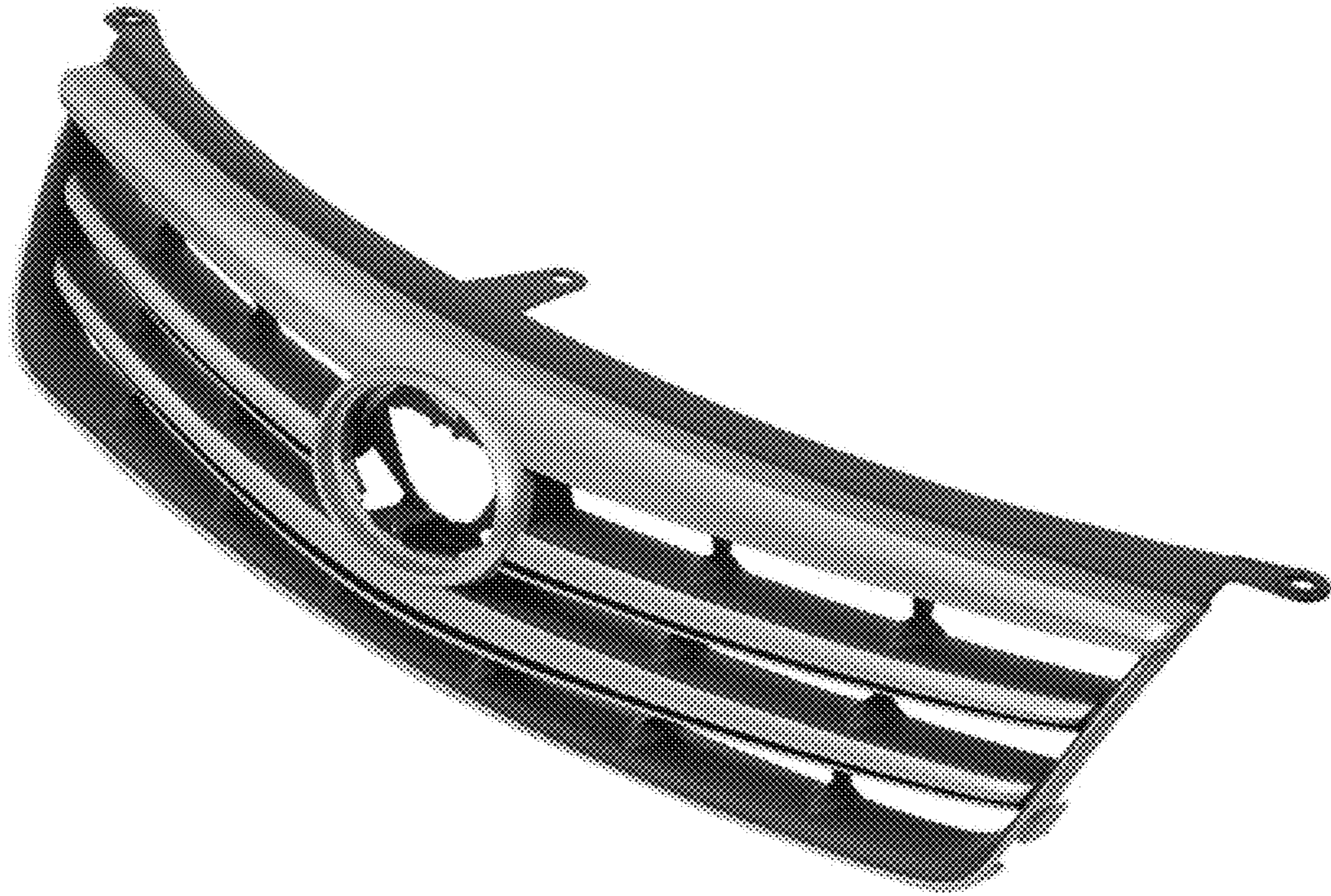

Fig. 1

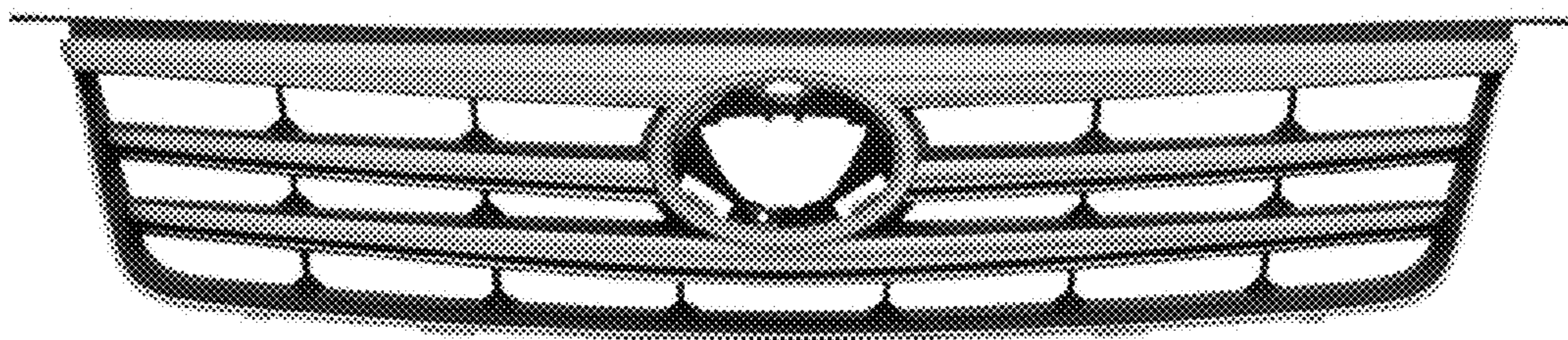

Fig. 2

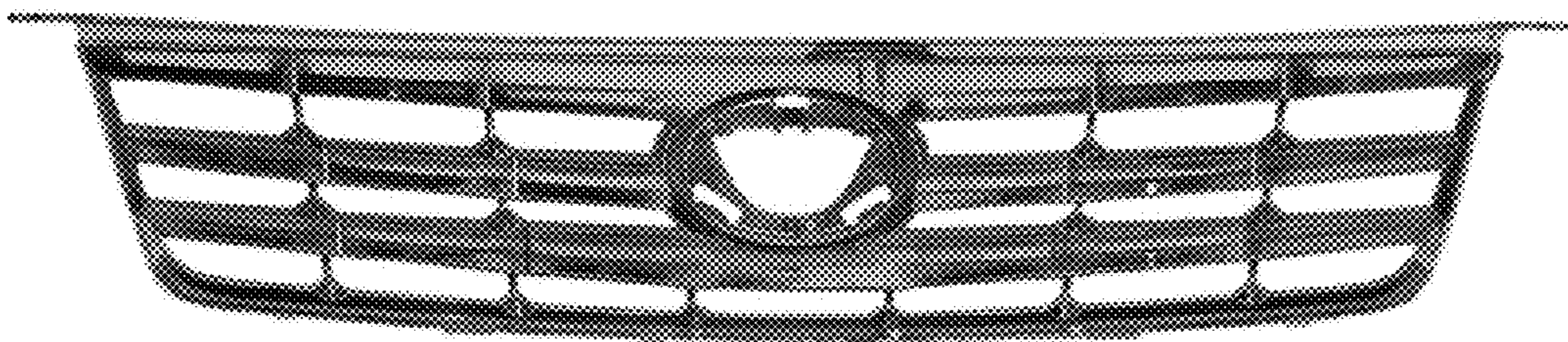

Fig. 3

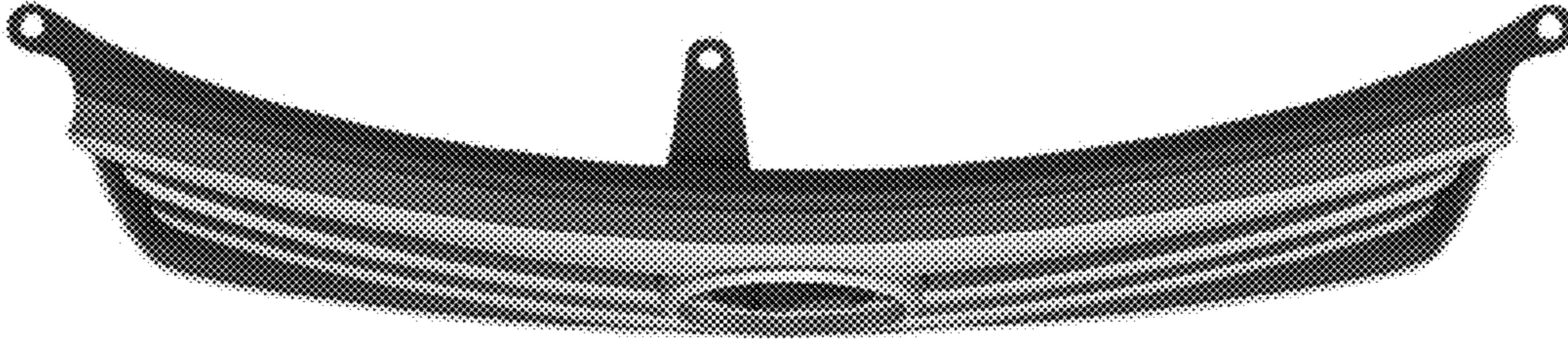

Fig. 4

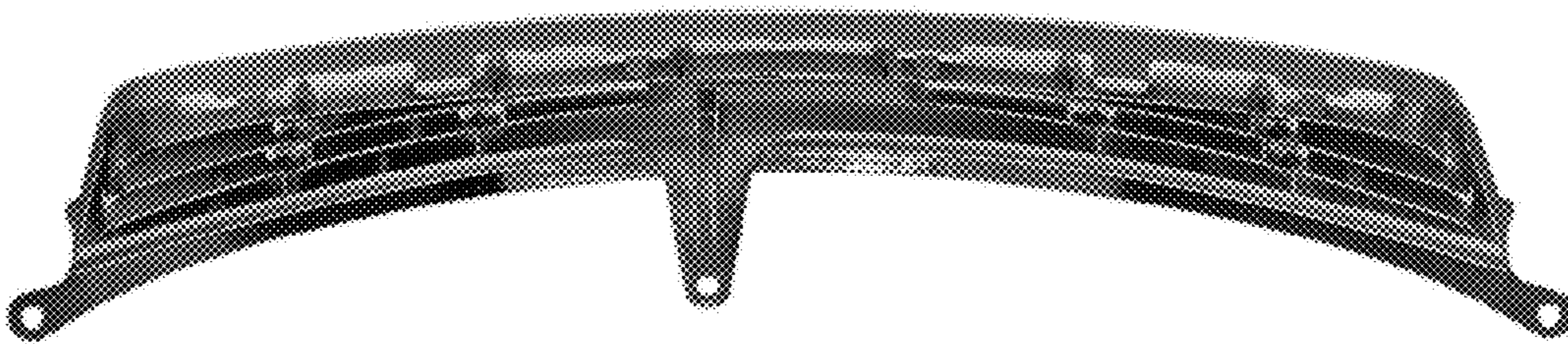

Fig. 5



Fig. 6

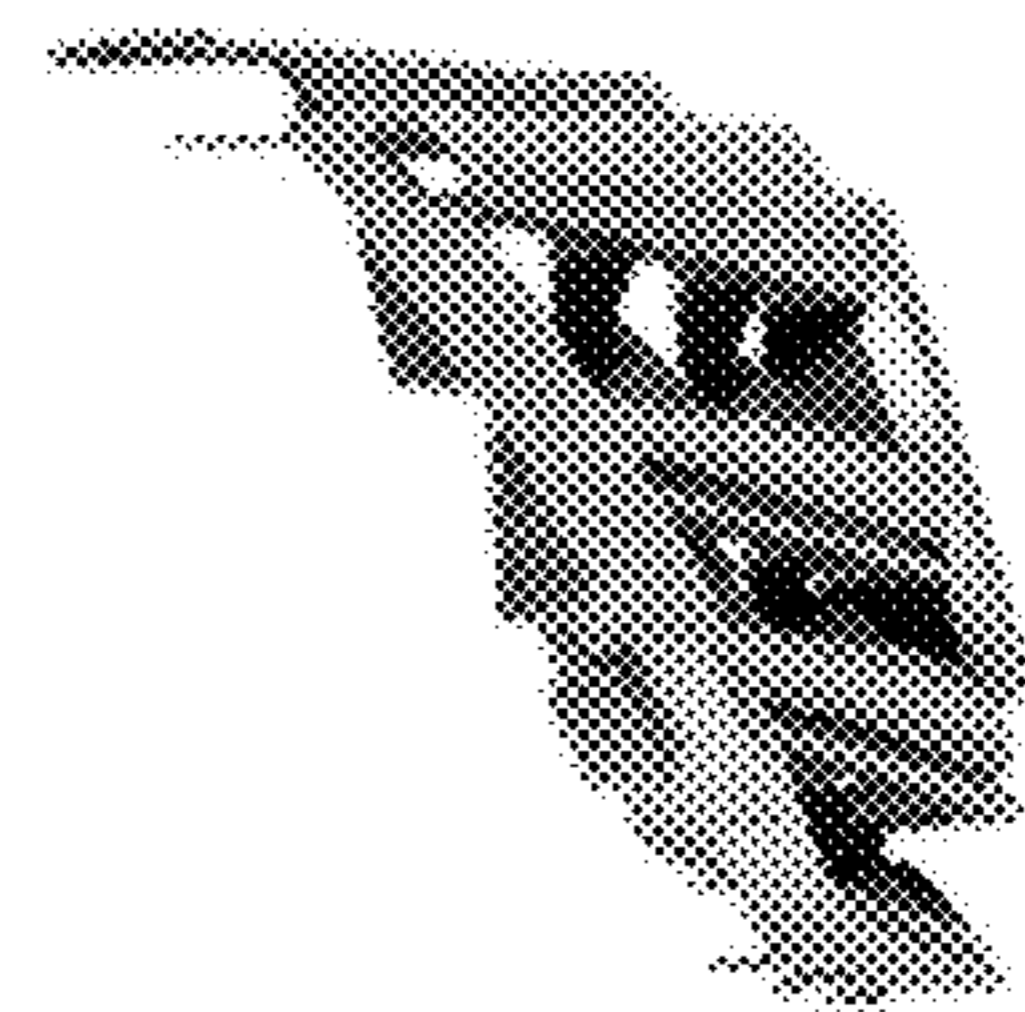

Fig. 7