



US00D597375S

(12) **United States Design Patent**
Wroblewski

(10) **Patent No.:** **US D597,375 S**

(45) **Date of Patent:** **** Aug. 4, 2009**

(54) **SET OF INTERLOCKING MUGS**

(76) **Inventor:** **Mariusz Wroblewski**, 72 Hill Station Rd., Southampton, NY (US) 11968

(**) **Term:** **14 Years**

(21) **Appl. No.:** **29/310,300**

(22) **Filed:** **Aug. 8, 2008**

(51) **LOC (9) Cl.** **07-01**

(52) **U.S. Cl.** **D7/505; D7/536**

(58) **Field of Classification Search** D7/505,
D7/536, 547, 600, 533, 509, 500, 538, 510,
D7/511, 602, 523, 300, 532, 622; D9/424-432;
222/205; 215/387, DIG. 7, 396; 220/703,
220/592.16, 592.17, 758

See application file for complete search history.

(56) **References Cited**

U.S. PATENT DOCUMENTS

| | | | | |
|---------------|---------|-----------------|-------|-----------|
| D16,522 S * | 2/1886 | Scanlon | | D18/32 |
| D158,558 S * | 5/1950 | Denn et al. | | D7/536 |
| 2,892,540 A * | 6/1959 | Tupper | | 206/427 |
| 4,230,235 A * | 10/1980 | Di Amico | | 220/710.5 |
| D292,157 S * | 10/1987 | Robinson | | D7/505 |
| D293,640 S * | 1/1988 | Perry et al. | | D7/553.6 |
| 4,907,719 A * | 3/1990 | Spotholz et al. | | 222/1 |
| D309,545 S * | 7/1990 | Ancona et al. | | D7/507 |
| D345,674 S * | 4/1994 | Charland | | D7/507 |

| | | | | |
|--------------|---------|-----------------|-------|----------|
| D345,675 S * | 4/1994 | Charland | | D7/536 |
| D347,547 S * | 6/1994 | Heinrich | | D7/533 |
| D351,315 S * | 10/1994 | van Stolk | | D7/536 |
| D439,304 S * | 3/2001 | Tilp et al. | | D23/209 |
| D479,692 S * | 9/2003 | Nilsson | | D10/46.2 |
| D491,063 S * | 6/2004 | Hicks et al. | | D9/443 |
| D532,082 S * | 11/2006 | Cimbura | | D23/233 |
| D583,625 S * | 12/2008 | Martinez et al. | | D7/507 |

* cited by examiner

Primary Examiner—Robert M Spear

Assistant Examiner—Cynthia Underwood

(57) **CLAIM**

I claim the original design for a “set of interlocking mugs,” as shown.

DESCRIPTION

FIG. 1 is a side view of the single mug from FIG. 5

FIG. 2 is a top view of the single mug from FIG. 5

FIG. 3 is a bottom view of a single mug from the set, 5 all other mugs being identical with the sole exception of the color;

FIG. 4 is a perspective view of the single mug from FIG. 5

FIG. 5 is a top view of the set in an assembled state; and,

FIG. 6 is a perspective view of the set in an assembled state.

The broken line showing of the logo in FIG. 3 forms no part of the claim.

1 Claim, 2 Drawing Sheets

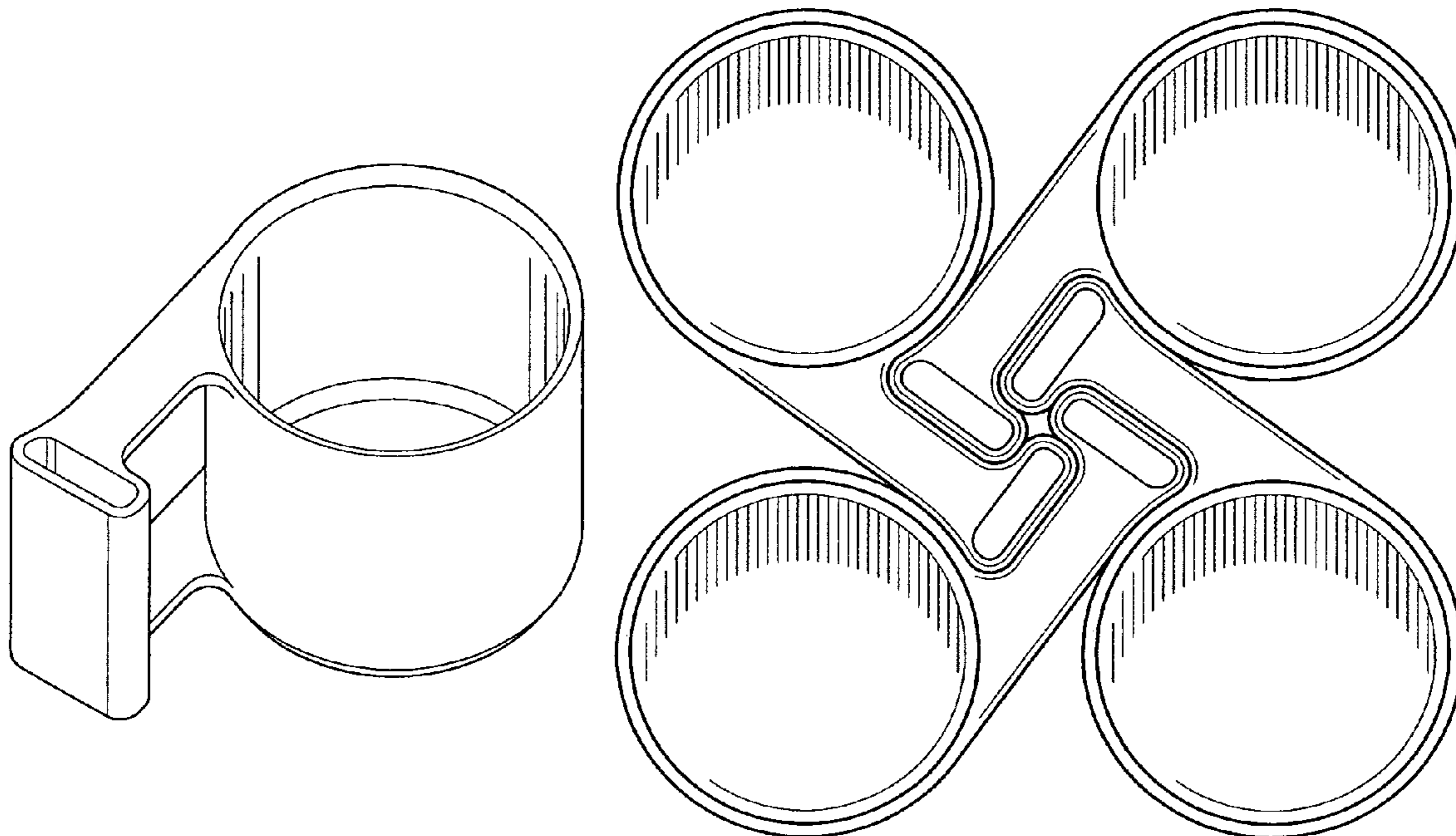

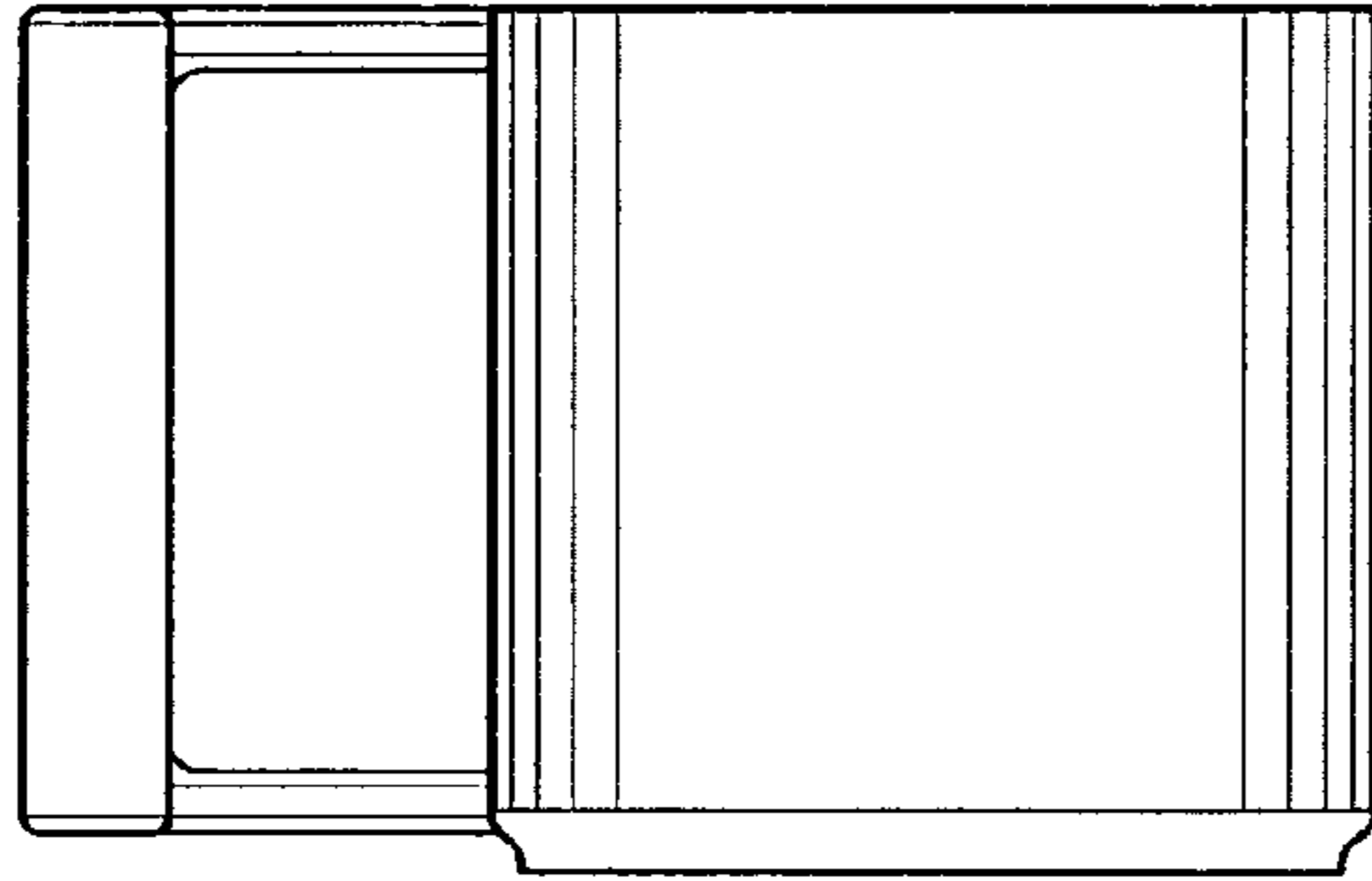

FIG. 1

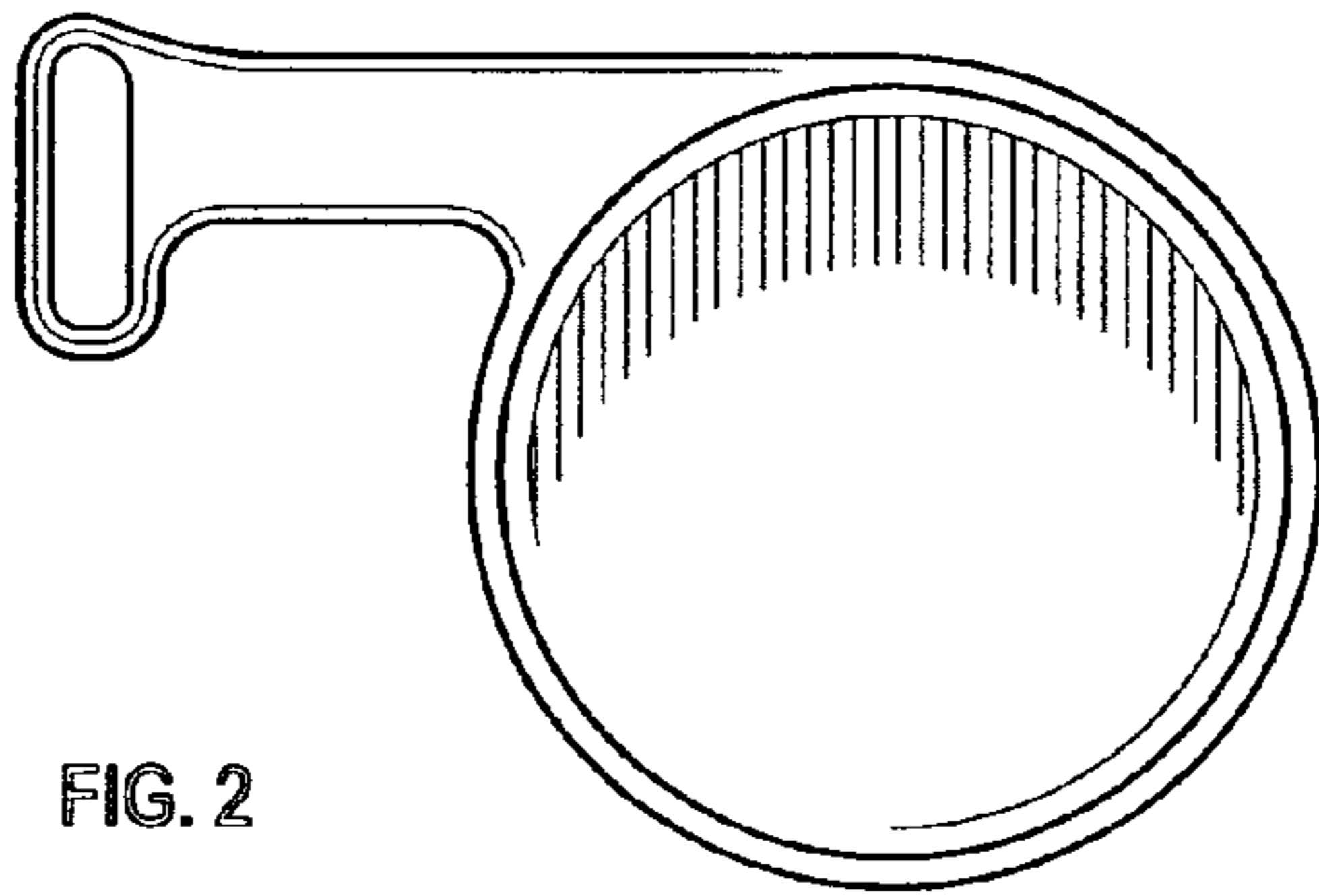

FIG. 2

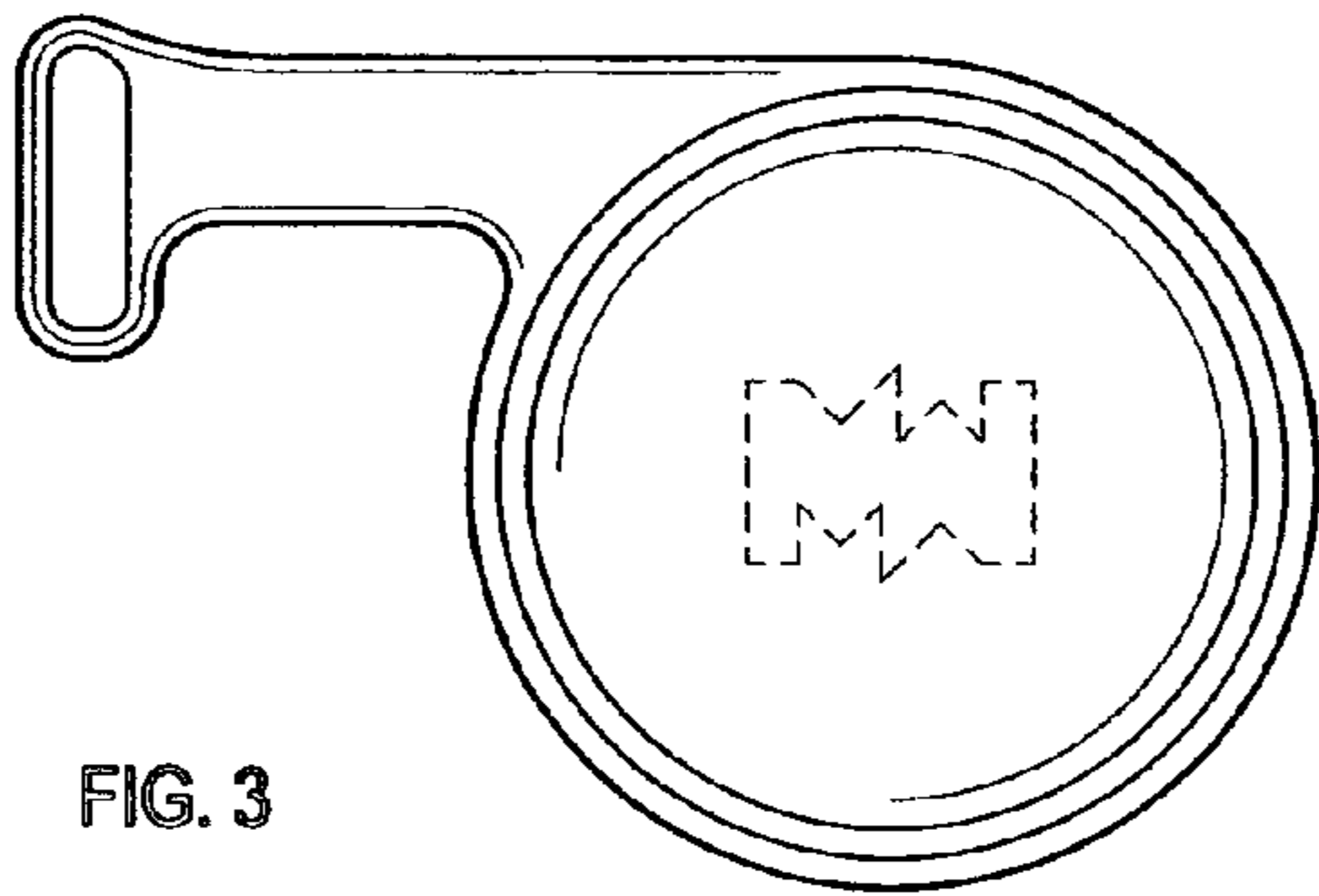

FIG. 3

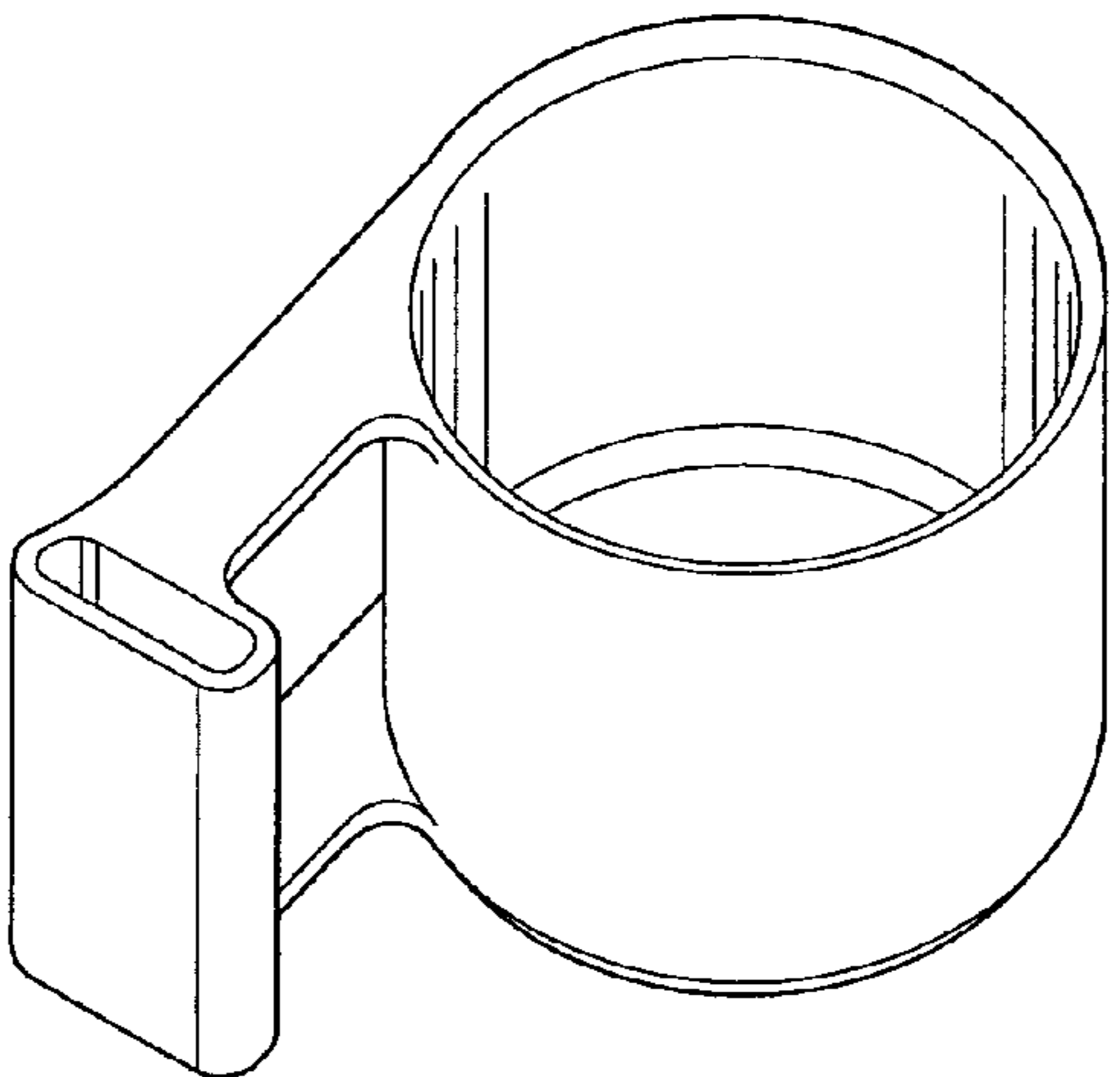

FIG. 4

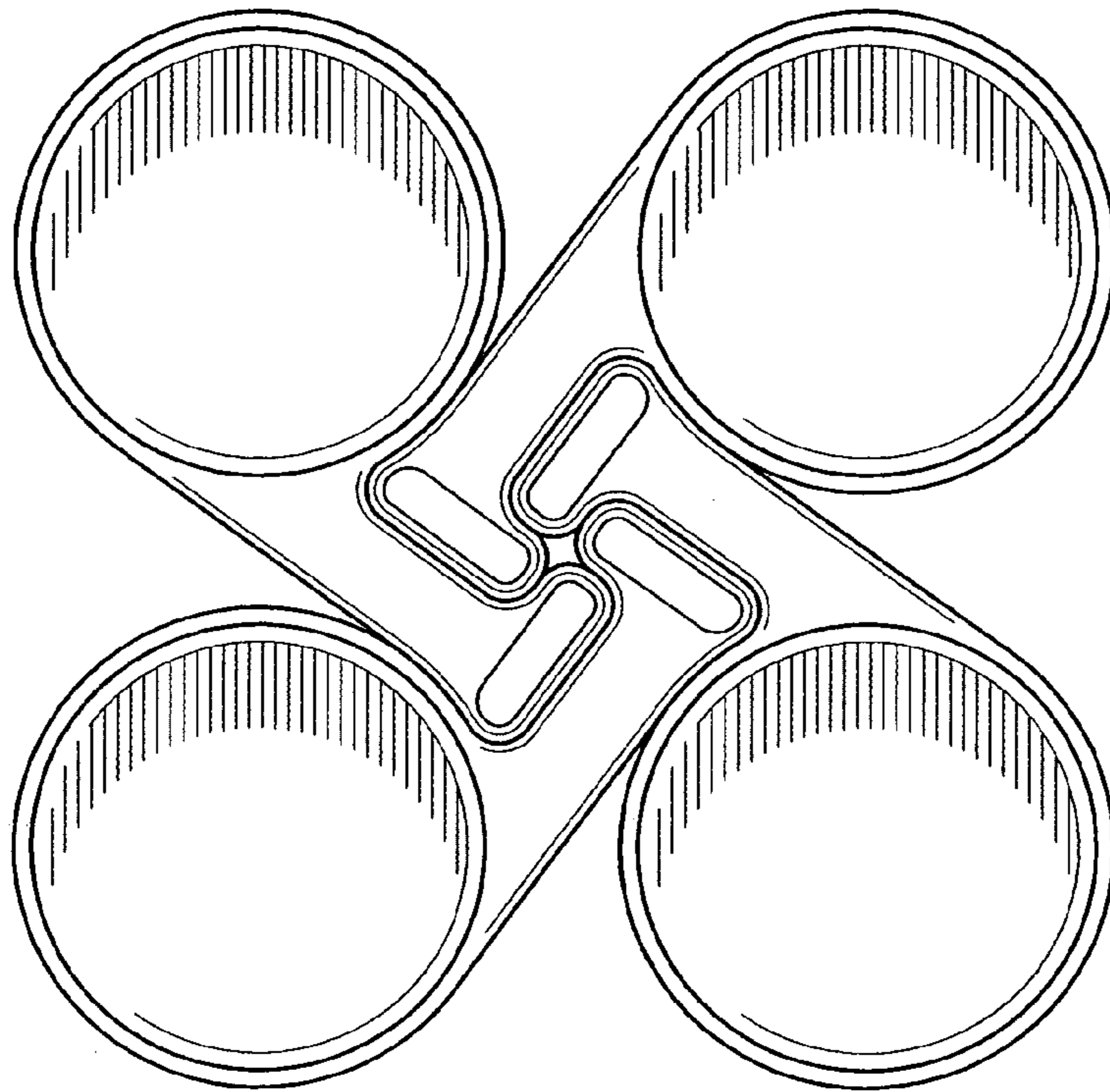

FIG. 5

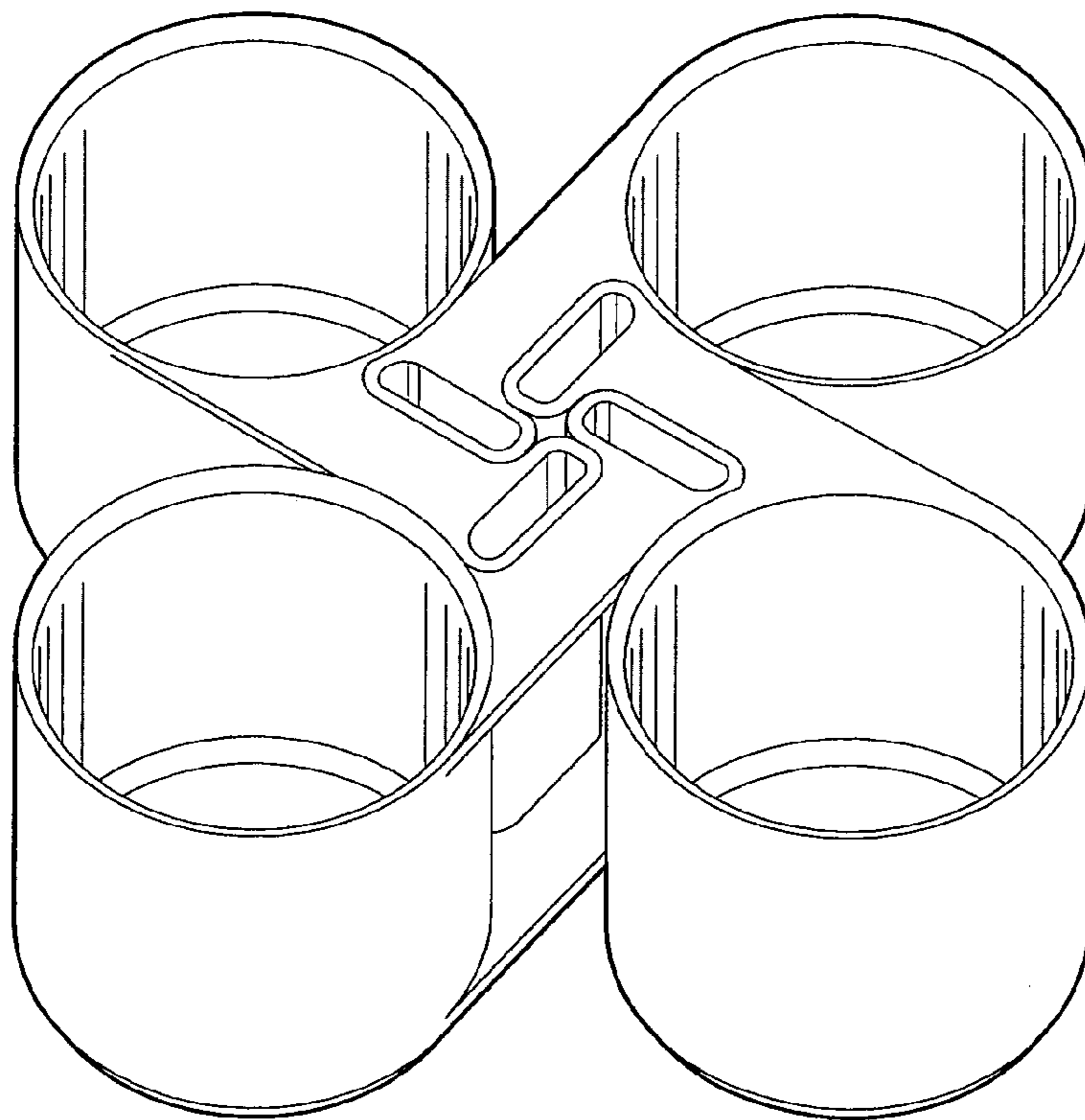

FIG. 6