

US00D596080S

(12) **United States Design Patent**  
**Lai et al.**

(10) **Patent No.:** **US D596,080 S**  
(45) **Date of Patent:** **\*\* Jul. 14, 2009**

(54) **ALL TERRAIN VEHICLE**

(75) Inventors: **Guogui Lai**, Zhejiang Province (CN);  
**Hongwei Fu**, Zhejiang Province (CN);  
**Youheng Qian**, Zhejiang Province (CN);  
**Zhangping Yuan**, Zhejiang Province (CN);  
**Jun Zhao**, Zhejiang Province (CN);  
**Minqiang Xiong**, Zhejiang Province (CN);  
**Hui Xu**, Zhejiang Province (CN)

(73) Assignees: **Chungfeng Holding Group Hangzhou Motorcycles Manufacturing Co., Ltd.**, Hangzhou, Zhejiang Province (CN);  
**Hangzhou Hexin Auto Sales Co., Ltd.**, Hangzhou, Zhejiang Province (CN)

(\*\*) Term: **14 Years**

(21) Appl. No.: **29/298,156**

(22) Filed: **Nov. 29, 2007**

(30) **Foreign Application Priority Data**

Jun. 15, 2007 (CN) ..... 2007 3 0119945

(51) **LOC (9) Cl.** ..... **12-11**

(52) **U.S. Cl.** ..... **D12/107**

(58) **Field of Classification Search** ..... D12/3,  
D12/86, 87, 107, 110; 180/225, 229, 233,  
180/311, 312

See application file for complete search history.

(56) **References Cited**

**U.S. PATENT DOCUMENTS**

D516,467 S \* 3/2006 Wu ..... D12/107

D520,912 S \* 5/2006 Knight et al. .... D12/107  
D520,914 S \* 5/2006 Luh ..... D12/107  
D522,924 S \* 6/2006 Yokoyama et al. .... D12/107  
D529,414 S \* 10/2006 Wu et al. .... D12/107  
D542,186 S \* 5/2007 Lai et al. .... D12/107

\* cited by examiner

*Primary Examiner*—Cathron C Brooks

*Assistant Examiner*—Linda Brooks

(74) *Attorney, Agent, or Firm*—Patterson, Thunte, Skaar & Christensen, P.A.

(57) **CLAIM**

The ornamental design for an all terrain vehicle, as shown and described.

**DESCRIPTION**

FIG. 1 is a front view of the all terrain vehicle according to the invention.

FIG. 2 is a rear view of the all terrain vehicle according to the invention.

FIG. 3 is a left side view of the all terrain vehicle according to the invention.

FIG. 4 is a right side view of the all terrain vehicle according to the invention.

FIG. 5 is a top view of the all terrain vehicle according to the invention; and,

FIG. 6 is a perspective side view of the all terrain vehicle according to the invention.

The portions shown in broken lines form no part of the claimed design.

**1 Claim, 6 Drawing Sheets**

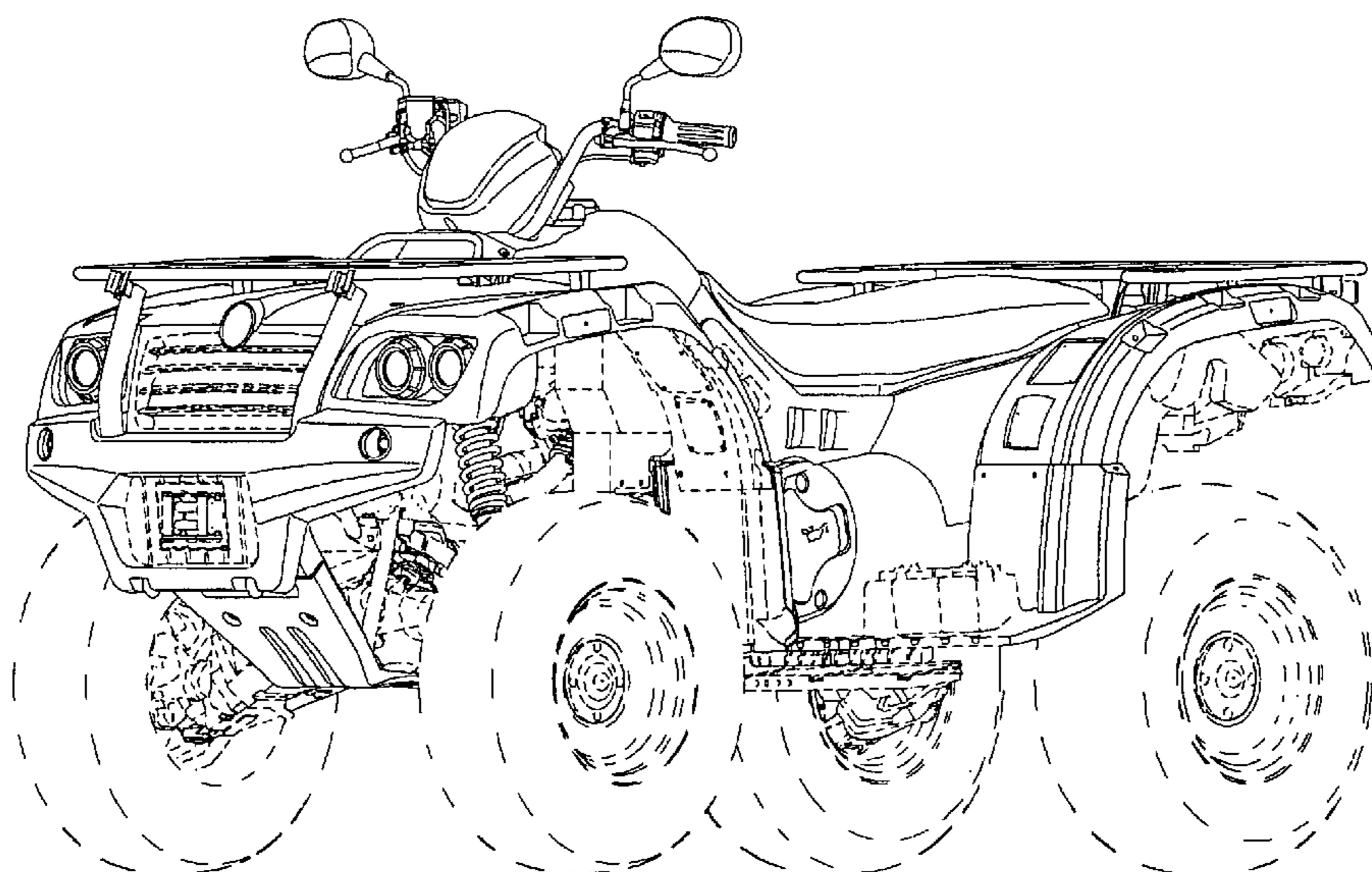

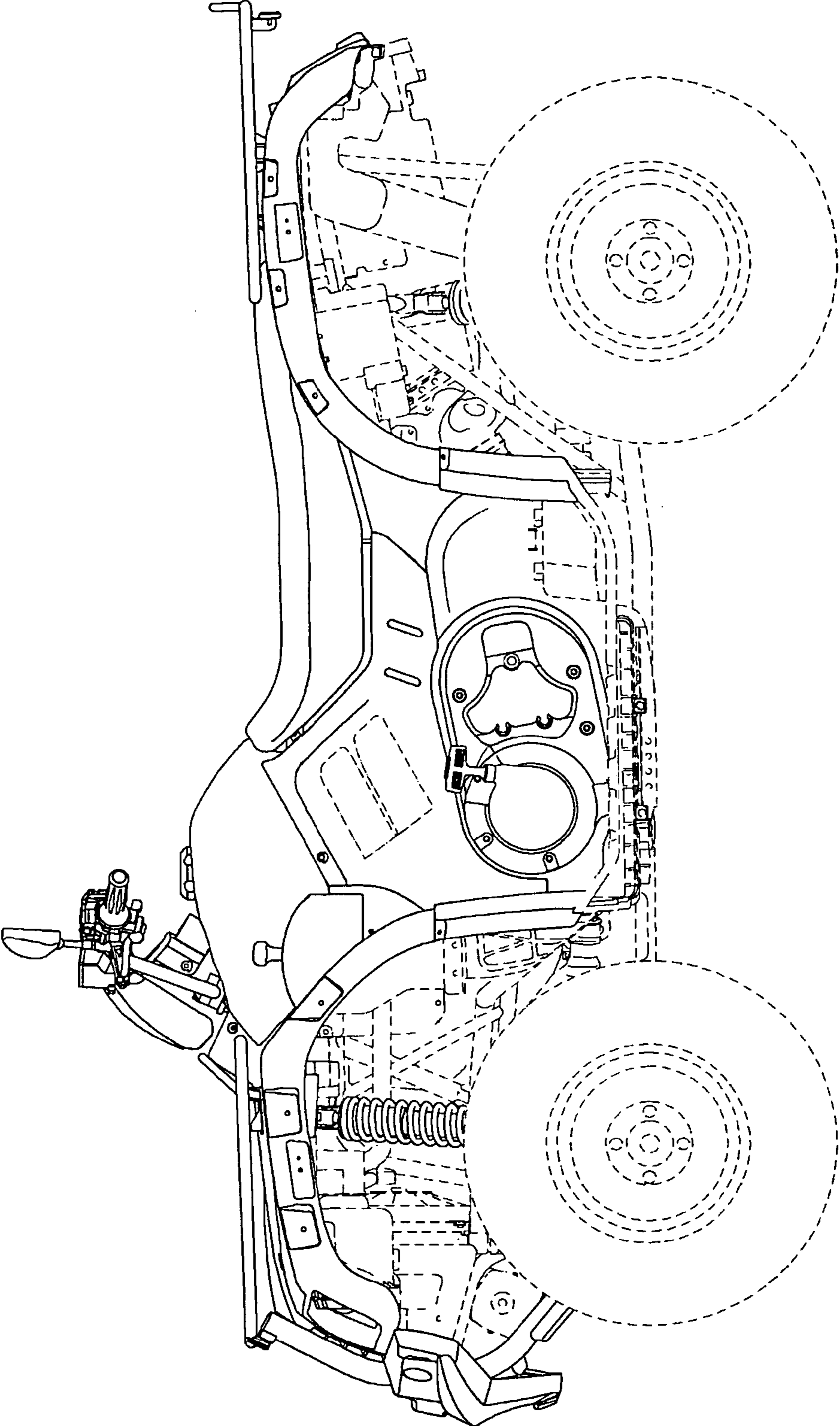

Fig.1

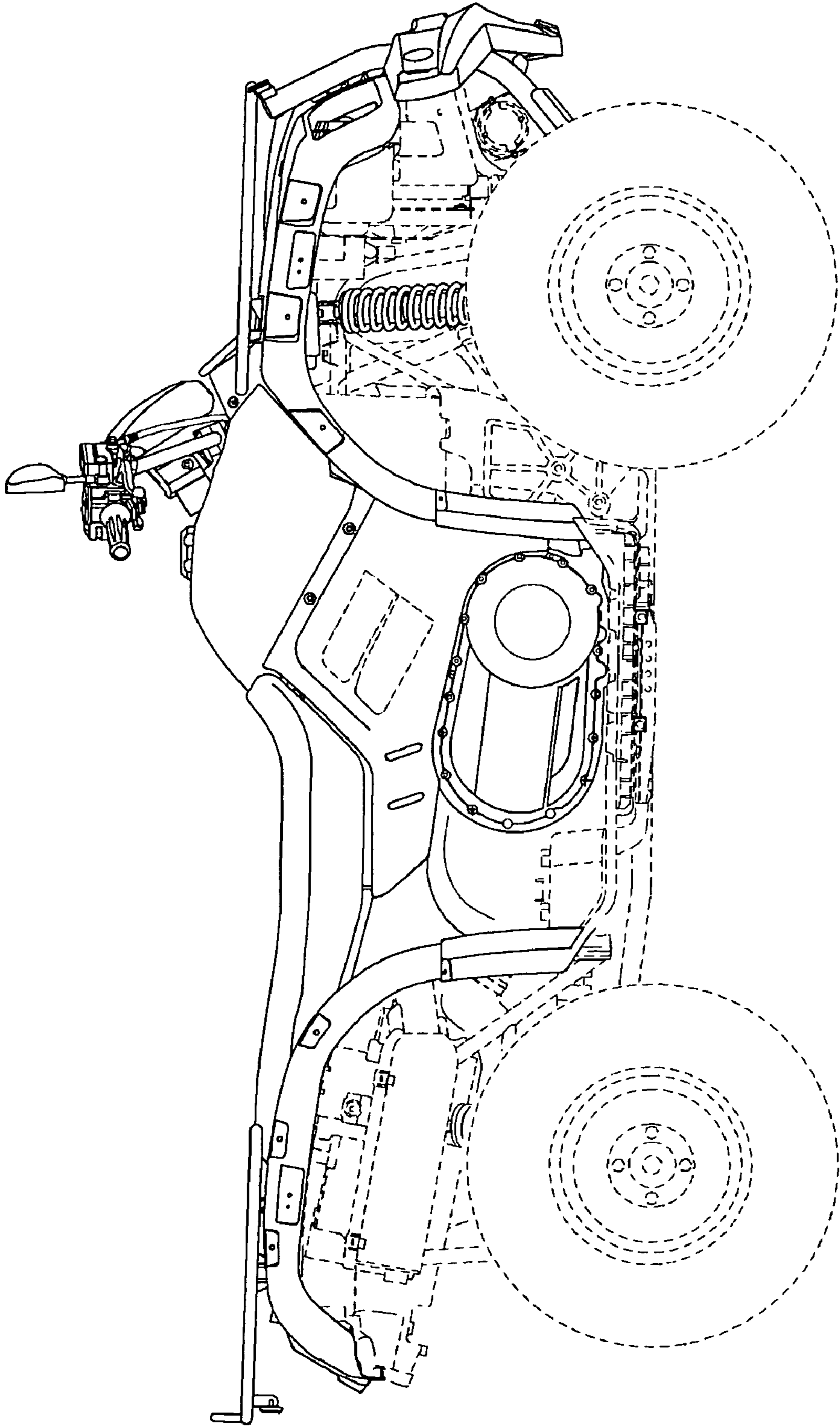

Fig.2

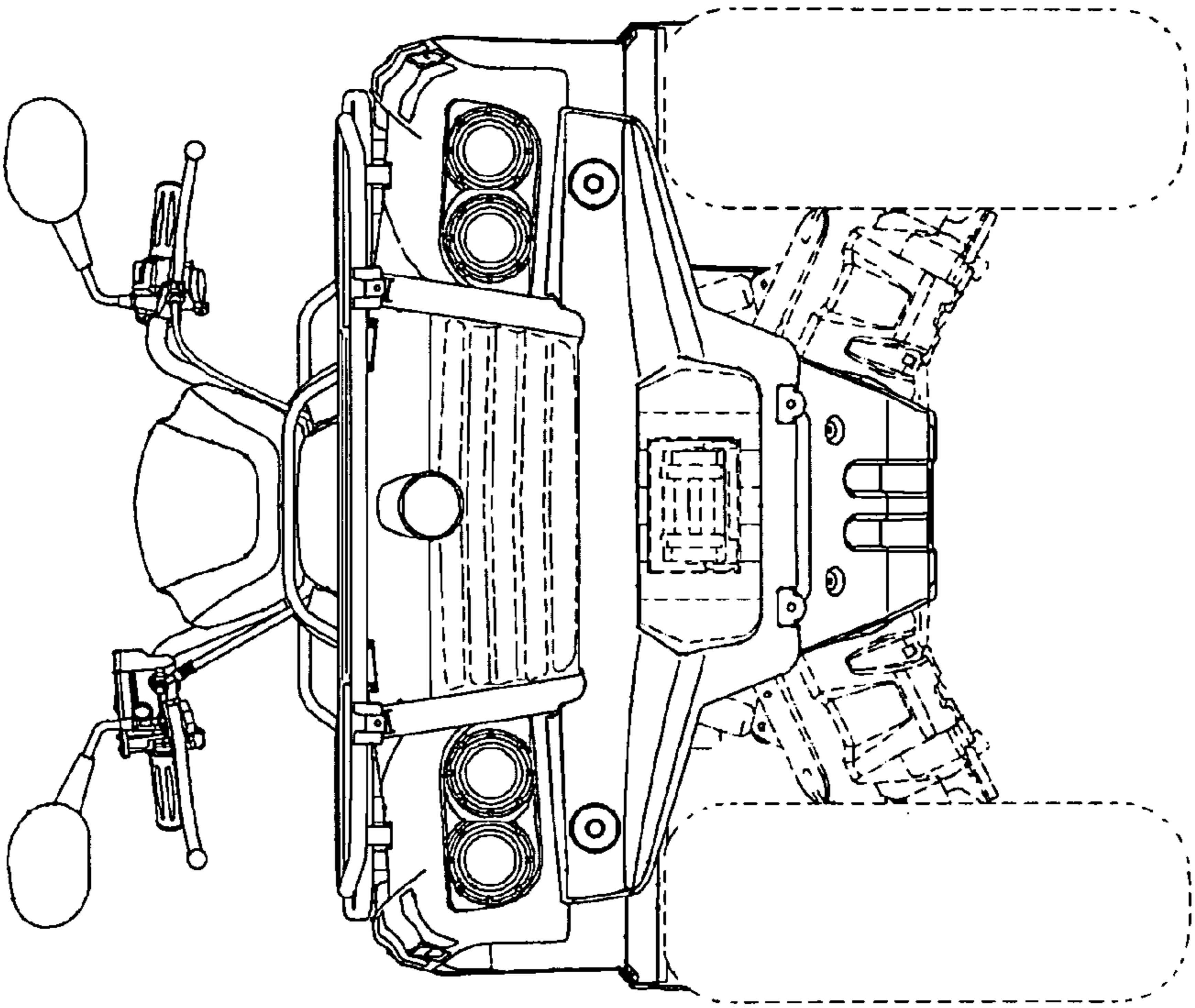

Fig.3

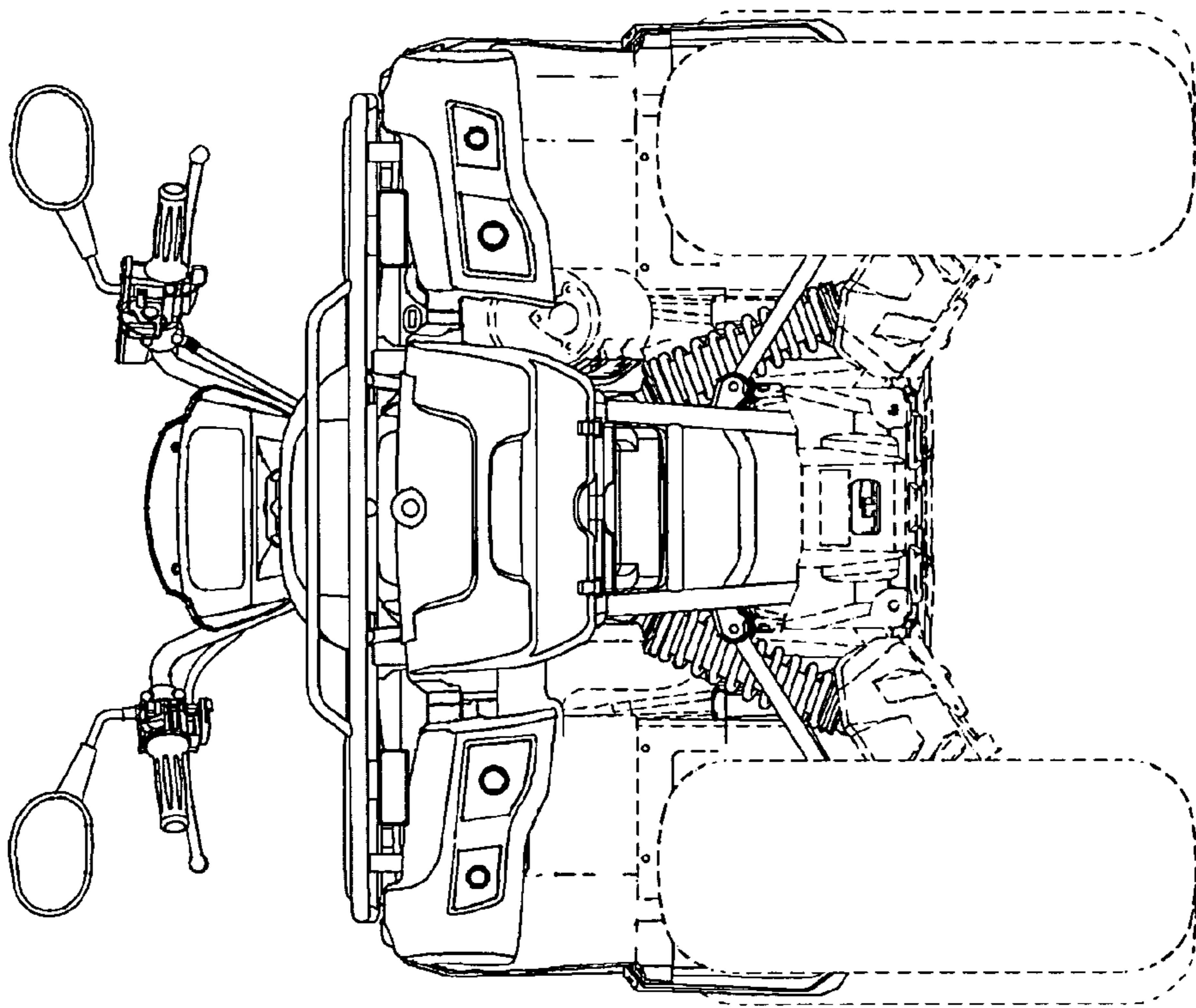

Fig.4

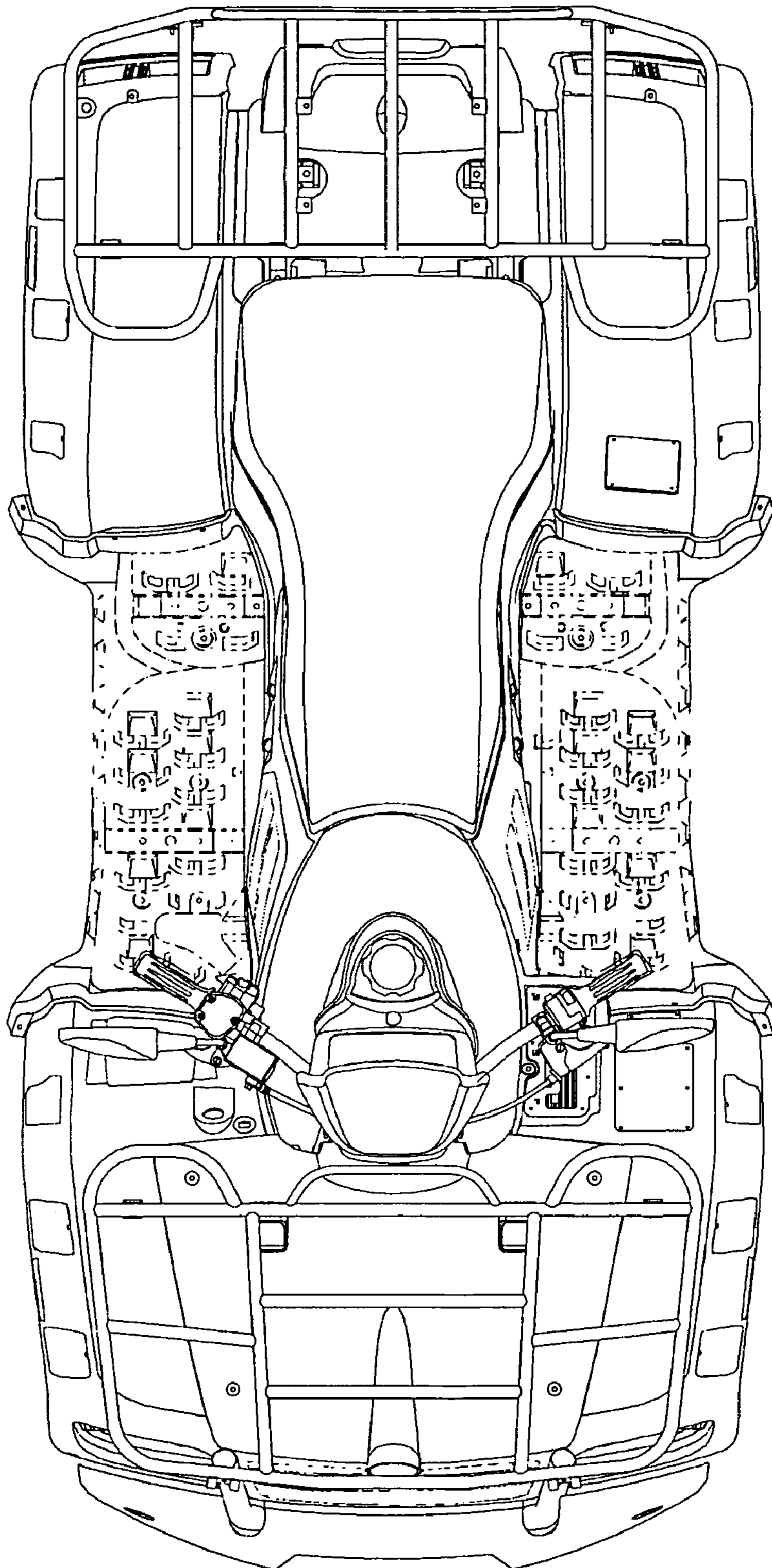

Fig. 5

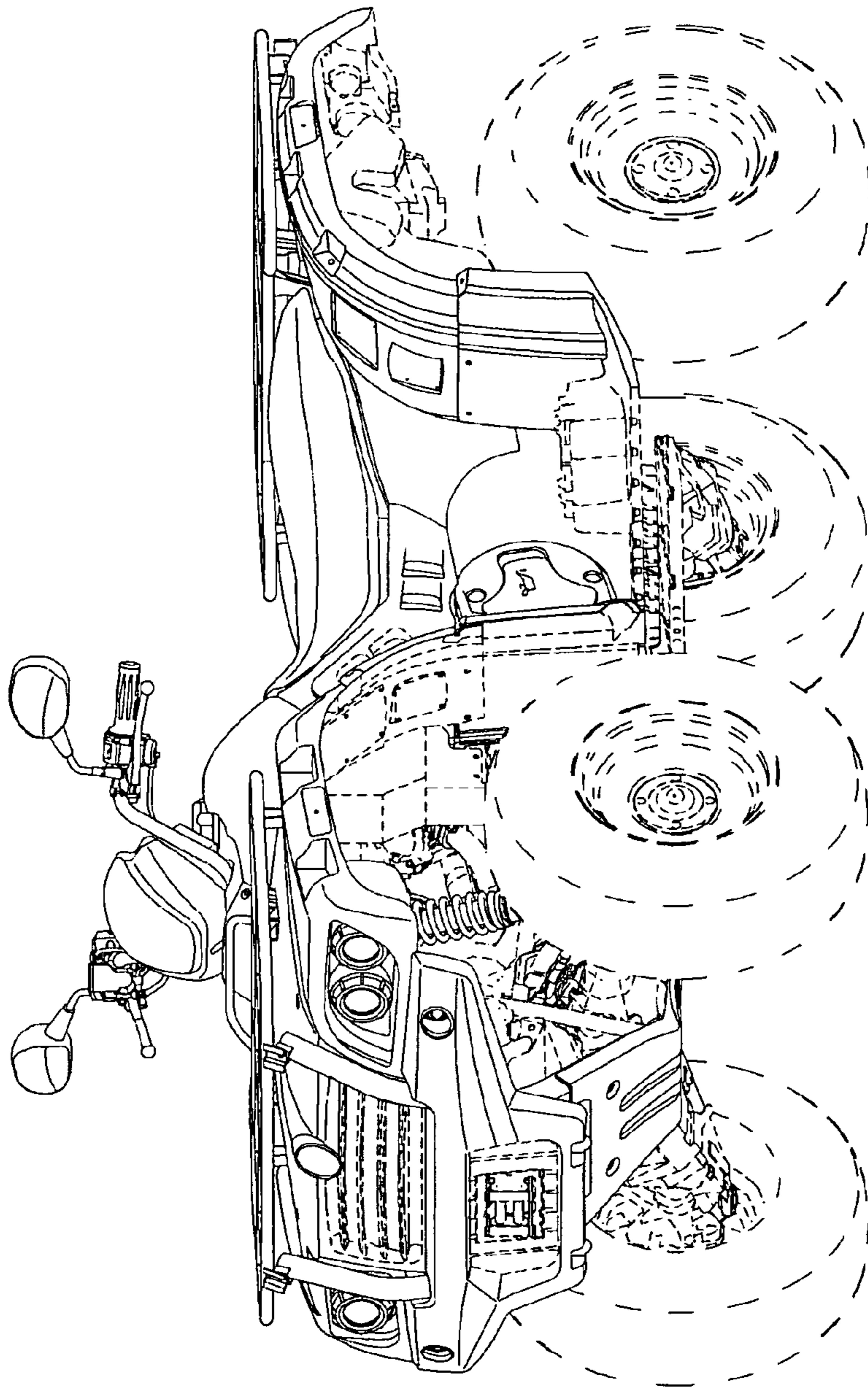

Fig.6