



US00D592255S

(12) **United States Design Patent**
Tak

(10) **Patent No.:** **US D592,255 S**

(45) **Date of Patent:** **** May 12, 2009**

(54) **JIGSAW PUZZLE PEG**

(76) Inventor: **Yeung Kai Tak**, Room 1121-22,
Peninsula Centre, 67 Mody Road,
Tsimshatsui Kowloon, Hong Kong
(CN)

(**) Term: **14 Years**

(21) Appl. No.: **29/318,973**

(22) Filed: **Jun. 1, 2008**

(51) **LOC (9) Cl.** **21-01**

(52) **U.S. Cl.** **D21/480; D8/DIG. 2**

(58) **Field of Classification Search** D21/385,
D21/386, 468, 470, 478-480, 484, 487, 488,
D21/499, 500, 503-505; D8/300-322, 349,
D8/355, 382-399, DIG. 1, DIG. 2; D11/213,
D11/214, 220, 222, 226, 227; 16/110.1,
16/422, 425, 2.1; 273/236-291, 153 R, 156,
273/157 R, 160, 153 J; 434/128, 150, 159-161,
434/171, 172, 193, 195, 200, 208, 259, 393,
434/406; 24/106-108, 104, 297, 114.05,
24/114.4, 453, 457, 458; 411/508-511, 913
See application file for complete search history.

(56) **References Cited**

U.S. PATENT DOCUMENTS

49,305 A * 8/1865 Ruggles 24/108
229,240 A * 6/1880 Dobell 24/108
661,916 A * 11/1900 Liphard 24/41.1
1,033,422 A * 7/1912 Langley et al. 273/153 J
1,276,344 A * 8/1918 Gilman 434/304
1,286,745 A * 12/1918 Otte 16/417
1,431,674 A * 10/1922 MacGill, Jr. 411/338
3,803,670 A * 4/1974 Johnson 411/508
4,218,599 A * 8/1980 Garn 200/530

4,475,273 A * 10/1984 Konno 24/108
D291,864 S * 9/1987 Hill D8/354
4,768,704 A * 9/1988 Beckway et al. 229/125.38
7,257,870 B2 * 8/2007 Deas et al. 24/453
D552,691 S * 10/2007 Tak D21/480

* cited by examiner

Primary Examiner—Catherine Tuttle

(74) *Attorney, Agent, or Firm*—Jennifer Meredith, Esq.;
Meredith & Keyhani, PLLC

(57) **CLAIM**

The ornamental design for the jigsaw puzzle peg, as shown
and described.

DESCRIPTION

FIG. 1 is an exploded top perspective view of the jigsaw
puzzle peg showing my new design;
FIG. 2 is an exploded bottom perspective view thereof;
FIG. 3 is a an exploded side view thereof;
FIG. 4 is an exploded front view thereof;
FIG. 5 is a top plan view of the separated components shown
in FIGS. 1-4;
FIG. 6 is a bottom plan view of FIG. 5;
FIG. 7 is a side elevational view showing the design in its
assembled state together with associated environmental
structure;
FIG. 8 is a top plan view of FIG. 7; and,
FIG. 9 is a bottom plan view of FIG. 9.
The broken lines shown in FIGS. 7-9 are included for the
purpose of illustrating environmental structure that forms no
part of the claimed design.

1 Claim, 3 Drawing Sheets

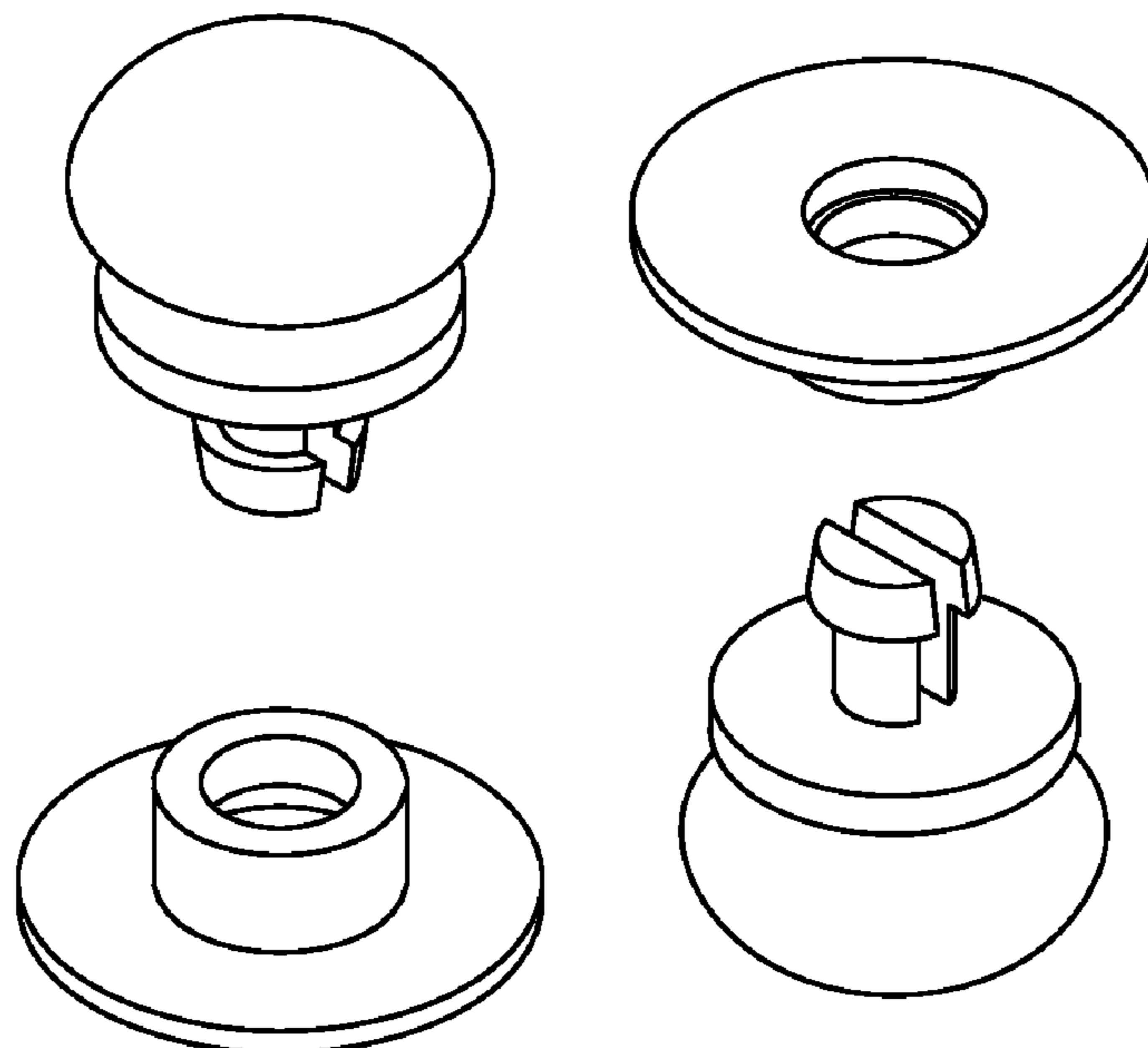

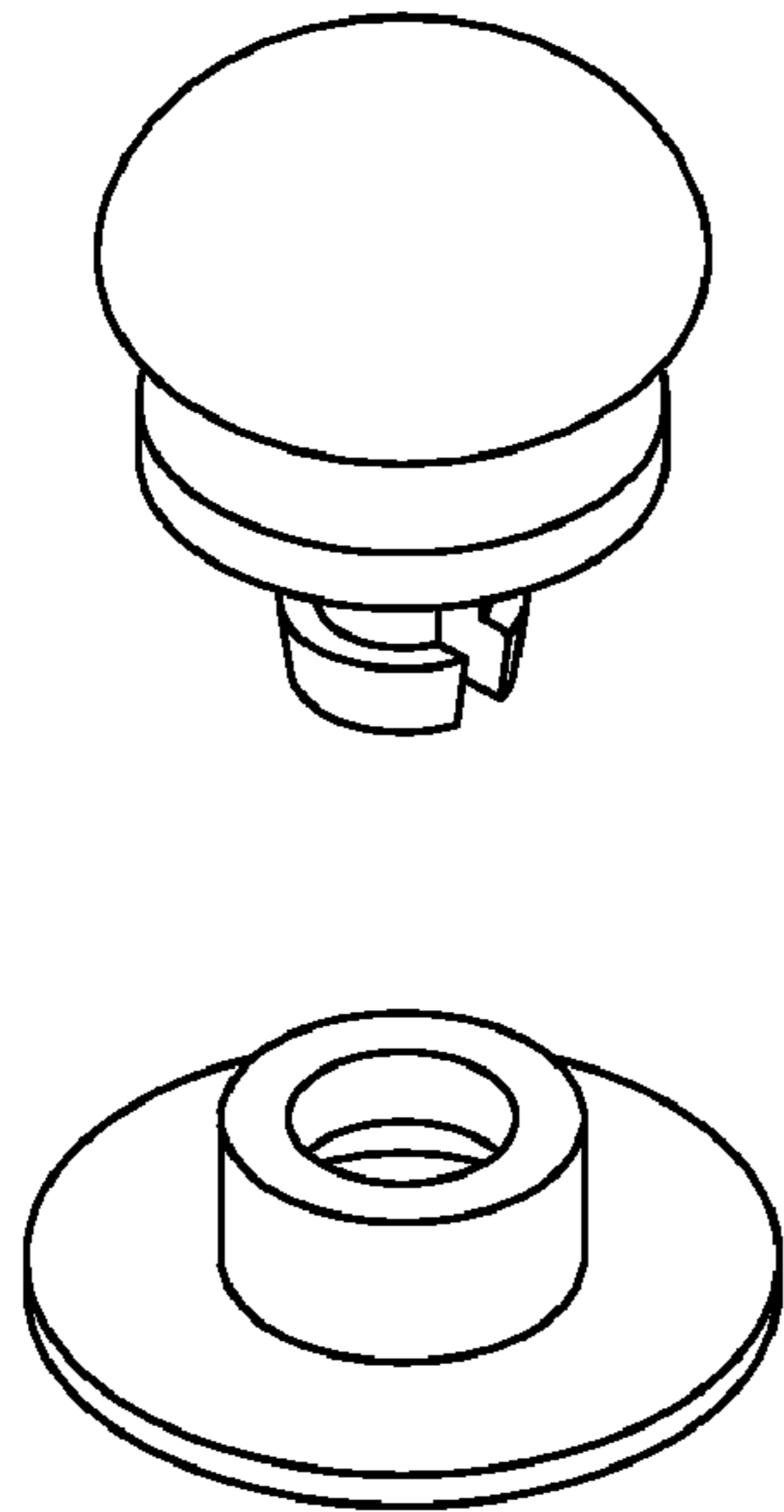

FIG. 1

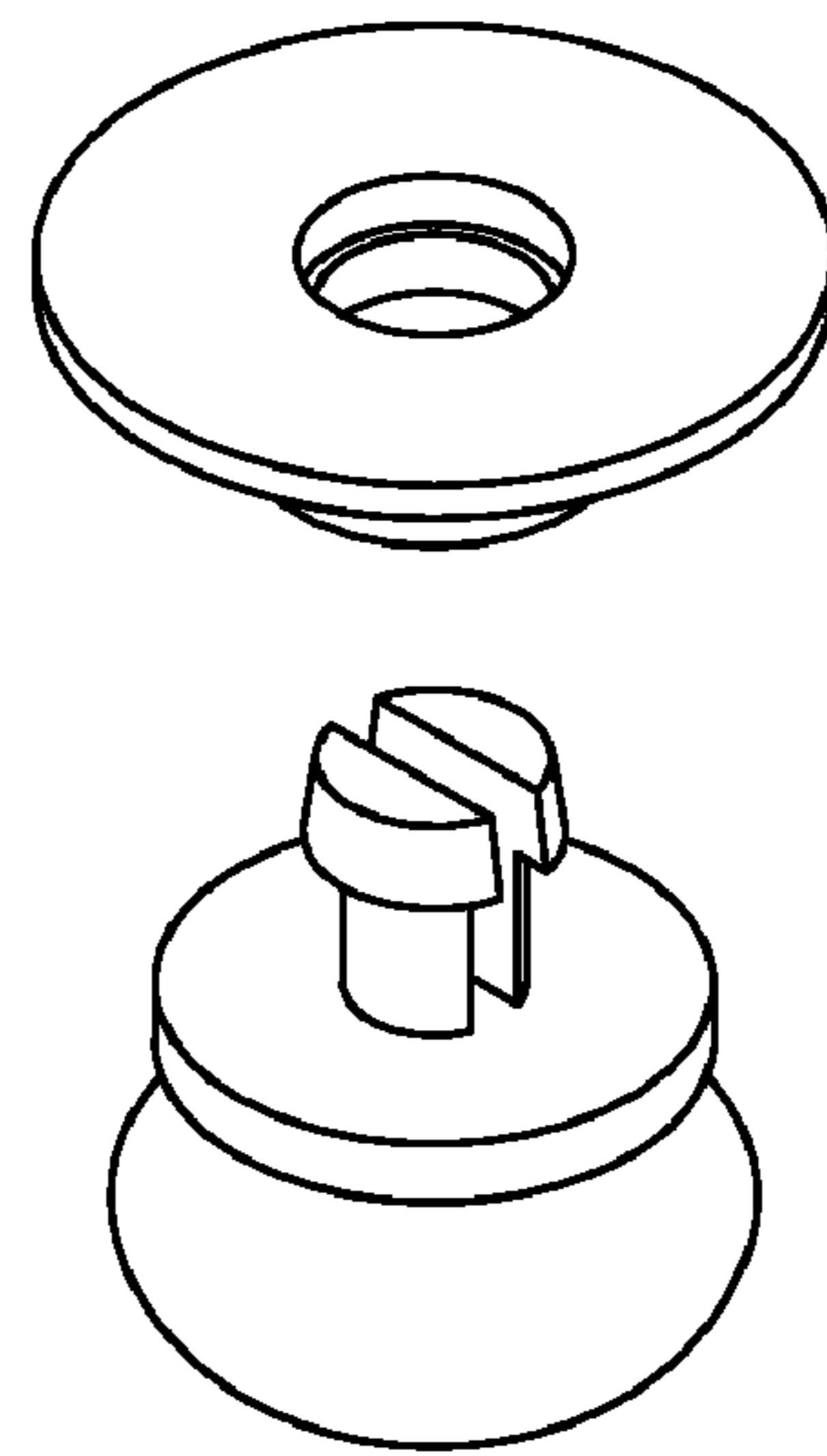

FIG. 2

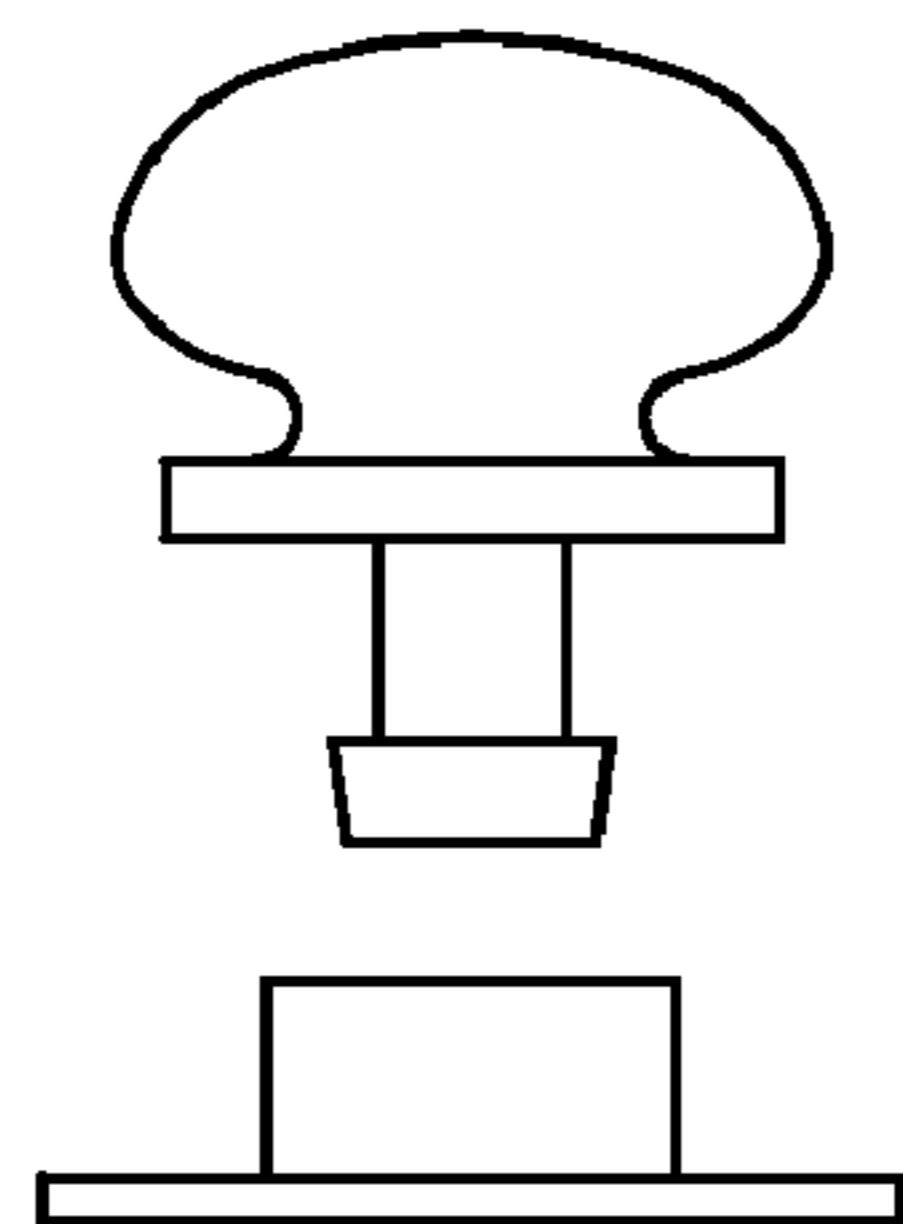

FIG. 3

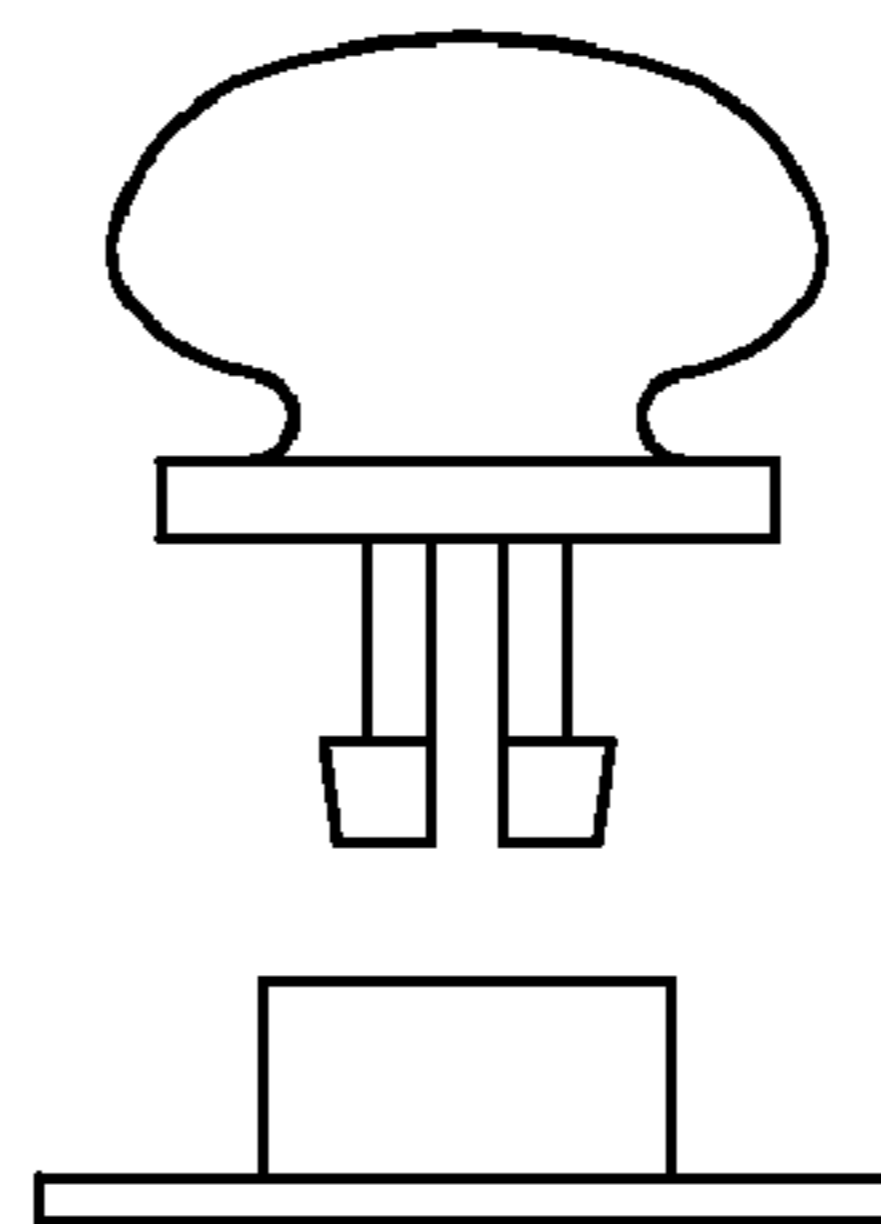

FIG. 4

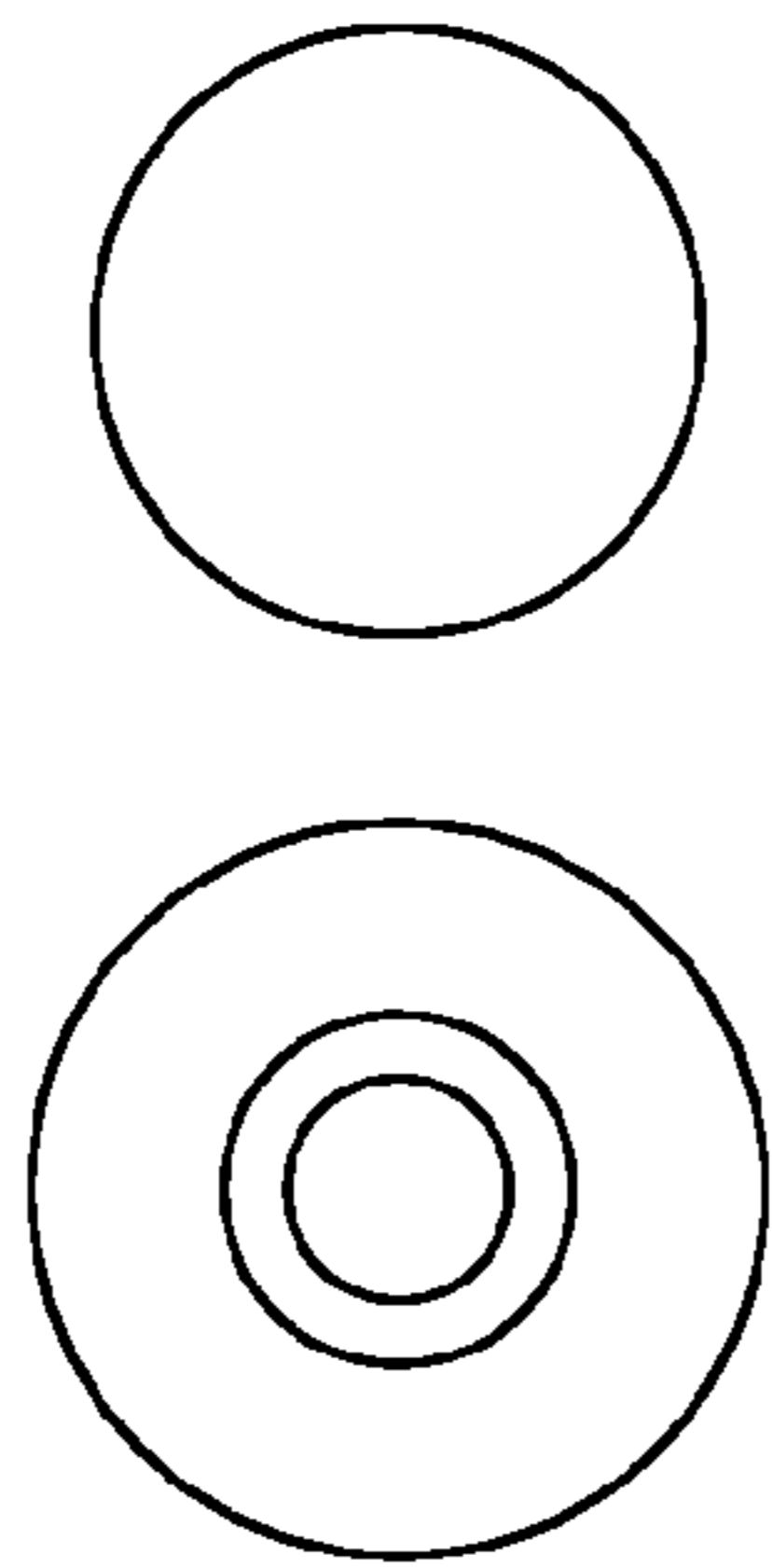

FIG. 5

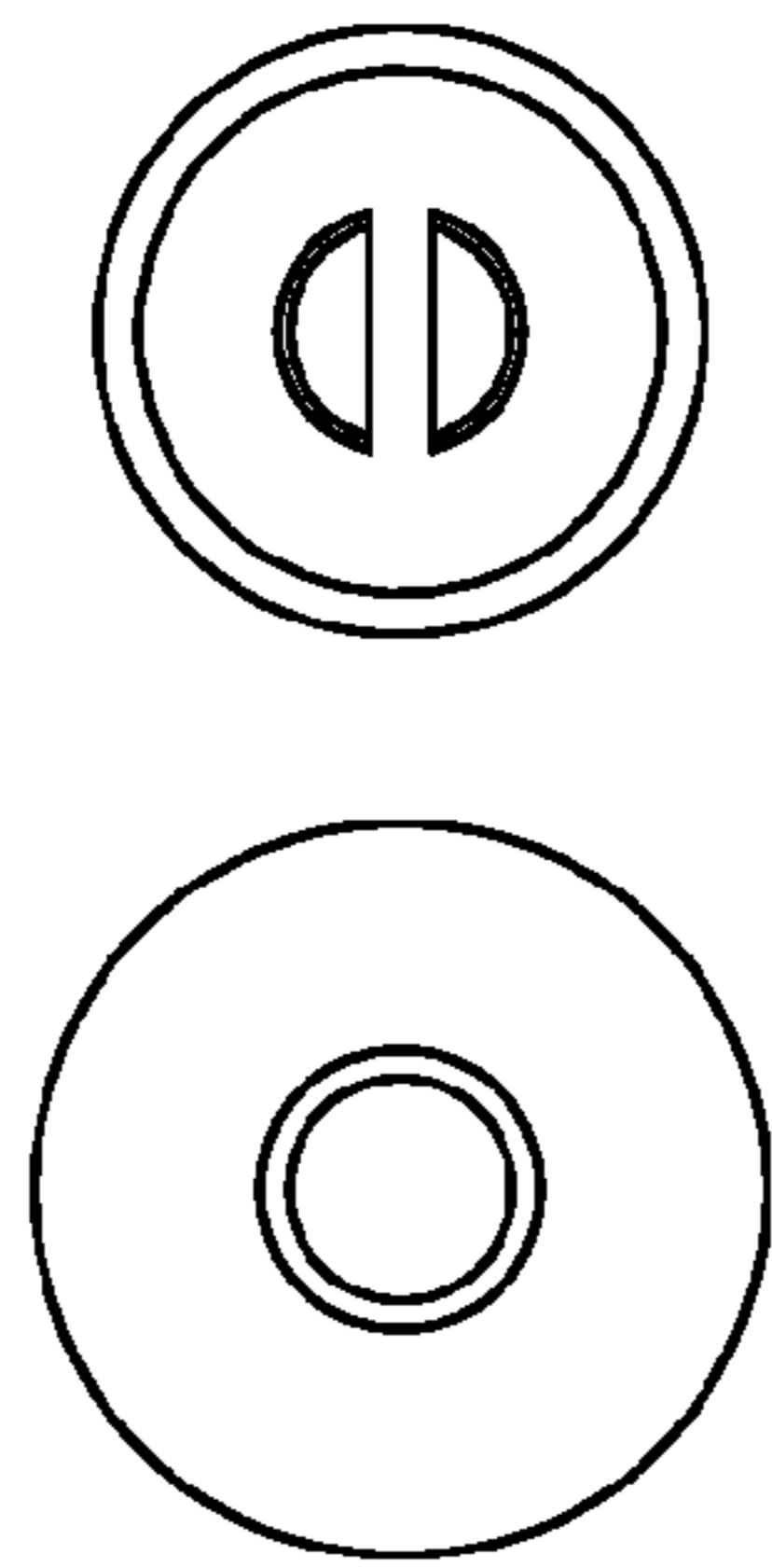

FIG. 6

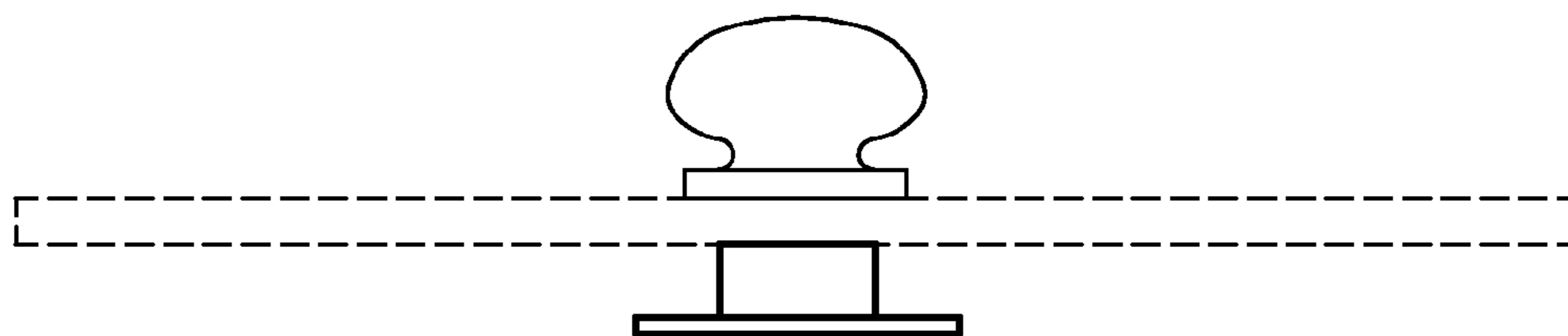

FIG. 7

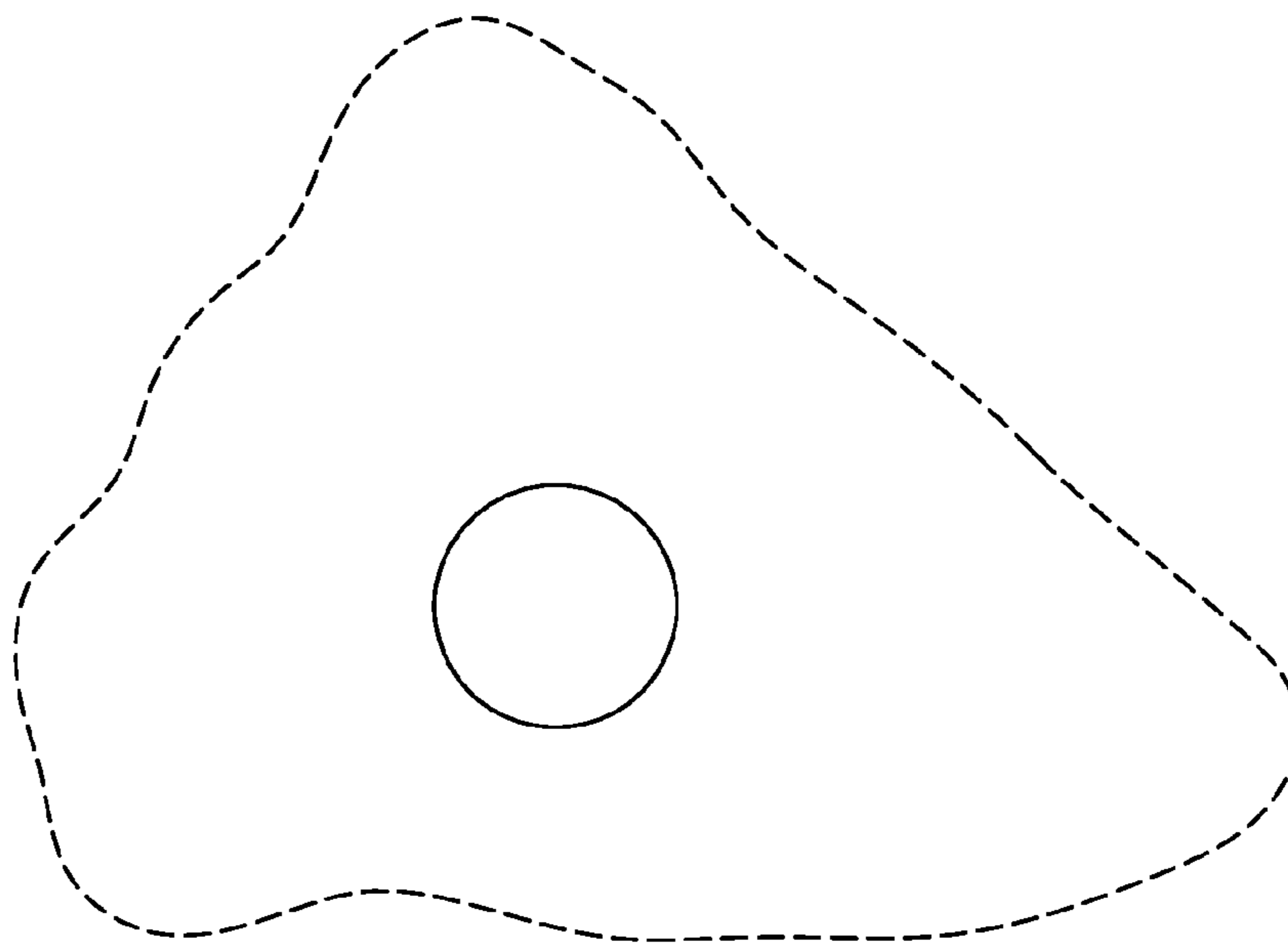

FIG. 8

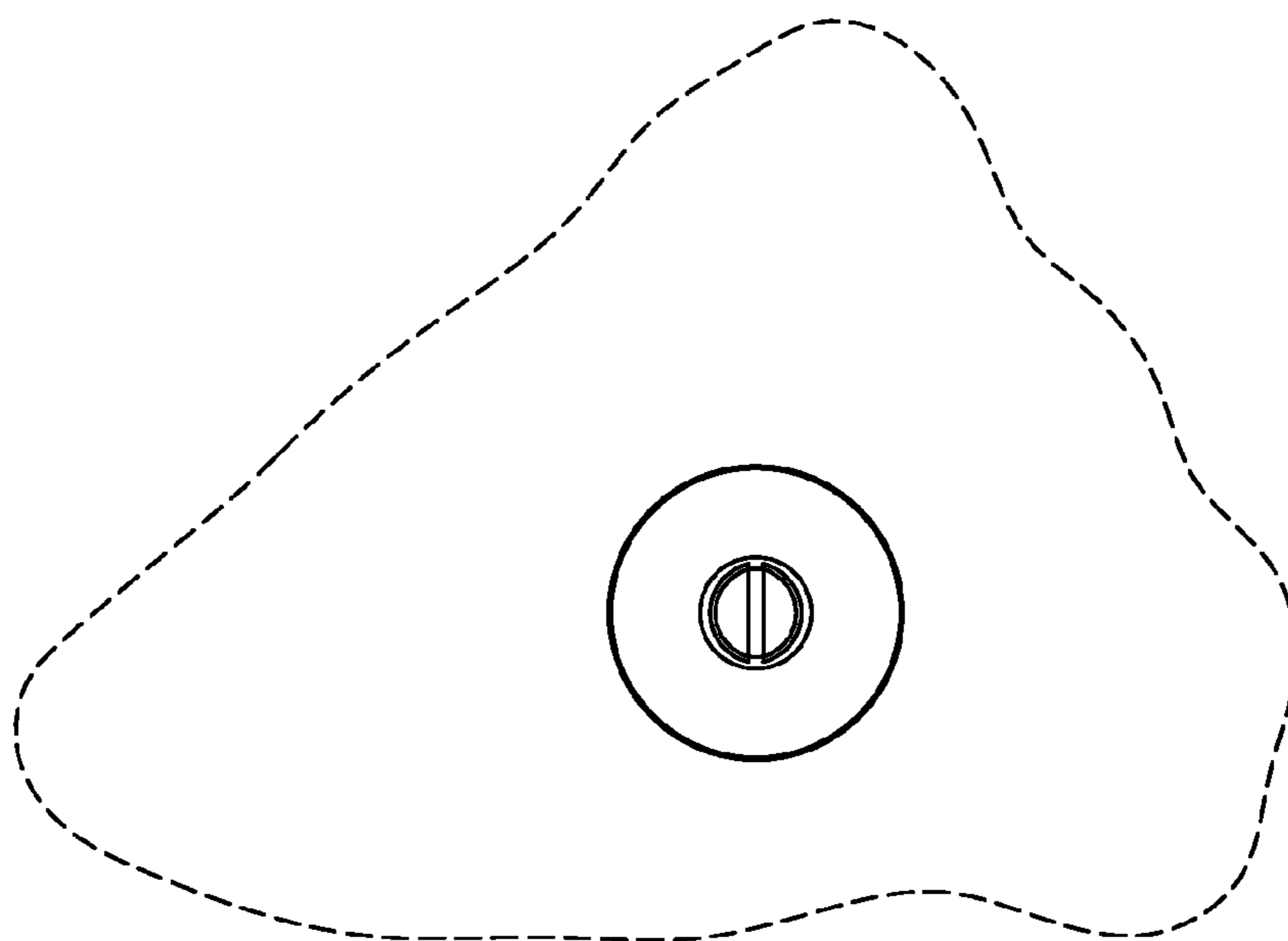

FIG. 9