

US00D592225S

(12) **United States Design Patent**  
**Blankenship et al.**

(10) **Patent No.:** **US D592,225 S**  
(45) **Date of Patent:** **\*\* May 12, 2009**

- (54) **DISPLAY PANEL WITH A COMPUTER-GENERATED ICON**
- (75) Inventors: **Esther M. Blankenship**, Mannheim (DE); **Leif Jensen-Pistorius**, Ostringen (DE); **Peer Hilgers**, St. Leon-Rot (DE)
- (73) Assignee: **SAP AG**, Walldorf (DE)
- (\*\*) Term: **14 Years**
- (21) Appl. No.: **29/284,881**
- (22) Filed: **Sep. 17, 2007**
- (51) **LOC (9) Cl.** ..... **32-00**
- (52) **U.S. Cl.** ..... **D14/492**
- (58) **Field of Classification Search** ..... D14/485-95; D18/26, 31-3; D19/6; D20/11-2, 23-5; D20/29-32, 36-8; 715/700-867, 973-7  
See application file for complete search history.

(56) **References Cited**

**U.S. PATENT DOCUMENTS**

5,295,062	A *	3/1994	Fukushima	.....	715/764
D393,840	S *	4/1998	Sakazume	.....	D14/489
D457,529	S *	5/2002	McRae	.....	D14/489
6,421,066	B1 *	7/2002	Sivan	.....	715/712
D470,504	S *	2/2003	McRae	.....	D14/492
D471,205	S *	3/2003	Lane	.....	D14/489
D563,990	S *	3/2008	Okuyama	.....	D14/492
D563,991	S *	3/2008	Okuyama	.....	D14/492
2005/0187649	A1 *	8/2005	Funk et al.	.....	700/121

2005/0251747	A1 *	11/2005	Dolling et al.	.....	715/713
2005/0271382	A1 *	12/2005	Ogata et al.	.....	396/611
2006/0064193	A1 *	3/2006	Yamashita et al.	.....	700/121

**OTHER PUBLICATIONS**

1000 Icons, Symbols and Pictograms: Visual Communication for Every Language, by Blackcoffee, Rockport Publishers, Gloucester, MA © 2006, p. 47.\*

IconExperience—'Objects and People', © Copyright 2006, Incors GmbH, p. 11 [online] 2006 [retrieved on Jan. 24, 2007]. Retrieved from the Internet <URL: <http://www.IconExperience.com>>.\*

\* cited by examiner

*Primary Examiner*—Cathron C Brooks

*Assistant Examiner*—Karen E Kearney

(74) *Attorney, Agent, or Firm*—Fenwick & West LLP

(57) **CLAIM**

We claim the ornamental design for display panel with a computer-generated icon, as shown and described.

**DESCRIPTION**

FIGS. 1 and 2 are first and second front views, respectively, of an icon shown on a display panel with a computer-generated icon.

The broken lines in the drawings are for illustrative purposes only and form no part of the claimed design.

The broken lines showing of the display panel are for the purpose of illustrating environmental structure and form no part of the claimed design.

**1 Claim, 2 Drawing Sheets**

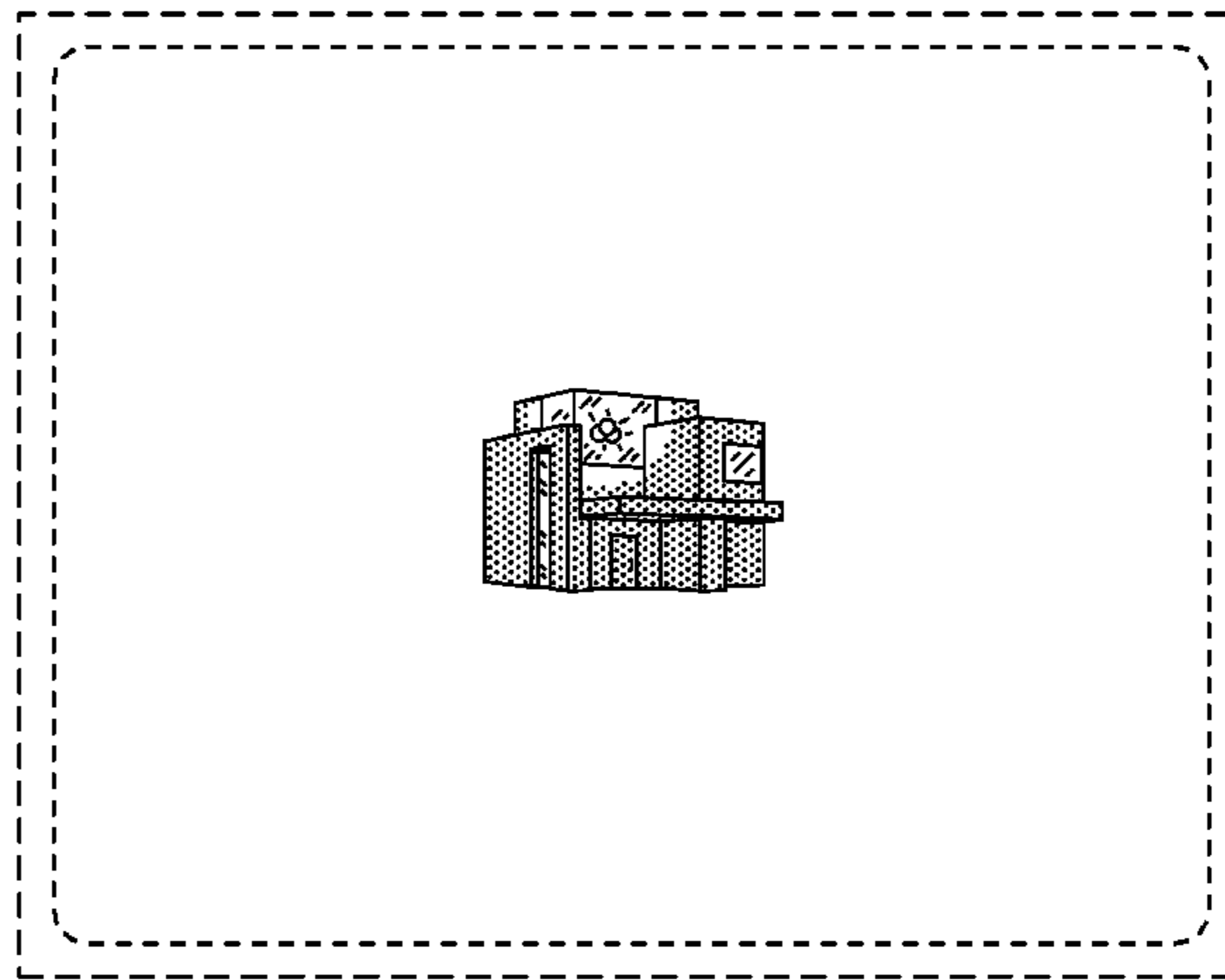
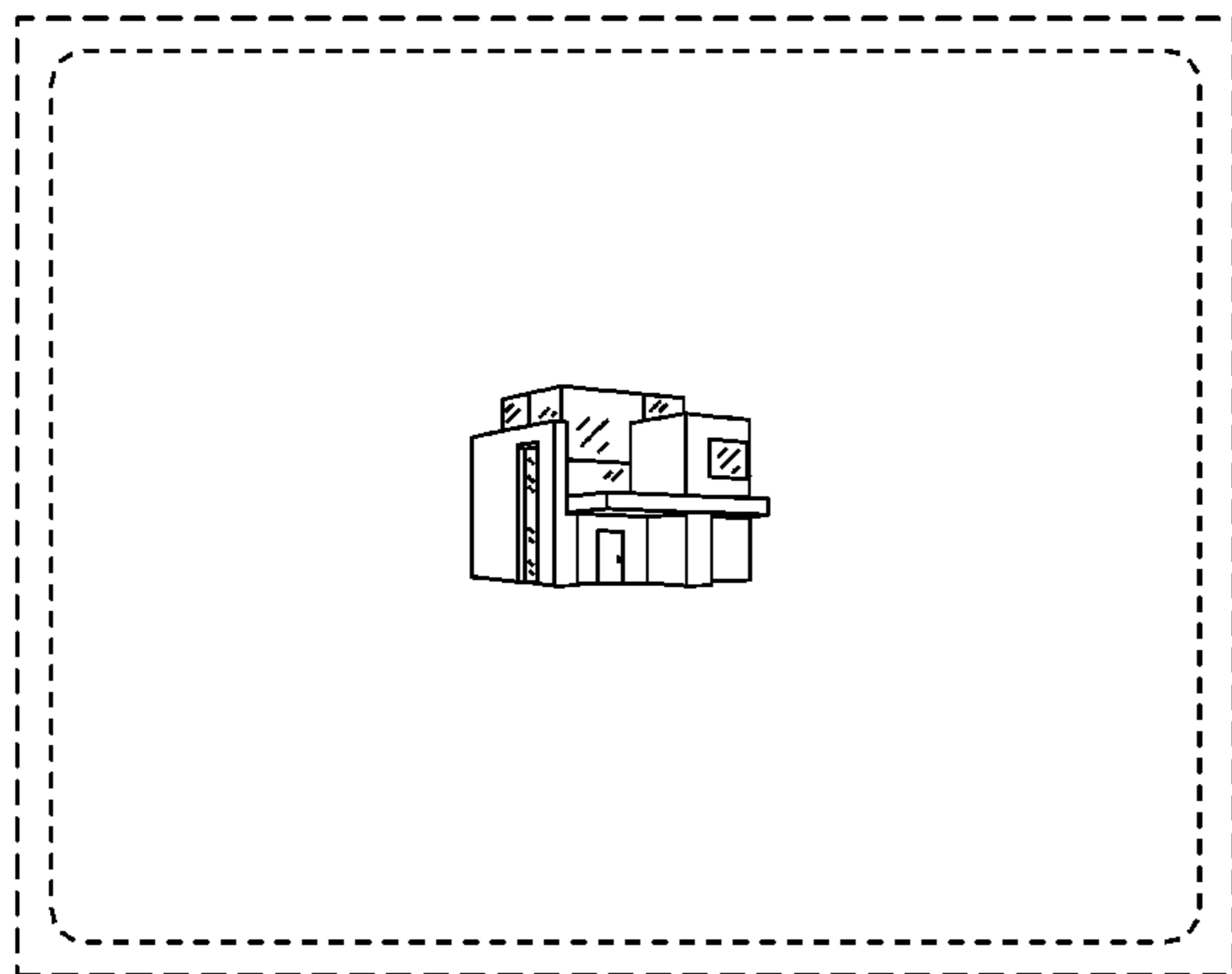

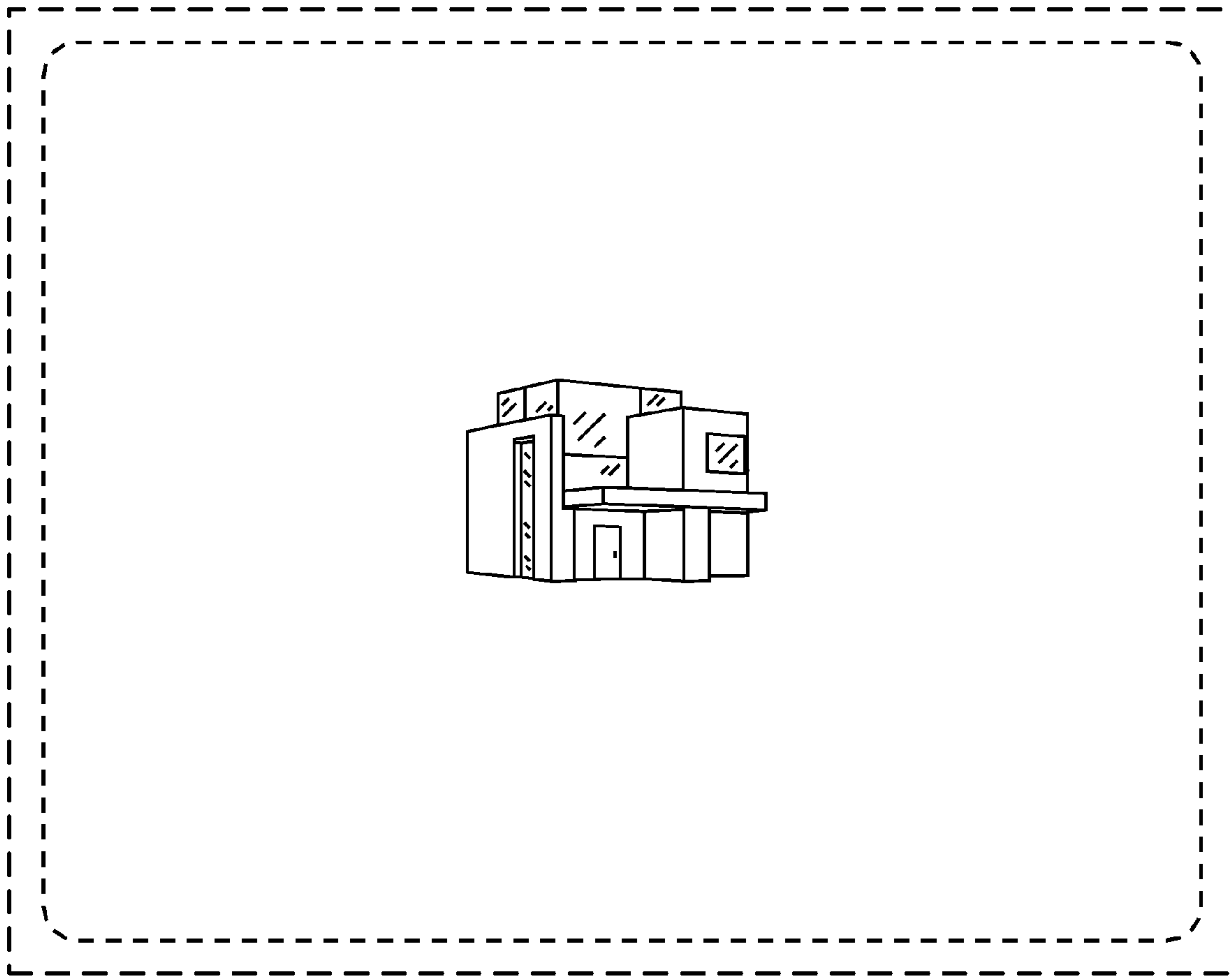

FIG. 1

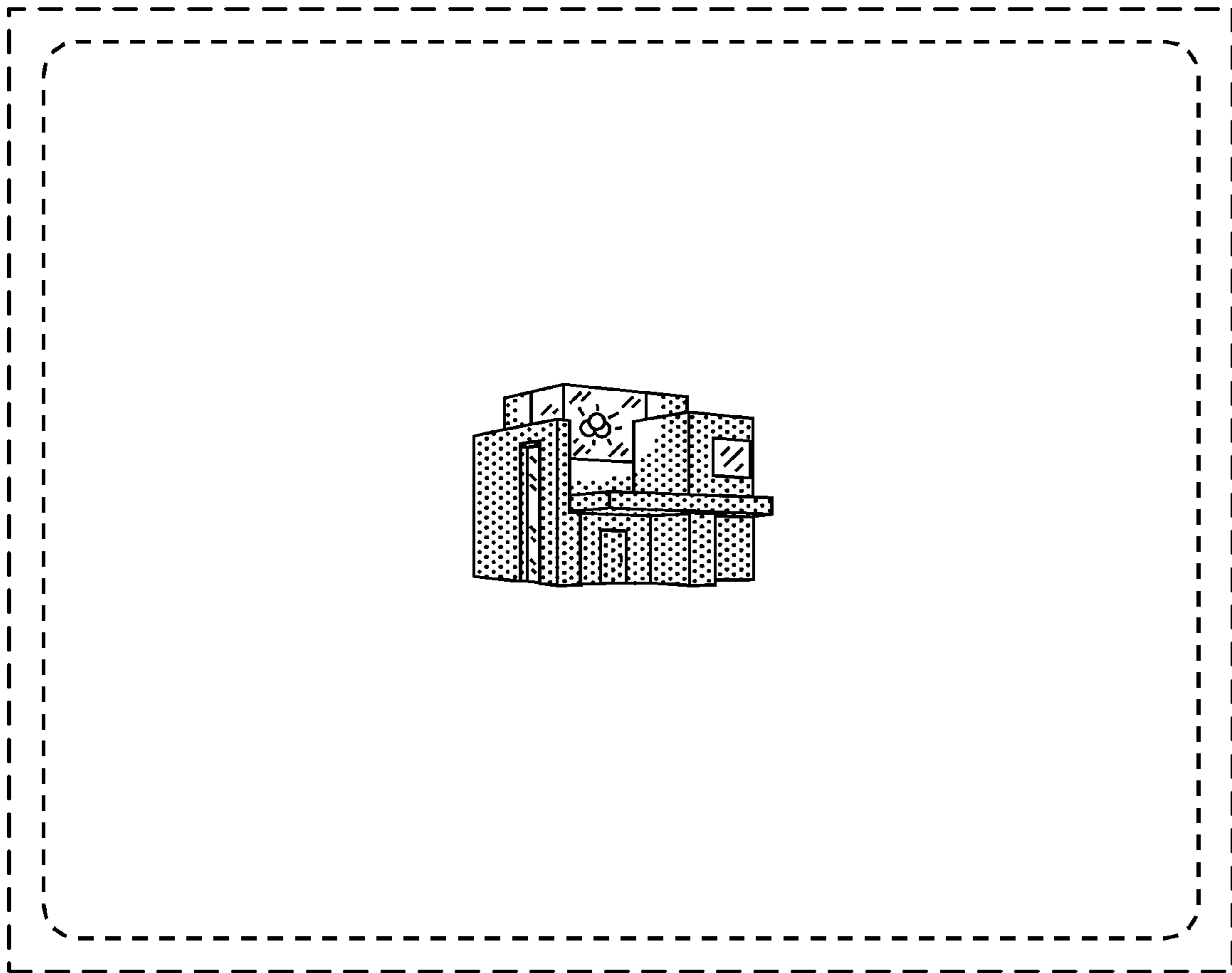

FIG. 2