



US00D591132S

(12) **United States Design Patent**  
**Fischer-Zernin**

(10) **Patent No.:** **US D591,132 S**  
(45) **Date of Patent:** **\*\* Apr. 28, 2009**

(54) **TACKER**

(75) Inventor: **Suzanne Fischer-Zernin**, Hamburg  
(DE)

(73) Assignee: **Joh. Friedrich Behrens Ag**, Ahrensburg  
(DE)

(\*\*) Term: **14 Years**

(21) Appl. No.: **29/306,740**

(22) Filed: **Apr. 15, 2008**

(30) **Foreign Application Priority Data**

Nov. 5, 2007 (EM) ..... 000821228

(51) **LOC (9) Cl.** ..... **08-05**

(52) **U.S. Cl.** ..... **D8/69**

(58) **Field of Classification Search** ..... D8/68-69;  
81/57.11, 429, 454, 455, 456, 469, 489; 173/13,  
173/104, 114, 168, 169-171, 178, 201, 211,  
173/213, 217; 408/20, 124, 125, 234, 241 R;  
451/358; 310/50; 227/113, 114, 120, 130,  
227/136, 142

See application file for complete search history.

(56) **References Cited**

**U.S. PATENT DOCUMENTS**

D497,299 S \* 10/2004 Matsuoka et al. .... D8/69  
7,225,768 B2 \* 6/2007 Akiba et al. .... 227/130

7,328,826 B2 \* 2/2008 Shkolnikov ..... 227/8  
7,334,715 B2 \* 2/2008 Oda et al. .... 227/2  
D575,127 S \* 8/2008 Buck ..... D8/69  
D575,607 S \* 8/2008 Buck ..... D8/69

**OTHER PUBLICATIONS**

Powers Wood-to-Wood—undated competitor's product.  
Hitachi Wood-to-Wood—undated competitor's product.  
Paslode IM 350—undated competitor's product.  
Powers Track—undated competitor's product.

\* cited by examiner

*Primary Examiner*—Antoine D Davis

(74) *Attorney, Agent, or Firm*—Vidas, Arrett & Steinkraus,  
P.A.

(57) **CLAIM**

The ornamental design for a tacker, as shown and described.

**DESCRIPTION**

FIG. 1 is a frontal view of the invention described;  
FIG. 2 is a right side view of the invention described;  
FIG. 3 is a left side view of the invention described;  
FIG. 4 is a rear view of the invention described;  
FIG. 5 a top view of the invention described;  
FIG. 6 a bottom view of the invention described; and,  
FIG. 7 is a perspective view of the front and right side of the  
invention described.

**1 Claim, 7 Drawing Sheets**

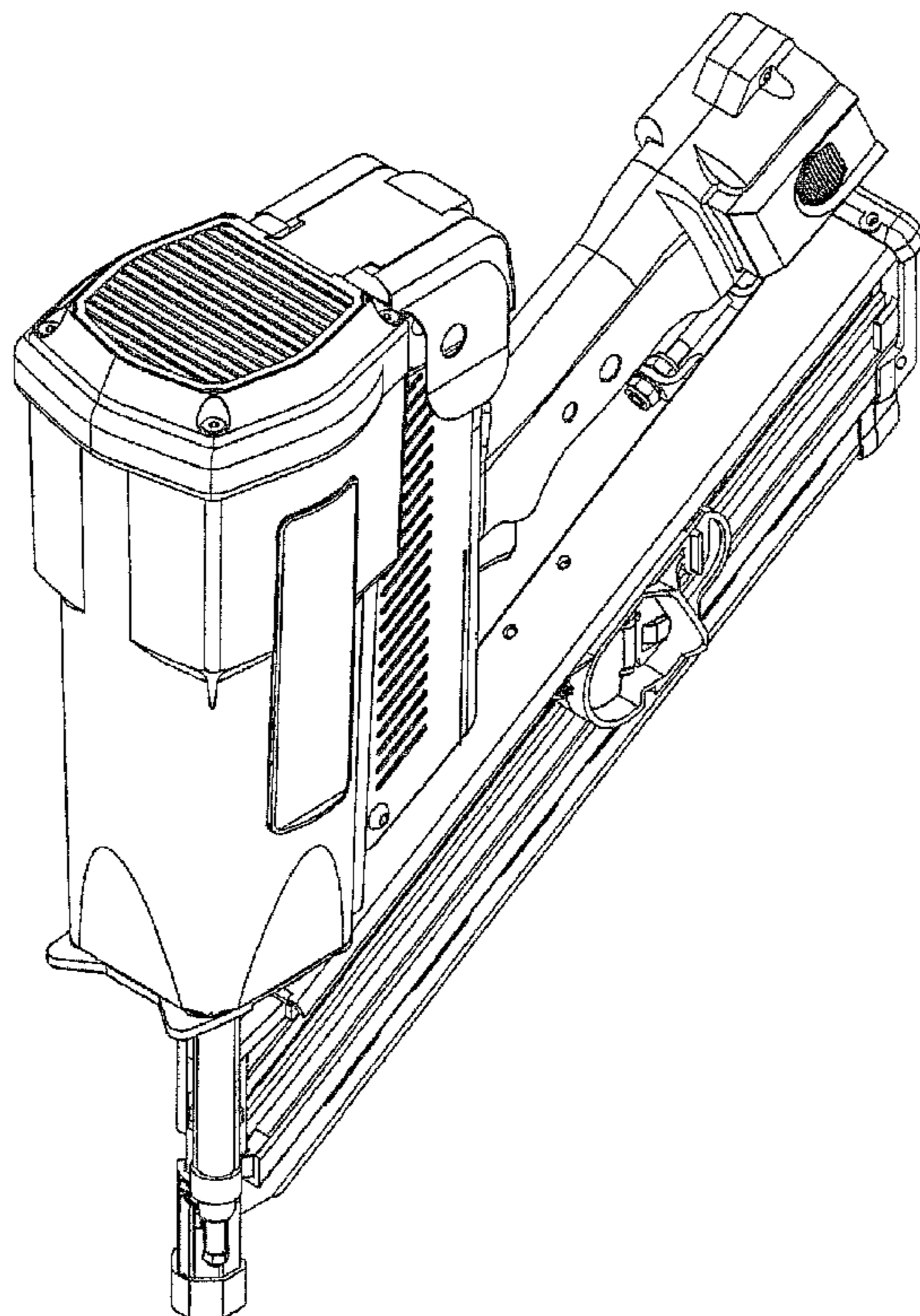

FIG. 1

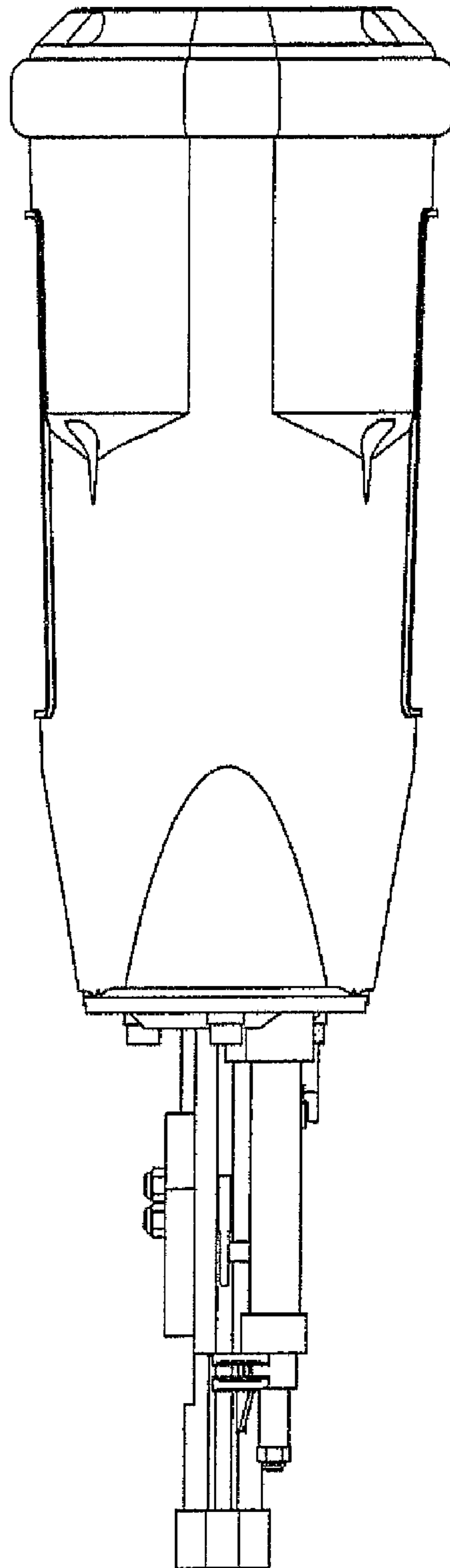

FIG. 2

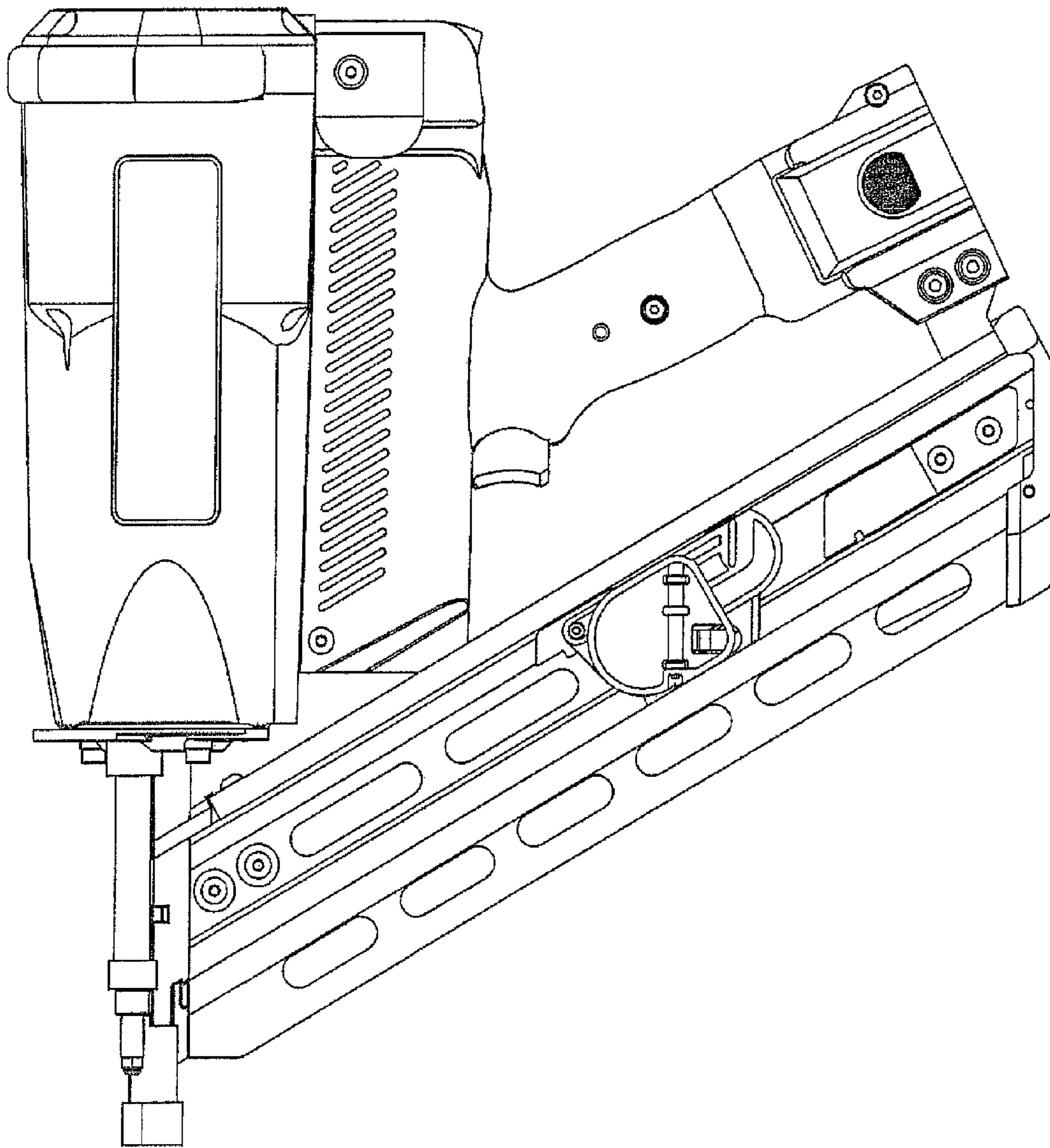

FIG. 3

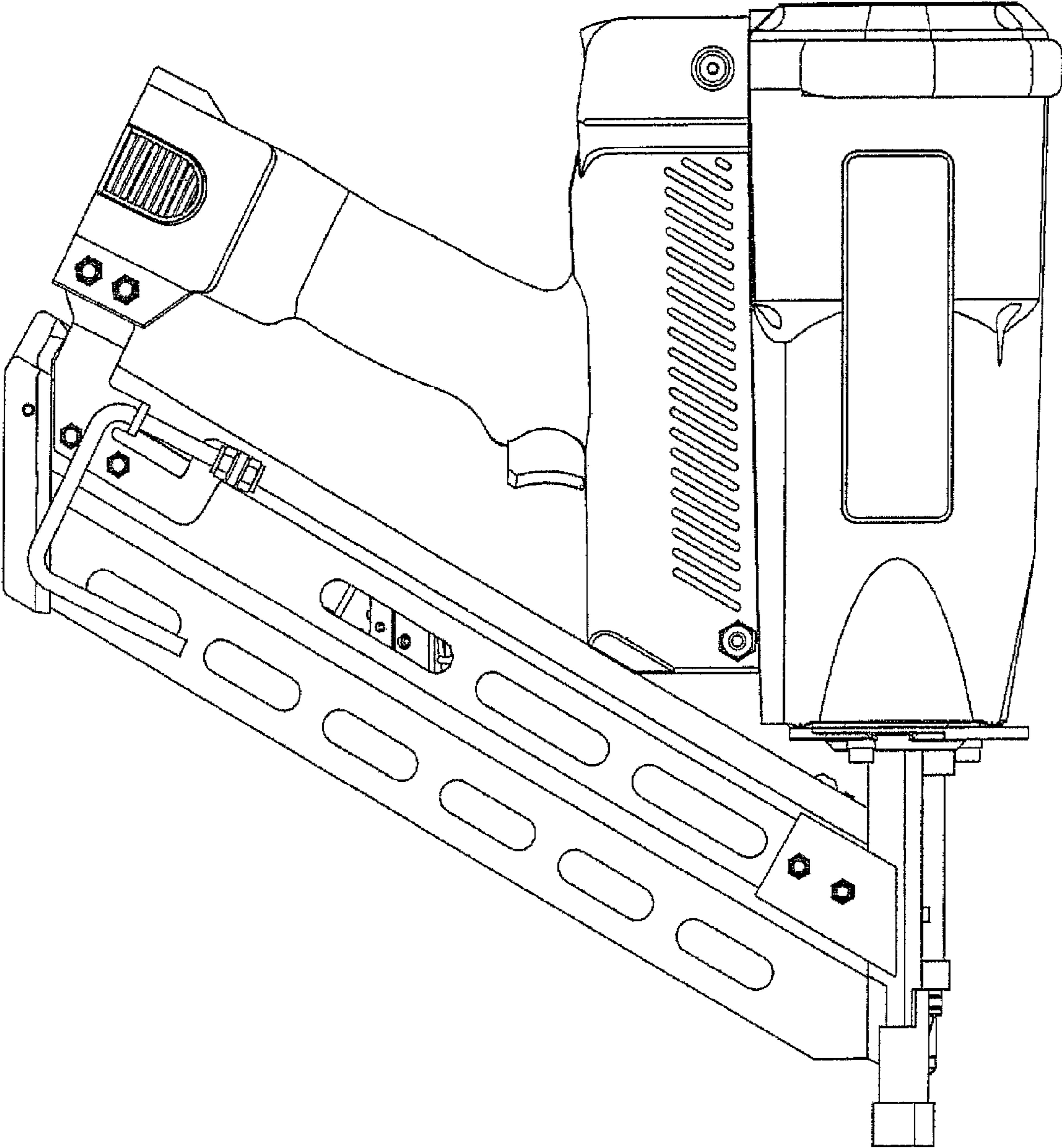



FIG. 4

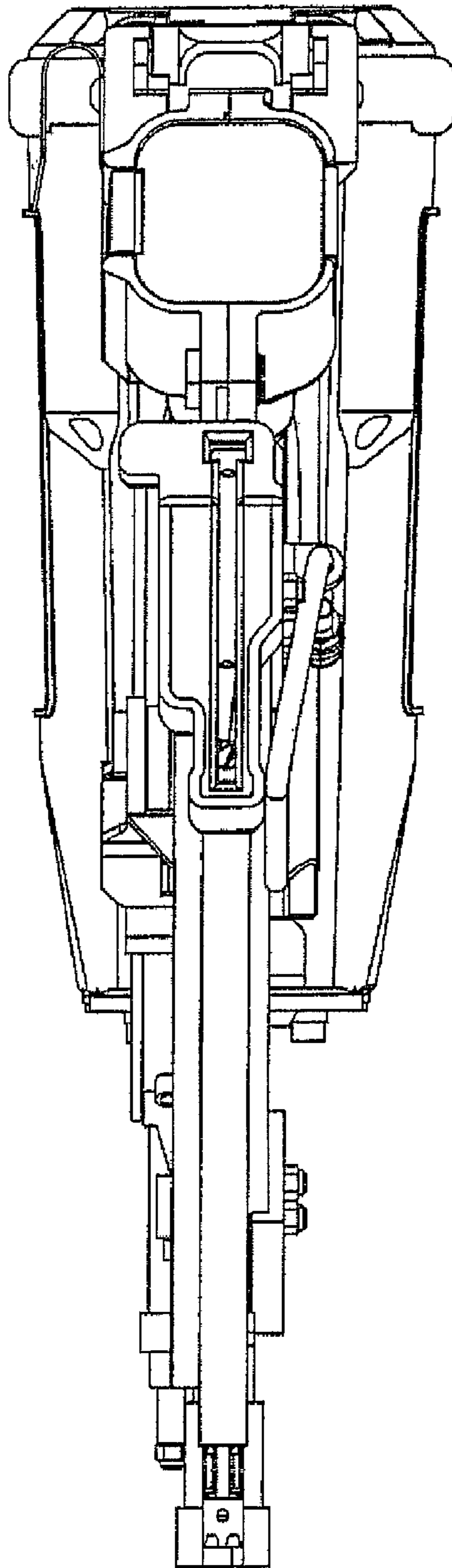

FIG. 5

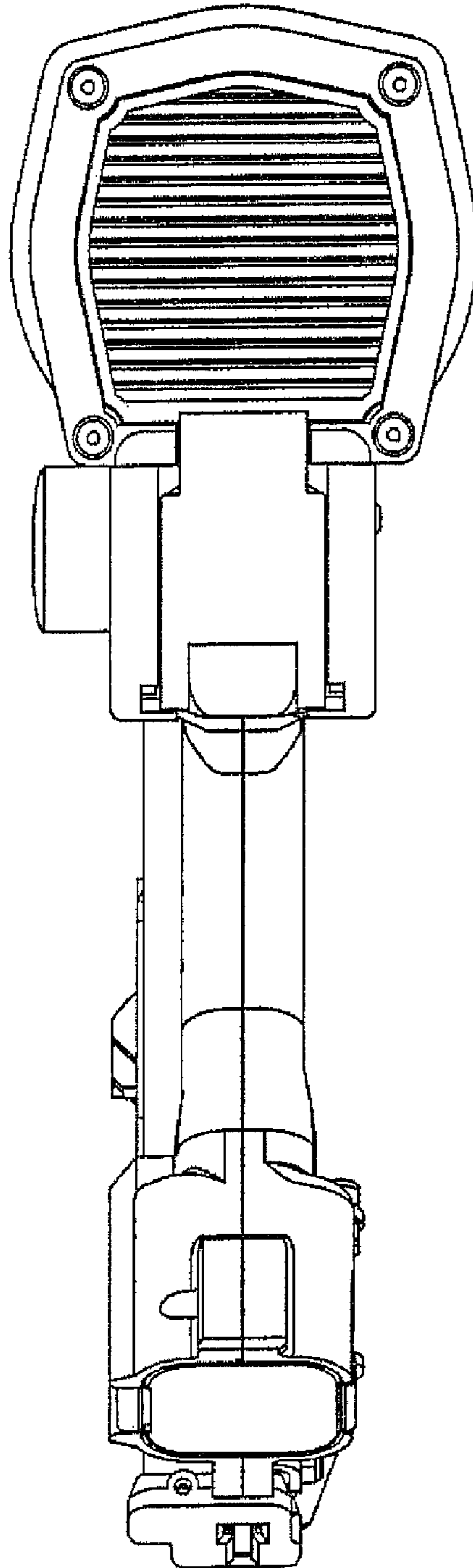

FIG. 6

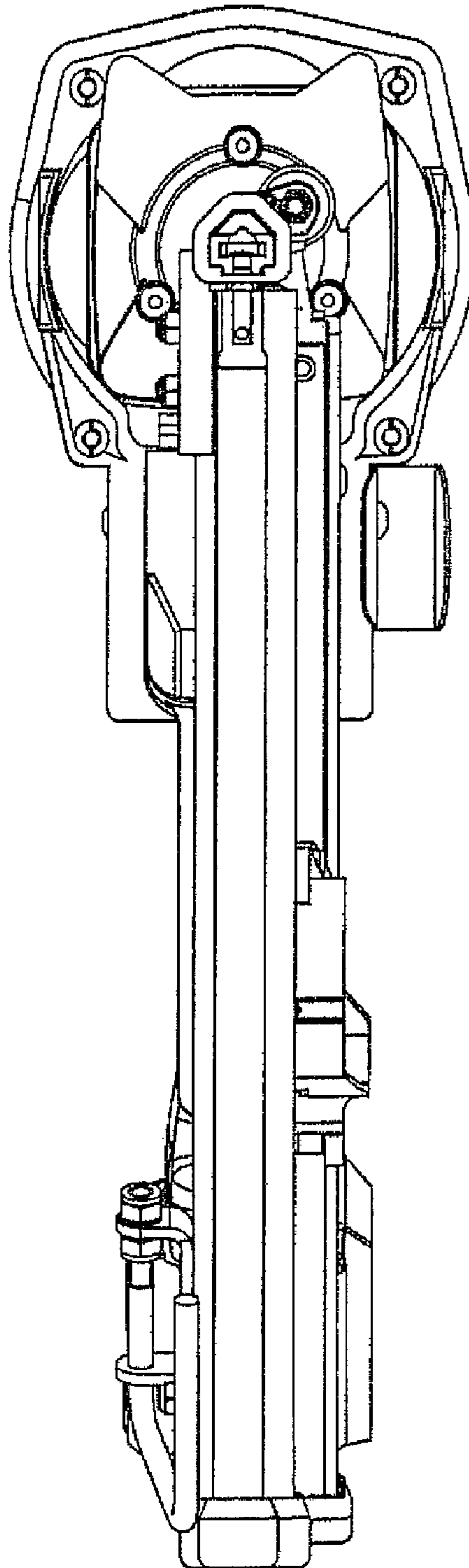

FIG. 7

