



US00D590752S

(12) **United States Design Patent**
Williams et al.

(10) **Patent No.:** **US D590,752 S**

(45) **Date of Patent:** **** Apr. 21, 2009**

(54) **VEHICLE LOWER BUMPER COVER**

D579,386 S * 10/2008 Saridakis et al. D12/169

(75) Inventors: **Bruce P. Williams**, Grosse Pointe Park, MI (US); **Sean W. Tant**, Livonia, MI (US); **George Bucher**, Dearborn, MI (US); **Patrick J. Schiavone**, Bloomfield, MI (US)

* cited by examiner

Primary Examiner—Melody N Brown

(74) *Attorney, Agent, or Firm*—Damian Porcari

(73) Assignee: **Ford Motor Company**, Dearborn, MI (US)

(57) **CLAIM**

The ornamental design for a vehicle lower bumper cover, shown and described.

(**) Term: **14 Years**

DESCRIPTION

(21) Appl. No.: **29/306,168**

FIG. 1 is a front elevational view of a vehicle lower bumper cover;

(22) Filed: **Apr. 3, 2008**

FIG. 2 is a side elevational view of the vehicle lower bumper cover, the opposite side is a mirror image of that shown;

(51) **LOC (9) Cl.** **12-16**

FIG. 3 is a top plan view of the vehicle lower bumper cover;

(52) **U.S. Cl.** **D12/169**

FIG. 4 is a bottom plan view of the vehicle lower bumper cover; and,

(58) **Field of Classification Search** D12/169,
D12/196, 171, 163, 216, 90–92, 86; 293/102,
293/113, 115, 117, 120; 296/180.1, 180.2
See application file for complete search history.

FIG. 5 is rear elevational view of the vehicle lower bumper cover.

(56) **References Cited**

U.S. PATENT DOCUMENTS

D491,119 S	6/2004	Metros	
D491,848 S	6/2004	Metros	
D492,627 S	7/2004	Metros	
D494,898 S	8/2004	Metros	
D497,577 S	10/2004	Metros	
D548,146 S *	8/2007	Schiavone et al. D12/169
D556,653 S *	12/2007	Leclercq D12/169
D560,144 S *	1/2008	Tant et al. D12/169

The vehicle lower bumper cover is styled independently of adjacent vehicle panels. To the extent that any feature lines are illustrated, they are intended to illustrate the crest and valley of the feature and are not necessarily sharp bends in the part. Shading is used to illustrate the curvature of the part and not color. Areas shown in or sounded by broken lines are not claimed. Any functional features of the vehicle lower bumper cover are not claimed. Views are orthogonal projections rendered from computer aided design data. The various views are not necessarily to scale in order to better illustrate the design.

1 Claim, 5 Drawing Sheets



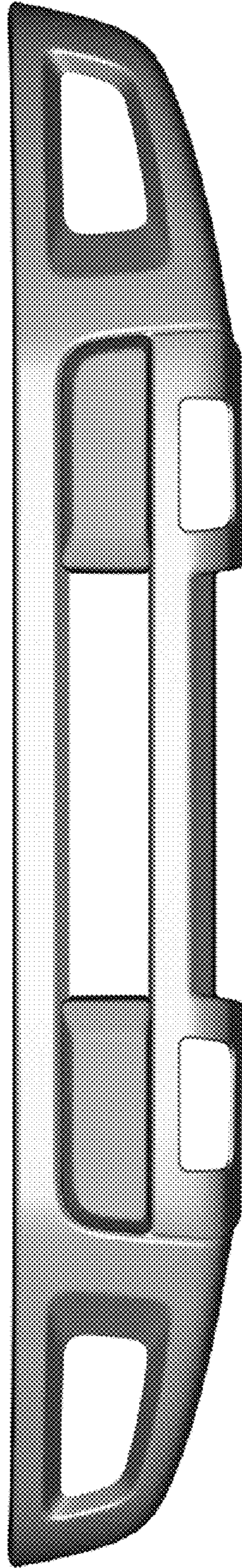

Figure 1

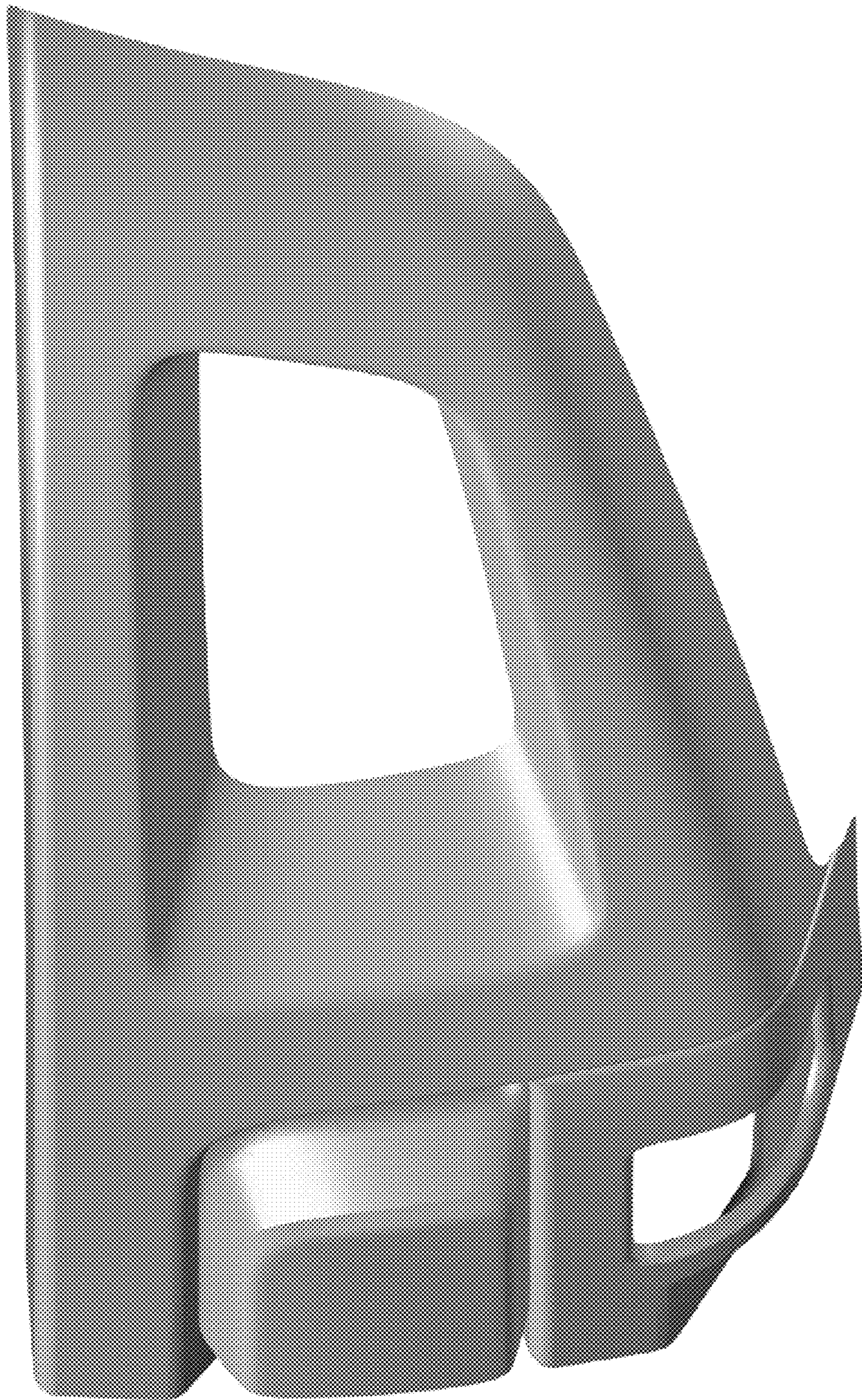

Figure 2

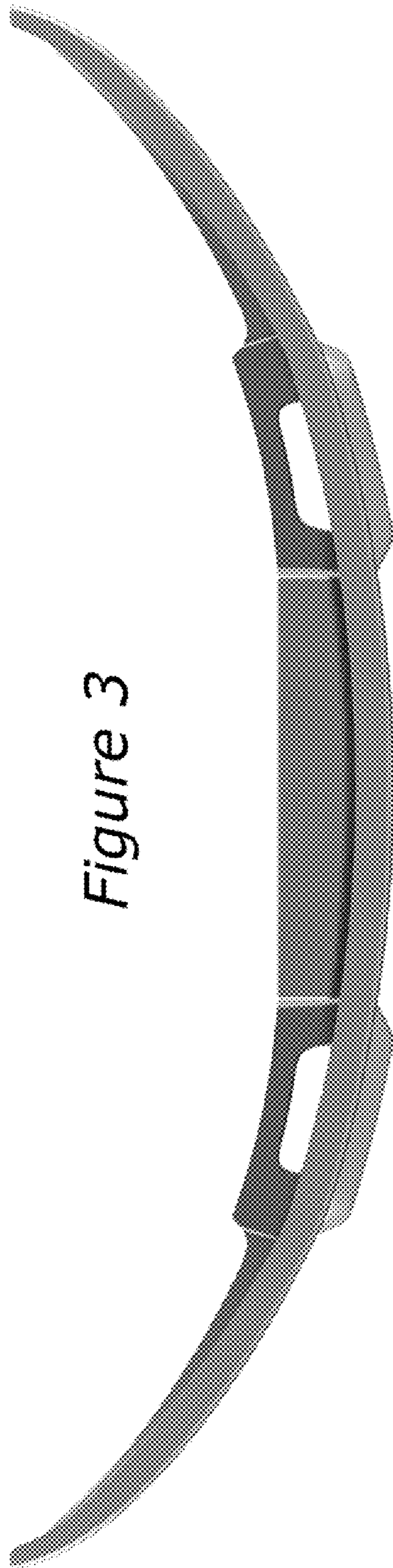

Figure 3

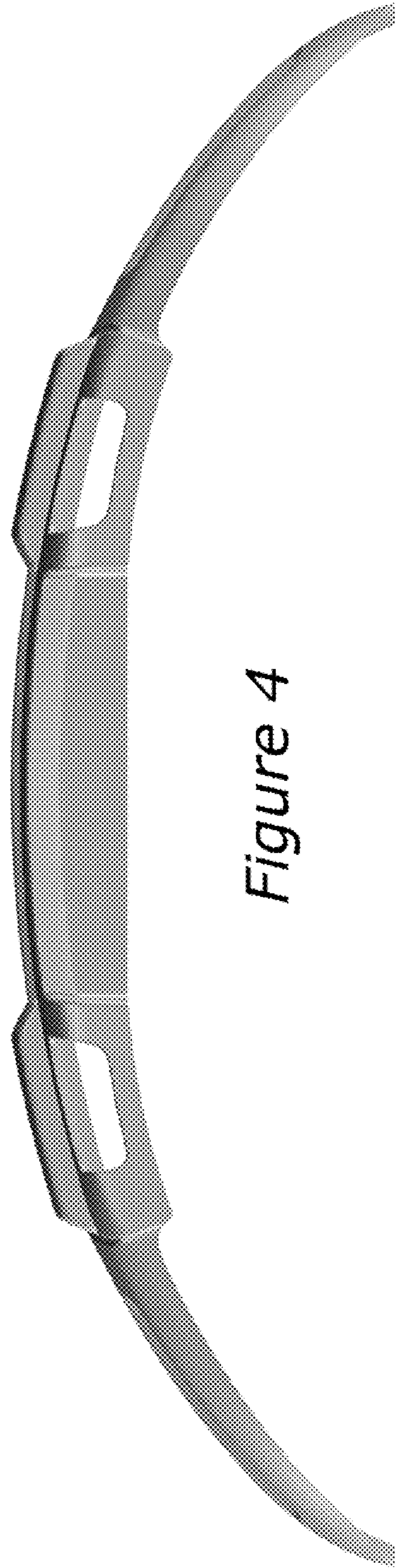

Figure 4

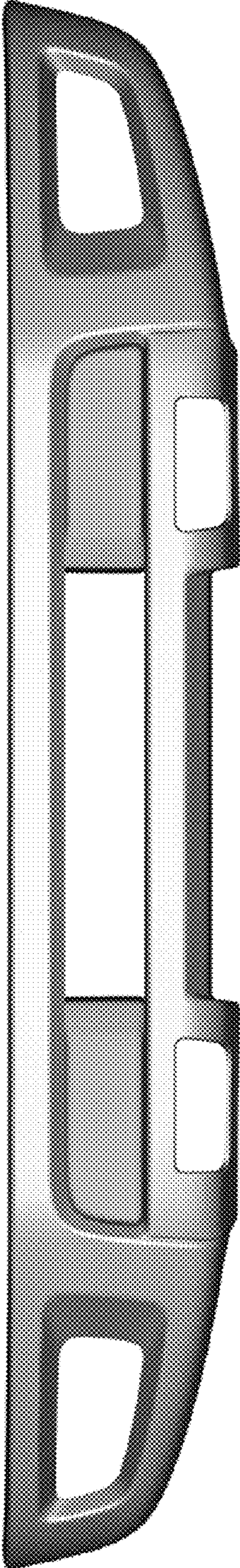

Figure 5